

Gen III Canopy
MITSUBISHI TRITON MY23
 Installation Instructions

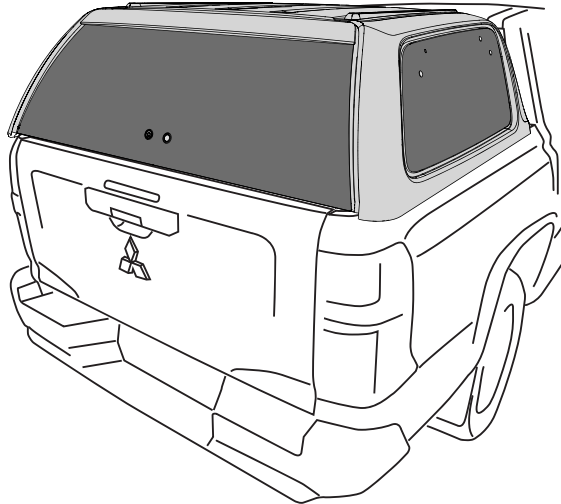

Installation Time: Approx. 90 mins

Important

- Do not tighten any bolts, screws and nuts that are used in window frames, locks and glass assemblies. This may cause water leaks along window frames and glass windows to shatter.
- Read instructions carefully before installation.
- It is strongly recommended that installation is conducted by an authorized dealer.
- This product must be installed exactly as specified in these instructions. Failure to do so may result in improper fit and/or retention/failure of components.

PERSONAL PROTECTIVE EQUIPMENT:

Mask

Rubber Gloves

Goggles

Hearing Protection

Care Instructions:

Clean canopy with a mild detergent and water solution.

Do not use abrasive cleaners or solvents.

Tools Required:

 13mm Socket Wrench	 Spanner 13mm	 Drill & Ø9mm bit	 Torque Wrench	 Rivet gun	 Nutsert Tool	 Tape Measure
 Non permanent marker	 Masking Tape	 Silicone & Gun				

PARTS IN CANOPY KIT:

1

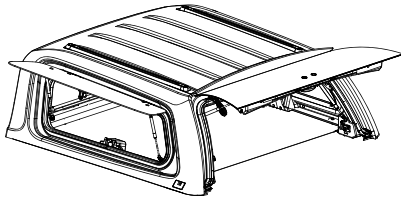

Canopy
Qty - 1

2

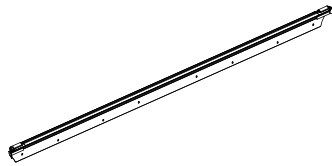

Tailgate Rail
(CNPY0109)
Qty - 1

3

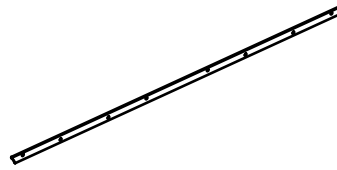

Tailgate Spacer
(MISC6027)
Qty - 1

4



Keys
Qty - 1

PARTS IN FITTING KIT039814:

5



Rail Clamp (inner)
(CLIP3533PC)
Qty - 6

6

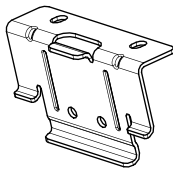

Rail Clamp (outer)
(CLIP3921PC)
Qty - 6

7



Stop Bracket
(CLIP4201PC)
Qty - 2

8



Top Plate
(CLIP3767PCTX)
Qty - 8

9



Clamp Template
(MISC5959)
Qty - 1

10

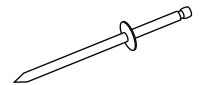

Rivet
(FAST0609)
Qty - 8

11

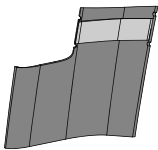

Rear Flap Seal LH
(MISC6025-LH)
Qty - 1

12

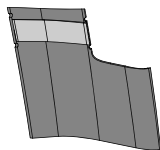

Rear Flap Seal RH
(MISC6025-RH)
Qty - 1

13



M8 Clutch Nut
(NUTS0250-1)
Qty - 16

14



M8 Washer
(WASH0171-1)
Qty - 33

15

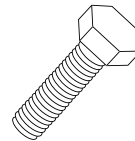

M8x30 Bolt
(SCRW0846)
Qty - 28

16

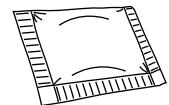

Rust Inhibitor
(MISC2776)
Qty - 1

17



Anti Abrasion Tape
110x15mm
(TAPE0258-6)
Qty - 2

18



Anti Abrasion Tape
140x60mm
(TAPE0649)
Qty - 6

19



Tape EPDM
14x6x1540
(TAPE0687)
Qty - 1

20

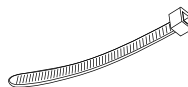

Cable Tie
(CONS1590)
Qty - 20

21



Cable Tie
(FAST0254)
Qty - 35

22

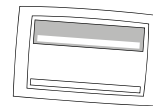

Alcohol Wipe
(MISC0052)
Qty - 8

23

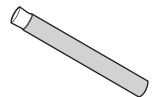

Primer
(MISC1365)
Qty - 3

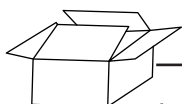

24 TUB REINFORCEMENT KIT040542

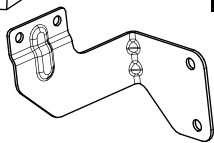

Tub Reinforcement
Bracket RH
Qty - 1

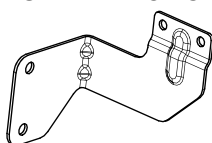

Tub Reinforcement
Bracket LH
Qty - 1

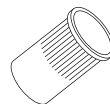

M8 Nutsert
Qty - 4



M8 Washer
Qty - 8

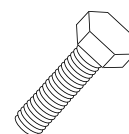

M8x30 Bolt
Qty - 8

ELECTRICAL COMPONENTS:

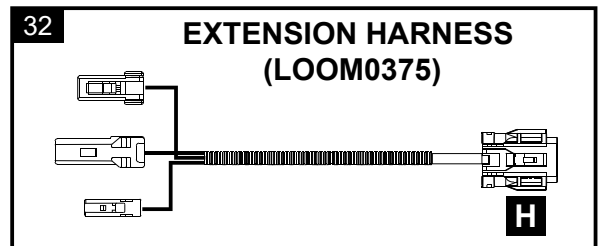
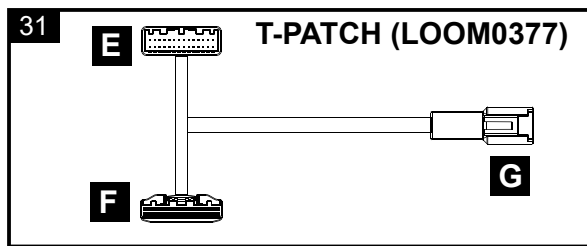
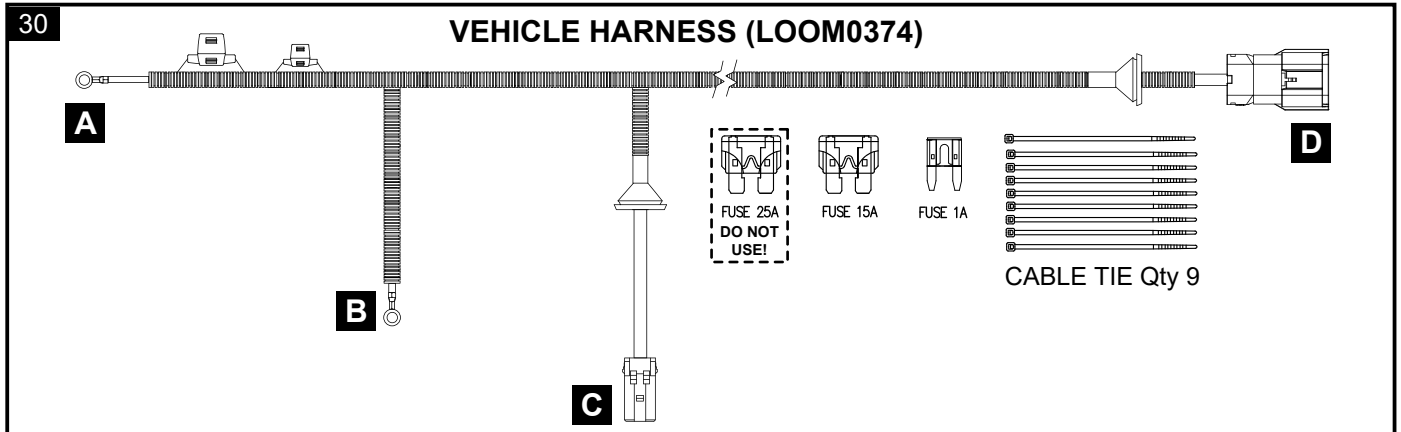

ELECTRICAL LOOM LAYOUT

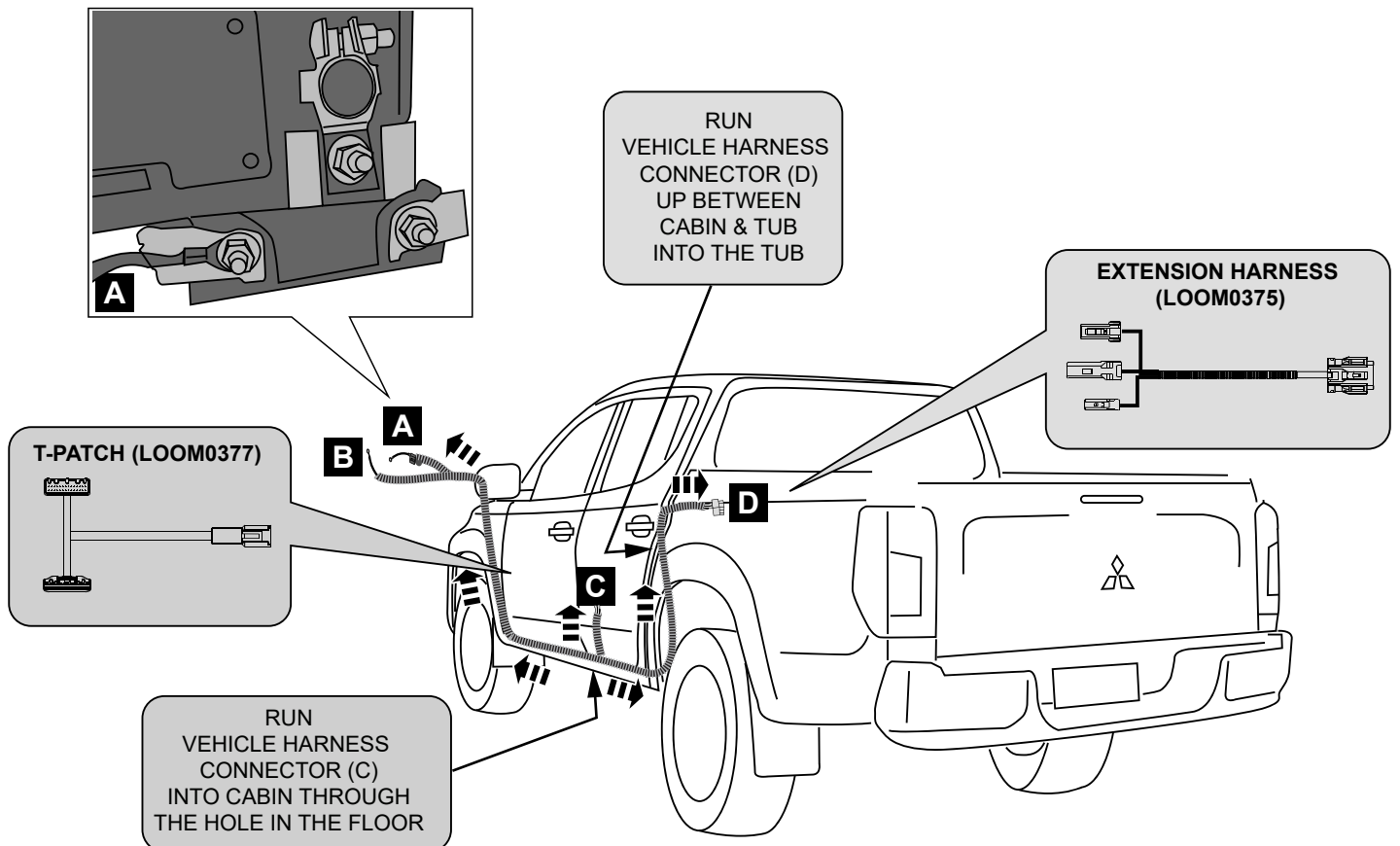

GEN III CANOPY

SECTION A

ELECTRICAL LOOM INSTALLATION

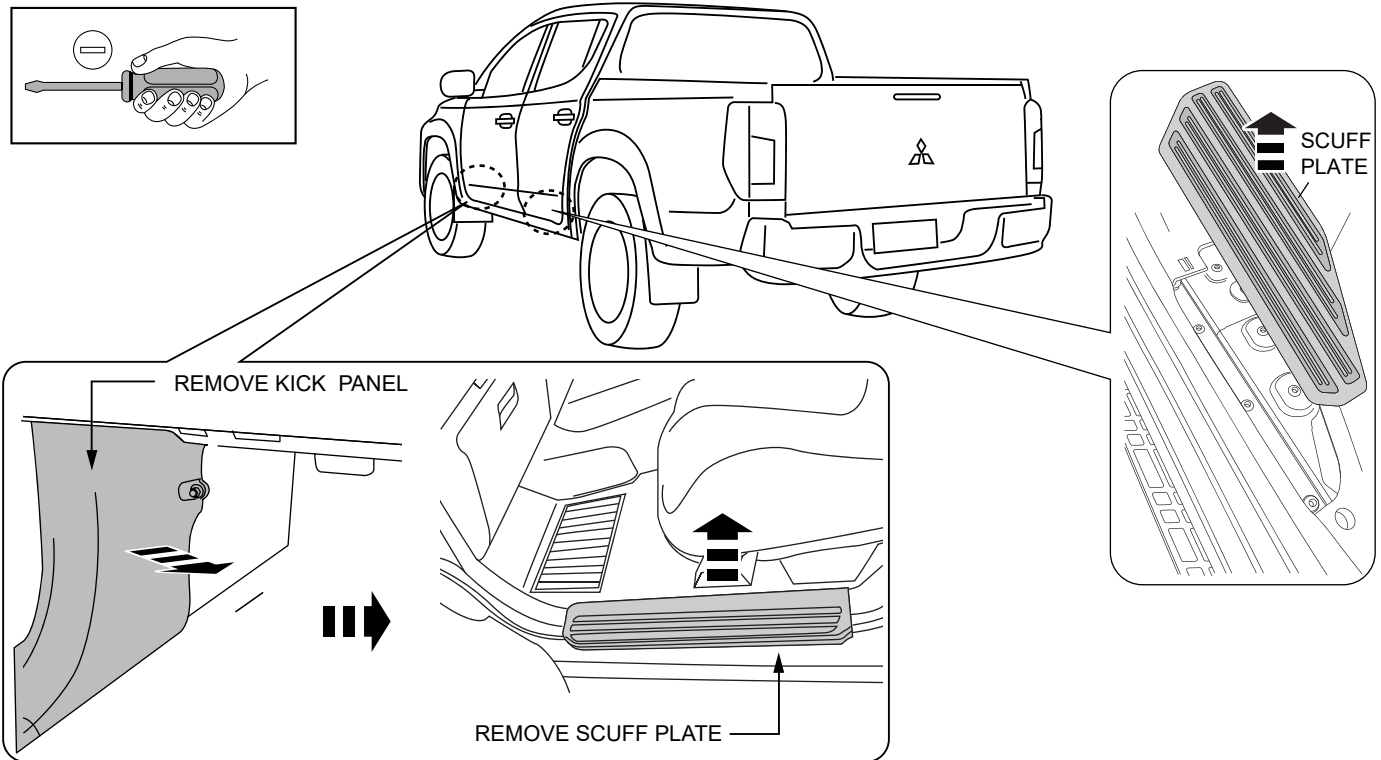

- 1 Remove and retain front passenger kick panel and scuff plate. Remove and retain rear passenger scuff plate.

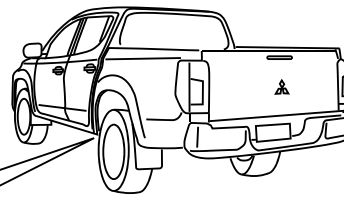
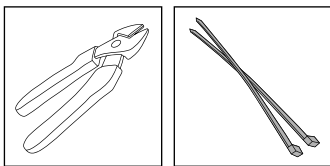

UNDERNEATH VEHICLE

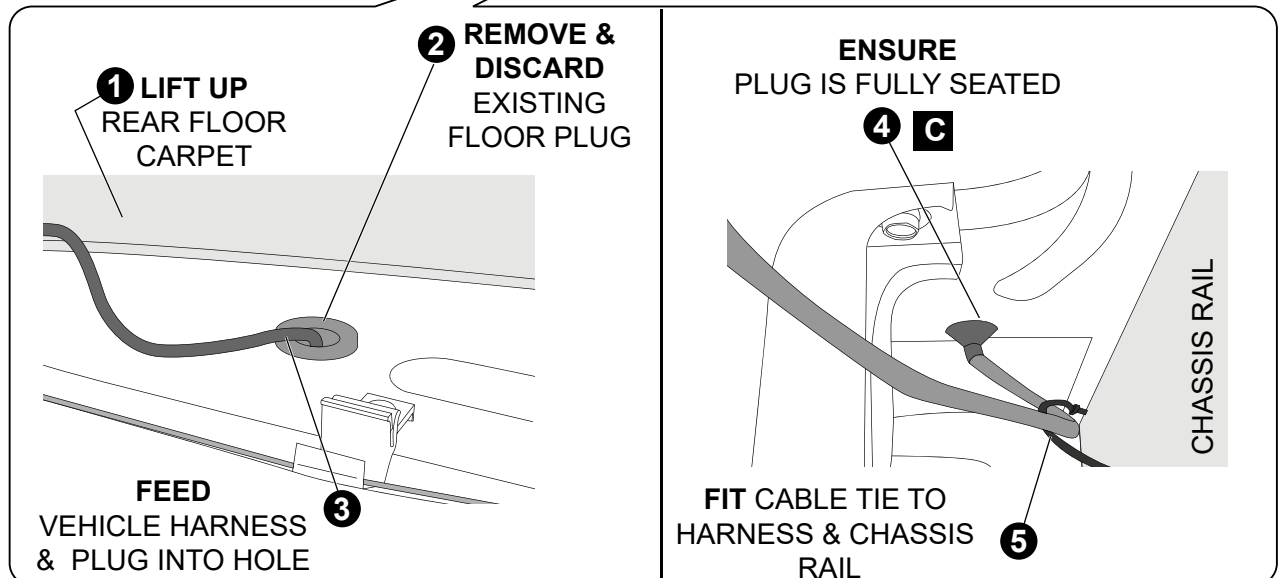

- 2 Lift up passenger side rear floor carpet. Remove and discard the existing plug in the floor. Feed the vehicle harness connector (C) down through the floor and fit the vehicle harness plug into the sheet metal. **Important: Check under the vehicle that plug is correctly located into the sheet-metal and fully seated to prevent water entering the vehicle.** Attach one (1) long cable tie to secure the vehicle harness to the top of the chassis rail as shown. Trim cable tie.

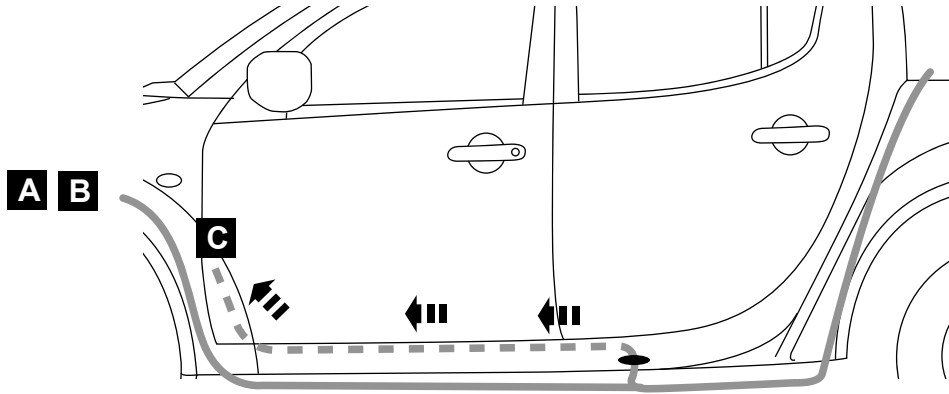

3 Run vehicle harness connector (C) along to the front passenger kick panel.

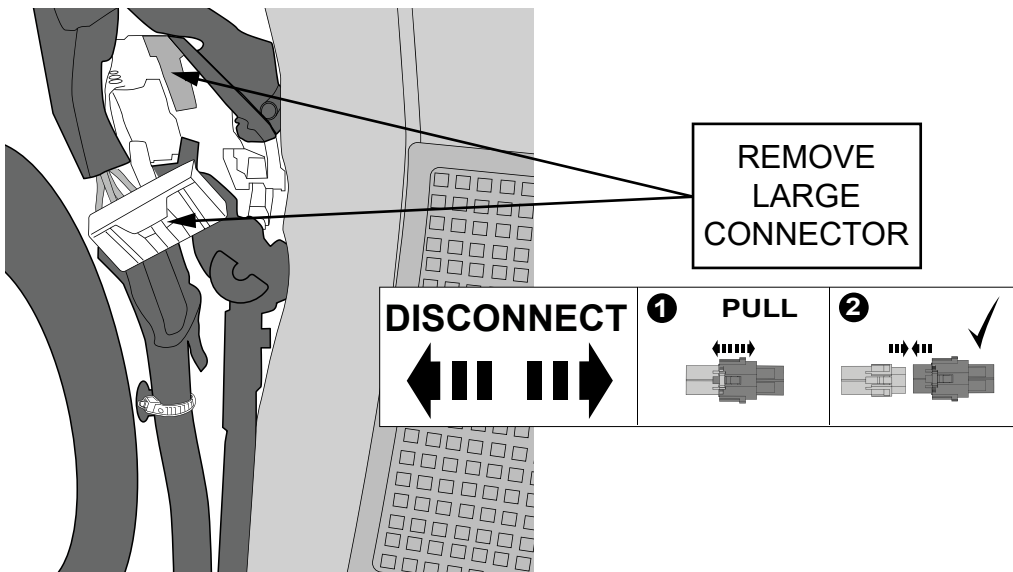

4 Behind the kick panel in the front passenger area, locate the large white connector and unplug it from the panel.

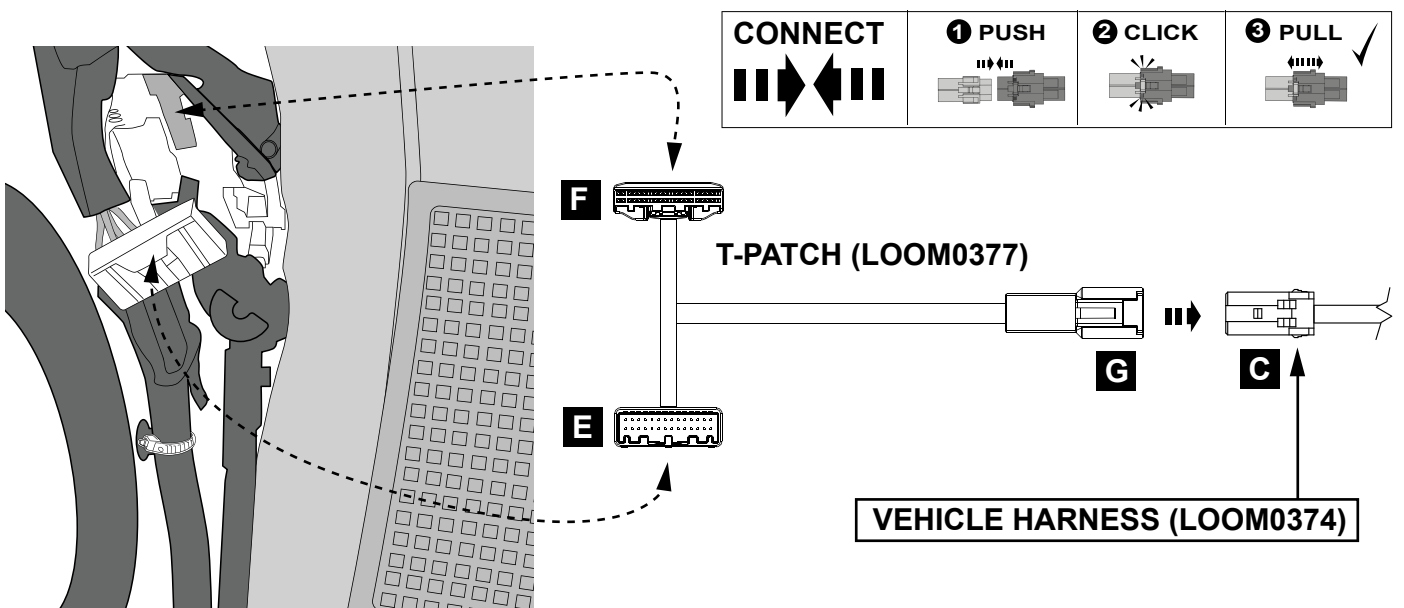

5 Connect the T-Patch (LOOM0377) connector (E) to the removed vehicle connector and connector (F) to the panel as shown. Connect the T-Patch connector (G) to the Vehicle Harness (LOOM0374) connector (C). Secure the harness to the existing harness using cable ties (supplied).

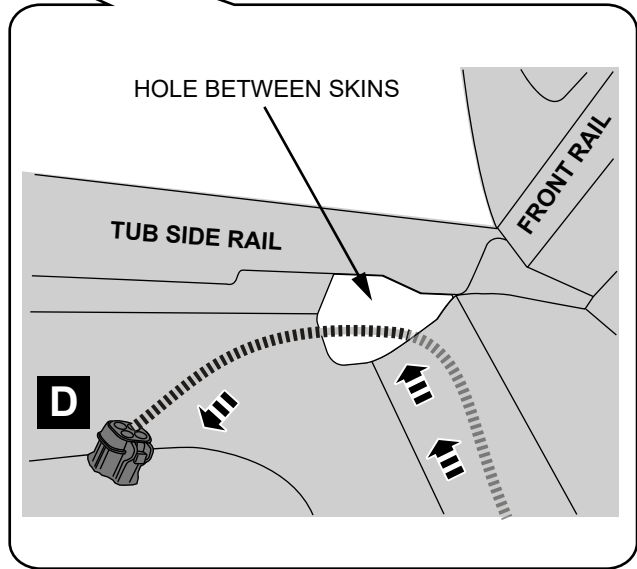
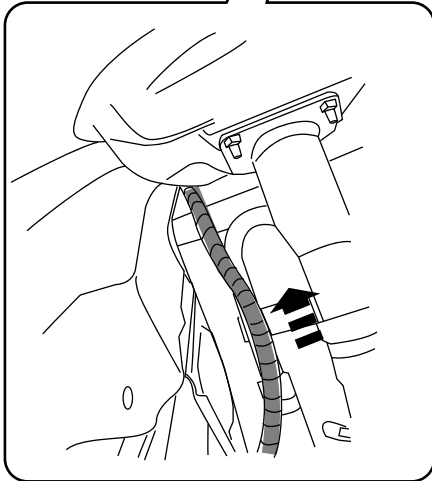
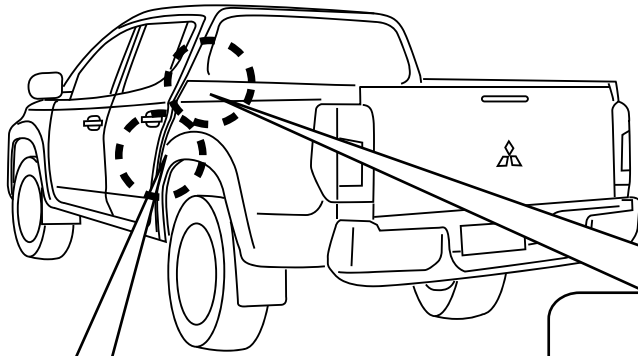

- 6** Run vehicle harness (connector D) along chassis rail towards the rear and secure with cable ties to existing vehicle harness. Remove wheel arch front section to allow feeding a draw wire from inside the tub down to the vehicle harness. Feed the harness up into the tub using draw wire fitted through the gap in the tub wall.

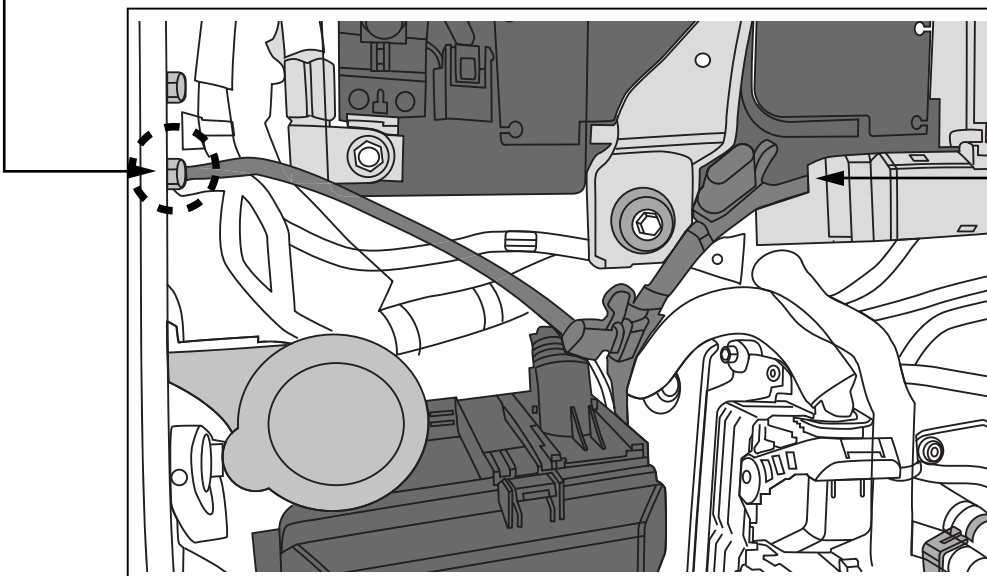
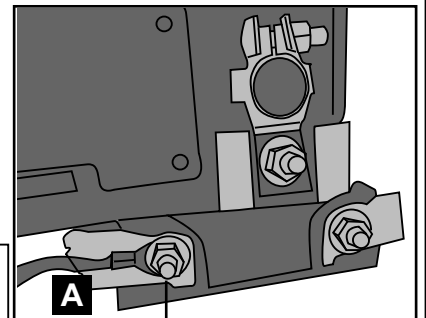
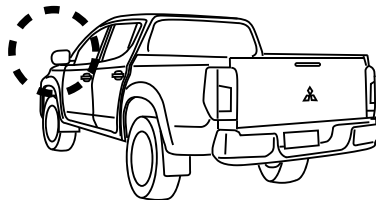
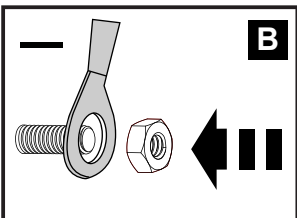

- 7** Feed the harness (connectors A&B) up into the engine bay from underneath the car. Connect the vehicle harness (A) to the positive terminal of the battery. Connect the vehicle harness (B) to the ground located in the engine bay. Once it is positioned, secure in place using cable ties.

SECTION B

TUB PREPARATION

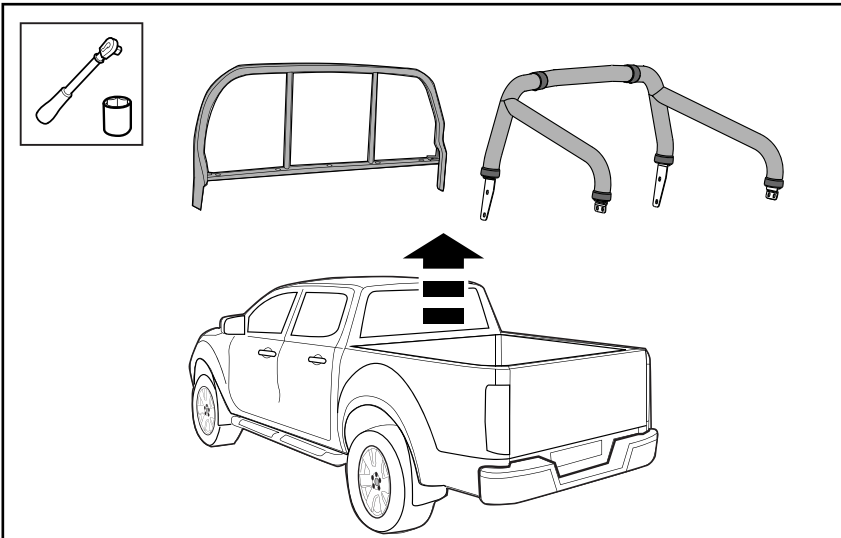

Diagram: 1 - REMOVE CABIN GUARD OR SPORTS BAR

1.

Carefully remove any accessories (Sports Bars, Cabin Guards, etc.) attached to the tub of the vehicle.

Thoroughly wash the vehicle and tub and ensure that all dirt and grease is removed. Allow to dry. Clean the top surfaces of the tub and tailgate.

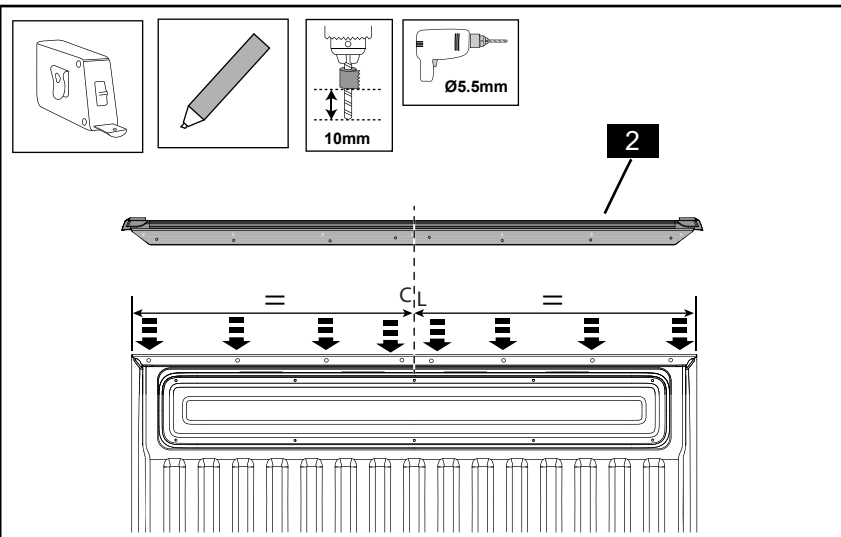

Diagram: 2 - MARK & DRILL TAILGATE

2.

Mark a centre line on the Tailgate Rail (2) and tailgate (as shown).

Place the Tailgate Rail on the tailgate and check that it is equally spaced from each end of the tailgate.

Mark the 8 holes on the front of the tailgate using a non-permanent marker and remove the Tailgate Rail.

Drill the marked locations with Ø5.5mm drill.

Apply Rust Inhibitor to all drilled holes.

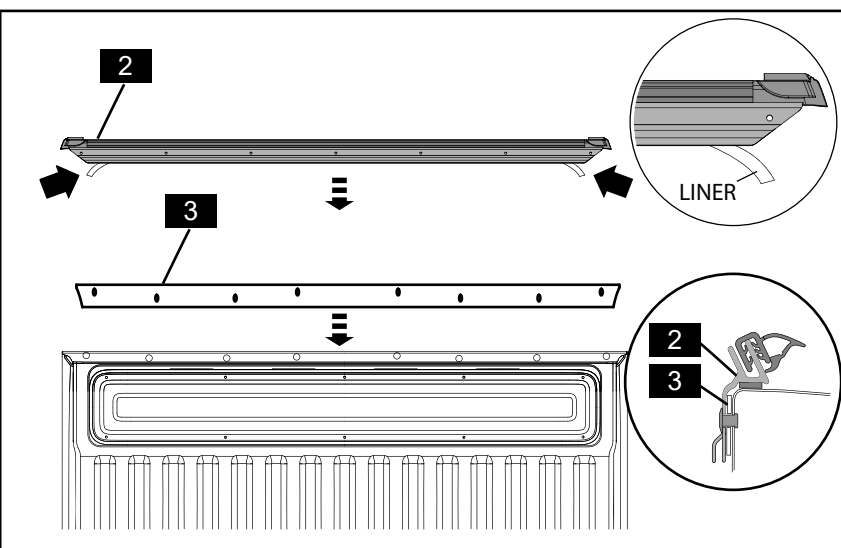

Diagram: 3 - FIT TAILGATE EXTRUSION

3.

Clean the top of tailgate with an alcohol wipe and apply primer. Allow to dry.

Place the Tailgate spacer (3) on the tub first. Hold the spacer in place while placing the rail on tailgate.

Remove 50mm of the liner from the double sided tape on the Tailgate Rail. Fit the Tailgate Rail to the tailgate, aligning with the marked center line.

Loosely insert the Rivets (8) through the holes in the Tailgate Rail (2) and Tailgate Spacer (3), into the tailgate, then remove liner from the double sided tape by pulling on the liner from both ends of the Tailgate Rail.

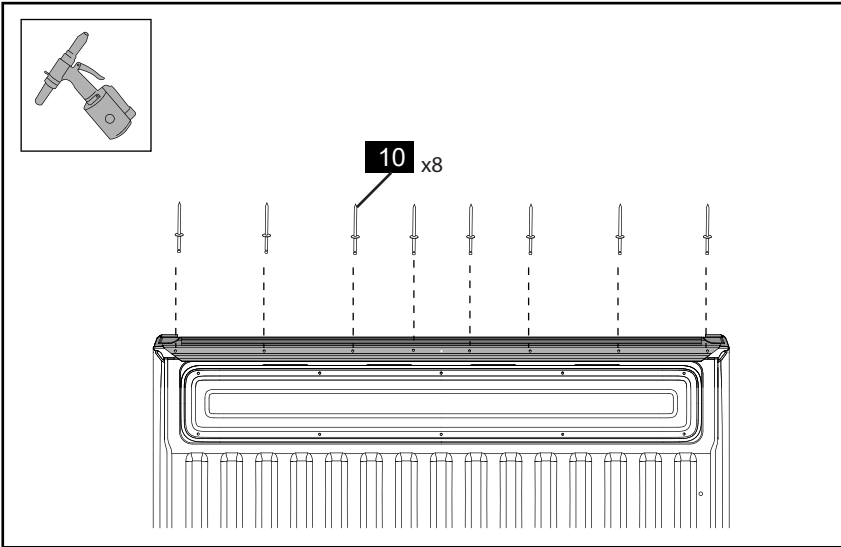

Diagram: 4 - FIT RIVETS

4.

Secure the Tailgate Rail with 8 Rivets (10). Apply firm pressure on the Tailgate Rail to ensure maximum adhesion of the tape.

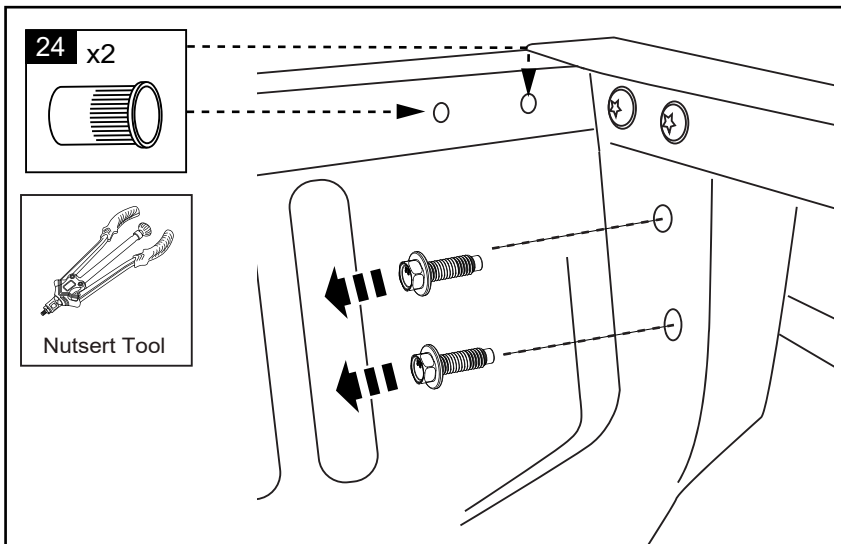

Diagram: 5 - TUB REINFORCEMENT

5.

Remove and discard the two M8 screws from the front tub side panel as shown.

Fit two M8 Nutserts (24) per side into the holes in the front tub rail.

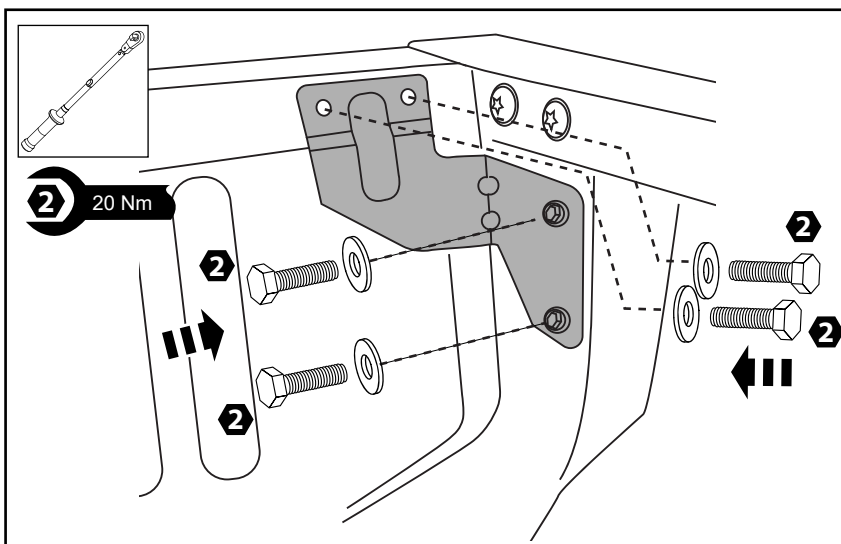

Diagram: 6 - TUB REINFORCEMENT

6.

Place the Tub reinforcement bracket (24) in the RHS front tub corner and secure to the tube with four M8 screws and four washers. Torque to 20Nm.

IMPORTANT: If tubliner is fitted, trace the shape of the bracket onto it and trim the tubliner. Bracket must be fixed direct to tub sheet metal.

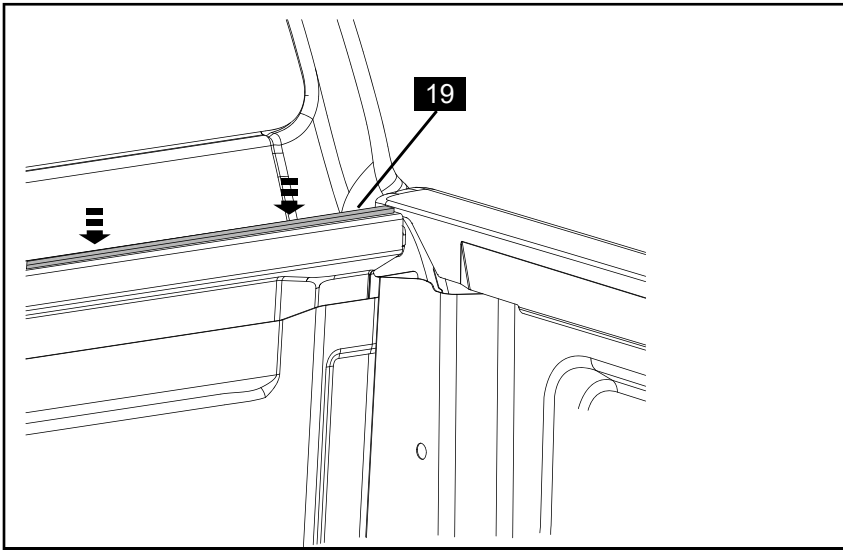

Diagram: 7 - APPLY EPDM TAPE

7.

Clean the top of the front tub rail with Alcohol Wipe (22) and apply Primer (23). Allow to dry. Fit the EPDM Tape (21) along the top edge and trim if necessary. Press firmly to adhere the double sided tape.

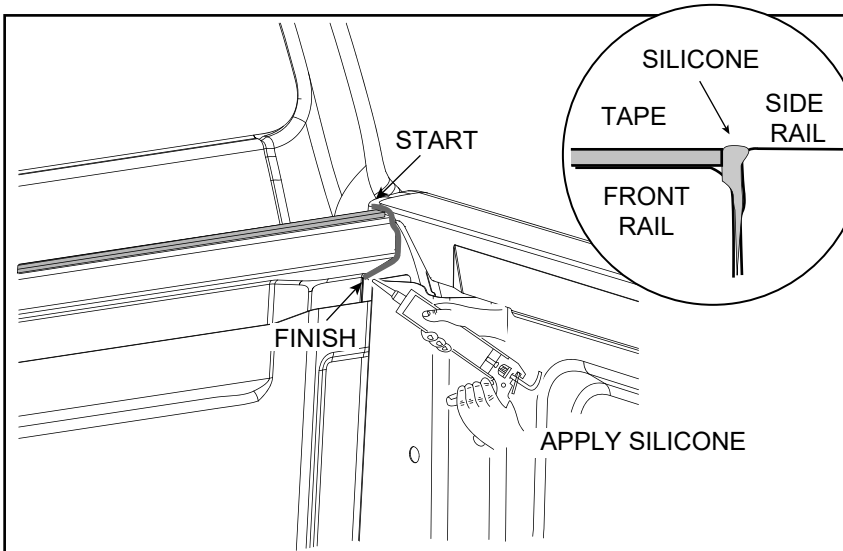

Diagram: 8 - APPLY SILICONE

8.

Apply a bead of silicone in the corner gap between the front and side rail as shown.

! Important: Apply at an angle to ensure that the silicone enters the space between the top of the front rail and side rail for the optimal seal.

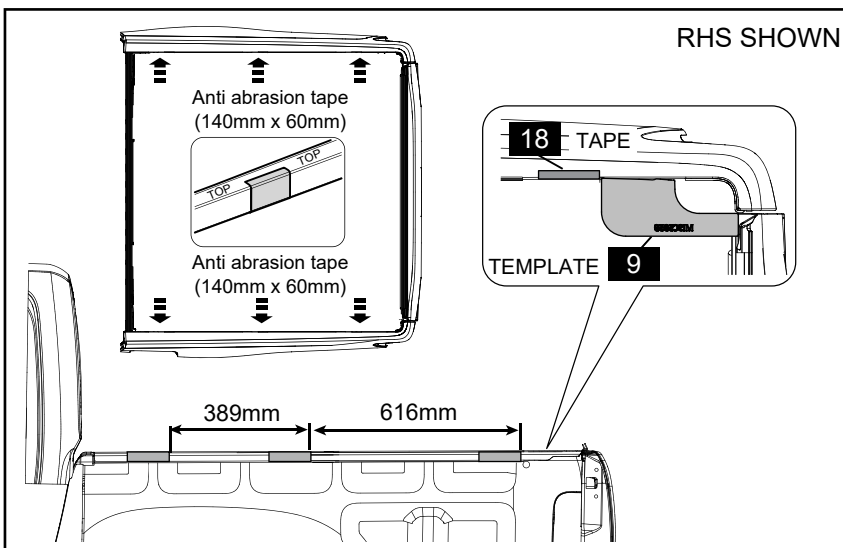

Diagram: 9 - APPLY ANTI ABRESIVE TAPE

9.

Using the Clamp Template (9) at the rear of the tub, position the first Anti Abrasion Tape (18) on the inside side rails as shown. Place 2nd and 3rd tape using dimensions as shown. Repeat for LHS.

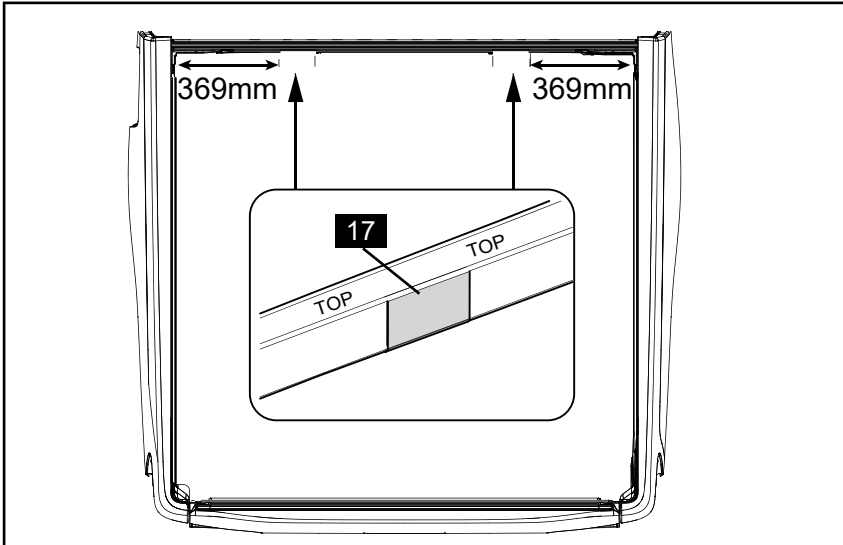
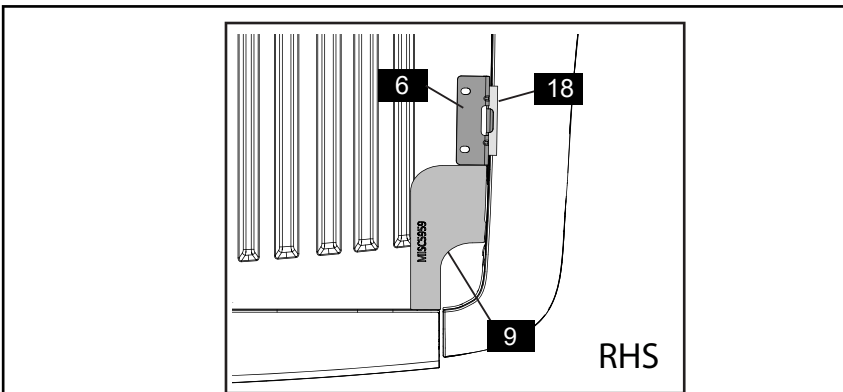

Diagram: 10 - APPLY TAPE TO FRONT RAIL

10.

Apply Anti Abrasion Tape (17) in two locations to the front of the tub where the stop bracket will contact the tub. Measure 369mm from the inside tub rail.



11.

Using the fitment tool (9) fit Rear Clamping Bracket (6+5) to the tub using two M8 Hex Bolts (11) and two Washers (10).

Measure 465mm from the edge of the rear bracket and fit the Mid Clamp Bracket (6+5) followed by 249mm gap for the third bracket as shown.

Torque all Bolts (11) to 20Nm.

Repeat for LHS.

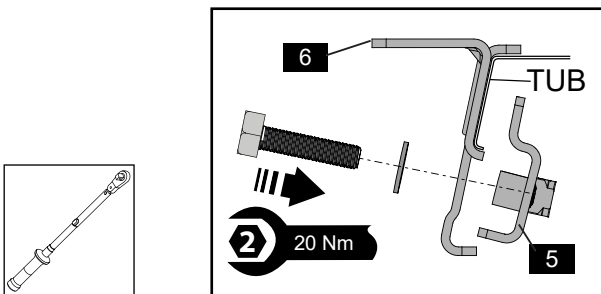
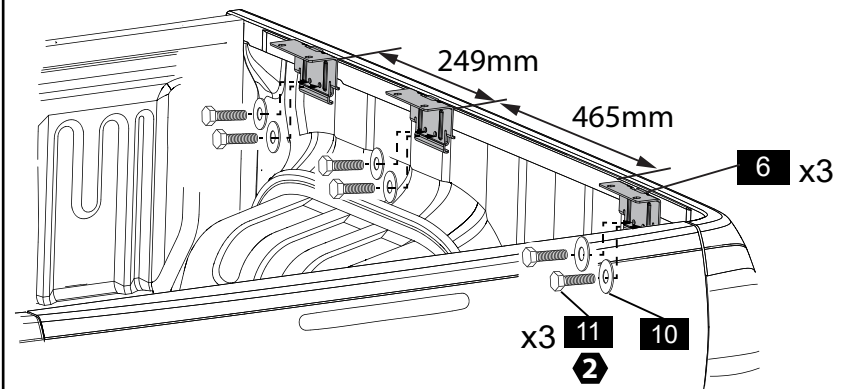

Diagram: 11 - FIT RAIL CLAMPS

SECTION C

CANOPY INSTALLATION

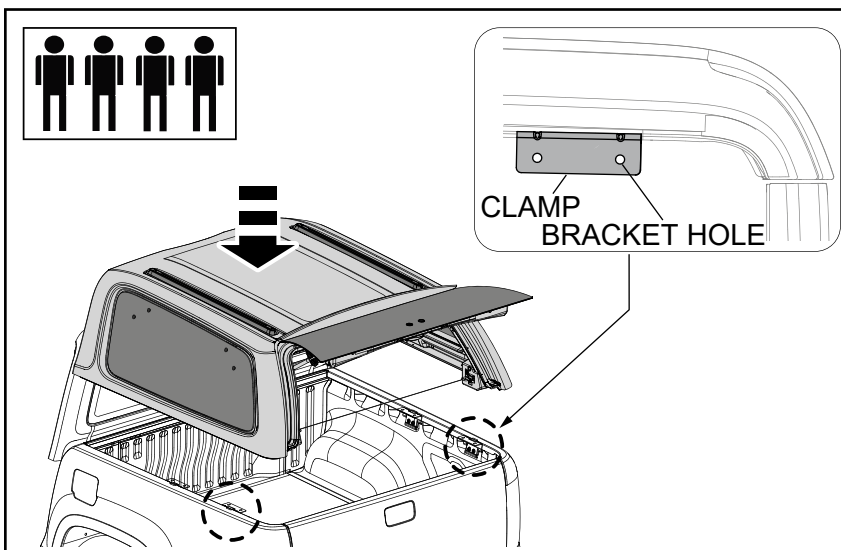

Diagram: 1 - FIT CANOPY

1.

With the rear canopy window open, gently lower the Canopy (1) onto the tub, ensuring it is seated evenly on the tub sides, and slightly back. Align the rear datum hole in the canopy base rail with the hole in the Rear Clamp (6) as shown. Position the canopy to be central sideways by checking the side alignment and front holes of the side rail placed over the side clamp brackets.

- ⚠ Important: The installation should be performed by four people for safety and efficiency.
- ⚠ Important: Remove the keys secured from the rear door of the canopy before proceeding.

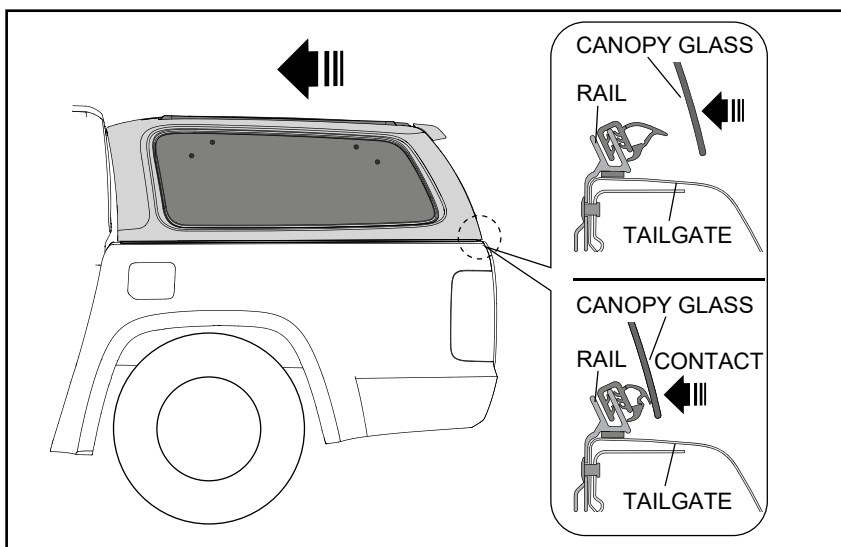

Diagram: 2 - CANOPY POSITION CHECK

2.

With one person inside the Canopy, slowly close the rear canopy window, and note how it closes. It should not touch the top of the tailgate and fully compresses the rubber extrusion of the Tailgate Rail.

If it fails to close correctly, see the striker adjustment guide in Section D.

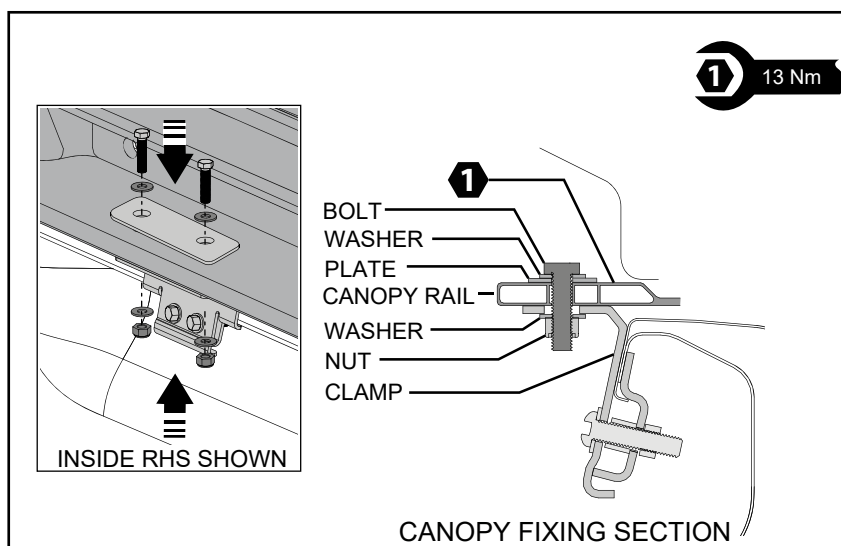

Diagram: 3 - SECURE CANOPY

3.

Secure the Canopy (1) to the Rail Clamps using the M8x30 Bolts (15), M8 Washers (14), Top Plates (8) and M8 Clutch Nuts (13).

Bolts through the Canopy Rail, torque to 13Nm.

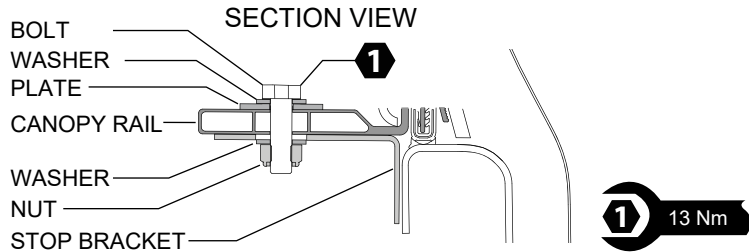
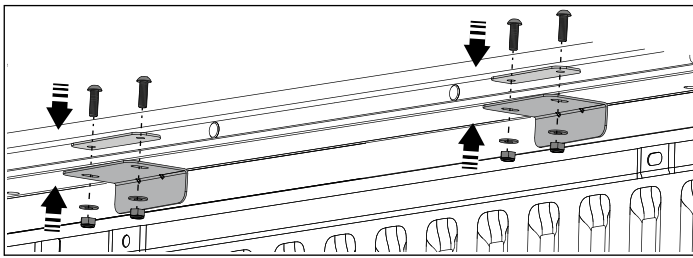
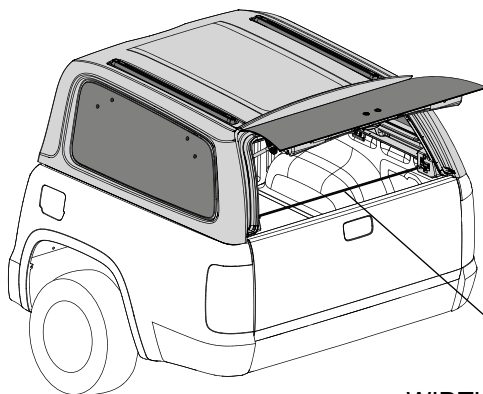

Diagram: 4 - FIT STOP BRACKETS

4.

Locate the holes in the front rail of the Canopy (1) and attach the Stop Brackets (7) using the M8x30mm Bolts (15), M8 Washers (14), Top Plates (8) and M8 Clutch Nuts (13). Torque to 13Nm.



REMOVE WIDTH SETTING CABLE

Diagram: 5 - REMOVE WIDTH SETTING CABLE

5.

Remove width setting cable from rear of the Canopy (1).

CONNECT

1 PUSH

2 CLICK

3 PULL ✓

EXTENSION HARNESS (LOOM0375)

VEHICLE HARNESS (LOOM0374)

6.

Inside the canopy front RHS corner, connect the Vehicle Harness (LOOM0374) connector (D) to the Extension Harness (LOOM0375) connector (H).

Diagram: 6 - CONNECT EXTENSION HARNESS

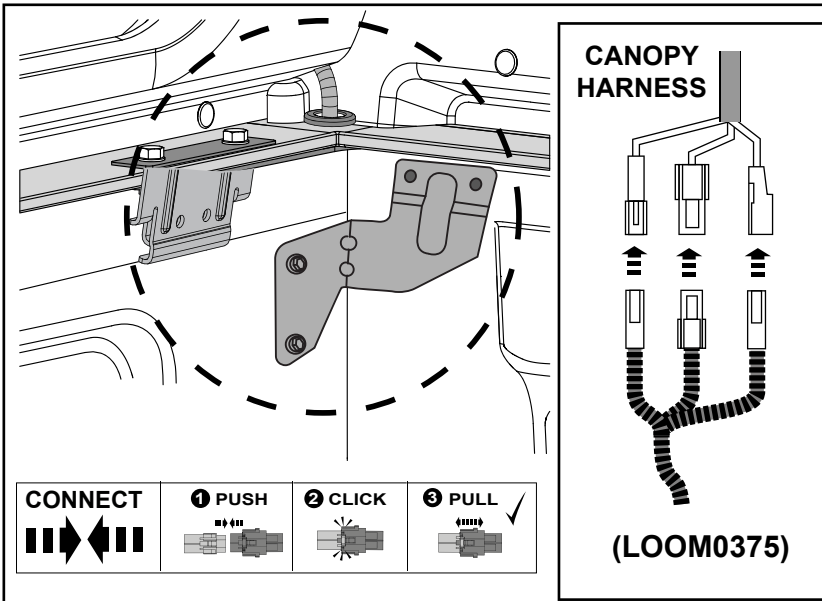

Diagram: 7 - CONNECT CANOPY HARNESS

7.

Connect the 3 connectors from the Extension Harness to the canopy harness as shown.

Tidy up the wiring and using cable ties attach to the canopy rail where possible.

Fit the 15A & 1A fuses to the fuse holders near the positive battery terminal.

8.

Test fit the Rear Flap Seal (LHS shown) to the inside corner of the canopy. Top edge to be just below the rubber dimple. Note where the double sided tape will adhere.

Prep the surface on the canopy with alcohol wipe (22) and primer (23). Allow to dry.

Remove the tape liner from the seal and fit inside the canopy. Press the rubber hard against the canopy.

Repeat for the RHS.

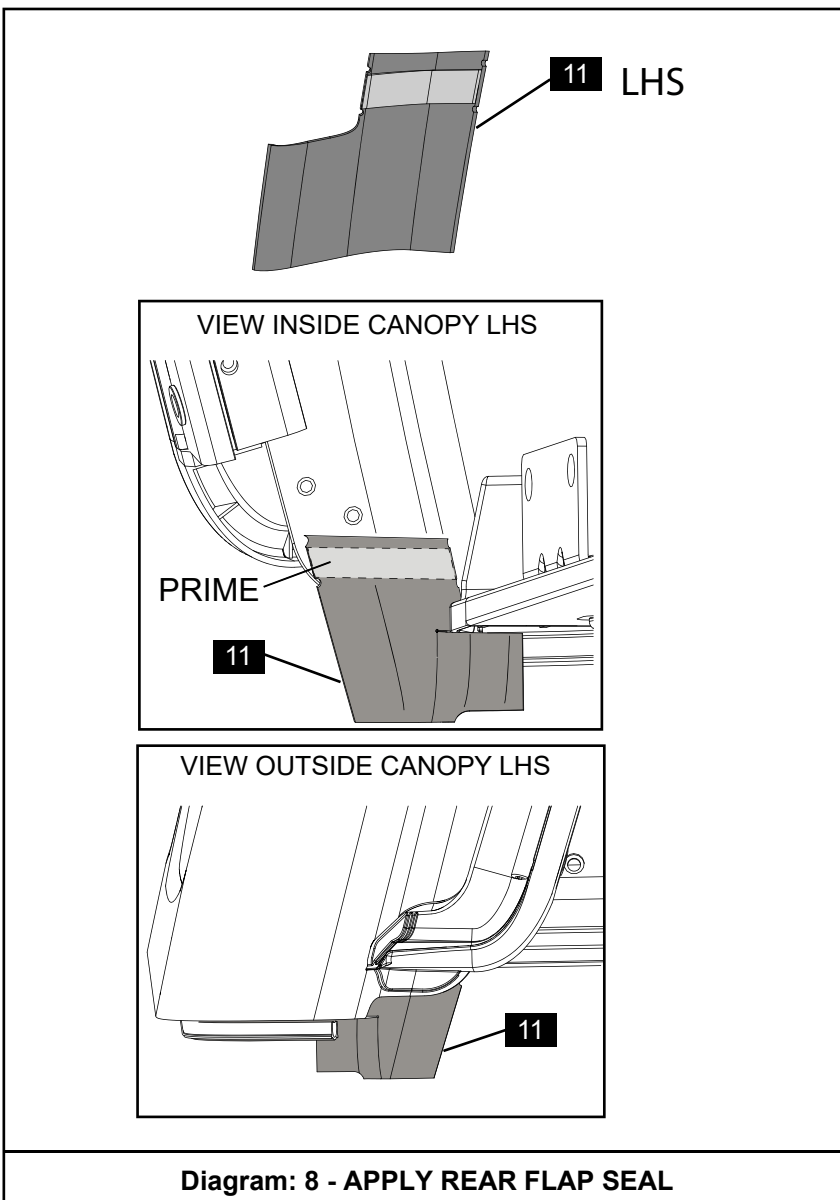
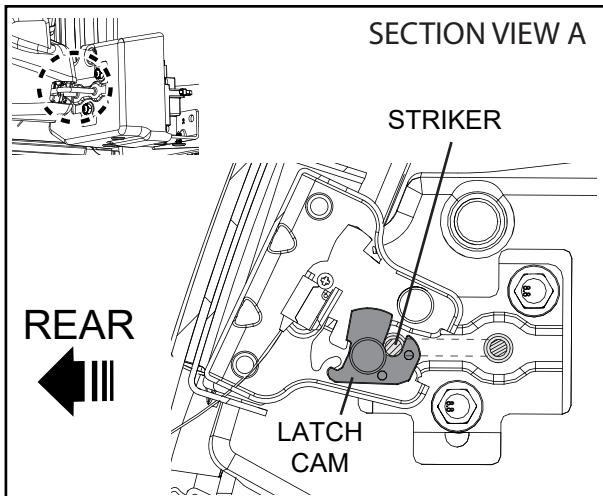

Diagram: 8 - APPLY REAR FLAP SEAL

SECTION D

STRIKER ADJUSTMENT GUIDE



STEP A

REAR DOOR LOCKING CHECK

- Check that the Striker on both sides of the canopy closes correctly. The Latch Cam is a single stage locking mechanism.
- Listen for a single distinct click from each side of the canopy window when locking or unlocking the window.
- If the Latch Cam does not produce a click on either side of the window, the Striker is not engaging the Latch Cam correctly. Got to **STEP B** for striker adjustment guide.

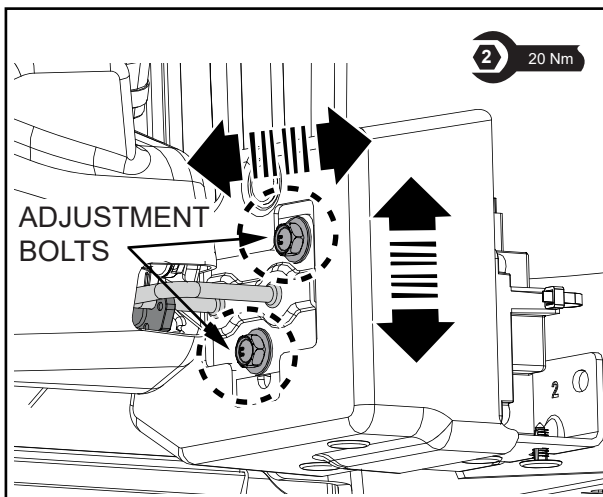

STEP B

STRIKER ADJUSTMENT GUIDE

- If the striker is not engaging the latch, the depth or height of the Striker will need to be adjusted.
- To adjust, slightly loosen the adjustment bolts, and move the striker incrementally horizontally or vertically.
- Appropriately tighten the bolts and test the mechanism after each incremental change.
- The Striker should be centrally aligned with the Latch Cam. The Latch Cam should not catch or scrape the Striker on engagement or release. If catchment is occurring, re-adjust the Striker.
- Once desired result is achieved, torque the striker adjustment bolts to 20Nm.

IMPORTANT: The striker movement will affect the glass clearance to the tailgate. Please follow the guide in **STEP C**.

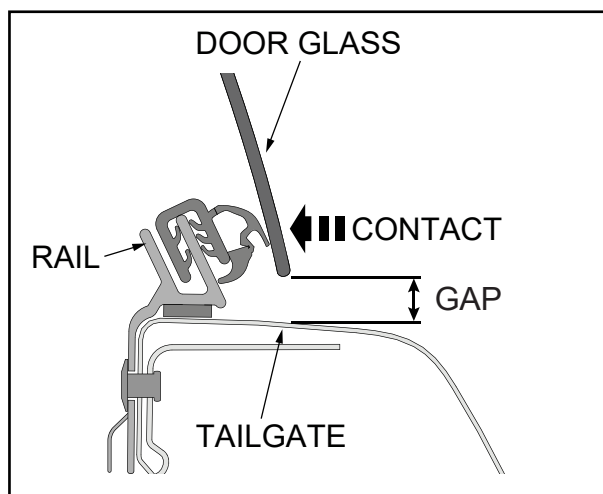

STEP C

DOOR GLASS CLEARANCE CHECK

- Carefully close the window, ensuring the glass does not contact the tailgate. Ensure there is a **minimum 10mm gap** between the glass and the top of the tailgate on both sides.
- If less than 10mm or very uneven gapping, adjust accordingly as described in **STEP B**.

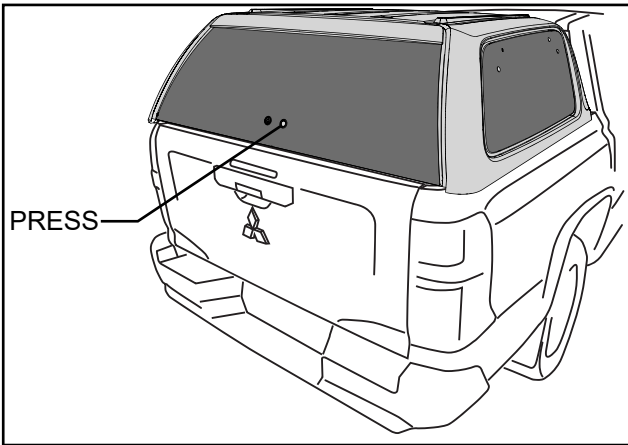
SECTION E**OPENING PROCEDURE****STEP A****REAR DOOR BUTTON OPENING**

- Check the function of the canopy central locking.
- Rear door will automatically open all the way after pressing the button on the glass.

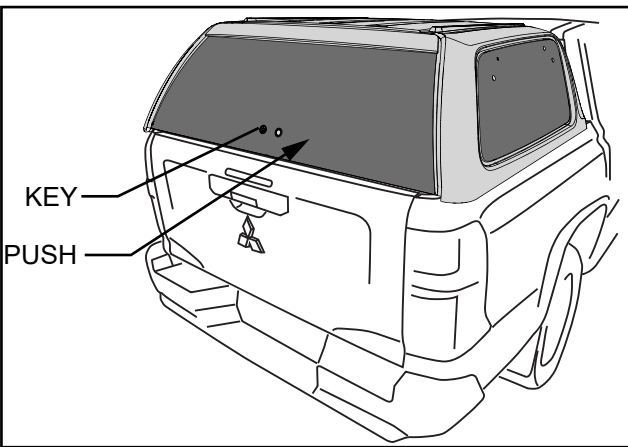
**STEP B****REAR DOOR MANUAL OPENING**

- When using the supplied key to open the rear door, please push slightly on the glass with one hand when turning the key. It will relieve the tension from the latches and allow easy opening.