

**Toyota HiLux 2015
Dust Defence Kit, A-Deck/338R/P
With and Without Ute Liner
Installation Instructions**

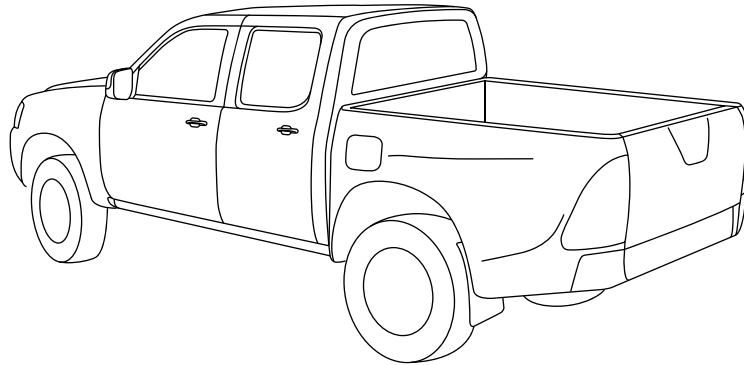

Kit Number: 037834

Installation Time:
Approx. 30min Without Ute Liner Fitted
Approx. 1 hour With Ute Liner Fitted

Place these instructions in vehicle's glove box after installation is complete

PLEASE REFER TO PAGE 2 OF THIS INSTRUCTION FOR A LIST OF PARTS AND QUANTITIES.

IMPORTANT!

- Read instructions carefully before installation.
- It is strongly recommended that installation is conducted by an authorized dealer.
- This product must be installed exactly as specified in these instructions. Failure to do so may result in improper fit and/or retention.

RECOMMENDED TOOL LIST - (Not Supplied in Kit)

- Drill and Ø5.5mm & Ø3.5mm Drill Bit
- Sharp Scissors or Sharp Knife
- 8mm Spanner & Socket
- Masking Tape
- Rivet Gun
- Marking Pen
- Centre Punch
- Rubber Mallet
- Torque Wrench

TOYOTA A-DECK HILUX DUST DEFENCE KIT

PARTS CHECK SHEET

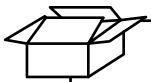

PARTS IN MAIN CARTON

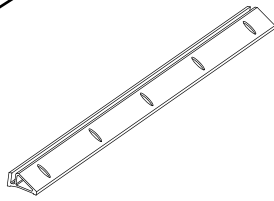

Base Extrusion
Qty - 1

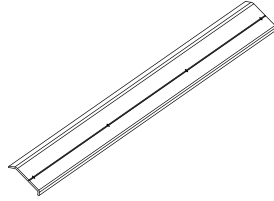

Cover Base Extrusion
Qty - 1

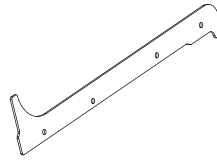

Tub Side Plate
Qty - 2

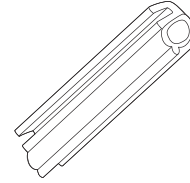

Pinch-weld Bulb Seal
Qty - 1



Fitting Kit
Qty - 1



PARTS IN FITTING KIT



Retention Clip Short
Qty - 2

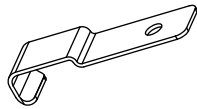

Retention Clip Long
Qty - 2



Self-tapping Screw
Qty - 4



M5 Small Washer
Qty - 16

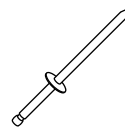

Rivet (large)
Qty - 5

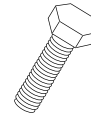

M5x30 Hex Head Screw
Qty - 8



M5 Nylock Nut
Qty - 8

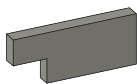

Foam Pad RH
Qty - 1

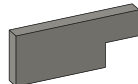

Foam Pad LH
Qty - 1

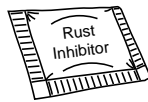

Rust Inhibitor
Qty - 1



Alcohol Wipe
Qty - 1



Primer
Qty - 1

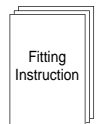

Fitting Instruction
Qty - 1

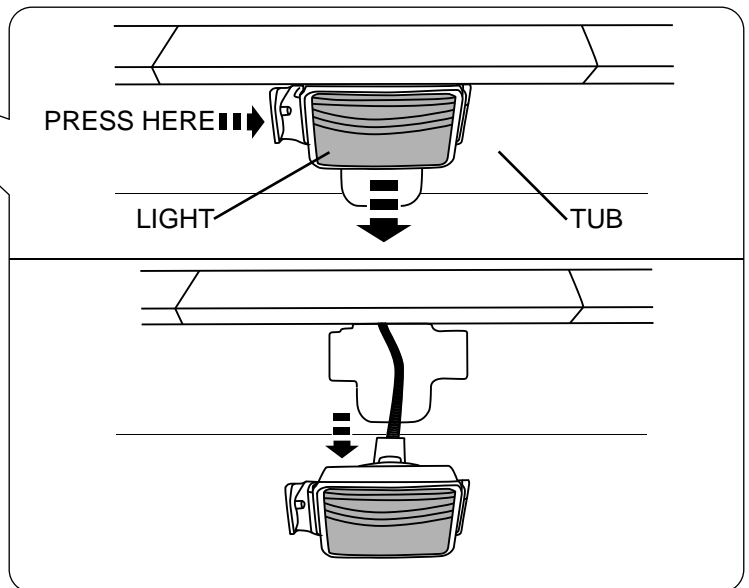
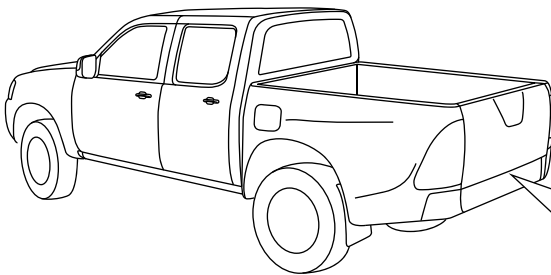
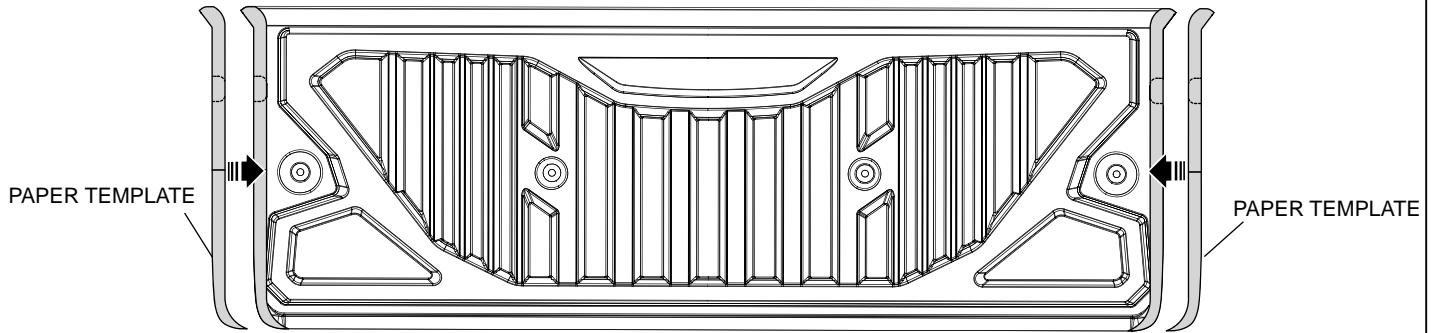

FIG. 1 Unclip licence plate light from the vehicle by pushing on the side tab.

TOYOTA A-DECK HILUX DUST DEFENCE KIT

FOR VEHICLES WITHOUT UTE LINER PLEASE GO TO STEP 5



Remove the ute liner from the tailgate. Cut the two part template from the page 8. Glue it together where the arrows indicate. Place the template on the RHS of the ute liner aligning to the edge and mark using white pen.

FIG. 2 Remove template and trim ute liner using jigsaw. Repeat on the LHS of the ute liner.

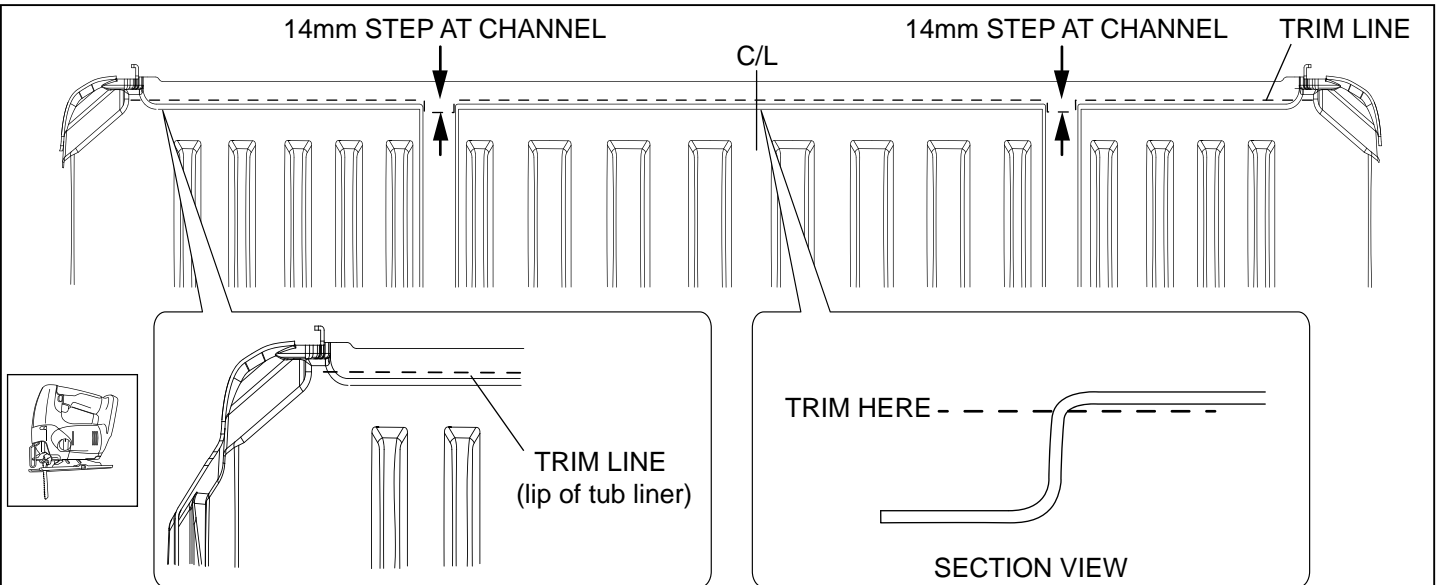
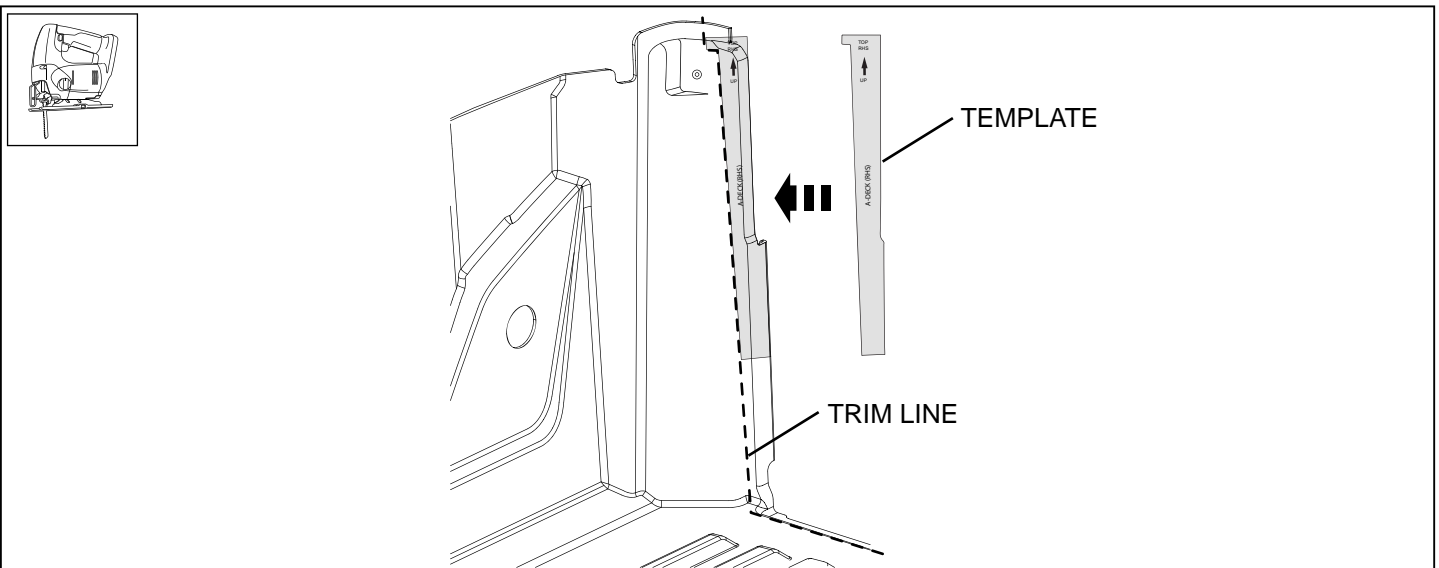

FIG. 3 Remove the ute liner from the tub and retain all the hardware. Trim along the top lip of the ute liner floor.



Cut out the paper template from page 9 and place inside the ute liner rear RHS as shown. Mark the dotted line with white pen and extend the line to the floor until it intersects with the trim line in the previous step. Trim the ute liner with a jigsaw. Repeat on the LHS.

FIG. 4

TOYOTA A-DECK HILUX DUST DEFENCE KIT

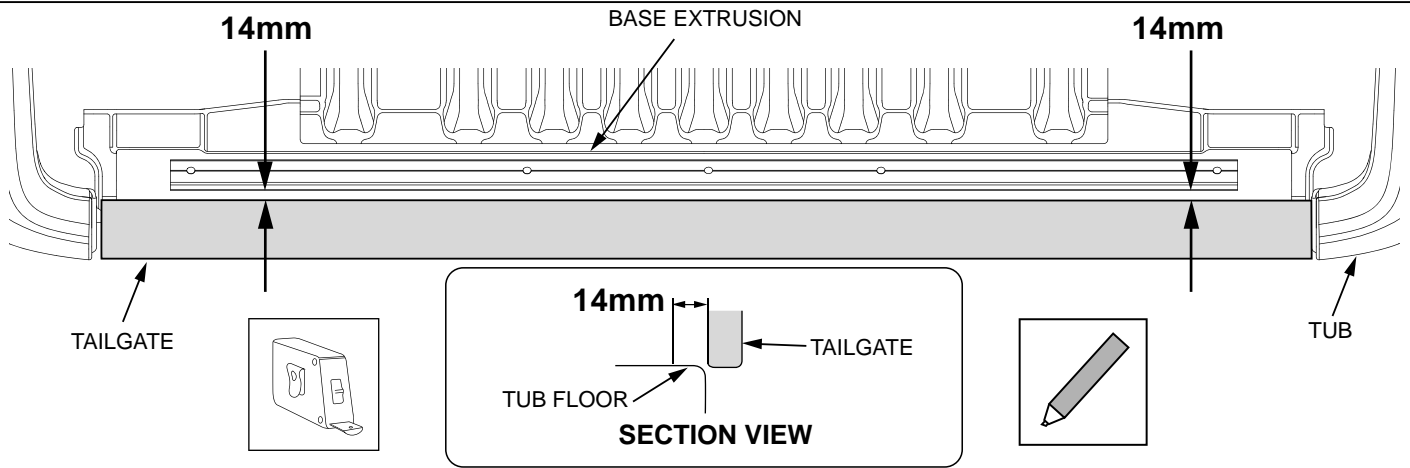

With the tailgate closed, measure and mark 14mm from the inside edge of the tailgate at 2 or 3 points. Carefully align the base extrusion with the 14mm marks and **centre it between the side plates**. Before drilling carefully close the tailgate and double check that the base extrusion is parallel with the tailgate i.e. there is an even gap between the base extrusion and the tailgate. If in doubt, carefully fit the pinchweld seal (see step 10) temporarily and check the operation of the tailgate is not hindered by the seal.

FIG. 5

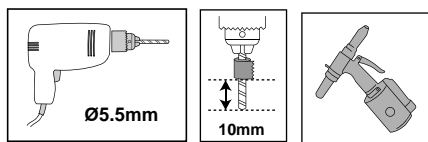

IMPORTANT: Set the drill to 10mm depth to avoid damaging the licence plate light or harness.

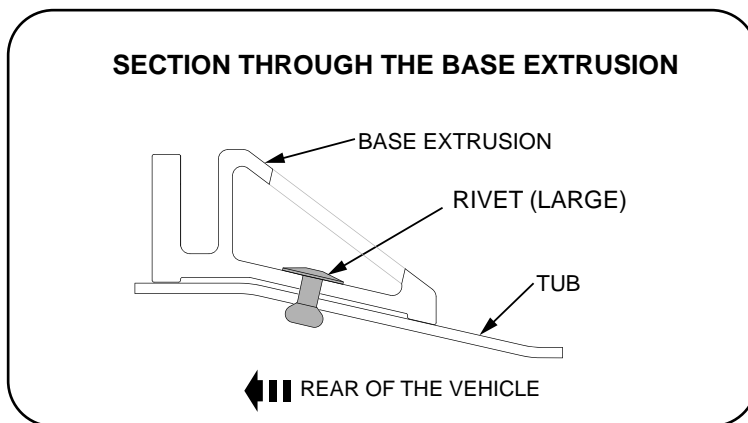
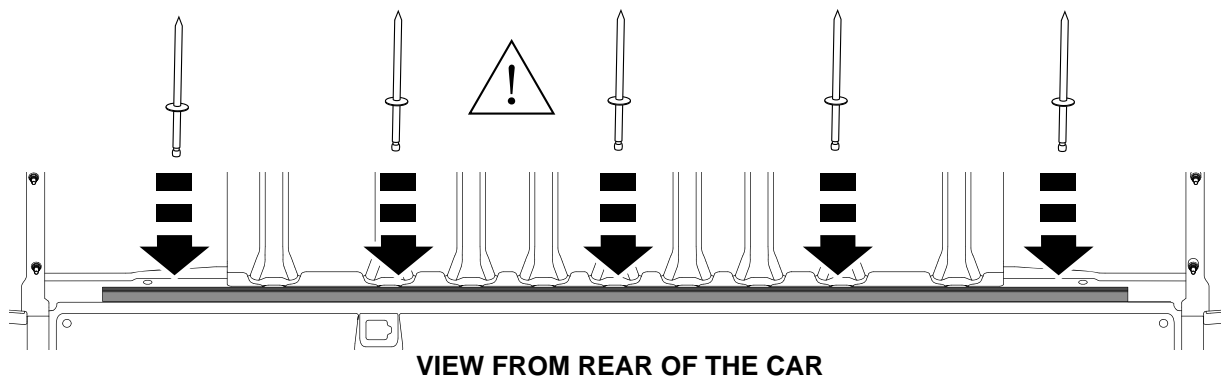

Using the pre-drilled holes in the base extrusion as a guide, centrepunch and drill 5 holes through the centres of the slots in the base extrusion and tub with 5.5mm drill set to 10mm depth. Apply rust inhibitor. Secure the extrusion to the tub using 5 large rivets.

FIG. 6

TOYOTA A-DECK HILUX DUST DEFENCE KIT

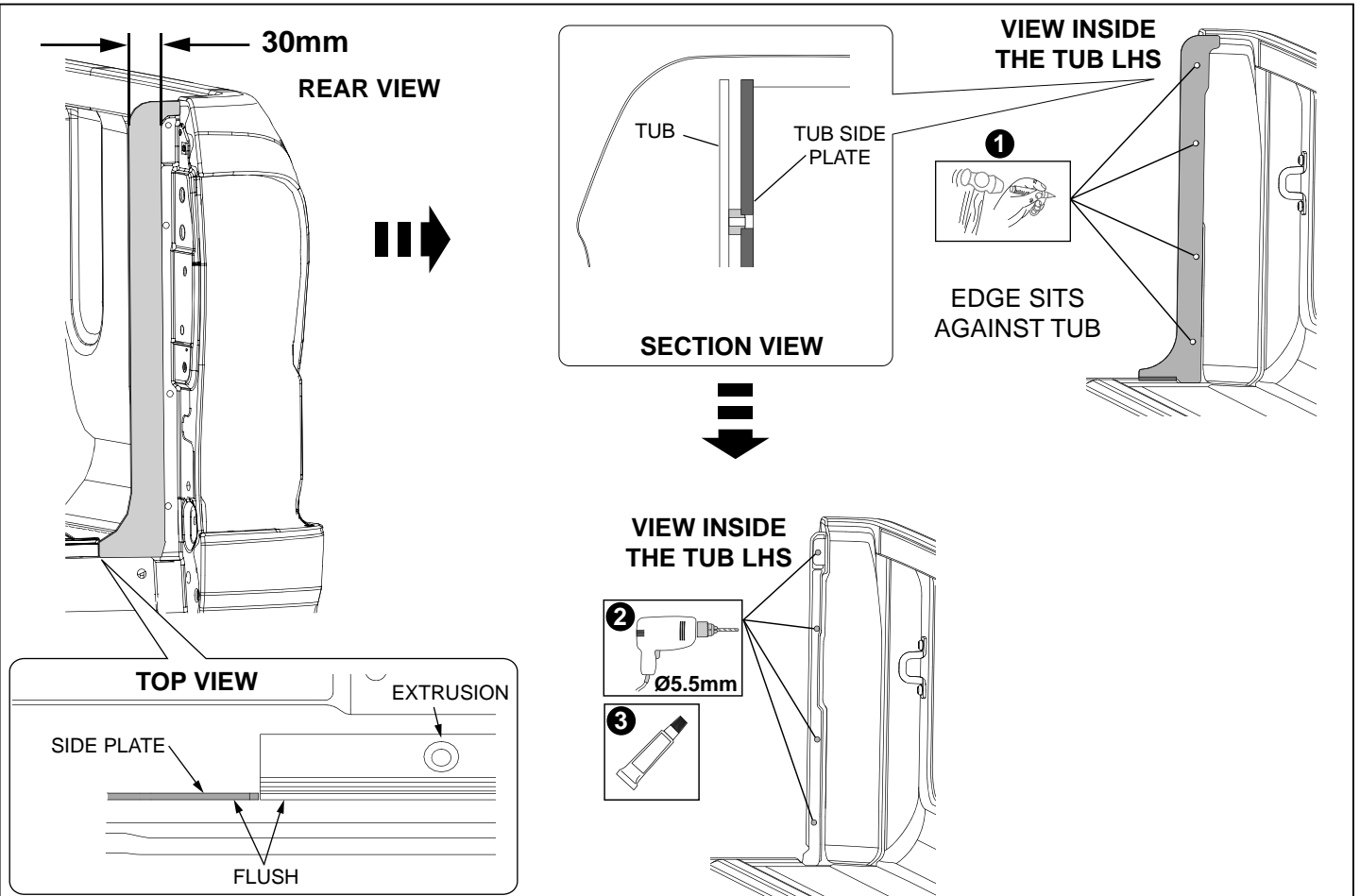

Trial fit tub side plates to the inside of the tub with the spacers as shown. The side plate should be 30mm inboard of the tub flange as shown. Mark and centre punch the centre points of four (4) hole positions on each side. Remove the plates and drill $\varnothing 5.5\text{mm}$ holes for each of the eight (8) centre marked locations. Apply rust inhibitor to all drilled holes.

FIG. 7

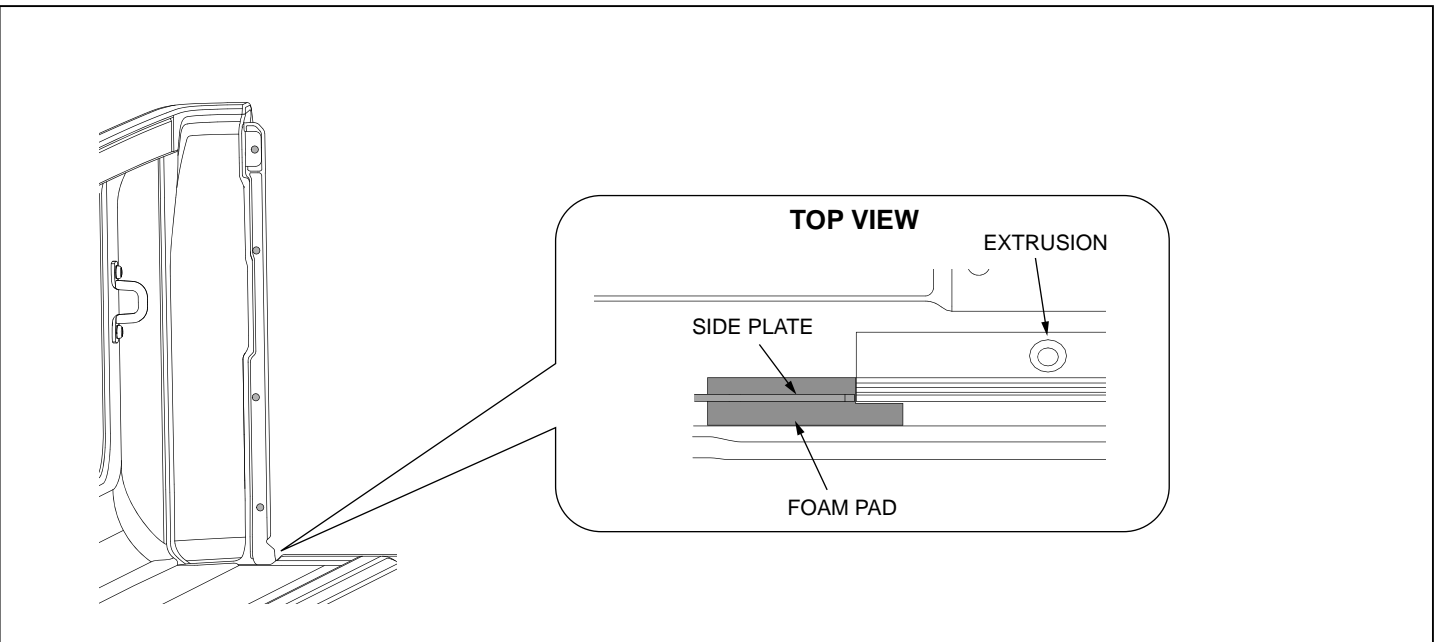

Clean the surface where the foam pad will go using the alcohol wipe, then apply primer. The foam pad should be applied flush between the extrusion and the tub flange. **Note: The side plates sit on top of the foam pads.**

FIG. 8

TOYOTA A-DECK HILUX DUST DEFENCE KIT

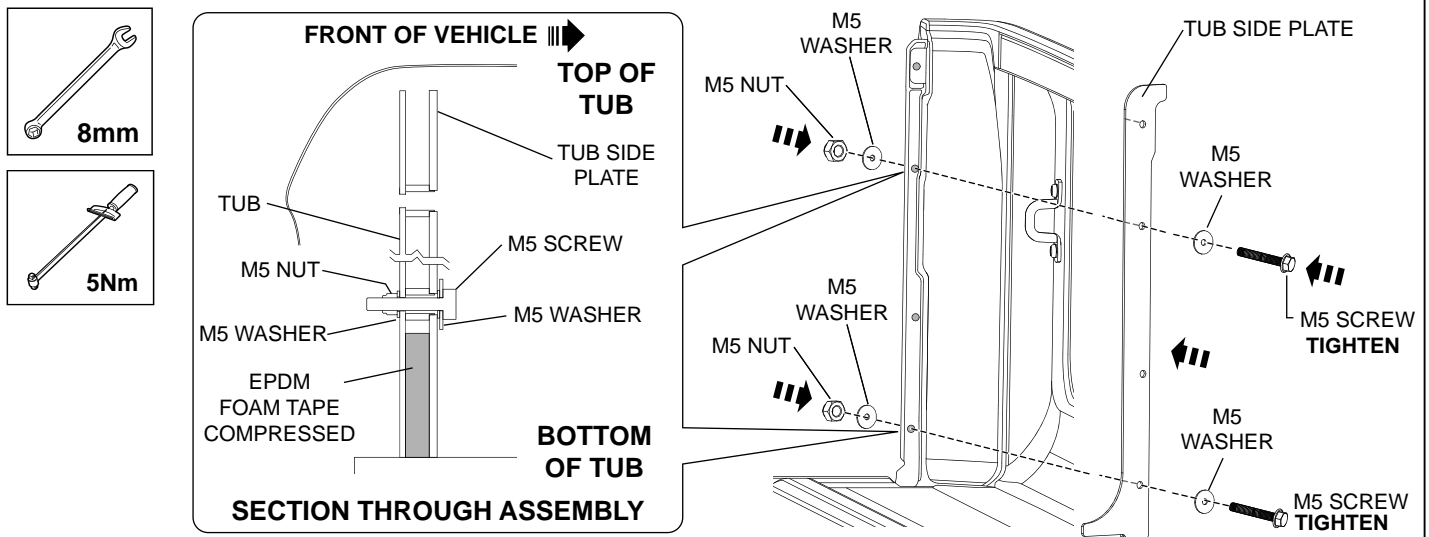

Fit tub side plate to the vehicle tub & align the holes. Secure with M5 screws, M5 washers and nuts. Tighten the screws as shown. **Torque to 5Nm.**

FIG. 9 Note: 20x20 EPDM foam tape faces rearward. LHS shown, repeat for RHS.

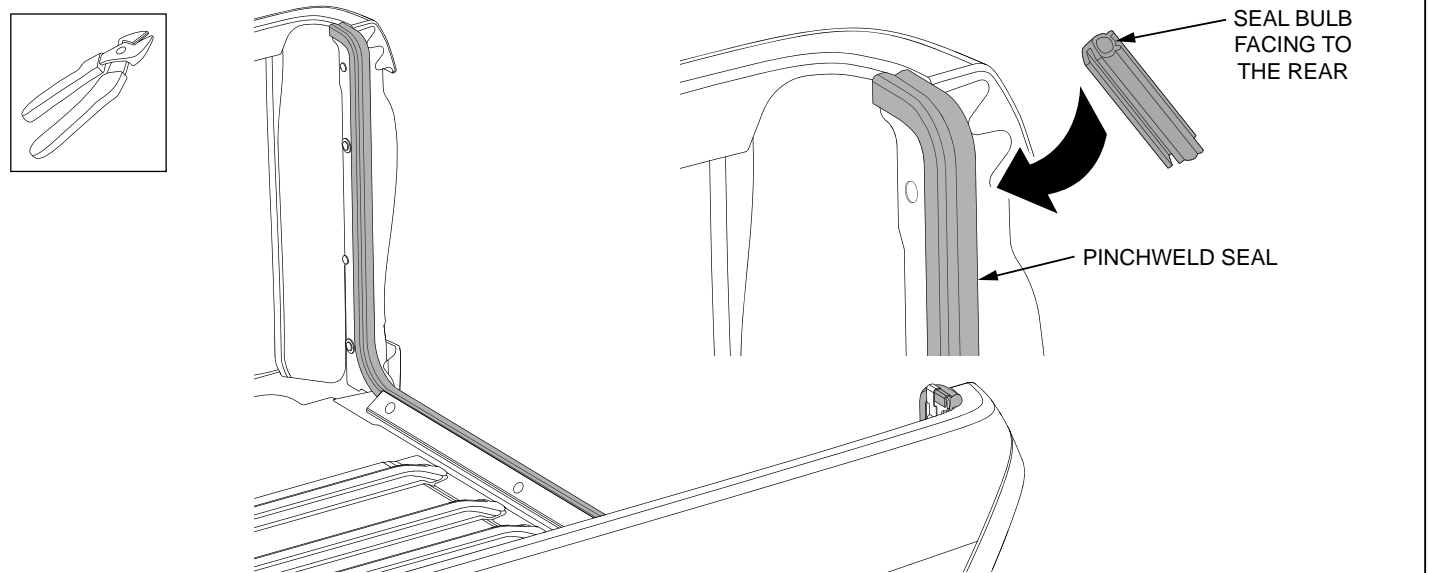

Install the pinchweld seal starting from the top of the RHS side plate. Use a rubber mallet to tap the pinchweld onto the side plates and base extrusion. Trim any excess pinchweld seal.

FIG. 10 Note: When installing the seal, position the retention clips over the over the seal.

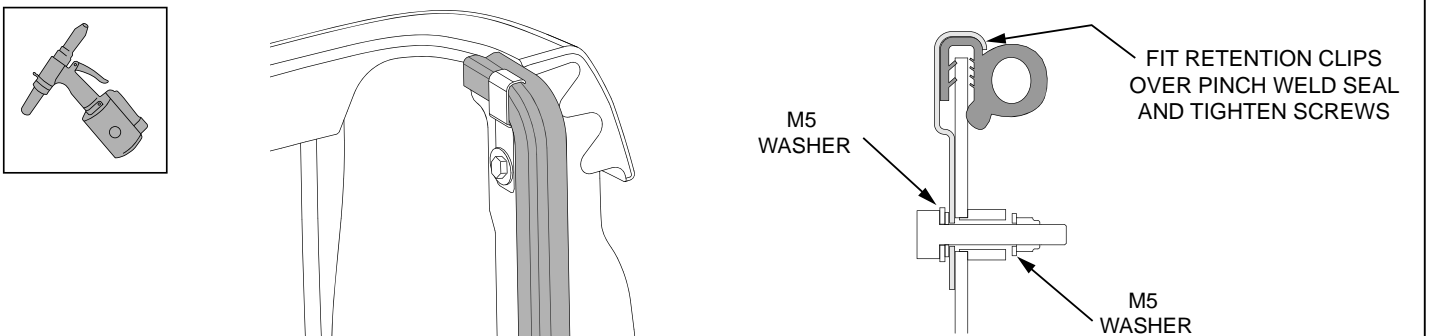

Position the top retention clip over the pinchweld and screw into place with a flat washers as shown RHS. Repeat for LHS. **NOTE:** If the dust defence kit is fitted with a Rolltrac, check gap between Rolltrac hand rail and the top of the retention clip - should be at least 1mm. If less than 1mm, fit the M5 screw, washer and M5 nut without the retention clip.

FIG. 11

TOYOTA A-DECK HILUX DUST DEFENCE KIT

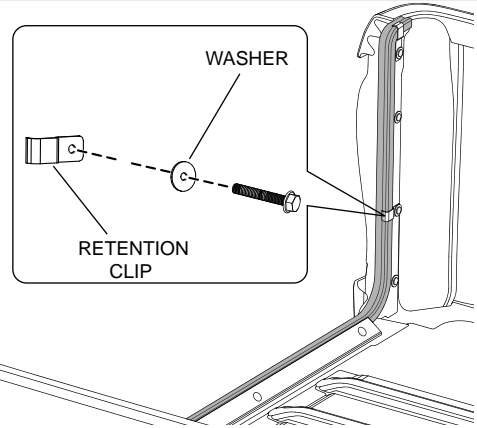
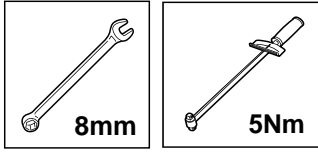

Position the centre retention clips over the pinchweld and fasten in place using M5 screw, washers and M5 Nylock nut. **Tighten to 5Nm.** LHS shown, repeat for RHS.

FIG. 12

Silicone the gaps inside the tub between the side plate and the vehicle, both sides as shown.

TUB TOP VIEW

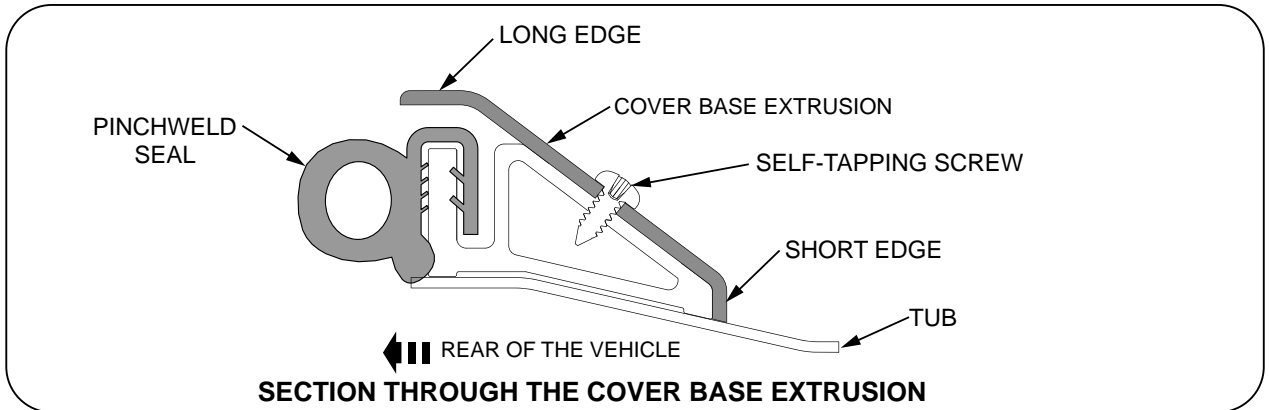
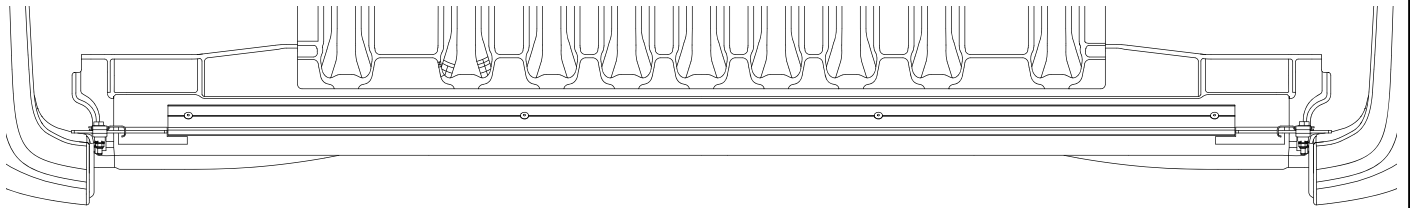

With the longer edge to the top, fit the base extrusion cover over the pinchweld seal and align the cover with the pre-drilled holes in the base extrusion. Fit the cover into place using the four self-tapping screws.

FIG. 13

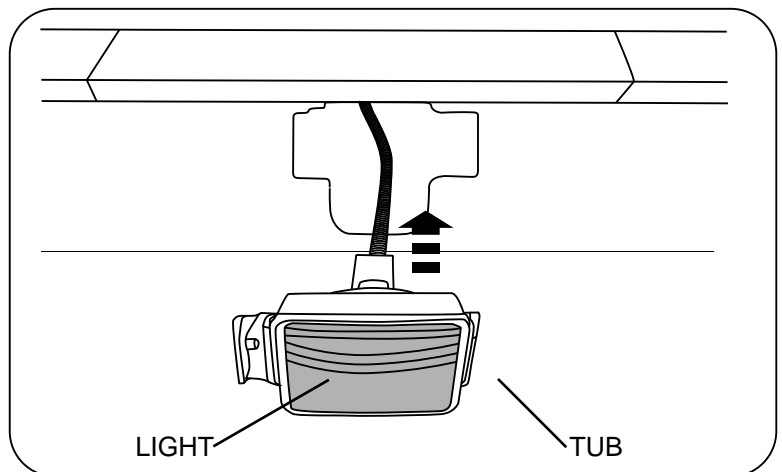
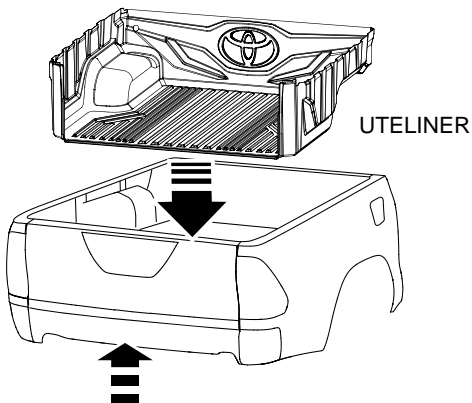

FIG. 14

Refit ute liner (if applicable). Refit licence plate light back to the vehicle.

THIS PAGE LEFT BLANK INTENTIONALLY

TOYOTA A-DECK HILUX DUST DEFENCE KIT

UTE LINER TAILGATE TRIM / PAPER TEMPLATE

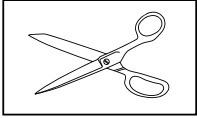

CUT OUT BOTH TEMPLATES
AND JOIN.

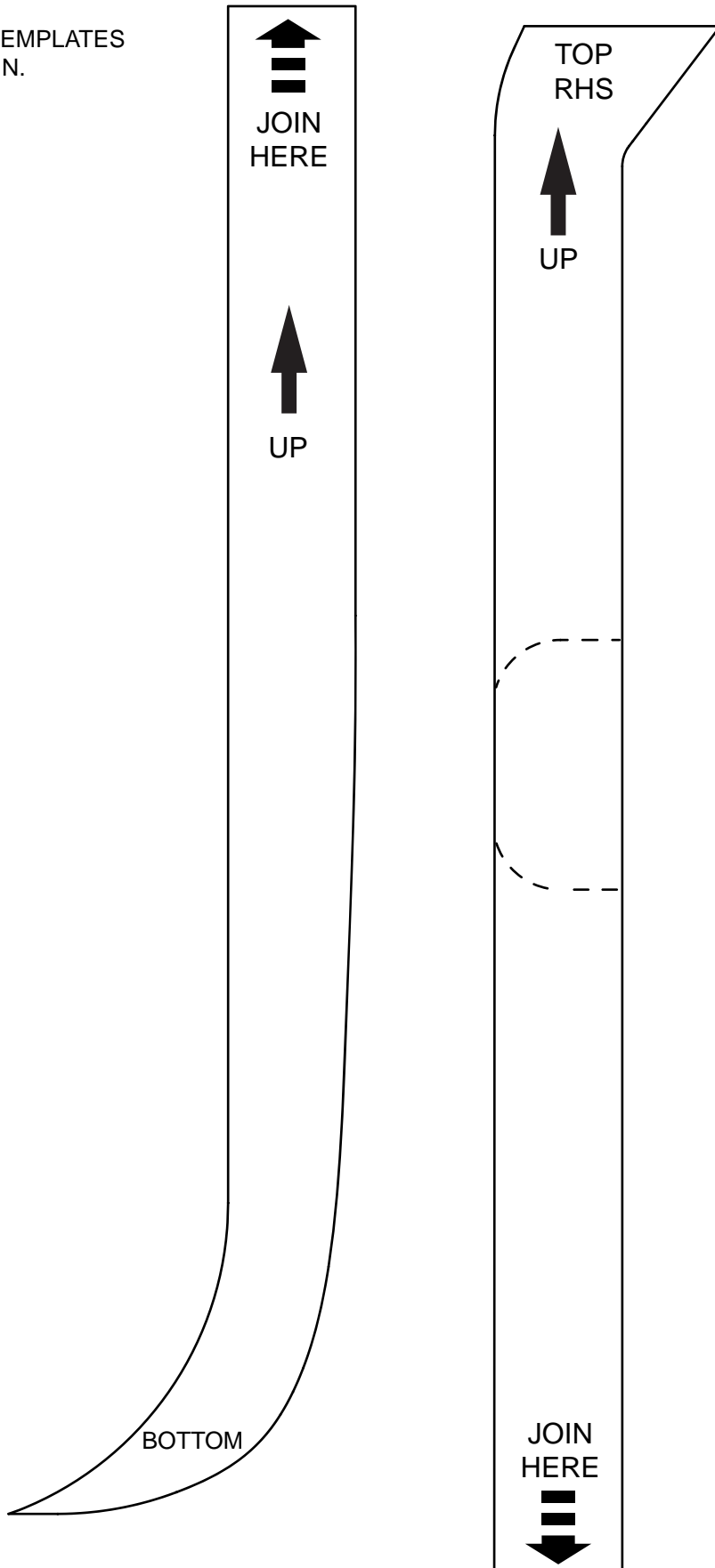

THIS PAGE LEFT BLANK INTENTIONALLY

TOYOTA A-DECK HILUX DUST DEFENCE KIT

UTE LINER TRIM / PAPER TEMPLATE

