

# MAZDA BT-50

(October 2011 Production Onwards)

## FRONT FENDER FLARES INSTALLATION INSTRUCTIONS

Installation Time: Approx. 45 Minutes

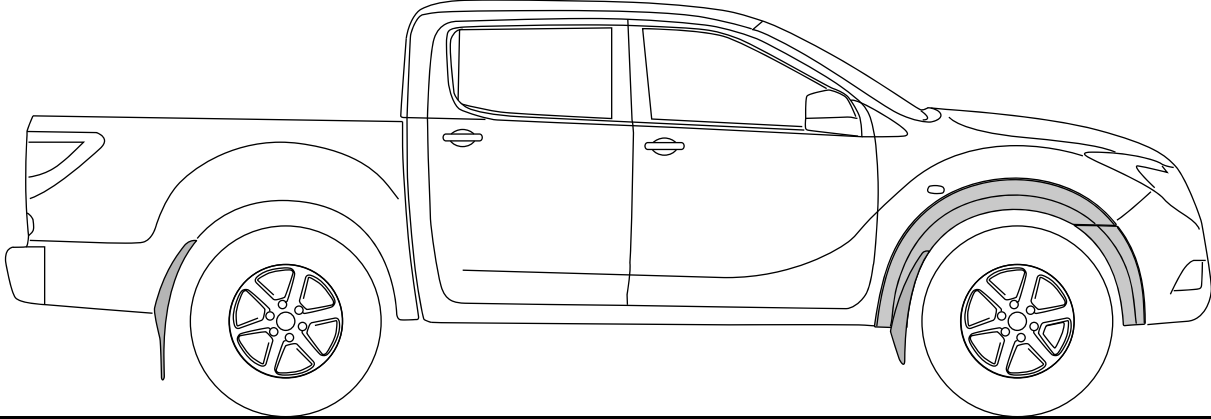

**NOTES:**

- Ensure that both left and right hand Fender Flares suit the profile of the vehicle. Note the areas where the Fender Flares come in contact with the vehicle.
- Before fitting Fender Flares remove any mouldings, strips or existing flares from the wheel arch. If there is a body side moulding, mark where the moulding is to be cut, alternatively the Fender Flares can be cut to go around the moulding. Be sure to allow enough room for the extrusion.

**PAINTING INSTRUCTIONS:**

- ⚠ **Warning: Do not fit trim edge extrusion or any of the hardware until paint is completely dry.**
- Spot Sand Fender Flares where required prior to painting, recommend 500 grit using an orbital type sander.
- Prior to painting, clean all surfaces to be painted using clean water and a mild detergent, do not use lacquer thinner or any solvent based products. Wipe completely dry.
- Best results will be achieved by wiping the areas to be painted with a tack rag just prior to painting.
- Select a top coat and clear paint that is suitable for ABS (Acrylonitrile-Butadiene-Styrene).
- Automotive paint systems, such as Acrylics or Two Packs, can be applied directly to the components. However, some paints may require a primer. If recommendations on paint specifications are not followed, cracking of the part or degradation to the material may result. In all paint systems, aromatic hydrocarbons and alkalis are best avoided to reduce damage to the material properties.
- If using a paint system which requires baking, do not expose the product to temperatures above 70° C (155° F).
- Allow a minimum of 8 hours after baking before installation on the vehicle.

### COMPONENTS LIST

	NO.	COMPONENT	QTY
1.	1	Front Fender Flares (RHS & LHS)	2
	2	Front Bumper Flares (RHS & LHS)	2
	3	Extrusion	4.1m
	4	Scrivet	26
	5	Wide Metal Clip	4
	6	Alcohol Wipe	2
	7	Installation Instructions	1
	8	Clear Tape	2

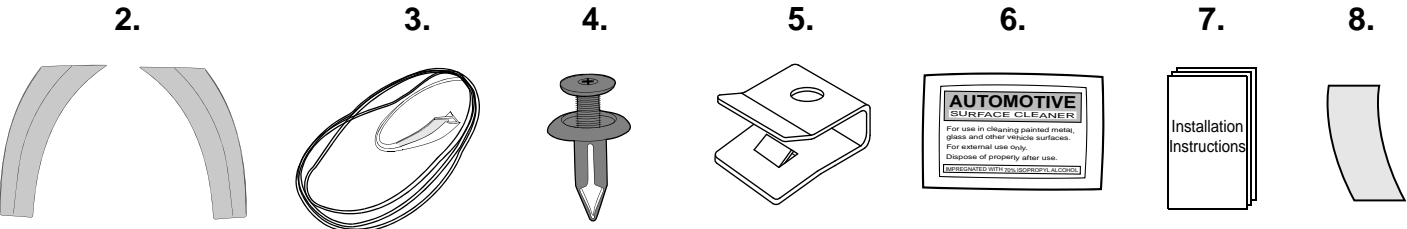

## MAZDA BT-50 - FRONT FENDER FLARE

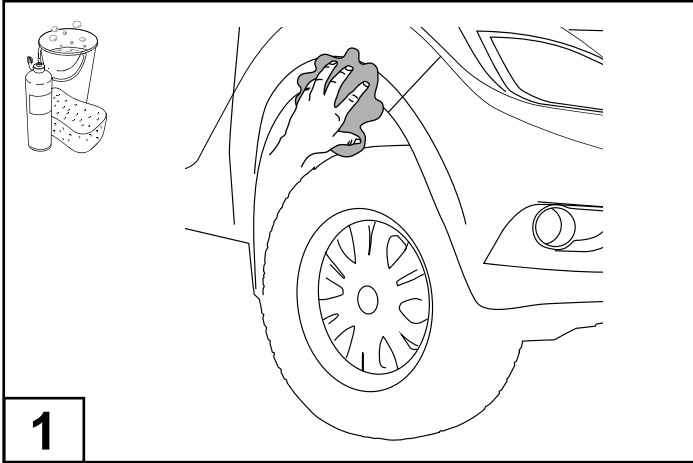

Wash the areas of contact on the vehicle and wipe dry both the vehicle and the Fender Flares with a clean cloth. Ensure inside of Fender Flares where extrusion is attached is clean.

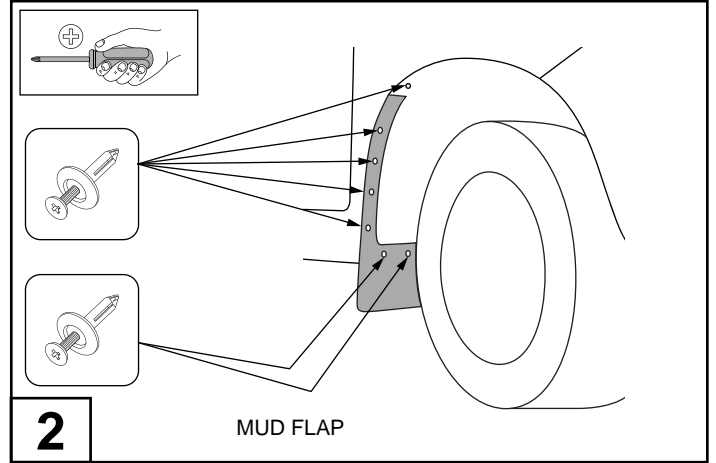

Remove the mud flaps by removing and retaining the 7 scrivenets from inside the wheel arch as shown. NOTE: Replacement scrivenets are supplied, if any scrivenets are damaged upon removing from the vehicle.

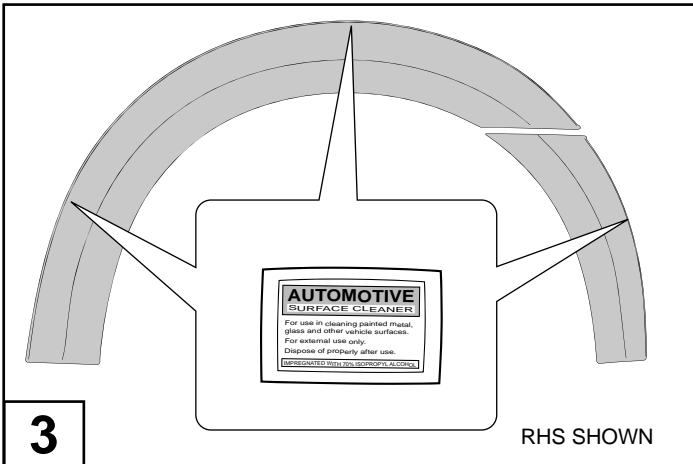

Clean the inside edge of each fender flare where the rubber extrusion will adhere.

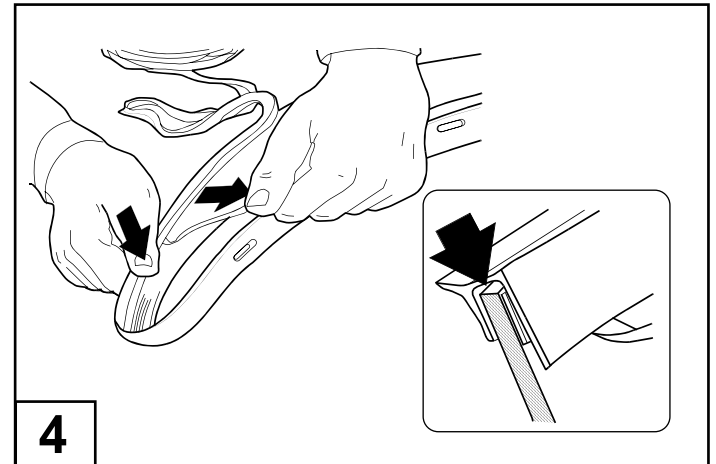

Remove approximately 50mm of the protective liner from the extrusion. Fit the extrusion to the Fender Flares along the edge that comes in contact with the vehicle's body panel.

Trim any unnecessary extrusion and discard.

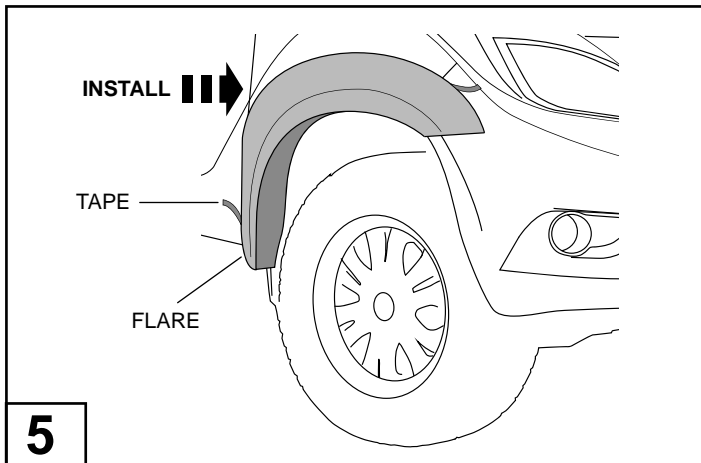

Peel back red tape liner, about 50mm from each corner of the adhesive tape on the back of the fender flare. Fit the flare to the vehicle as shown.

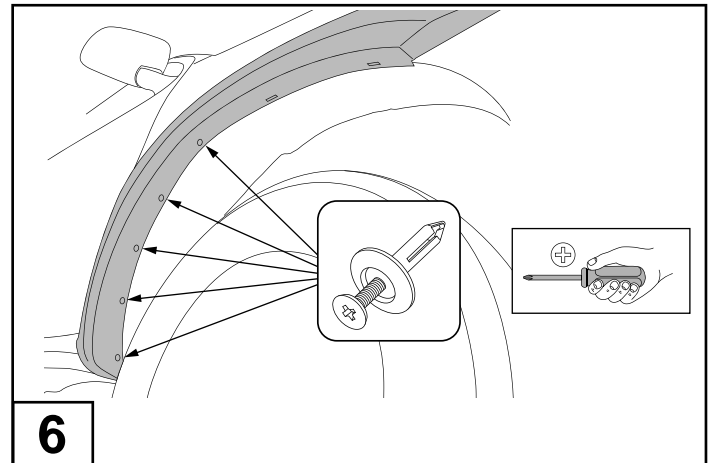

Install 5 wheel arch scrivenets onto the flare as shown. While pressing and holding the flare in position of best fit.

## MAZDA BT-50 - FRONT FENDER FLARE

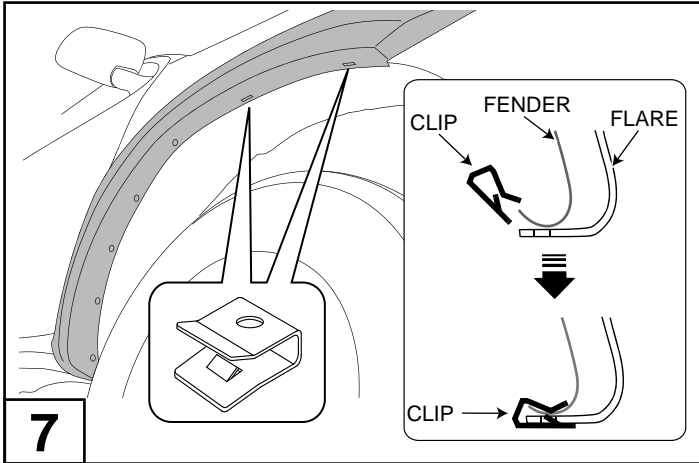

**7**

Install 2 wide clips at an angle, by pushing it on to the fender lip and then rotate downwards, as shown.

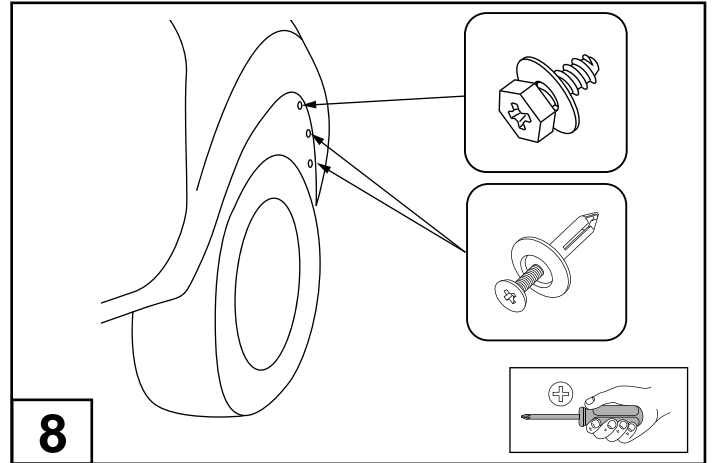

**8**

Remove 2 scrivenets and 1 screw from the wheel arch on the front bumper.

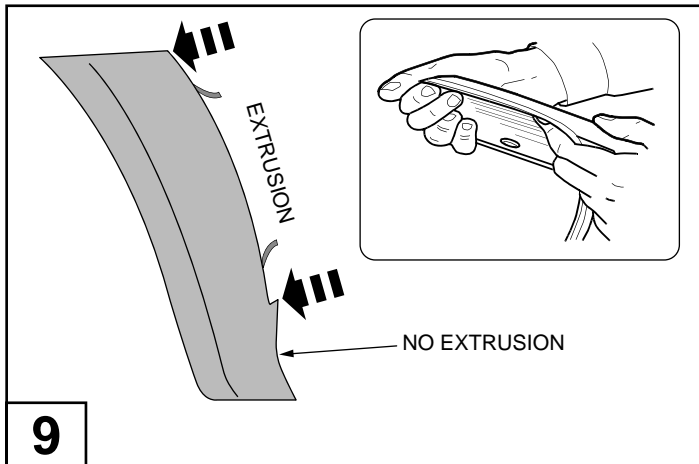

**9**

Peel back red tape liner, about 50mm from each corner of the adhesive tape on the back of the fender flare. Fit the extrusion to the Fender Flares along the edge that comes in contact with the bumper bar as shown between the large arrows.

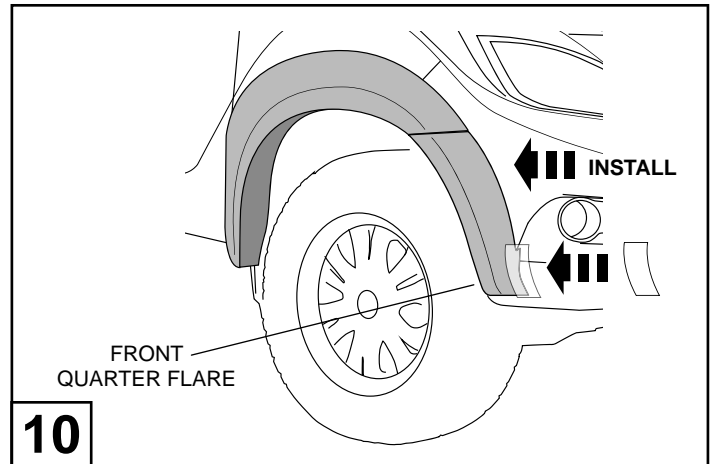

**10**

Fit the front quarter flare to the vehicle as shown and mark the indicated area where flare will contact front bumper. Remove the flare and apply clear tape to this area.

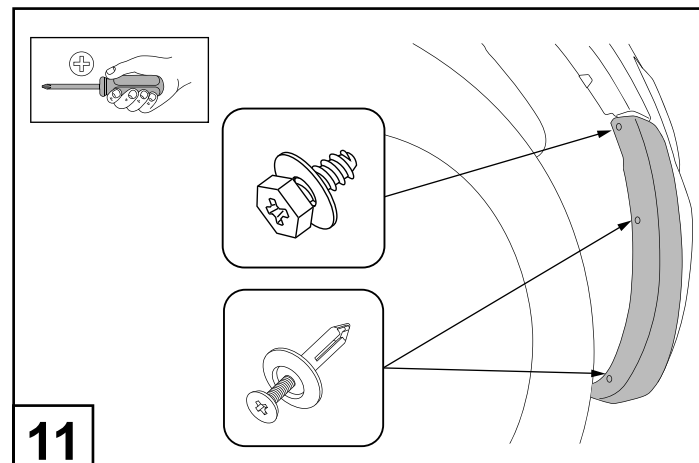

**11**

Secure the fender flare to the wheel arch with 2 scrivenets and 1 screw as shown.

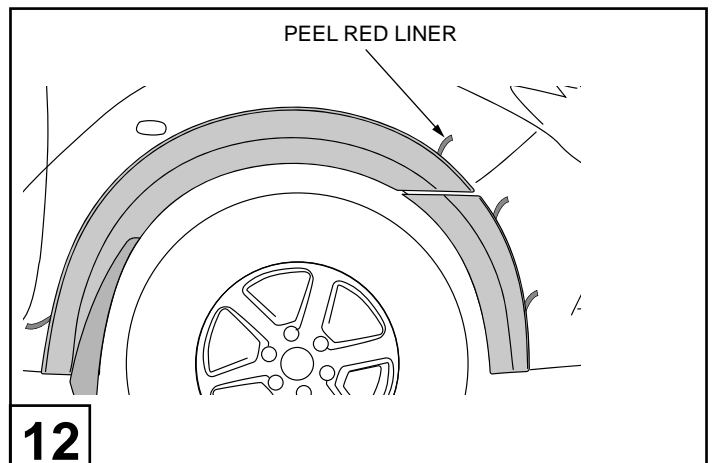

**12**

Ensure that flares are aligned. Remove the tape liner and apply firm pressure to ensure the tape is contacting the car body.

# MAZDA BT-50 - FRONT FENDER FLARE

RHS MUD FLAP SHOWN

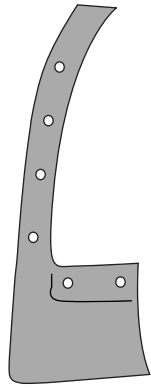

MUD FLAP

REMOVE THE SHADED SECTION

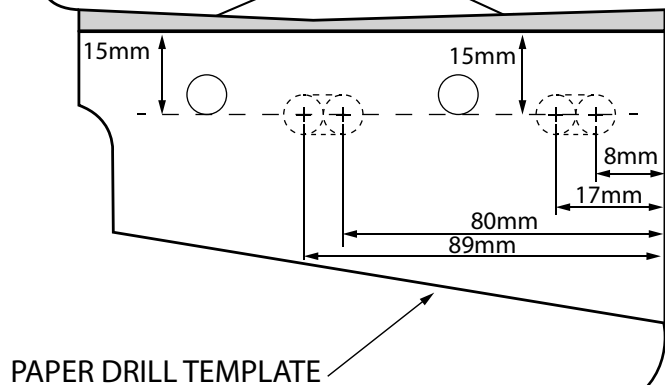

**13**

Print 1:1 scale paper drill template on the last page. Cut it out and stick to the back of the front mud flap using the 2 existing hole to position the template. Trim the top edge of the mud flap as shown, using tin snips. Mark the 4 slot centres as shown from the inside edge and drill with 8mm drill. Join two holes to create slot using die grinder or drill. Repeat the same on the lhs mud flap.

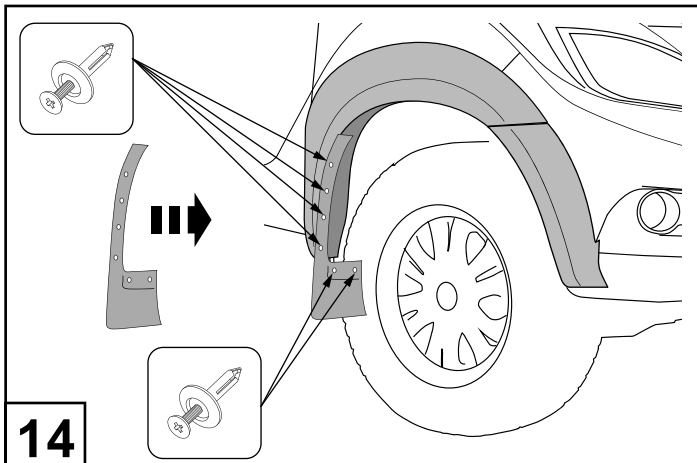

**14**

Secure the mud flap to the fender flare with 6 screws as shown.

PAPER DRILL TEMPLATE FOR THE FRONT MUD FLAPS

