

MITSUBISHI TRITON MN onwards

1 & 3 PIECE TONNEAU REMOTE LOCKING KIT

INSTALLATION INSTRUCTIONS

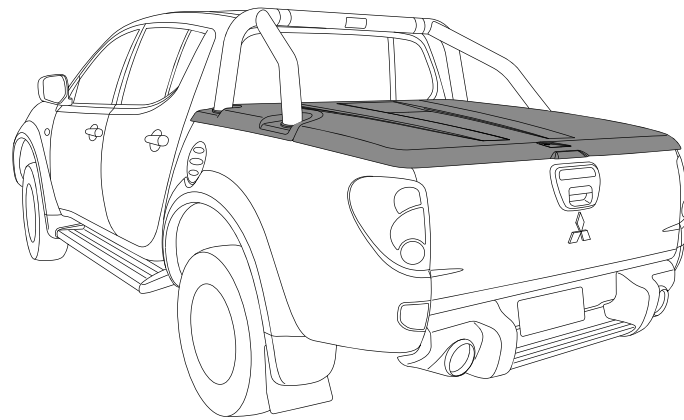
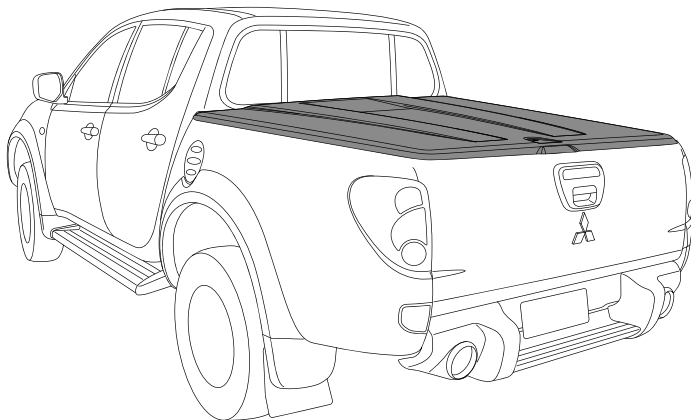

PLEASE KEEP INSTRUCTIONS IN GLOVE BOX FOR FURTHER USE

PLEASE REFER TO PAGE 2, OF THIS INSTRUCTION FOR A LIST OF PARTS AND QUANTITIES.

IMPORTANT:

- Read Instructions carefully before installation.
- It is strongly recommended that installation is conducted by an authorised dealer.
- This product must be installed exactly as specified in these instructions.
Failure to do so may result in improper fit and/or retention..
- Recommend installation by 2 people.
- Do not cycle remote key fob continuously or the actuator for operation of the remote locking system will burn out.

Maintenance:

- The locking mechanisms & Latches only require occasional lubrication with Graphite Powder.
- DO NOT use any other lubricants or oils. Using alternative products will VOID Warranty.
- All installation hardware and fasteners must be checked regularly for tightness.

RECOMMENDED TOOLS LIST

NO.	TOOL NAME
1	Rivet Gun
2	Drill
3	Ø5mm & Ø12mm Drill Bits
4	Spanners

NO.	TOOL NAME
5	Hammer & Centre Punch
6	Caulking Gun & Silicon
7	Tape Measure
8	Sharp Knife

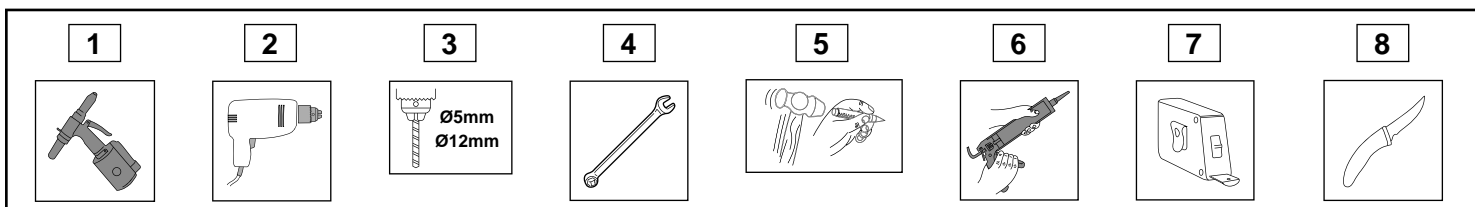

MITSUBISHI TRITON 1 & 3 PIECE REMOTE LOCKING KIT

PARTS CHECK SHEET

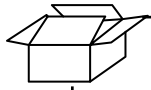

PARTS IN MAIN CARTON - (KIT031823)

5



Double Sided
Foam Tape Gasket
(TAPE614)
Qty - 1

9

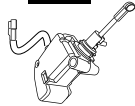

Actuator
(LOCK0004-1)
Qty - 1

10

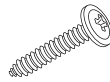

Long Self
Tapping Screw
(SCRW0735)
Qty - 2

11

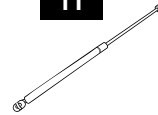

Gas Strut
with Switch
(STRT0001-2)
Qty - 1

12



Phillips Head
Screw
(SCRW0648-2)
Qty - 1

13

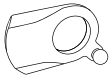

Lock Cam with
Ball Stud
(CLIP2419-3)
Qty - 1

14



Spacer
(FAST0466)
Qty - 1

15

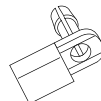

Pull Rod Clip
(MISC2474)
Qty - 1

16

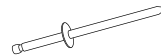

Pop Rivet
(FAST0505)
Qty - 1

18

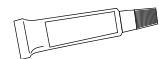

Rust Inhibitor
(MISC2776)
Qty - 1

19



Alcohol Wipe
(MISC0052)
Qty - 1



Fitting
Instruction
(TC0376)
Qty - 1



Vehicle
Wiring Kit
(LOOM0011)
Qty - 1



Tonneau
Wiring Kit
(LOOM0002B)
Qty - 1



PARTS IN VEHICLE WIRING KIT - (LOOM0011)

1



Vehicle Wiring
Harness
Qty - 1

3

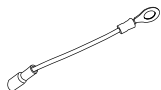

Gas Strut
Earth Wire
Qty - 1

6

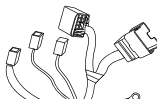

T-Connector
Loom
Qty - 1

7



Male Terminal
Housing
Qty - 1

17

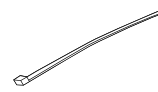

Cable Tie
Qty - 12

20



Adhesive
Pad
Qty - 3



PARTS IN TONNEAU WIRING KIT - (LOOM0002B)

2



Tonneau Wiring
Harness
Qty - 1

4



Interior Light
Qty - 1

8

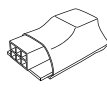

Module
Qty - 1

MITSUBISHI TRITON 1 & 3 PIECE REMOTE LOCKING KIT

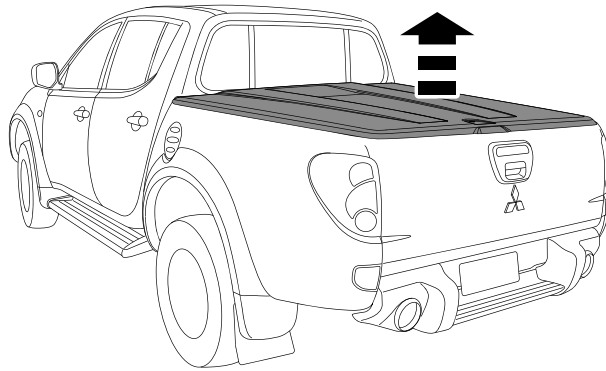
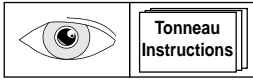
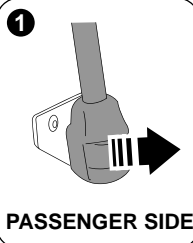
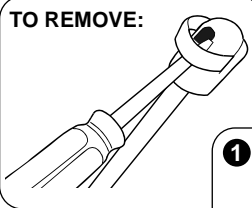

FIG. 1

REFER TO THE TONNEAU INSTALLATION INSTRUCTIONS, TO REMOVE THE TONNEAU COVER.
LAY THE TONNEAU COVER UPSIDE DOWN ON A SHEET OR MAT TO PREVENT SCRATCHING.

TO REMOVE:



2 PASSENGER SIDE ONLY

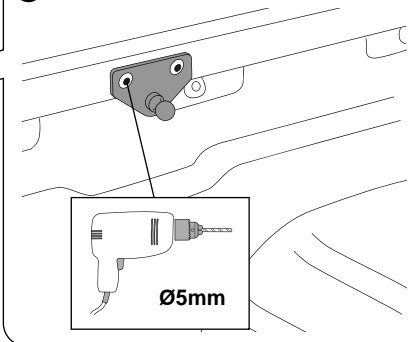
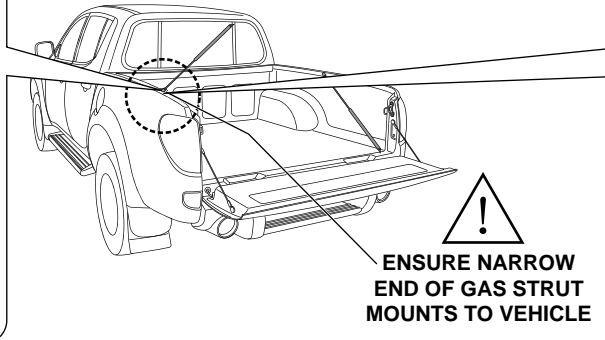
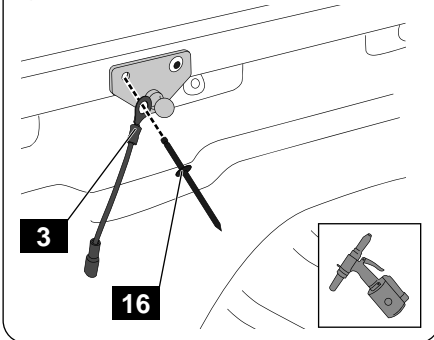

FIG. 2

REMOVE AND DISCARD GAS STRUT FROM THE PASSENGER SIDE OF THE VEHICLE.
USING A Ø5mm DRILL BIT, DRILL OUT THE REAR RIVET ON THE GAS STRUT BRACKET AS SHOWN (PASSENGER SIDE ONLY).

1 PASSENGER SIDE ONLY



2 PASSENGER'S SIDE ONLY

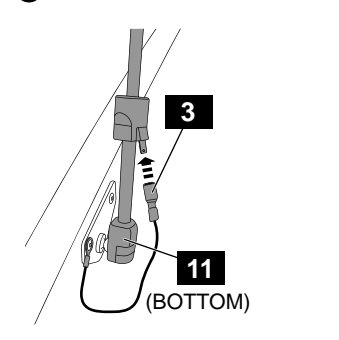
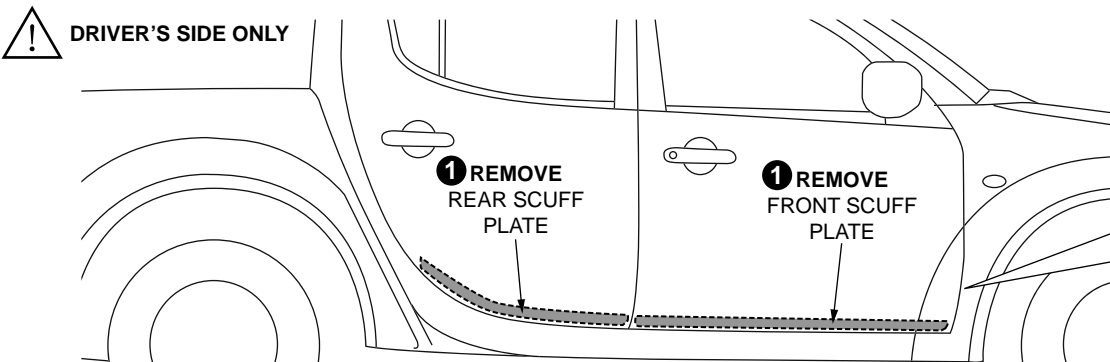

FIG. 3

RIVET THE GAS STRUT EARTH WIRE (**PASSENGER SIDE ONLY**) TO THE GAS STRUT BRACKET AS SHOWN.
ATTACH THE GAS STRUT FROM THE KIT TO THE VEHICLE AND SECURE EARTH WIRE AS SHOWN.
ENSURE THE NARROW END MOUNTS TO THE VEHICLE.

DRIVER'S SIDE ONLY



DRIVER'S SIDE ONLY

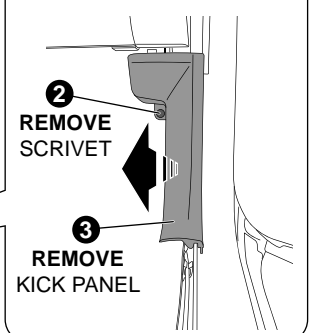
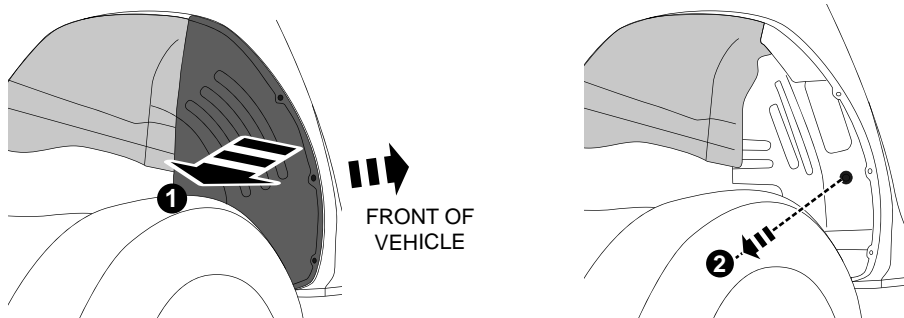

FIG. 4

REMOVE THE FRONT AND REAR SCUFF PLATES ON THE DRIVER'S SIDE OF THE VEHICLE ONLY.
REMOVE THE DRIVER'S SIDE KICK PANEL BY FIRST REMOVING THE SCRIVET.

MITSUBISHI TRITON 1 & 3 PIECE REMOTE LOCKING KIT

DRIVER'S SIDE REAR WHEEL ARCH



REMOVE AND RETAIN THE FRONT PANEL AND HARDWARE, FROM THE REAR DRIVER'S SIDE WHEEL ARCH AS SHOWN. REMOVE RUBBER GROMMET TO GAIN ACCESS TO VEHICLE CABIN.

FIG. 5

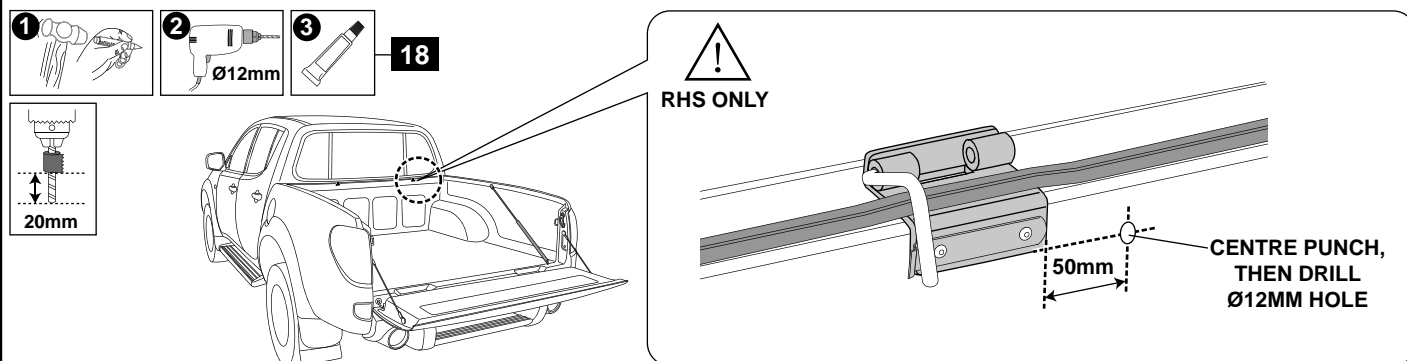

MARK AND CENTREPUNCH 50mm ACROSS FROM THE BOTTOM RIGHT CORNER OF THE RHS BOTTOM HINGE AS SHOWN. DRILL A Ø12mm HOLE AND APPLY RUST INHIBITOR.

FIG. 6

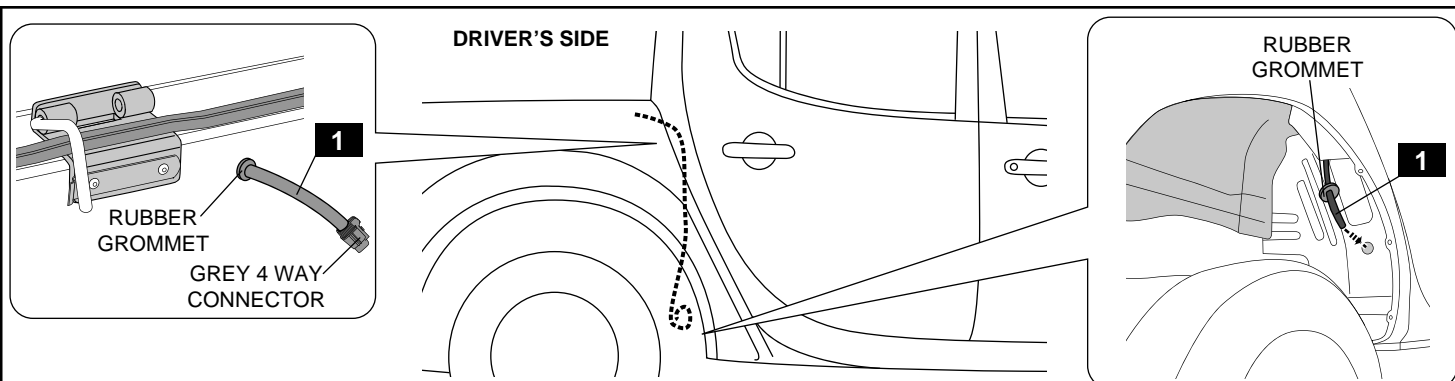

FEED THE VEHICLE WIRING LOOM THROUGH THE Ø12MM HOLE AND DOWN BETWEEN THE TUB AND THE CABIN UNTIL YOU REACH THE RUBBER GROMMET AT THE END OF THE WIRING LOOM. PUSH THE RUBBER GROMMET INTO THE Ø12MM HOLE TO SEAL IT. FEED THE VEHICLE WIRING LOOM INTO THE HOLE LEADING INTO THE VEHICLE'S CABIN UNTIL YOU REACH THE RUBBER GROMMET. PUSH THE RUBBER GROMMET INTO THE CABIN HOLE TO SEAL IT AS SHOWN.

FIG. 7

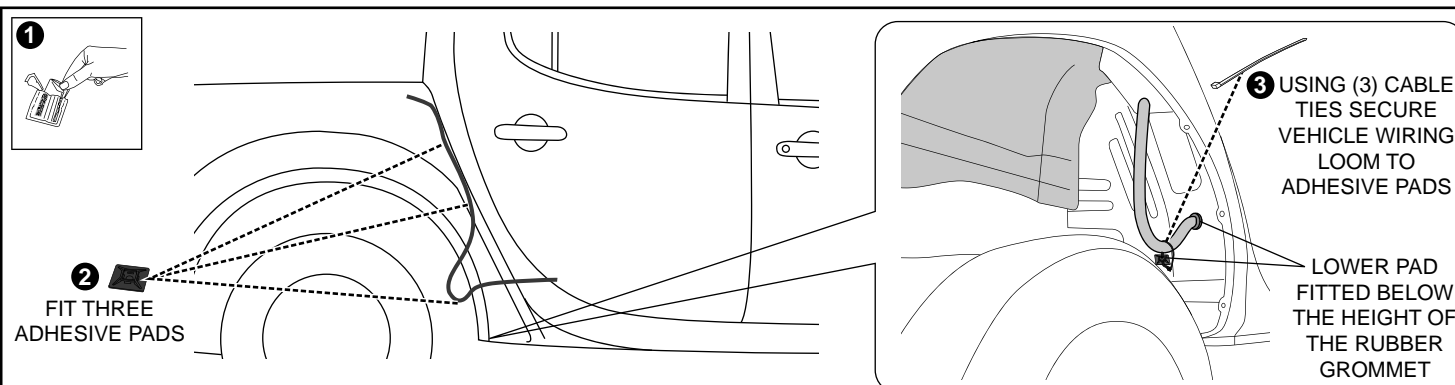

USING ALCOHOL WIPE PROVIDED CLEAN THREE AREAS INSIDE THE WHEEL ARCH ALONG THE VEHICLE WIRING LOOM TO ATTACH THE ADHESIVE PADS (**ENSURE THE LOWER PAD IS FITTED BELOW THE HEIGHT OF THE RUBBER GROMMET**), AND WIPE AWAY RESIDUE WITH A DRY CLEAN CLOTH. REMOVE BACKING TAPE FROM THE THREE ADHESIVE PADS AND FIT TO AREAS CLEANED AND APPLY FIRM PRESSURE FOR MAXIMUM ADHESION. USE A CABLE TIE ON EACH PAD TO SECURE THE VEHICLE WIRING LOOM.

FIG. 8

MITSUBISHI TRITON 1 & 3 PIECE REMOTE LOCKING KIT

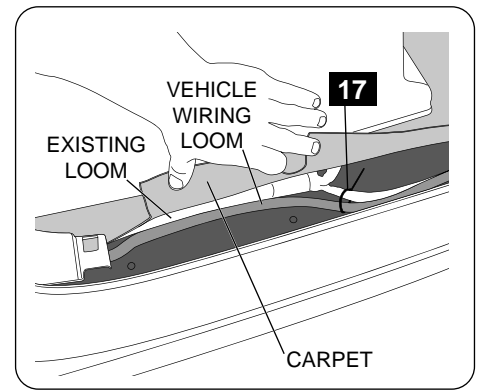
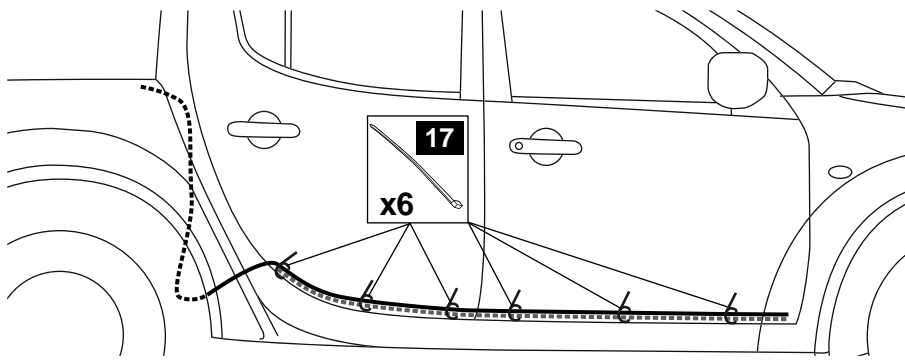
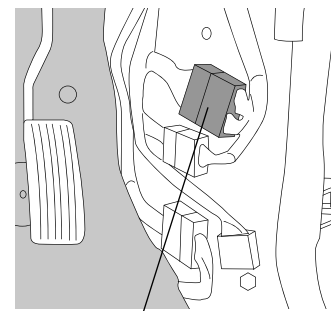
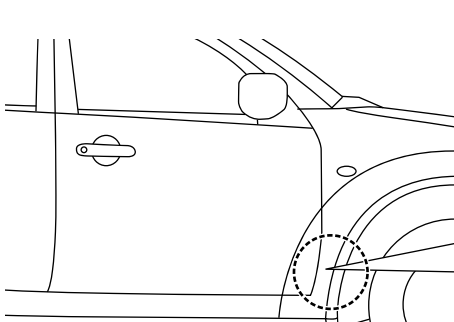
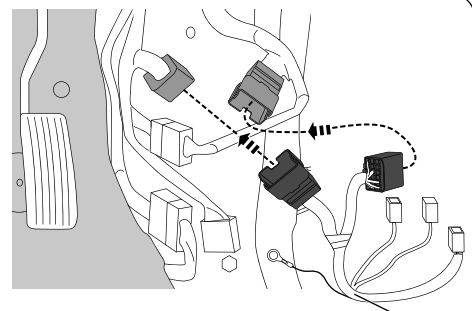

FIG. 9 FEED THE VEHICLE WIRING LOOM FROM THE REAR OF THE CABIN AND RUN IT ALONG THE EDGE OF THE CARPET FOLLOWING THE EXISTING WIRES UNTIL YOU REACH THE FRONT KICK PANEL AREA. CABLE TIE VEHICLE HARNESS TO EXISTING WIRES.



1 DISCONNECT PLUGS



2 CONNECT T-CONNECTOR

FIG. 10 LOCATE AND DISCONNECT PLUGS AS SHOWN IN FRONT KICK PANEL AREA. ATTACH THE T-CONNECTOR WIRING LOOM LARGE CONNECTORS PROVIDED TO THE PREVIOUSLY DISCONNECTED WIRING PLUGS AS SHOWN.

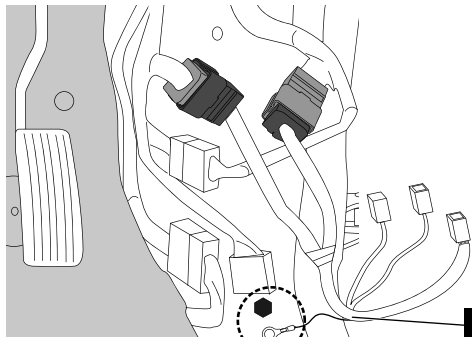
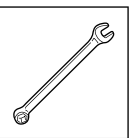

6

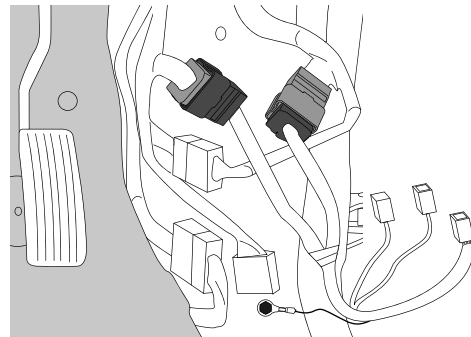

FIG. 11 ATTACH THE EYELET ON THE T-CONNECTOR TO THE VEHICLE EARTH TERMINAL BY REMOVING THE BOLT, ATTACHING THE EYELET AND THEN REPLACING THE BOLT.

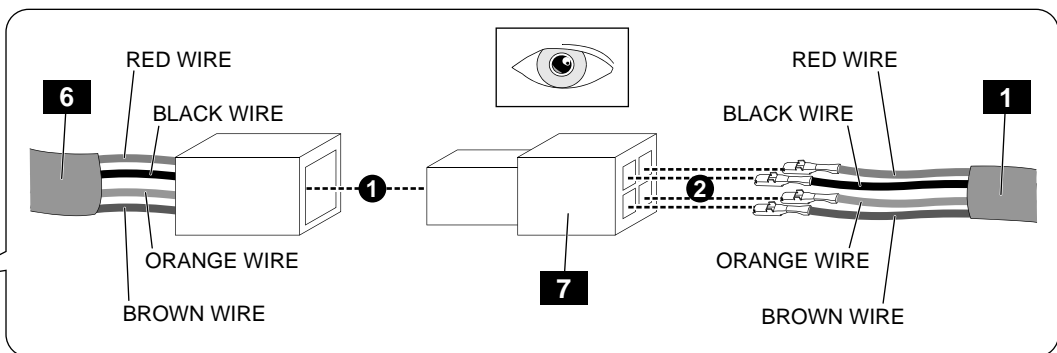
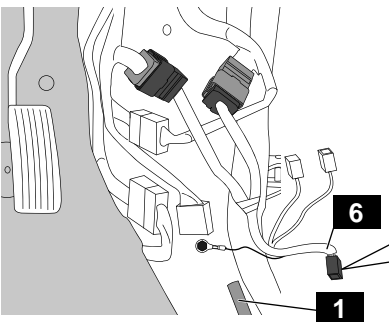
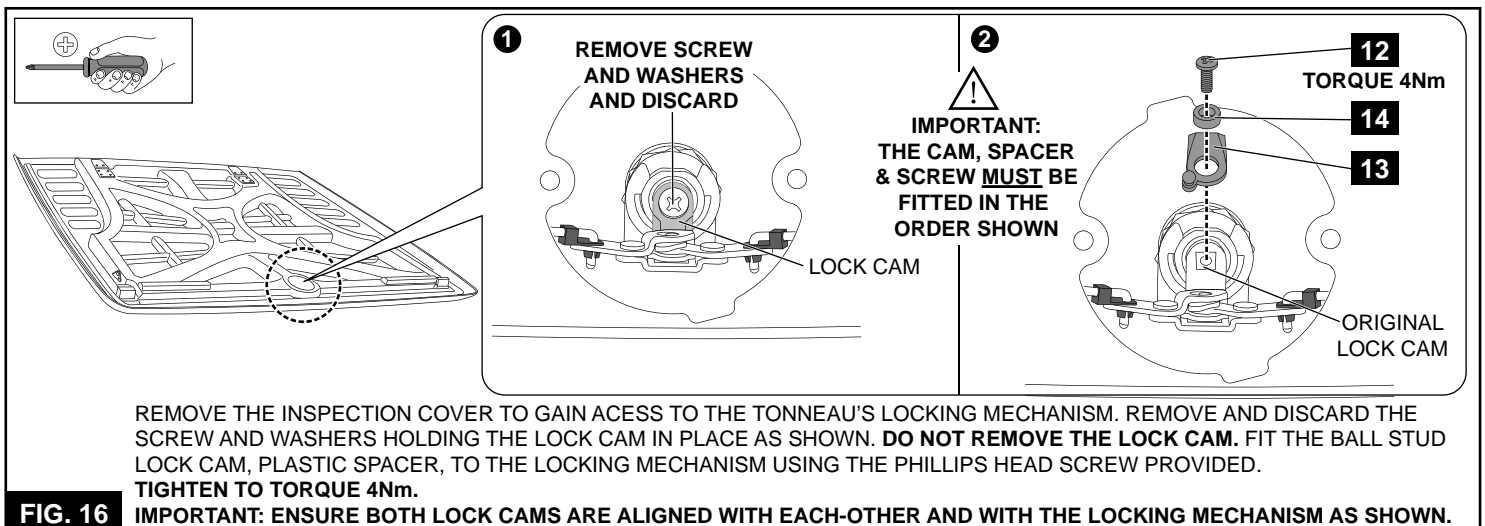
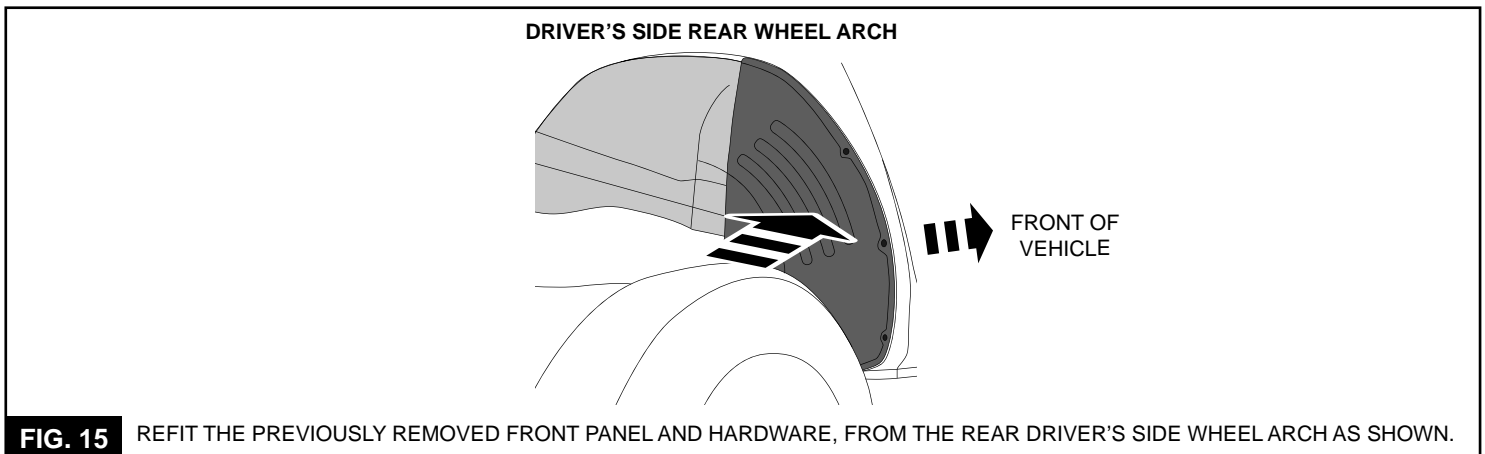
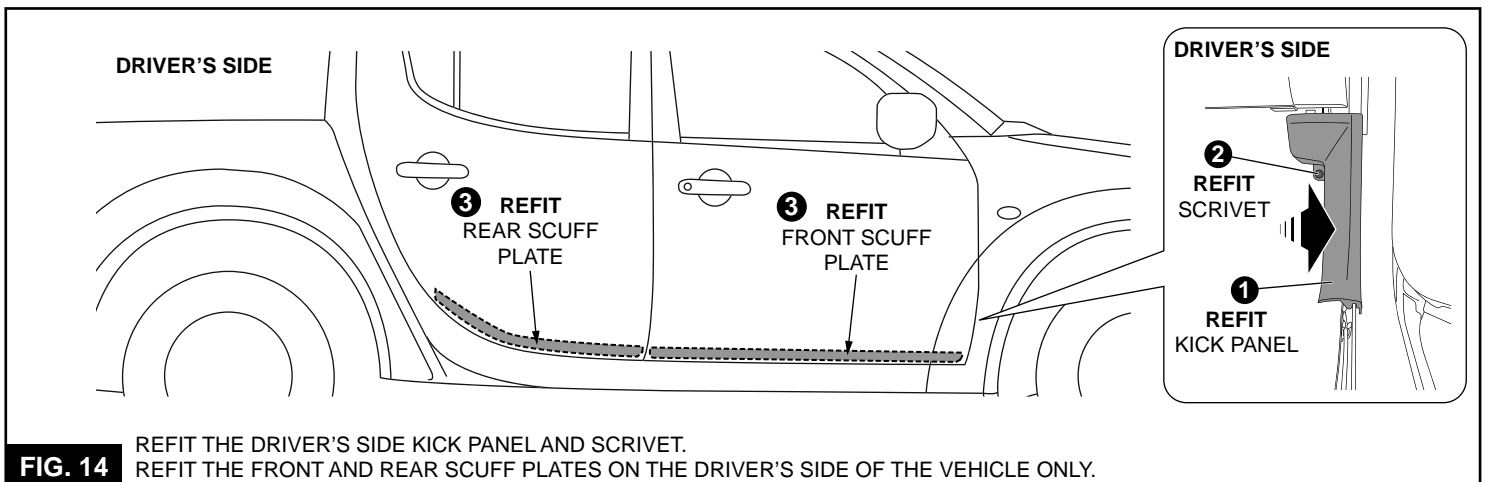
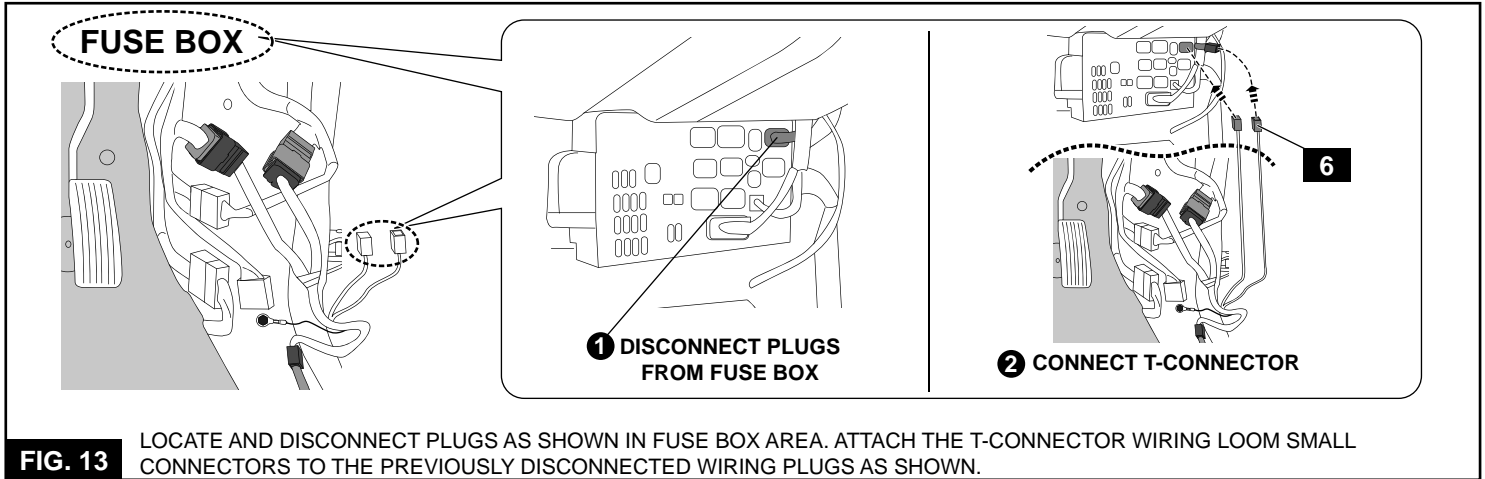
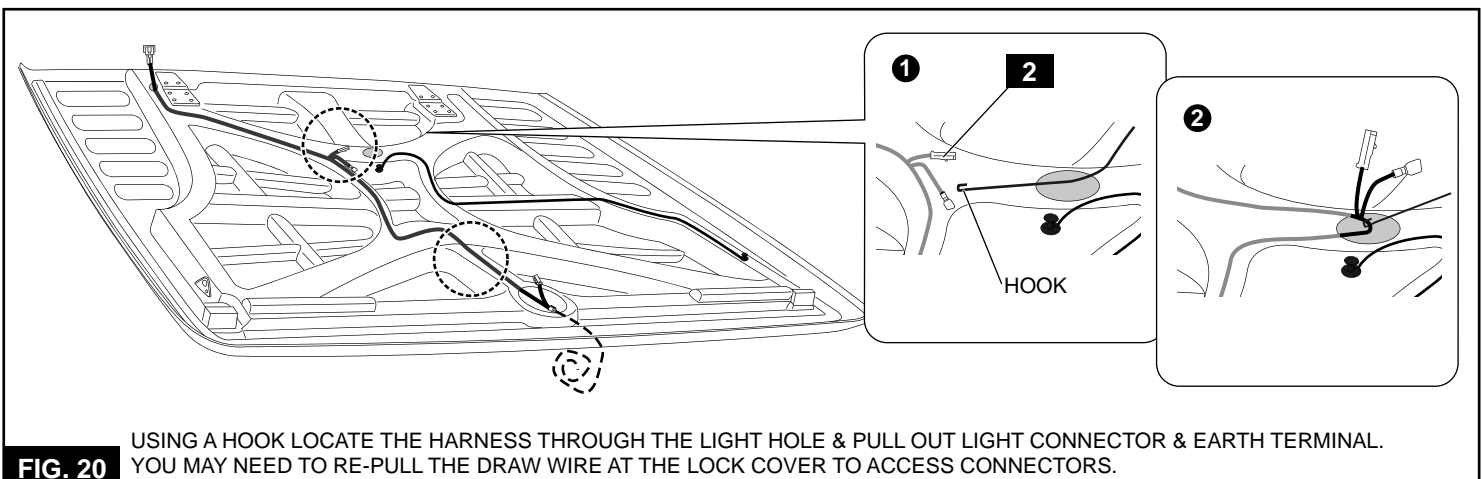
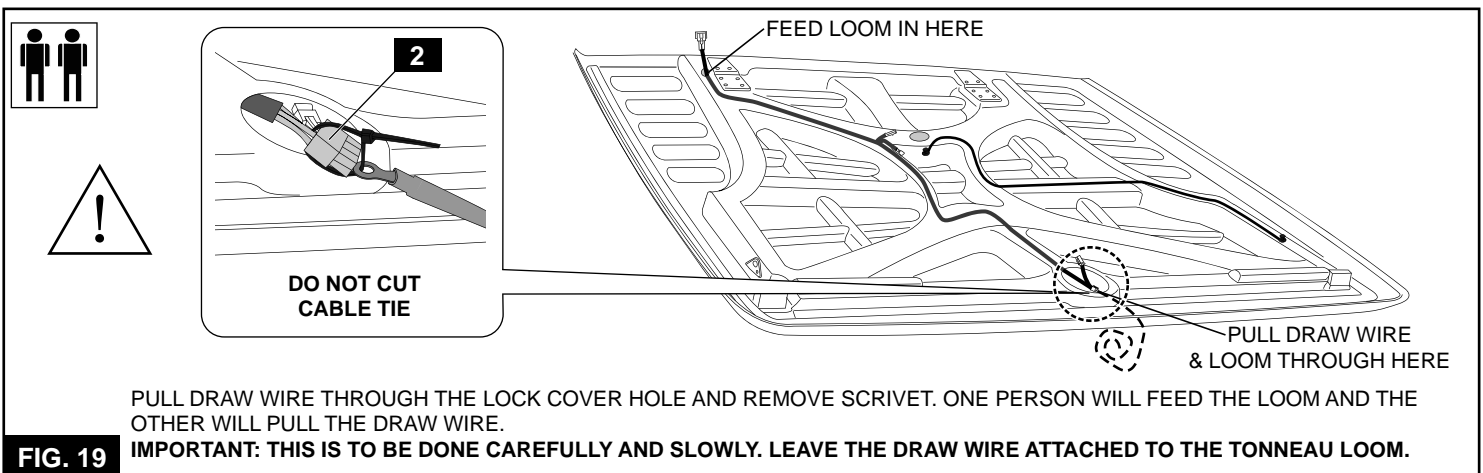
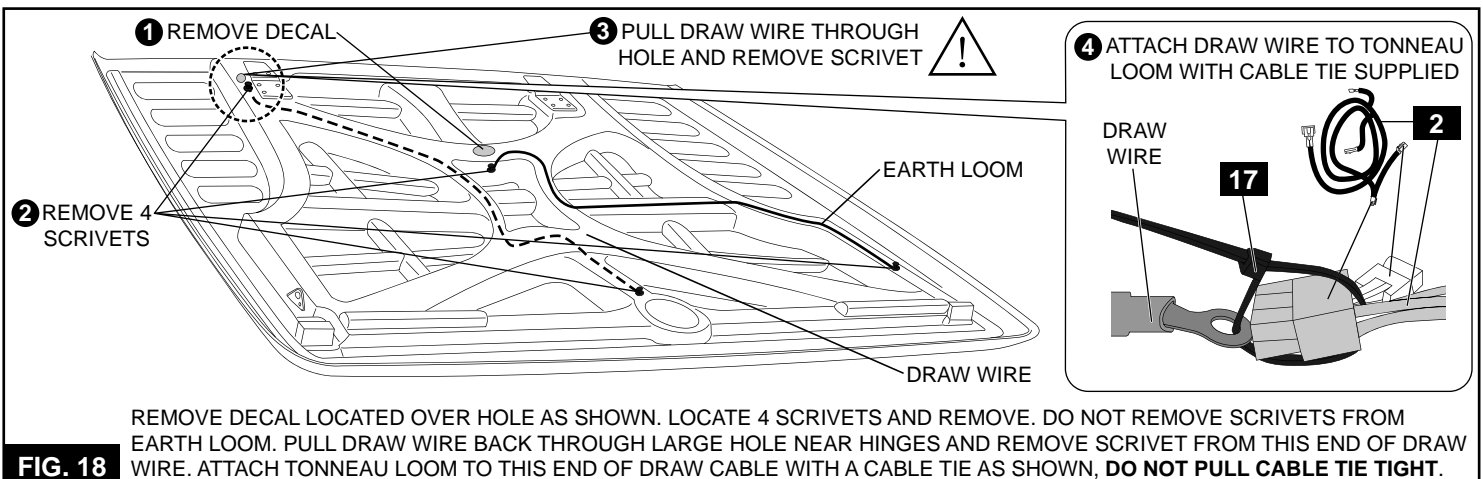
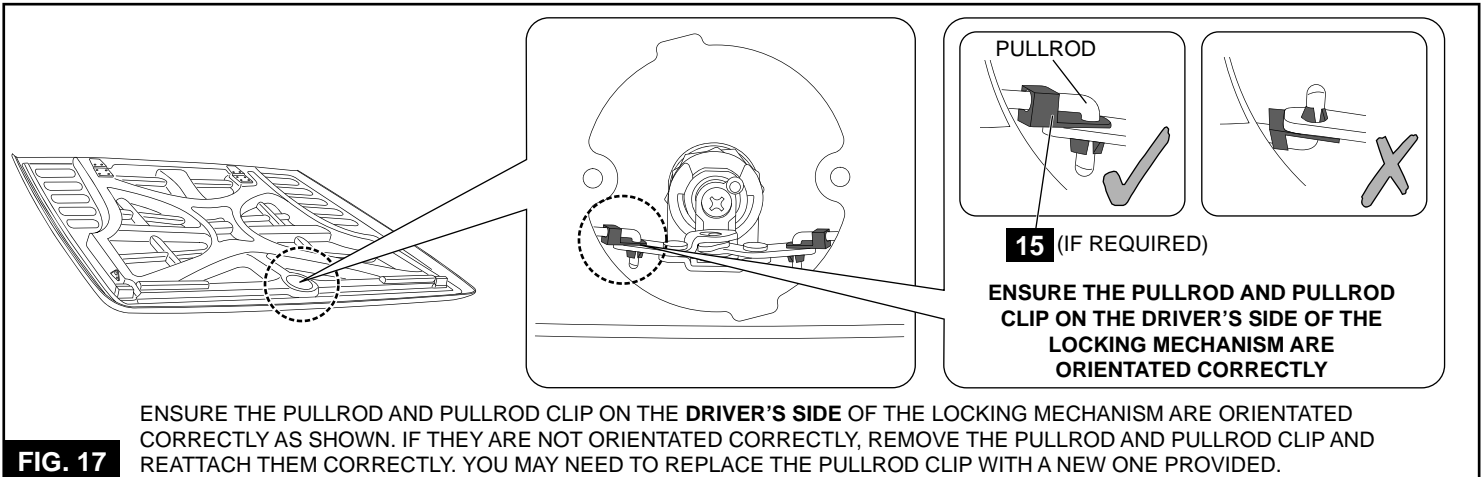

FIG. 12 INSERT THE 4-WAY MALE TERMINAL HOUSING PROVIDED INTO THE 4-WAY FEMALE TERMINAL HOUSING ON THE T-CONNECTOR. INSERT THE FOUR TERMINALS ON THE VEHICLE WIRING LOOM INTO THE 4-WAY MALE TERMINAL HOUSING. **IMPORTANT: THE COLOUR OF THE WIRES MUST LINE UP WITH EACH OTHER THROUGH THE CONNECTORS AS SHOWN. THE TERMINALS MUST BE PUSHED INTO THE TERMINAL HOUSING UNTIL A DEFINITE CLICK IS HEARD.**

MITSUBISHI TRITON 1 & 3 PIECE REMOTE LOCKING KIT



MITSUBISHI TRITON 1 & 3 PIECE REMOTE LOCKING KIT



MITSUBISHI TRITON 1 & 3 PIECE REMOTE LOCKING KIT

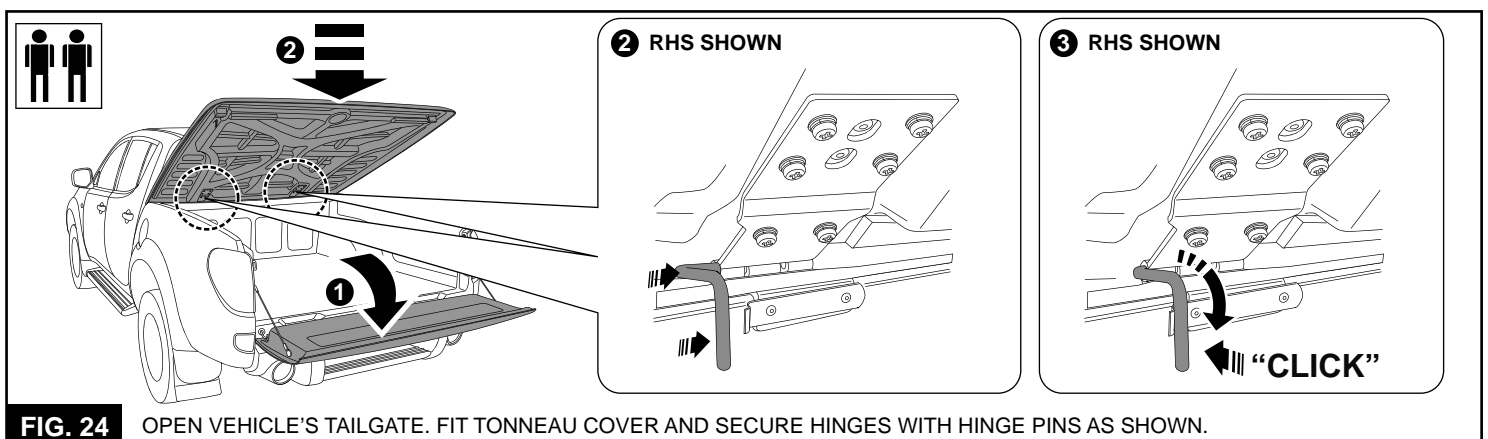
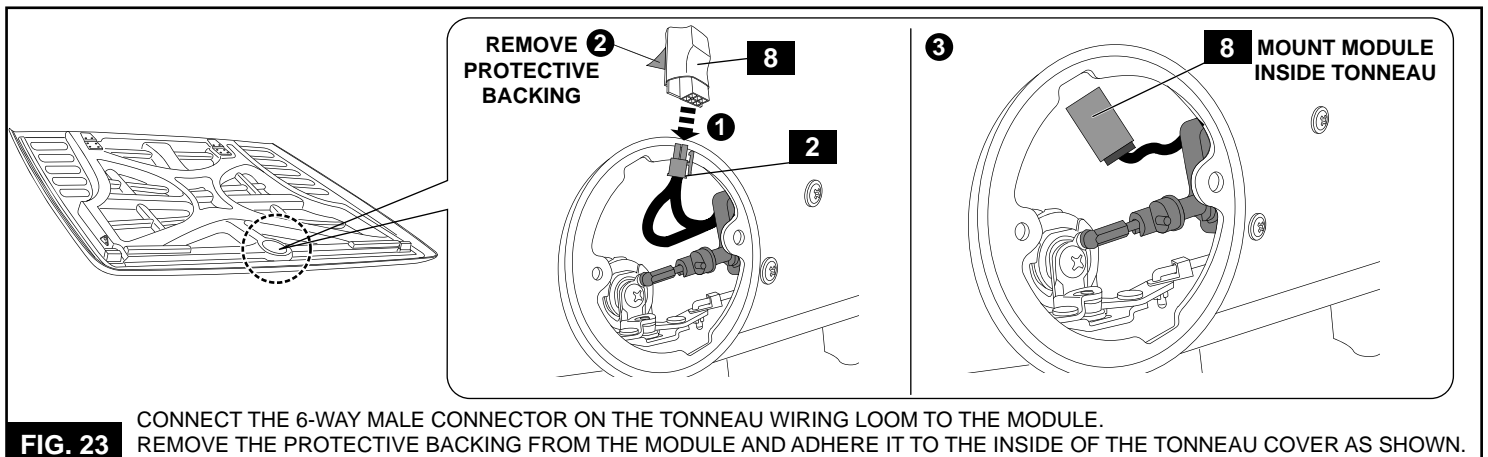
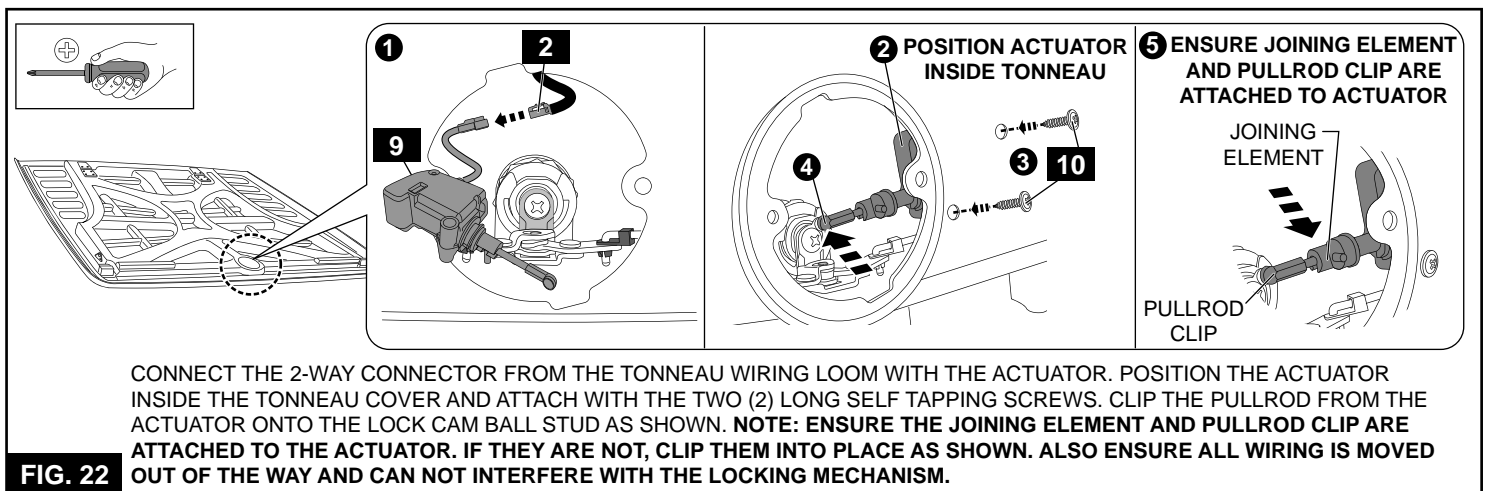
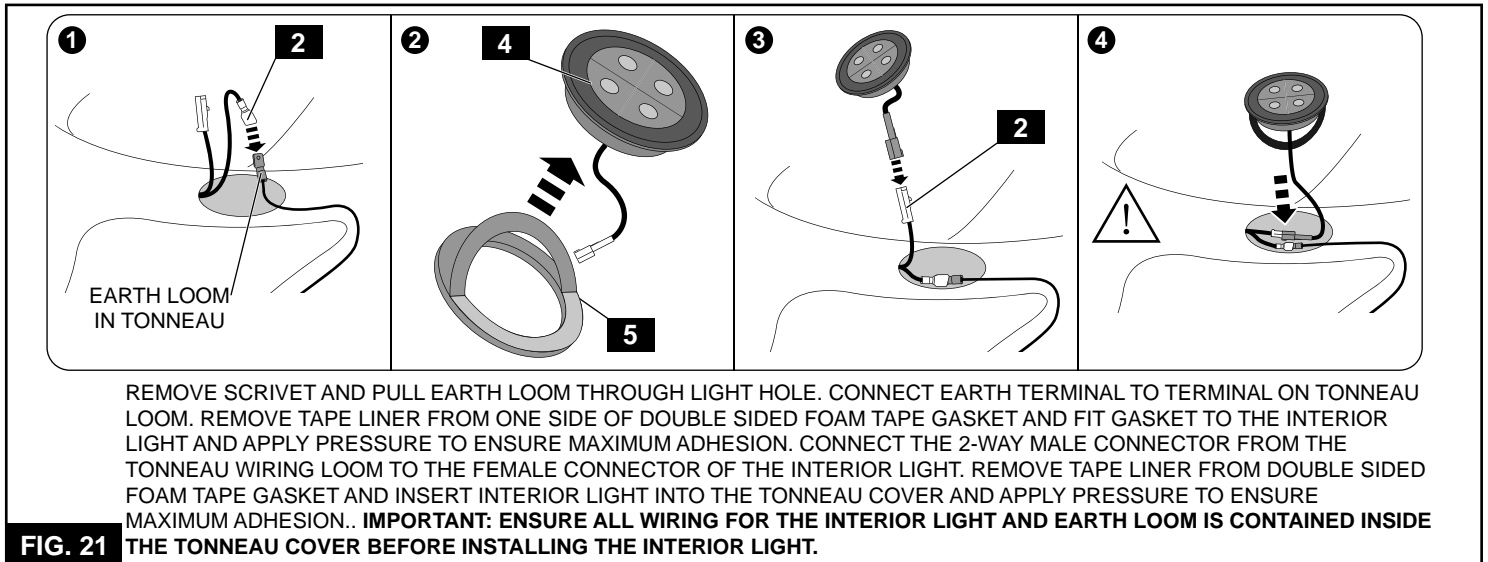

MITSUBISHI TRITON 1 & 3 PIECE REMOTE LOCKING KIT

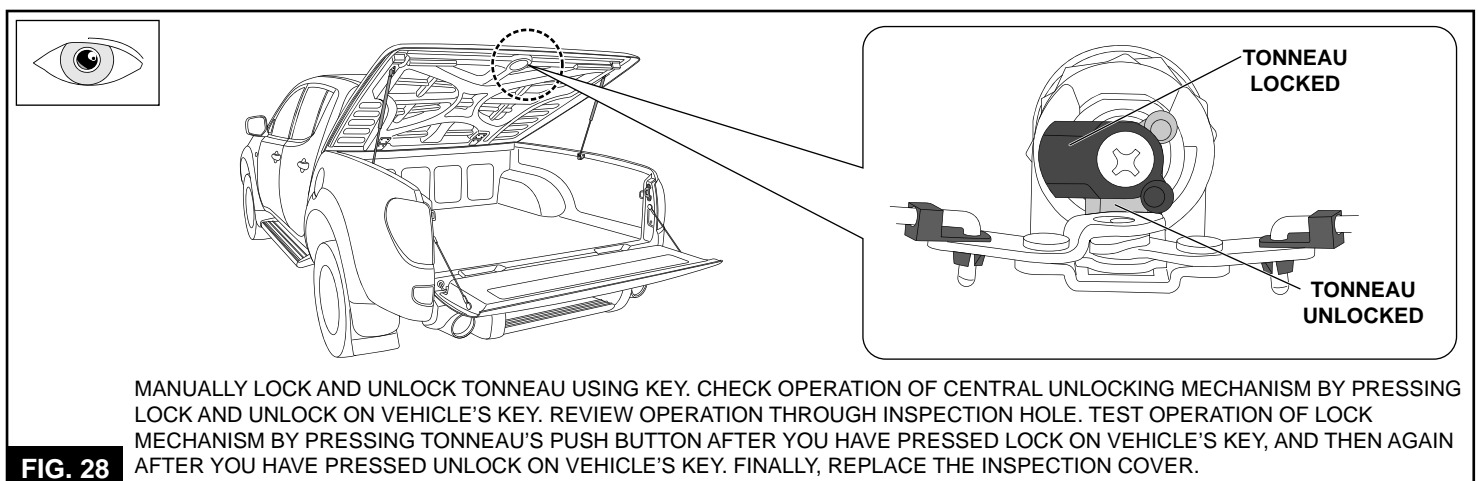
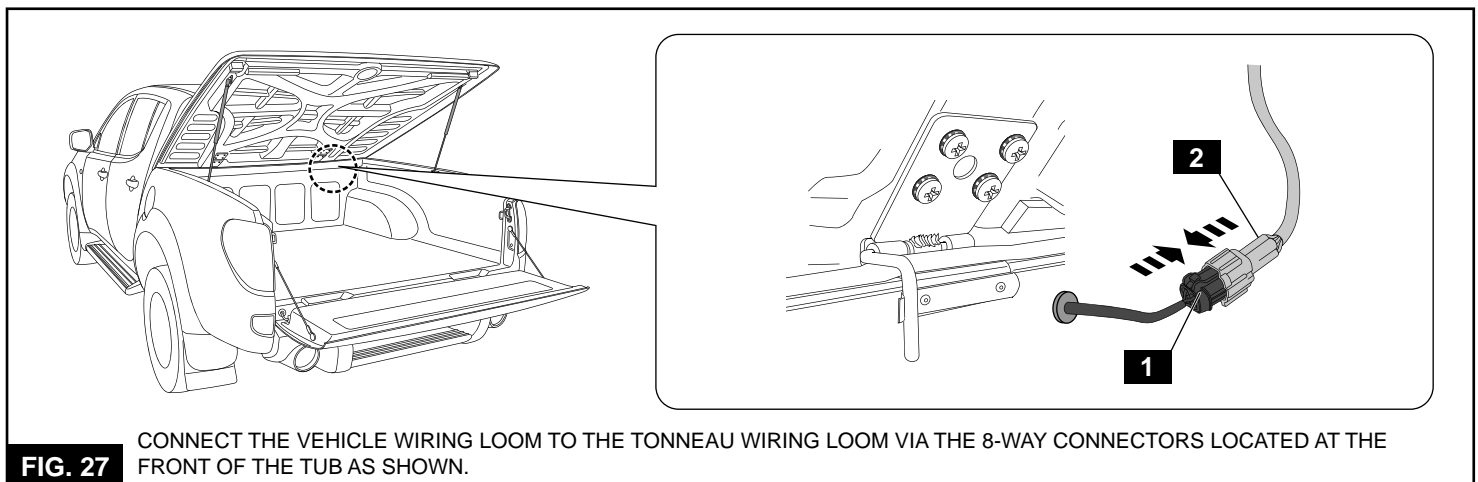
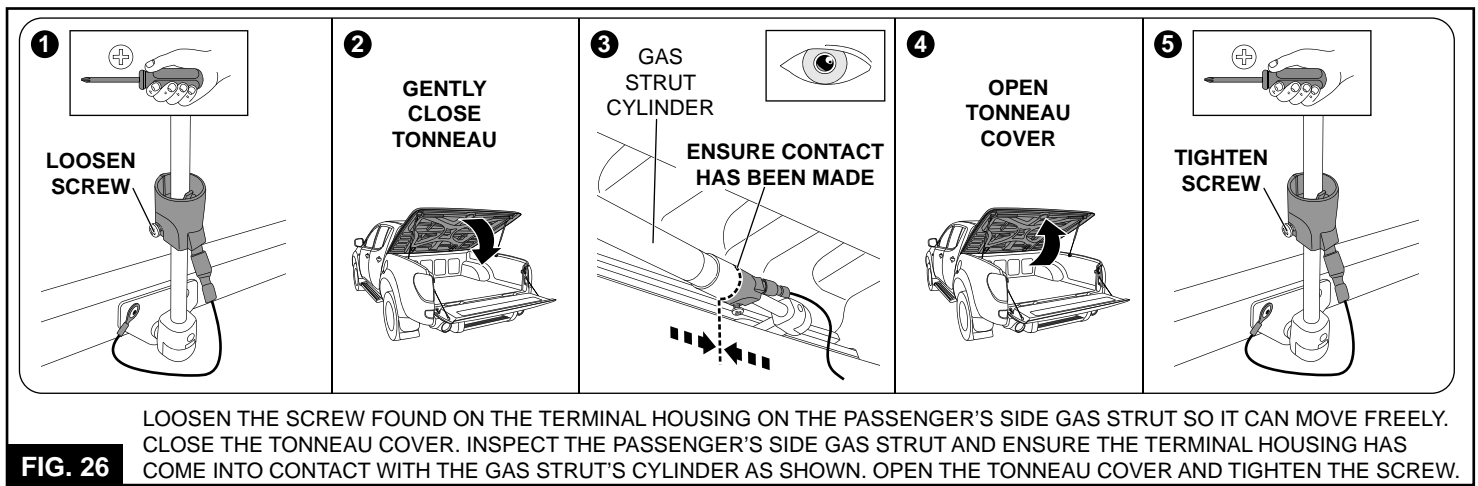
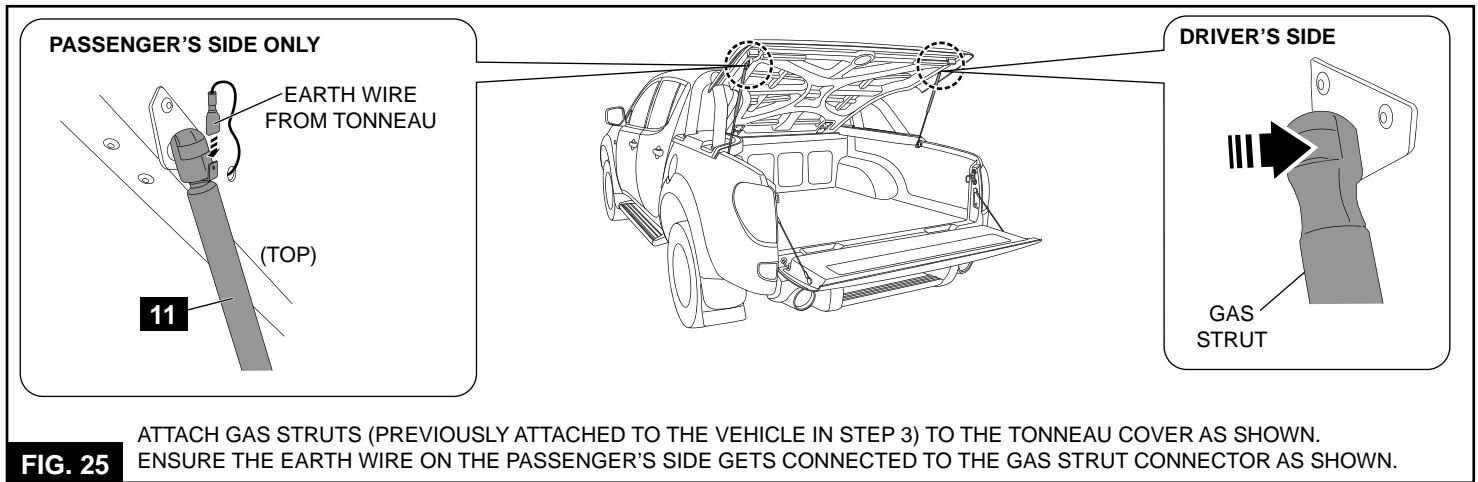

MITSUBISHI TRITON 1 & 3 PIECE REMOTE LOCKING KIT

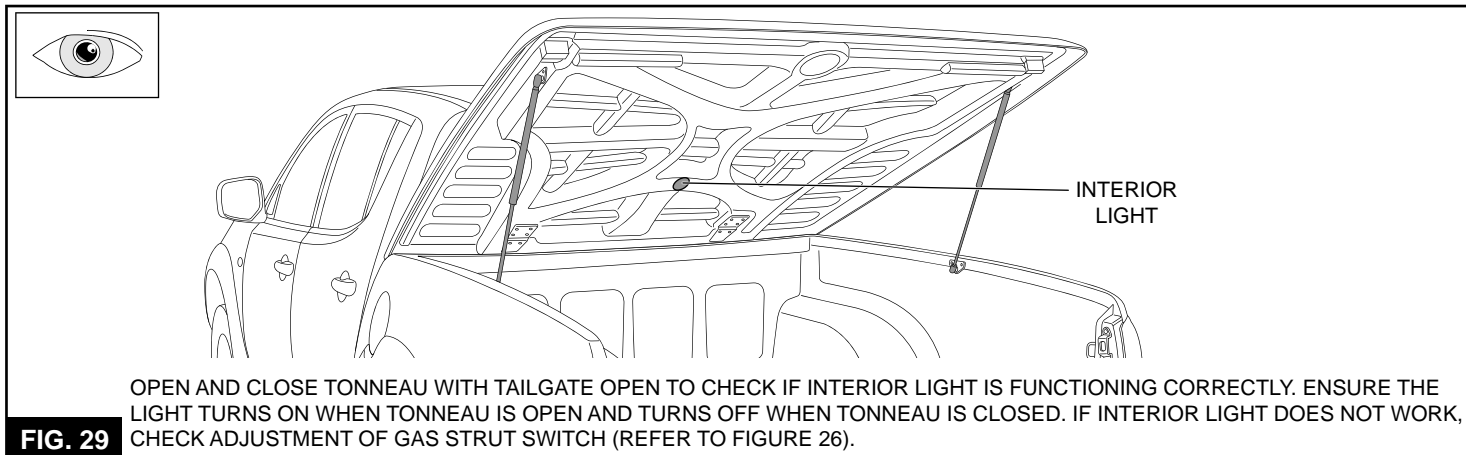

REMOVAL OF TONNEAU COVER

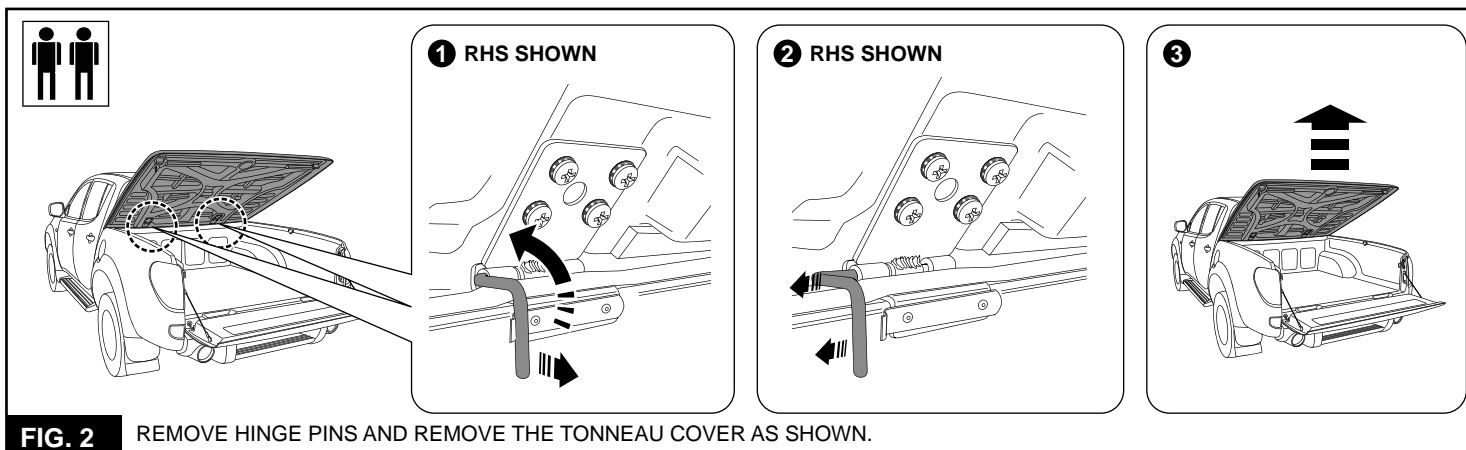
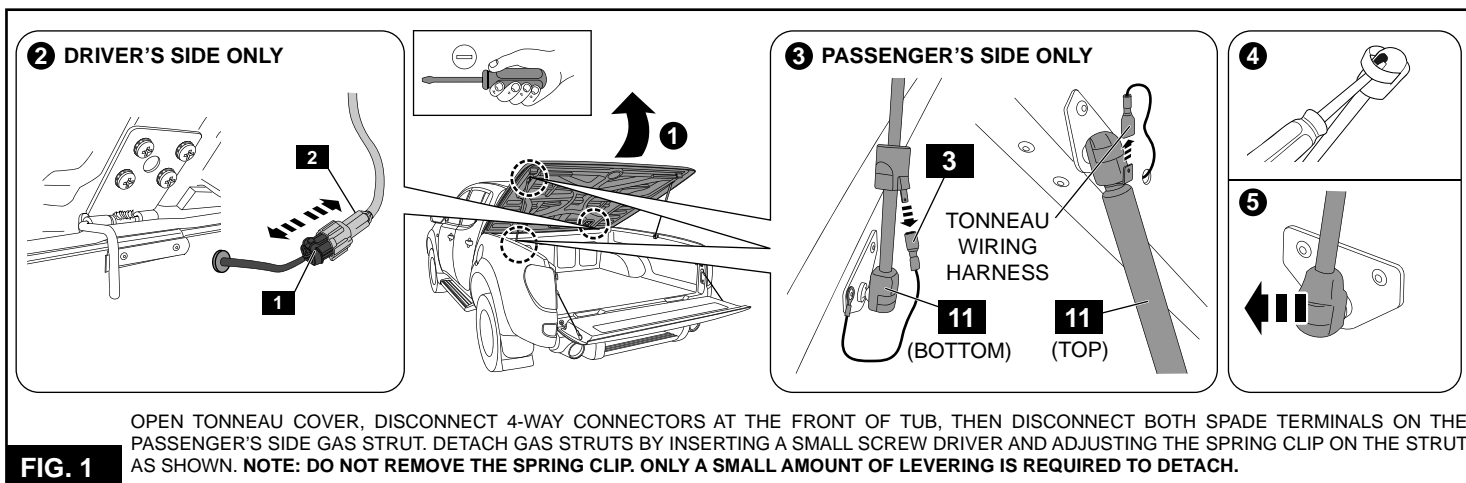
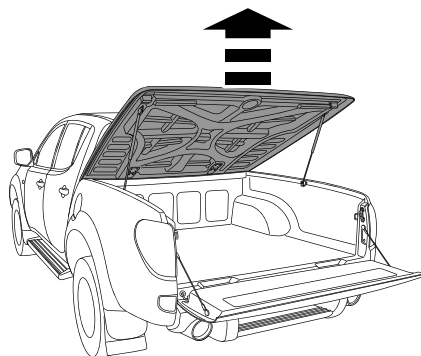

TO REPLACE THE TONNEAU COVER:

Reverse the sequence and the procedures of the two (2) Figures above.