

Isuzu D-Max 2016

1 & 3 PIECE HARD TONNEAU REMOTE LOCKING KIT INSTALLATION INSTRUCTIONS

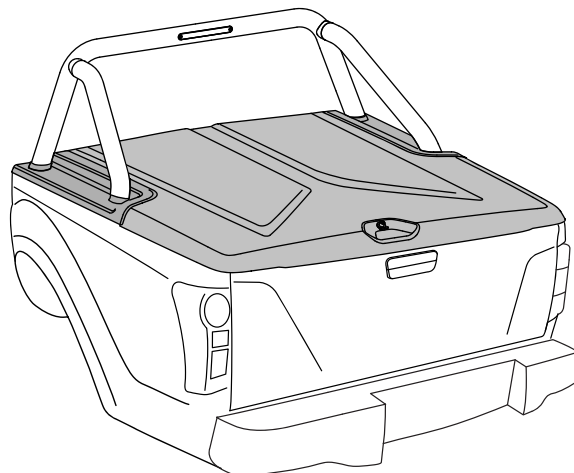
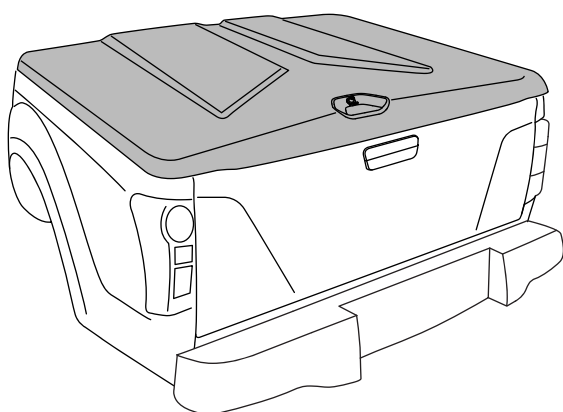

Installation Time: Approx. 180 min

Care Instructions:



Clean Tonneau Cover with a mild detergent and water solution.



Do not use abrasive cleaners or solvents.



Place these instructions in vehicle's glove box after installation is complete

TONNEAU COVER - IMPORTANT:

- Read instructions carefully before installation. It is strongly recommended that installation is conducted by an authorized dealer.
- This product must be installed exactly as specified in these instructions. Failure to do so may result in improper fit and/or retention.
- Recommend installation by 2 people.
- Fitting Instructions must be given to the end customer to understand correct removal and replacement process onto the vehicle.
- Do Not cycle remote key fob continuously or the actuator for operation of the remote locking system will burn out.

MAINTENANCE:

The gas struts are self lubricating and should only be cleaned occasionally with a damp cloth. Premature seal failure will result if solvents or lubricants are used to clean struts. Gas struts must be connected with the cylinder end to the Tonneau Cover or Warranty is Void. The locking mechanisms and latches only require occasional lubrication with Graphite Powder. DO NOT use any other lubricants or oils. Using alternative products will VOID Warranty. All installation hardware and fasteners must be checked every so often for tightness.

TOOLS REQUIRED:

- | | | |
|--------------------|-----------------------------|----------------------------|
| • Torque Wrench | • Phillips Head Screwdriver | • Drill & 11mm, 5.5mm bits |
| • Sockets & Driver | • Flat Blade Screwdriver | • Holesaw 50mm |
| • Spanners | • Draw Wire | • Dremel |
| • Side Cutters | • Wire Hook | • Tape measure |
| | • PVC or masking tape | |

PARTS CHECK SHEET

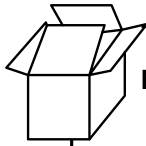

PARTS IN MAIN CARTON

1

Double Sided
Tape
(TAPE0614)
Qty - 1

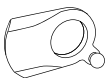
4

Lock Cam with
Ball Stud
(CLIP2419-3)
Qty - 1

10



Spacer
(MISC0001)
Qty - 2



Vehicle
Wiring Kit
(LOOM0147)
Qty - 1

5

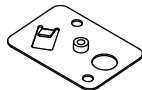

Spacer
(FAST0466)
Qty - 1

11

Pin Switch Base
(CLIP3140)
Qty - 1

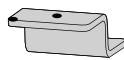

Tonneau
Wiring Kit
(LOOM0002B)
Qty - 1

6

Pin Switch Plate
(CLIP3141PC)
Qty - 1

12



Pin Switch
Screw
(SCRW0915)
Qty - 1



Earth Wire
(LOOM0005)
Qty - 1

7

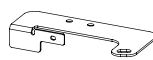
M5x30 Hex
Head Bolt
(SCRW0907)
Qty - 2

13

Harness Bracket
(CLIP3304PC)
Qty - 1

8

M5 Flat Washer
(WASH0190)
Qty - 8

14

M5x16 Hex
Head Bolt
(SCRW0450)
Qty - 2

9

M5 Nylock Nut
(NUTS0171)
Qty - 4

15

Blackout Sticker
(LABL1373)
Qty - 1



Fitting
Instruction
(FIT-TC0378b)
Qty - 1

2

Actuator Qty - 1

CLIP2901BL

B

MISC3481
(part b)

D

MISC3481
(part a)

E

SCRW1073

C

MISC5838

A

LOOM0347

F
3

Phillips Head
Screw
(SCRW0648-2)
Qty - 1

PARTS IN VEHICLE WIRING KIT - (LOOM0147)

20

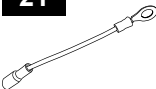

Vehicle Wiring
Harness
(LOOM0147A)
Qty - 1

21

Earth Wire
Qty - 1

22

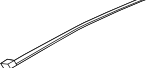
Male Terminal
Housing
Qty - 1

23

Cable Tie
Qty - 8

24

T-Connector
B-Pillar
(LOOM0147B)
Qty - 1

25

T-Connector
Tub rear
(LOOM0147C)
Qty - 1

PARTS IN TONNEAU WIRING KIT - (LOOM0002B)

31

Tonneau Wiring
Harness
Qty - 1

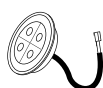
32

Interior Light
Qty - 1

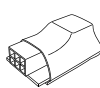
33

Module
Qty - 1



REMOTE LOCKING KIT - ACTUATOR ASSEMBLY

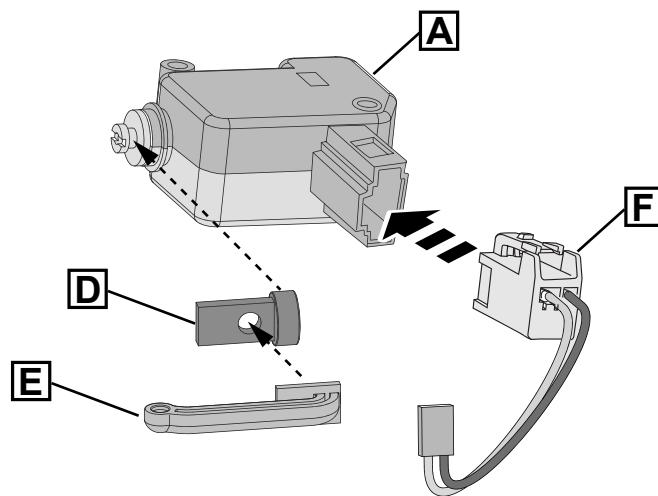
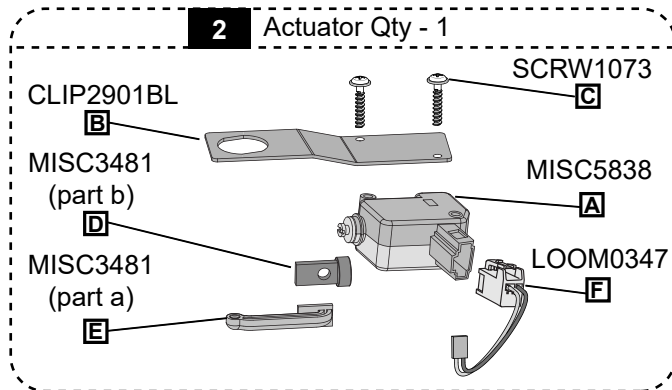

STEP A Connect the Pull Rod (E) to the Pull Rod Joiner (D) and slide into the end of the actuator (A) as shown. Connect the Loom (F) to the Actuator (A).

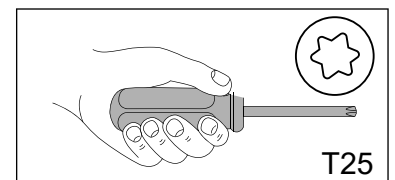
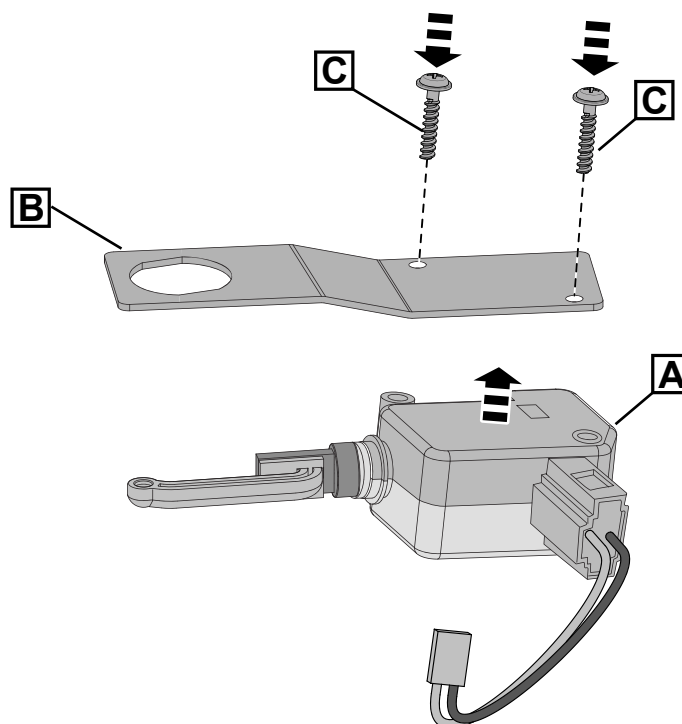

STEP B Secure the actuator (A) to the bracket (B) with 2x self tapping screws (C).
NOTE: Hand torque screws (C) until fully seated (tight).

REMOTE LOCKING KIT FOR 1&3 PIECE HARD TONNEAU

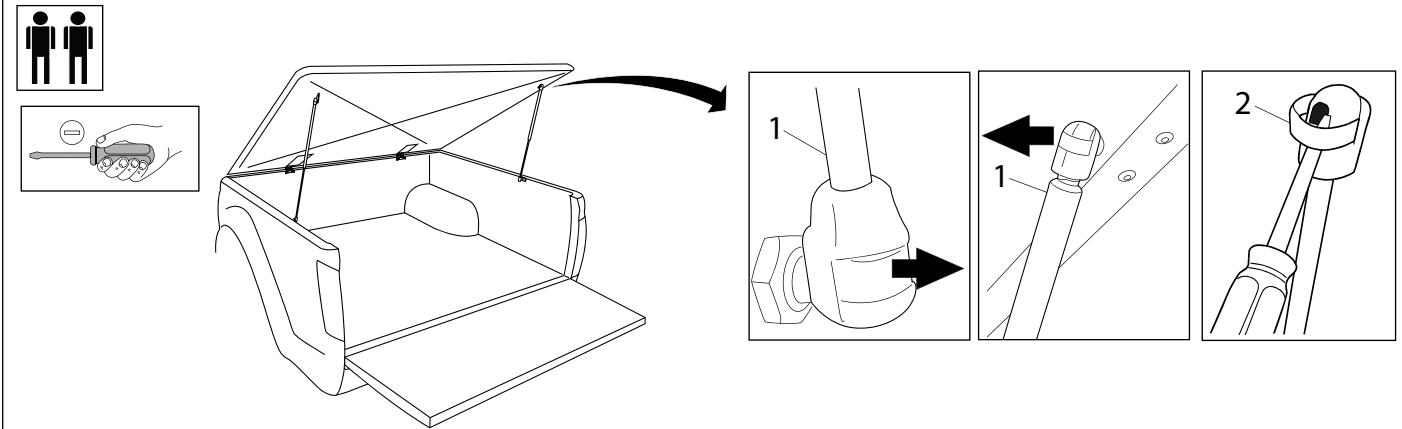

Diagram #:1

1. **NOTE:** Two people are required to complete installation. Open tonneau cover, detach gas strut (1) from the tonneau cover by inserting a small screwdriver and adjusting the spring clip (2) on the gas strut (1). **NOTE:** Do not remove the spring clip, only a small amount of levering is required to detach.

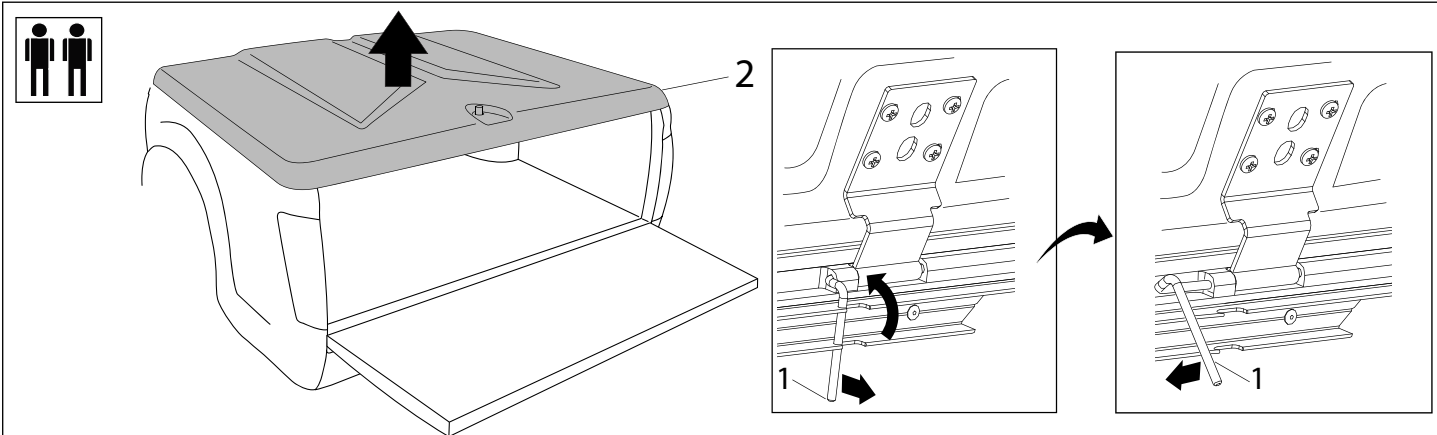

Diagram #:2

2. **NOTE:** 2 people are required to lift and remove the tonneau cover from the vehicle. Remove hinge pins (1) and remove tonneau cover (2).

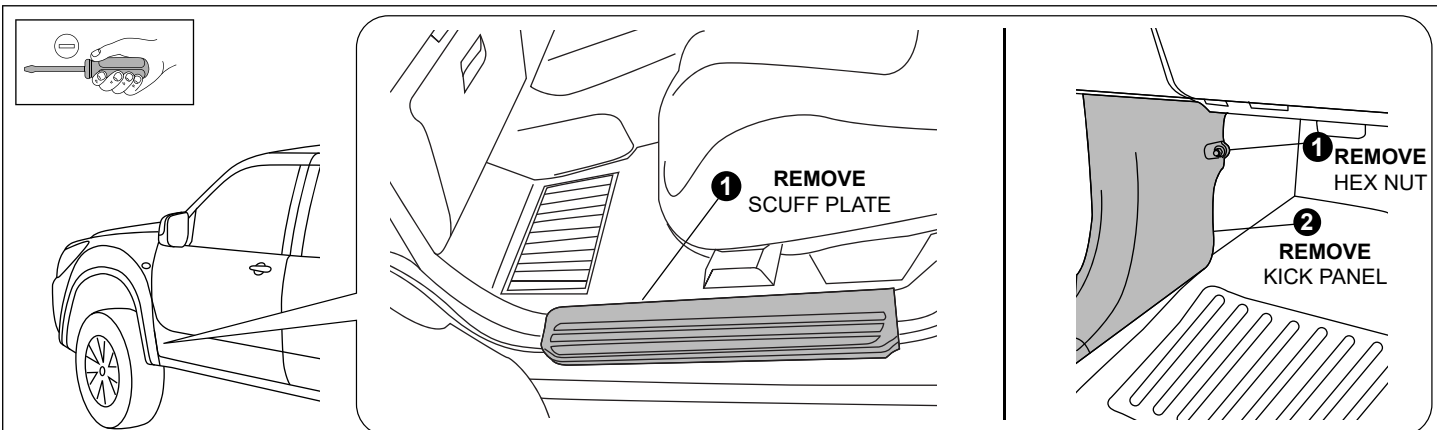

Diagram #:3

3. Remove the passenger's side scuff plate and kick panel.

REMOTE LOCKING KIT FOR 1&3 PIECE HARD TONNEAU

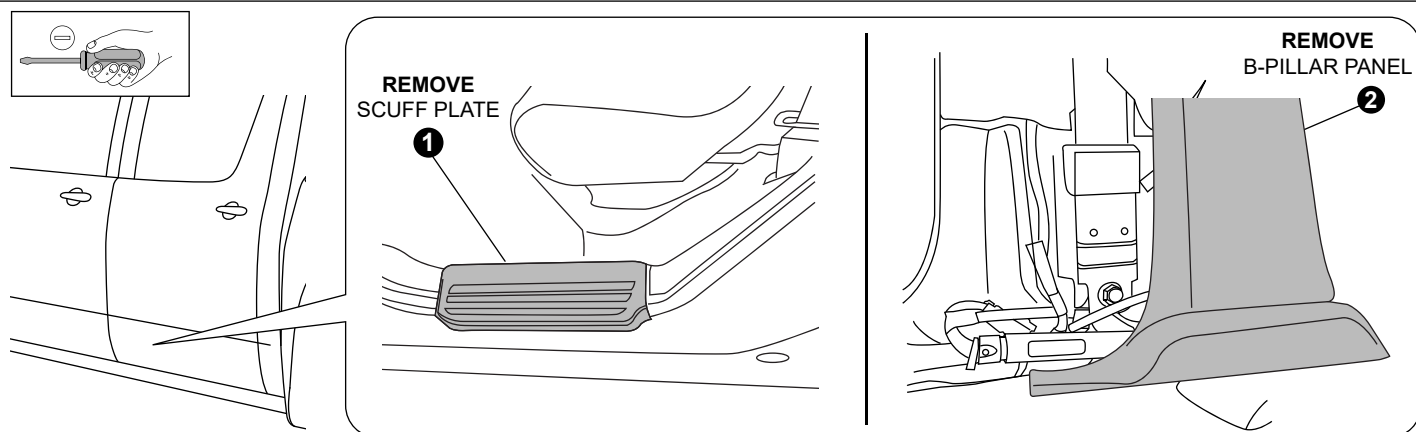

Diagram #4

4. Remove the rear passenger's side scuff plate and B-pillar panel. **Note:** The B-pillar panel will need to be pulled aside as it has the seat belt attached.

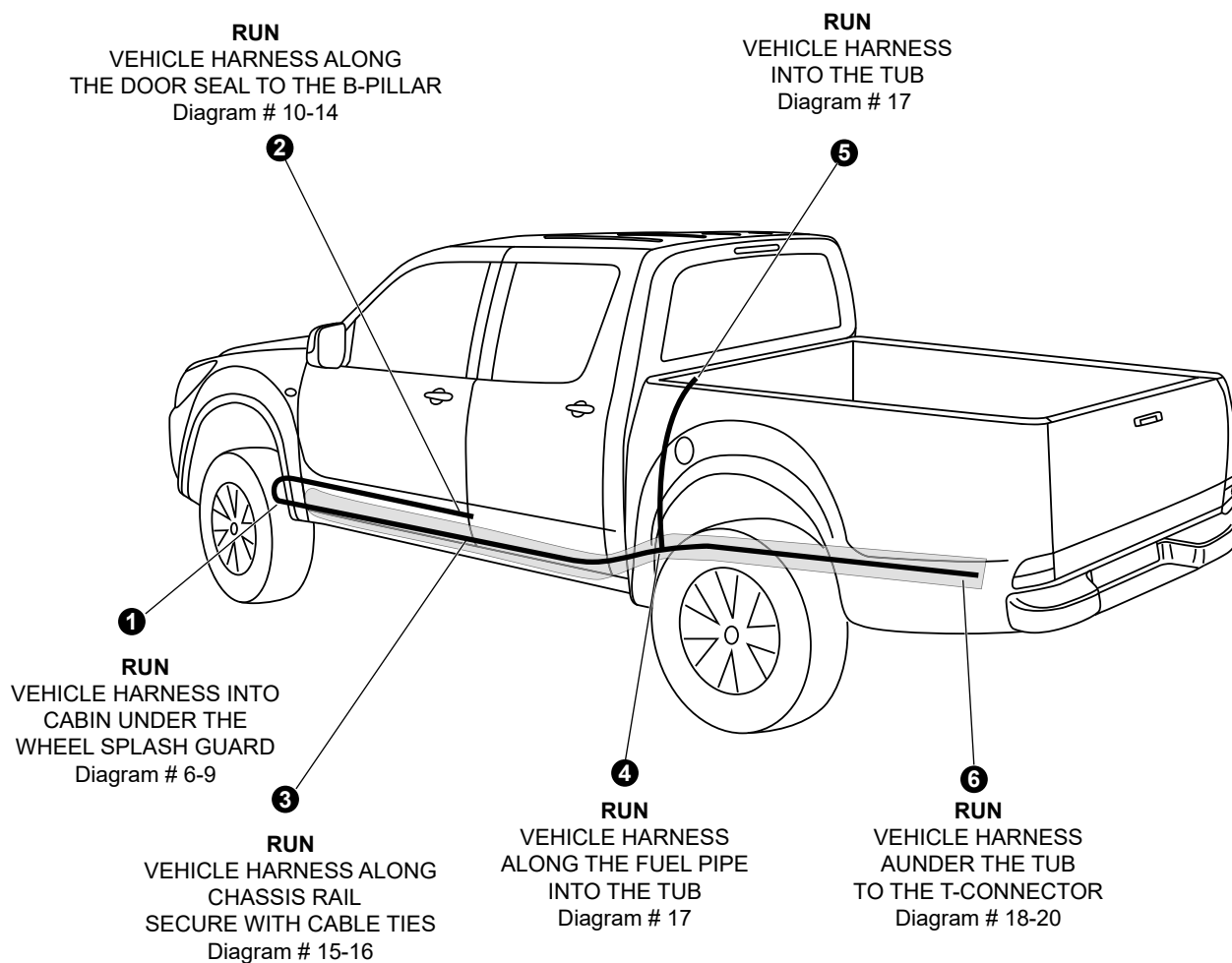

Diagram #5

5. Vehicle Harness layout as above.
Note: Follow detail steps below.

REMOTE LOCKING KIT FOR 1&3 PIECE HARD TONNEAU

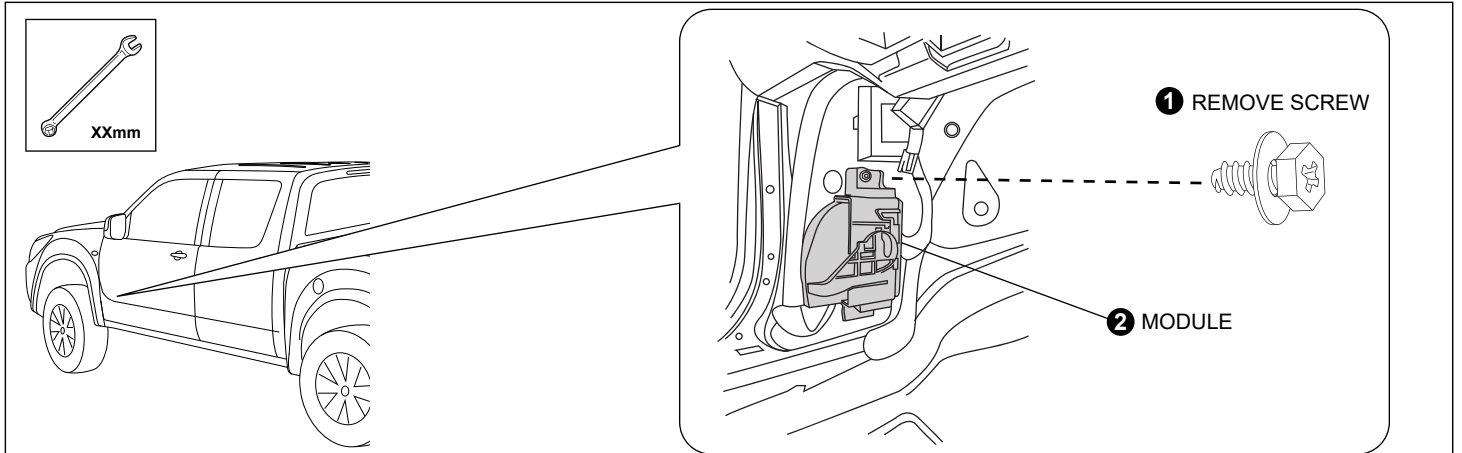

Diagram #:6

6. Inside the passenger footwell, remove the screw holding the module and pull it to side.

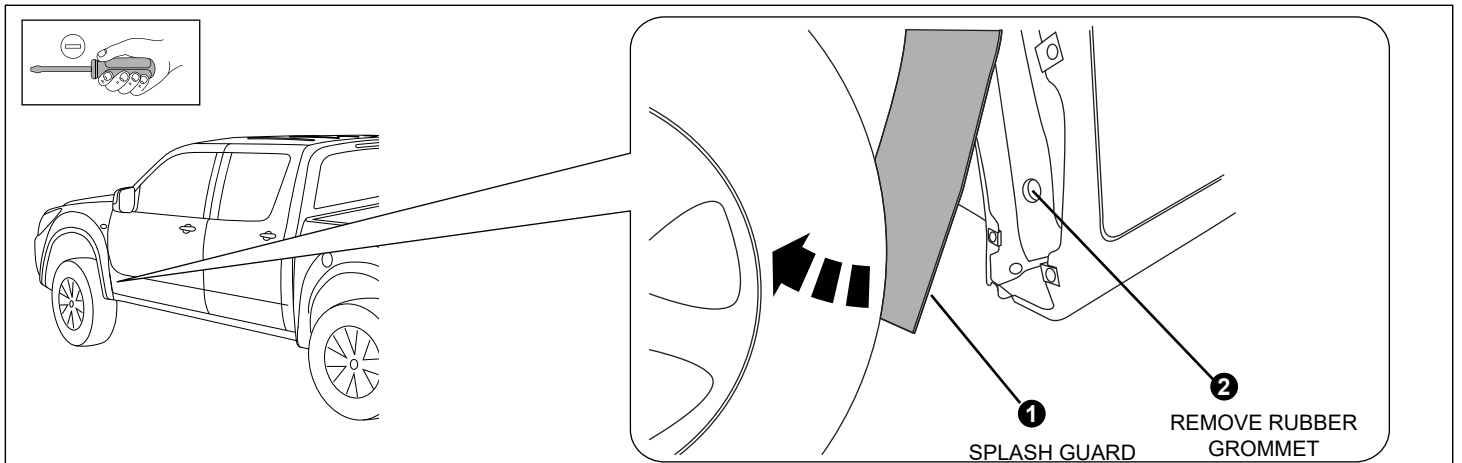

Diagram #:7

7. Pull the front passenger wheel splash guard forward and remove the rubber grommet from the hole as shown.

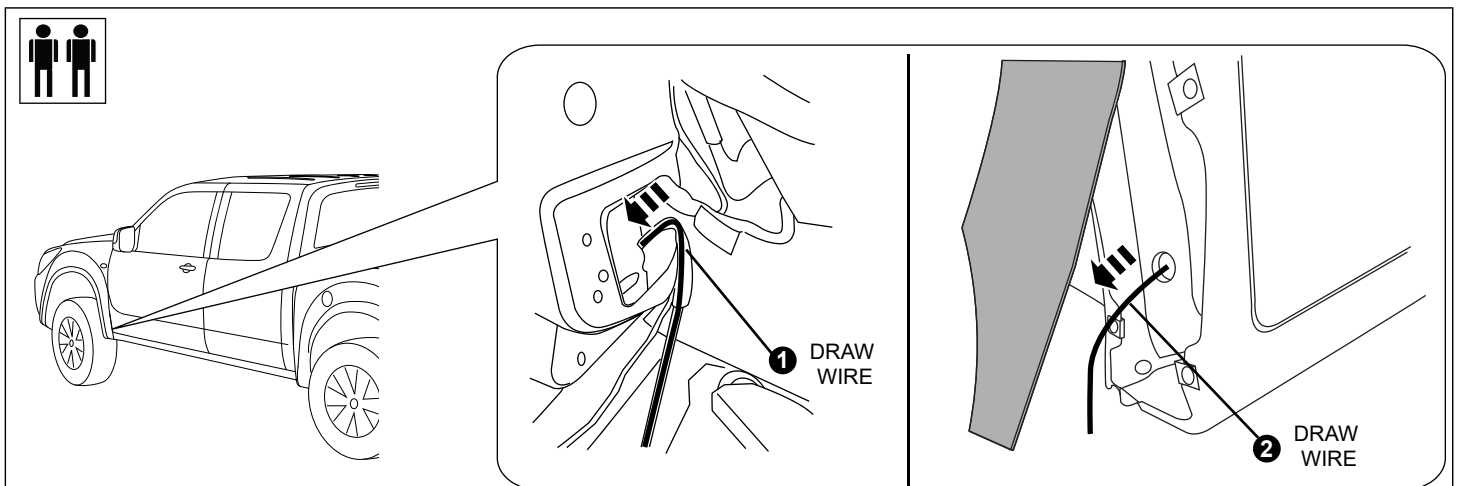

Diagram #:8

8. Feed a Draw Wire from inside of the foot well into the hole till the wire comes out inside the wheel arch as shown. One person feeding the wire from inside of the cab and other person looking for the wire at the grommet hole.

REMOTE LOCKING KIT FOR 1&3 PIECE HARD TONNEAU

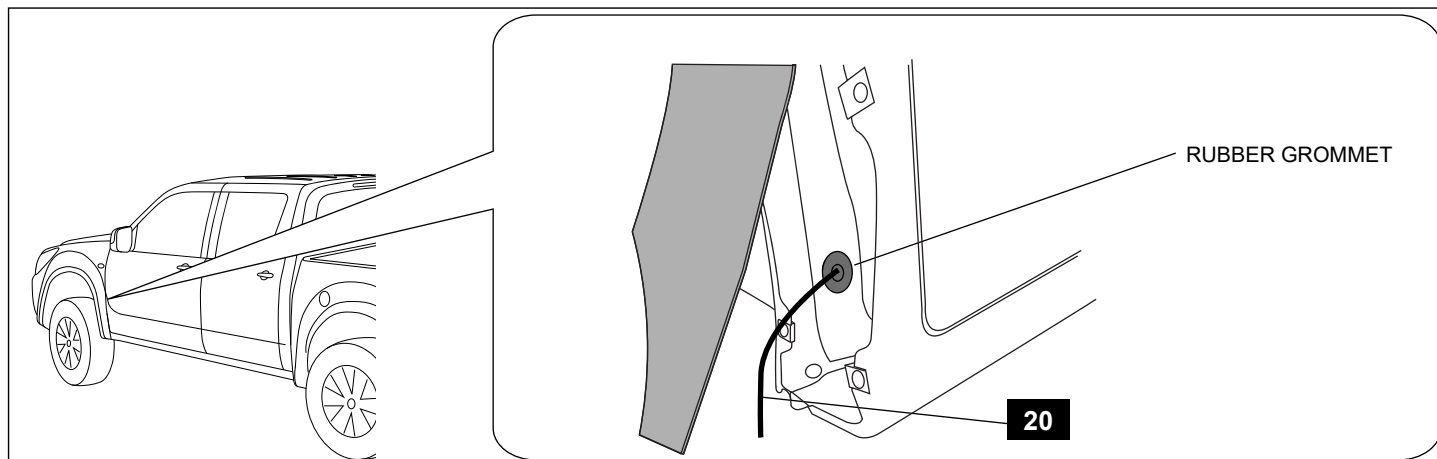

Diagram #:9

9. Attach the thin end of the Vehicle Harness (20) (two wires, orange and brown) to the draw wire and pull into the foot well until the rubber grommet located on the Vehicle Harness is fitted into the hole in the chassis.

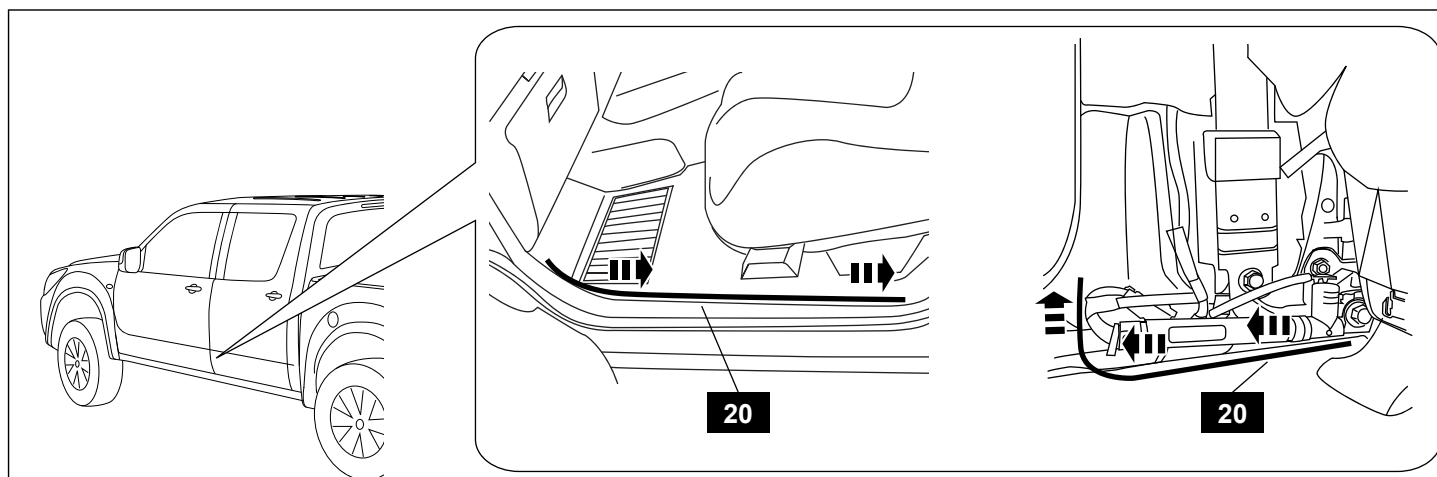

Diagram #:10

10. Run the Vehicle Harness (20) inside the cabin along the door seal to the B-pillar, near the electrical connectors. Make sure routing is underneath seat belt pretensioner and other wiring.

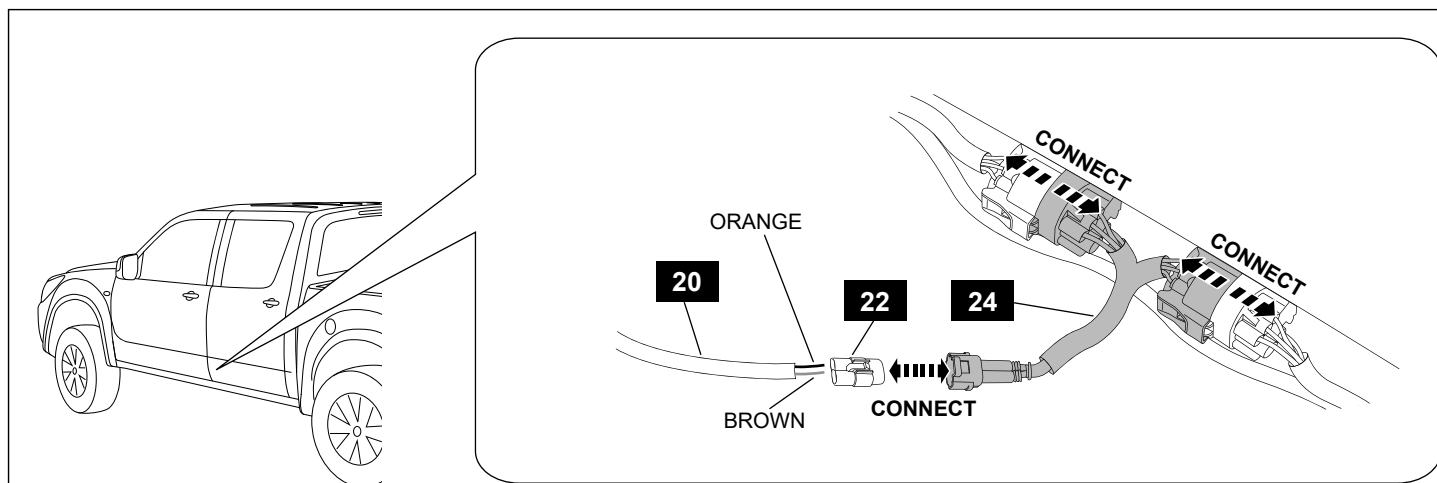

Diagram #:11

11. Disconnect the main wiring near the B-pillar and join using the supplied T-connector (24). Fit the two terminals (orange & brown) on the Vehicle Harness (20) into the Male terminal housing (22). **Note: Make sure the wires are colour matched to the wires in the T-connector (24).**

REMOTE LOCKING KIT FOR 1&3 PIECE HARD TONNEAU

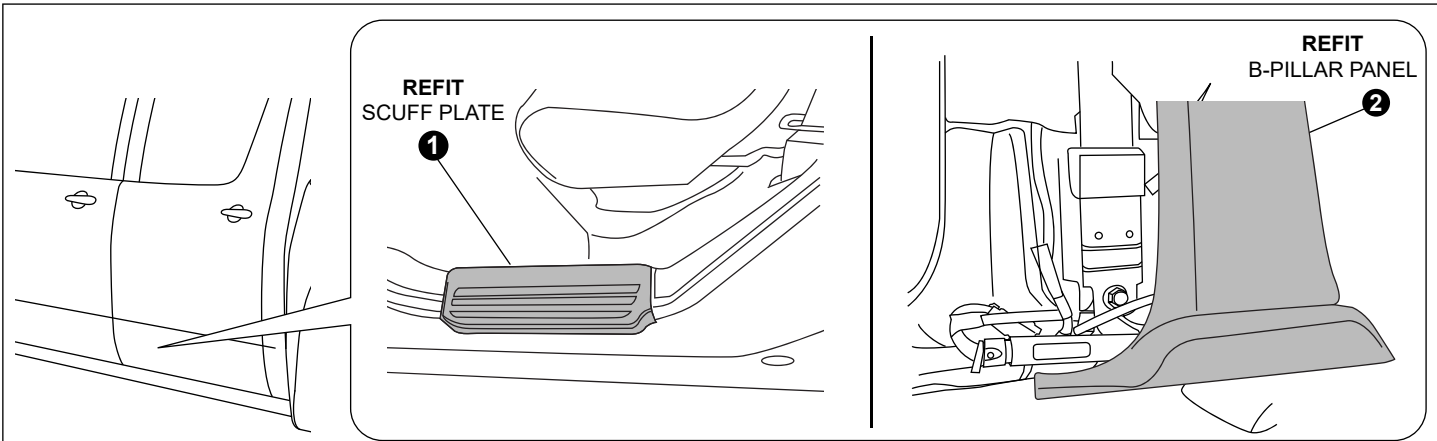

Diagram #:12

12. Position the t-connector and wiring so it will not interfere with other components. Refit the B-pillar panel and rear scuff plate.

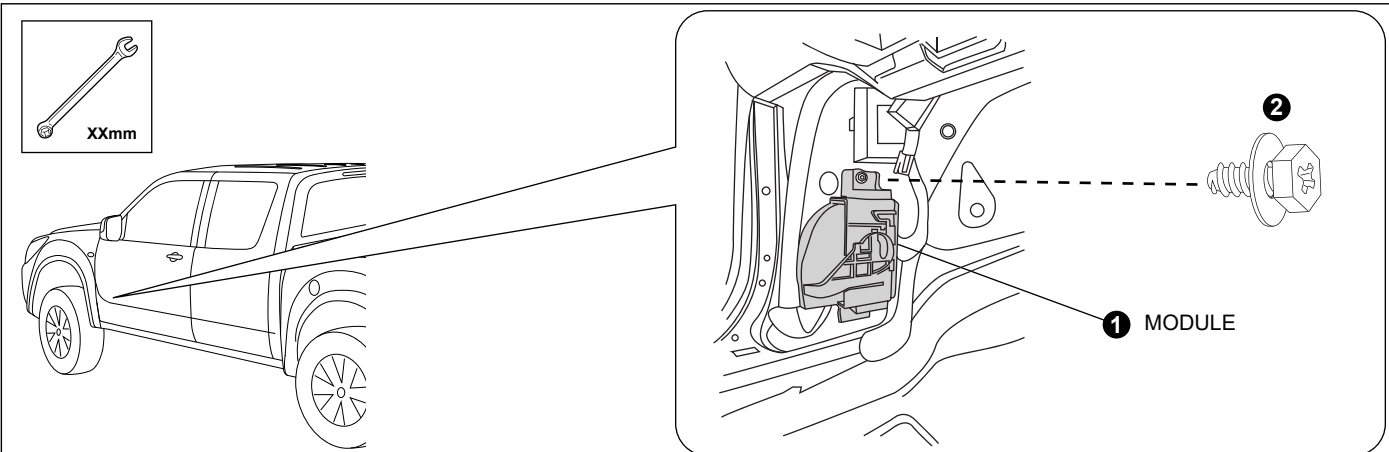

Diagram #:13

13. Inside the passenger footwell, secure the module with the screw.

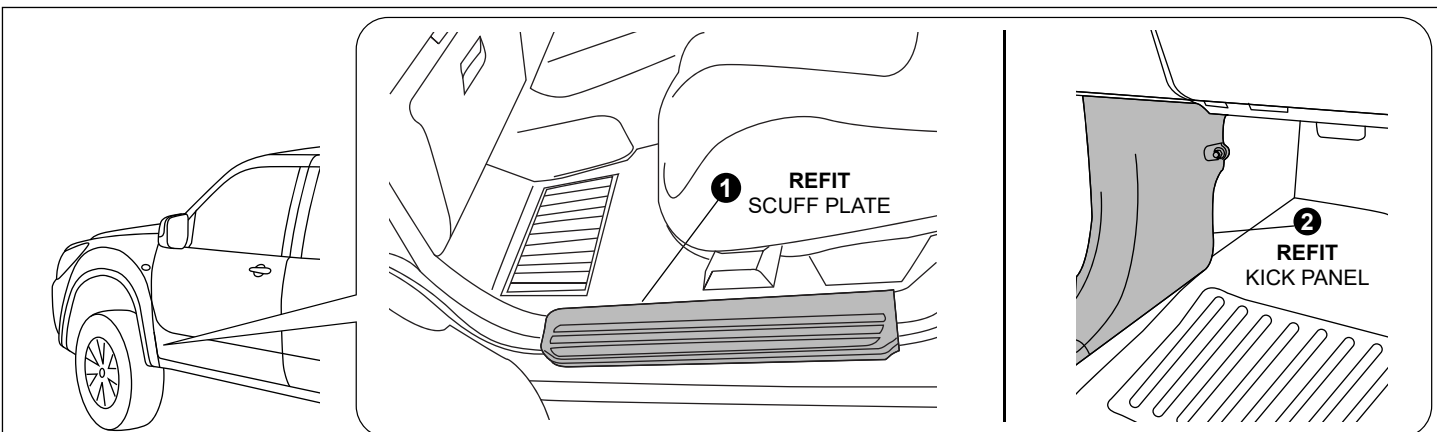

Diagram #:14

14. Refit the kick panel and the scuff plate ensuring the wiring does not get trapped by clip fasteners.

REMOTE LOCKING KIT FOR 1&3 PIECE HARD TONNEAU

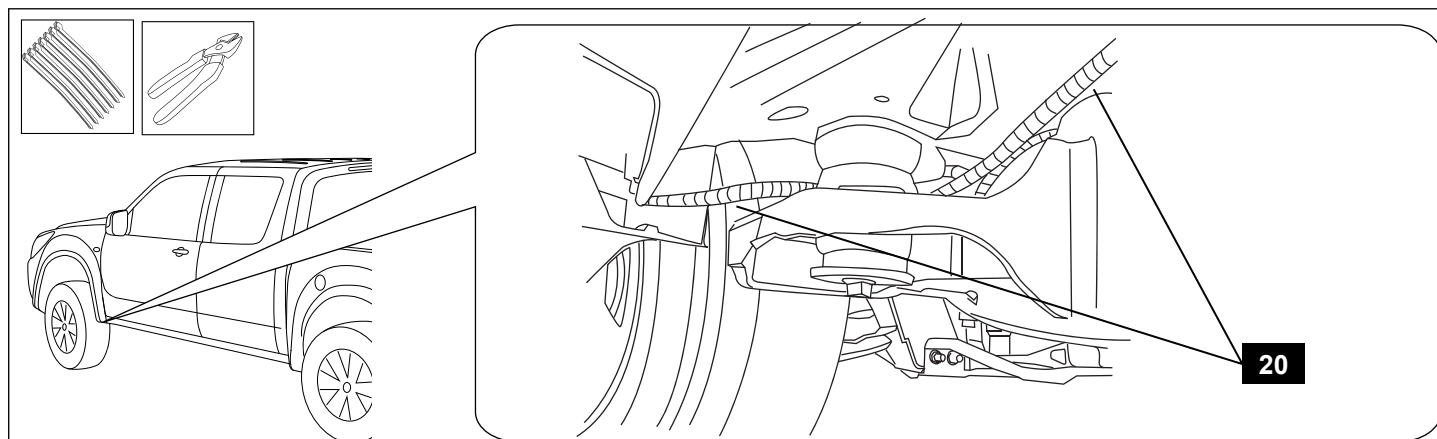

Diagram #15

15. Run the Vehicle Harness from the front wheel arch to the rear along the chassis rail and secure with cable ties. Make sure harness is clear of sharp edges.

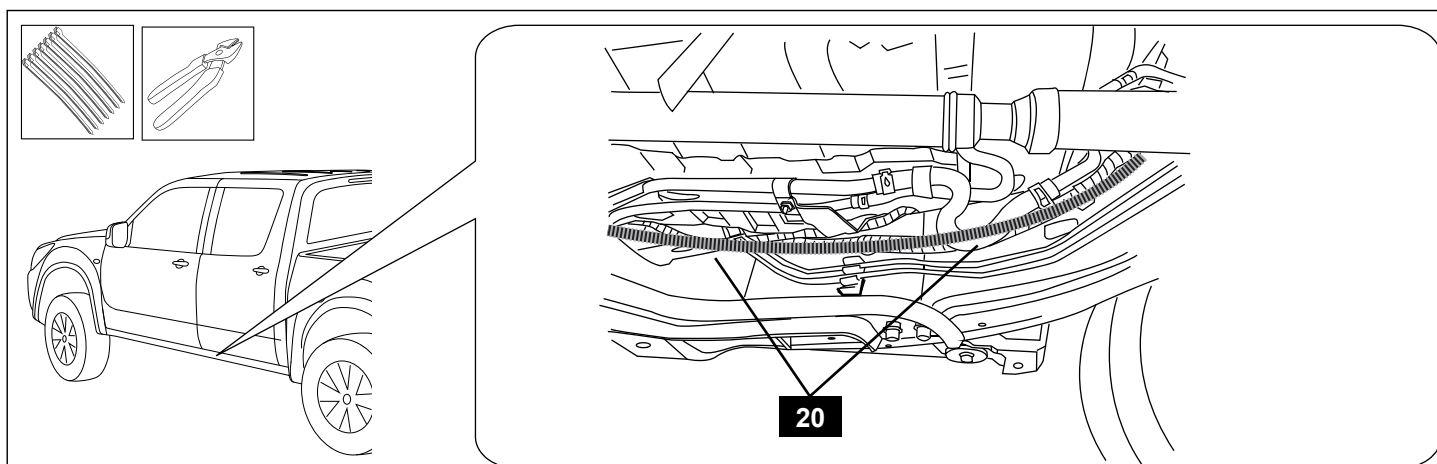

Diagram #16

16. Run the Vehicle Harness to the rear along the chassis rail and secure with cable ties to existing vehicle harness.

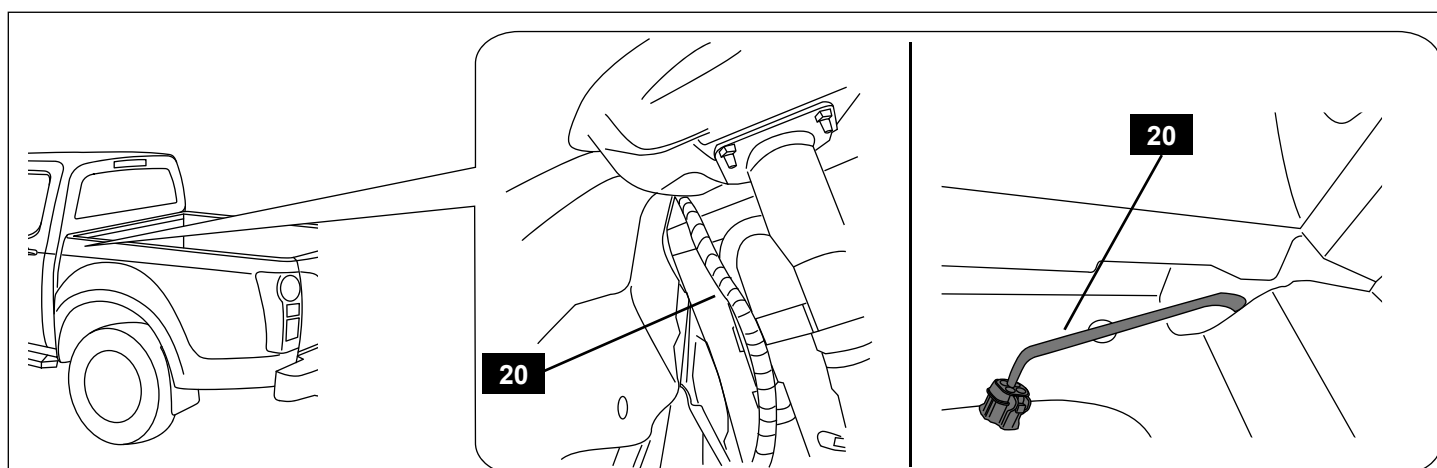

Diagram #17

17. At the t-junction run the grey terminal housing up to the tub along the fuel pipe and out through gap under tub rail flange. Continue with the Vehicle Harness (white terminal housing) along the chassis to the rear section of the tub attaching to existing vehicle harness.

REMOTE LOCKING KIT FOR 1&3 PIECE HARD TONNEAU

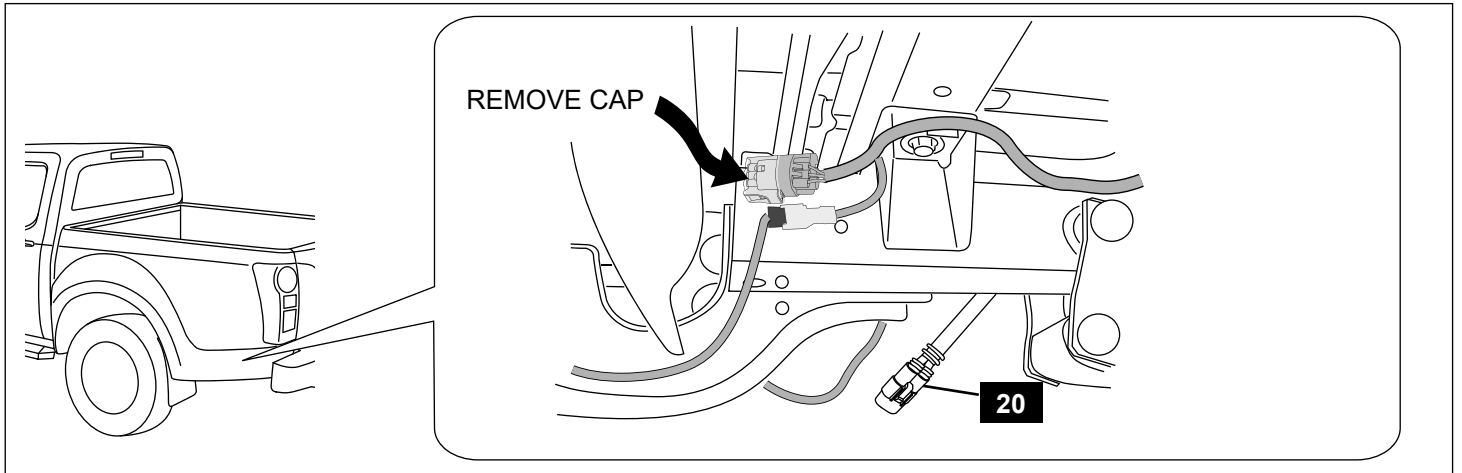

Diagram #18

18. Pull the vehicle harness (20) through under the vehicle. The existing vehicle harness will have an end cap at the back end of the chassis. Remove the cap from the plug.

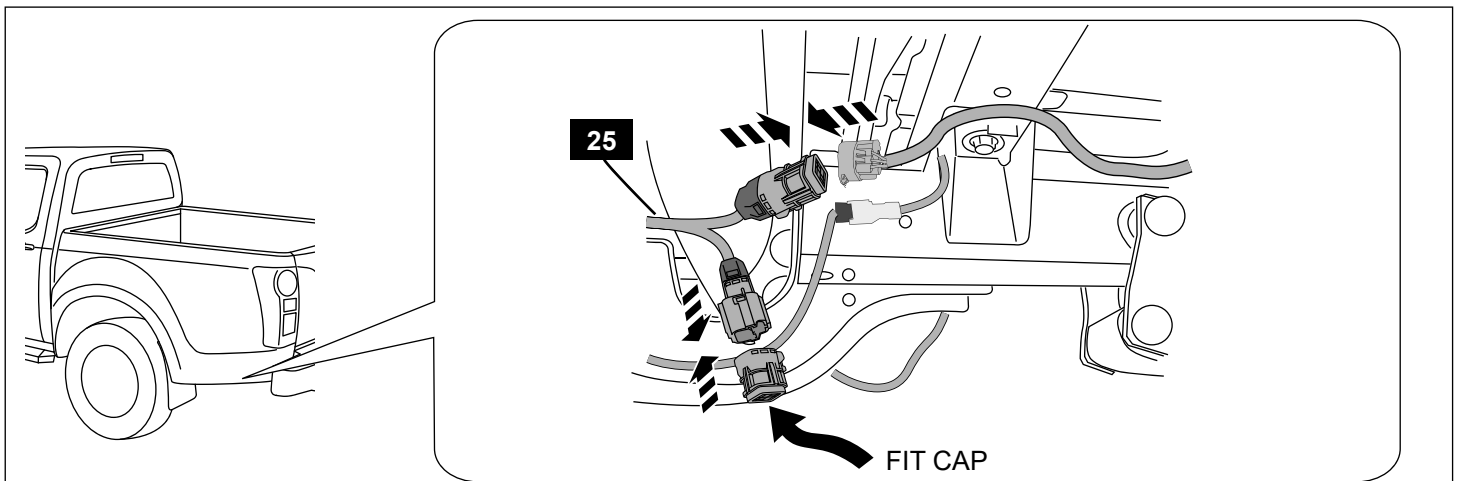

Diagram #19

19. Connect the T-connector (25) into the vehicle harness as shown. Fit the removed cap into the spare wiring plug on the T-connector.

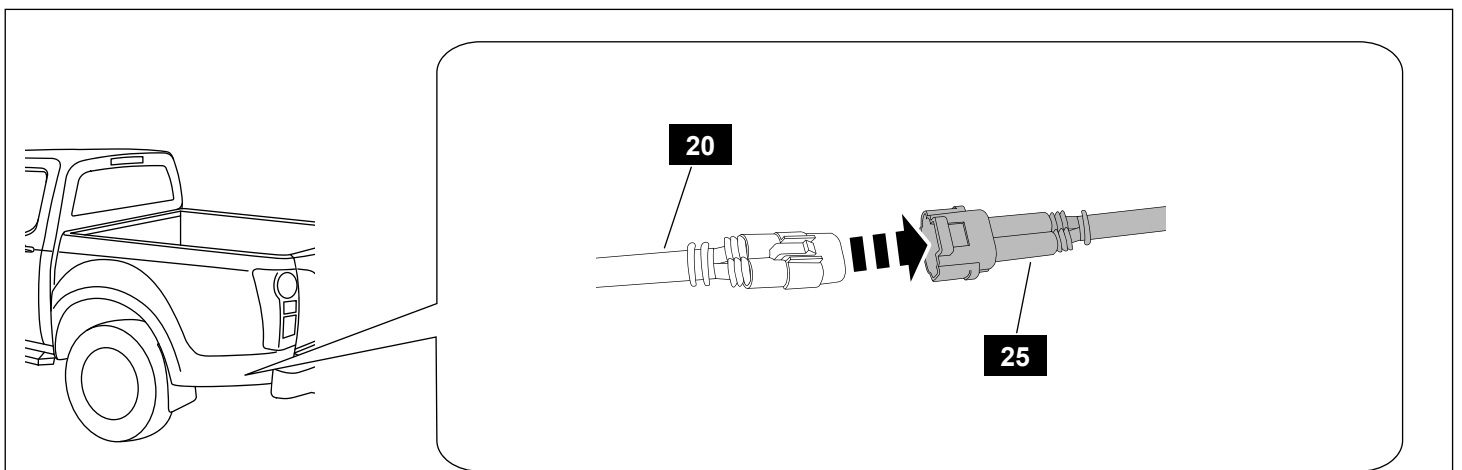

Diagram #20

20. Connect the Vehicle harness connector (20) into the T-connector (25).

REMOTE LOCKING KIT FOR 1&3 PIECE HARD TONNEAU

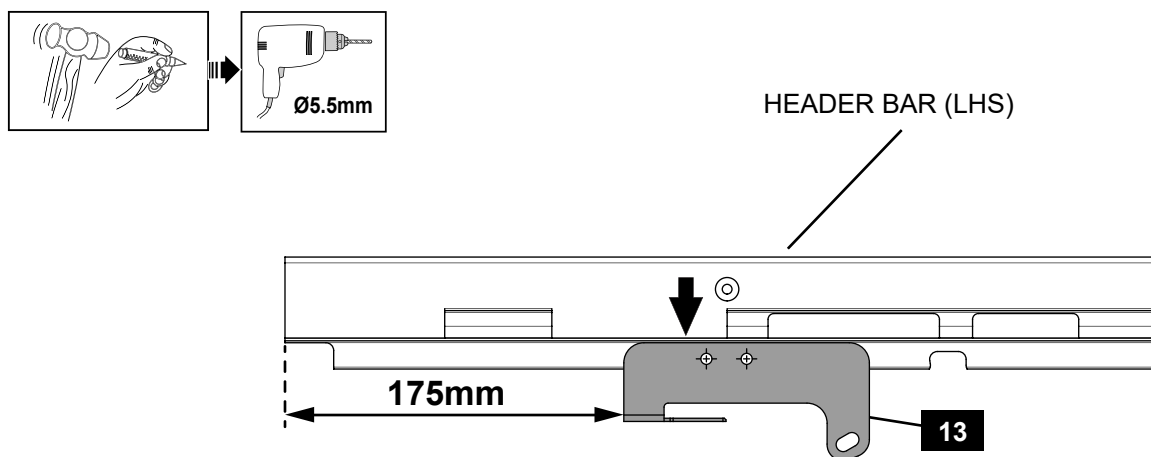

Diagram #:21

21. Position the Harness Bracket on top of the Header Bar LHS hard against the edge and 175mm from the edge. Mark the two holes. Drill with 5.5mm drill bit.

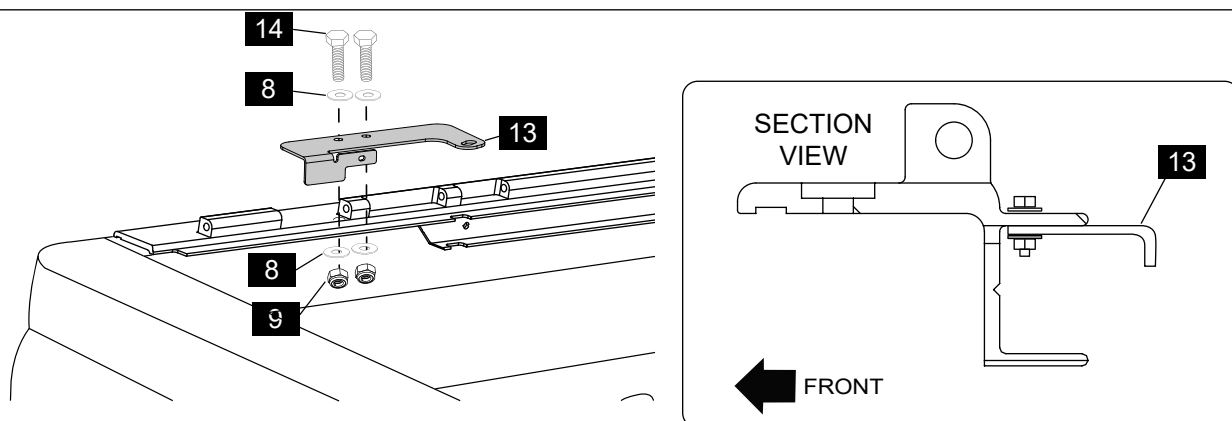

Diagram #:22

22. Secure the Harness Bracket under the Header Bar as shown in the section view, using the M5 screws, washers and nuts.

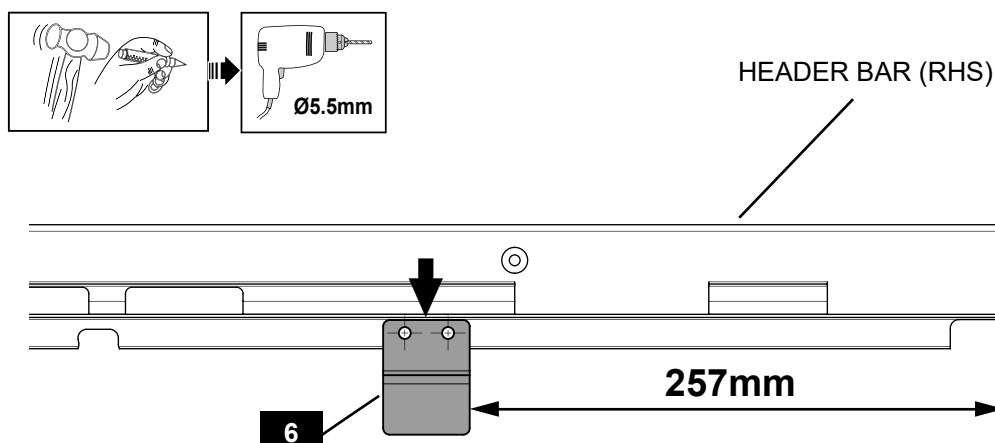

Diagram #:23

23. Position the Pin Switch Plate on top of the Header Bar hard against the edge and 257mm from the RHS edge. Mark the two holes. Drill with 5.5mm drill bit.

REMOTE LOCKING KIT FOR 1&3 PIECE HARD TONNEAU

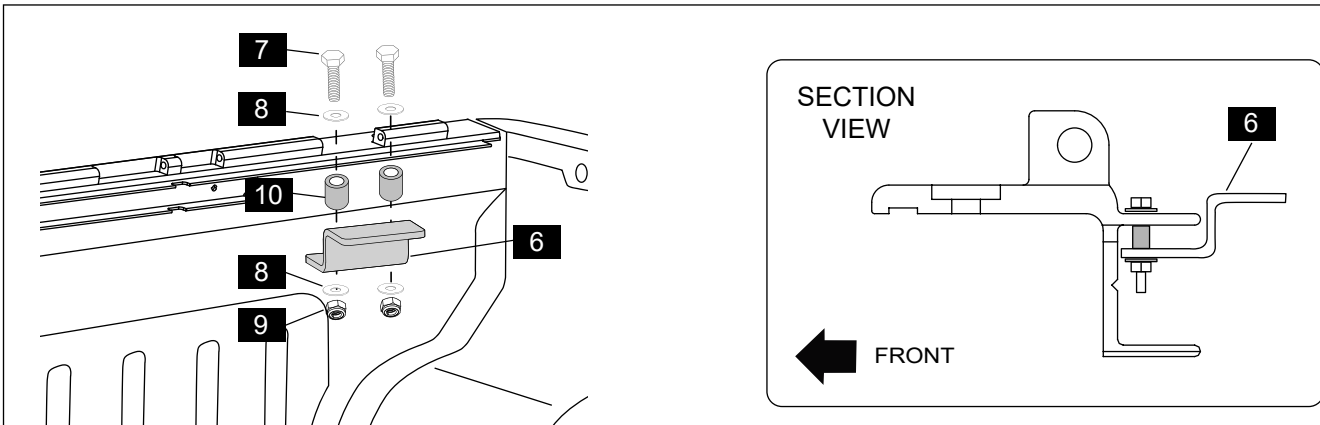

Diagram #24

24. Secure the Pin Switch Plate under the Header Bar as shown in the section view, using the M5 screws, spacers, washers and nuts.

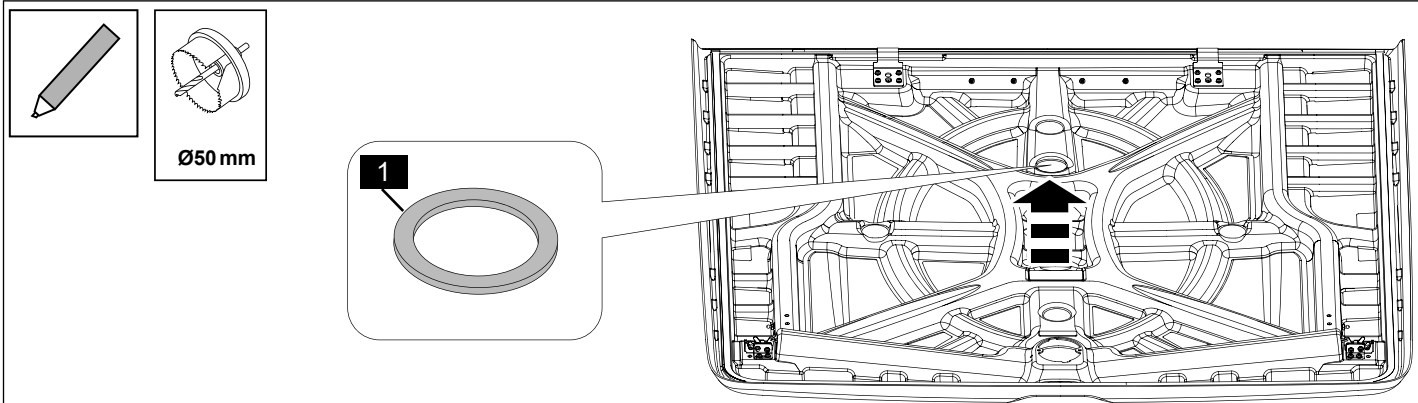

Diagram #25

25. Place the round double sided tape (1) in the central position of the lamp location as shown. Mark the inside diameter using the tape ring centre with a pen and cut a 50mm diameter hole using a holesaw. Debur sharp edges.

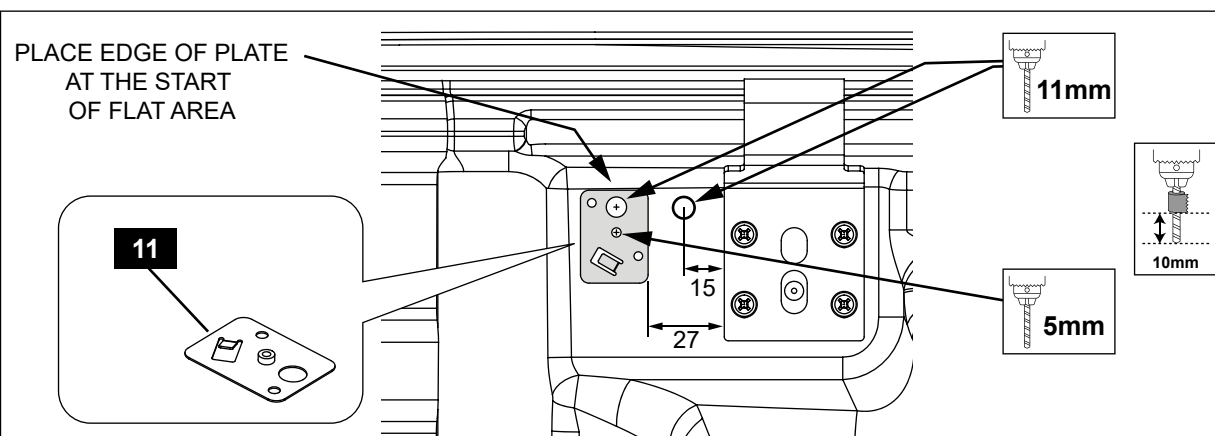

Diagram #26

26. Place the Pin Switch Base plate as shown, next to the hinge on the LHS of the tonneau and mark the two holes using the plate as a guide. Mark a hole between the plate and hinge to use for the Earth wire, drill with 11mm drill. Drill holes using 10mm stop.

REMOTE LOCKING KIT FOR 1&3 PIECE HARD TONNEAU

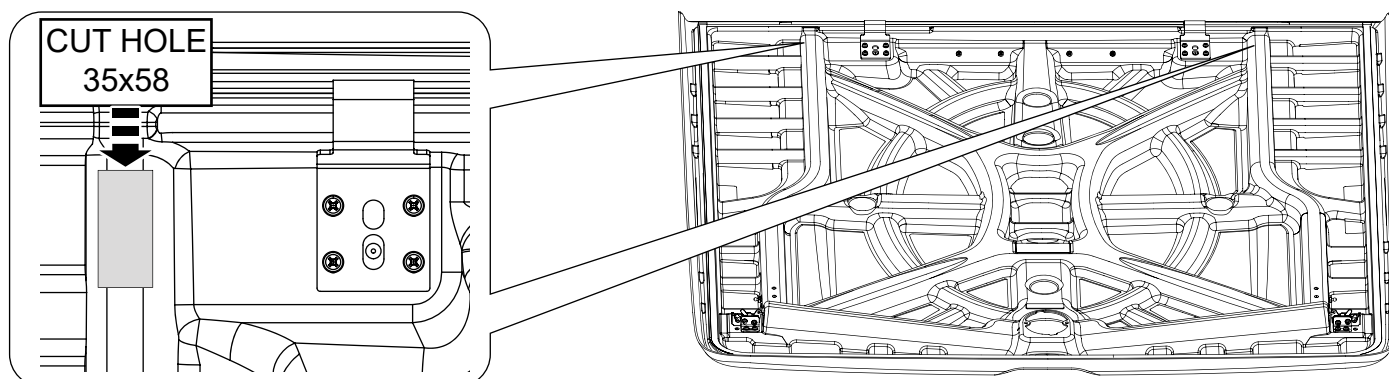

Diagram #27

27. Align hole with position of plate. Mark out hole. Copy position on other side of tonneau. Drill each corner with 12mm drill bit set to 10mm depth. Cut two holes 35x58 using a Dremel as shown. Debur sharp edges.

WIRING DIAGRAM INSIDE THE TONNEAU COVER

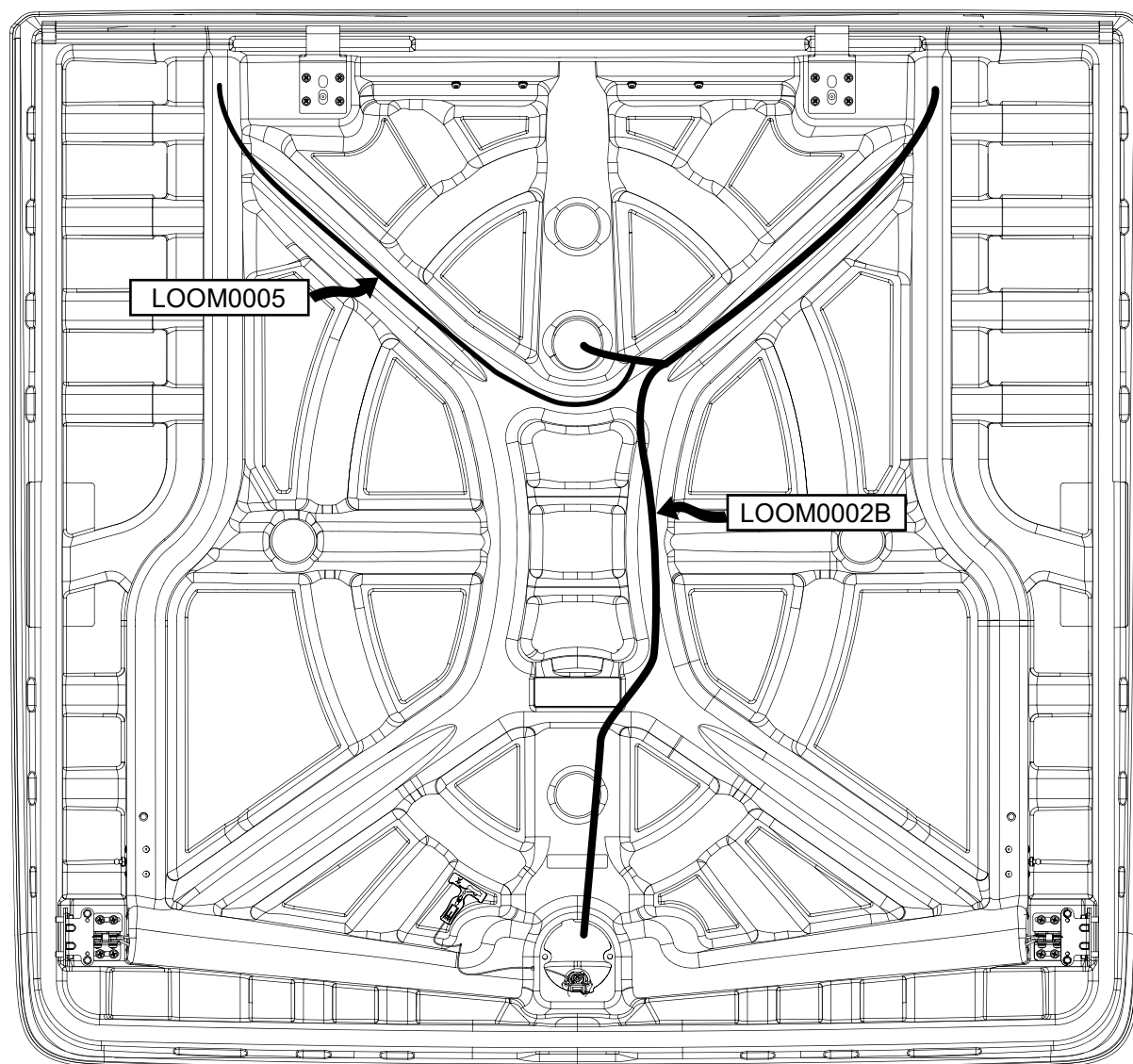

Diagram #28

28. Using a suitable draw wire, feed the LOOM002B from the lock opening to the cut hole for the lamp and the female plug to the cut hole near the RHS (underside view of the tonneau) hinge as shown. Plug the Earth Wire LOOM0005 into the terminal on the LOOM002B near the lamp and feed using draw wire to the cut hole near the Pin Switch on the LHS (underside view of the tonneau) as shown. **Note: Follow detail steps below.**

REMOTE LOCKING KIT FOR 1&3 PIECE HARD TONNEAU

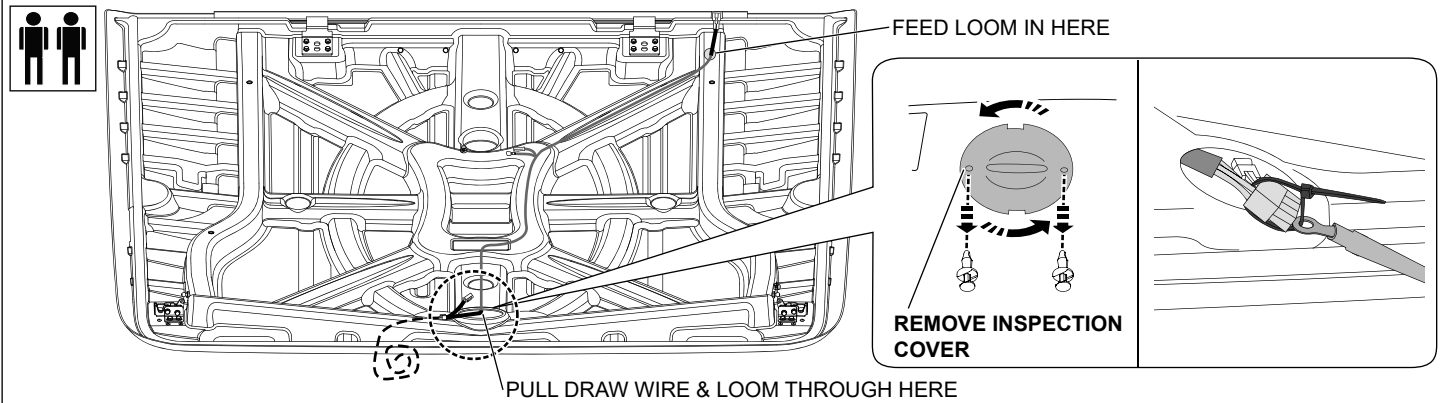

Diagram #29

29. Pull draw wire through the lock cover hole. This requires one person to feed the loom and the other to pull the draw wire.
IMPORTANT: This is to be done carefully and slowly. Leave the draw wire attached to the tonneau loom.

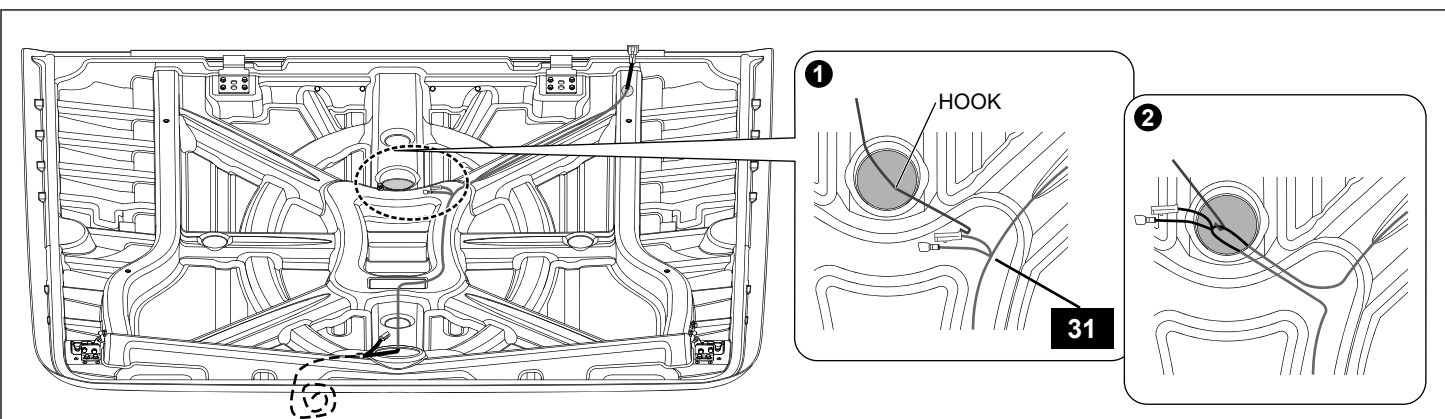

Diagram #30

30. Using a hook locate the harness 31 (LOOM002B) through the light hole & pull out light connector & earth terminal branches. You may need to re-pull the draw wire at the lock cover to access connectors.

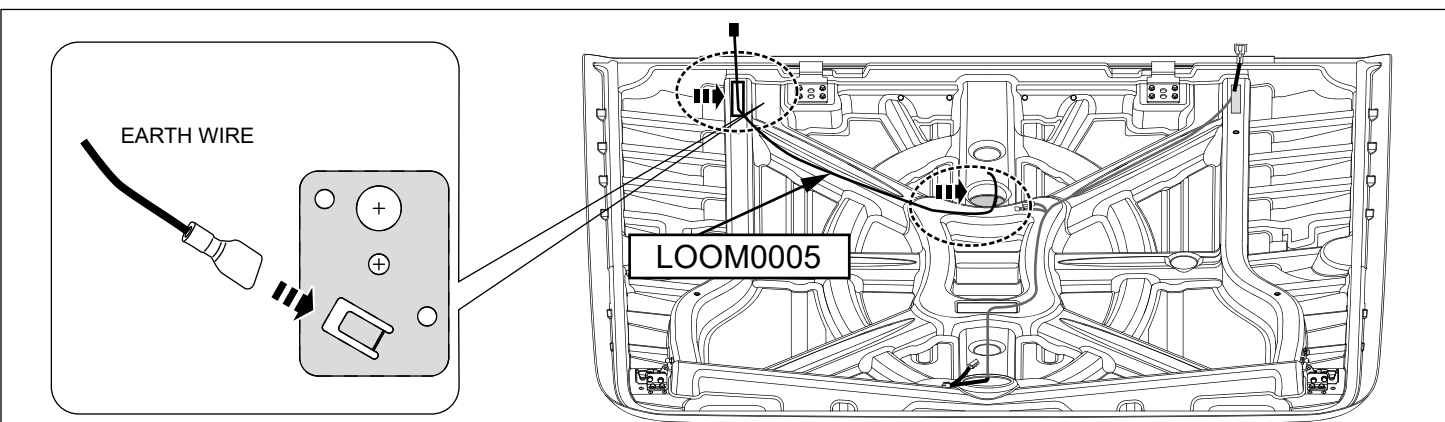

Diagram #31

31. Using a draw wire pull the Earth Wire LOOM005 from the light opening into the cut out near the Pin switch on the LHS. Connect the earth wire to the male terminal under the pin switch plate.

REMOTE LOCKING KIT FOR 1&3 PIECE HARD TONNEAU

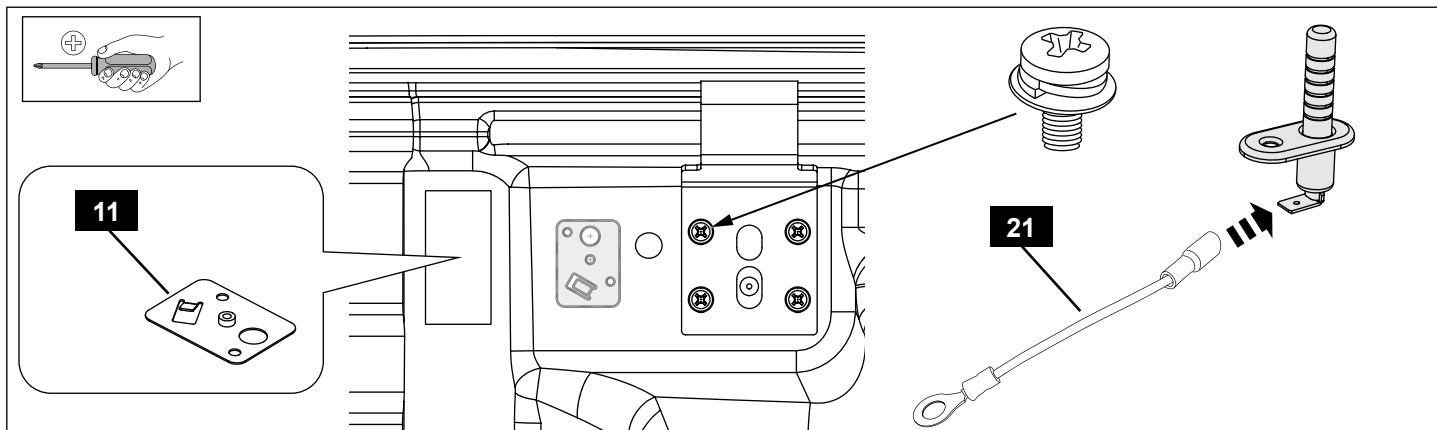

Diagram #32

32. Connect the Earth Wire (21) to the Pin Switch. Place the Pin Switch Base plate (11) inside the tonneau cover using the previously cut hole (35x58). Feed the wire into the hole in the tonneau and plate and out through the hole next to the plate. Remove one screw from the hinge and secure the earth wire under the screw.

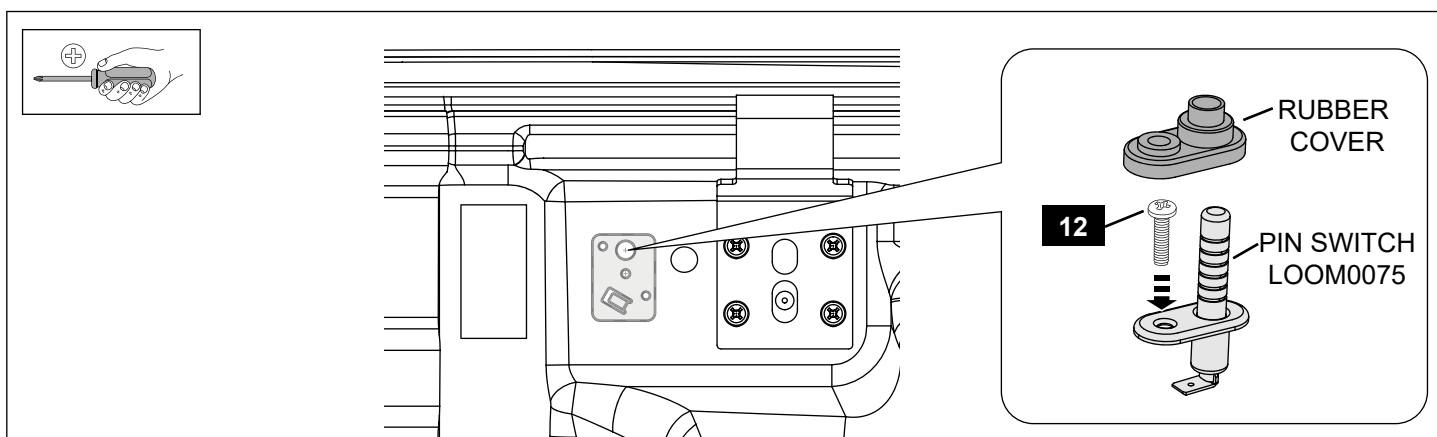

Diagram #33

33. Place the Pin Switch Base plate (11) inside the tonneau cover using the previously cut hole (35x58). Align the plate with the drilled holes and fit the Pin Switch (LOOM0075). Secure with one screw (12). Fit the rubber cover supplied with the Pin Switch.

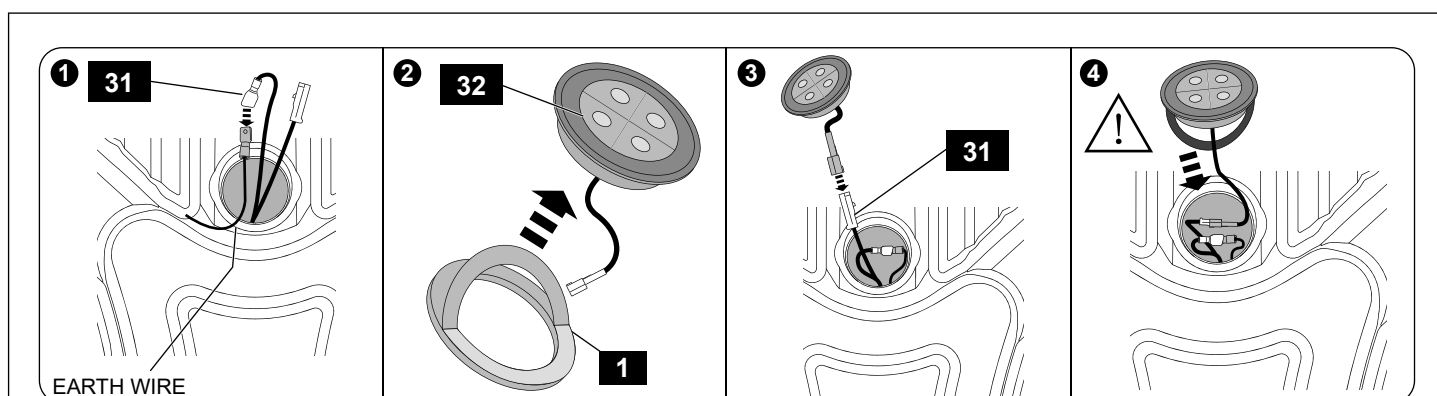
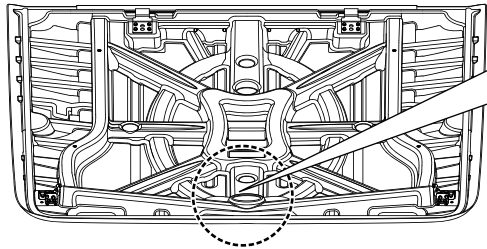

Diagram #34

34. Connect earth terminal LOOM0005 to terminal on tonneau loom.

Remove tape liner from one side of double sided foam tape gasket and fit gasket to the interior light and apply pressure to ensure maximum adhesion. Connect the 2-way male connector from the tonneau wiring loom to the female connector of the interior light. Remove tape liner from double sided foam tape gasket and insert interior light into the tonneau cover and apply pressure to ensure maximum adhesion. **IMPORTANT: Ensure all wiring for the interior light and earth loom is contained inside the tonneau cover before installing the interior light.**

REMOTE LOCKING KIT FOR 1&3 PIECE HARD TONNEAU



1 RELEASE PLASTIC RETAINER CLIPS

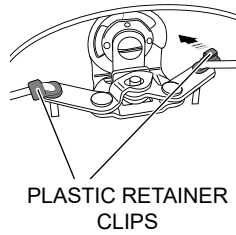

2 UNCLIP PULL RODS FROM PLASTIC RETAINER CLIPS

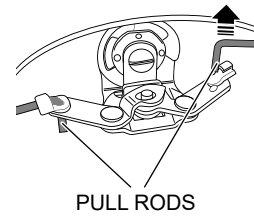

Diagram #35

35. Release plastic retainer clips and unclip pullrods as shown.

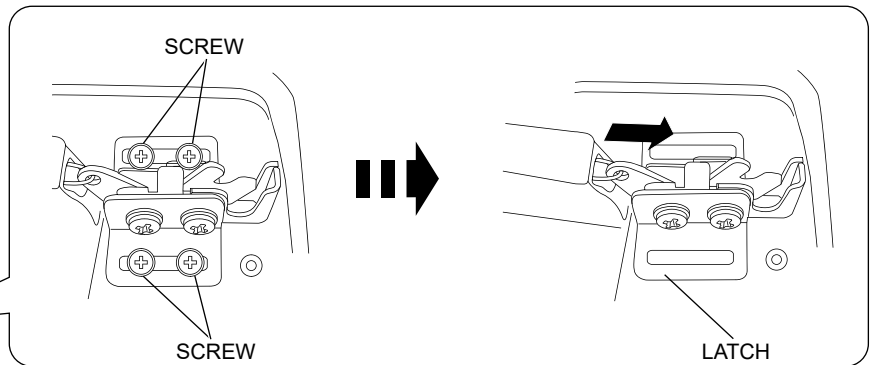
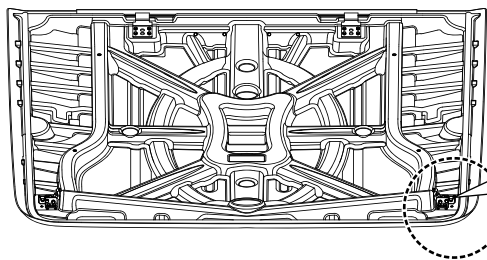
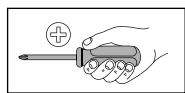

Diagram #36

36. **Note:** Mark the LHS latch position and screw locations on the tonneau cover to use this location for the latch reinstall. Remove the 4 screws holding the LHS rotary latch. Remove the latch and pullrod assembly from the tonneau cover.

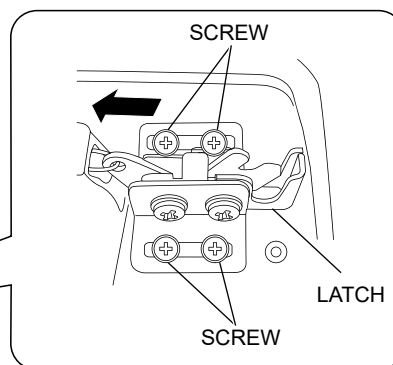
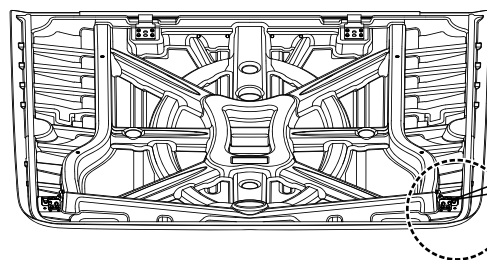
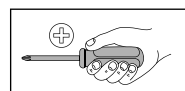

Diagram #37

37. Slide the pull rod assembly into the tonneau. Attach the latch to the tonneau using four screws.

REMOTE LOCKING KIT FOR 1&3 PIECE HARD TONNEAU

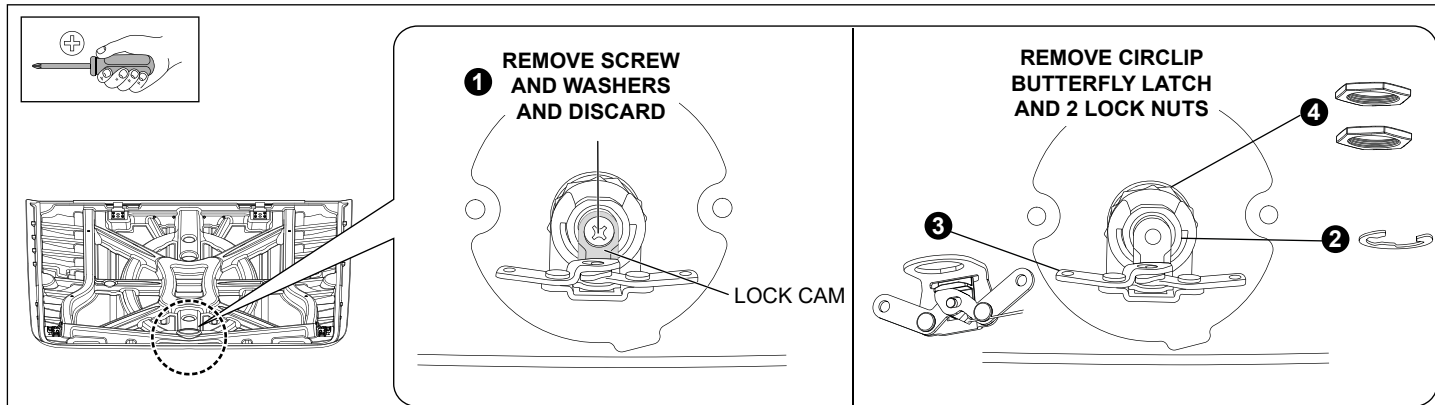

Diagram #38

38. Remove and discard the screw and washers holding the lock cam in place as shown. Remove the circlip and remove the butterfly latch assembly. Unscrew the two lock nuts holding the lock barrel assembly.
Note: Keep one large nut as you will need one for reassembly.

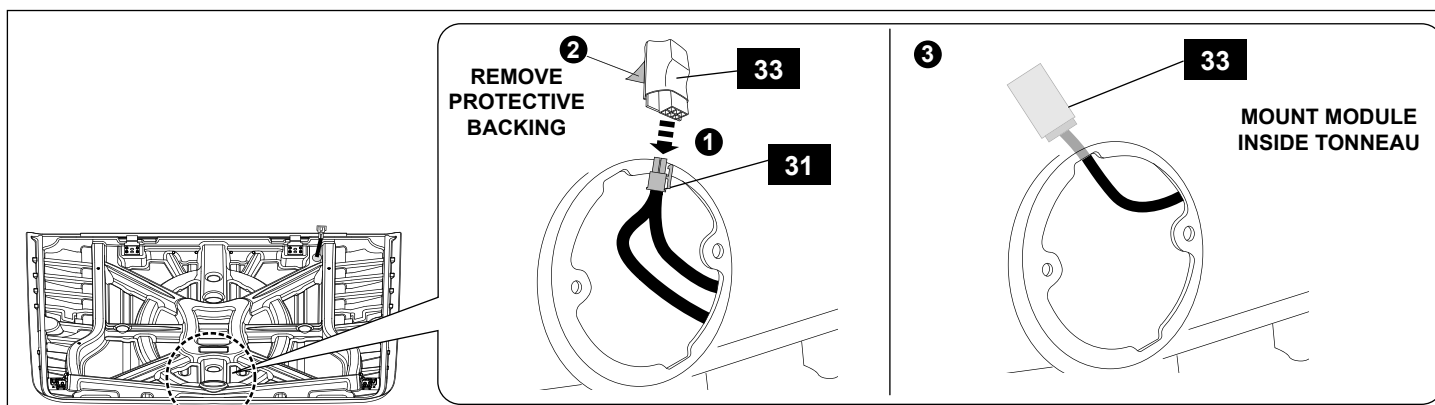

Diagram #39

39. Connect the 6-way male connector on the tonneau wiring loom to the module. Remove the protective backing from the module and adhere it to the inside of the tonneau cover as shown.

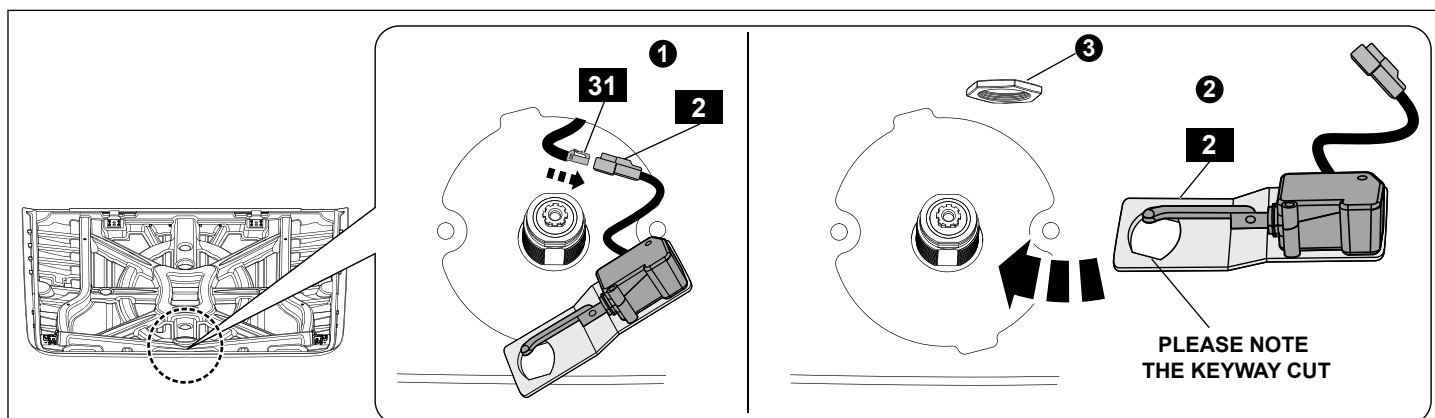

Diagram #40

40. Fit the remote bracket over the lock barrel assembly and secure with one lock nut. **Note: The remote lock bracket has a keyway cut into it on angle for the lock barrel. Ensure that the bracket sits at this angle in relation to the lock barrel.**

REMOTE LOCKING KIT FOR 1&3 PIECE HARD TONNEAU

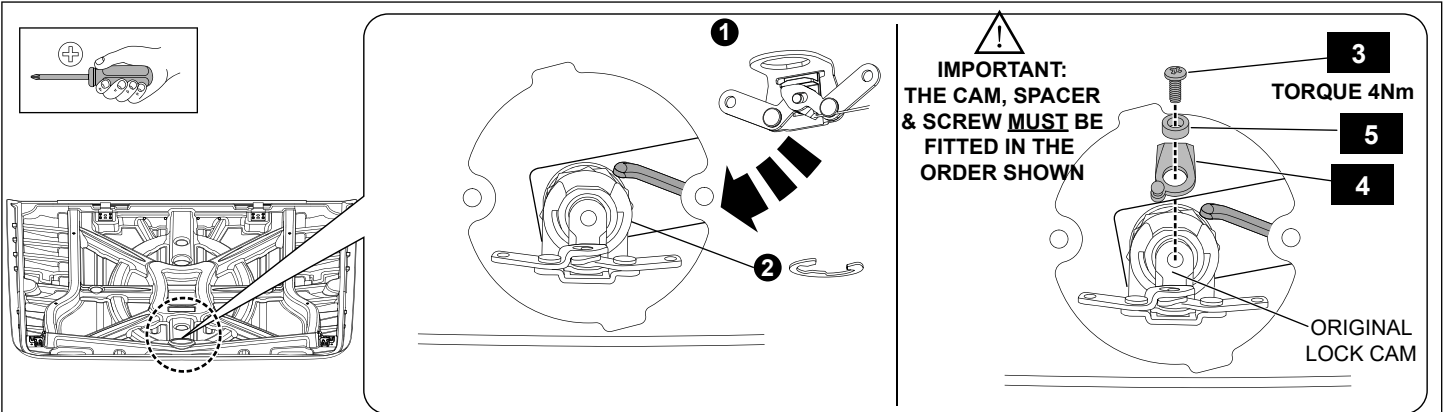

Diagram #:41

41. Refit the butterfly latch and secure with the circlip. Fit the ball stud lock cam and plastic spacer, to the locking mechanism and secure with the Phillips head screw provided. **Tighten to Torque 4Nm.**

IMPORTANT: Ensure both lock cams are aligned with each-other and with the locking mechanism as shown.

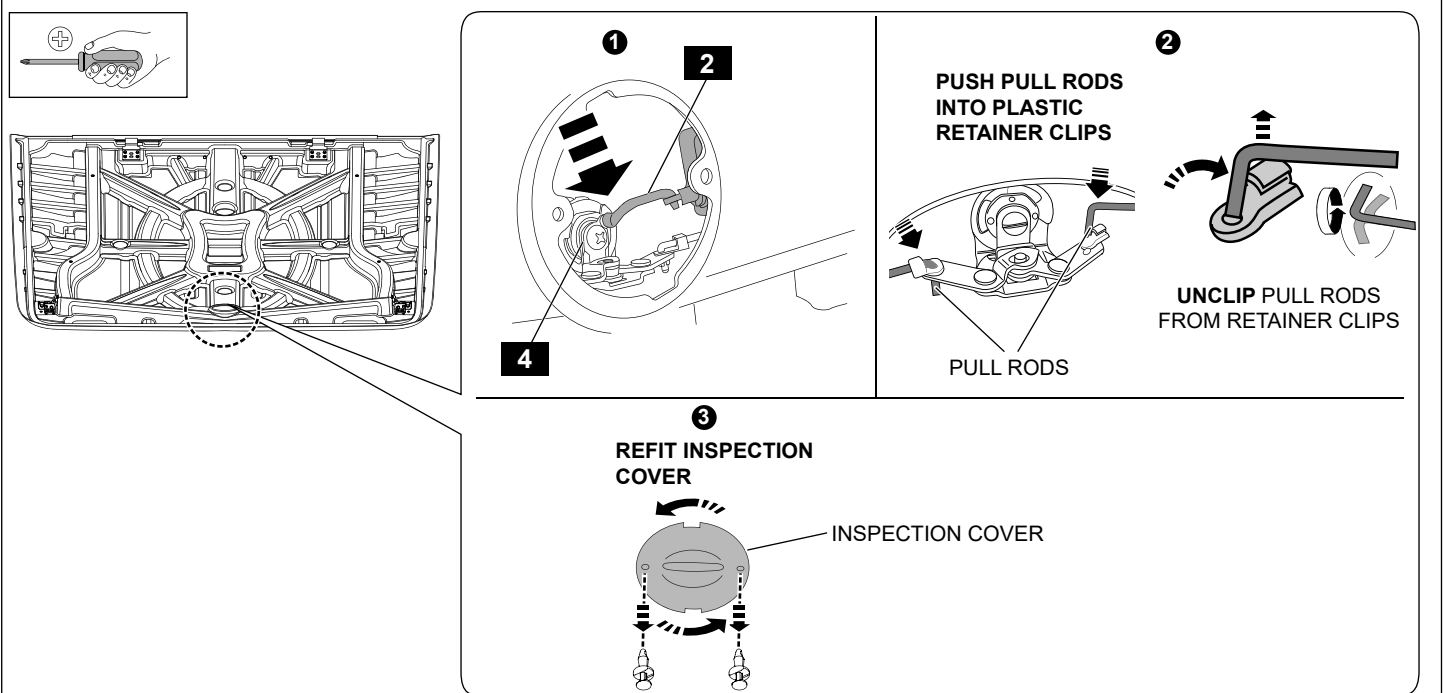

Diagram #:42

42. Clip the pull rod from the actuator onto the lock cam ball stud as shown. Adjust pull rods so that they clip back into the retainer clips correctly. Do this by rotating them clockwise to shorten them or anti-clockwise to lengthen them (via internal turn buckle). Clip pullrods and retainer clips back into position. Push clip on actuator connector through scrivet hole forward of inspection cover hole. Test lock by pressing the button on top of Tonneau Cover. If latch mechanism **DOES NOT** release, return to **Step 2** and shorten the pullrods. Unclip the latch pull rods from the locking mechanism. Wind the pull rods in a clockwise direction to shorten and anti-clockwise to lengthen. If it **DOES** release, replace inspection cover.

NOTE: Ensure the joining element and pullrod clip are attached to the actuator. If they are not, clip them into place as shown. Also ensure all wiring is moved out of the way and can not interfere with the locking mechanism.

REMOTE LOCKING KIT FOR 1&3 PIECE HARD TONNEAU

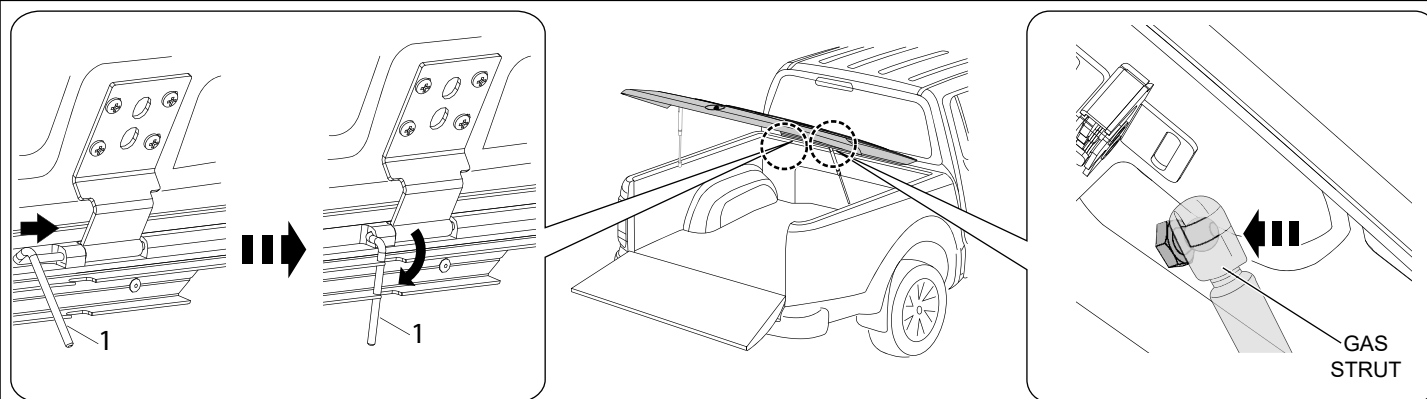

Diagram #43

43. Refit the tonneau cover and secure with hinge pins. Attach gas struts (already attached to the vehicle) to the tonneau cover by clipping into place as shown.

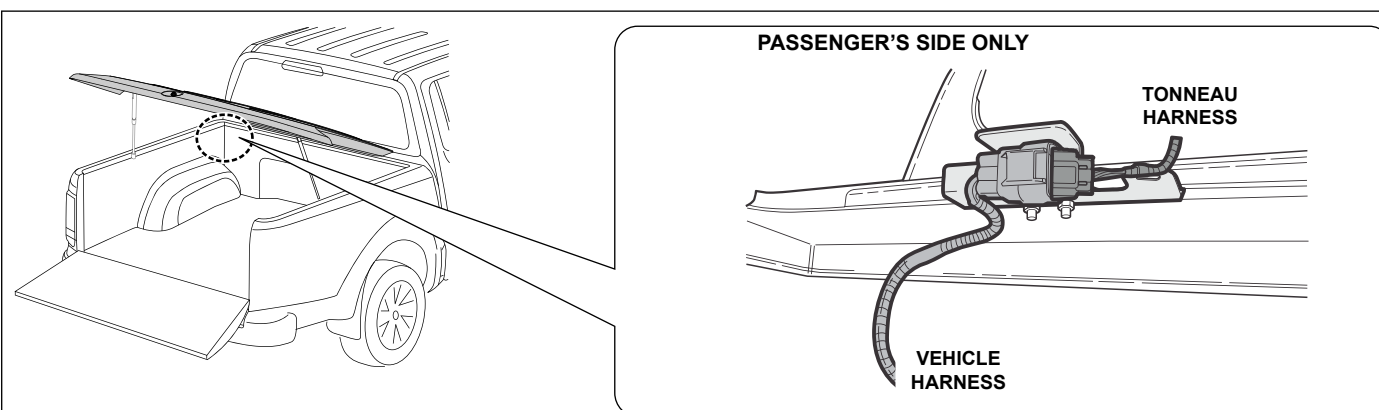

Diagram #44

44. Connect the vehicle wiring loom to the tonneau wiring loom via the connectors located at the front of the tub as shown. Attach connector to bracket 13 (refer diagram #22) and cable tie cable through hole in bracket 13.

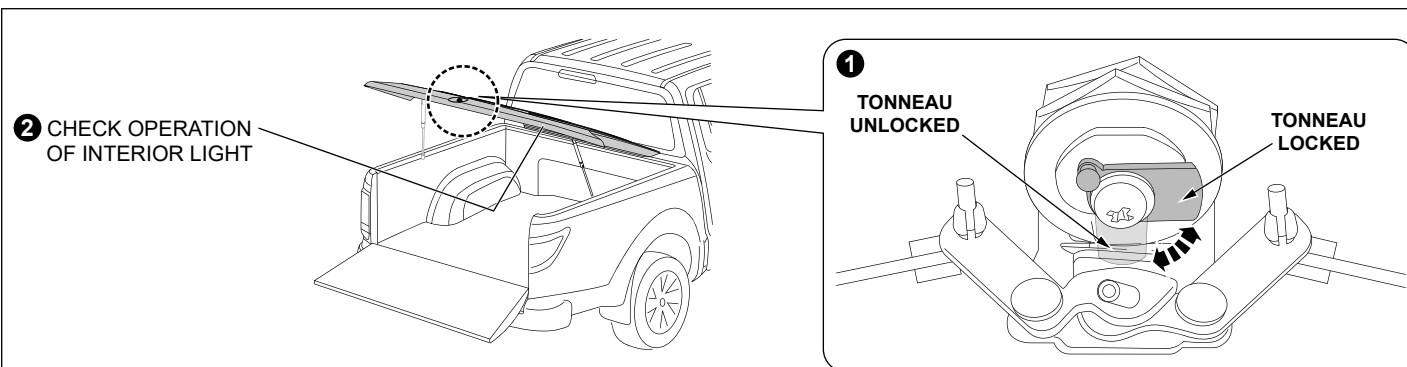

Diagram #45

45. Manually lock & unlock tonneau using the tonneau key. The key supplied with the hard tonneau cover will over-ride the remote actuator of the lock. In standard conditions, ensure the lock barrel is rotated by the tonneau key to the locked position. The unlocking and locking of the cover will be controlled by pushing the vehicles unlock button on the key fob (that moves a secondary cam). Check operation of central unlocking mechanism by pressing lock and unlock on vehicle's key. Review operation through inspection hole. Test operation of lock mechanism by pressing tonneau's push button after you have pressed lock on vehicle's key, and then again after you have pressed unlock on vehicle's key. Finally, replace the inspection cover.

NOTE: If the tonneau key is used to unlock the cover, ensure to relock the cover using the same key.

Open and close tonneau with tailgate open to check if interior light is functioning correctly. Ensure the light turns on when tonneau is open and turns off when tonneau is closed.

If actuator unlocks when lock button is pressed and vice versa then the wires have been connected the wrong way round (diagram#11). If light does not work check earth connector.