

MITSUBISHI TRITON MQ 2015 onwards 1 & 3 PIECE TONNEAU REMOTE LOCKING KIT INSTALLATION INSTRUCTIONS

**Care Instructions:**

Clean Tonneau Cover with a mild detergent and water solution.

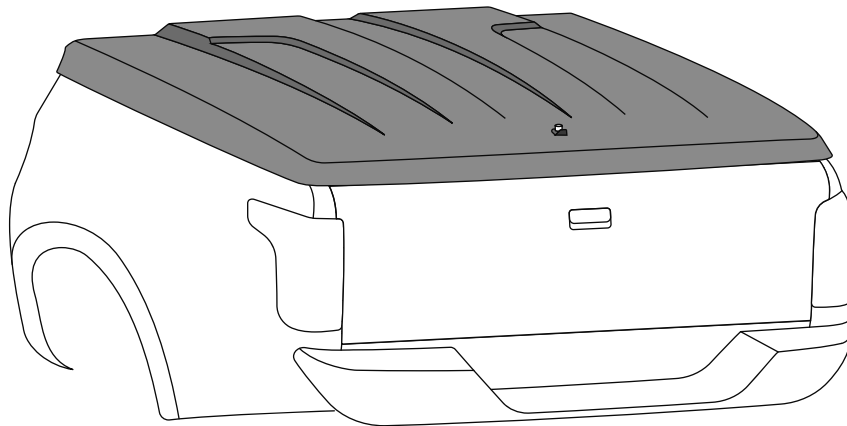

Do not use abrasive cleaners or solvents.



Place these instructions in vehicle's glove box after installation is complete

PLEASE REFER TO PAGE 2, OF THIS INSTRUCTION FOR A LIST OF PARTS AND QUANTITIES.

IMPORTANT:

- Read Instructions carefully before installation.
- It is strongly recommended that installation is conducted by an authorised dealer.
- This product must be installed exactly as specified in these instructions.
Failure to do so may result in improper fit and/or retention..
- Recommend installation by 2 people.
- Do not cycle remote key fob continuously or the actuator for operation of the remote locking system will burn out.

Maintenance:

- The locking mechanisms & Latches only require occasional lubrication with Graphite Powder.
- DO NOT use any other lubricants or oils. Using alternative products will VOID Warranty.
- All installation hardware and fasteners must be checked regularly for tightness.

TOOLS REQUIRED:

- | | |
|-----------------------------|-----------------------------|
| • Torque Wrench | • Phillips Head Screwdriver |
| • Sockets & Driver | • Flat Blade Screwdriver |
| • Spanners | • Draw Wire |
| • Drill and 5.5mm drill bit | • Wire Hook |

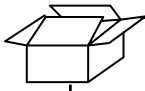

PARTS IN MAIN CARTON

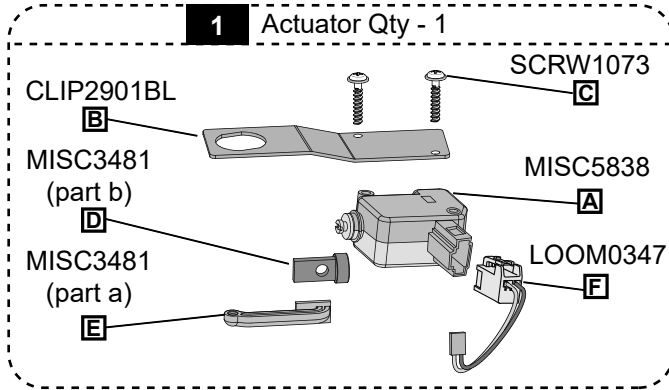

2

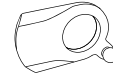

Lock Cam with
Ball Stud
(CLIP2419-3)
Qty - 1

3



Spacer
(FAST0466)
Qty - 1

4



Phillips Head
Screw
(SCRW0648-2)
Qty - 1

5

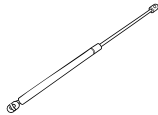

Gas Strut
with Switch
(STRT0042)
Qty - 1

6

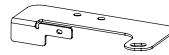

Harness Bracket
(CLIP3304PC)
Qty - 1

7



M5x16 Phillips
Head Screw
(SCRW0450)
Qty - 2

8



M5 Nylock Nut
(NUTS0171)
Qty - 2

9



M5 Flat Washer
(WASH0190)
Qty - 4

10



Light Gasket
(TAPE614)
Qty - 1

11



Earth Kit
(LOOM0156)
Qty - 1

12



Vehicle
Wiring Kit
(LOOM0152)
Qty - 1

13



Tonneau
Wiring Kit
(LOOM0002B)
Qty - 1

14



Fitting
Instruction
(TC0415b)
Qty - 1

PARTS IN VEHICLE WIRING KIT - (LOOM0152)

15



Vehicle Wiring
Harness
Qty - 1

16

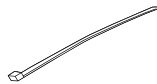

Cable Tie
200mm
Qty - 2

17

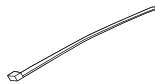

Cable Tie
600mm
Qty - 3

PARTS IN EARTH KIT - (LOOM0156)

18

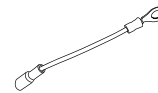

Gas Strut
Earth Wire
(LOOM0156)
Qty - 1

19



External Star
Washer
Qty - 1

PARTS IN TONNEAU WIRING KIT - (LOOM0002B)

20



Tonneau Wiring
Harness
Qty - 1

21



Interior Light
Qty - 1

22

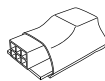

Module
Qty - 1



REMOTE LOCKING KIT - ACTUATOR ASSEMBLY

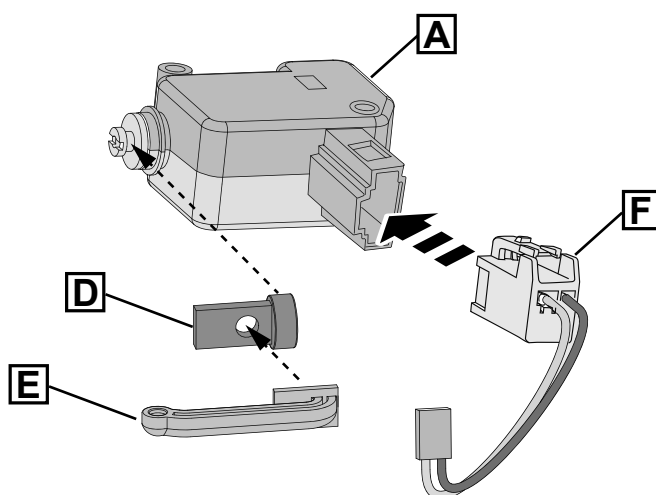
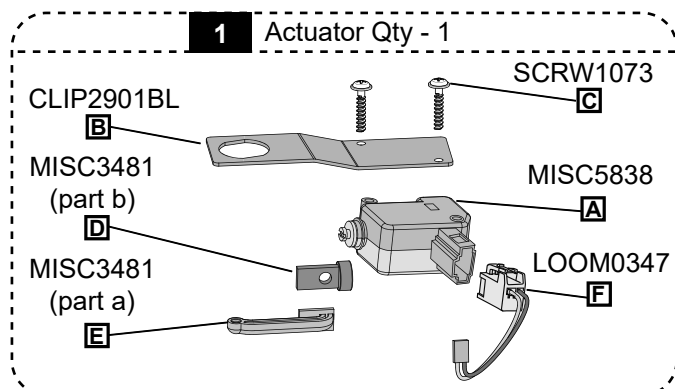

STEP A Connect the Pull Rod (E) to the Pull Rod Joiner (D) and slide into the end of the actuator (A) as shown. Connect the Loom (F) to the Actuator (A).

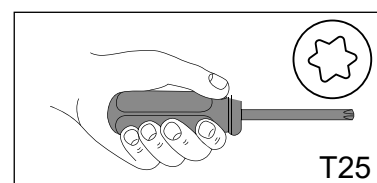
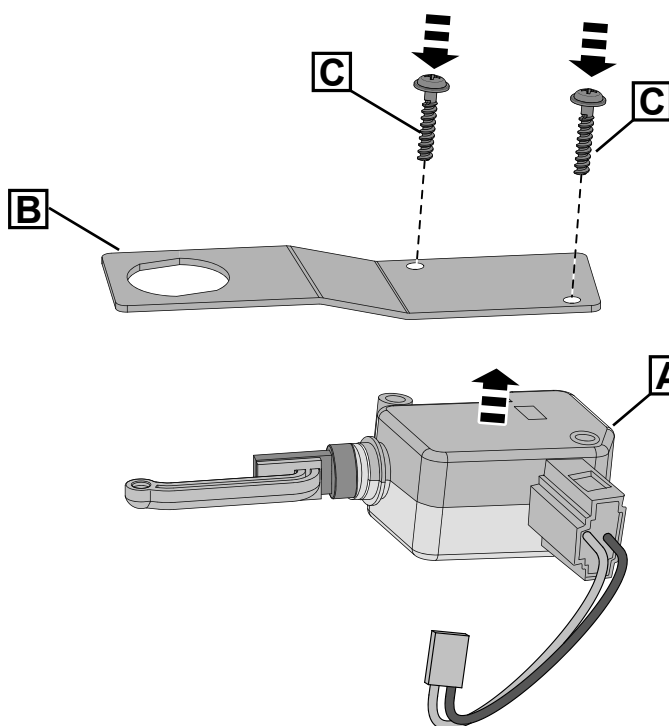

STEP B Secure the actuator (A) to the bracket (B) with 2x self tapping screws (C).
NOTE: Hand torque screws (C) until fully seated (tight).

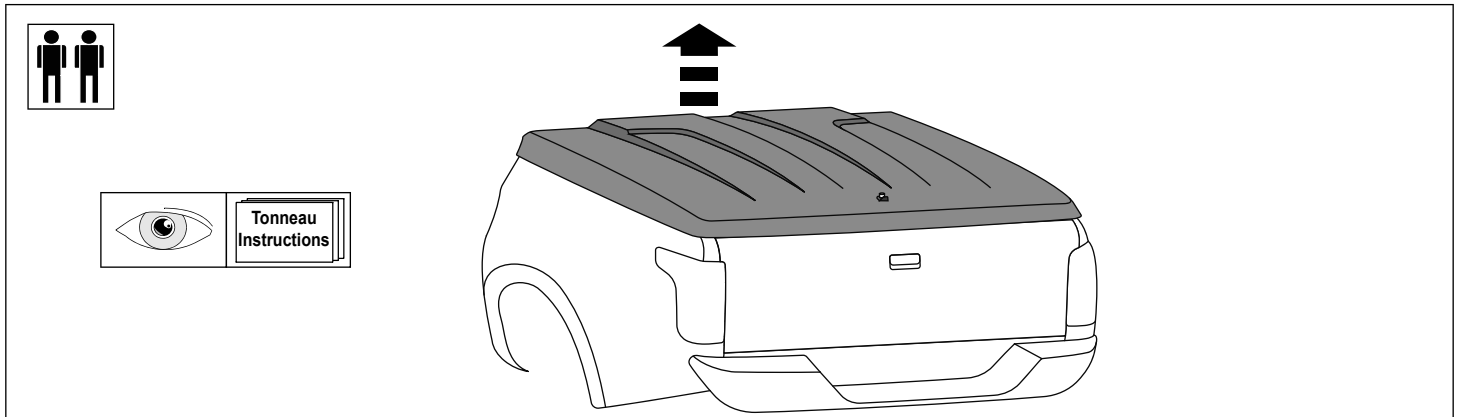

Diagram 1

1. Refer to the tonneau installation instructions, to remove the tonneau cover. Lay the tonneau cover upside down on a sheet or mat to prevent scratching.

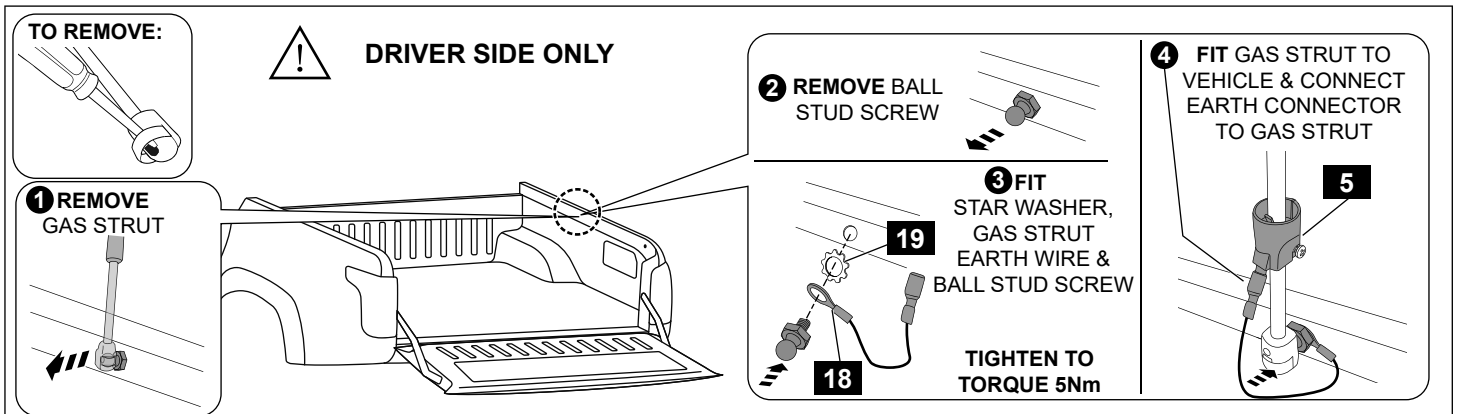

Diagram 2

2. FOR THE DRIVER SIDE OF THE VEHICLE ONLY. Remove and discard the gas strut. Remove and retain the ball stud screw. Fit the gas strut earth wire and star washer (in order as shown) to the ball stud screw and fit to the vehicle as shown. **Tighten to Torque 5Nm.** Attach the gas strut from the kit to the vehicle and secure earth wire as shown. **ENSURE THE NARROW END MOUNTS TO THE VEHICLE. See Dia #2.**

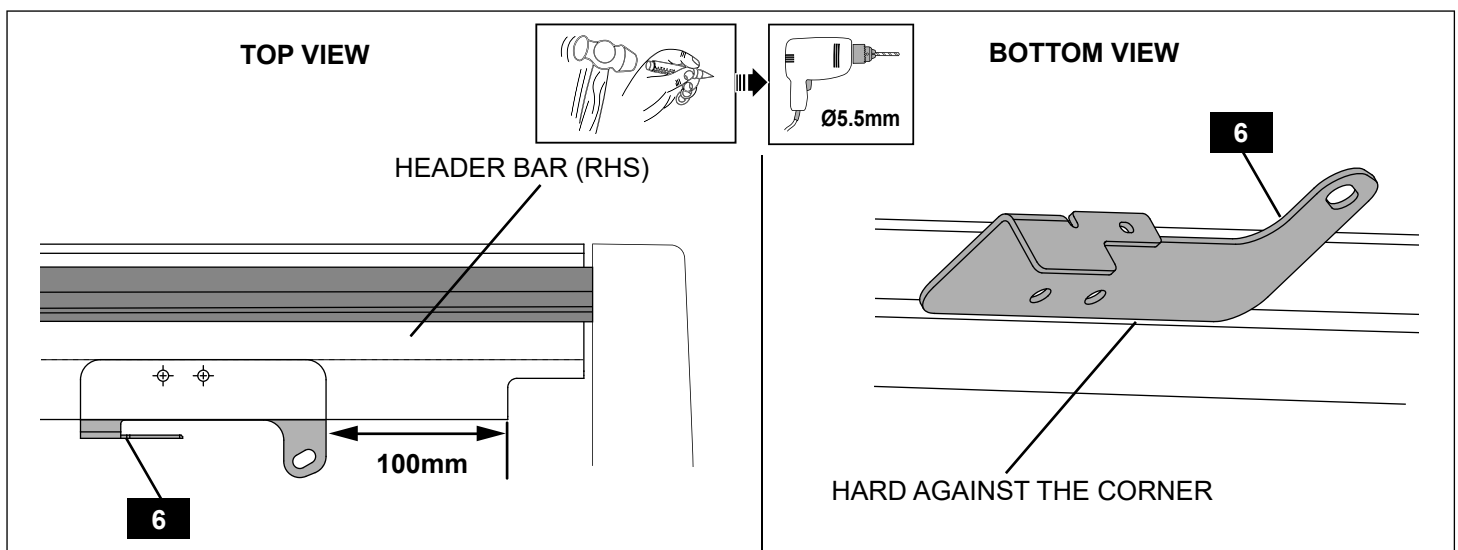

Diagram 3

3. Position the Harness Bracket (6) under the Header Bar RHS hard against the corner underneath of the Header Bar. Set at 100mm from the edge as shown. Mark the two holes. Drill with 5.5mm drill bit.

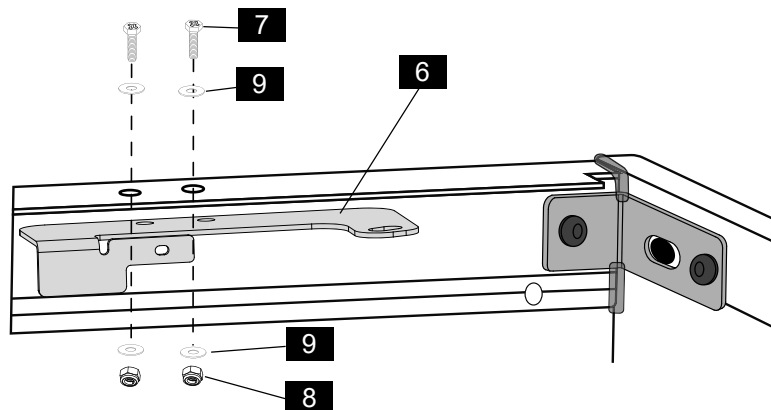

Diagram 4

4. Secure the Harness Bracket under the Header Bar as shown using the M5 screws, washers and nuts.

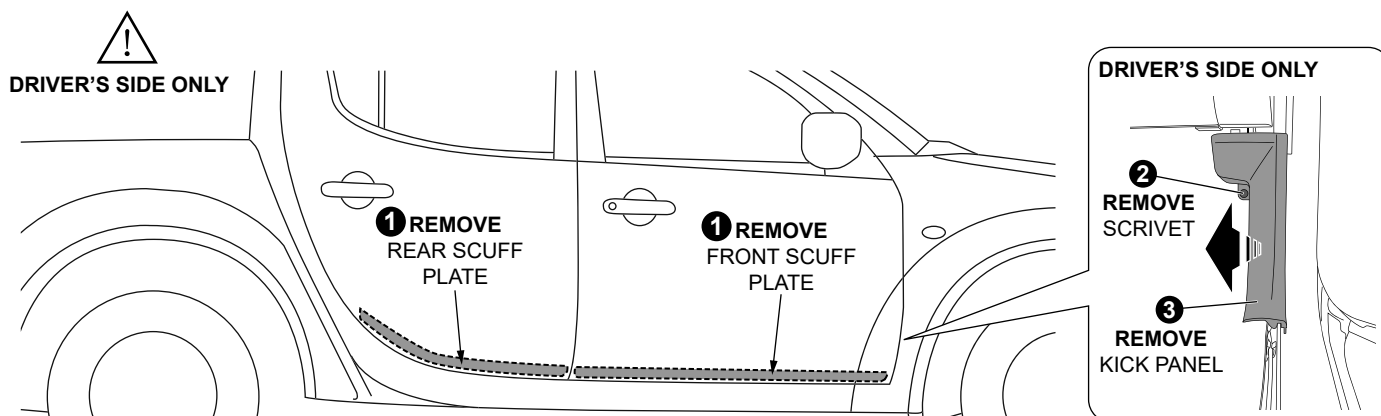

Diagram 5

5. Remove the front and rear scuff plates on the driver's side of the vehicle only. Remove the driver's side kick panel by first removing the scrivet.

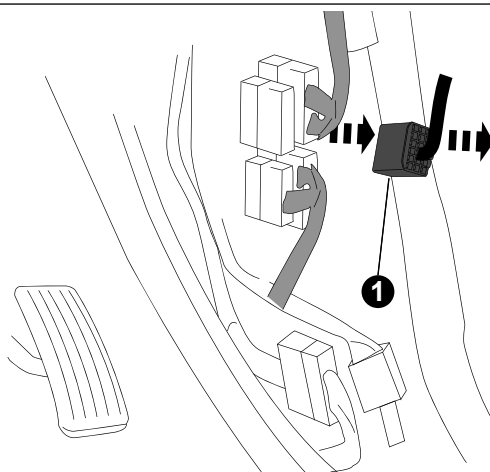

Diagram 6

6. Unplug the male connector from the female connector on the RHS as shown.

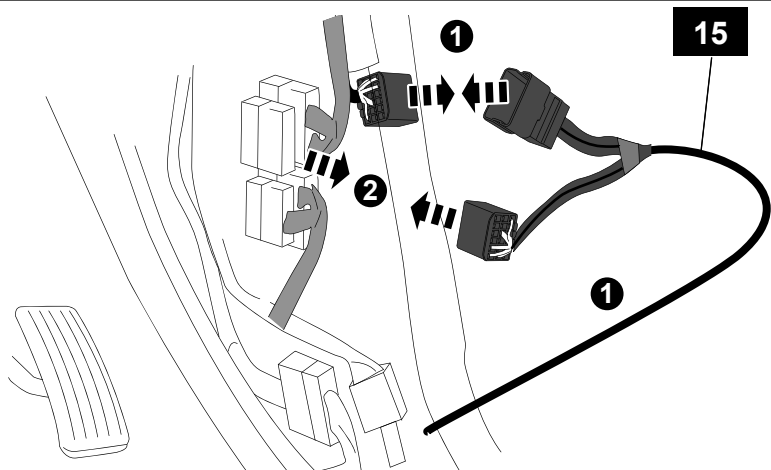

Diagram 7

7. Connect the female LOOM0152 connector to the male connector (1) as shown. Connect the male connector from LOOM0152 into the female plug (2) as shown.

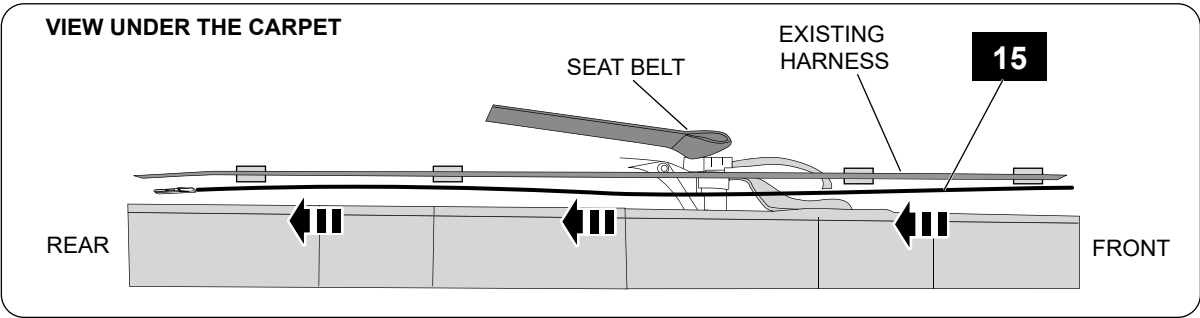
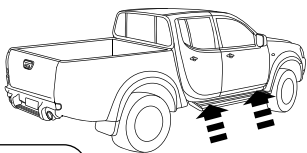

Diagram 8

8. Route vehicle harness from the front door scuff plate to the rear door scuff plate, ensuring the harness sits between the 'B' pillar sheetmetal and the seat belt as shown.

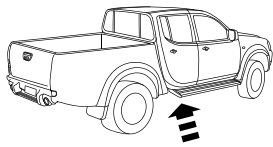
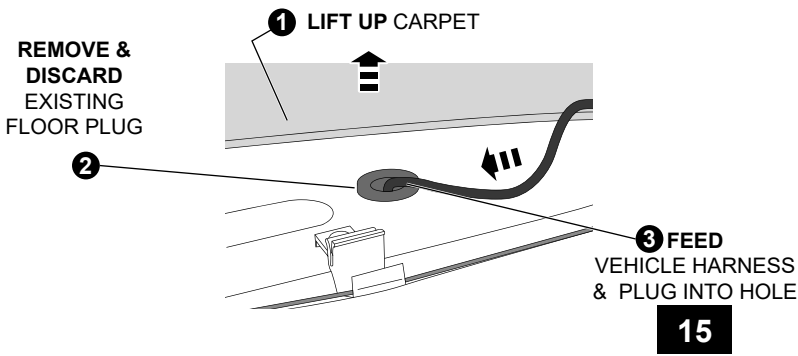

Diagram 9

9. Lift up drivers side rear floor carpet. Remove and discard the existing plug in the floor. Feed the vehicle harness down through the floor and fit the vehicle harness plug into the sheetmetal.

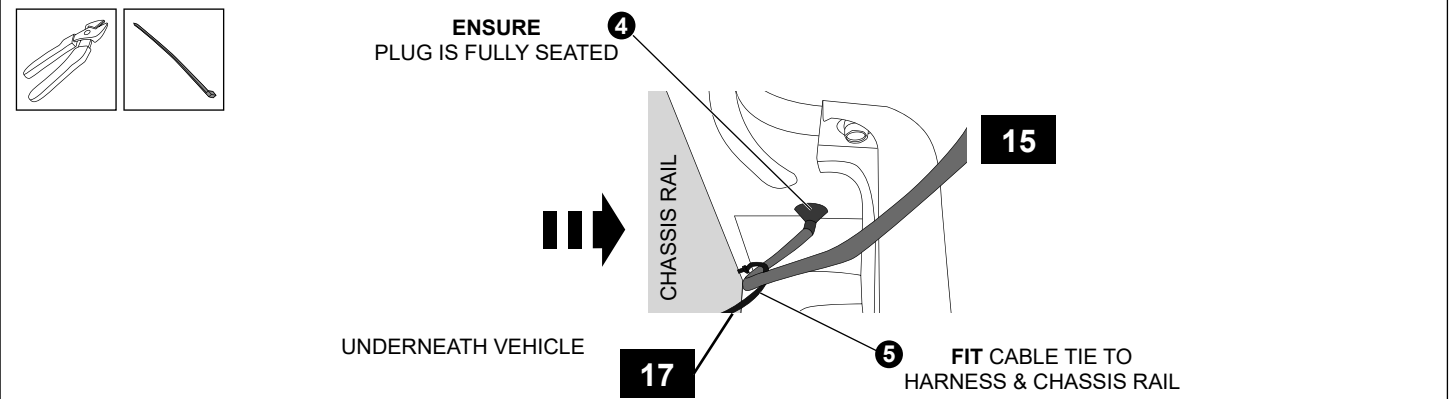

Diagram 10

10. Check under the vehicle that plug is correctly fitted into the sheet-metal and fully seated to prevent water entering the vehicle. Attach 1 long cable tie to secure the vehicle harness to the top of the chassis rail as shown.
Note: Ensure harness is routed over the body mount. Trim excess tie with side cutters.

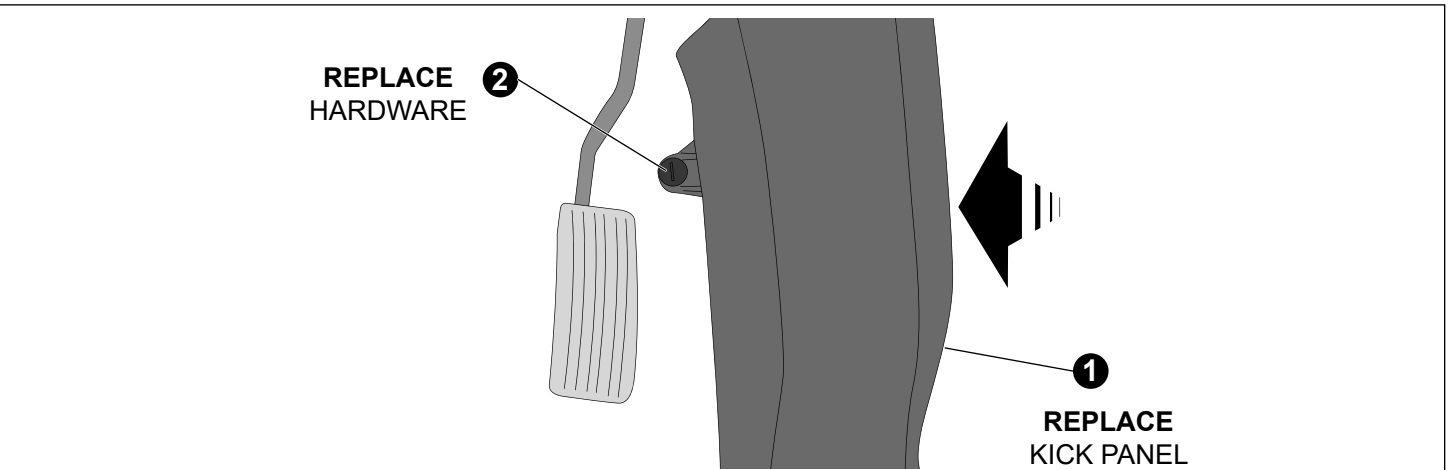

Diagram 11

11. Refit driver's side kick panel and hardware as shown.

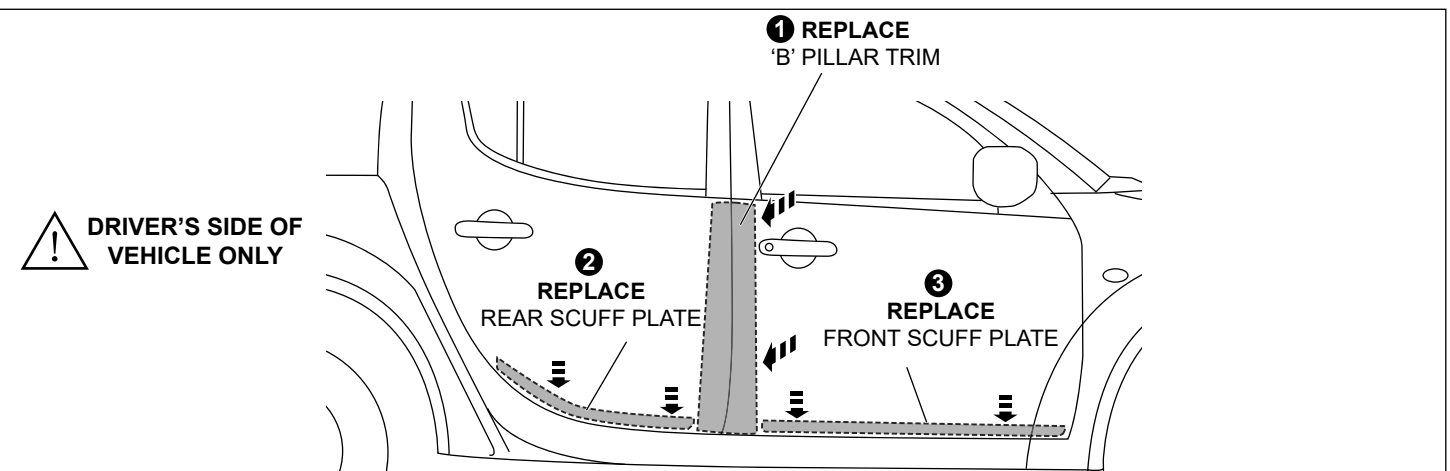

Diagram 12

12. Refit driver's side 'B' Pillar trim. Refit Front and Rear driver's side scuff plates.

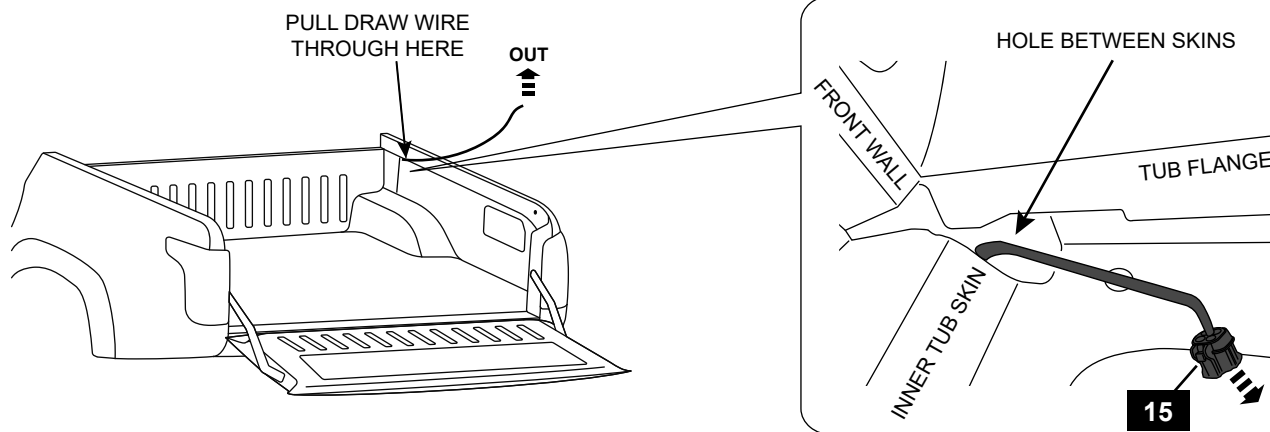

Diagram 13

13. Inside the tub looking up in to the drivers side front corner there is a opening , feed a draw wire between the inner and outer skin to the inner guard behind the wheel splash shield and pull the 4-pin connector end of the harness up into the tub .

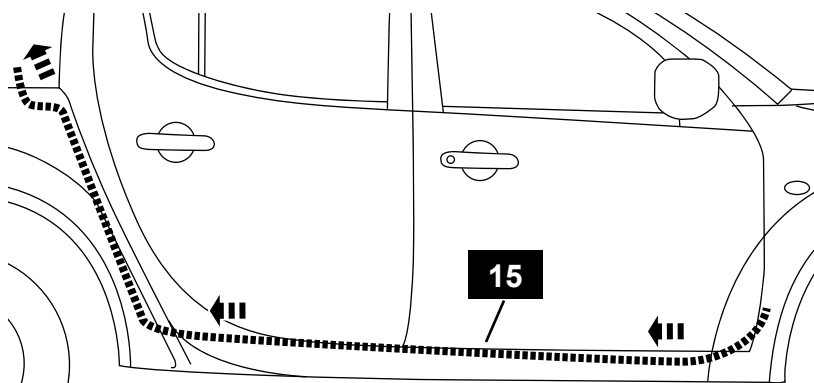

Diagram 14

14. Completed LOOM0152 vehicle layout.

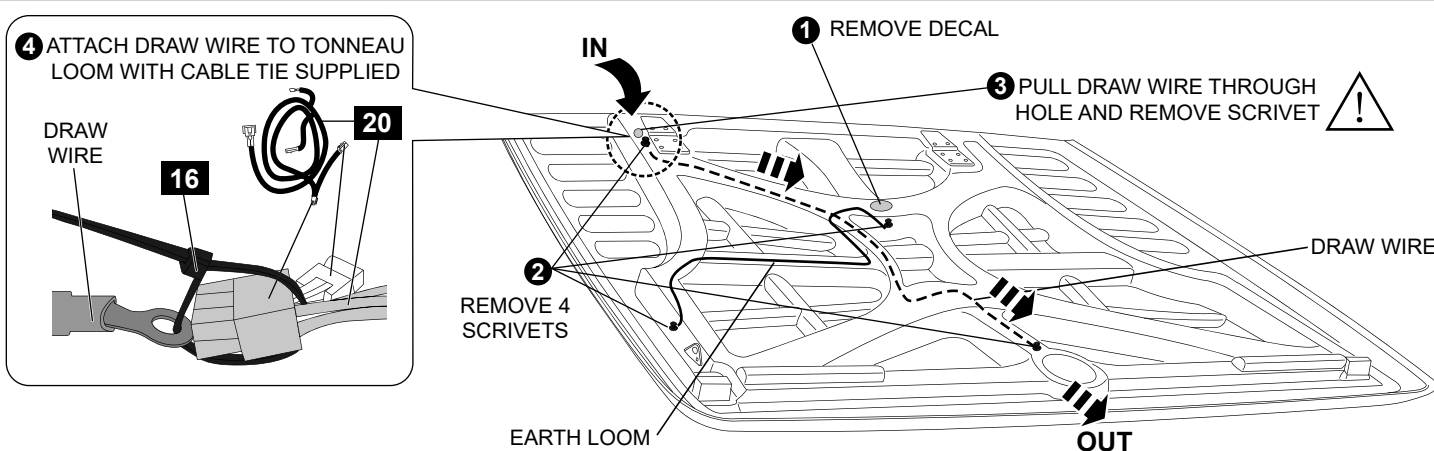

Diagram 15

15. Remove decal located over hole as shown. locate 4 scrivets and remove. Do not remove scrivets from earth loom. pull draw wire back through large hole near hinges and remove scrivet from this end of draw wire. Attach tonneau loom to this end of draw cable with a cable tie as shown, do not pull cable tie tight.

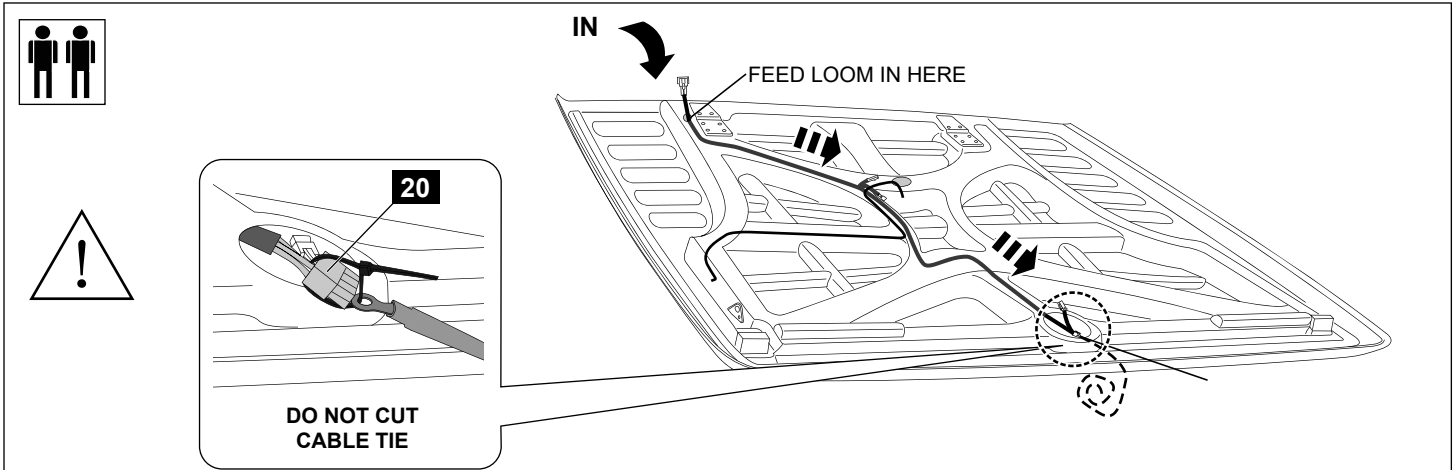

Diagram 16

16. Pull draw wire through the lock cover hole and remove scrivet. One person will feed the loom and the other will pull the draw wire. Important: this is to be done carefully and slowly. Leave the draw wire attached to the tonneau loom.

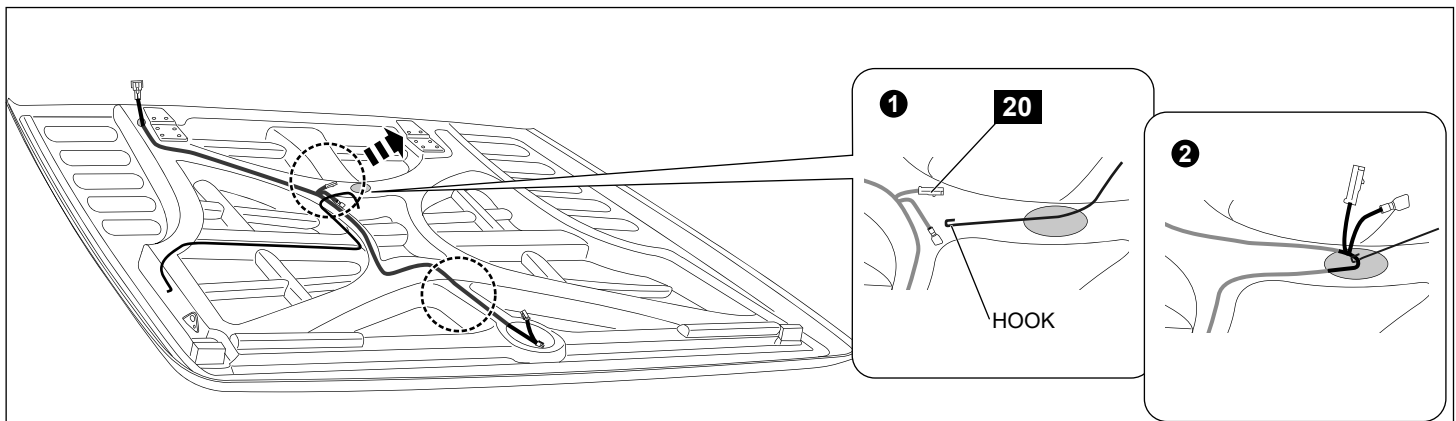

Diagram 17

17. Using a hook locate the harness through the light hole & pull out light connector & earth terminal. You may need to re-pull the draw wire at the lock cover to access connectors.

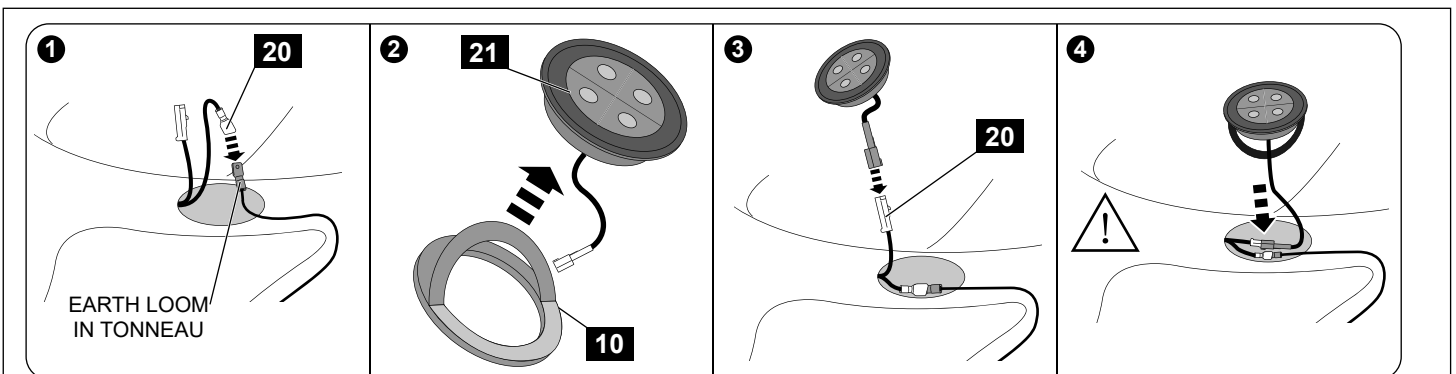
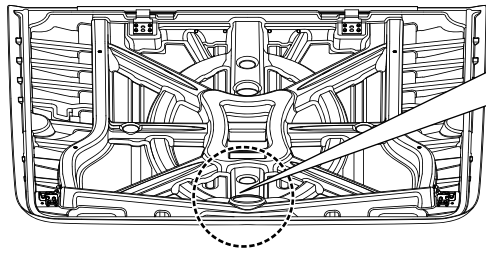
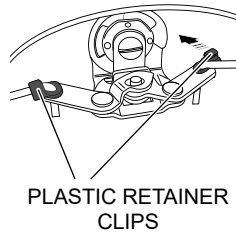

Diagram 18

18. Remove scrivet and pull earth loom through light hole. connect earth terminal to terminal on tonneau loom. Remove tape liner from one side of double sided foam tape gasket and fit gasket to the interior light and apply pressure to ensure maximum adhesion. Connect the 2-way male connector from the tonneau wiring loom to the female connector of the interior light. remove tape liner from double sided foam tape gasket and insert interior light into the tonneau cover and apply pressure to ensure maximum adhesion. **Important: ensure all wiring for the interior light and earth loom is contained inside the tonneau cover before installing the interior light.**



1 RELEASE PLASTIC RETAINER CLIPS



PLASTIC RETAINER CLIPS

2 UNCLIP PULL RODS FROM PLASTIC RETAINER CLIPS

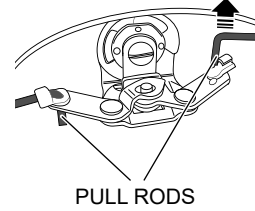

PULL RODS

Diagram 19

19. Release plastic retainer clips and unclip pullrods as shown.

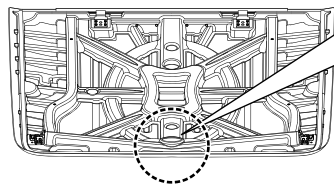
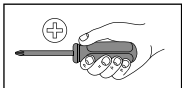

1 REMOVE SCREW AND WASHERS AND DISCARD

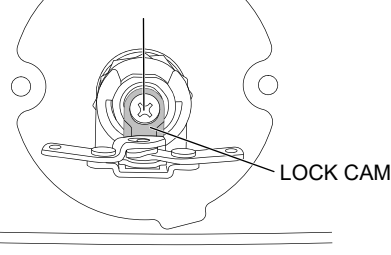

LOCK CAM

REMOVE CIRCLIP BUTTERFLY LATCH AND 2 LOCK NUTS

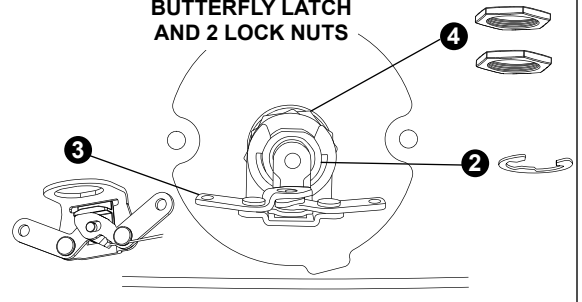
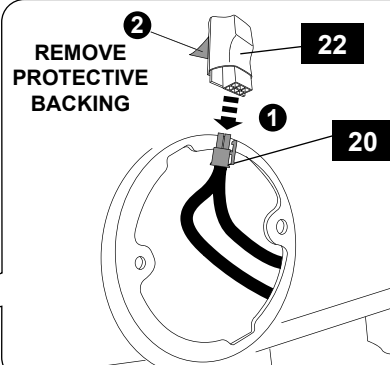
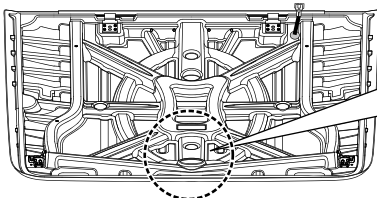

Diagram 20

20. Remove and discard the screw and washers holding the lock cam in place as shown. Remove the circlip and remove the butterfly latch assembly. Unscrew the two lock nuts holding the lock barrel assembly.
Note: Keep one large nut as you will need one for reassembly.



2 REMOVE PROTECTIVE BACKING

20

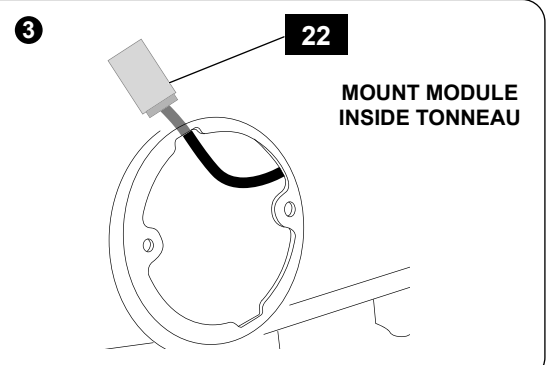

22

MOUNT MODULE INSIDE TONNEAU

Diagram 21

21. Connect the 6-way male connector on the tonneau wiring loom to the module.
Remove the protective backing from the module and adhere it to the inside of the tonneau cover as shown.

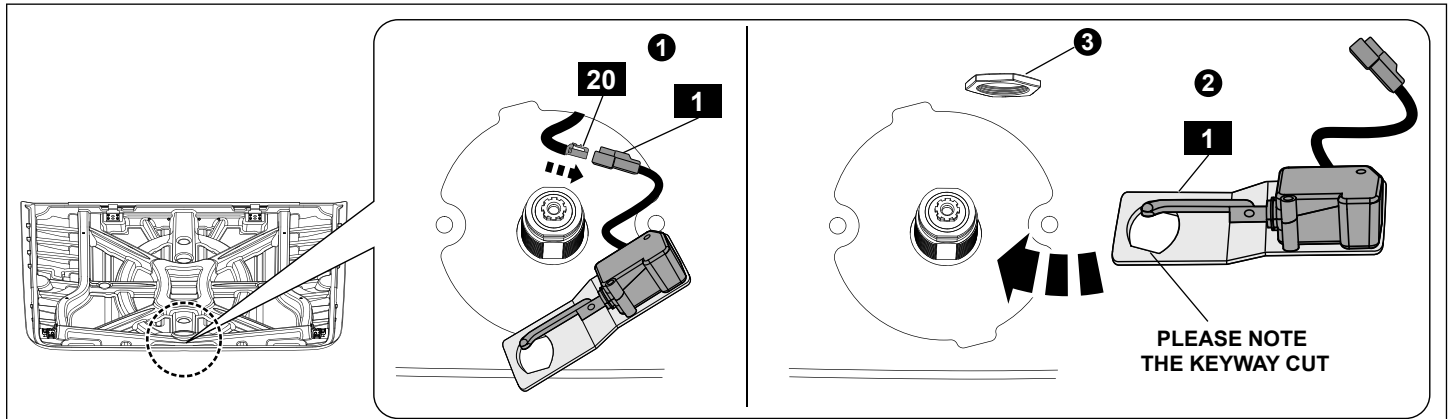

Diagram 22

22. Fit the remote bracket over the lock barrel assembly and secure with one lock nut. **Note: The remote lock bracket has a keyway cut into it on angle for the lock barrel. Ensure that the bracket sits at this angle in relation to the lock barrel.**

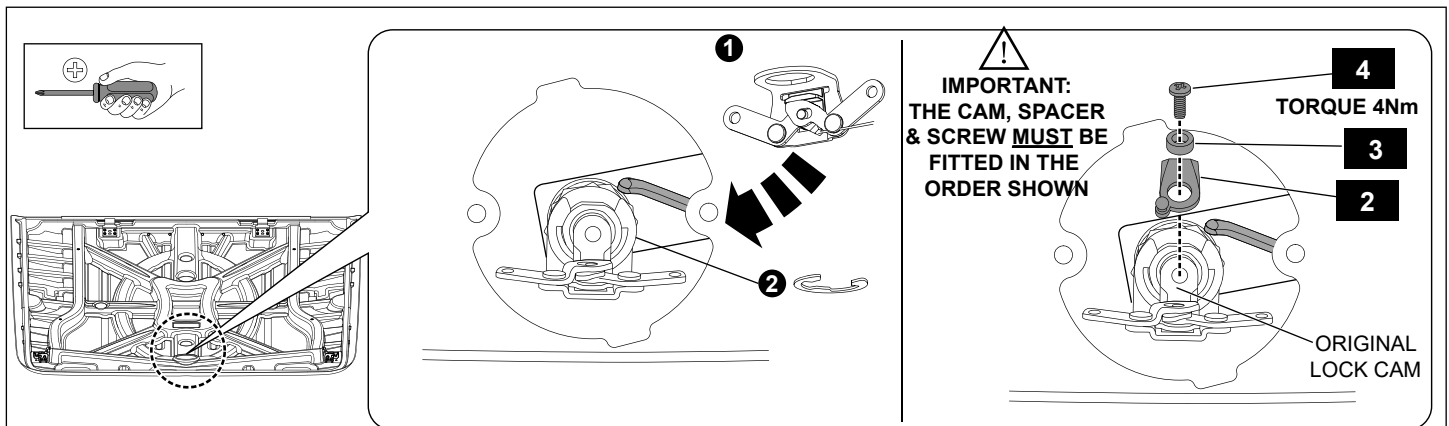

Diagram 23

23. Refit the butterfly latch and secure with the circlip. Fit the ball stud lock cam and plastic spacer, to the locking mechanism and secure with the Phillips head screw provided. **Tighten to Torque 4Nm.**
IMPORTANT: Ensure both lock cams are aligned with each-other and with the locking mechanism as shown.

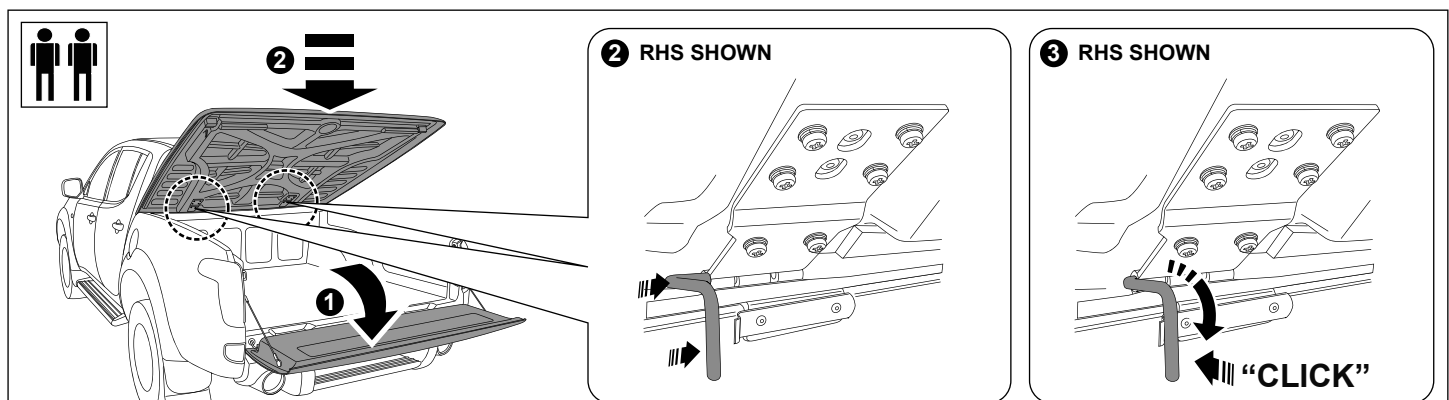

Diagram 24

24. Open vehicle's tailgate. Fit tonneau cover and secure hinges with hinge pins as shown.

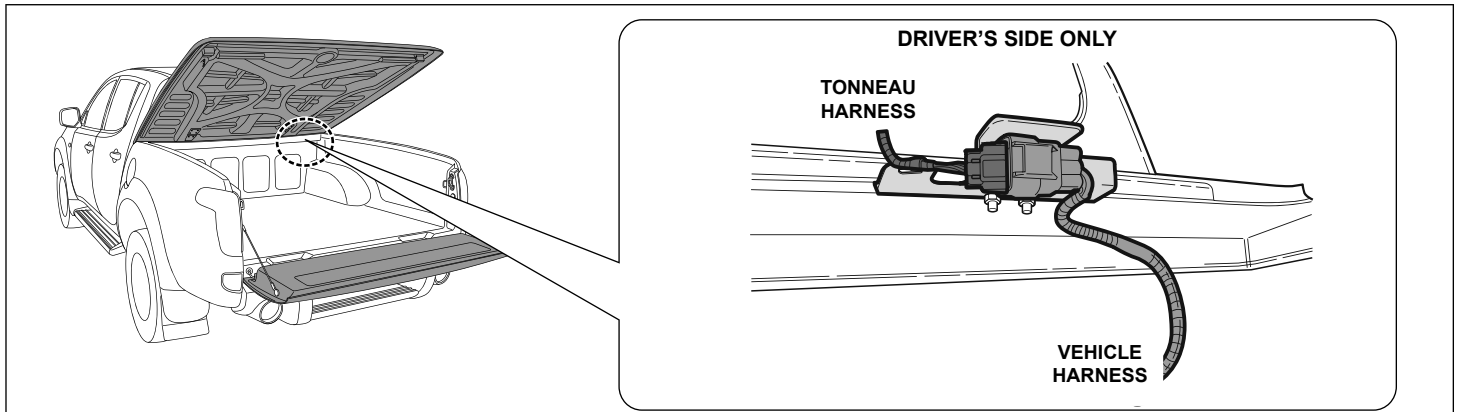

Diagram 25

25. Connect the vehicle wiring loom to the tonneau wiring loom via the connectors located at the front of the tub as shown. Attach connector to bracket and cable tie cable through hole in bracket.

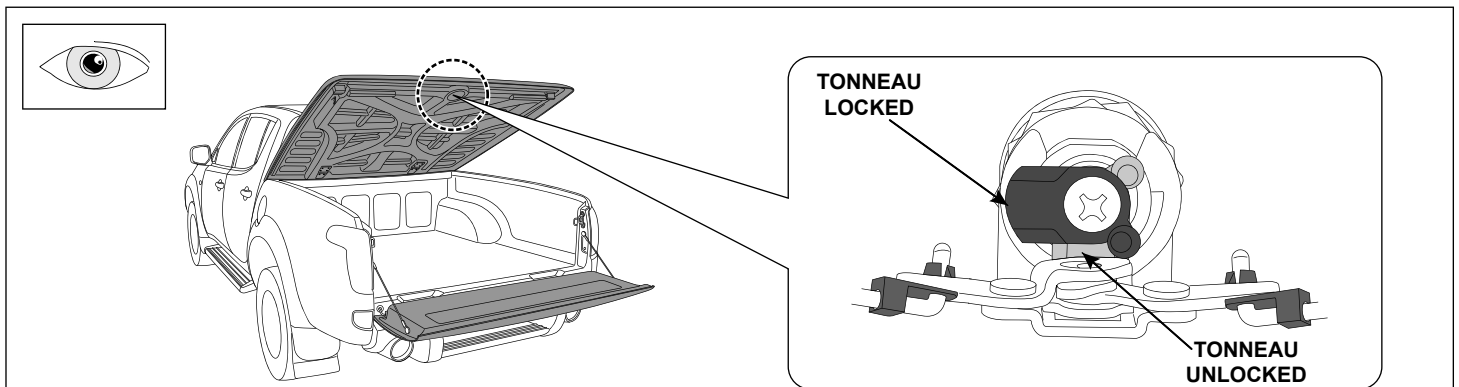

Diagram 26

26. Manually lock and unlock tonneau using key. check operation of central unlocking mechanism by pressing lock and unlock on vehicle's key. Review operation through inspection hole. Test operation of lock mechanism by pressing tonneau's push button after you have pressed lock on vehicle's key, and then again after you have pressed unlock on vehicle's key. Finally, replace the inspection cover.

Diagram 26 the rod and retainer that comes pass the remote lock to the tonneau lock need to be rotated to the other side of the lever to give clearance between the remote lock and if this is not done the rod will hits on the remote lock

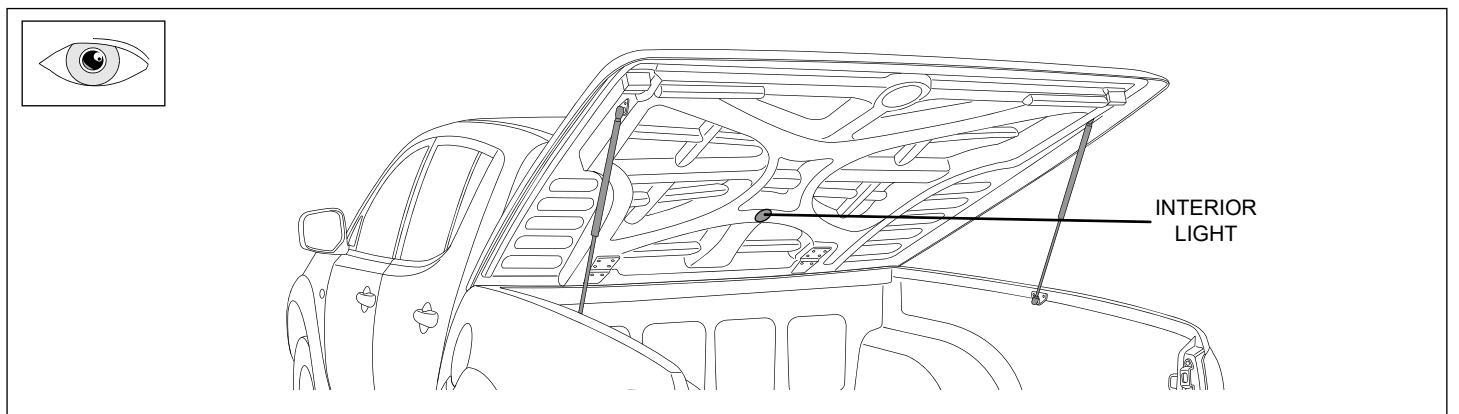

Diagram 27

27. Open and close tonneau with tailgate open to check if interior light is functioning correctly. Ensure the light turns on when tonneau is open and turns off when tonneau is closed. If interior light does not work, check adjustment of gas strut switch.

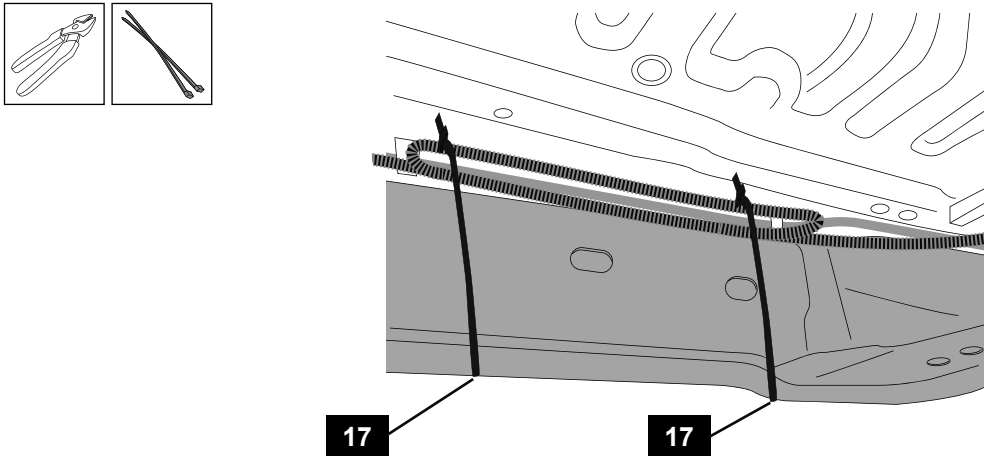
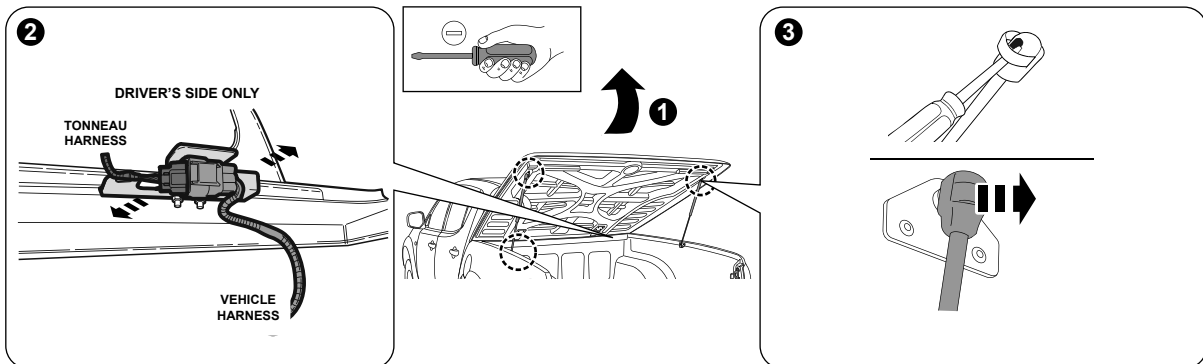
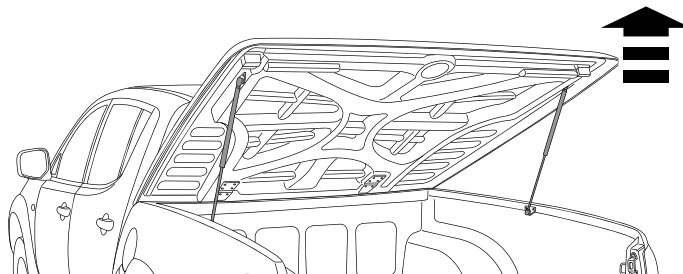

Diagram 28

28. Pull the harness down through to chassis rail. Attach 2 long cable tie to secure the vehicle harness to the top of the chassis rail as shown. Trim excess tie with side cutters.

REMOVAL OF TONNEAU COVER



Open tonneau cover, disconnect 4-way connectors at the front of tub. Detach gas struts from the tonneau cover by inserting a small screw driver and adjusting the spring clip on the strut as shown.

FIG. 1 Note: do not remove the spring clip. only a small amount of levering is required to detach.

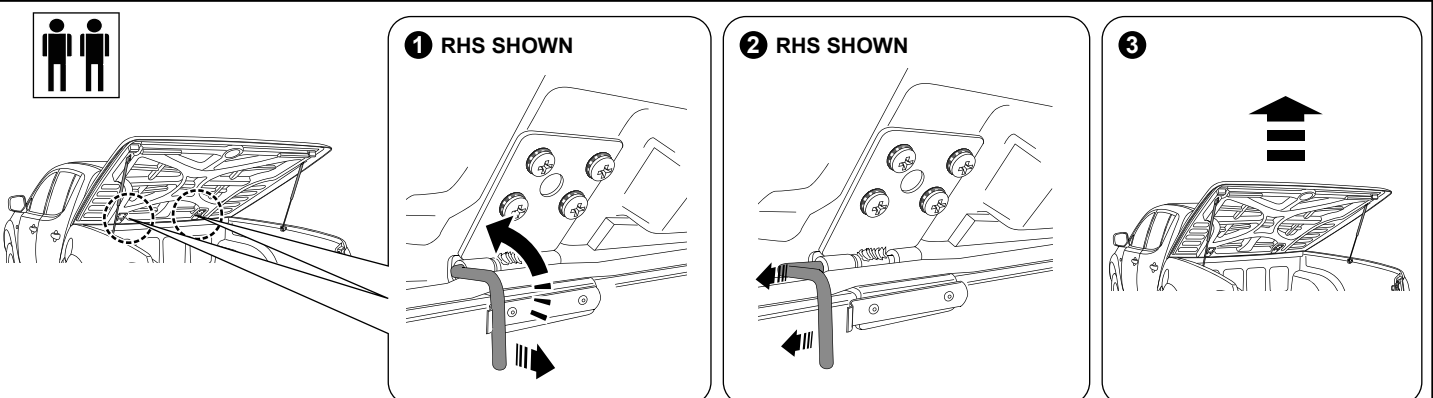

FIG. 2 Remove hinge pins and remove the tonneau cover as shown.



TO REPLACE THE TONNEAU COVER:
Reverse the sequence and the procedures of the two (2) Figures above.

