

WARNING!

When in the closed position, Aluminium Tonneau Cover must be latched and tailgate must be closed. Failure to do so could result in unexpected opening of the Tonneau Cover from sudden wind gusts or driving conditions, which could cause damage to the vehicle and/or your Aluminium Tonneau Cover.

Secure any items tall enough to strike the Tonneau Cover lock mechanism.

DO NOT close the Tailgate when the Aluminium Tonneau is in the closed position, as damage may occur to the vehicle and/or your Tonneau Cover.

Do not operate vehicle while cover is open.

MAINTENANCE:

- Avoid the use of chemicals to clean painted surfaces, wash regularly with car wash detergent, hose off and chamois dry. Aluminium top sheet finish can be maintained with briteshine polish or similar. Un-maintained product i.e. surface finish degradations not covered by warranty.
- The gas struts are self lubricating and should only be cleaned occasionally with a damp cloth. Premature seal failure will result if solvents or lubricants are used to clean struts.
- Gas struts must be connected with the cylinder (wide) end to the Aluminium Tonneau Cover or Warranty is Void.
- The locking mechanisms and latches only require occasional lubrication with Graphite Powder.
- DO NOT use any other lubricants or oils. Using alternative products will VOID Warranty.
- All installation hardware and fasteners must be checked every so often for tightness.

TONNEAU COVER - IMPORTANT:

- Read instructions carefully before installation. It is strongly recommended that installation is conducted by a qualified mechanic.
- This product must be installed exactly as specified in these instructions. Failure to do so may result in improper fit and/or retention.
- Do not stand/sit or rest heavy objects on Tonneau Cover.
- Humans or animals are not to be under the closed Tonneau Cover at any time.
- Securely latch Tonneau Cover before operating vehicle.
- Do not carry open volatile chemicals with Tonneau Cover installed.
- If contact with volatile chemicals occurs clean Tonneau Cover with mild detergent and water solution.
- Recommend installation by 2 people.
- Fitting Instructions must be given to the end customer to understand correct removal and replacement process onto the vehicle.

Care Instructions:



Clean Tonneau Cover with a mild detergent and water solution.



Do not use abrasive cleaners or solvents.

Tonneau Cover Assembly x1	Hinge Bracket x2	Striker Bracket x2	Striker x2	
M10 Nut x8	M10 Washer x8	Gas Strut x2	Ball Stud x4	
M8 Lock Nut x4	M8 Washer x2	M6 Lock Nut x4	Gas Strut Bracket x2	M6 Button Head Cap Screw x4
M6 Washer x8	Striker Bracket Spacer x4	4.8x10mm Rivets x12	4.8x16mm Rivets x17	Tailgate Lock Bracket x2
Foam Pad x1	Header Rail Extrusion x1	Header Rail Seal x1	Corner Bracket x2	Corner Bkt Pad x2

REQUIRED TOOLS | EQUIPMENT



- | | | |
|----------------------------------|-----------------|-----------------------------------|
| 13mm and 17mm Socket | 4mm Allen Key | Cleaning Materials |
| ½" Drive Ratchet + Extension Bar | Rivet Gun | Masking Tape |
| 8mm, 13mm and 17mm Spanner | Tape Measure | Right Angle |
| Power Drill | Centre Punch | Rust Inhibitor |
| 5mm Drill Bit | Hammer | Personal Protective Equipment: |
| 8 mm Drill Bit | Pencil / Marker | Safety Glasses, Ear Plugs, Gloves |
| | | (Scissors, Silicone)* Optional |

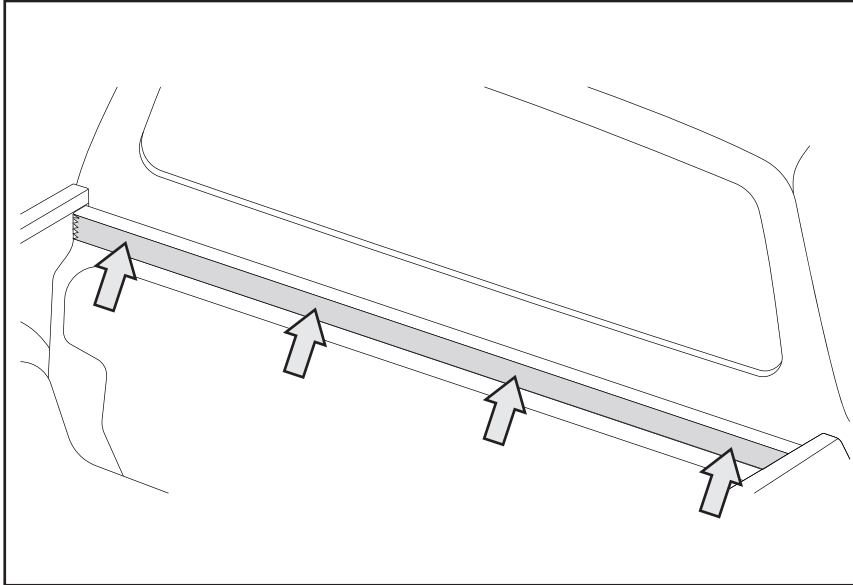

Step 1

Required tools: Masking Tape,

- Clean the top surface of the tub.
- Apply masking tape to side face of front rail.

Note: This instruction is for plain tub installation only. If tub liner is fitted, the liner will need to be trimmed to allow correct installation of the tonneau cover brackets and hinges. No spacers or additional media allowed between hinges/brackets and the vehicle tub.

Note: If fitted, cabin guard must be removed.

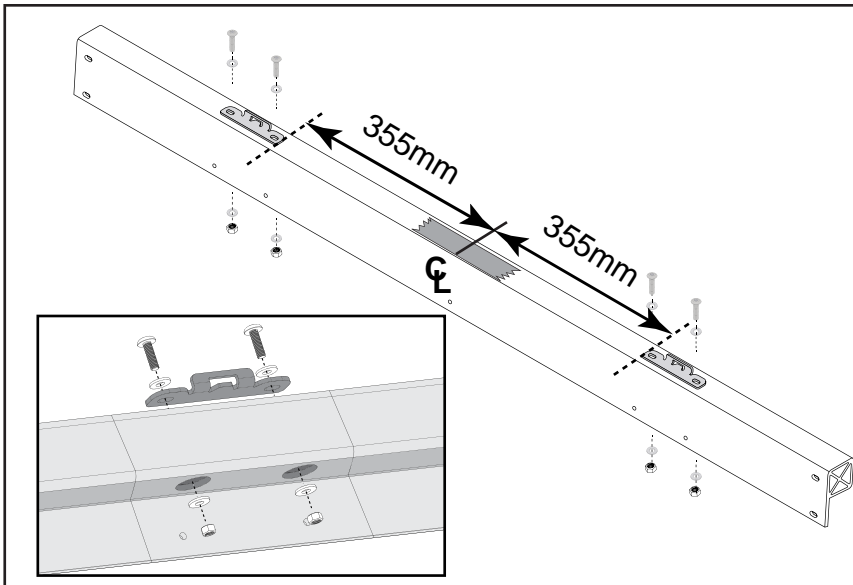

Step 2

Required tools: 6mm Allen Key, 6mm Socket, Ratchet, Masking Tape, Marker Pen, Tape Measure

- Apply masking tape to the top of the header rail extrusion and mark the centre line.

Install lower hinge brackets to the header rail extrusion using the supplied M6 Button Head Cap Screws and M6 nuts and Washers. Ensure that the inside face of the brackets are positioned exactly 355mm from the centre line as shown.

- Tighten the bolts to 10 Nm.
- Remove masking tape

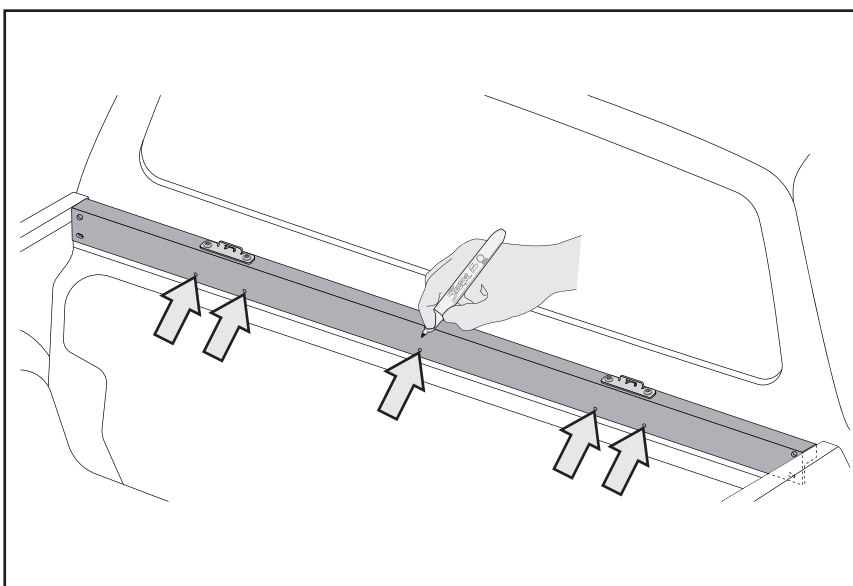

Step 3

Required tools: Tape Measure, Marker Pen.

- Place the header rail assembly over the tub front rail. Ensure it is located at the centre by taking measurements from each side.
- Using the header rail as a template, mark the five hole locations.

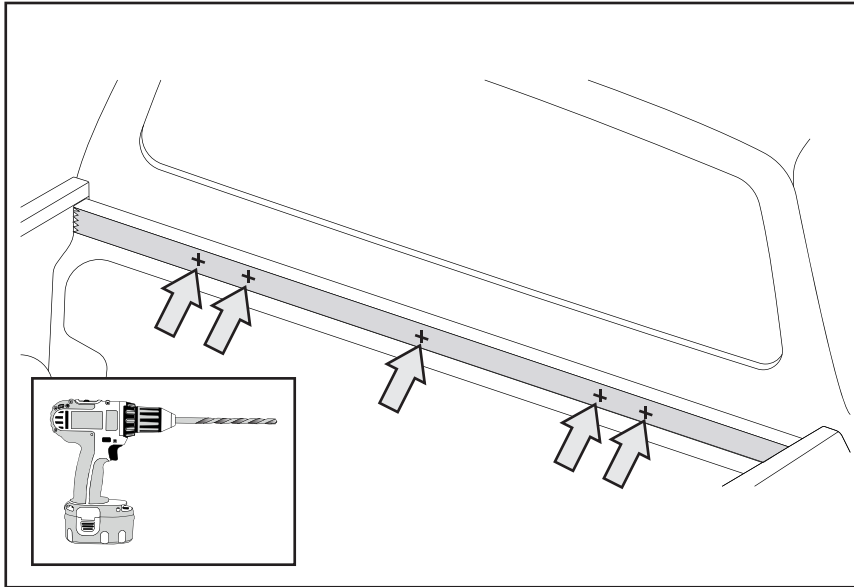

Step 4

Required tools: Drill, 5mm drill bit , centre punch.

- Centre punch 5 marked hole locations.
- Drill 5mm hole at each location ensuring that drill only passes through first tub skin.
- Remove any swarf from holes, remove tape and apply corrosion inhibitor to each hole.

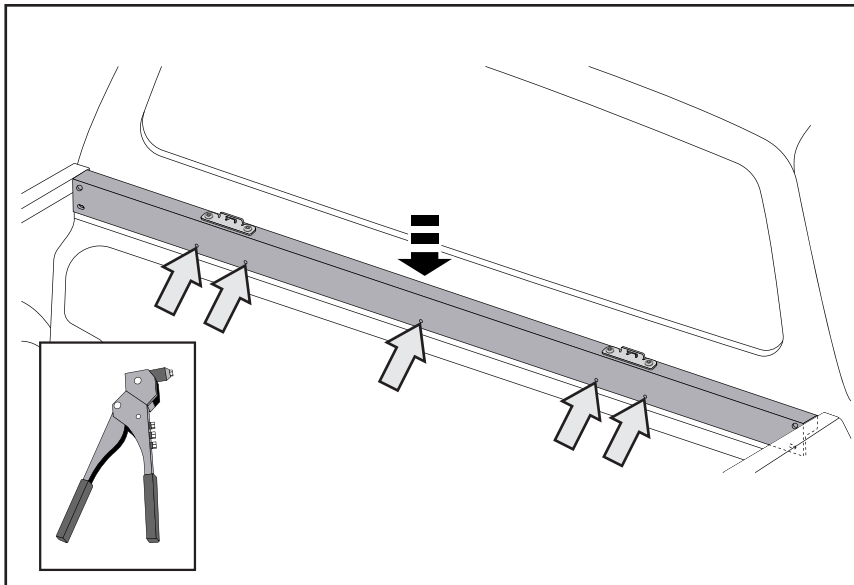

Step 5

Required tools: Rivet Gun.

- Place the header rail assembly back on the vehicle tub.
- Secure the header rail with supplied five 4.8x16mm rivets.

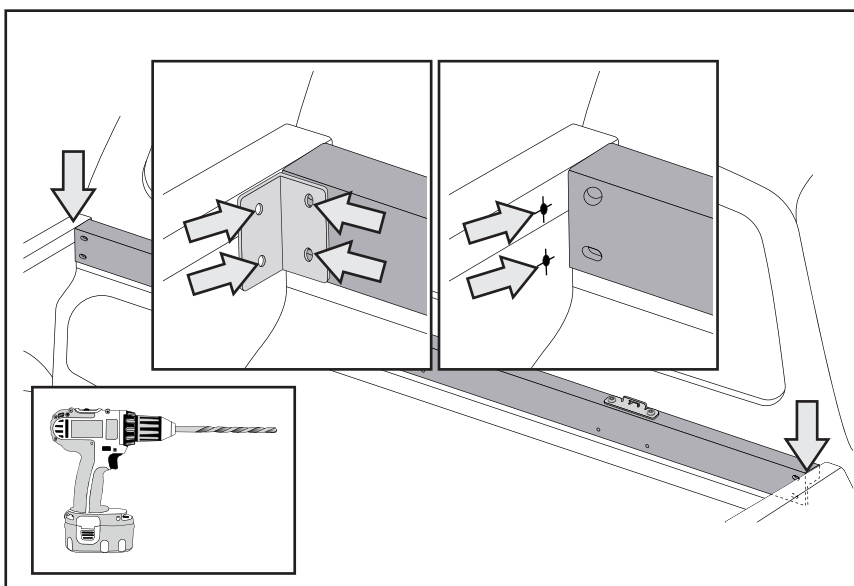

Step 6

Required tools: Marker Pen, 5mm Drill Bit and Power Drill.

- Place the corner brackets against the header rail and sides of the tub and align bracket to pre-drilled hole and slot in the header bar.
- Using the corner brackets as a template, mark the two hole locations on the side of the tub.
- Centre punch and drill both holes on the side of the tub ensuring that the drill only passes through the first skin of the tub.
- Repeat this step for the RHS corner bracket.

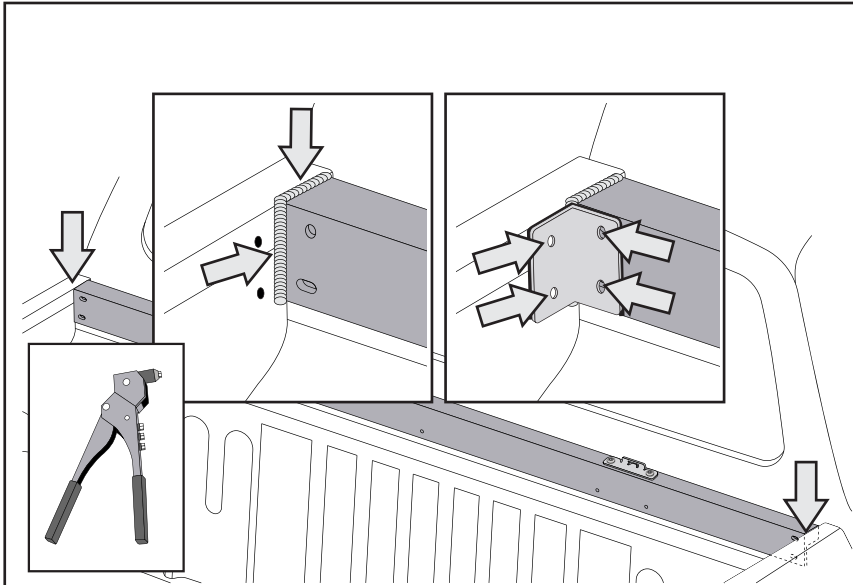

Step 7

Required tools: Sikaflex, Rivet Gun,

- Apply a bead of sikaflex where the header rail meets the sides of the tube.
- Install the corner bracket foam pads behind the corner brackets and secure corner brackets with supplied 4.8x16mm rivets.
- Repeat step for RHS corner bracket.

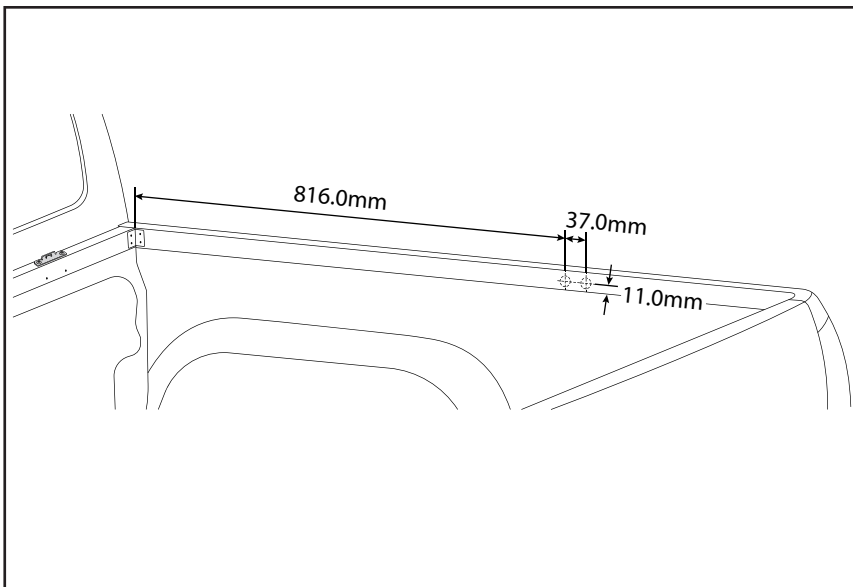

Step 8

Required tools: Masking Tape, Marker Pen and Tape Measure.

- Apply masking tape to the side rail inner surface and measure 816.0mm from the front rail inner surface, and mark location.
- Mark another line 37.0mm from this line, and a line 11.0mm from the side rail bottom edge, crossing both lines.
- Repeat for LHS.

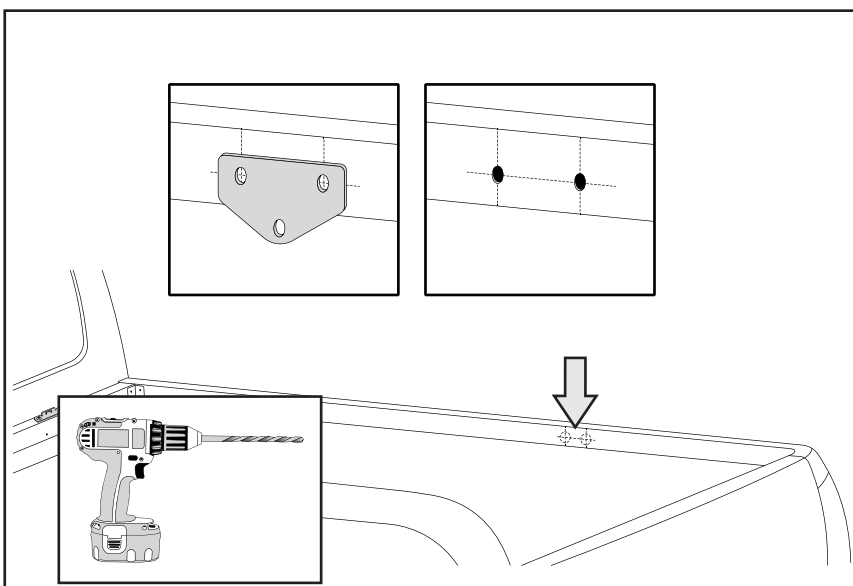

Step 9

Required tools: Centre Punch, Marker Pen, 5mm Drill Bit and Power Drill, Hammer.

- Align Gas Strut Bracket with marked lines to confirm hole locations.
- Mark and centre punch hole locations.
- Drill holes through using 5.0mm drill bit, and remove any drill burr from holes.
- Apply rust inhibitor to the drilled holes.
- Repeat for LHS.

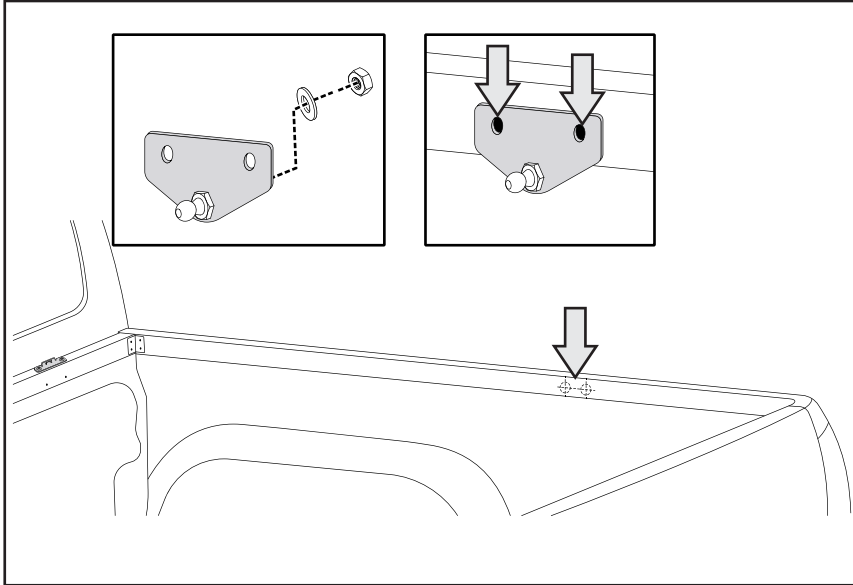

Step 10

Required tools: Rivet gun, 13mm spanner and 13mm socket and driver.

- Install the pivot end ball to the bracket using the supplied M8 Lock nut and tighten it to 20.0 Nm.
- Install the gas strut bracket with supplied 4.8x10mm rivets.
- Repeat for LHS.

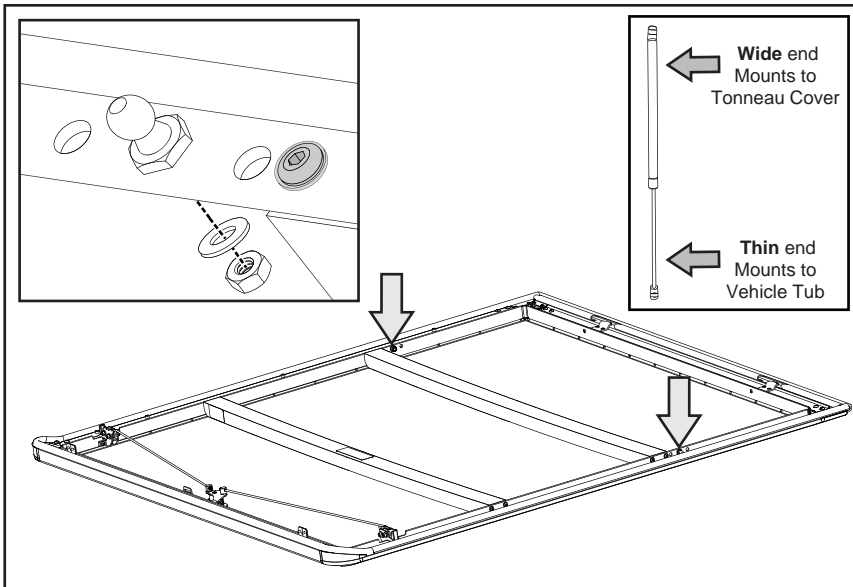

Step 11

Required tools: 13mm spanner, 13mm socket and driver.

- Install the ball stud with supplied M8 lock nut and washer in the middle hole of the Tonneau cover. (Ball Stud to outside).
- Connect the wide end of gas strut by pressing it onto the ball stud.
- Repeat for both sides.

Note: The opening height of the tonneau cover can be adjusted by fixing the ball studs in either holes illustrated.

Note: Ensure the gas strut is installed in the correct orientation as shown. The wide end connects to the Tonneau cover.

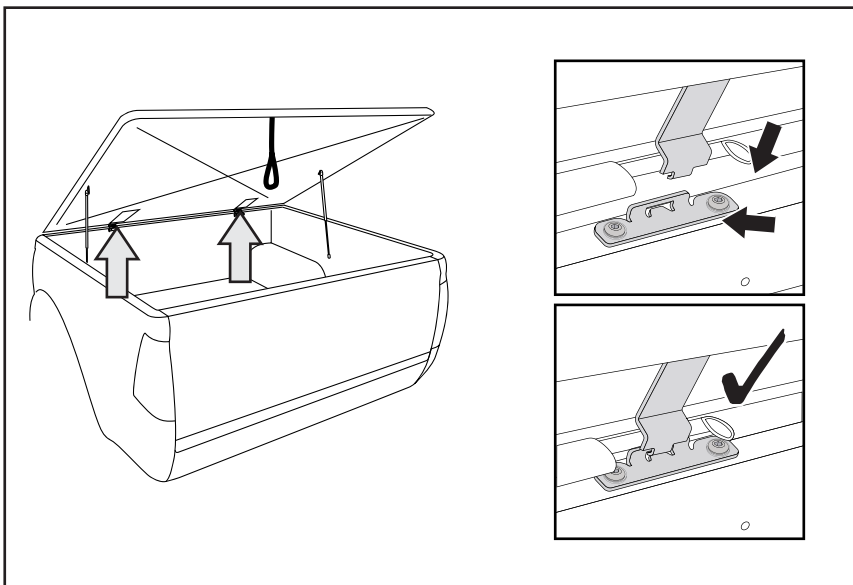

Step 12

Required tools:

- Install the cover by letting the hinge tongue to rest on front of the hinge groove while holding the cover at a 60° angle.
- Move the cover toward the vehicle cabin to slide the tongue to the groove, ensure hinge parts fully engage.
- **Do not lower the cover yet.**

Note: When lowering the cover, ensure the front seal is not crushed between the front rail and the cover.

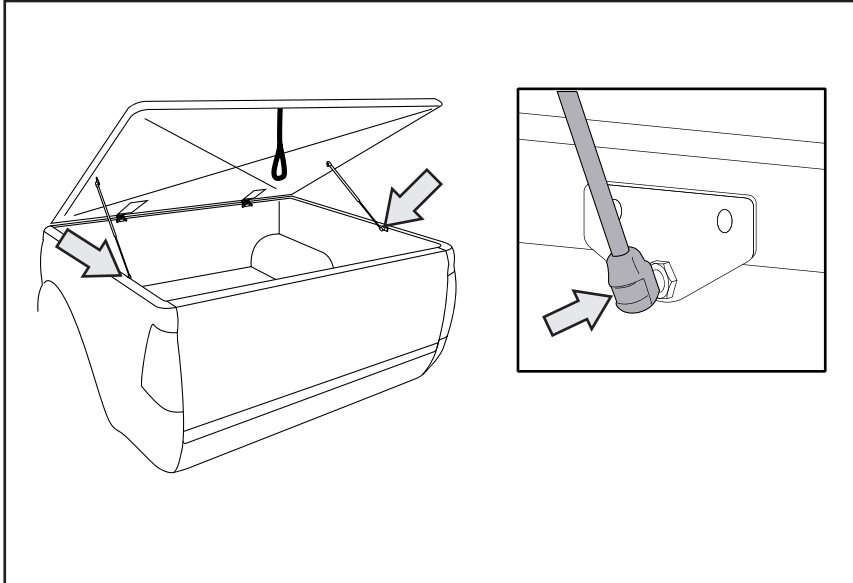
**Step 13**

- Attach gas struts to brackets by clipping into place. Ensure narrow end mounts to the vehicle.

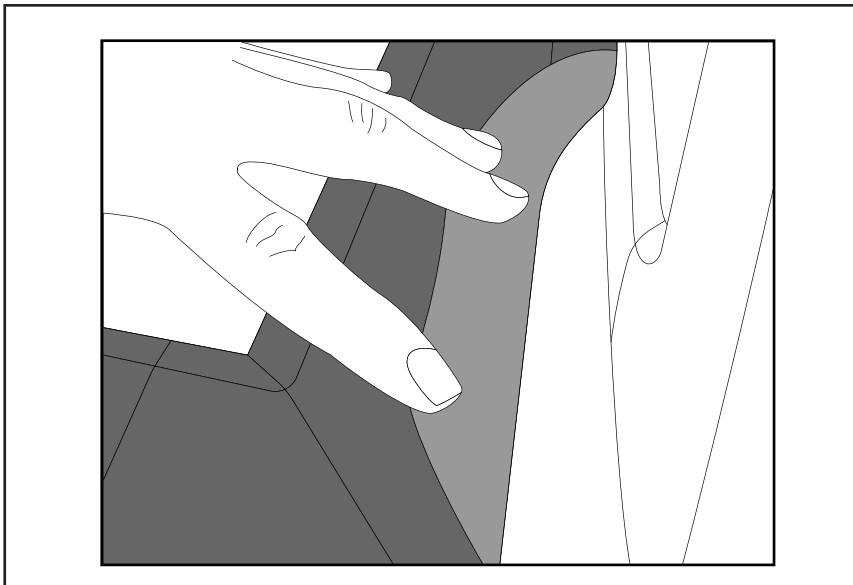
**Step 14**

- While the cover is open, check the front seal's lip is not trapped between the cover and the front rails by bending it up.

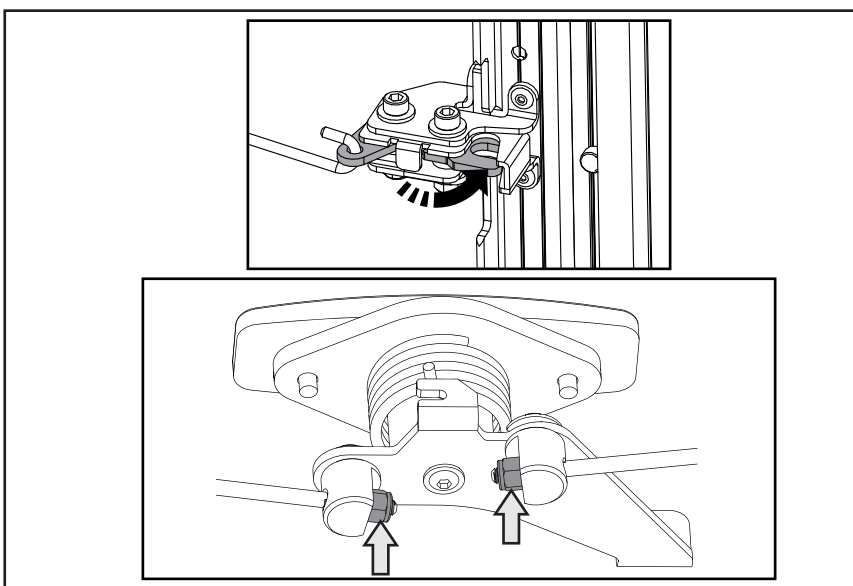
**Step 15**

Required tools: 8mm Spanner.

- While the cover is open and tailgate is open. Press the latch rotor to closed position, both sides.
- Rotate the tonneau cover handle slowly clock-wise, ensure both latches disengage at the same time. Adjustment may be required.

Note: Mechanism can be adjusted by tightening or loosening the latch rod M5 nuts from underneath the cover.

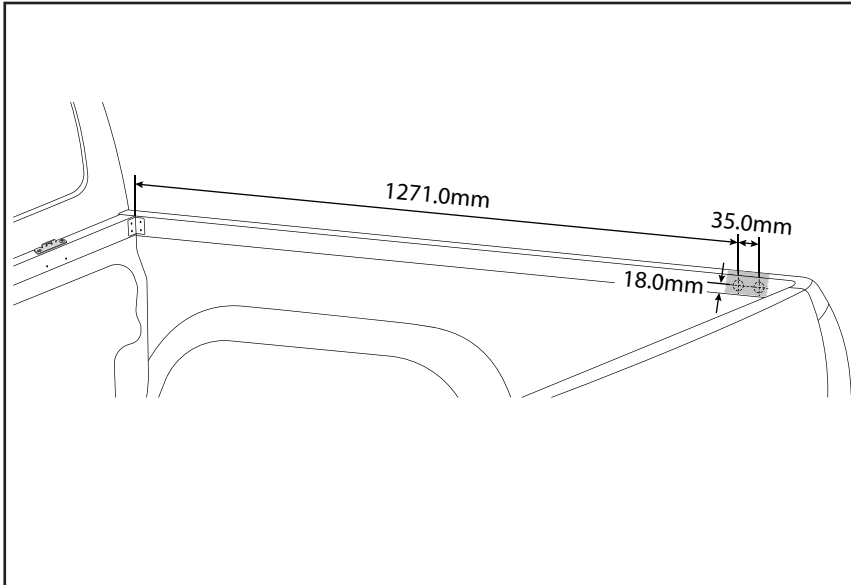

Step 16

Required tools: Masking Tape, Marker Pen and Tape Measure.

- Apply masking tape to the rear section of the side rails and side wall below.
- Using tape measure, mark a line 1271.0 mm from the front rail inner surface.
- Mark another line 35.0 mm, towards the tailgate.
- Mark one more line 18.0 mm from the side rail bottom edge, crossing two previously marked lines.
- RHS shown, repeat for LHS

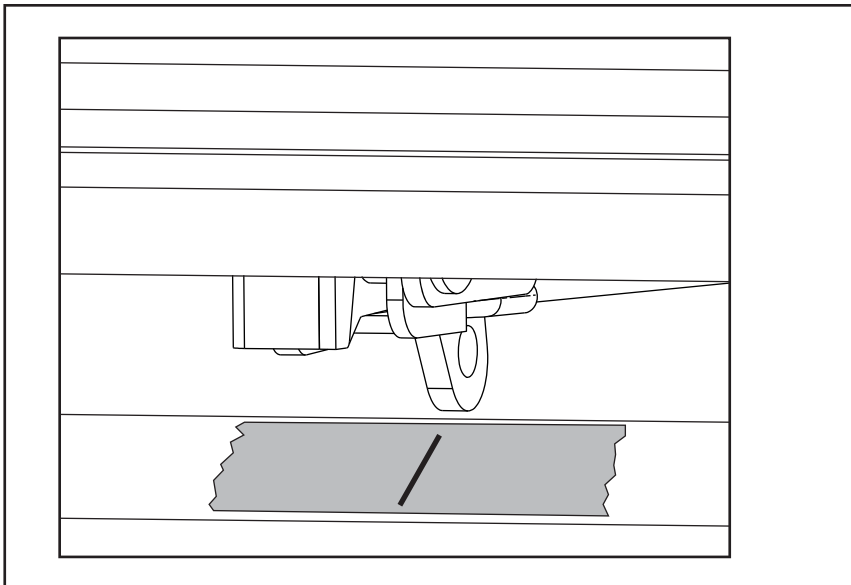

Step 17

Required tools: Marker Pen

- Lower the tonneau cover. Mark the centre of the tonneau cover latch on the masking tape on the top surface of the side rail.
- Do this for both sides.

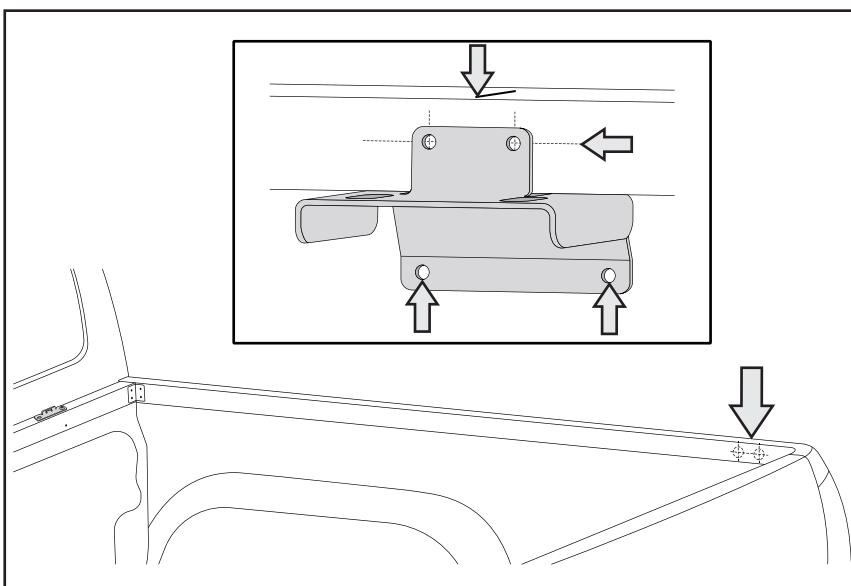

Step 18

Required tools: Marker Pen.

- Take the striker bracket and line up the top holes with marked location in the side rail.
- Mark up the bottom hole location, using the bracket as template.
- Ensure bracket top surface is horizontal and that the line marked in step 17 lines up with the centre of the bracket.
- Do this for both sides.

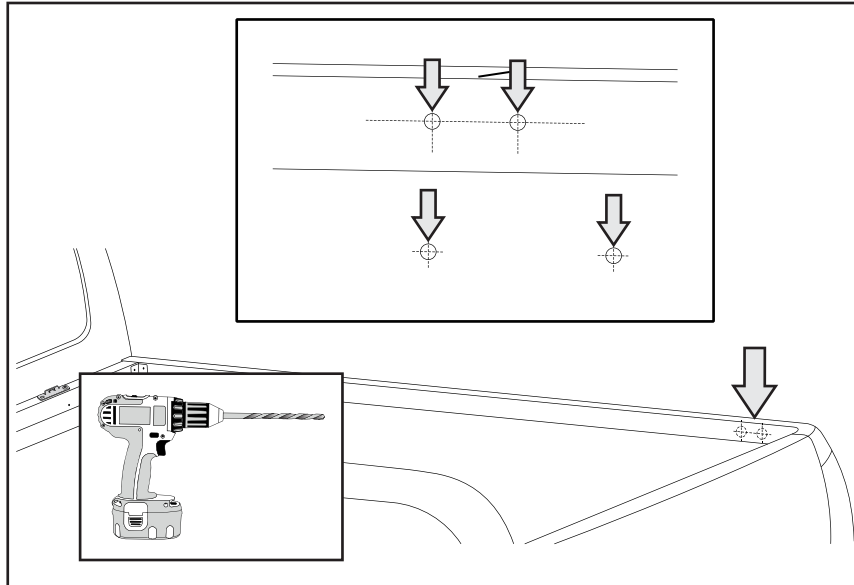

Step 19

Required tools: Power drill, 5mm drill bit and drill bit stopper, centre punch, hammer.

- Remove the bracket, take centre punch and centre punch the four hole locations.
- Using 5.0 mm drill bit, drill the holes, only through the first layer of steel. Remove any drill burr from the holes.
- Apply rust inhibitor to the drilled holes and remove masking tape from tub.
- Repeat for other side.

Note: Use drill stopper to avoid drilling too deep.

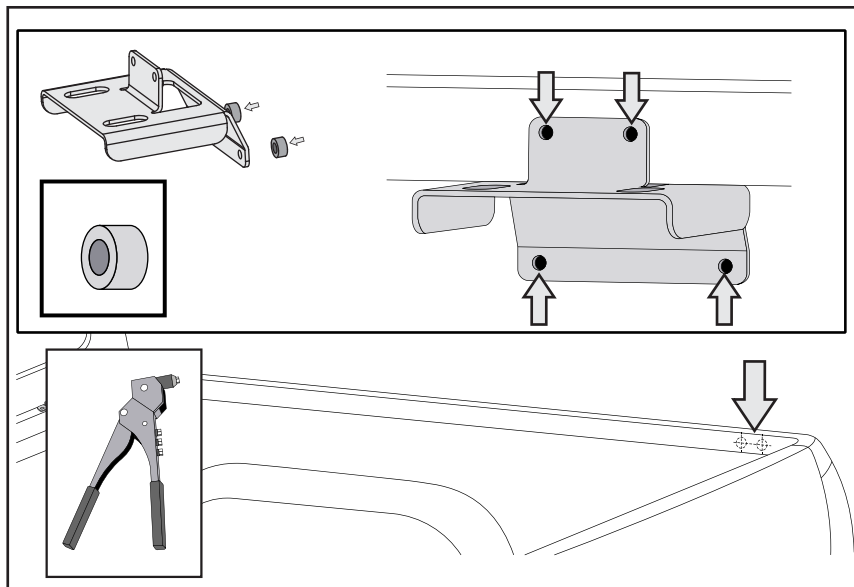

Step 20

Required tools: Rivet gun.

- Position the spacers behind the bracket at the lower rivet positions.
- Secure the bracket to the tub with 2x 4.8x10mm Rivets in the upper holes and 2x 4.8x16mm Rivets in the lower holes.
- Repeat for LHS

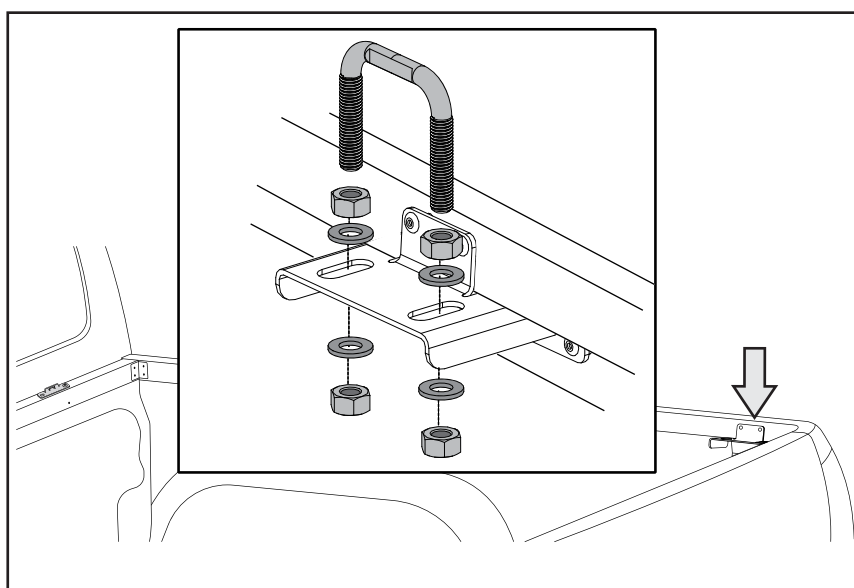

Step 21

Required tools: 17mm spanner, 17mm socket and driver.

- Install the striker to the striker bracket using supplied M10 Hex Nuts and washers.
- The striker should line up with the top surface of the side rails, fine adjustment required.
- Repeat for LHS

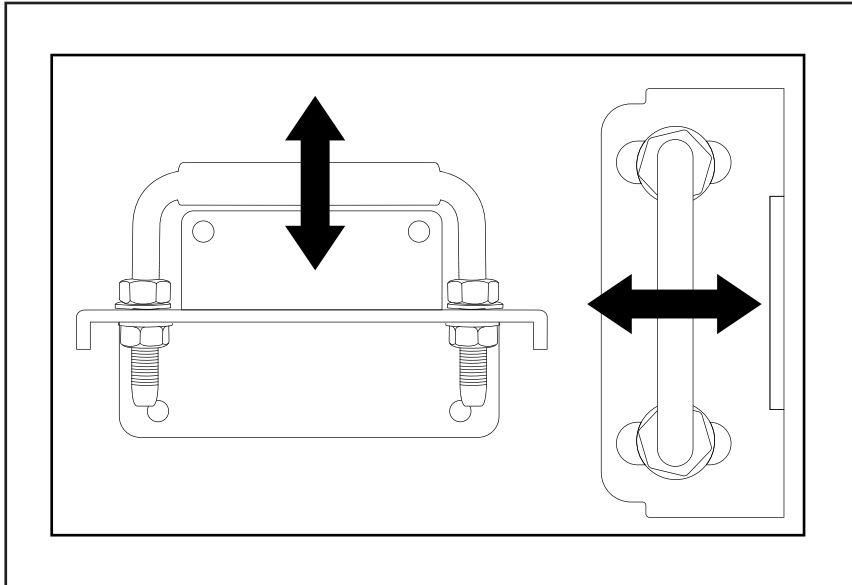

Step 22

Required tools: Masking Tape, Marker Pen and Tape Measure.

- Slowly close the cover and move the striker sideways to line it up with the latches. Ensure both sides are lined correctly.
- Adjust the striker height by first closing the cover and measuring the gap between the cover and side rails top surface. The gap should be 9.0 mm at the rear, adjust strikers accordingly.
- Tighten the striker nuts to 30.0Nm.
- Repeat for LHS

Note: Do Not Close the tailgate.

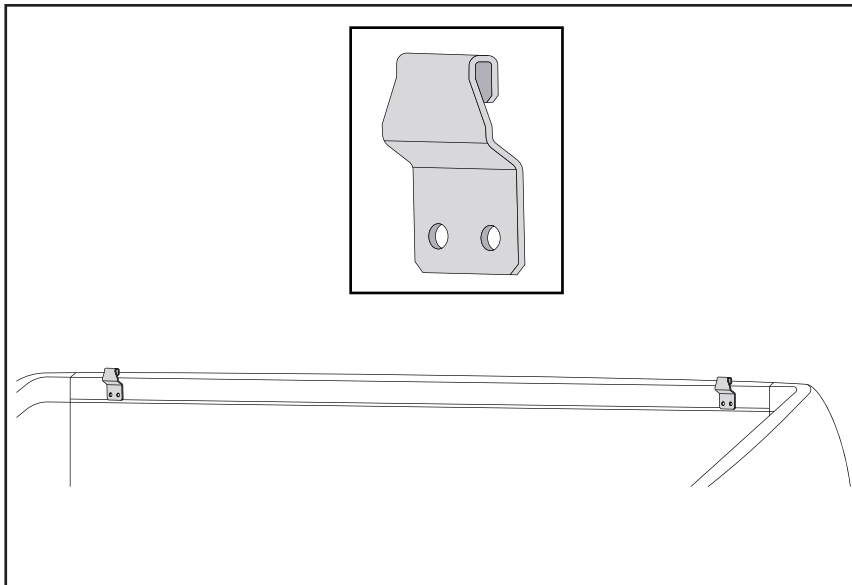

Step 23

Note: Tailgate locking brackets are included for added security, if you already have tailgate lock installed or do not require this feature, please go to step 28.

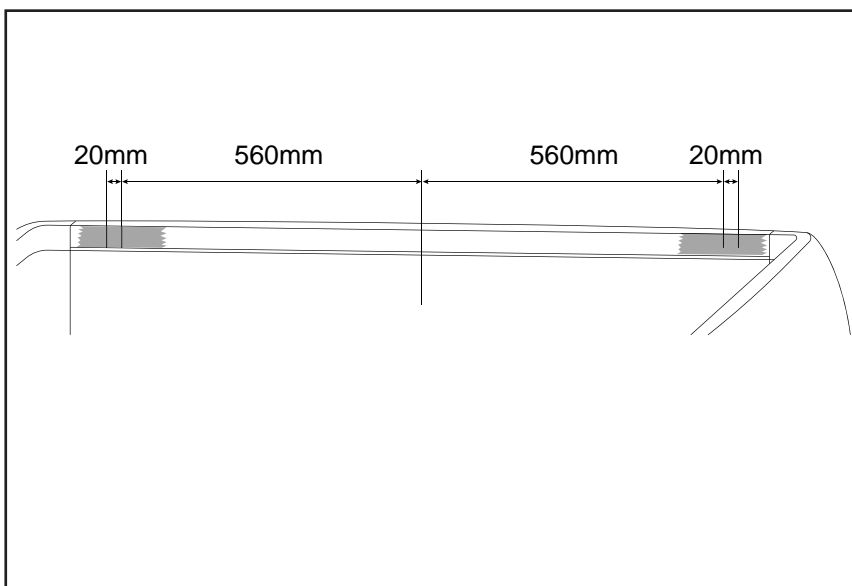

Step 24 (Optional)

Required tools: Masking Tape, Marker Pen and Tape Measure.

- Apply masking tape on both corner of the tailgate top surface and first 30 mm of inner surface.
- Mark a centre line accurately. Mark lines 560.0mm from the centre line to both sides.
- Mark another line 20.0 mm outboard from this line.

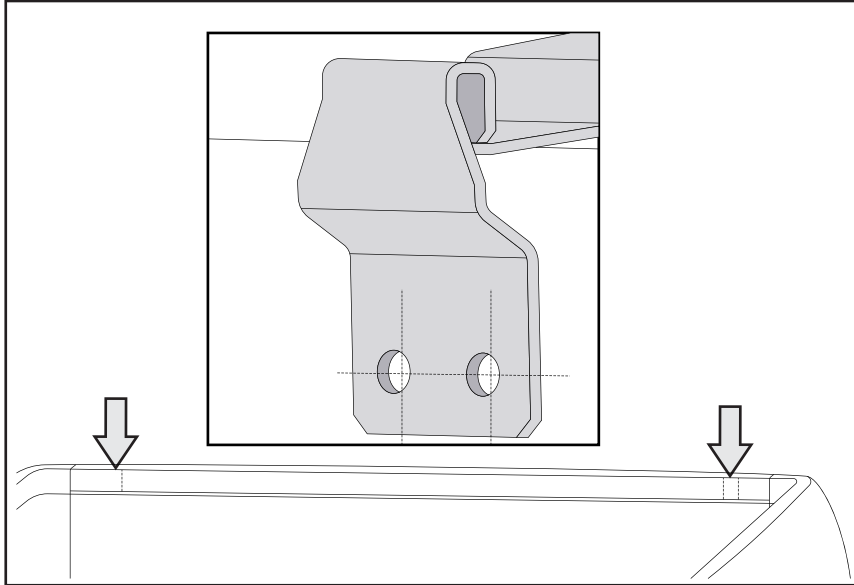
**Step 25 (Optional)****Required tools:** Marker Pen

- Align tailgate lock bracket with marked lines to confirm hole location.
- Use the other bracket to create a gap between the tailgate top surface and tailgate lock bracket, as shown. Mark the centre of the two holes.
- Repeat for the other side.

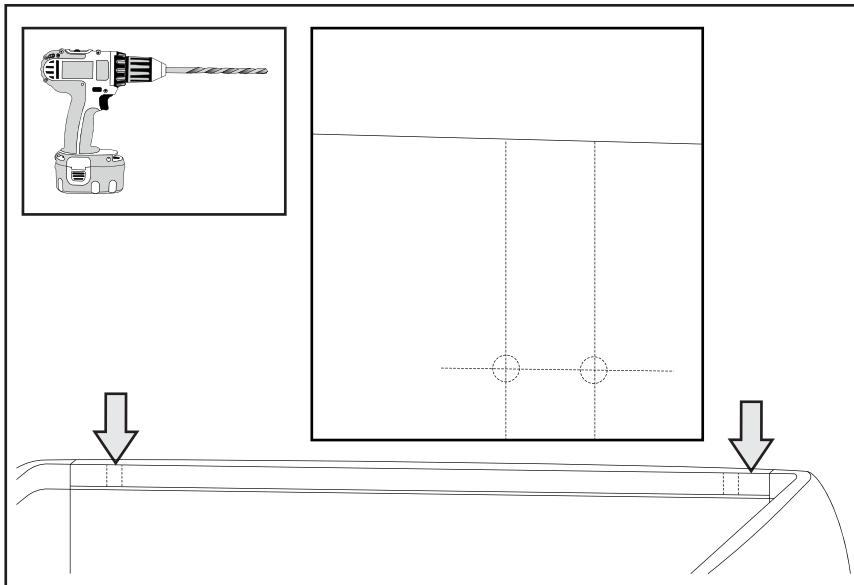
**Step 26 (Optional)****Required tools:** Centre punch, hammer, drill, 5mm drill bit, drill bit stopper.

- Centre punch the four hole locations.
- Drill holes using a 5.0 mm drill bit and drill stopper.
- Remove drill burr from the holes.
- Apply rust inhibitor to the drilled holes.

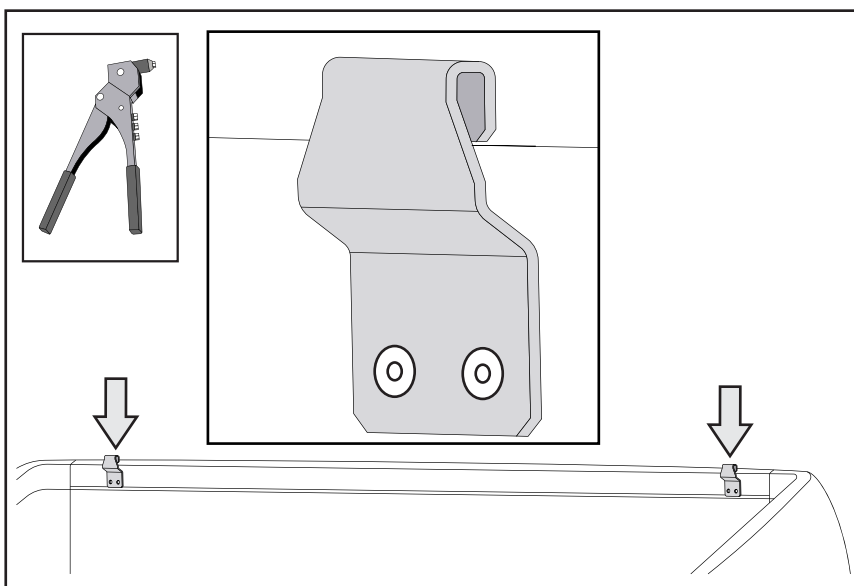
**Step 27 (Optional)****Required tools:** Rivet gun.

- Install the tailgate lock brackets with supplied 4.8x10mm rivets.

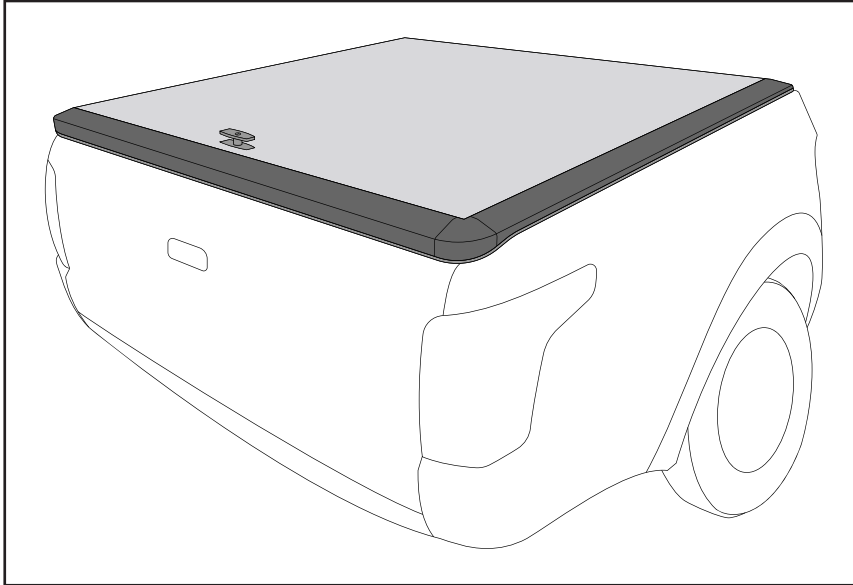
**Step 28 (Optional)**

- Ensure all the parts are correctly installed.
- Open the tailgate.
- Close the cover slowly and ensure locking mechanism functions correctly. Repeat ten times.
- Fully open the cover.
- Close the cover again slowly ensuring the tailgate lock brackets are lined up correctly (if installed) and the cover closes fully.

Note: Ensure the keys do not get locked inside the tub.