

WARNING!

When in the closed position, Aluminium Tonneau Cover must be latched and tailgate must be closed. Failure to do so could result in unexpected opening of the Tonneau Cover from sudden wind gusts or driving conditions, which could cause damage to the vehicle and/or your Aluminium Tonneau Cover.

Secure any items tall enough to strike the Tonneau Cover lock mechanism.

DO NOT close the Tailgate when the Aluminium Tonneau is in the closed position, as damage may occur to the vehicle and/or your Tonneau Cover.

Do not operate vehicle while cover is open.

MAINTENANCE:

- Avoid the use of chemicals to clean painted surfaces, wash regularly with car wash detergent, hose off and chamois dry. Aluminium top sheet finish can be maintained with briteshine polish or similar. Un-maintained product i.e. surface finish degradations not covered by warranty.
- The gas struts are self lubricating and should only be cleaned occasionally with a damp cloth. Premature seal failure will result if solvents or lubricants are used to clean struts.
- Gas struts must be connected with the cylinder (wide) end to the Aluminium Tonneau Cover or Warranty is Void.
- The locking mechanisms and latches only require occasional lubrication with Graphite Powder.
- DO NOT use any other lubricants or oils. Using alternative products will VOID Warranty.
- All installation hardware and fasteners must be checked every so often for tightness.

TONNEAU COVER - IMPORTANT:

- Read instructions carefully before installation. It is strongly recommended that installation is conducted by a qualified mechanic.
- This product must be installed exactly as specified in these instructions. Failure to do so may result in improper fit and/or retention.
- Do not stand/sit or rest heavy objects on Tonneau Cover.
- Humans or animals are not to be under the closed Tonneau Cover at any time.
- Securely latch Tonneau Cover before operating vehicle.
- Do not carry open volatile chemicals with Tonneau Cover installed.
- If contact with volatile chemicals occurs clean Tonneau Cover with mild detergent and water solution.
- Recommend installation by 2 people.
- Fitting Instructions must be given to the end customer to understand correct removal and replacement process onto the vehicle.

Care Instructions:



Clean Tonneau Cover with a mild detergent and water solution.



Do not use abrasive cleaners or solvents.

Tonneau Cover Assembly x1	Hinge Bracket x2	Striker Bracket x2	Striker x2
M10 Nut x8	M10 Washer x8	Gas Strut x2	Ball Stud x4
M8 Nyloc Nut x8	M8 Washer x6	Gas Strut Bracket x2	M6 Button Head Cap Screw x4
M6 Washer x4	Hinge Bracket Fixing Plate x2	4.8x10 Rivets x12	Tailgate Lock Bracket x2
Rust Inhibitor			

REQUIRED TOOLS | EQUIPMENT



- 13mm and 17mm Socket
- 8mm, 13mm and 17mm Spanner
- Power Drill
- 5mm Drill Bit
- 8mm Drill Bit
- Phillips Head Screwdriver
- Jigsaw

- 4mm Allen Key
- Rivet Gun (air powered)
- Tape Measure
- Centre Punch
- Hammer
- Pencil / Marker
- Cleaning Materials

- Masking Tape
- Right Angle
- Personal Protective Equipment: Safety Glasses, Ear Plugs, Gloves (Scissors, Silicone)* Optional

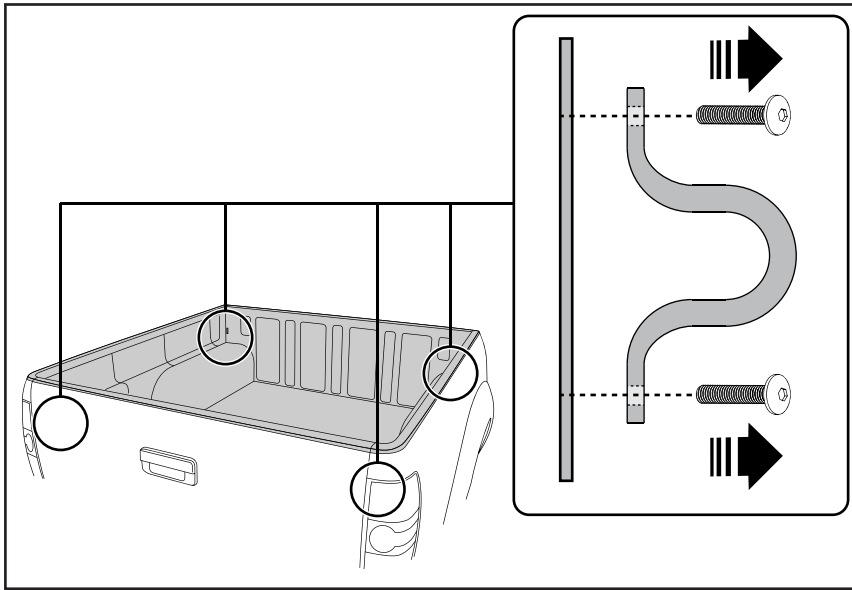

Step 1

Required tools: 4mm Allen key

- Remove and retain the utility hoops and hardware from the tubliner.

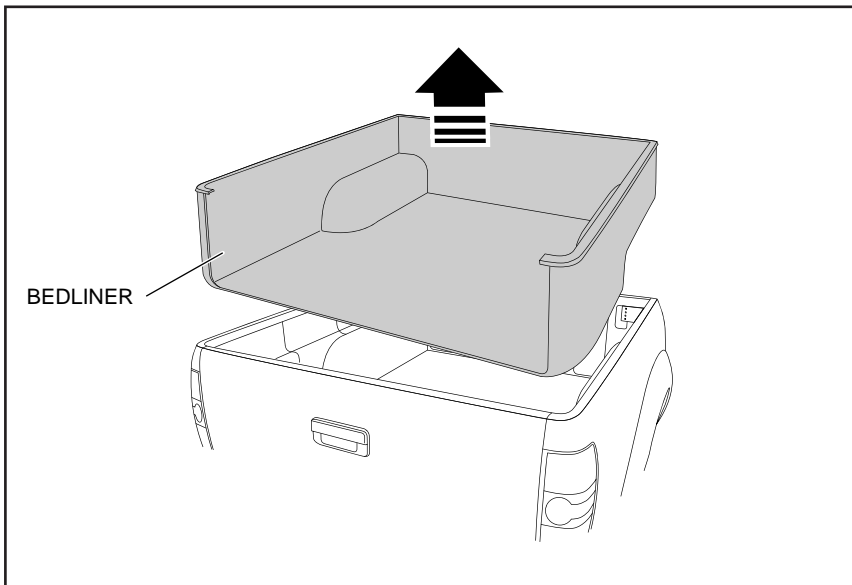

Step 2

- Remove the tubliner from the tub.

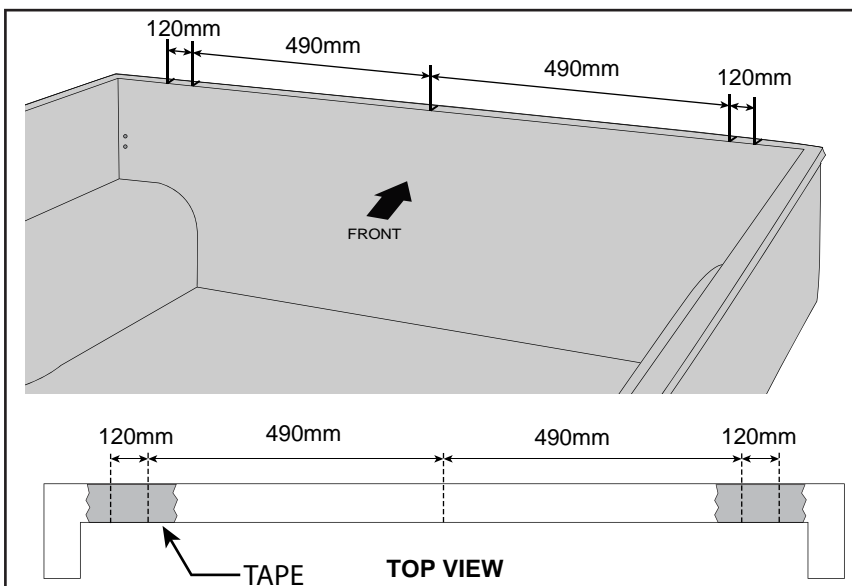

Step 3

TUBLINER TRIM

Required tools: Masking Tape, Marker Pen, Tape Measure and cutting tool.

- Apply masking tape on the tubliner front top surface
- Accurately mark a line at the centre of the front rail.
- Mark 4 lines: 490mm from the centre line and another 120mm outward from that.
- Using the lines as a guide, cut the segments out.

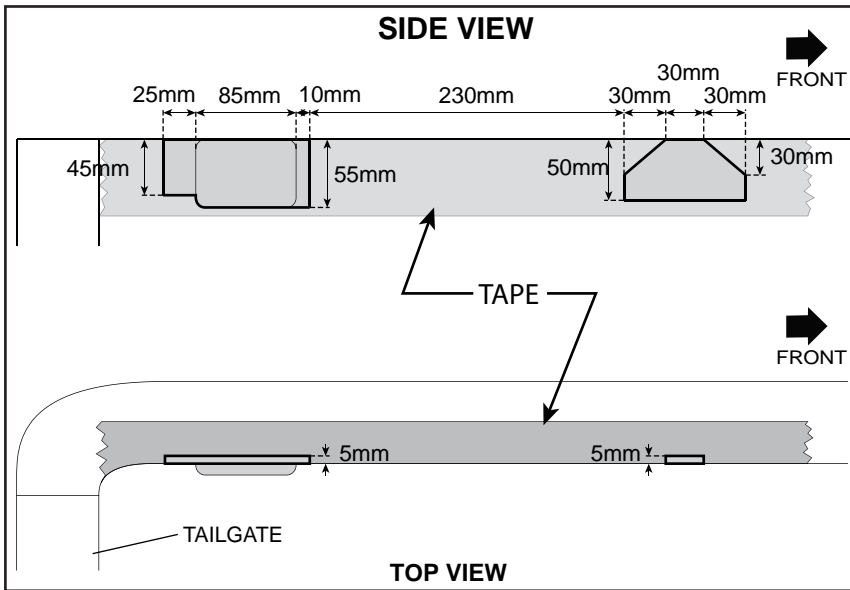

Step 4

TUBLINER TRIM

Required tools: Masking Tape, Marker Pen, Tape Measure and cutting tool.

- Apply masking tape on front rail top and inside surface.
- Noting the rectangular protrusion in the tub liner, accurately mark a line 25mm back from it and 10mm forward of it.
- Mark two lines, 45mm and 55mm down from the top edge of the tub, connecting to the protruded part of the tub, as shown.
- Mark two lines, 230mm forward from the previous marking, and another 90mm forward from that, as shown.
- Mark a line 50mm down from the top edge of the tub.
- Using the lines as a guide, cut the segments out.

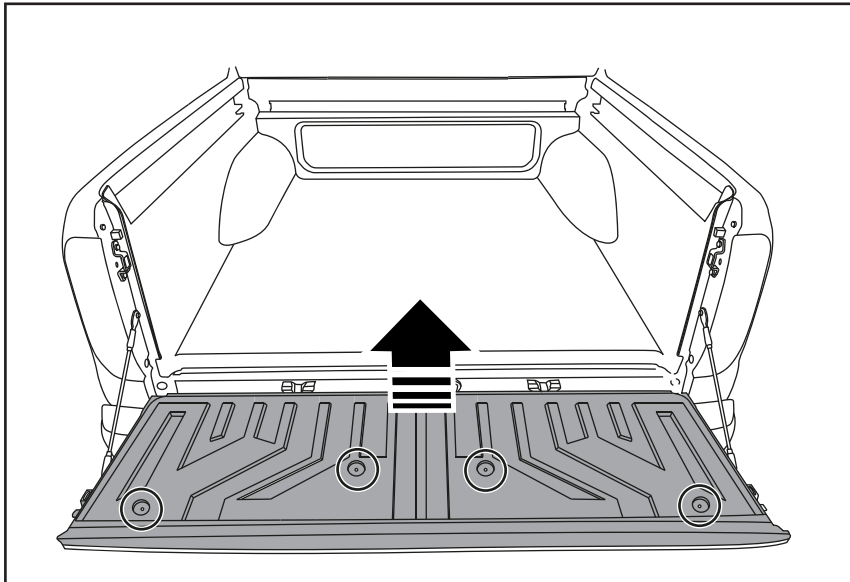

Step 5

TUBLINER TRIM

Required tools: Philips Head Screwdriver

- Remove the 4 screws securing the tailgate liner to the tailgate. Retain the components.
- Lift the tailgate liner from the tailgate.

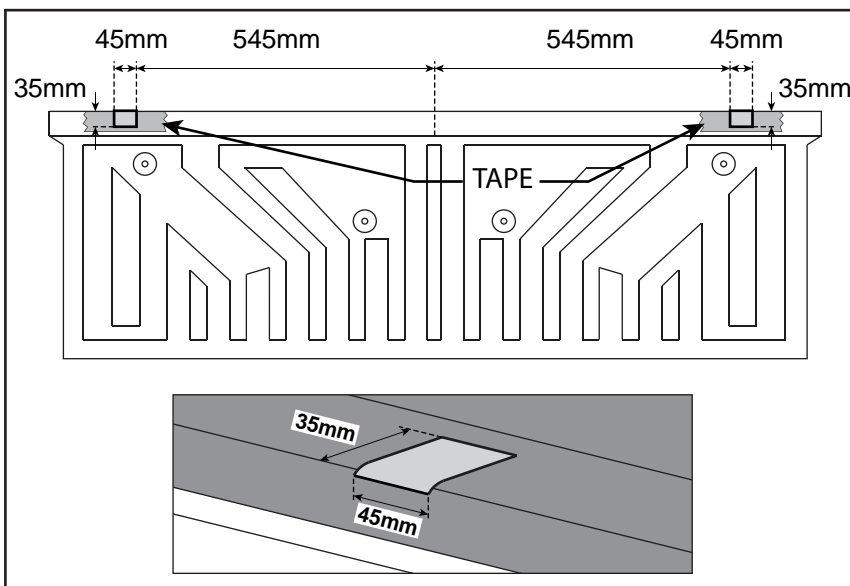

Step 6

TUBLINER TRIM

Required tools: Masking Tape, Marker Pen, Tape Measure and cutting tool.

- Apply masking tape on front rail top and inside surface.
- Accurately mark a line at the centre of the front rail.
- Mark 4 lines: 545mm from the centre line and another 45mm outward on the inside surface.
- Mark a line 35mm back from the inside edge of the tub, connecting the previous lines on the inside surface.
- Using the lines as a guide, cut the segments out.

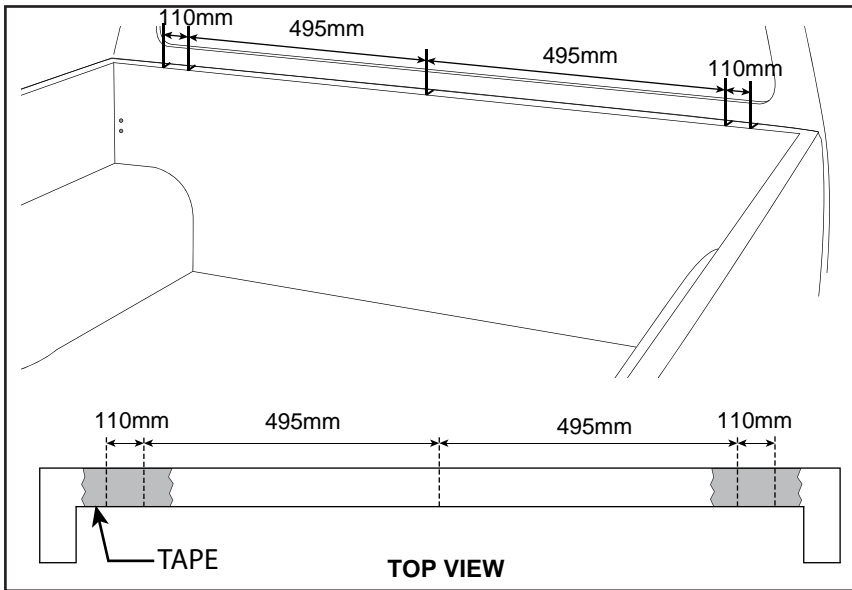

Step 7

Required tools: Masking Tape, Marker Pen and Tape Measure.

- Clean the top surface of the tub.
- Apply masking tape on front rail top surface
- Accurately mark a line at the centre of the front rail.
- Mark 4 lines: 495mm from the centre line and another 110mm outward from that.

Note:

If fitted, cabin guard must be removed.
If installed, utility-track must also be removed.

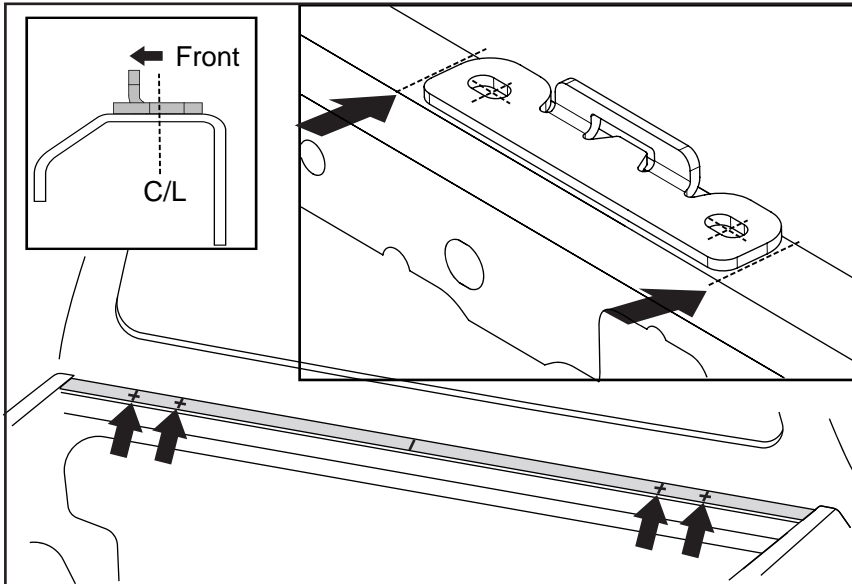

Step 8

Required tools: Masking Tape, Marker Pen and Tape Measure.

- Position Hinge Bracket between the marked lines and in the center of the tub top surface as shown in detail. Mark the slot centers.
- Repeat for both sides.

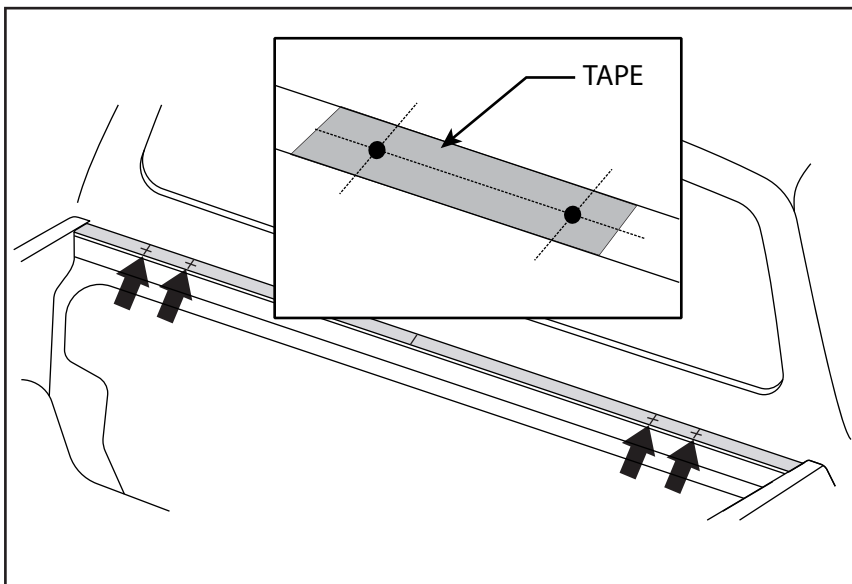

Step 9

Required tools: Power drill, 8mm drill bit and drill bit stopper, centre punch, hammer.

- Centre punch the two hole locations.
- Drill holes using a 8mm drill bit.
- Remove drill burr from the holes.
- Apply rust inhibitor to the drilled holes.
- Repeat for other side.

Note: Use drill stopper set at 10mm to avoid drilling too deep.

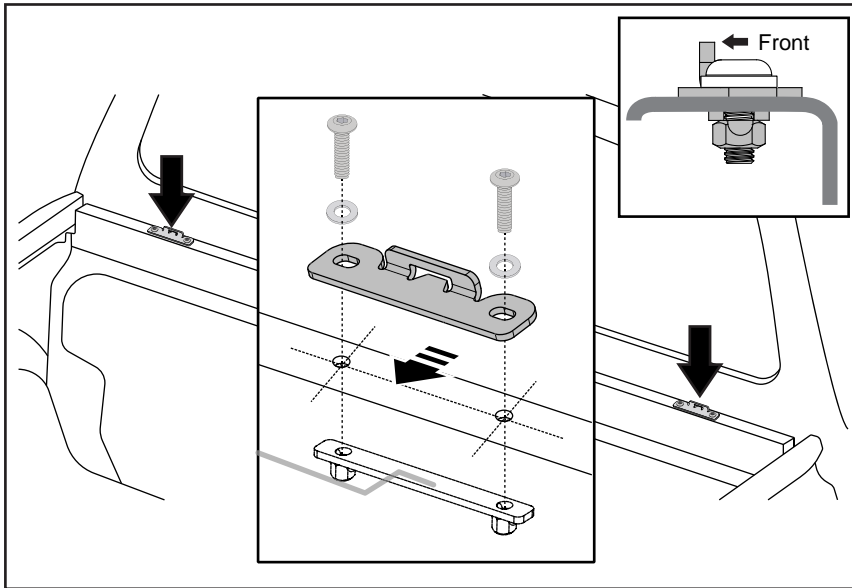

Step 10

Required tools: 4mm Allen Key.

- Position hinge bracket fixing plate inside the tub front rail, holding it by the wire to allow positioning the plate under the holes.
- Position hinge bracket and secure with supplied M6 bolts and M6 washers to the hinge fixing bracket. Finger tighten only.
- Repeat for both sides.

Note: Bend attached fixing plate wire as required to aid installation.

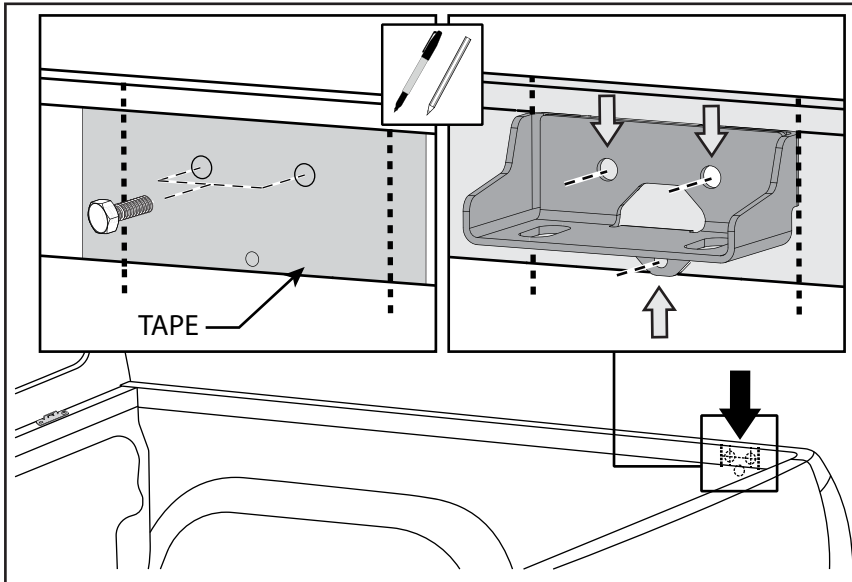

Step 11

Required tools: Marker Pen, power drill, 5mm drill bit and drill bit stopper, centre punch, hammer.

- Remove bolts from the side rail toward the rear of the tub on each side and retain.
- Apply masking tape to the side rail.
- Align the striker brackets with the exposed holes in the side rail.
- Mark the bottom hole location, using the bracket as template and remove the bracket.
- Centre punch the bottom hole location.
- Drill a hole using a 5mm drill bit.
- Remove drill burr from the hole.
- Apply rust inhibitor to the drilled holes.
- Do this for both sides.

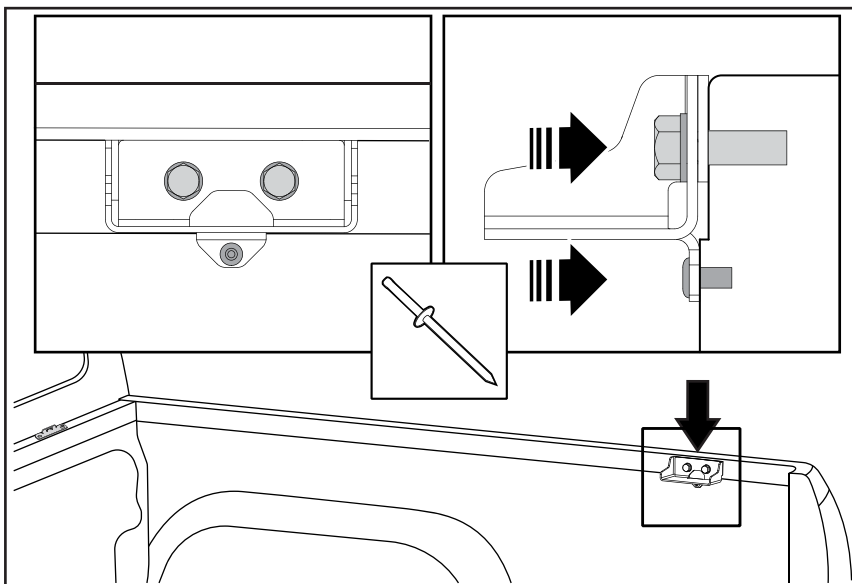

Step 12

Required tools: 13mm spanner, 13mm socket and driver, rivet gun.

- Install the bracket using the retained bolts and supplied M8 washers.
- Rivet the bottom of the bracket with a 4.8x10mm rivet.
- Repeat for other side.

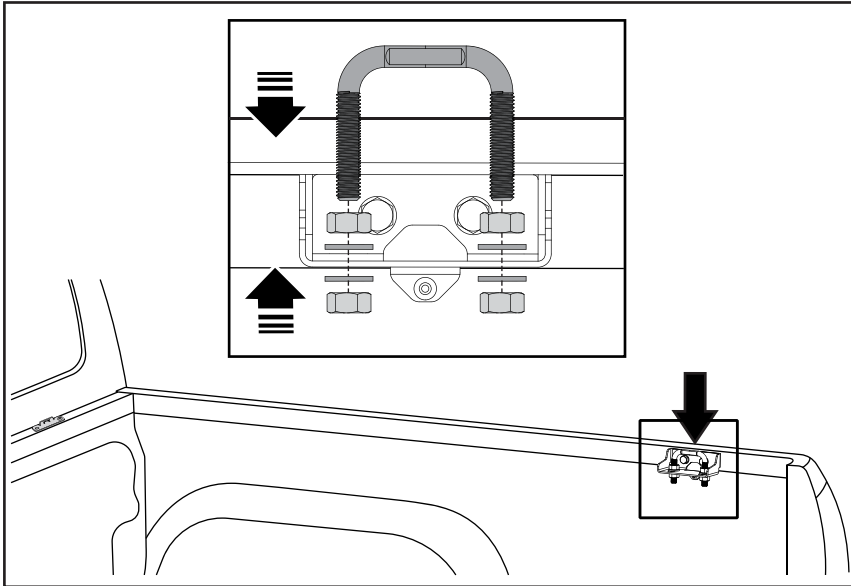

Step 13

- Loosely assemble the striker, M8 nuts and M8 washers to the striker bracket.

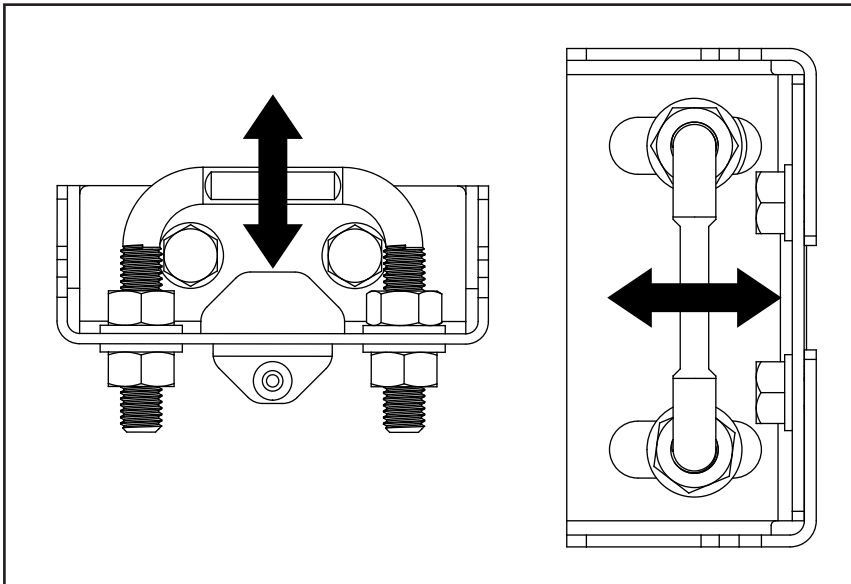

Step 14

Required tools: 13mm spanner, 13mm socket and driver.

- Slowly close the cover and move the striker sideways to line it up with the latches. Ensure both sides are lined correctly.
- Adjust the striker height correct by first closing the cover and measuring the gap between the cover and side rails top surface. The gap should be 9.0 mm at the rear, adjust strikers accordingly.
- Tighten the striker nuts to 30.0Nm.

Note: Do Not Close the tailgate.

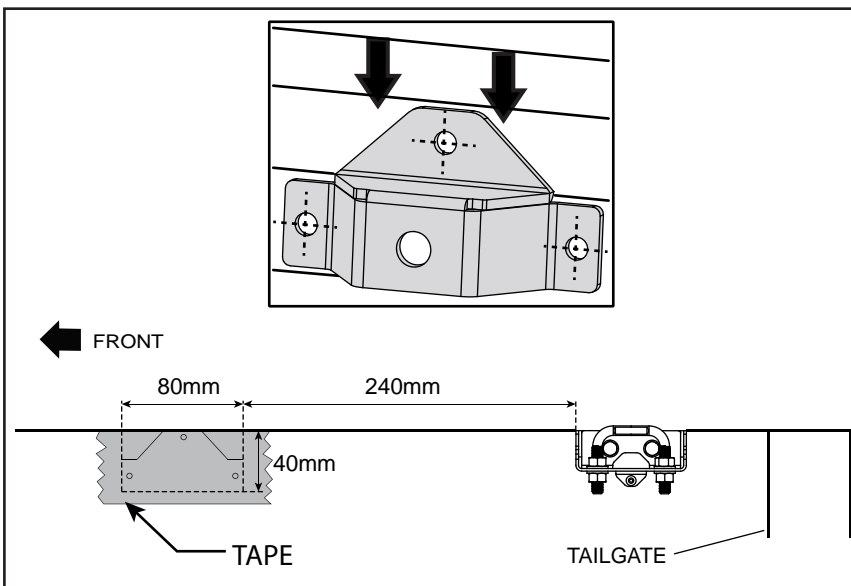

Step 15

Required tools: Masking Tape, Marker Pen, Tape Measure, Power drill, 5mm drill bit and drill bit stopper, centre punch, hammer.

- Apply masking tape to the side rail inner surface and measure 240mm from the striker bracket and mark location.
- Mark a line 80mm from the previous mark.
- Mark a line 40mm from the top edge of the side rail, crossing both lines.
- Align Gas Strut Bracket with marked lines mark hole locations.
- Remove the bracket and centre punch the two hole locations.
- Drill holes using a 5mm drill bit.
- Remove drill burr from the holes.
- Apply rust inhibitor to the drilled holes.
- Repeat for other side.

Note: Use drill stopper set at 10mm to avoid drilling too deep.

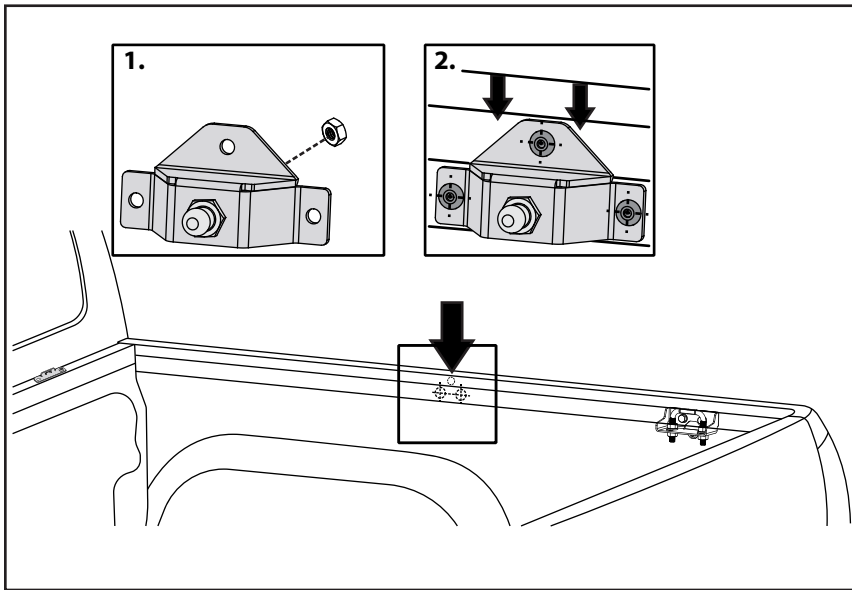

Step 16

Required tools: Rivet gun, 13mm spanner and 13mm socket and driver.

- Install the ball stud to the bracket with a nyloc nut and tighten it to 20.0 Nm.
- Install the gas strut bracket with supplied 4.8x10mm rivets.
- Repeat for both sides.

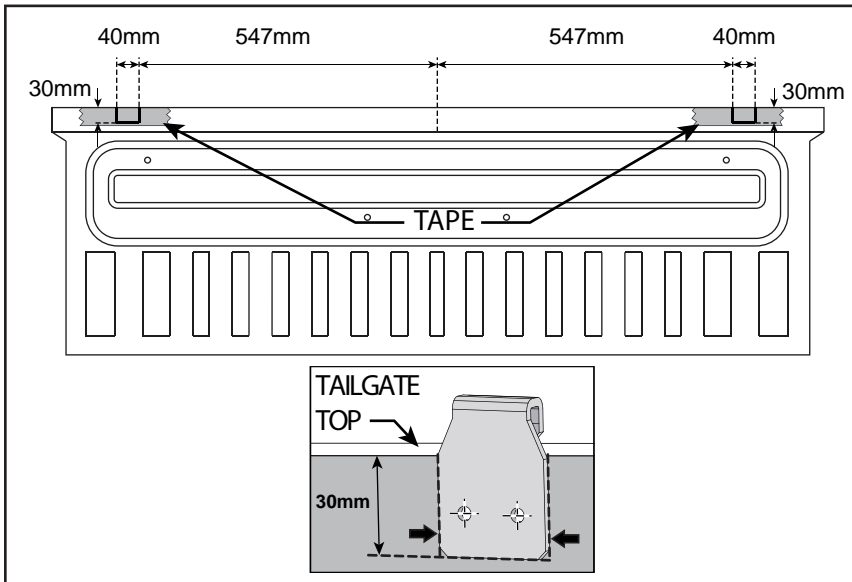

Step 17

Required tools: Masking Tape, Marker Pen and Tape Measure.

- Apply masking tape on both corners of the tailgate top surface and first 50mm of inner surface.
- Mark a centre line accurately.
- Mark a line 547mm either side of the centre line.
- Mark a line 40mm from the previously mark.
- Mark a line 30mm down from the tailgate top.
- Align the tailgate lock bracket between the marked lines.
- Mark the top locations, using the bracket as a template.
- Repeat for the other side.

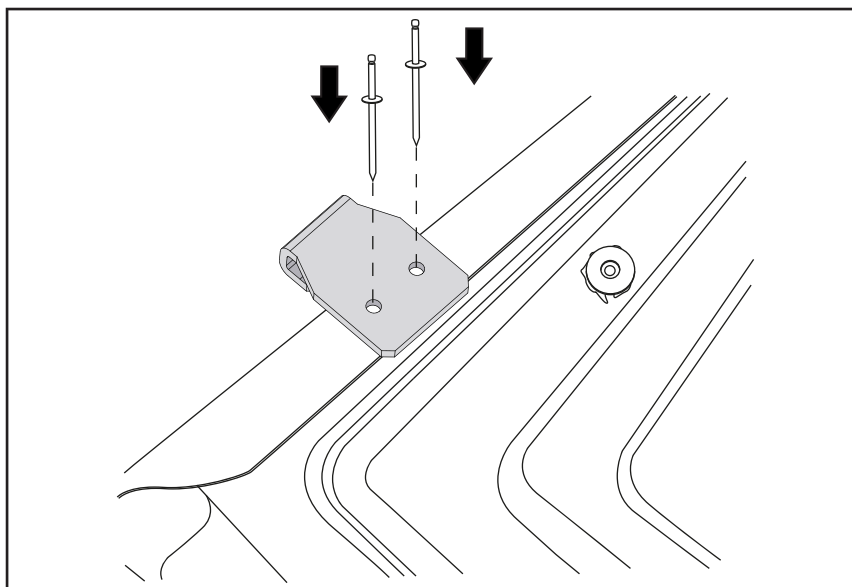

Step 18

Required tools: Rivet Gun

- Fix the bracket in place using the supplied 4.8x10 rivets.
- Note:** Use the bottom holes on the bracket as indicated.
- Reinstall the tailgate liner

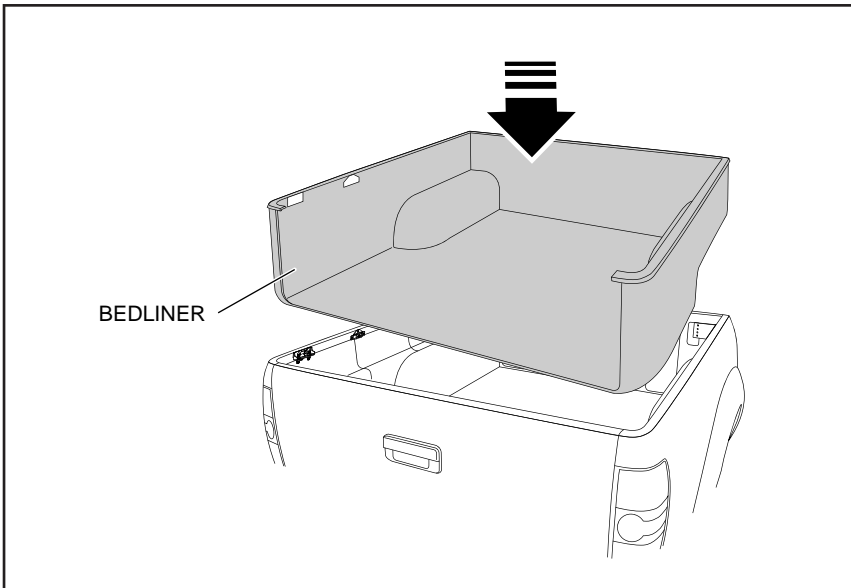

Step 19

- Reinstall the tubliner, ensuring the alterations to the liner align neatly with the brackets on the tub.

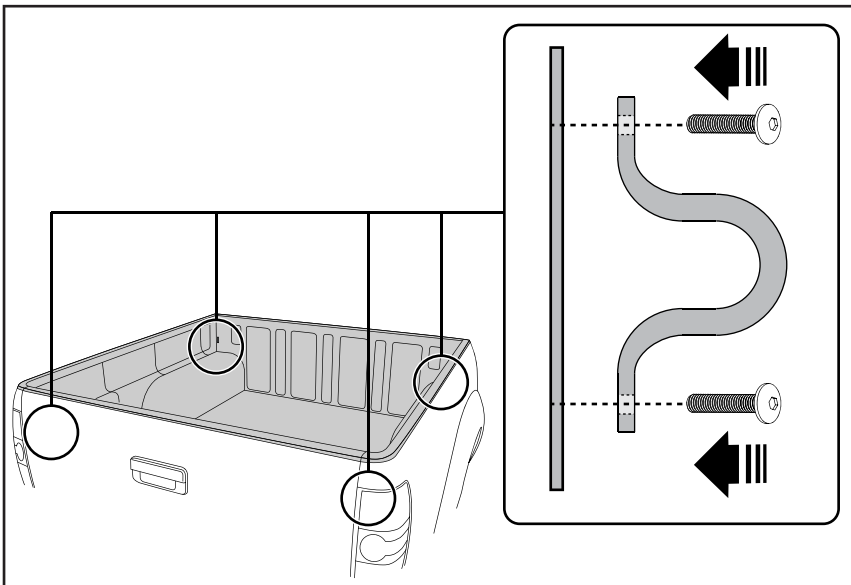

Step 20

Required tools: 4mm Allen key

- Reinstall the bracket hoops through the tubliner into the tub using the existing hardware, and tighten to 15Nm.

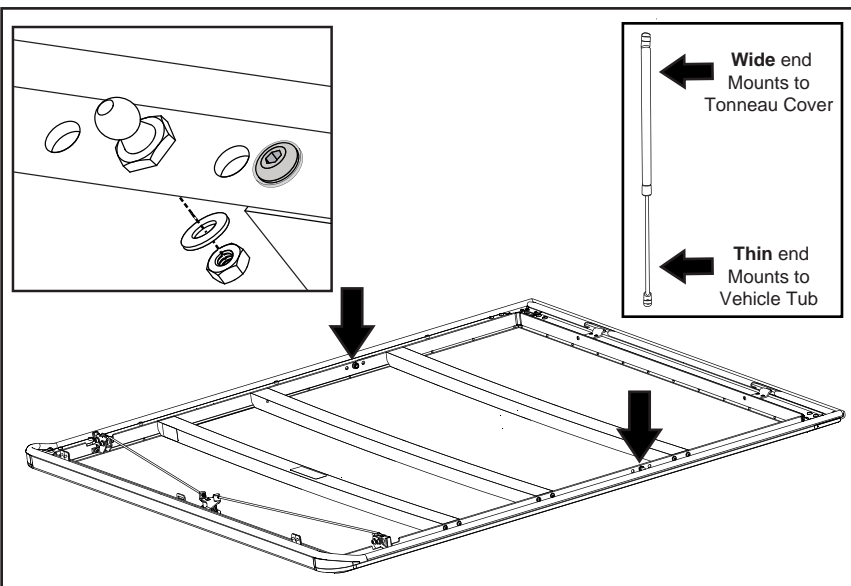

Step 21

Required tools: 13mm spanner, 13mm socket and driver.

- Install the ball stud with supplied nylock nut and M8 washer in the middle hole of the Tonneau. (Ball Stud to outside).
- Connect the wide end of gas strut by pressing it onto the ball stud.
- Repeat for both sides.

Note: The opening height of the tonneau cover can be adjusted by fixing the ball studs in either holes illustrated.

Note: Ensure the gas strut is installed in the correct orientation as shown. The wide end connects to the Tonneau cover.

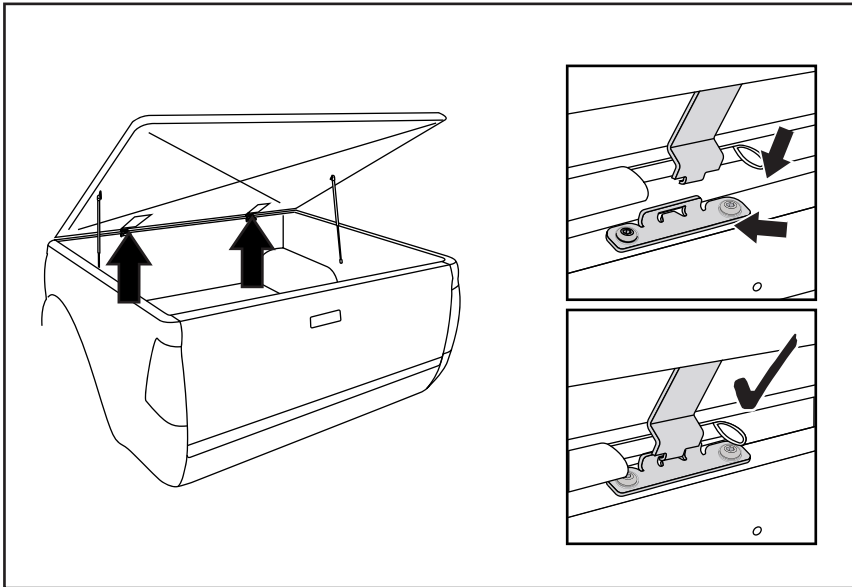
**Step 22**

- Install the cover by letting the hinge tongue to rest on front of the hinge groove while holding the cover in a 60° angle.
- Move the cover toward the vehicle cabin to slide the tongue to the groove, ensure hinge parts fully engage.
- **Do not lower the cover yet.**

Note: When lowering the cover, ensure the front seal is not crushed between the front rail and the cover.

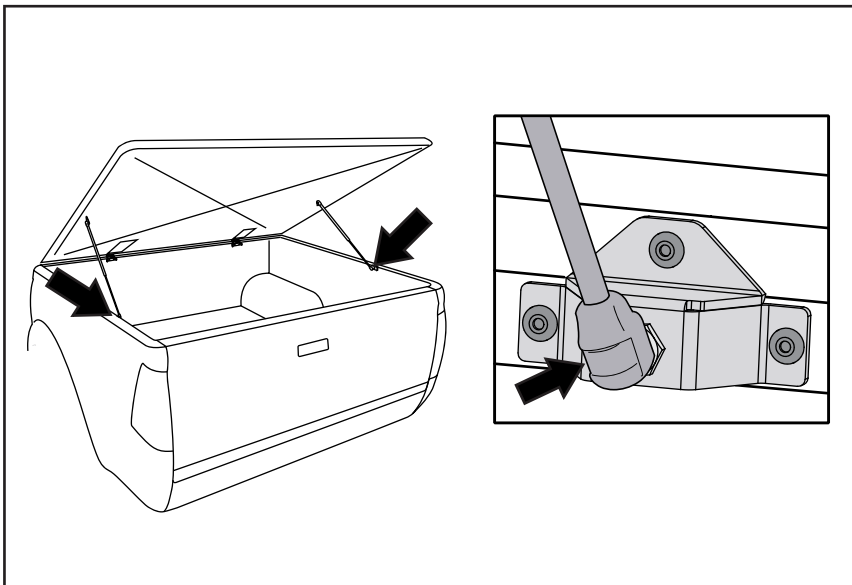
**Step 23**

- Attach gas struts to brackets by clipping into place. Ensure narrow end mounts to the vehicle.

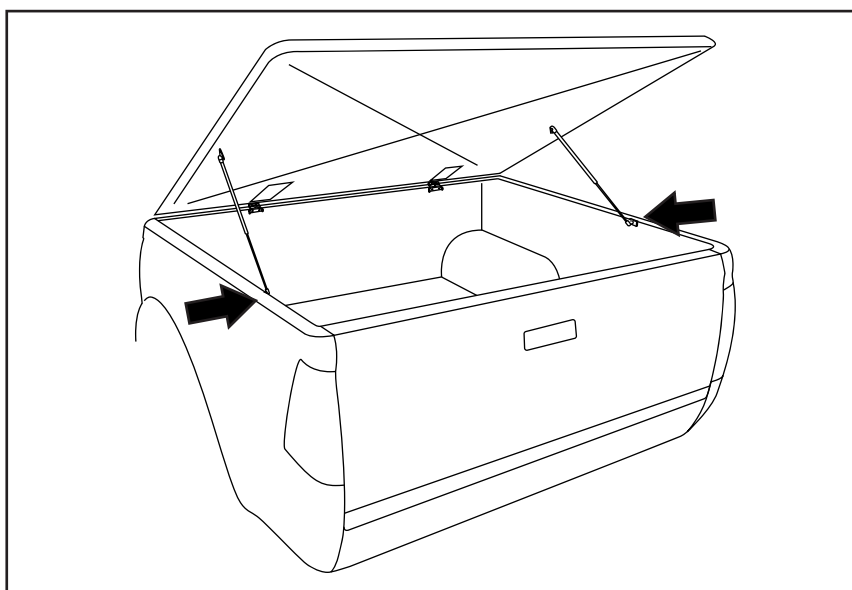
**Step 24**

- Close the cover by pulling from the handle and slowly close it while checking that the cover is correctly lined up to the tub and the latch mechanisms are not touching the tub's side rails.
- Once confirmed the cover is lined up correctly, leave it fully open.

Note: If the cover does not line up correctly, move hinge parts mounted to the front rail forward or backward, one at the time.

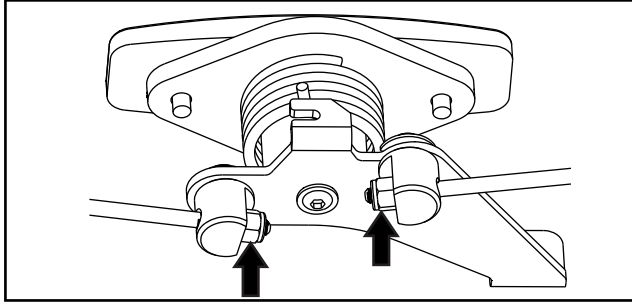
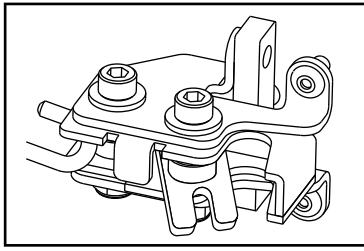
**Step 25**

Required tools: 8mm Spanner.

- While the cover is open and tailgate is open. Press the latch rotor to closed position, both sides.
- Rotate the handle slowly to clock-wise, ensure both latches disengage at the same time. Adjustment may be required.

Note: Mechanism can be adjusted by tightening or loosening the latch rod M5 nuts from underneath the cover.

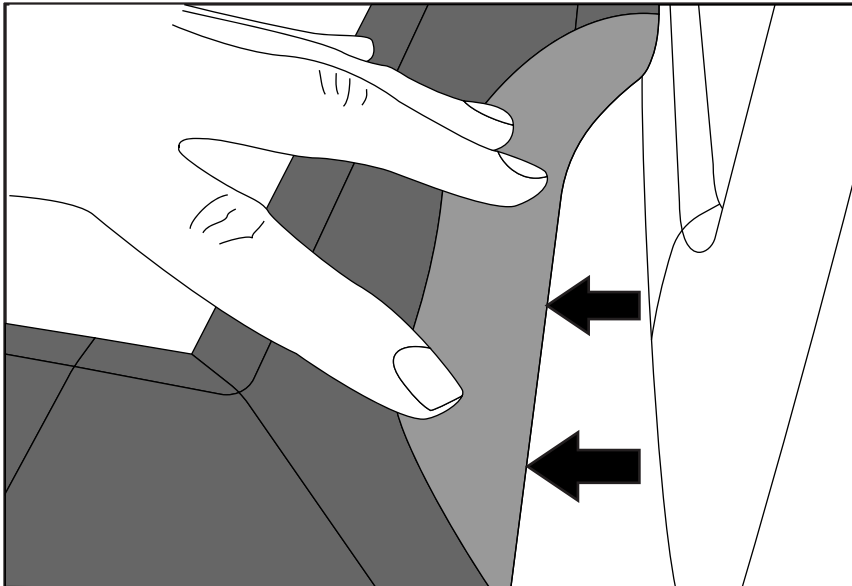
**Step 26**

- While the cover is open, check the front seal's lip is not trapped between the cover and the front rails by bending it up.

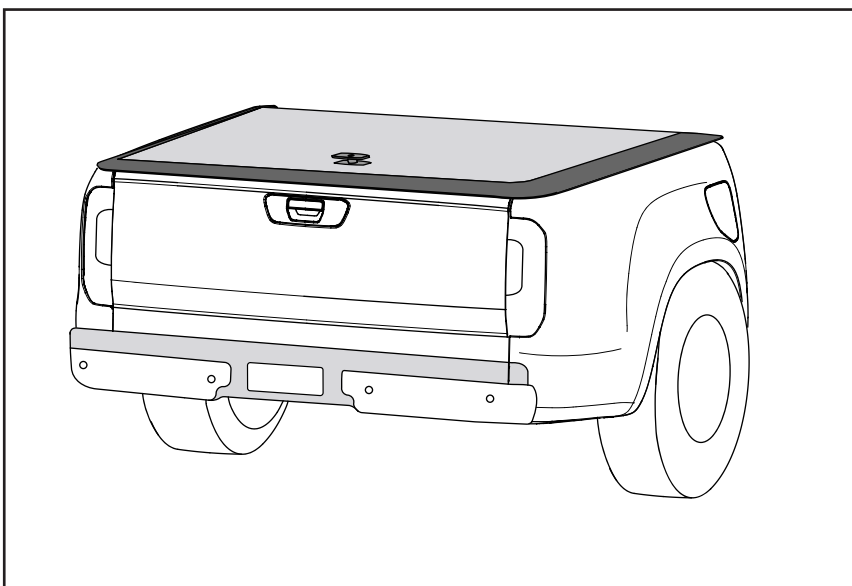
**Step 27**

Note: Ensure the keys do not get locked inside the tub.

- Ensure all the parts are correctly installed.
- Open the tailgate.
- Close the cover slowly and ensure locking mechanism functions correctly. Repeat 2-3 times.
- Fully open the cover.
- Close the cover again slowly ensuring the tailgate lock brackets are lined up correctly (if installed) and the cover closes fully.