**WARNING!**

- When in the closed position, Aluminium Tonneau Cover must be latched and tailgate must be closed. Failure to do so could result in unexpected opening of the Tonneau Cover from sudden wind gusts or driving conditions, which could cause damage to the vehicle and/or your Aluminium Tonneau Cover.
- Secure any items tall enough to strike the Tonneau Cover lock mechanism.
- DO NOT close the Tailgate when the Aluminium Tonneau is in the closed position, as damage may occur to the vehicle and/or your Tonneau Cover.
- Do not operate vehicle while cover is open.

**MAINTENANCE:**

- Avoid the use of chemicals to clean painted surfaces, wash regularly with car wash detergent, hose off and chamois dry. Aluminium top sheet finish can be maintained with briteshine polish or similar. Un-maintained product i.e. surface finish degradations not covered by warranty.
- The gas struts are self lubricating and should only be cleaned occasionally with a damp cloth. Premature seal failure will result if solvents or lubricants are used to clean struts.
- Gas struts must be connected with the cylinder (wide) end to the Aluminium Tonneau Cover or Warranty is Void.
- The locking mechanisms and latches only require occasional lubrication with Graphite Powder.
- DO NOT use any other lubricants or oils. Using alternative products will VOID Warranty.
- All installation hardware and fasteners must be checked every so often for tightness.

**TONNEAU COVER - IMPORTANT:**

- Read instructions carefully before installation. It is strongly recommended that installation is conducted by a qualified mechanic.
- This product must be installed exactly as specified in these instructions. Failure to do so may result in improper fit and/or retention.
- Do not stand/sit or rest heavy objects on Tonneau Cover.
- Humans or animals are not to be under the closed Tonneau Cover at any time.
- Securely latch Tonneau Cover before operating vehicle.
- Do not carry open volatile chemicals with Tonneau Cover installed.
- If contact with volatile chemicals occurs clean Tonneau Cover with mild detergent and water solution.
- Recommend installation by 2 people.
- Fitting Instructions must be given to the end customer to understand correct removal and replacement process onto the vehicle.

**Care Instructions:**

Clean Tonneau Cover with a mild detergent and water solution.



Do not use abrasive cleaners or solvents.

FITTING KIT:

ATC Assembly x1	Strut Bracket x2	Clamp Bracket x2	Load Pad x2
Striker Bracket x2	Gas Strut x2	Hinge Lower x2	Hinge Spacer x2
M6 x 20 Socket Button Head Screw x4	M6 Washer x12	M6 x 20 Hex Head Bolt x4	M6 Rivnut x4
Rivet x6	M6 Nyloc Nut x4	Anti-Rust	Foam Tape

REQUIRED TOOLS | EQUIPMENT

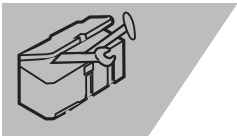

10mm & 16mm Spanners  
Power Drill  
5&9mm Drill Bit  
4mm Allen Key

Rivet Gun (air powered)  
Rivnut Tool  
Automatic Centre Punch  
Pencil / Marker

Masking Tape  
Rust Inhibitor  
Tape Measure  
Cleaning Materials



Personal Protective Equipment:  
Safety Glasses, Ear Plugs, Gloves

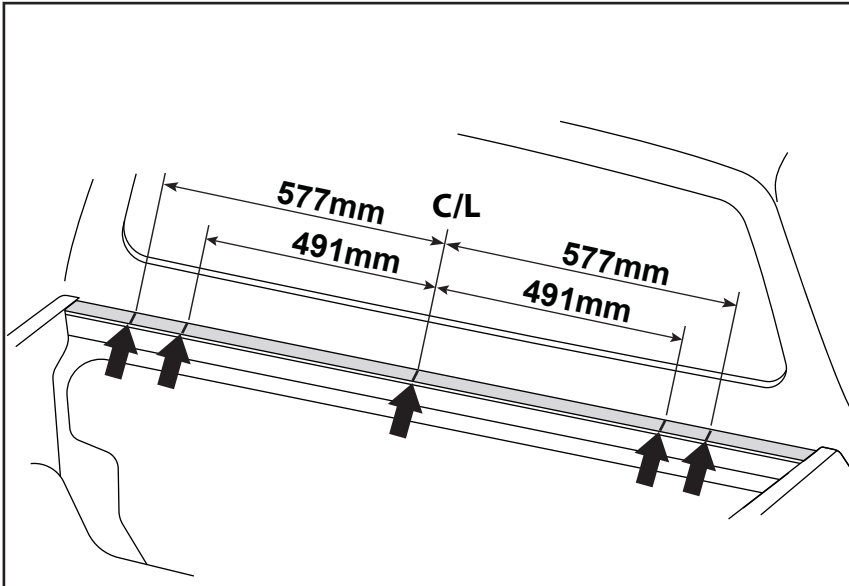

### Step 1

**Required tools:** Masking Tape, Marker Pen and Tape Measure.

- Clean the top surface of the tub.
- Apply masking tape on front rail top surface
- Accurately mark a line at the centre of the front rail.
- Mark 4 lines: 491mm and 577mm either side of the centre line.

**Note:** This instruction is for plain tub installation only. If **tub liner** is fitted, the liner will need to be trimmed to allow correct installation of the tonneau cover brackets and hinges. No spacers or additional media allowed between hinges/brackets and the vehicle tub.

**Note:**

If fitted, cabin guard must be removed.

If installed, utility-track must also be removed.

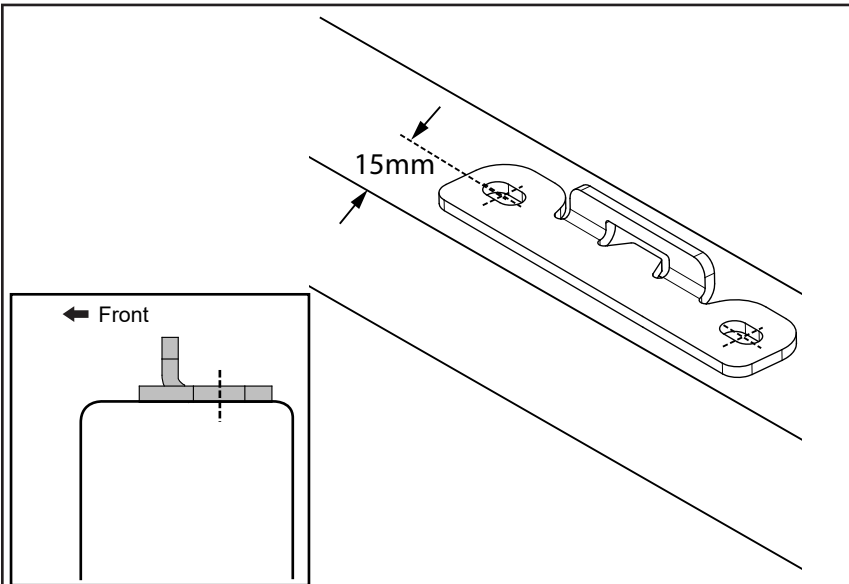

### Step 2

**Required tools:** Masking Tape, Marker Pen and Tape Measure.

- Mark 15mm from the tub inside edge towards the front for the Hinge hole centers as shown.
- Repeat for all 4 holes locations.

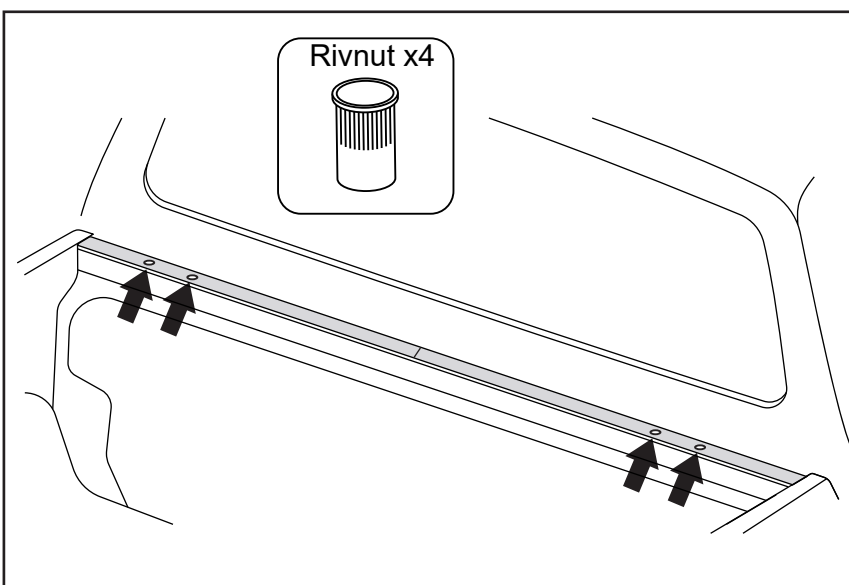

### Step 3

**Required tools:** Power drill, 5&9mm drill bit, automatic centre punch, Rivnut tool.

- Centre punch the 4 hole locations.
- Drill pilot holes using a 5mm drill bit.
- Drill holes using a 9mm drill bit.
- Remove drill burr from the holes.
- Fit 4 Rivnuts using Rivnut Tool.

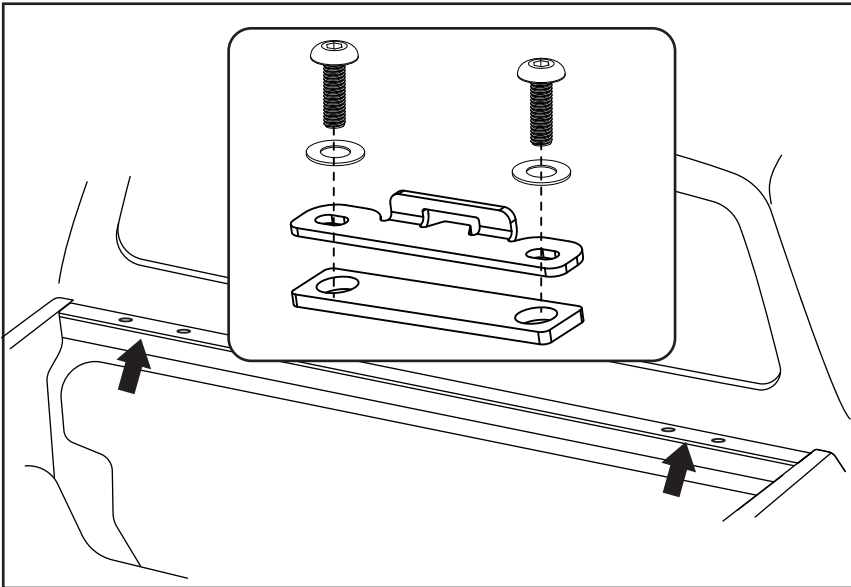

### Step 4

**Required tools:** 4mm Allen Key.

- Position the lower hinge with spacer on the tub and secure with M6 screws and washers.
- Repeat for both sides.

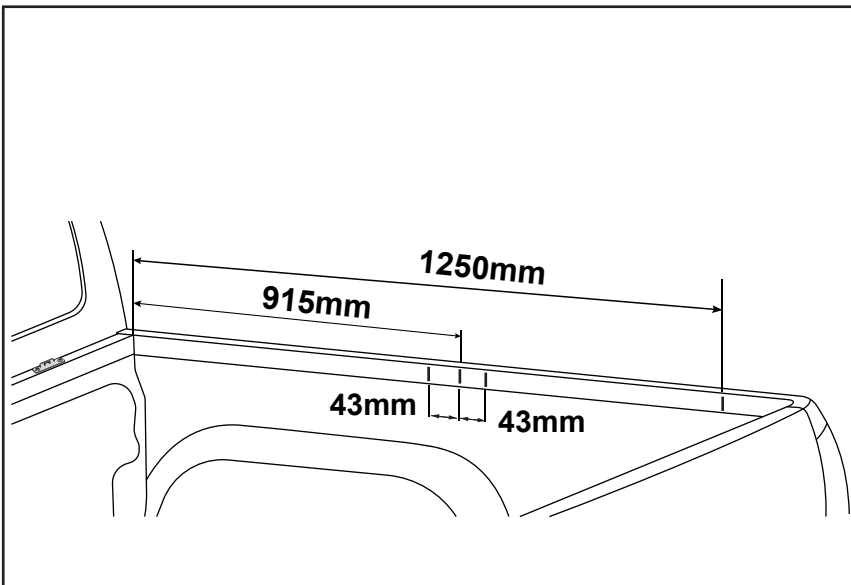

### Step 5

**Required tools:** Masking Tape, Marker Pen, Tape Measure.

- Apply masking tape to the side rail inner surface and measure 915mm and 1250mm from the front rail inner surface, and mark location.
- Mark the vertical lines 43mm on either side of the 915mm centerline as shown.
- Repeat for other side.

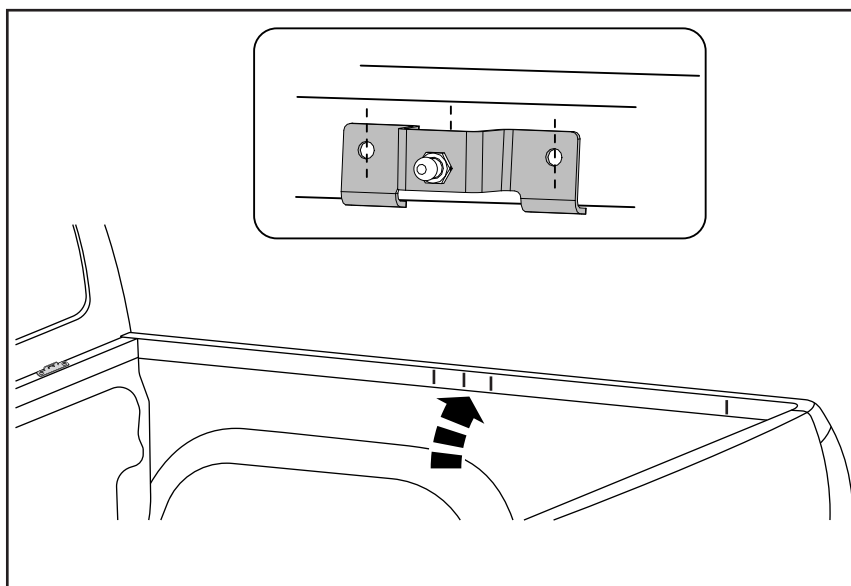

### Step 6

**Required tools:** Masking Tape, Marker Pen, Tape Measure.

- Place the strut bracket on the tub, hard against the tub bottom edge as shown.
- Align the holes center to the marked lines for strut bracket and mark hole positions.
- Remove the bracket and center punch hole positions.
- Drill the two holes with Ø6.5mm drill bit and apply rust inhibitor.
- Repeat for other side.

### Step 7

**Required tools:** 10mm spanner

- Place the load bracket inside the tub behind the sheet metal and fasten the Gas strut bracket using 2 x M6 Hex Head screws and 4 x washers and 2 Nylock nuts.
- Repeat for other side.

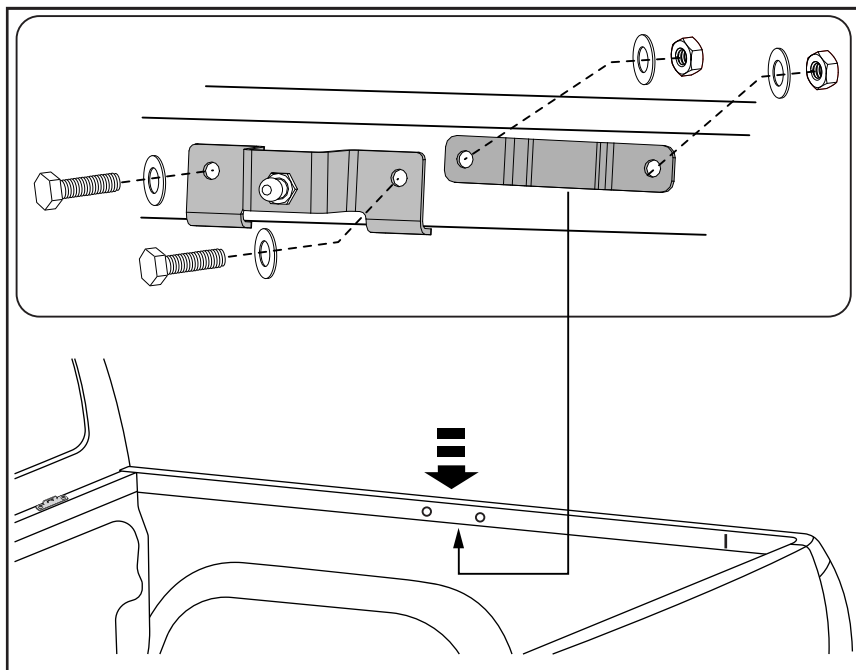

### Step 8

**Required tools:** Marking pen, centre punch, 5mm drill bit.

- Place the Striker bracket on the tub and align the centre hole with previously marked line as shown.
- Push the bracket up so its base touch the bottom edge of tub.
- Mark the 3 holes for the rivets and drill with 5mm drill bit set to 10mm depth.
- Apply rust inhibitor to holes.
- Secure the bracket to the tub using 3 rivets.
- Repeat for other side.

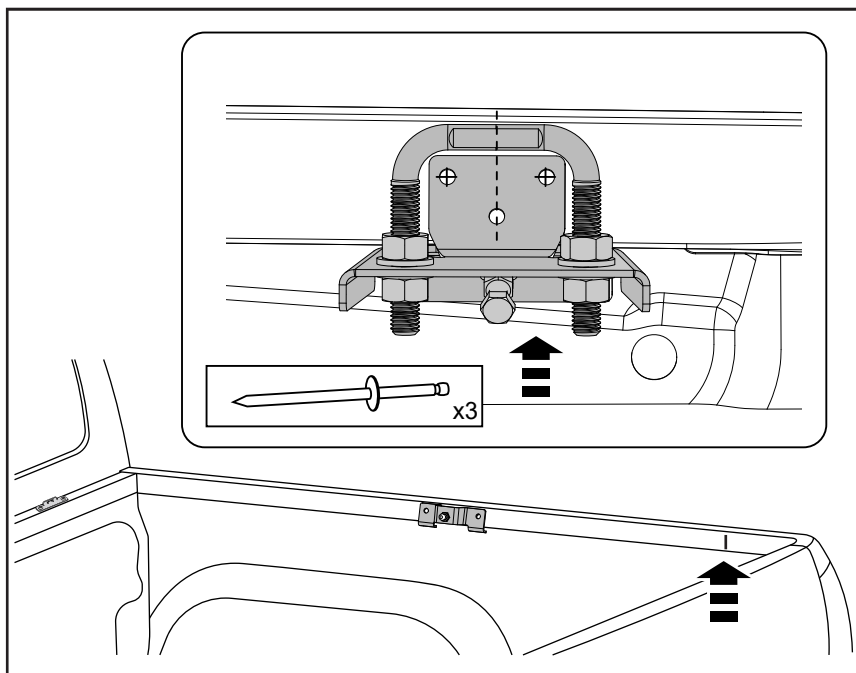

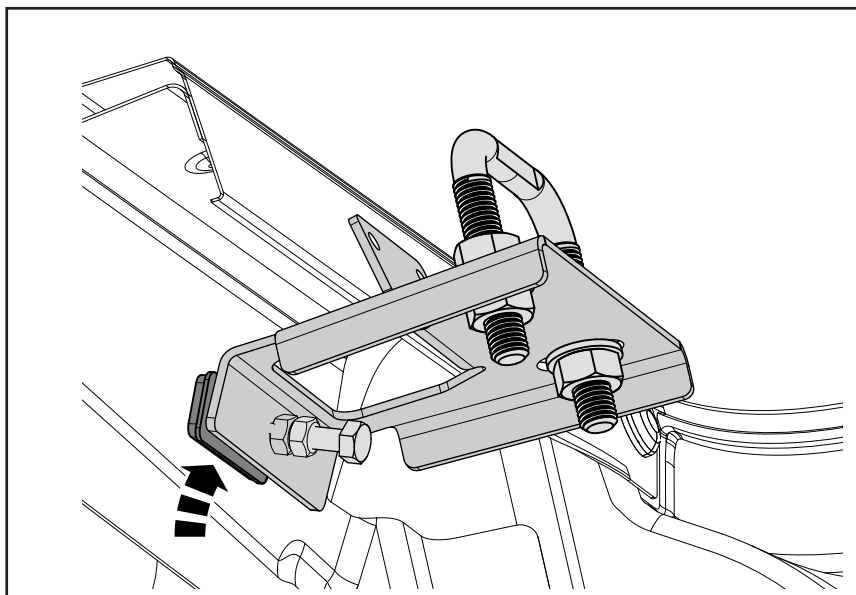

### Step 9

**Required tools:** 10mm spanner

- Place the load plate behind the M6 screw and apply to the tub using the double sided tape.

**NOTE:** Clean the tub with an alcohol wipe and apply suitable primer to activate the tape.

- Adjust the M6 screw till the striker bracket is level with the ground.
- Once in position secure the M6 screw with the M6 hex nut.
- Repeat for other side.

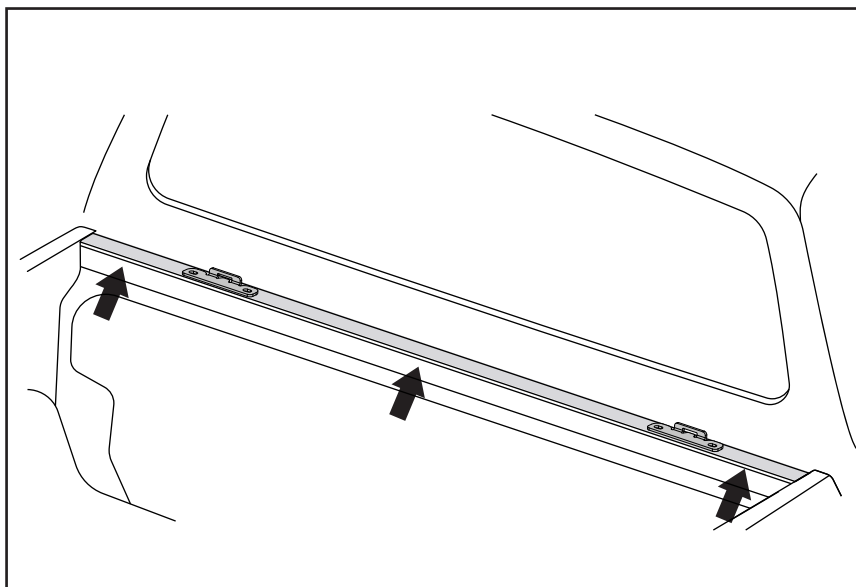

### Step 10

**Required tools:** alcohol wipe,

- Clean top of the tub with an alcohol wipe.
- Apply the supplied EPDM tape along the top of tub.
- Cut the tape into 3 pieces to fit between the hinges.

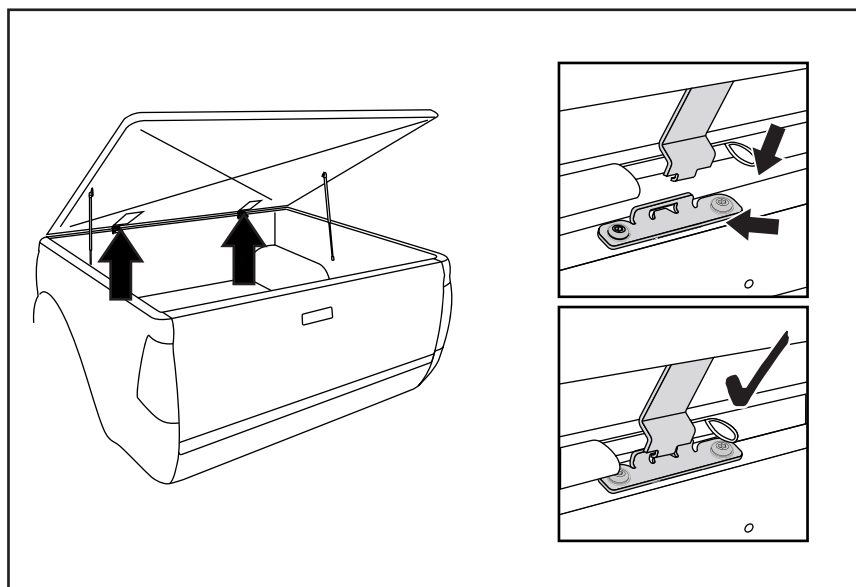

### Step 11

- Install the cover by letting the hinge tongue to rest on front of the hinge groove while holding the cover in a 60° angle.
- Move the cover toward the vehicle cabin to slide the tongue to the groove, ensure hinge parts fully engage.
- **Do not lower the cover yet.**

**Note:** When lowering the cover, ensure the front seal is not crushed between the front rail and the cover.

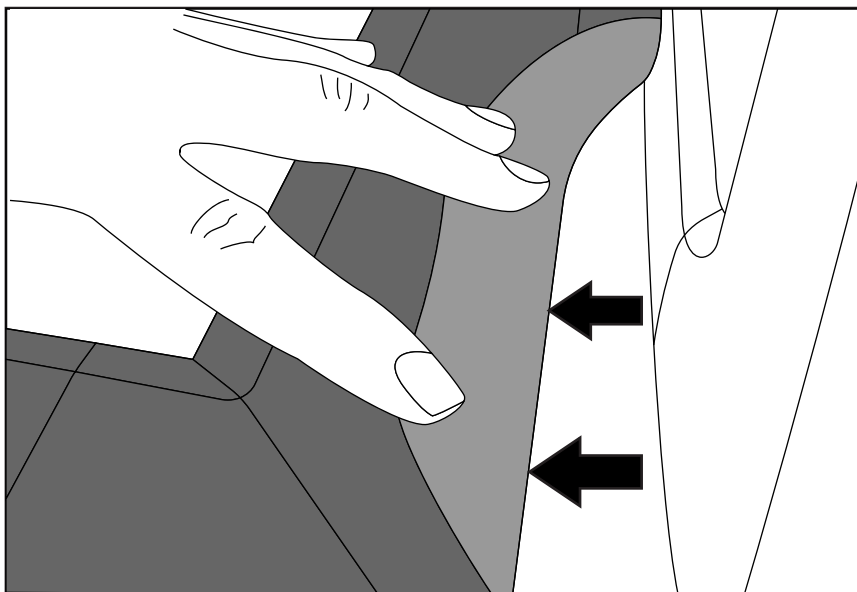

### Step 12

- While the cover is open, check the front seal's lip is not trapped between the cover and the front rails by bending it up.

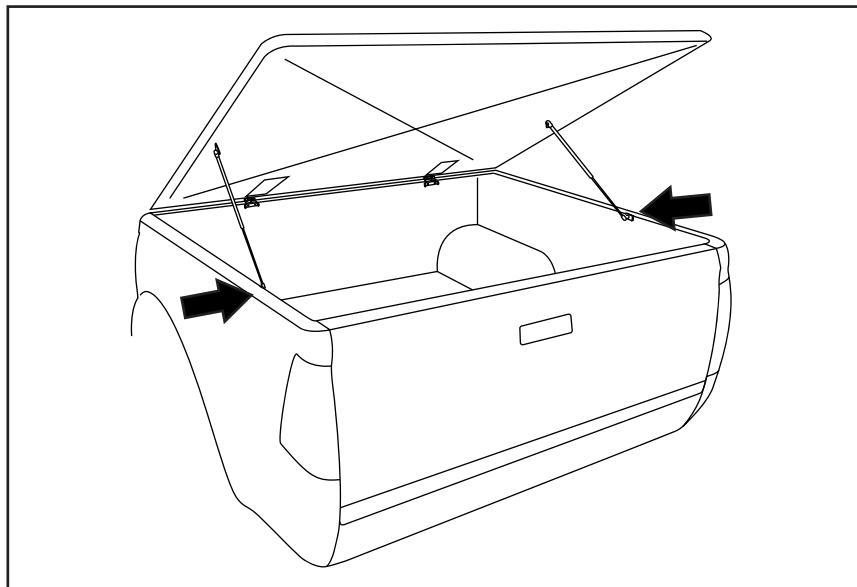

### Step 13

- Close the cover by pulling from the handle and slowly close it while checking that the cover is correctly lined up to the tub and the latch mechanisms are not touching the tub's side rails.
- Attach gas struts to brackets by clipping into place. Ensure narrow end mounts to the vehicle.

**Note:** If the cover does not line up correctly, move hinge parts mounted to the front rail forward or backward, one at the time.

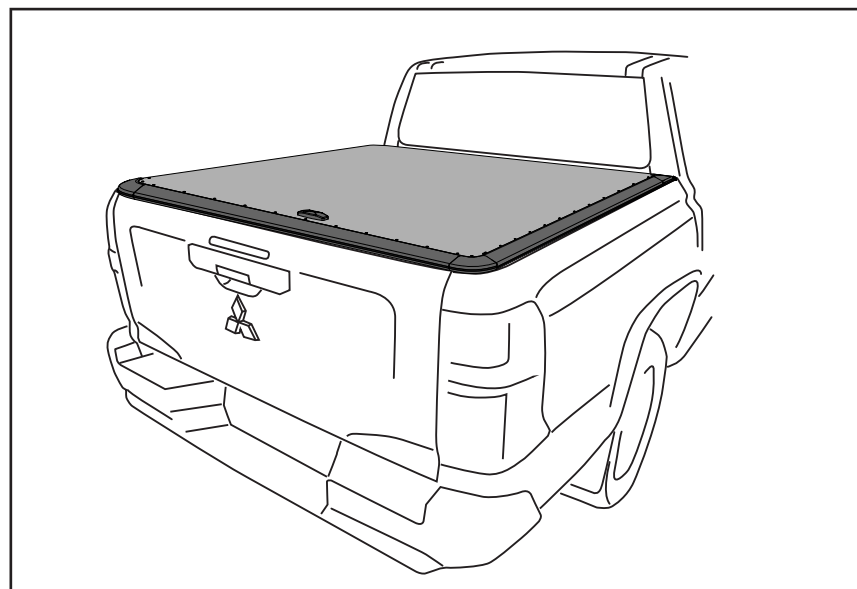

### Step 14

**Note:** Ensure the keys do not get locked inside the tub.

- Ensure all the parts are correctly installed.
- Open the tailgate.
- Close the cover slowly and ensure locking mechanism functions correctly. Repeat 2-3 times.

**IMPORTANT :** If not latching, go to next step for adjustment guide.

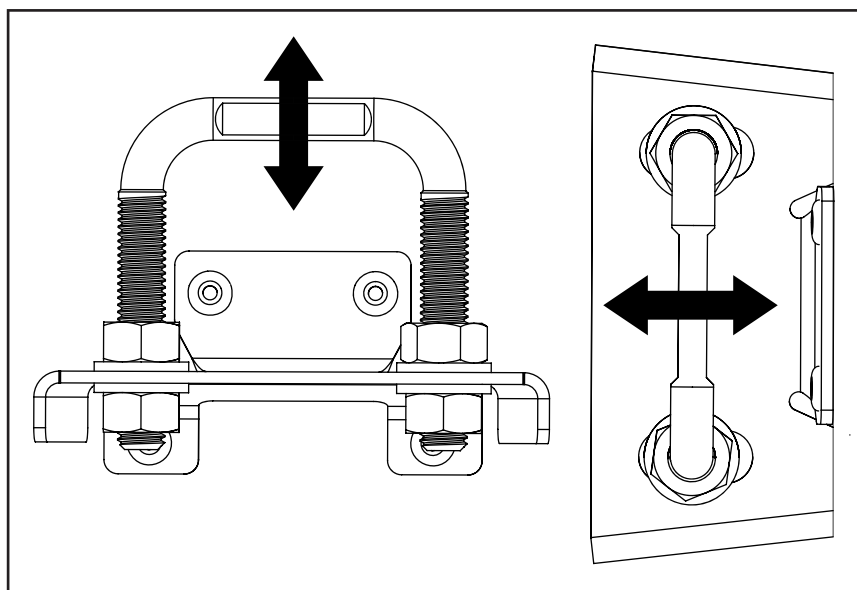

### Step 15

**Required tools:** Masking Tape, Marker Pen and Tape Measure.

- Slowly close the cover and move the striker sideways to line it up with the latches. Ensure both sides are lined correctly.
- Adjust the striker height correct by first closing the cover and measuring the gap between the cover and side rails top surface. The gap should be 9.0 mm at the rear, adjust strikers accordingly.
- Tighten the striker nuts to 30.0Nm.

**Note:** Do Not Close the tailgate.

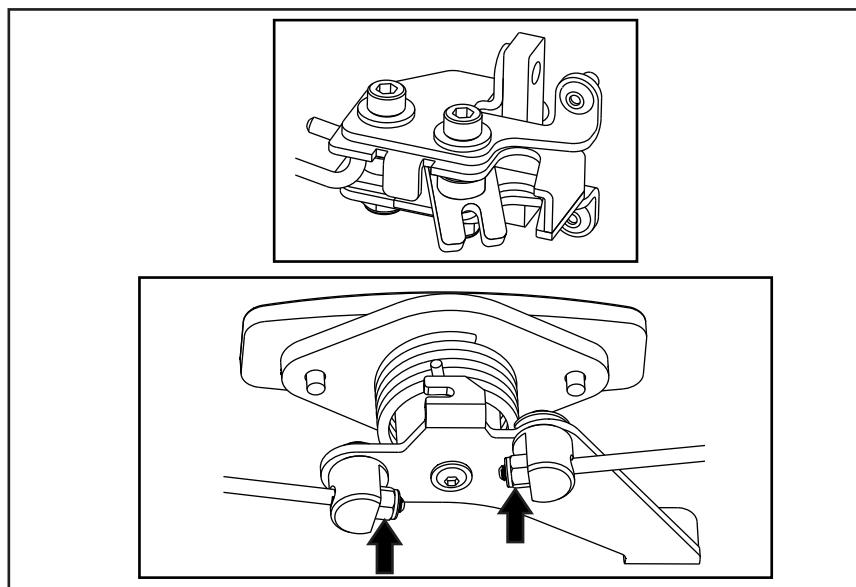

### Step 16

**Required tools:** 8mm Spanner.

- While the cover is open and tailgate is open. Press the latch rotor to closed position, both sides.
- Rotate the handle slowly to clock-wise, ensure both latches disengage at the same time. Adjustment may be required.

**Note:** Mechanism can be adjusted by tightening or loosening the latch rod M5 nuts from underneath the cover.