

INSTALLATION INSTRUCTIONS

EGR ROLLTRAC

ELECTRIC

Vehicle Model: GWM CANNON MY21

Year of manufacture: 2021 onwards

EGR RollTrac type: Electric - no tailgate lock

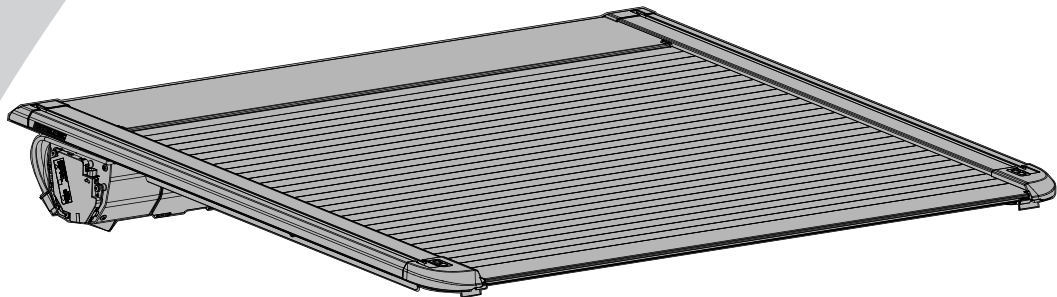

Installation time: 180 minutes (without tubliner)

Caution

- Do not attach EGR RollTrac in a location or by a method not specified.
- Do not use this product for any vehicle make or model, other than those specified in this document.
- Do not remove the plaque or label from this product.
- Do not modify the structure of the EGR RollTrac in any way.

General Notes

- Read through the fitting instructions before installation of EGR RollTrac.
- Always install the accessory following the fitting instructions. Failure to do so may cause damage to the vehicle or the accessory.
- Ensure all recyclable discarded vehicle accessory components and packaging are recycled following local recycling regulations.
- It is always recommended that this accessory is fitted by a qualified Technician.
- Safely store and protect any removed vehicle components.
- Ensure all bare metal surfaces are protected using Automotive Bare Metal Primer and touch-up paint.
- Remove all metal swarf and dust from all vehicle surfaces if surface is used for accessory installation.



Safety Notes

- Check that all work practices comply with safety standards.
- Please wear appropriate clothing and use safety equipment.



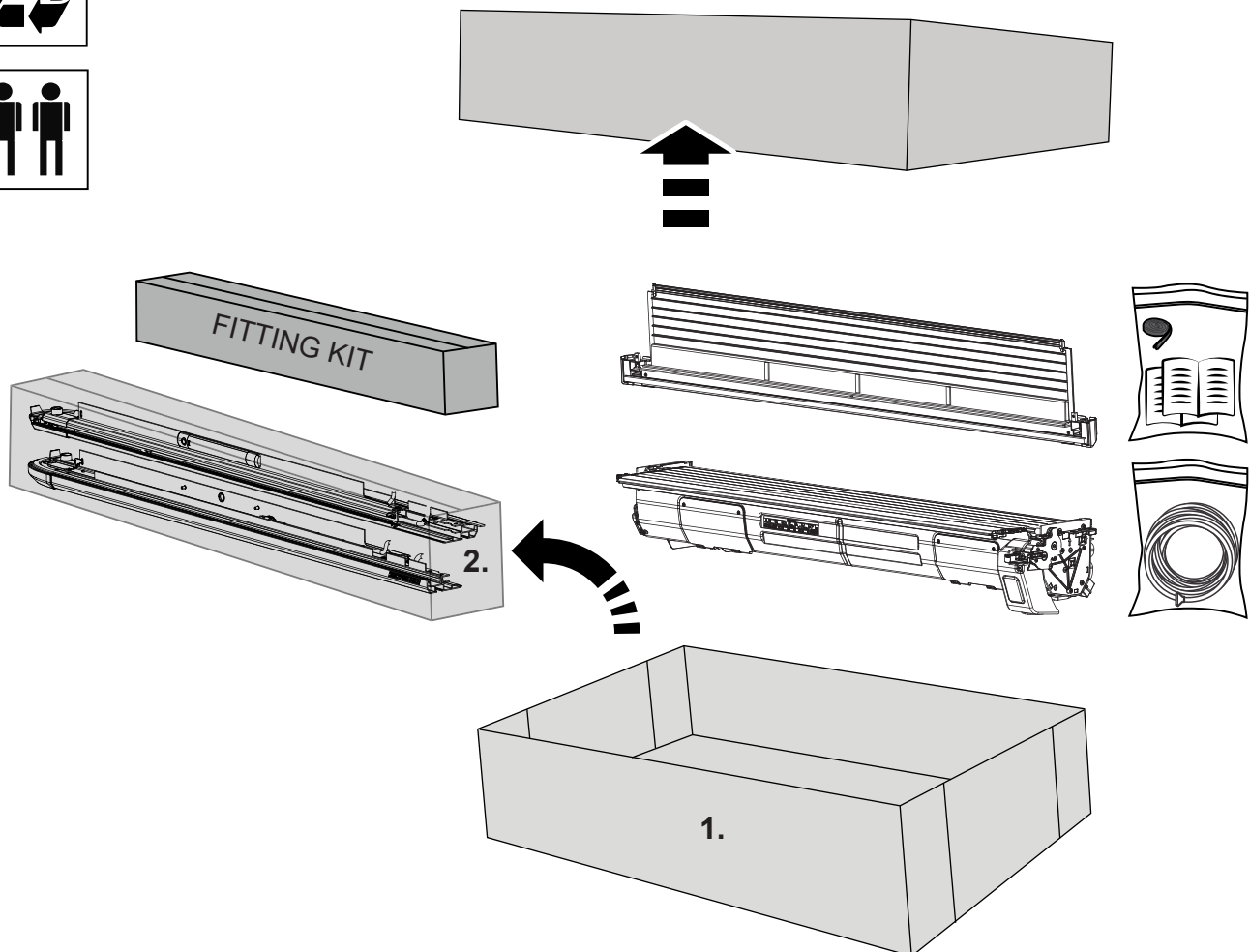
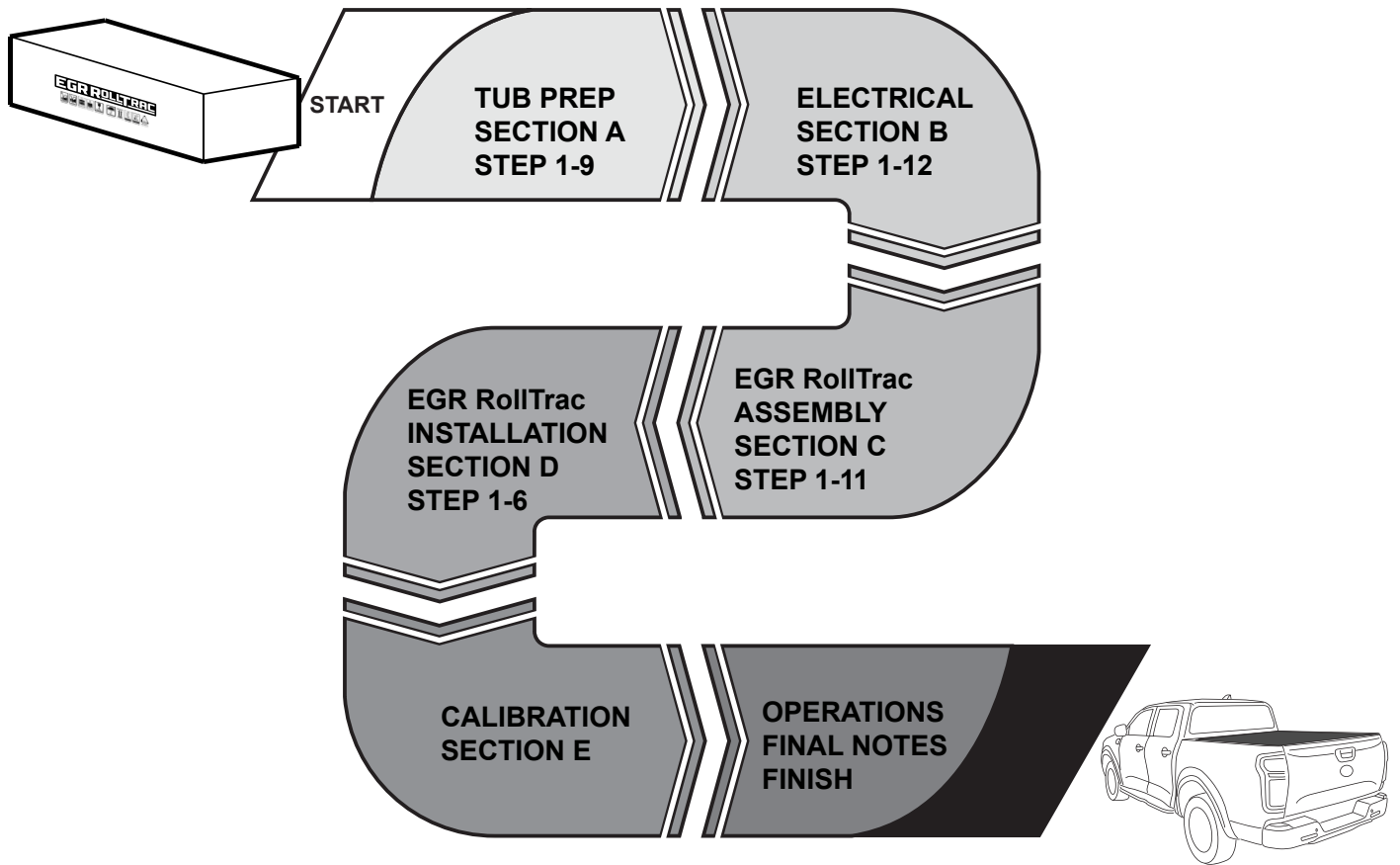

KIT CONTENTS - COMPONENT NUMBER AND QUANTITY

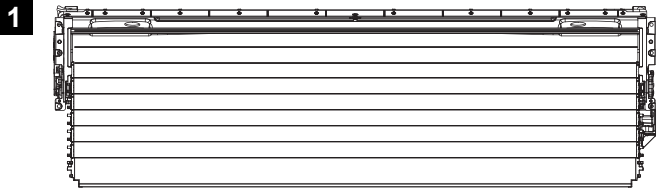

CANISTER ASM. QTY: 1

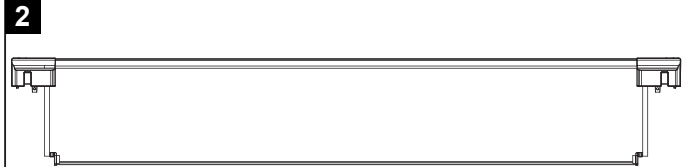

FRONT COVER QTY: 1



RHS RAIL QTY: 1



LHS RAIL QTY: 1

EGR ROLLTRAC FITTING KIT IN BOX

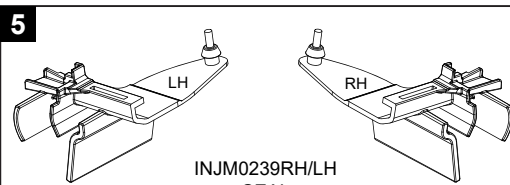

INJM0239RH/LH
SEAL
QTY: 2

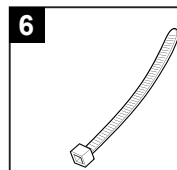

CONS70097
CABLE TIE
QTY: 9

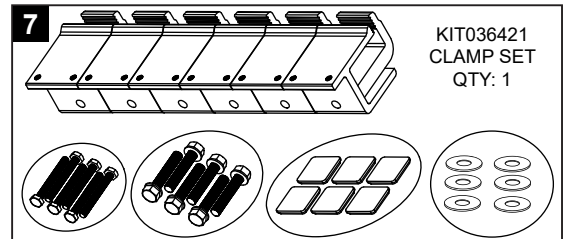

KIT036421
CLAMP SET
QTY: 1

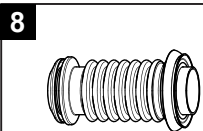

MISC5222
FRONT DRAINAGE TUBE
QTY: 2



KIT37458
(MISC5223 & MISC4895)
REAR DRAINAGE TUBE
QTY: 2

TUB REINFORCEMENT KIT

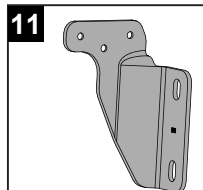

CLIP4060PC-RH
QTY: 1

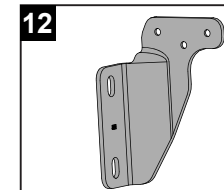

CLIP4060PC-LH
QTY: 1

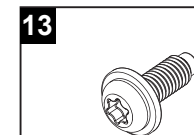

M8x20 TORX SCREW
SCRW1004
QTY: 6

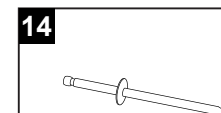

RIVET
FAST0609
QTY: 6

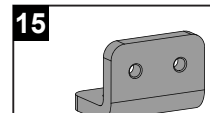

CLIP4057PC
M6 TAPPED PLATE
QTY: 2

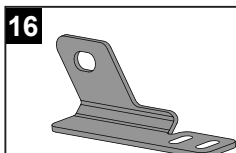

CLIP4059PC-LH
REAR BRACKET
QTY: 1

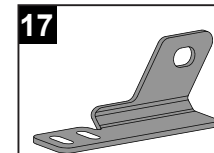

CLIP4059PC-RH
REAR BRACKET
QTY: 1

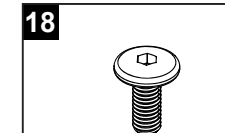

SCRW0973
SCREW M6X15MM
QTY: 14

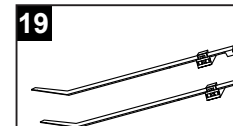

PANEL CLIP
MISC5256
QTY: 2

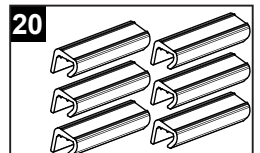

CLAMP FOOT
MISC5677
QTY: 6

EGR ROLLTRAC FITTING KIT ADDITIONAL ITEMS

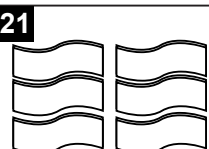

TAPE0698
TAPE 150X25MM
QTY: 6

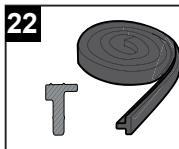

RUBBER
EXTRUSION
QTY: 2

INSTALLATION
INSTRUCTIONS



OWNERS
MANUAL



EGR ROLLTRAC FITTING KIT COMPONENTS IN BAGS

VEHICLE HARNESS

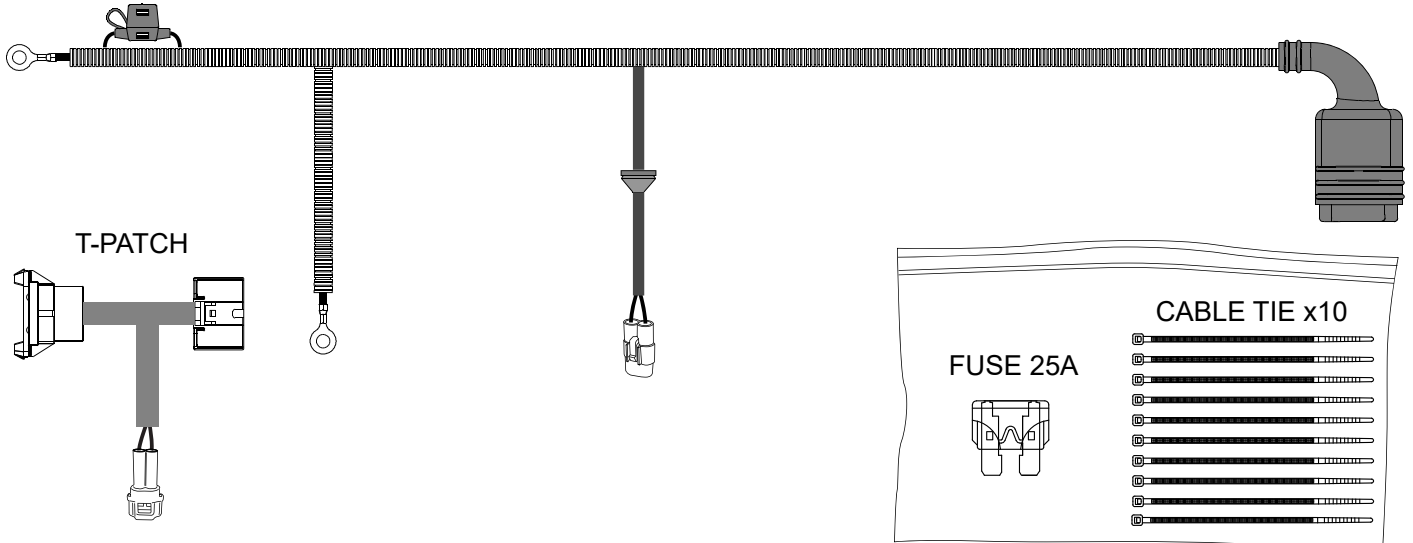

TOOLS REQUIRED - NOT SUPPLIED IN KIT

 Drill	 Holesaw Ø29mm Ø38mm	 Centre Punch & Hammer	 Drill Bits Ø5.0mm Ø15.0mm	 Non-permanent pen	 Flat Screwdriver
 Phillips Screwdriver	 Tape Measure	 Scissors	 Rivet Gun	 Side Cutters	 Spanners 10,13mm
 Ratchet & Sockets 10,13mm	 Torx Bit T40	 Allen Key Bit 4mm	 Allen Key 2.5 & 4mm	 Torque Wrench	 Trim Removal Tool
 Masking Tape Fiberglass Tape Black Cloth Tape	 Isopropyl Alcohol/Water 50/50	 Rust Inhibitor	 Silicone	 Silicone Spray	 Soapy Water
 Draw wire					

GLOSSARY:

- 1** Number inside a square indicate part number.
- 1** Number inside circle indicate the within a step.
- 1** Number inside the hexagon indicate torque instruction.

SECTION A

TUB PREPARATION

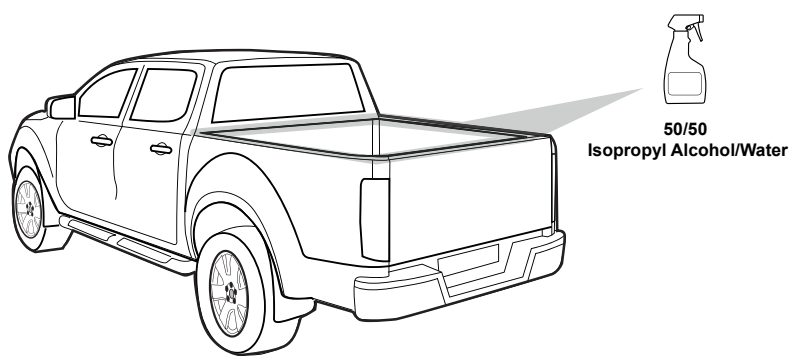
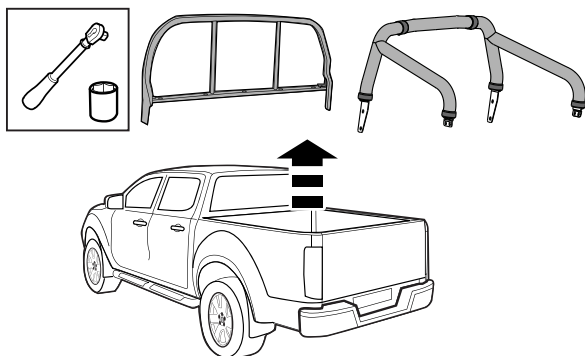

- 1 Carefully remove any accessories (Sports Bars, Cabin Guards, etc.) attached to the tub of the vehicle. Thoroughly wash the vehicle and tub and ensure that all dirt and grease is removed. Allow to dry. Clean the top surfaces of the tub and tailgate with a mixture of Isopropyl Alcohol and Water (50/50) and allow to dry.

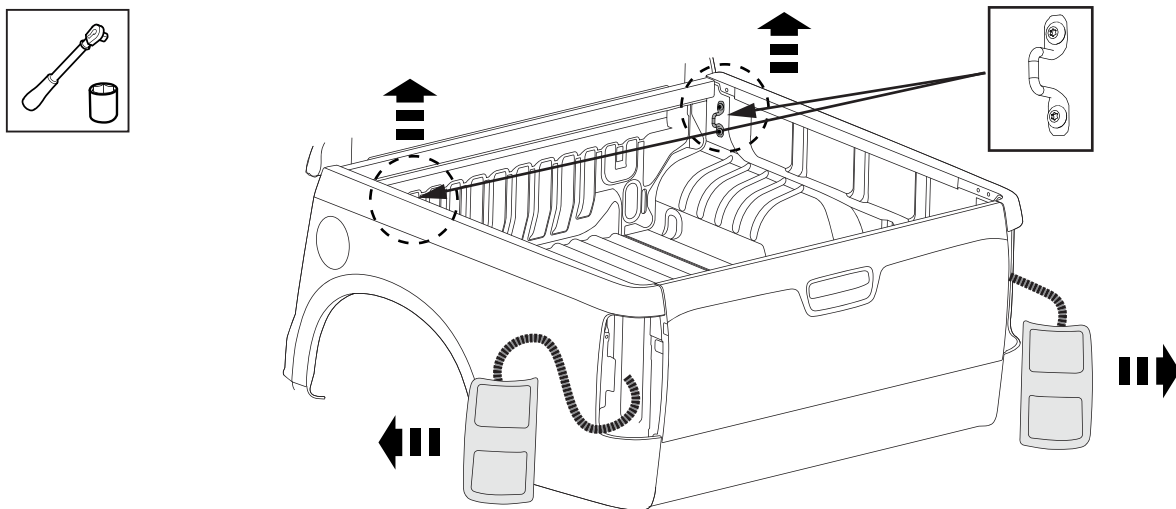

- 2 Carefully remove both Rear Tail Lamps with the appropriate tools and store in safe place. Retain all hardware for re-installation. Remove and discard front tie down hooks.
NOTE: Scrape off the spray-liner from the screws holding tie down hooks.

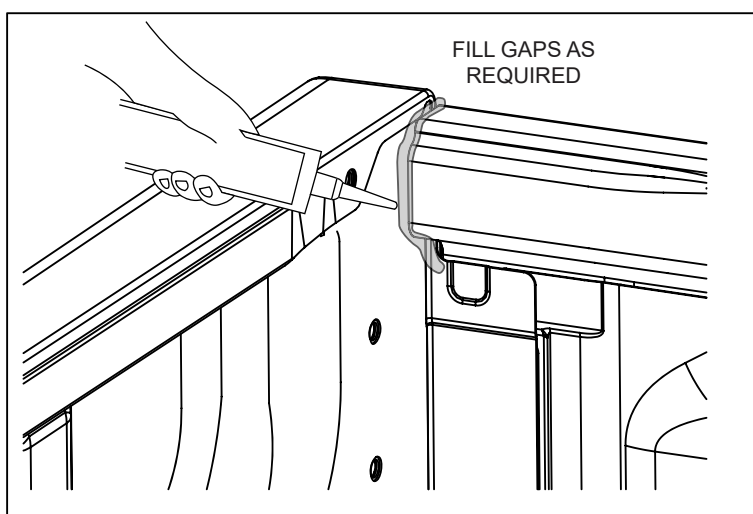
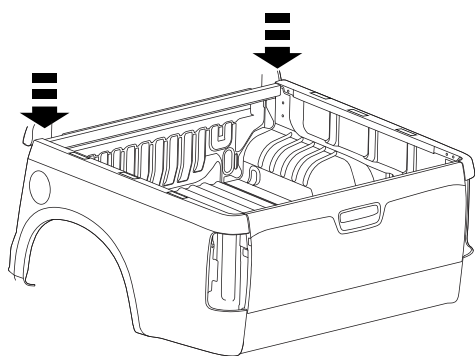

- 3 To prevent water ingress, apply a bead of silicon (non-acetic) to gaps such as between the front rail and the side rail as shown. Holes in the tub from any removed accessories should be covered using tape or silicone.
NOTE: Ensure the Silicone bead transitions smoothly between front and side rail and underneath the rubber extrusion. **Refit the tubliner.**

TUB REINFORCEMENT KIT

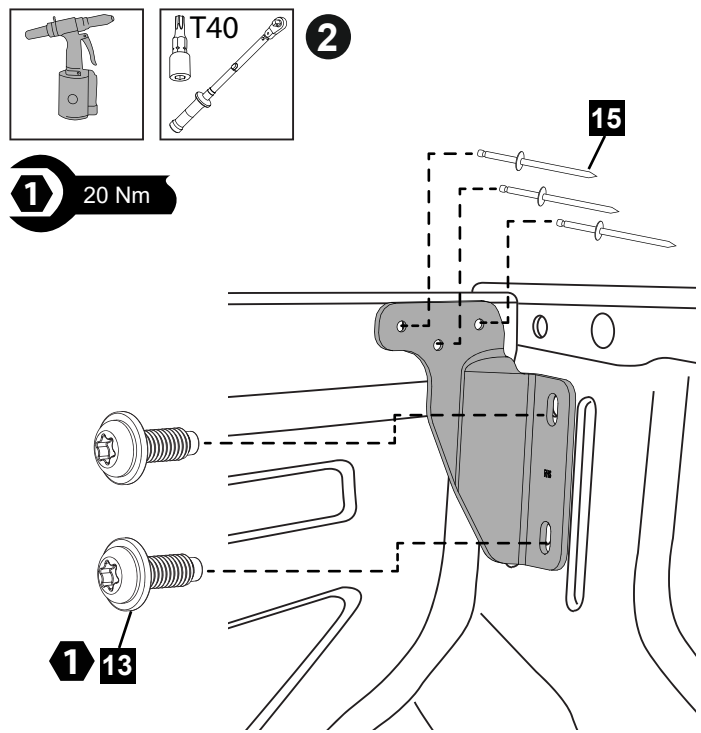
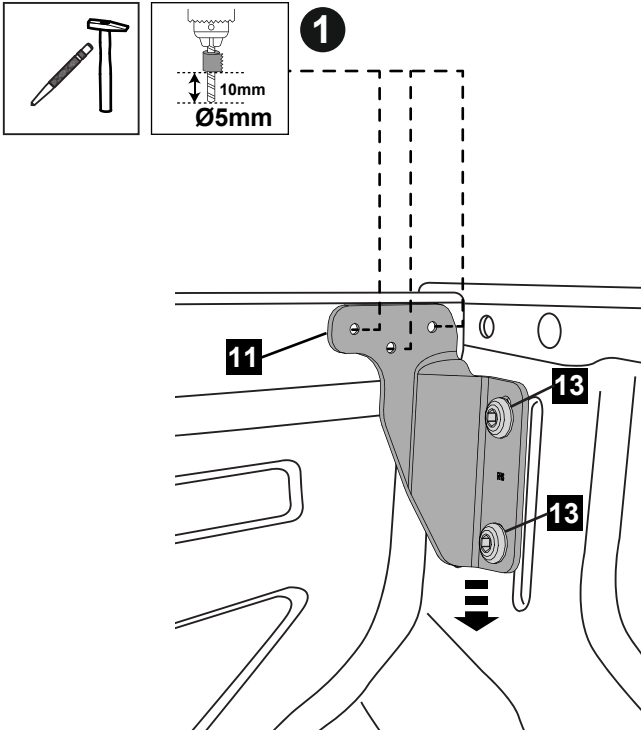

- 4** Place the reinforcement plate (11) in the front RHS corner as shown and attach with two screws (13) as shown (do not torque). **IMPORTANT:** Set the plate as low as possible on the tub. Mark the 3 holes for rivets. Remove bracket. Drill the 3 hole locations using 5mm drill bit. **NOTE:** Apply rust inhibitor to drilled holes. Secure the brackets with rivets and screws as shown and torque to 20Nm. Repeat for LHS.

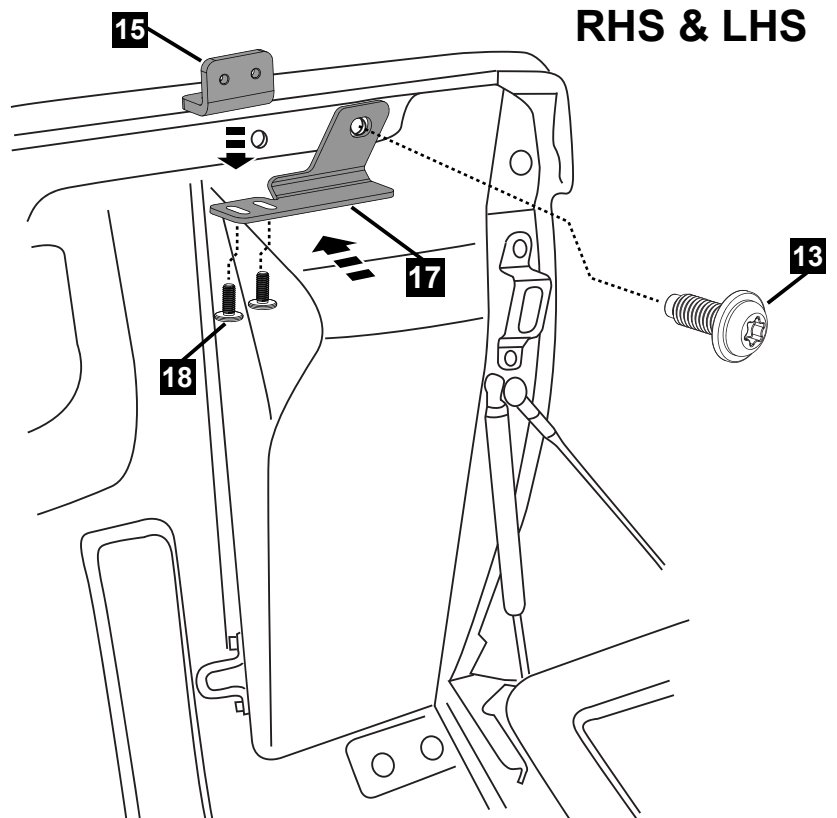
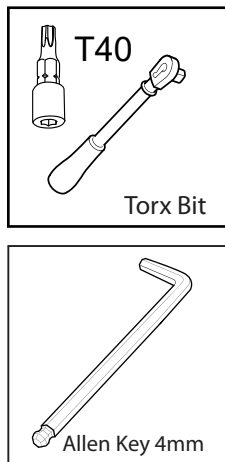

- 5** Secure rear bracket (17) to the rear most hole in the tub with one screw (13). Do not torque at this stage. Fit the tapped plate (15) to the rear bracket and secure with two screws (18), do not torque them. Repeat for the LHS.

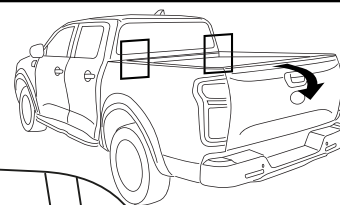
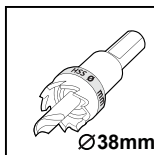
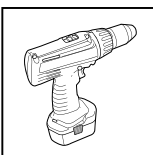
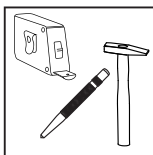

FRONT OF TUB

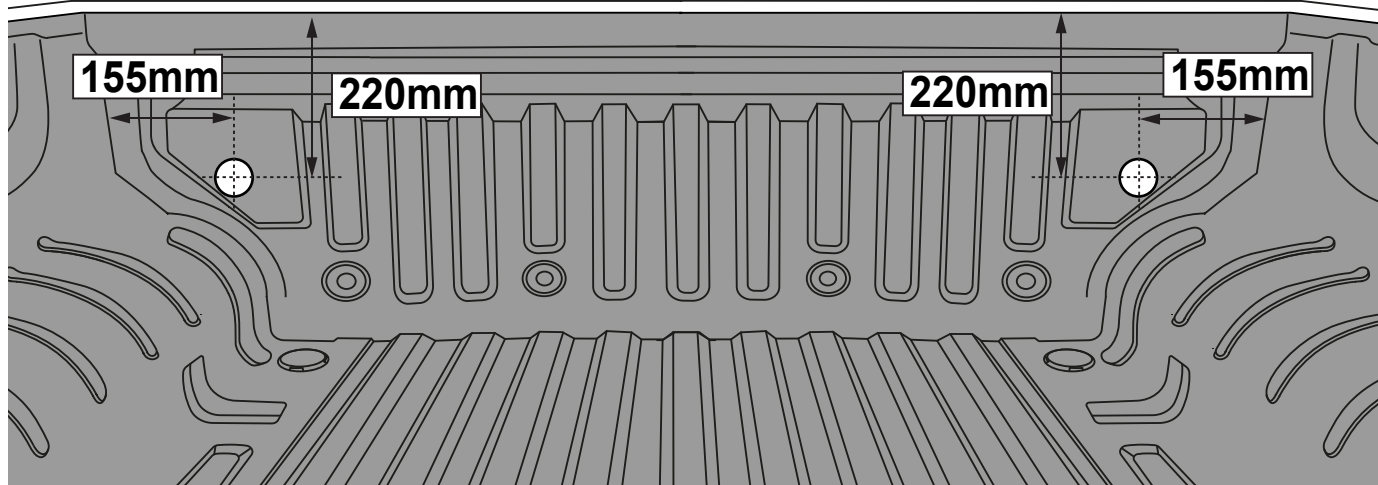

- 6** Measure and markup the positions for the Front Drain Tubes on both sides. Centre punch the locations and drill with Ø38mm hole saw. Clean all burrs and coat the exposed metal with a suitable rust preventative (not supplied). Repeat for the LHS.

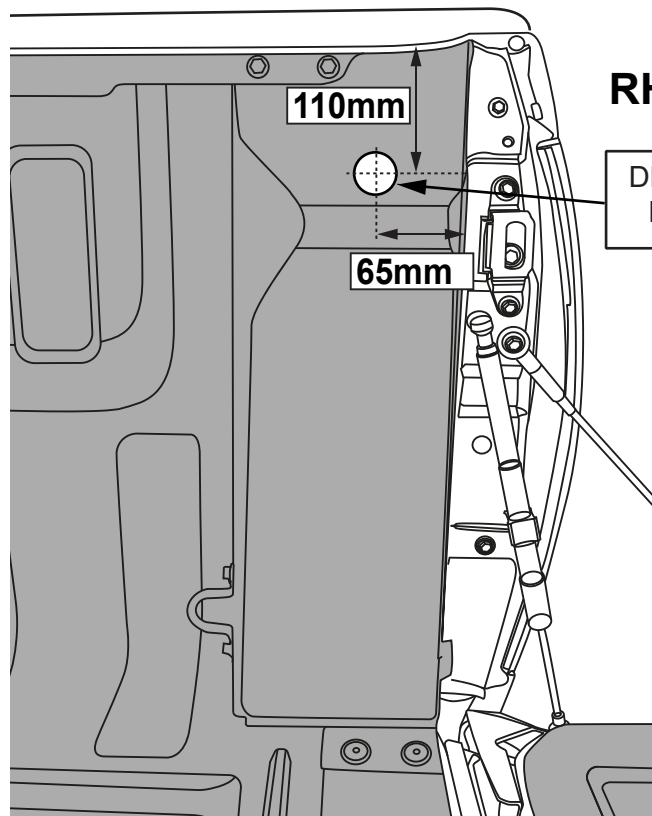

RHS & LHS

DRILL Ø29MM
RHS & LHS

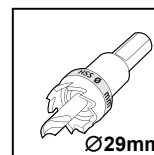
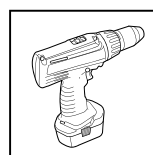
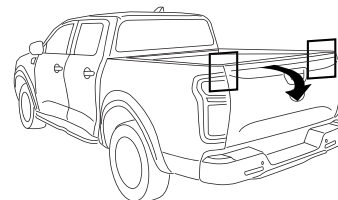

- 7** Measure and markup the positions for the Rear Drain Tubes on both sides. Centre punch the locations and drill with Ø29mm hole saw. Clean all burrs and coat the exposed metal with a suitable rust preventative (not supplied). Repeat for the LHS.

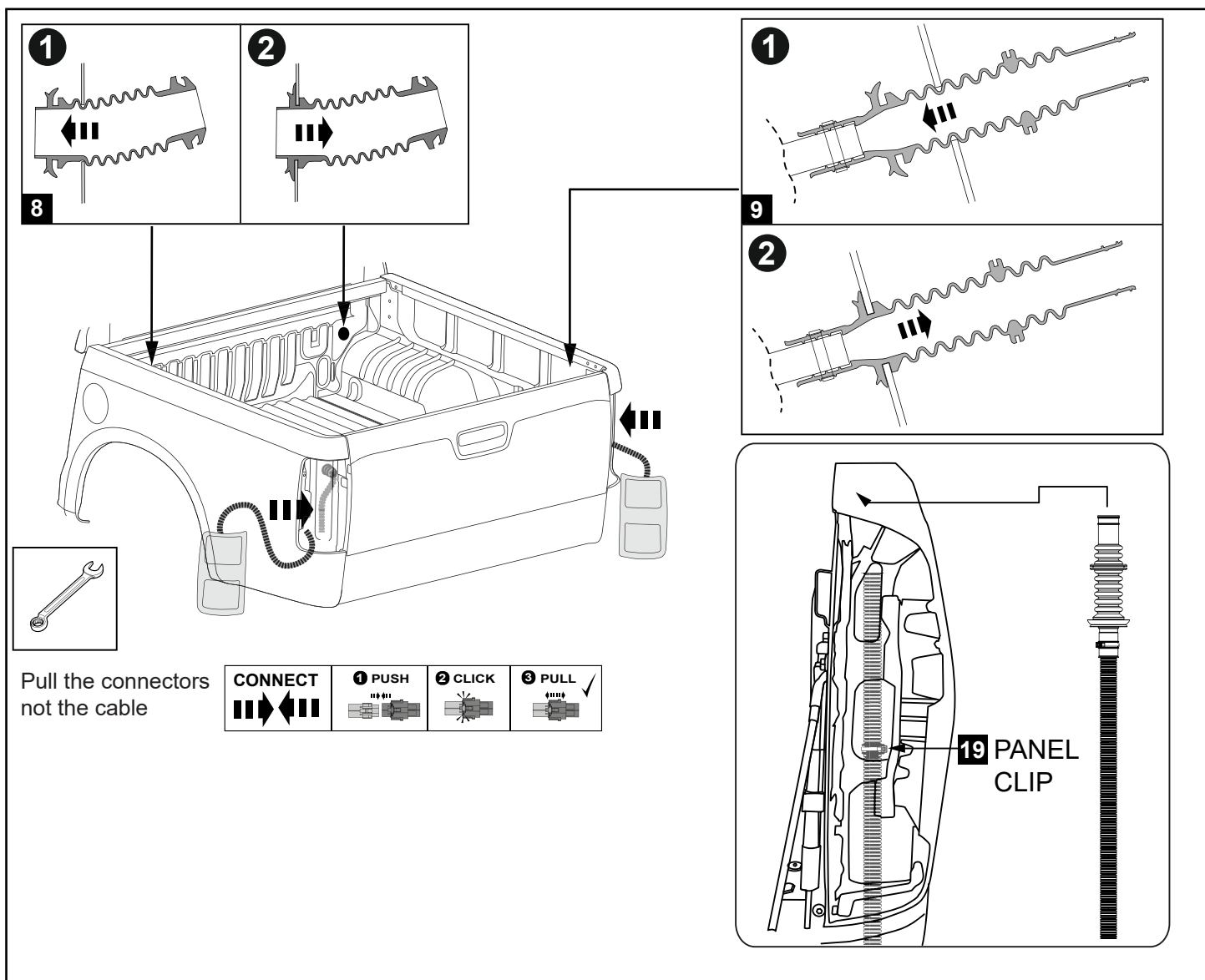

- 8** Install the front drain tubes (8) as shown. Install the rear drain tubes (9) and water conduit into the gap in the LHS and RHS tail lamp recess. Secure the drain tube with one panel clip inside the tail lamp cavity as shown. Re-connect the rear tail lamps with the previously removed hardware.

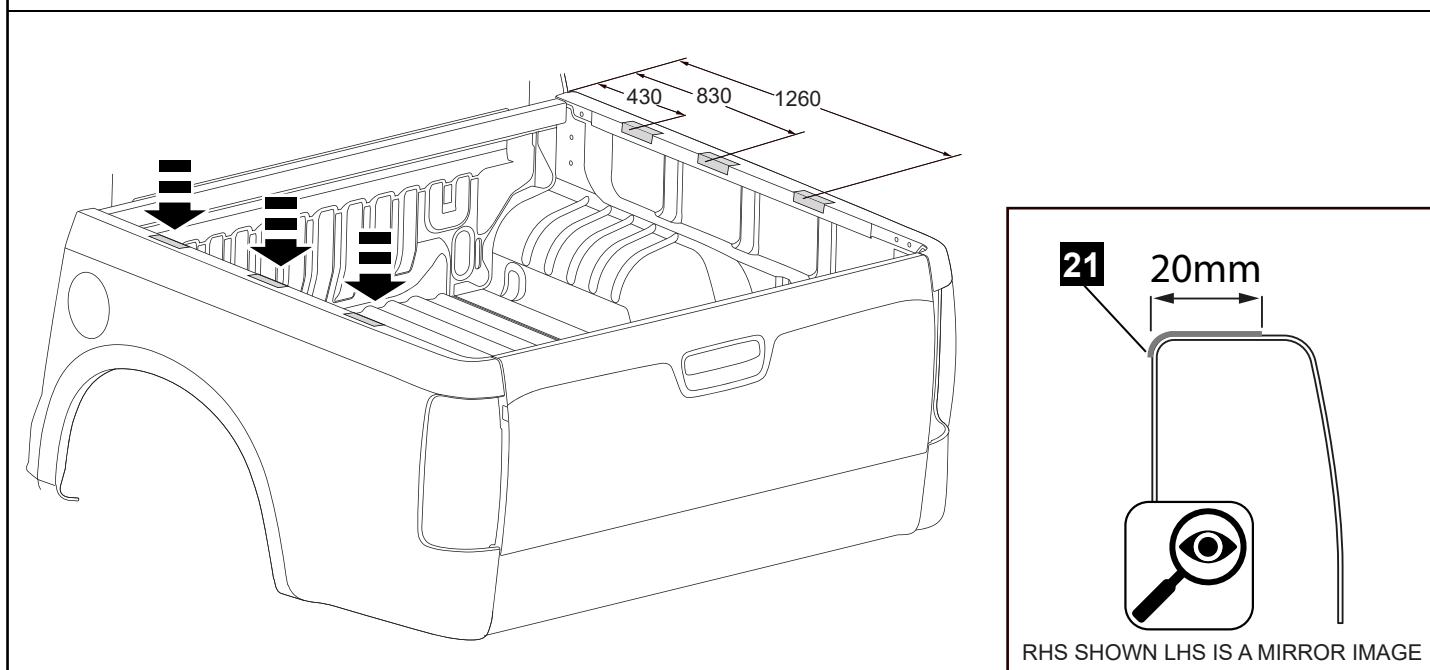

- 9** Clean top of the tub. Measure and mark the position for the clear tape as shown. Adhere the clear tape to the top of the tub in 6 locations.

SECTION B

ELECTRICAL LOOM INSTALLATION



IMPORTANT: DISCONNECT CAR BATTERY NEGATIVE TERMINAL.
FIT THE FUSE AT THE END OF INSTALLATION.
WHILE ROUTING THE VEHICLE HARNESS AVOID ANY VEHICLE COMPONENTS
THAT HEAT UP, LIKE EXHAUST AND ENGINE COMPONENTS.
DO NOT ATTACH HARNESS TO FUEL LINES AND AVOID PINCH POINTS.



OVERVIEW OF ELECTRICAL LOOM INSTALLATION

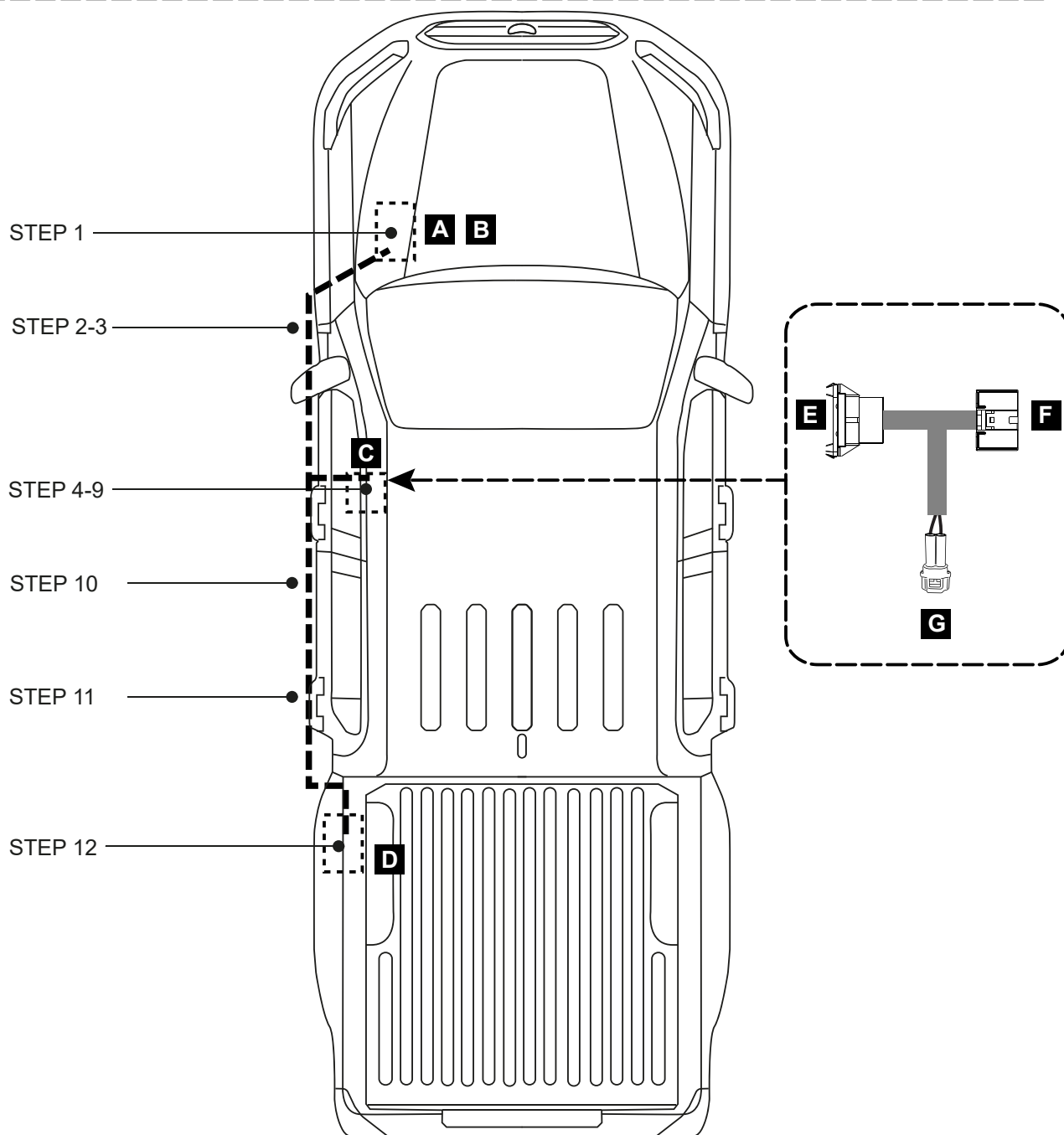
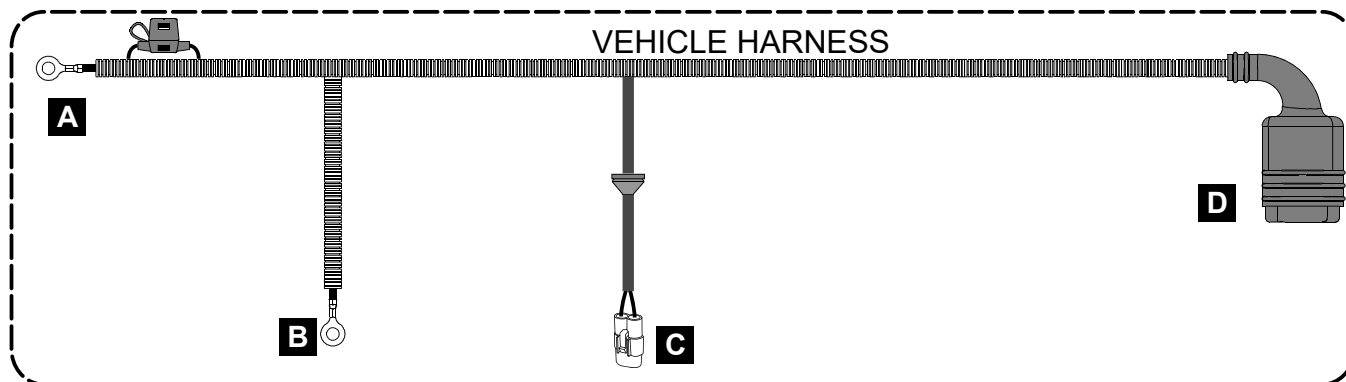

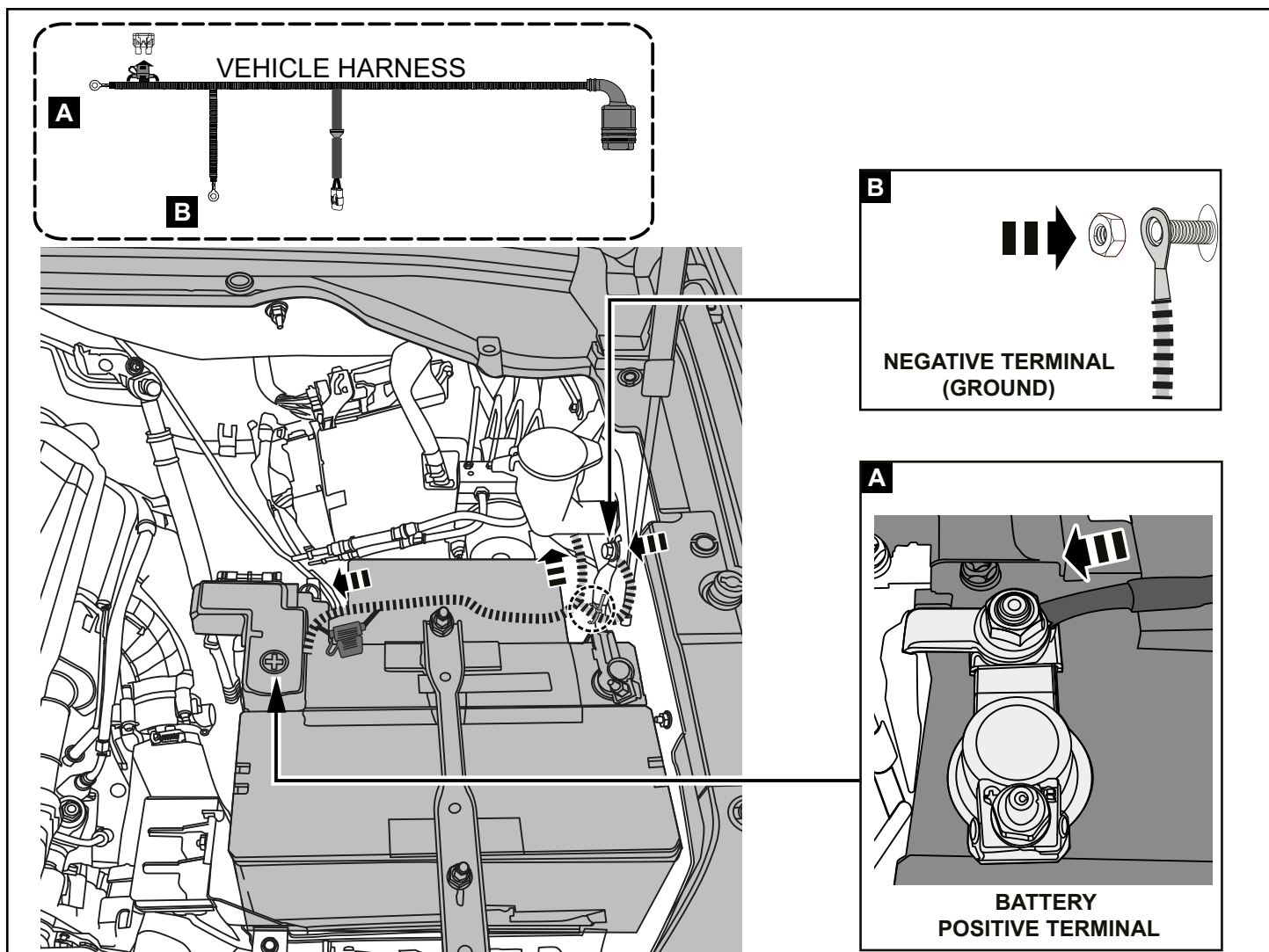

- 1 IMPORTANT:** Make sure fuses are not fitted before making connection. Connect the vehicle harness branch (B) to vehicle body negative ground, located in the engine bay as shown. Connect the vehicle harness branch (A) to the positive terminal of the battery. Once it is positioned, secure in place using cable ties.

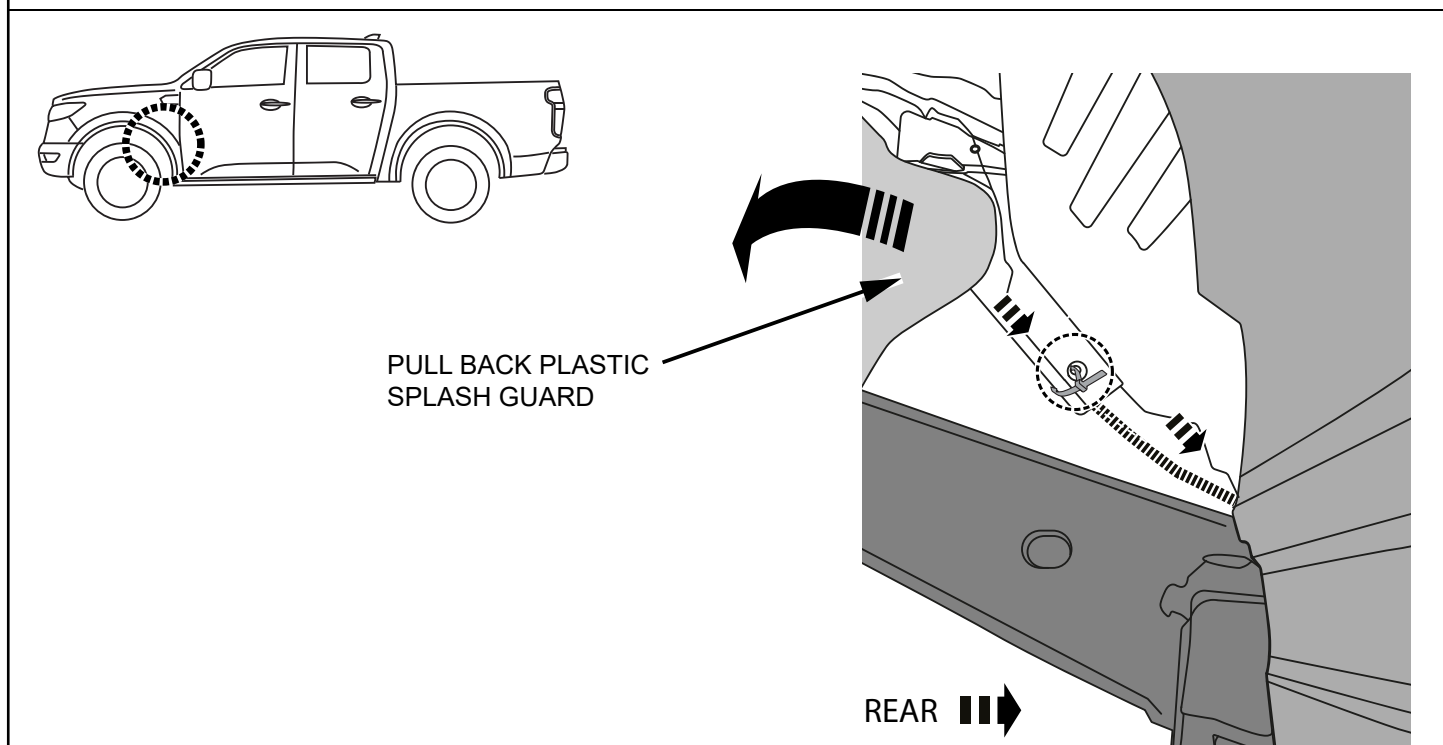

- 2** Feed the remaining branch of the harness down to the inside of the front wheel well. Pull the plastic splash guard back and secure the harness to the chassis using cable tie as shown.

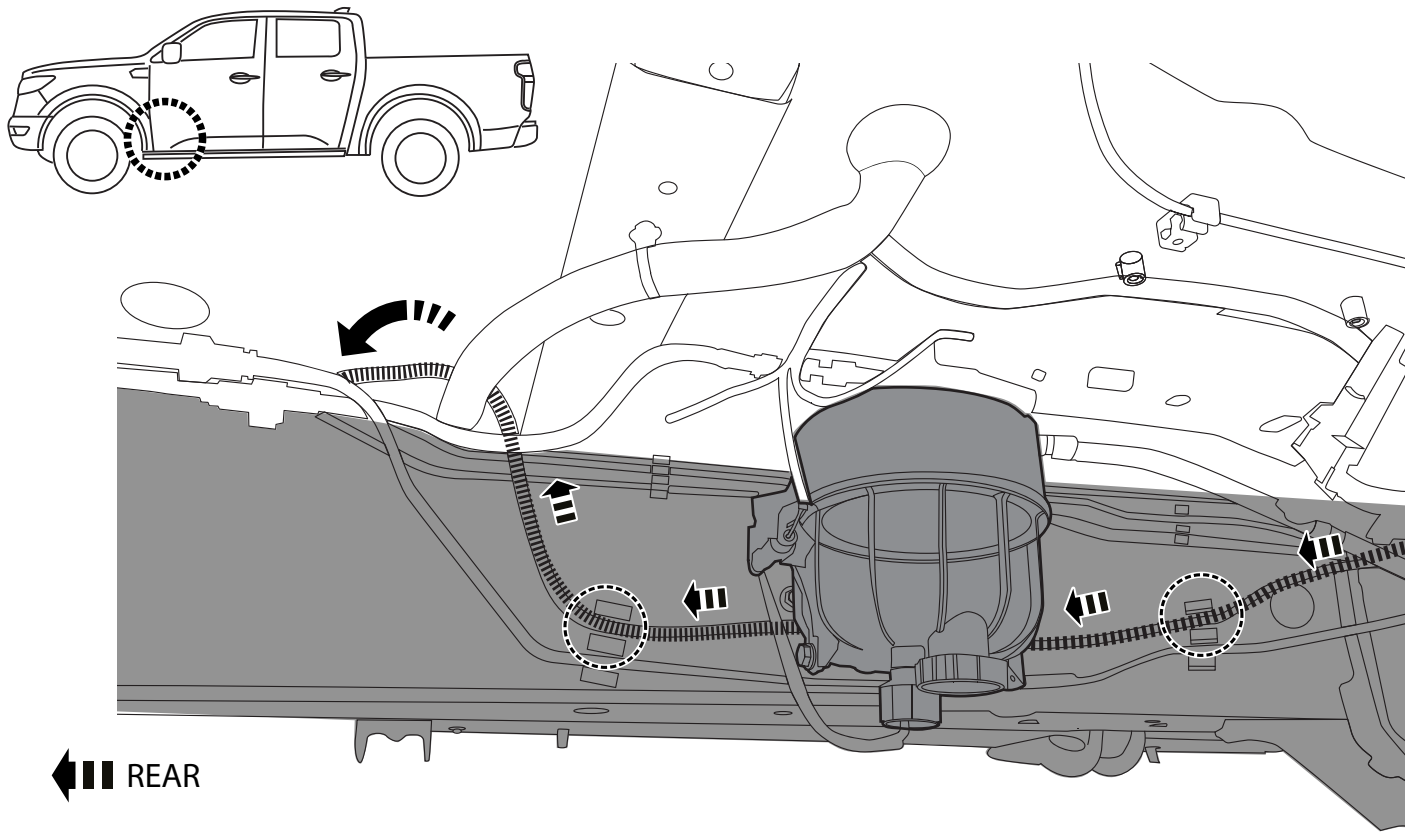

- 3** Feed the harness down to the **inside of the chassis rail**. Run the harness along the chassis rail towards the rear and secure inside existing clip-in brackets as shown. Flip the harness over to the outside of the chassis rail as shown.

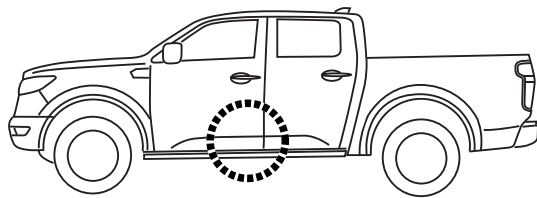

REAR →

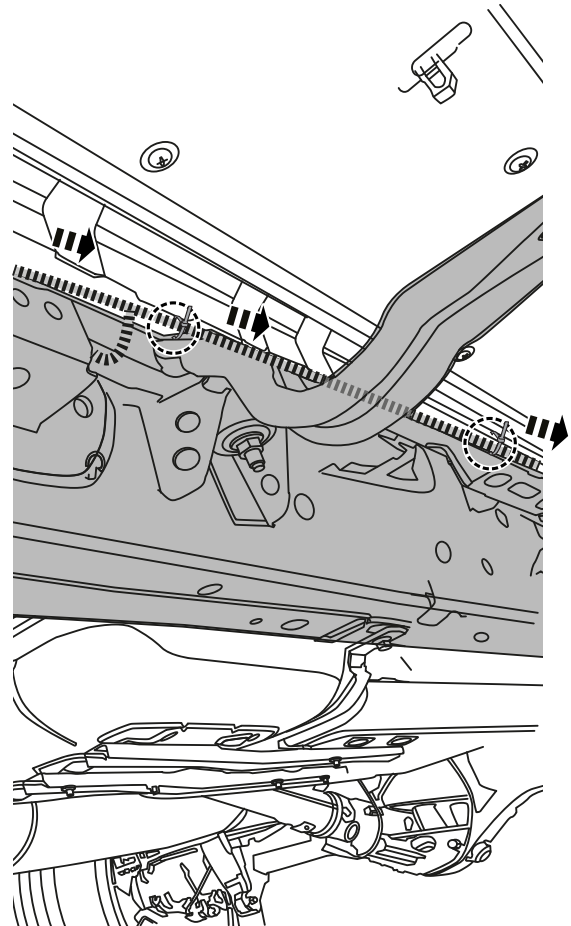

- 4** Feed the remaining branch of the harness down to the inside of the chassis rail. Run the harness along the chassis rail towards the rear and secure with cable ties as shown. Flip the harness over to the outside of the chassis rail just before the cross member as shown.

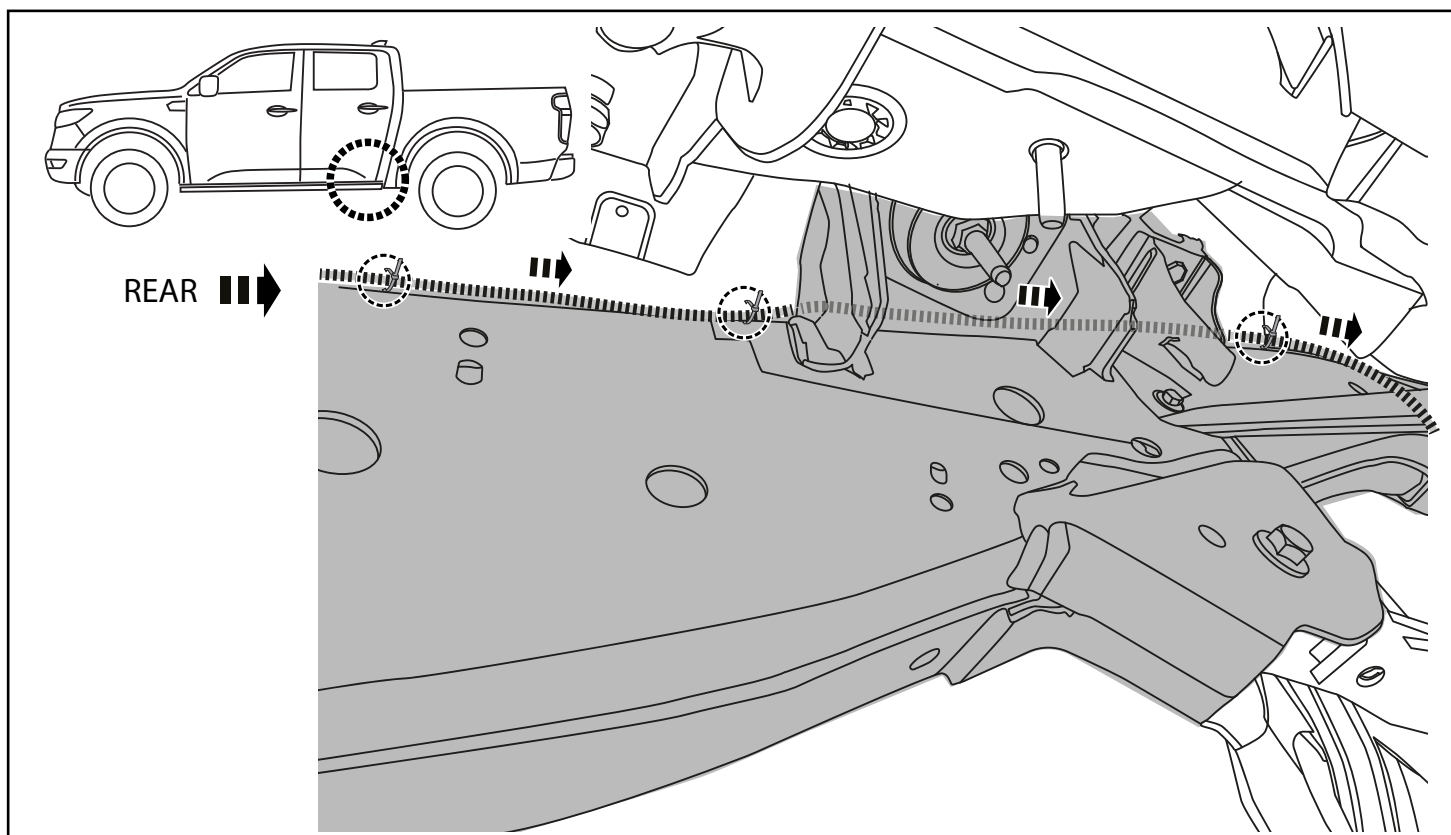

- 5** Feed the remaining branch of the harness down to the inside of the chassis rail. Run the harness along the chassis rail towards the rear and secure with cable ties as shown. Flip the harness over to the outside of the chassis rail just before the cross member as shown.

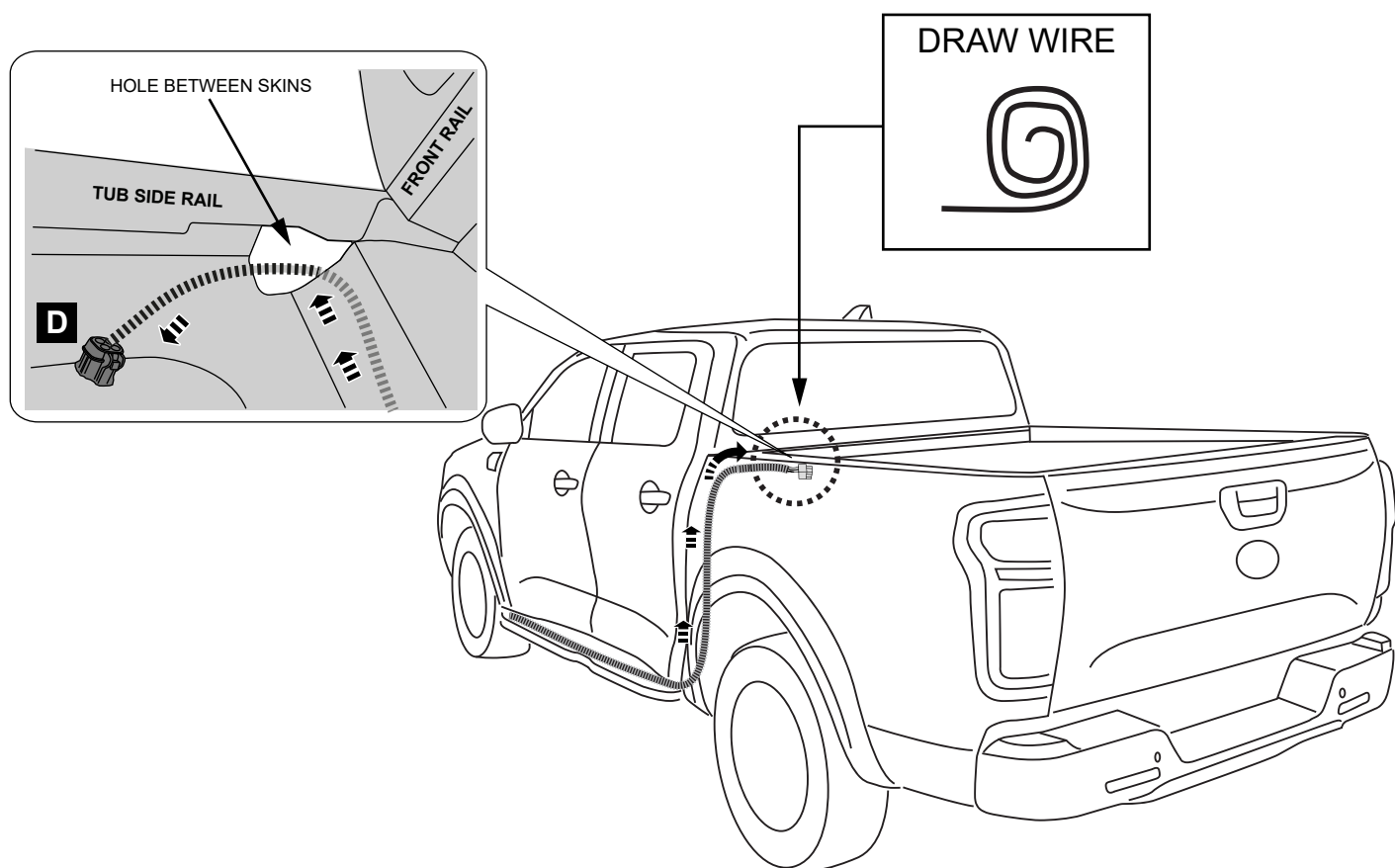

- 6** Inside the tub (front left top corner), push a draw wire down to the floor through the opening in the tub. Attach the connector (D) to it and pull up into the tub. Feed the plug end (D) of harness loom into the opening in the tub until approx 300mm protrudes.

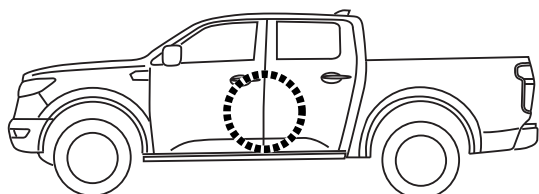

B-PILLAR VIEW

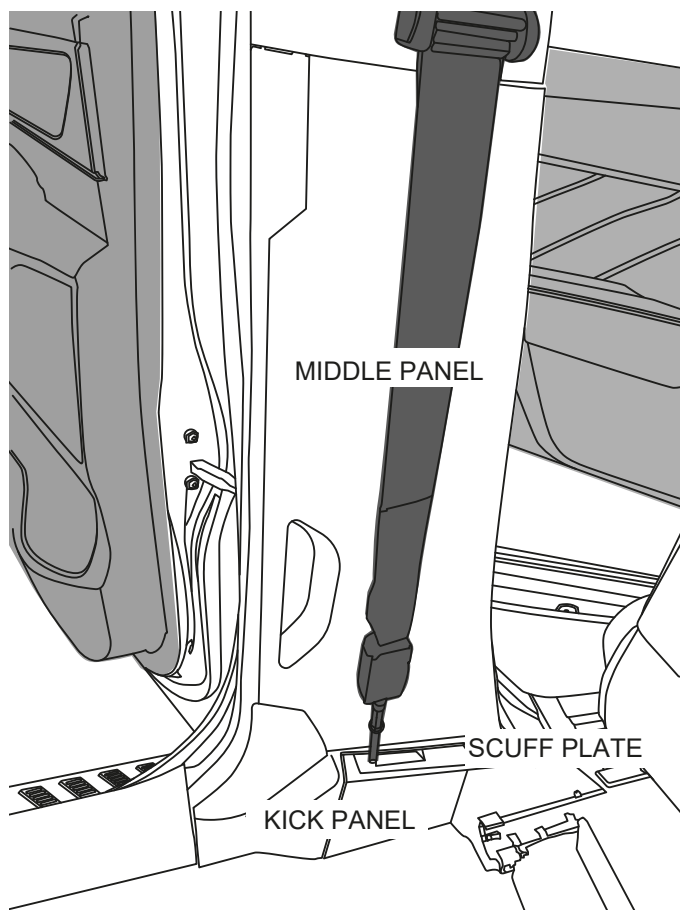

- 7** Lift the scuff plate with the kick panel. Remove the middle panel on the B-pillar as shown above. Pull the carpet up to expose the floor area near the kick panel.

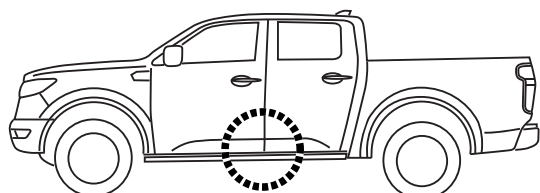

PLASTIC FLOOR PLUG

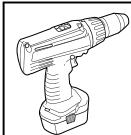

DRILL 17mm HOLE IN PLASTIC FLOOR PLUG

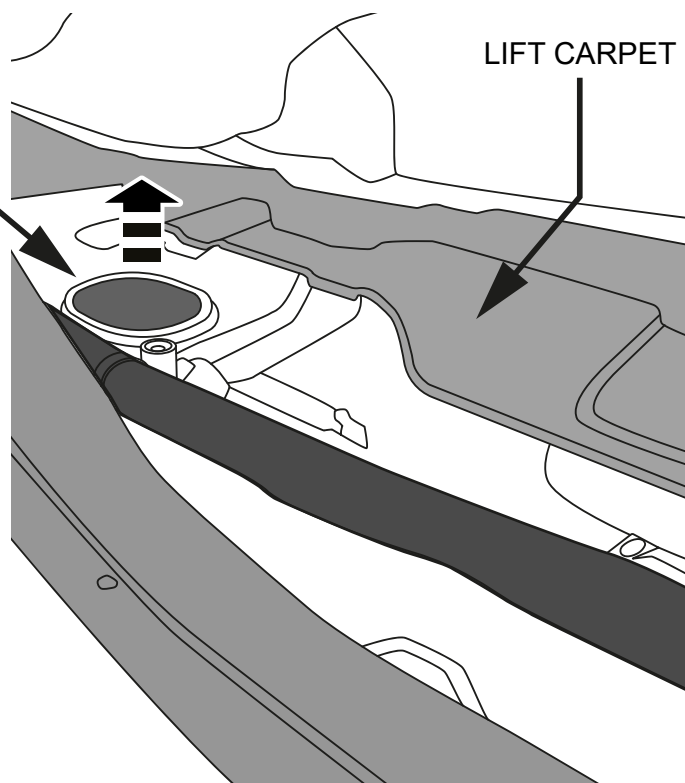
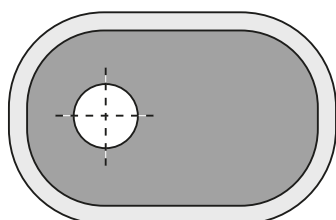

- 8** Inside the vehicle (LH) side, lift the scuff plate to allow lifting the carpet under the front seat in order to expose the plastic floor plug. Remove the plug and drill 17mm diameter hole in the plug as shown. Deburr the hole.

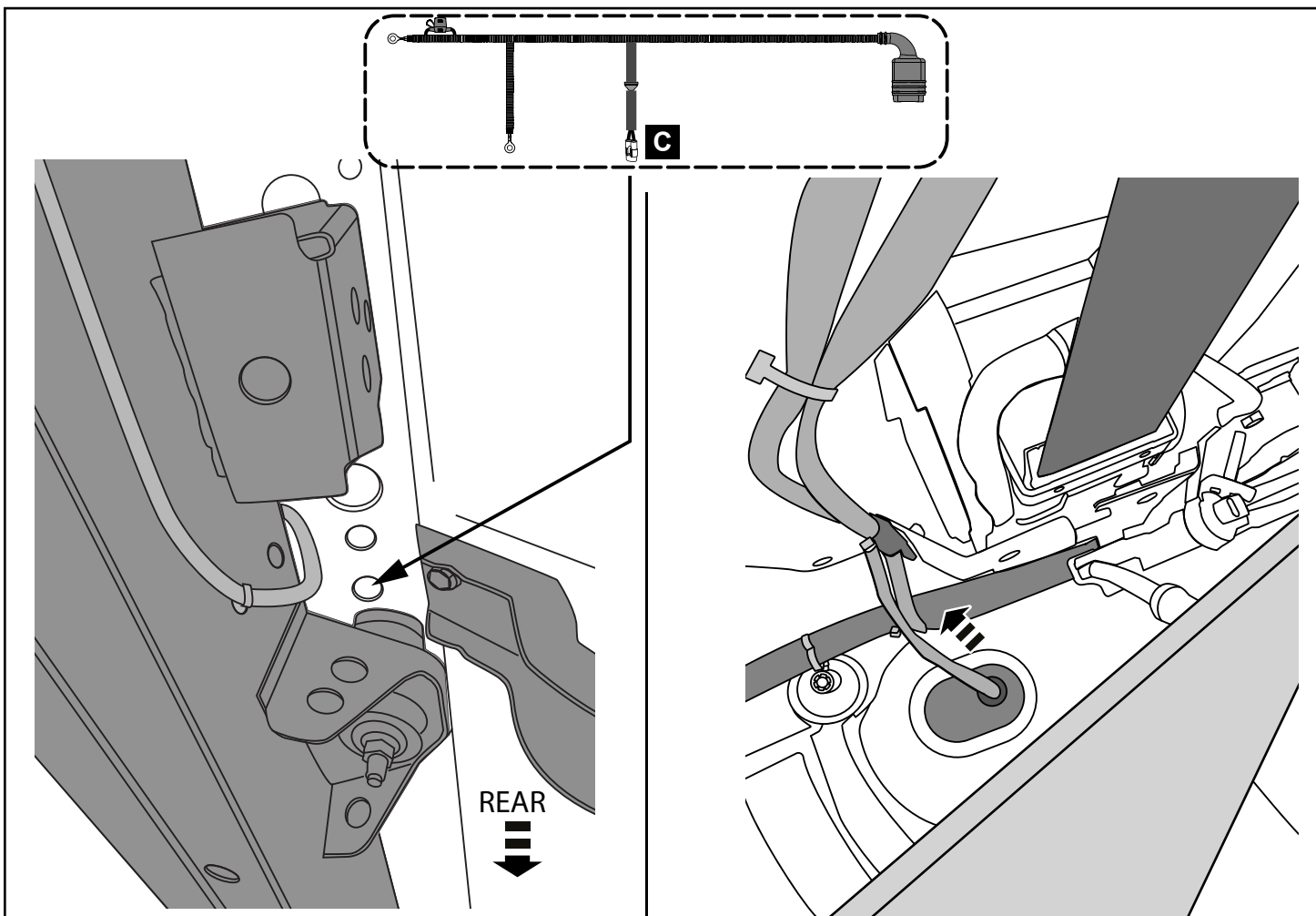

- 9** Feed the vehicle harness branch (C) into the cabin through the hole in the floor as shown. Pull the harness into the cabin. Feed the connector through the hole in the plastic cap until the rubber grommet is sited firm and refit the plastic cap to the floor.

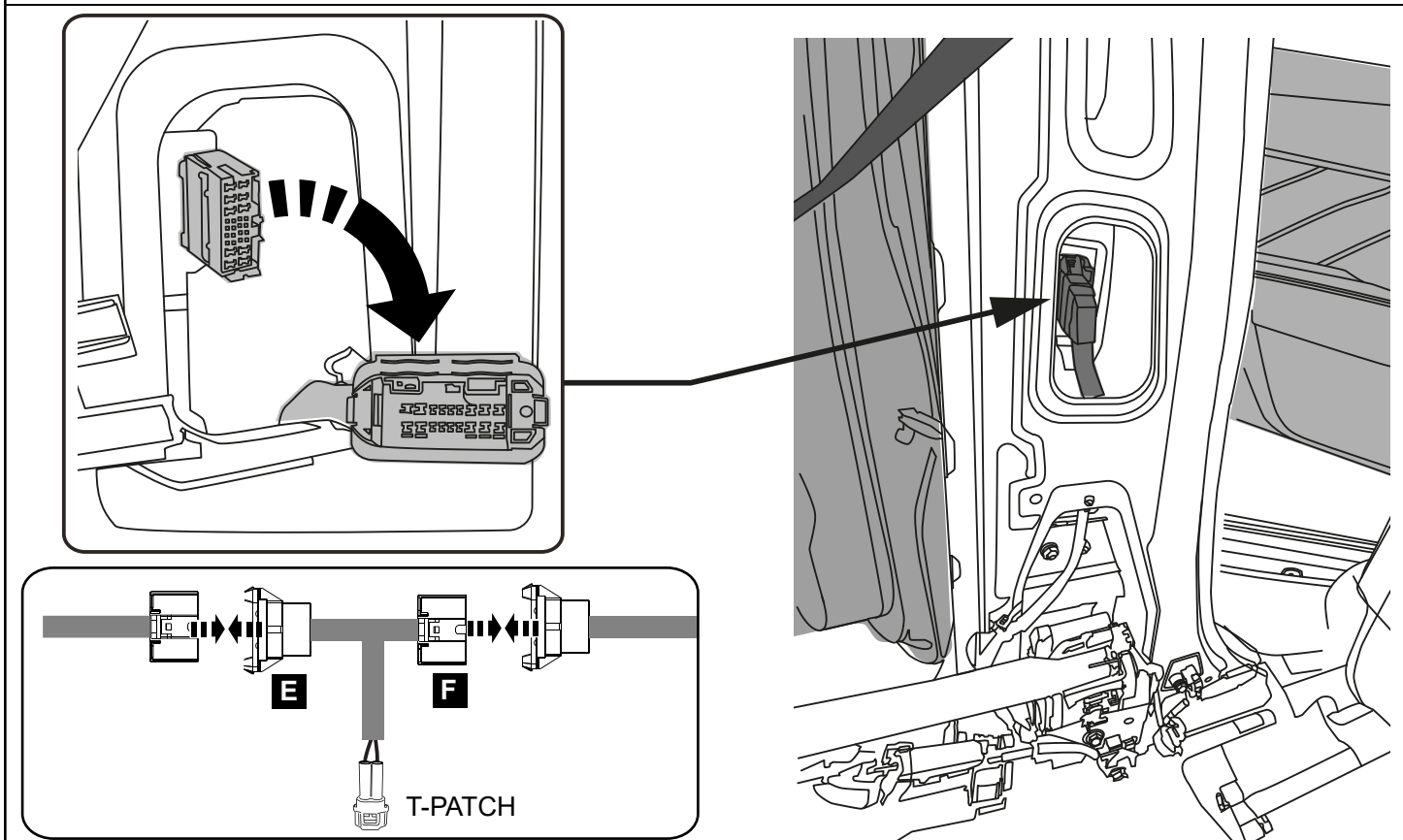

- 10** Inside the vehicle connect the previously disconnected connector inside the B-pillar to the (F) connector from the T-patch. Connect the T-patch connector (E) to the connector in the B-pillar.

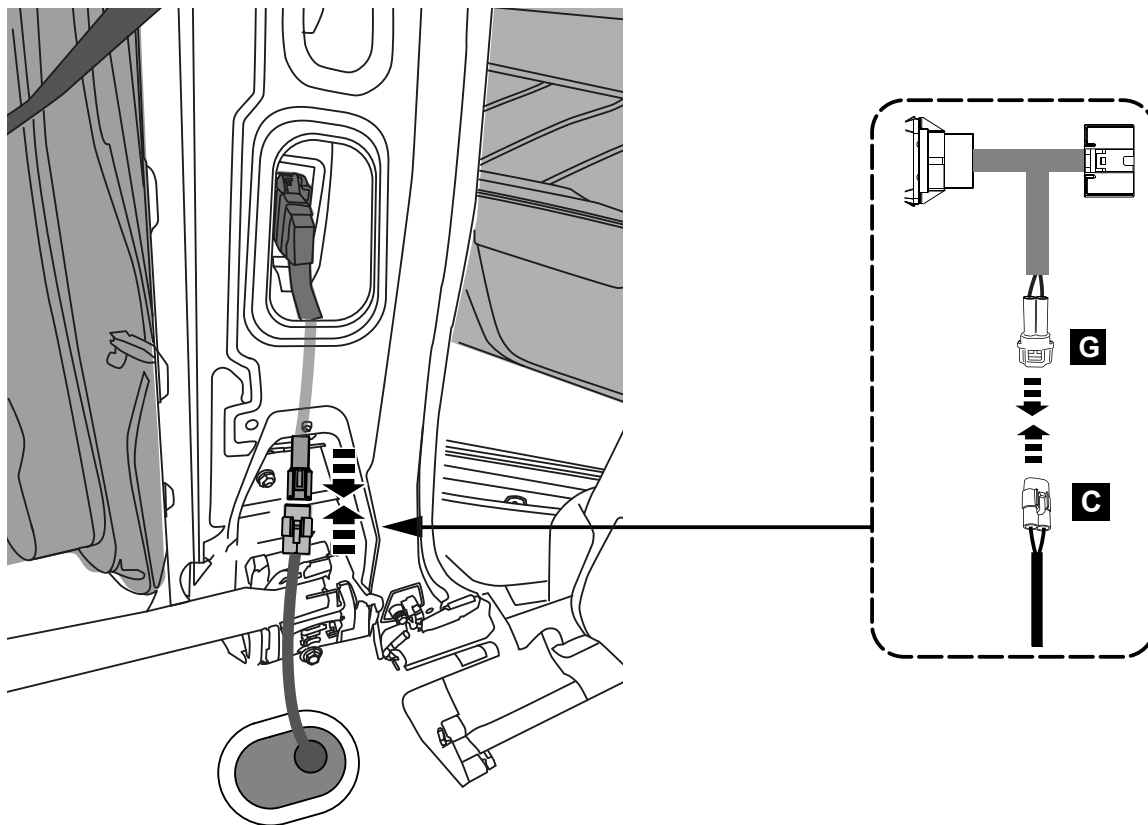

- 11** Connect the T-patch connector (G) to the main harness connector (C) in the B-pillar.

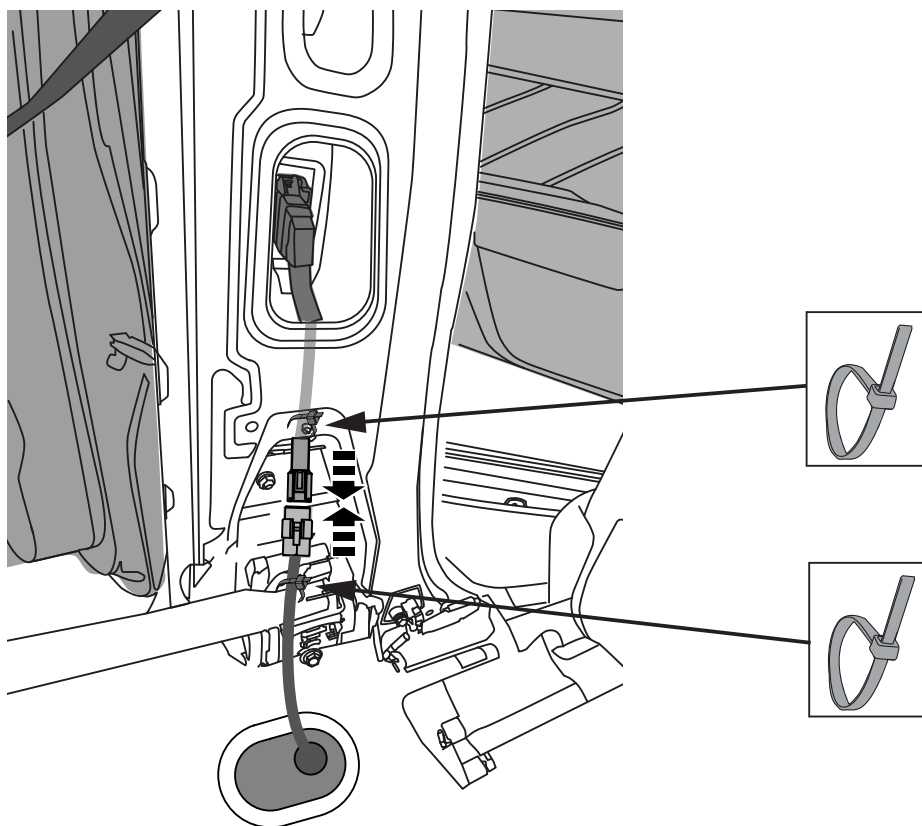

- 12** Run the vehicle harness connector (C) along the floor and up to the T-Patch and connect to the (G) connector joining T-patch and harness as shown.
IMPORTANT: Secure the harness by using cable ties to the original vehicle harness and cable tie to the body on the B-pillar to keep away from the seat belt retractor. Test seat belt before and after refitting the panels. Refit the middle panel and kick panel with the scuff plate to the vehicle.



DURING ASSEMBLY PROCEDURE SUPPORT AT CENTRE OF CANISTER ONLY,
PLACE ON TOP AND BASE CARTON (OR SIMILAR), COVER WITH FOAM BLANKET.
TO AVOID SCRATCHING POWDER COATED SURFACES.
DO NOT LOAD ELECTRICAL CONNECTORS OR MOTOR COVER.

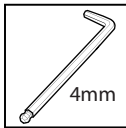
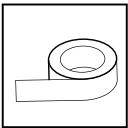

**RHS
FIT FIRST**

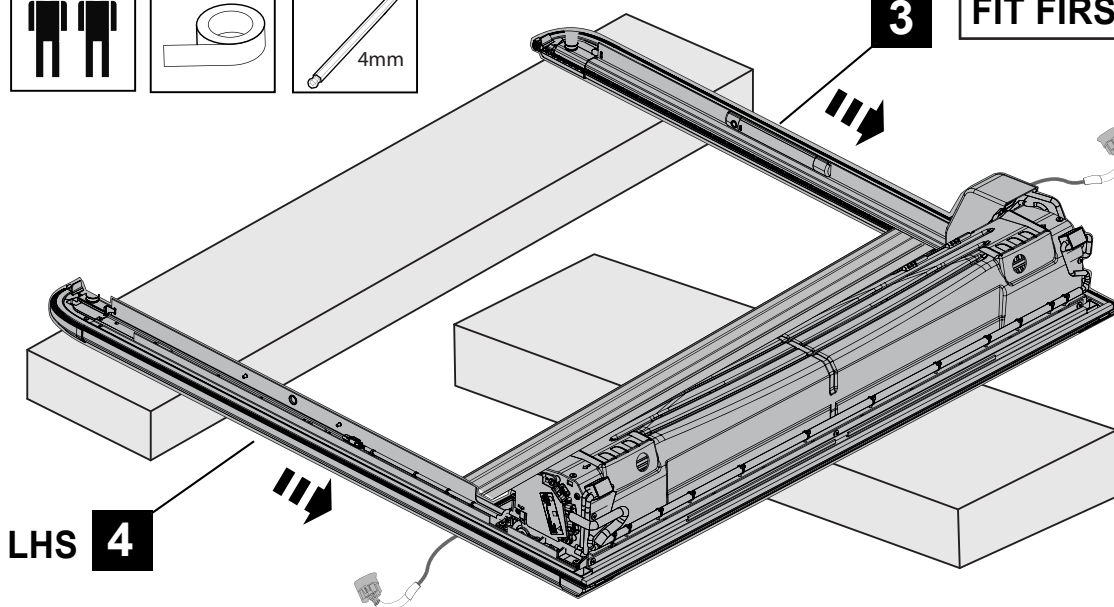

1



ATTENTION: SEAL MUST FACE IN THE
DIRECTION AS SHOWN. WARRANTY VOID IF
ASSEMBLED INCORRECTLY.

HOLD SEAL FLAT
USE CLOTH TAPE

RHS SHOWN

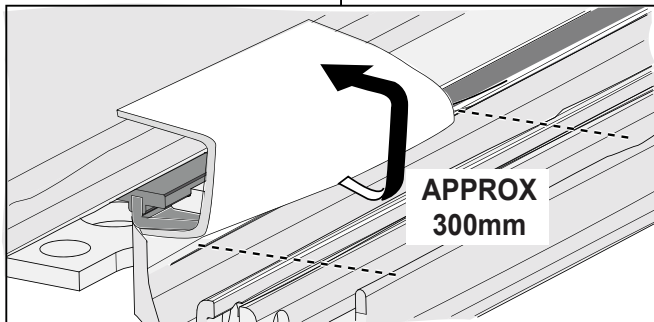
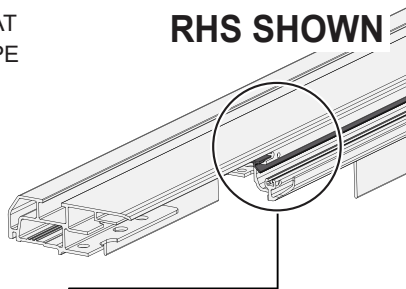
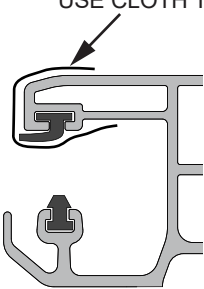

**APPROX
300mm**

2



ATTENTION: EXPOSE 3 SLATS PRIOR TO
FITTING SIDE RAILS.



ENSURE ENDS ARE
ALIGNED

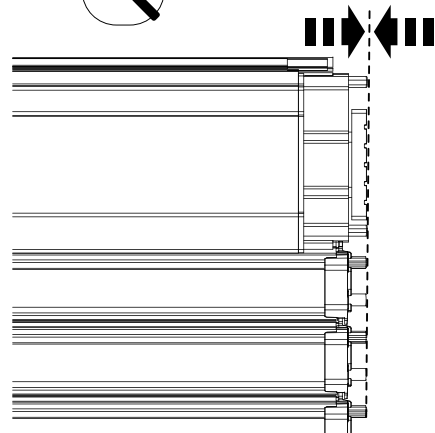

1 Place the canister (1) on two protected boxes as shown, ensure hand rail and slat ends are aligned. Tape up the seal on the Side Rail (5) as shown.

IMPORTANT: Carefully align and slide the rail over the handrail and canister endplate taking particular care to ensure that the siderails are slid straight and no undue force is applied to the rail. Details in following steps.

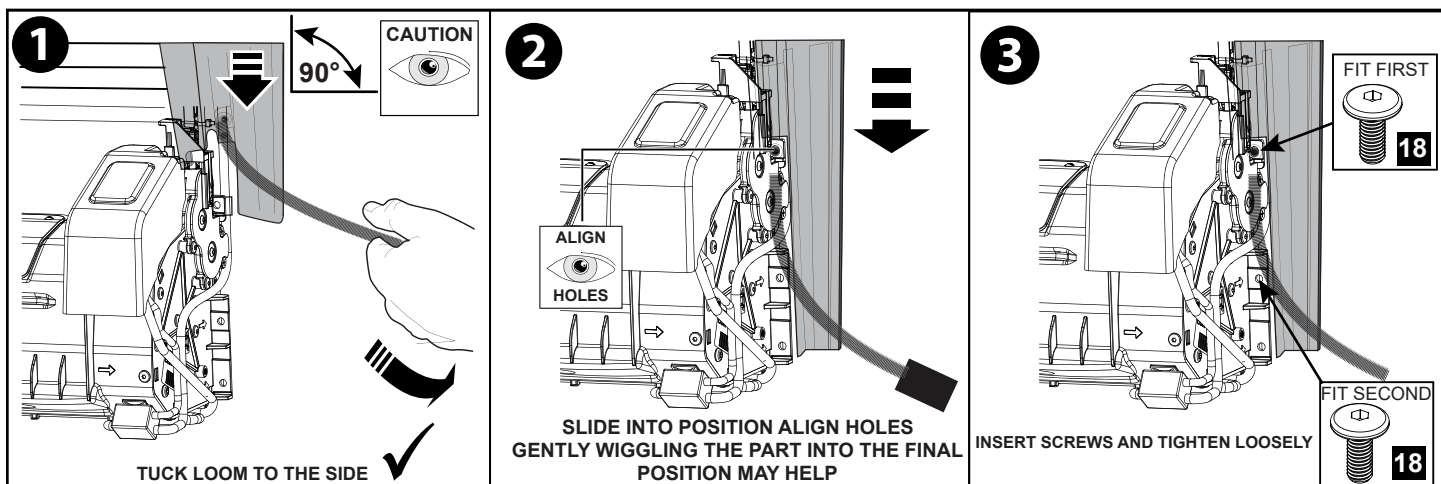

2 Pull hand rail to expose 3 slats. Slide the RHS Rail over slat ends and onto endcap location pins. Align the holes and secure loosely with two screws (18). Do not tighten. Repeat for LHS Rail (4).

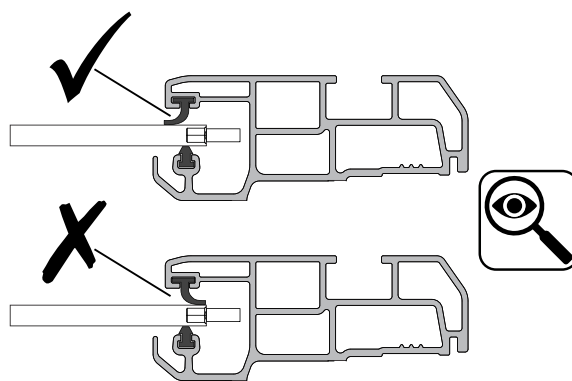
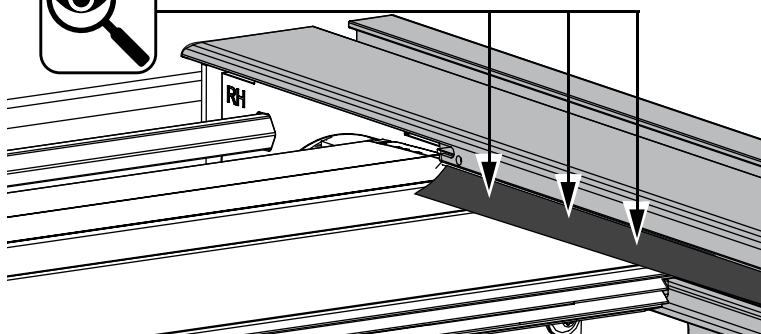
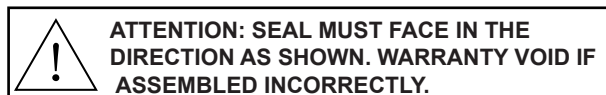
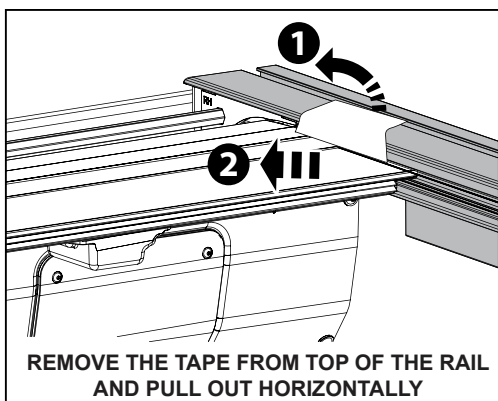
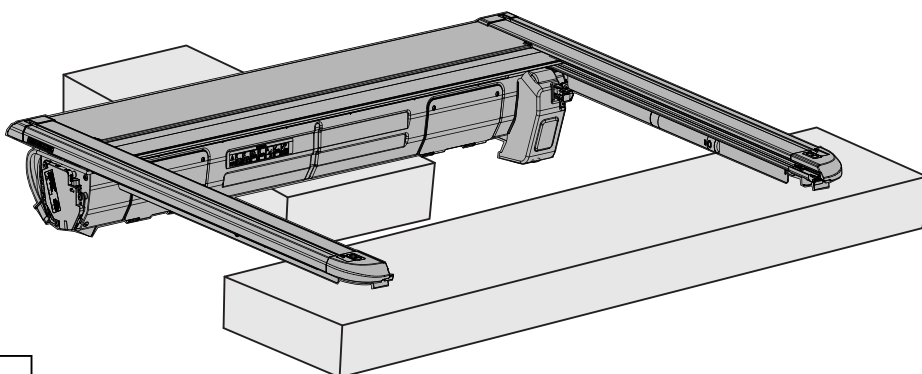
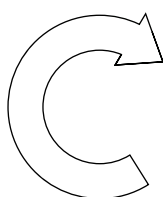

CHECK SEAL IS IN POSITION AND NOT DAMAGED

3 Carefully lay the assembly over onto a protected surface. Remove the tape holding the rubber seal and check the seal position as shown. Repeat for LHS Rail (4)

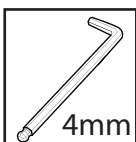

SIDE VIEW

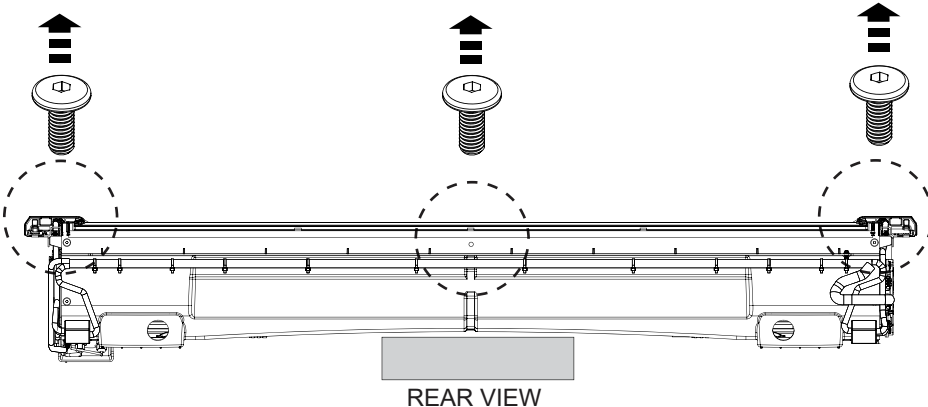
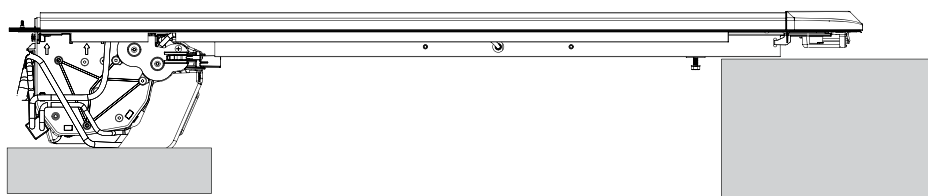

REAR VIEW

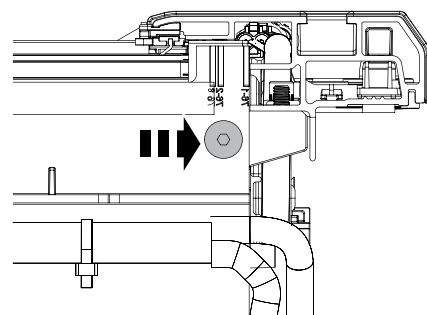

REMOVE AND RETAIN 3 SCREWS

- 4** Remove the 3 pre-fitted screws from the rear of the cover which will be used to secure the Front Plate (1) to the assembly. Ensure the product is not scratched or damaged when laying flat.
IMPORTANT: Do not apply load to the electrical connectors and do not sit product on motor cover.



CAUTION



DO NOT DAMAGE

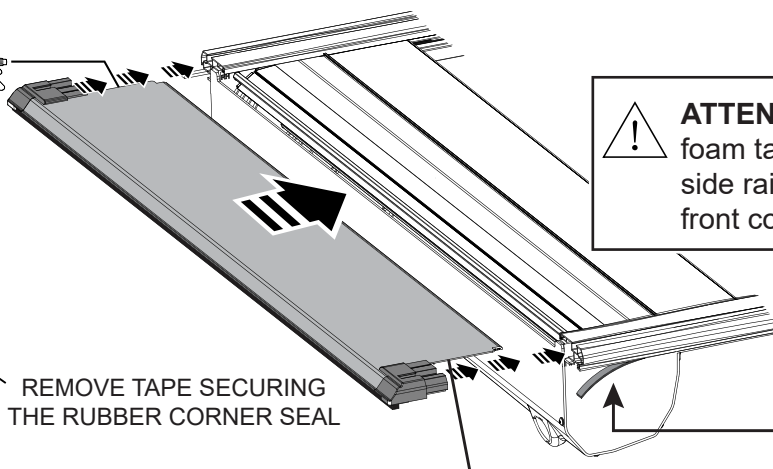

REMOVE TAPE SECURING THE RUBBER CORNER SEAL

LHS SHOWN



ATTENTION: Remove foam tape end from the side rail before fitting into front cover

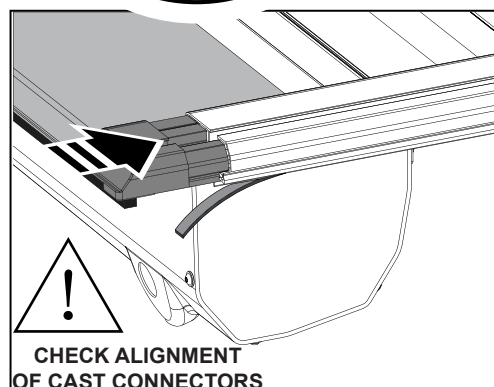

! CHECK ALIGNMENT OF CAST CONNECTORS

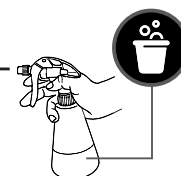
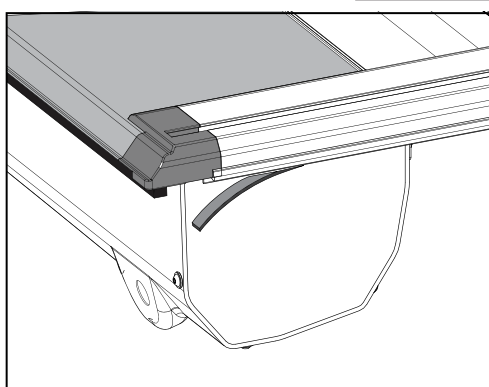

- 5** Slide the Front Plate (2) over the canister and into the side rail channels ensuring that the foam side rail tape is pulled out of side rail and the small rubber corner seal on the RHS and LHS of the front plate are not damaged.
IMPORTANT: Spray the front cover edge with soapy water to allow it to slide easily into the sides, twisting side rails outwards will also help.

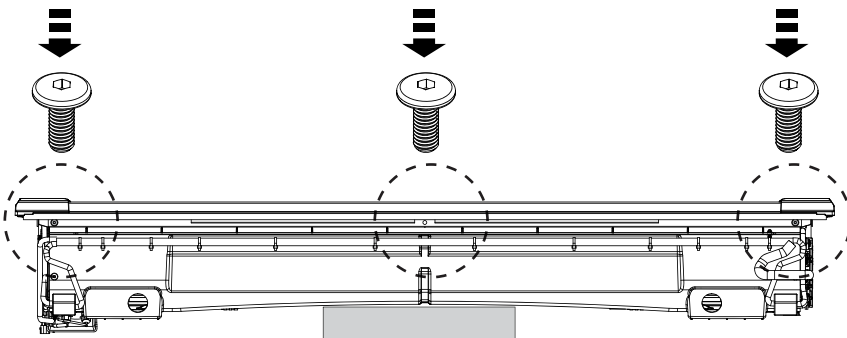
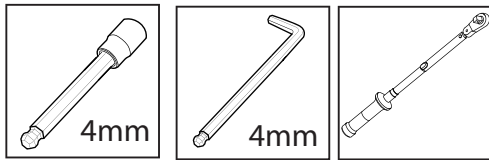

REAR VIEW

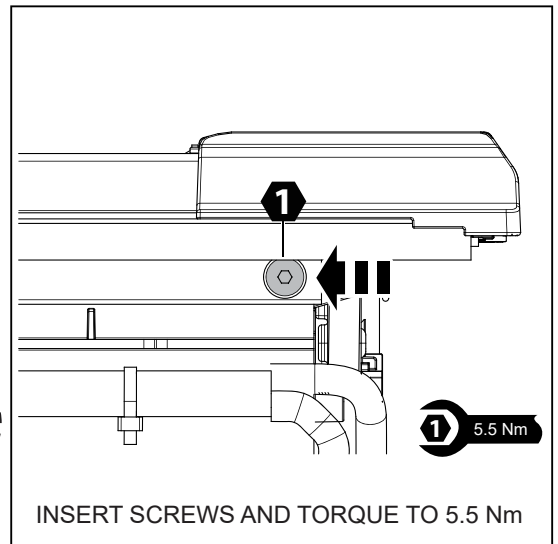

INSERT SCREWS AND TORQUE TO 5.5 Nm

- 6** Using the 3 screws removed from Step 4, screw the Front Plate (2) to the Canister Assembly (1) and torque to 5.5 Nm.

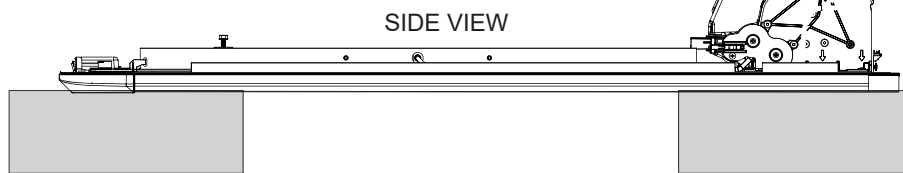
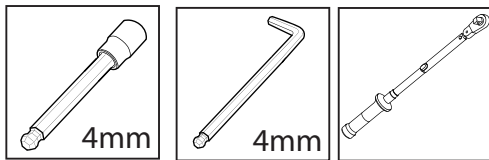

SIDE VIEW



LHS SHOWN - RHS IS A MIRROR IMAGE

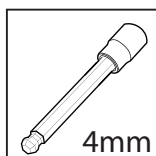
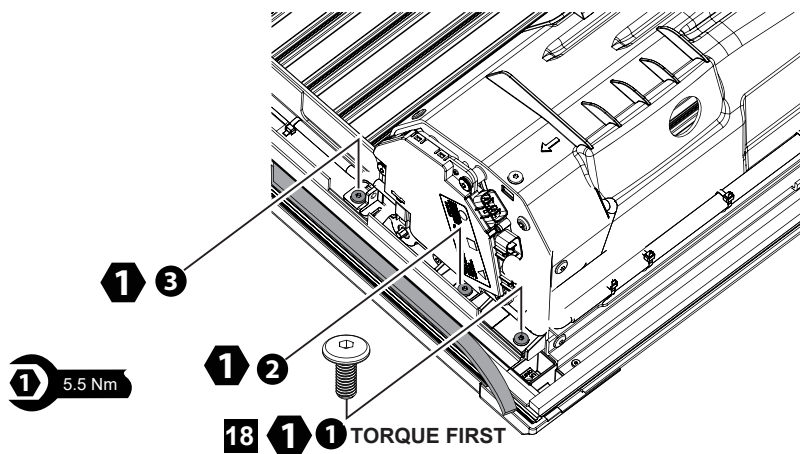

USE BALL END 4MM ALLEN KEY
FOR THE SCREW LOCATED UNDER THE ECU



- 7** Carefully flip the assembly over onto a flat protected surface which will not damage the cover or scratch the paint work. Install the screw (18) on each side through the canister and side rail into front cover. Torque all screws in order shown to 5.5 Nm.

LHS SHOWN - RHS IS A MIRROR IMAGE

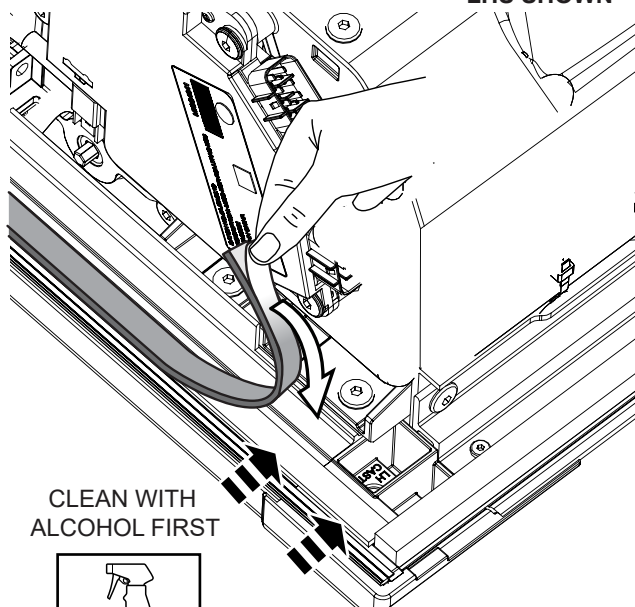

CLEAN WITH ALCOHOL FIRST

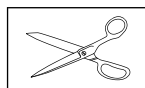
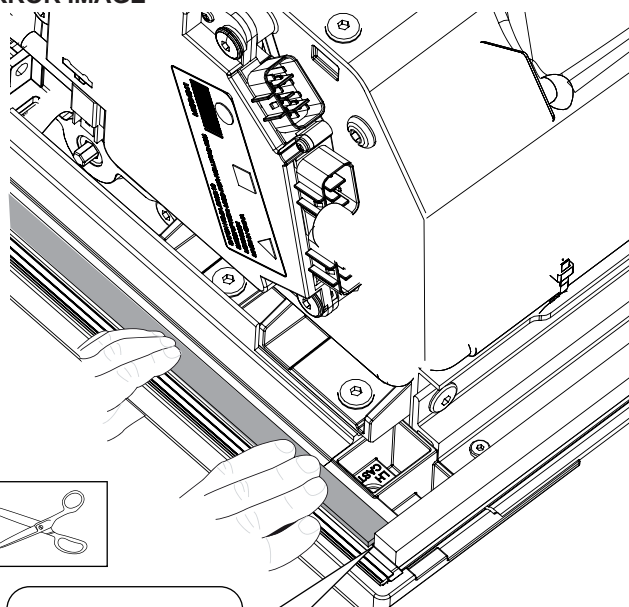

TAPES MUST CONTACT

- 8** Clean powder coated surface first with alcohol spray. Trim foam tape length to ensure the end will butt against front cover seal - avoiding any gap. Peel the protective liner from the foam tape, adhere to the channel in the side rail, Press down firmly to secure. Repeat on RH side rail.

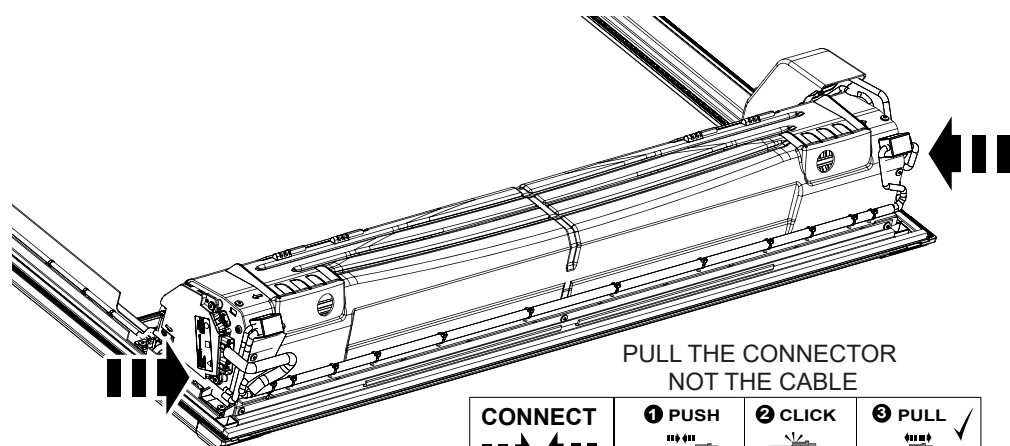

PULL THE CONNECTOR
NOT THE CABLE

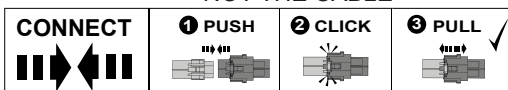

IMAGES FOR REFERENCE ONLY

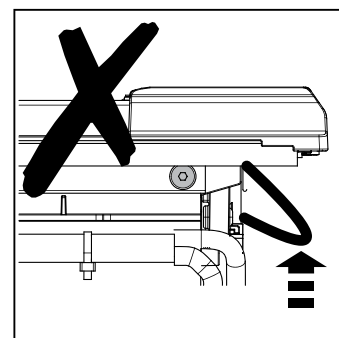

SECURE ALL CABLES TO
PREVENT PINCHING

IMAGES FOR REFERENCE ONLY

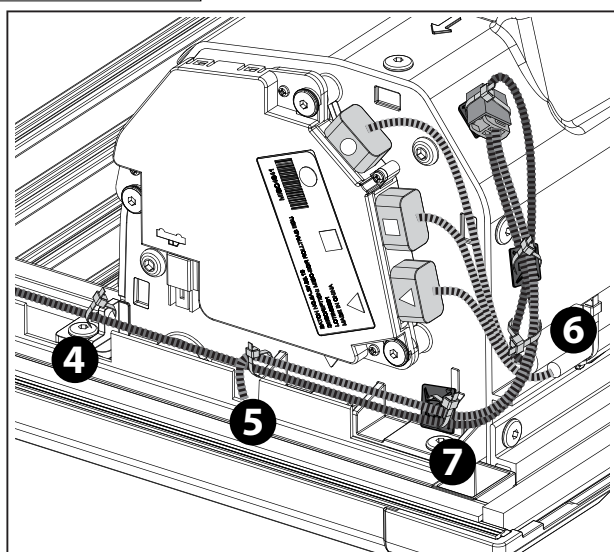
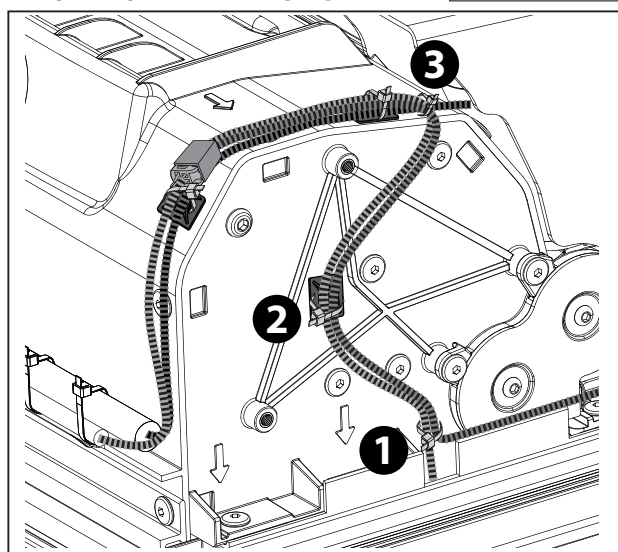

- 9** Connect side rail harness connectors to the connectors on the canister on the LHS and RHS. Secure the harness to the canister using cable ties at the six locations shown. Secure with zip ties and pads. Ensure all cables are retained to prevent pinching during installation.

1

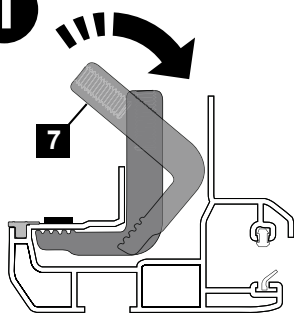

INSTALL 6 CLAMP
TOPS INTO RAILS & SECURE
WITH CLOTH TAPE

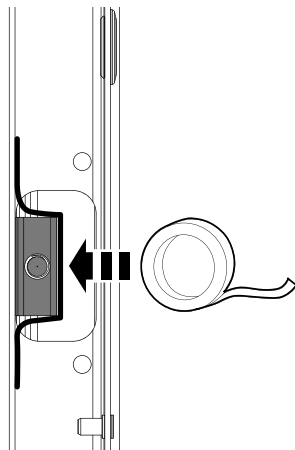

2

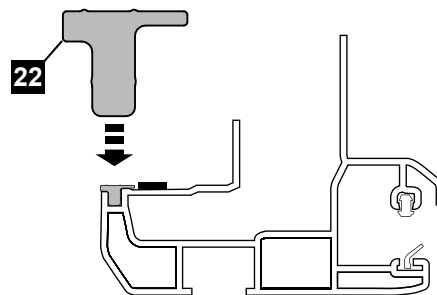

INSTALL RUBBER SEAL
IN SIDE RAILS

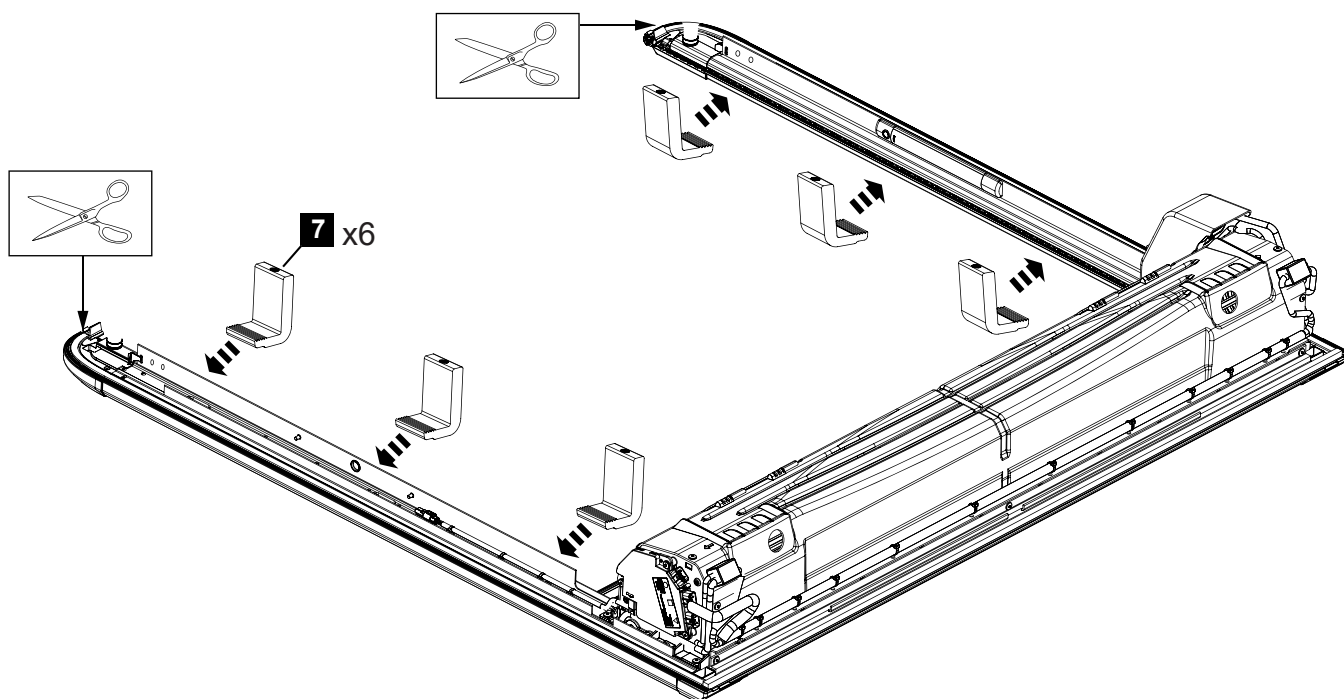

- 10** Install the six Clamp Tops (7) into the LHS and RHS side rails and secure with tape to temporarily hold in position. Install the Rubber Perimeter Seal (22) into each side rail and ensure seal is firmly seated (note the seal orientation). Trim the seal length to suit.

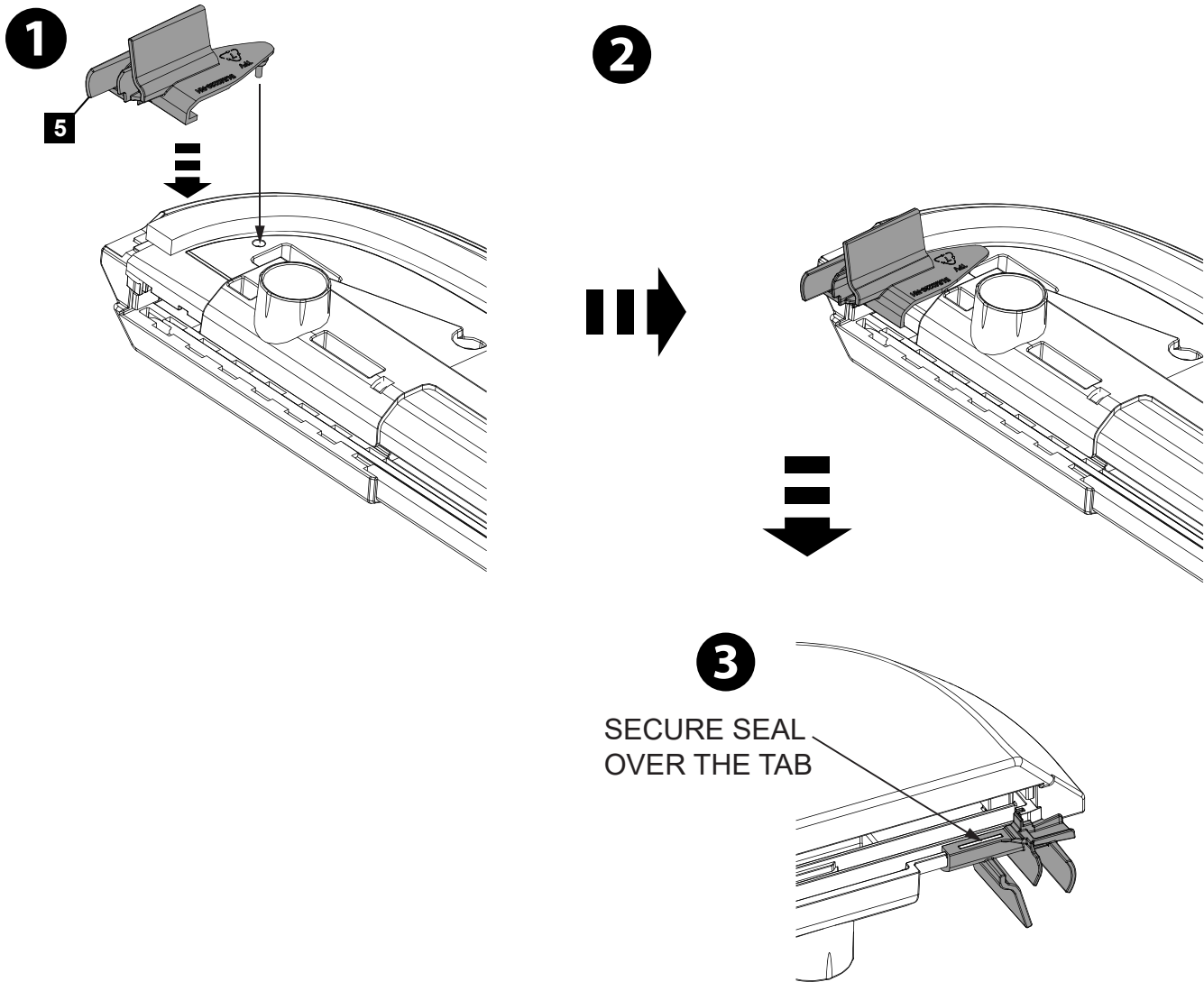

- 11** Fit the rear seal (5) to the endcap as shown on the RHS. Push the rubber dimple through the hole in the endcap first (use soapy water to assist). Secondly fit the rubber seal over the tab on the inner side of the endcap. Repeat for the LHS.

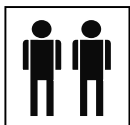
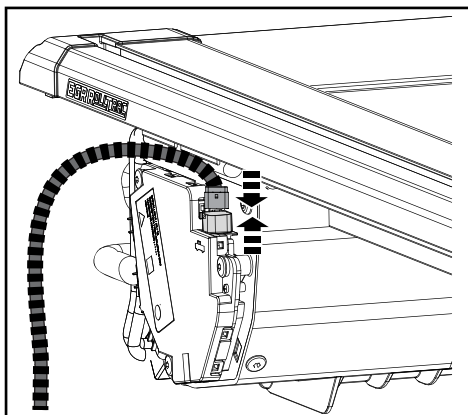
**HEAVY**

PULL THE CONNECTORS NOT THE CABLE

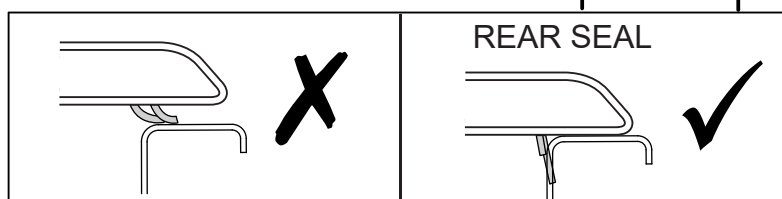
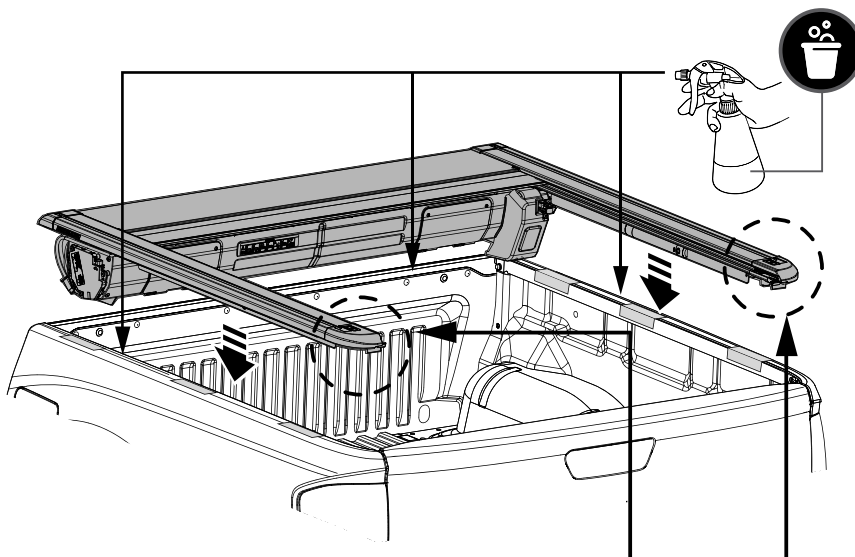
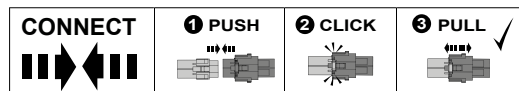

- 1** Spray the top surface of the tub liberally with a soapy water solution to enable the Cover to slide easily. Using two people to lift the cover from both sides and carefully lower it onto the tub. Connect the vehicle harness to the ECU as shown. **NOTE:** You may have to lift the LHS of the cover and use packer to aid connection. Ensure rear seals are sitting vertically as illustrated.

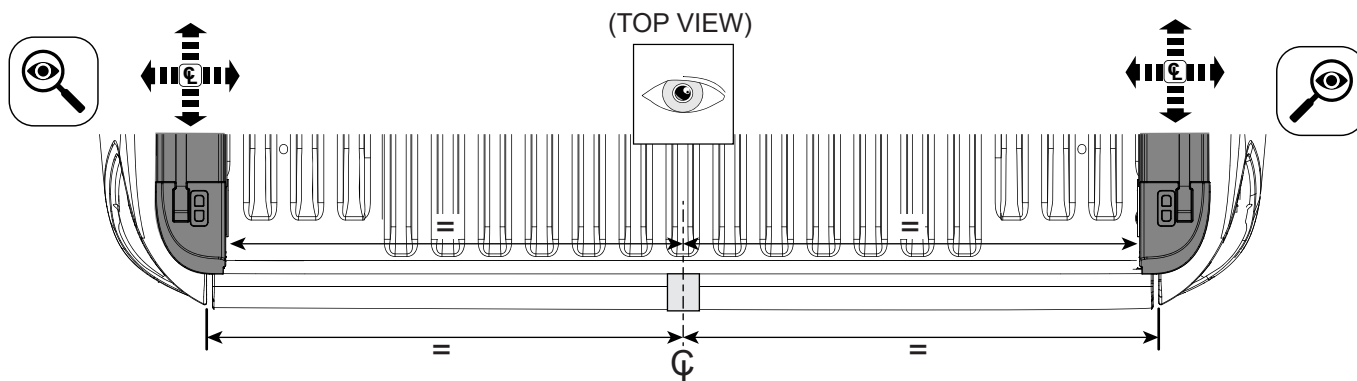

CENTRALISE AND ALIGN THE COVER TO THE MARKINGS

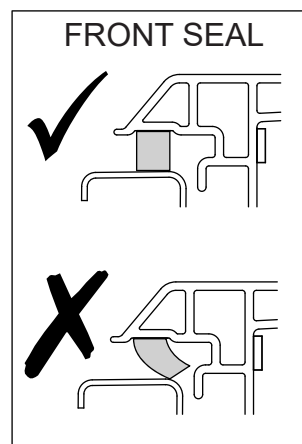
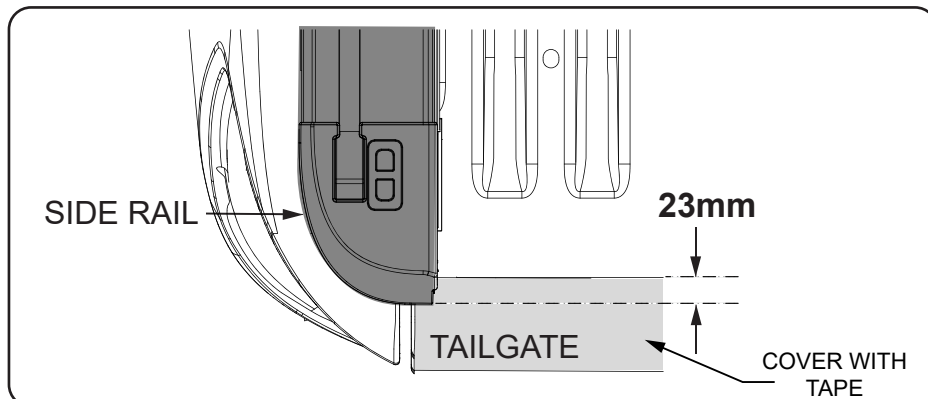

- 2** Adjust the cover as shown. Ensure seals are not deformed by lifting cover and dropping vertically on tub.

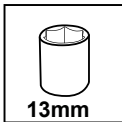
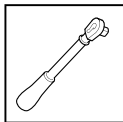

13mm

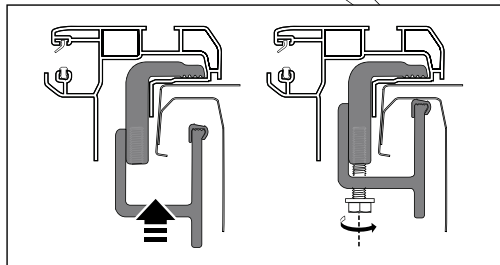
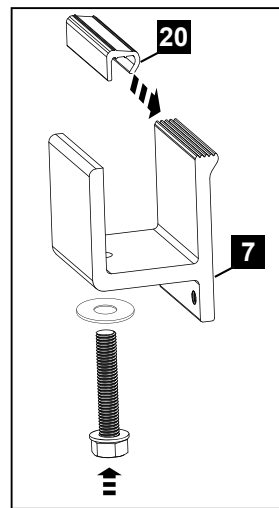
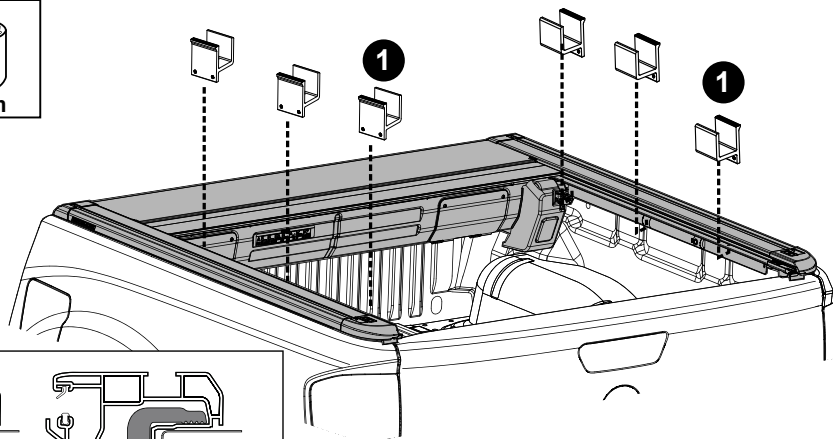

- 3** Slide the clamp feet (20) onto the clamp base and loosely install the LHS and RHS clamp bases (7). **DO NOT TIGHTEN. IMPORTANT:** Ensure to install washers as supplied in the kit.

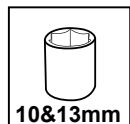

10&13mm

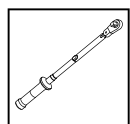

x6

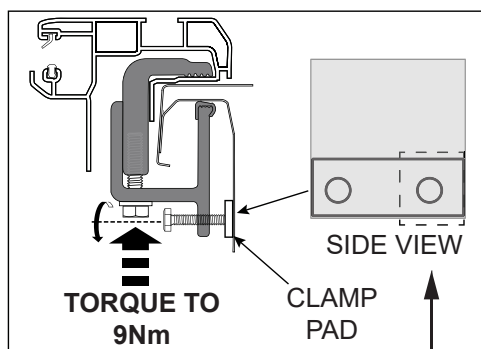

TORQUE TO
9Nm

SIDE VIEW

CLAMP
PAD



ATTENTION: The side M6 bolts should be tightened until it contacts with the rectangular clamp pad. The bolts should not be tightened any further.



PERFORM FITMENT CHECK

A = A B = B

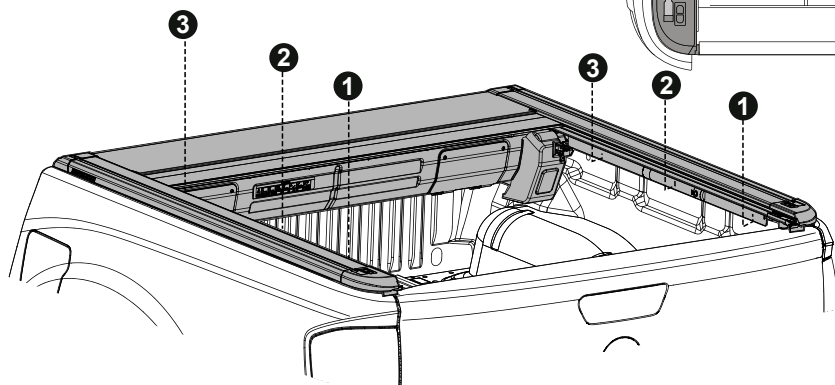
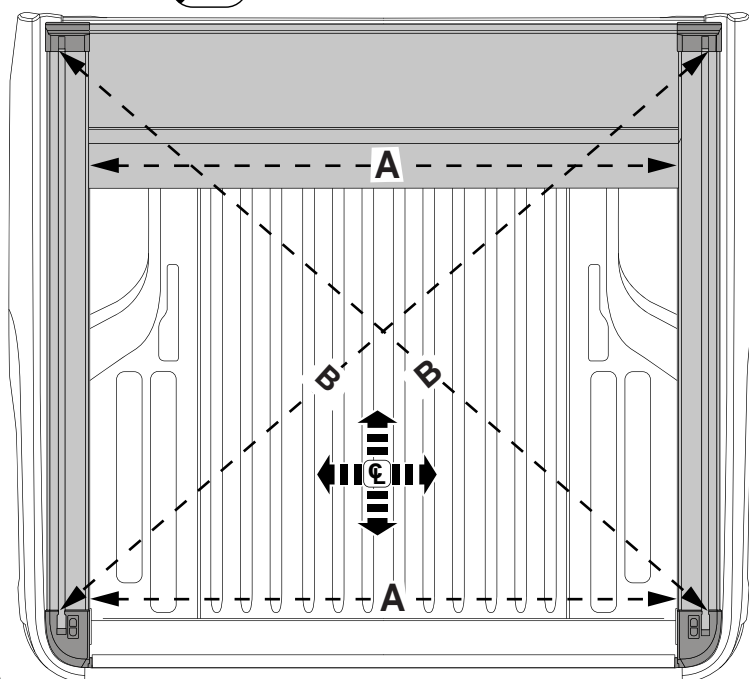

- 4** Torque (9Nm) the rear set of cover clamp bolts, ensuring cover does not move after tightening. Perform diagonal fitment check (bolts may need loosening for adjustment). At this stage the clamp bolts should be tightened from tailgate to the cab to 9Nm.

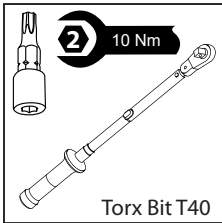

RHS SHOWN - LHS IS A MIRROR IMAGE

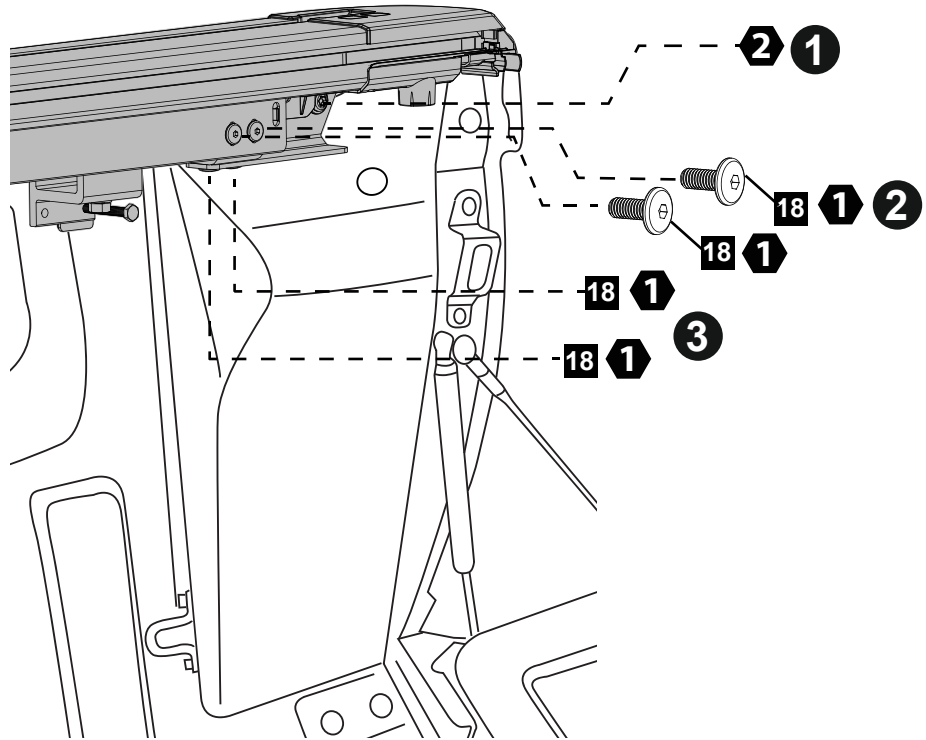

- 5** Secure the rear bracket to the siderail with two M6 screws (6) and torque the 4 screws to 5.5Nm.
Torque the rear bracket screw to 10Nm.
Torque the previously fitted screws (6) connecting rear bracket to the plate to 5.5Nm.
Repeat for the LHS.

FIT FRONT DRAIN TUBES TO THE CANISTER

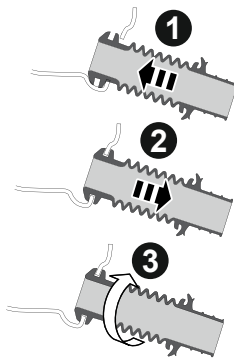
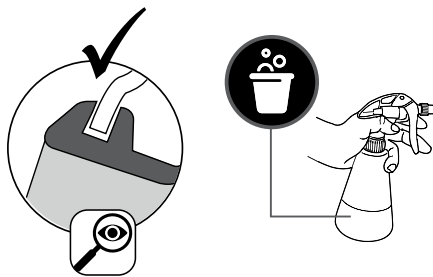

FIT REAR DRAIN TUBES TO SIDE RAILS

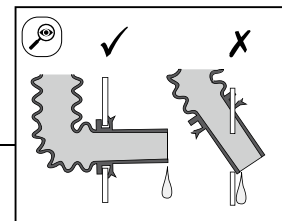
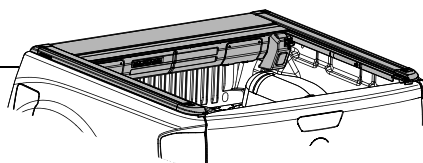
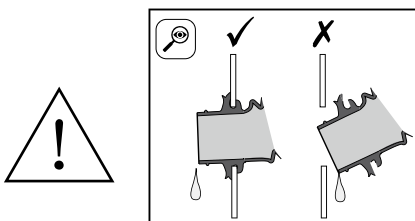
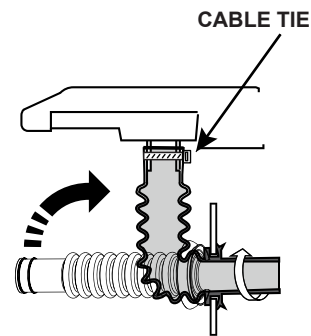

- 6** Connect the front drain tubes (8) to the canister cover. Connect rear (9) drain tubes to the vehicle tub, making sure that both tubes engage over the wall of the tub. Leakage will occur if they are not properly installed.

SILICONE LUBRICATION TO THE SPIRALS

(MODELS MAY VARY, IMAGES FOR REFERENCE ONLY)

- 1** Open tailgate and EGR RollTrac

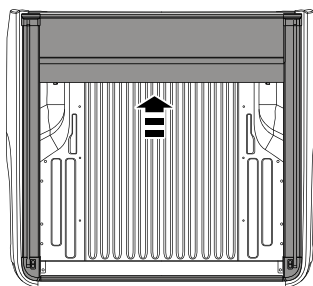
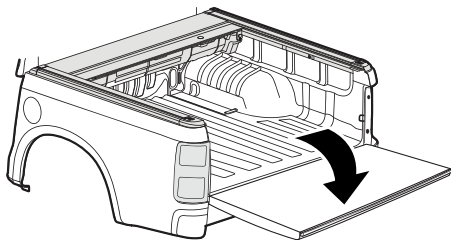

TOOLS REQUIRED:

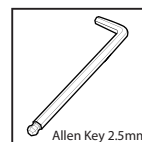

- 2** Using a 2.5mm Allen Key remove the 4 screws and open the inspection covers.
WARNING: Keep clear of moving parts and avoid unnecessary operation of the EGR RollTrac while inspection covers are open.

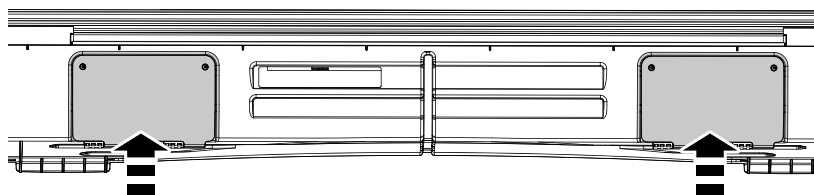

INSPECTION COVER

INSPECTION COVER

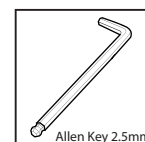

- 3** Close the EGR RollTrac to access canister internals

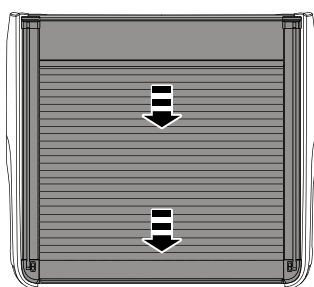

- 4** To avoid water leaks, look into the inspection points and check that the flanges of both front drain tubes are correctly engaged to the canister cover (without any kinking etc.), readjust if required.

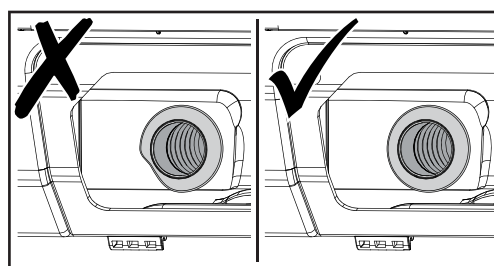

- 5** Using plastic compatible 100% Silicone Spray (ONLY) spray onto the spirals on both ends of the canister through the inspection points.

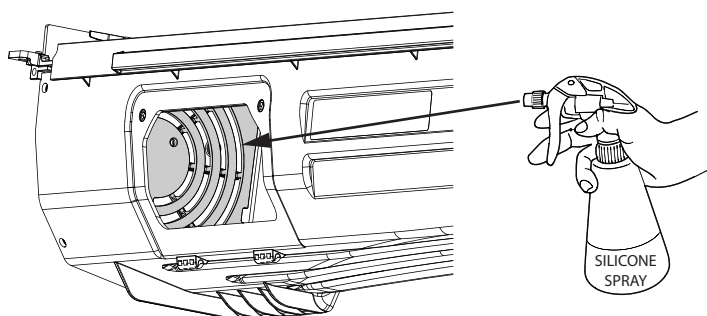

- 6** Open the EGR RollTrac

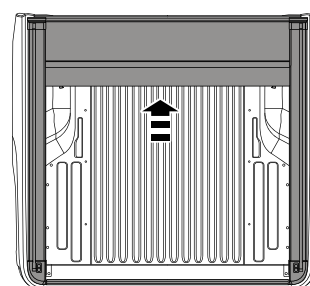

- 7** Close the inspection covers and secure with retained screws. Open and close the EGR RollTrac to distribute lubricant and check operation.

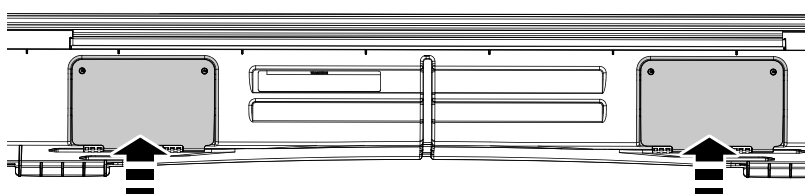

INSPECTION COVER

INSPECTION COVER



SECTION E

CALIBRATION PROCEDURE (MODELS MAY VARY, IMAGES FOR REFERENCE ONLY)

1. Insert fuse to EGR RollTrac harness.
2. Make sure the tailgate is open.
3. Engage motor, pull out lever (clutch).
4. Make sure the vehicle is unlocked and driver door open.
5. Press both buttons and hold for 5 sec. until light illuminates.



WARNING: Keep obstructions clear of cover during calibration mode.

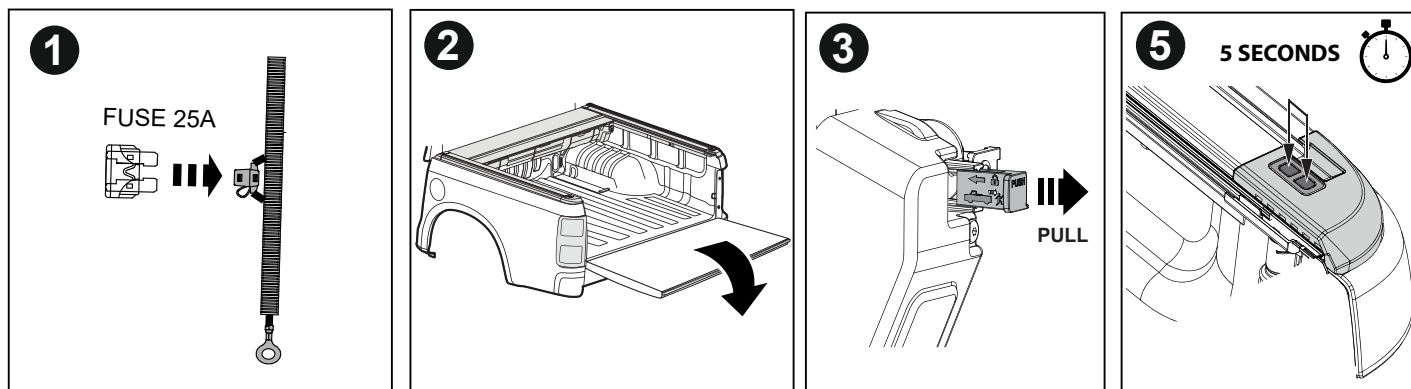

- Cover will CLOSE and OPEN once automatically.
- The EGR RollTrac internal LED light will pulse slowly during calibration and stop pulsing when calibration is complete.

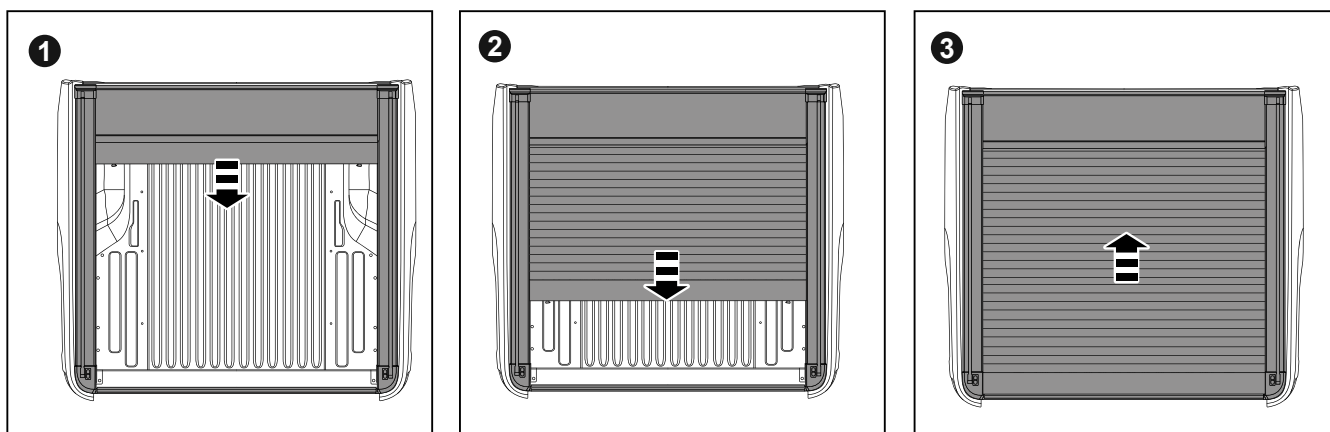
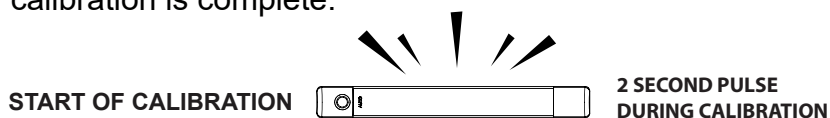

OPENING AND CLOSING PROCEDURE

Electric Opening Procedure:

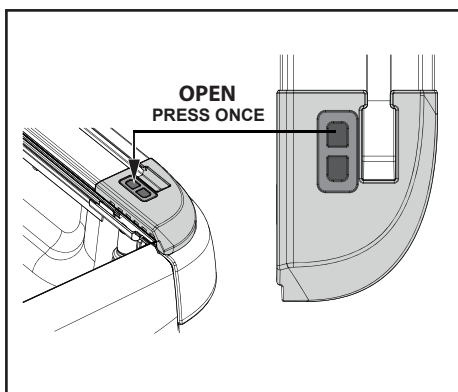
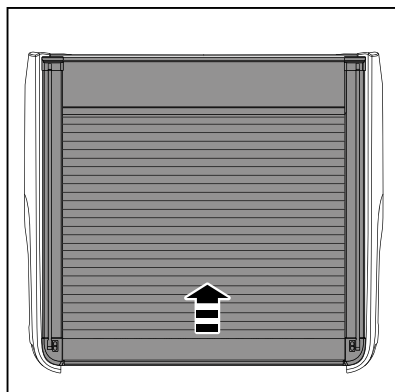

1. Press the front button on the EGR RollTrac side rail as shown.

Electric Closing Procedure:

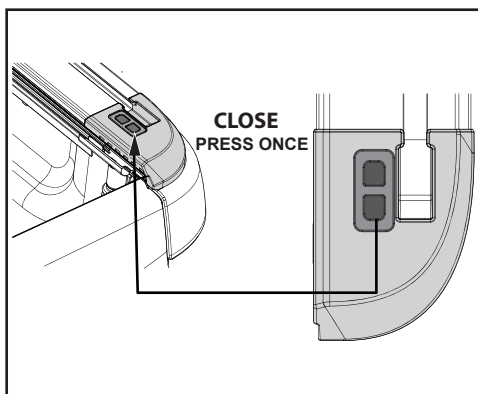
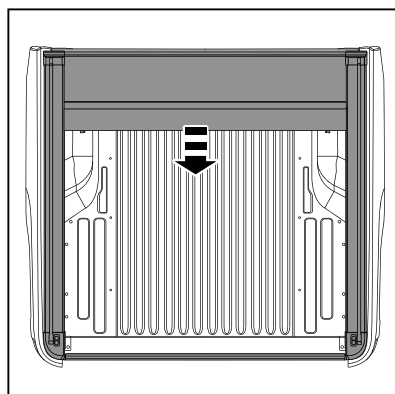

1. Press the rear button on the EGR RollTrac side rail as shown.

NOTE: EGR RollTrac should open and close smoothly. If cover does not lock or open correctly, please refer to the trouble shooting section in the Owners Manual. If the EGR RollTrac closing is slow, clean the siderails and ensure that no dirt or debris is inside the drive rail.

Manual Opening and Closing Procedure:

Locate the Clutch Disengagement Lever on the RH side of the cover and push the Clutch inward to disengage the motor. Pull the cover rearward or forward as required. Before driving vehicle ensure you re-engage the clutch.

IMPORTANT: If clutch was disengaged, calibration procedure needs to be re-run prior to electric operation.

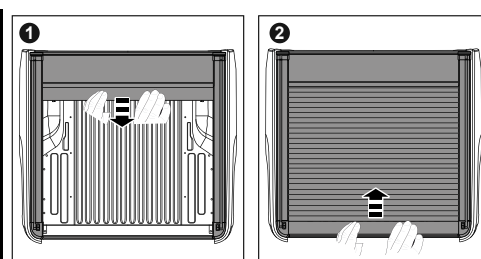
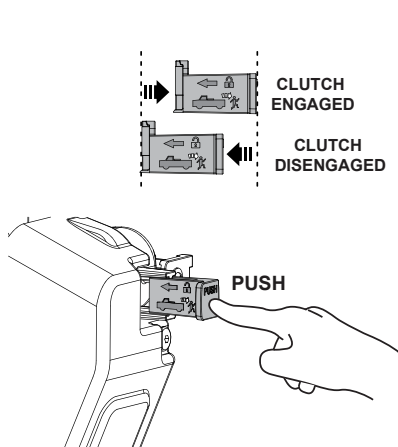
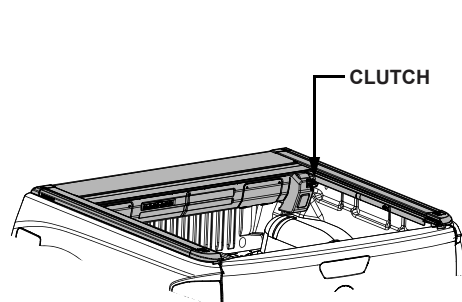

KEY FOB OPERATION



WARNING



- THIS DOCUMENT IS A SUPPLEMENT TO YOUR EGR ROLLTRAC OWNERS MANUAL, ENSURE THAT YOU READ BOTH DOCUMENTS AND FOLLOW ALL INSTRUCTIONS WHEN OPERATING THE EGR ROLLTRAC.
- DO NOT OPERATE THE EGR ROLLTRAC WHILE THE VEHICLE IS IN MOTION.
- EXERCISE CAUTION WHEN OPERATING THE EGR ROLLTRAC AT ALL TIMES – ALWAYS CHECK THE VEHICLE TUB / BED FOR POTENTIAL SAFETY RISKS (OBSTRUCTIONS, ENTRAPMENT etc) PRIOR TO OPERATION.

LOCKING / AUTO CLOSE PROCEDURE

Key Fob

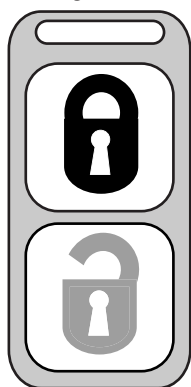

1. Press lock twice within 2 second, the vehicle will lock, if closed the RollTrac will lock, if open it will auto close.
2. To pause while in auto close motion, press lock once and the RollTrac will stop.
3. To resume auto close, press lock twice within 2 second.
4. When auto close is complete the RollTrac will auto lock.

UNLOCKING / AUTO OPEN PROCEDURE

Key Fob

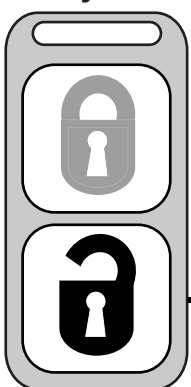

1. Press unlock twice within 2 second, the vehicle will unlock and the RollTrac will auto open.
2. To pause while in auto open motion, press unlock button once and the RollTrac will stop.
3. To resume auto open, press unlock twice within 2 second.
4. When auto open is complete the RollTrac will remain open until operated by either the key fob or the RollTrac buttons.

NOTES

- If pause is activated by the fob whilst auto closing, the RollTrac can be closed and paused using the RollTrac close button. Reactivate both Rolltrac buttons by unlocking the vehicle.
- If the RollTrac is open and the lock button is only pressed once, the vehicle and the RollTrac will lock.