

ADJUSTABLE LADDER RACK

Rolltrac Adjustable Ladder Rack Installation Instructions

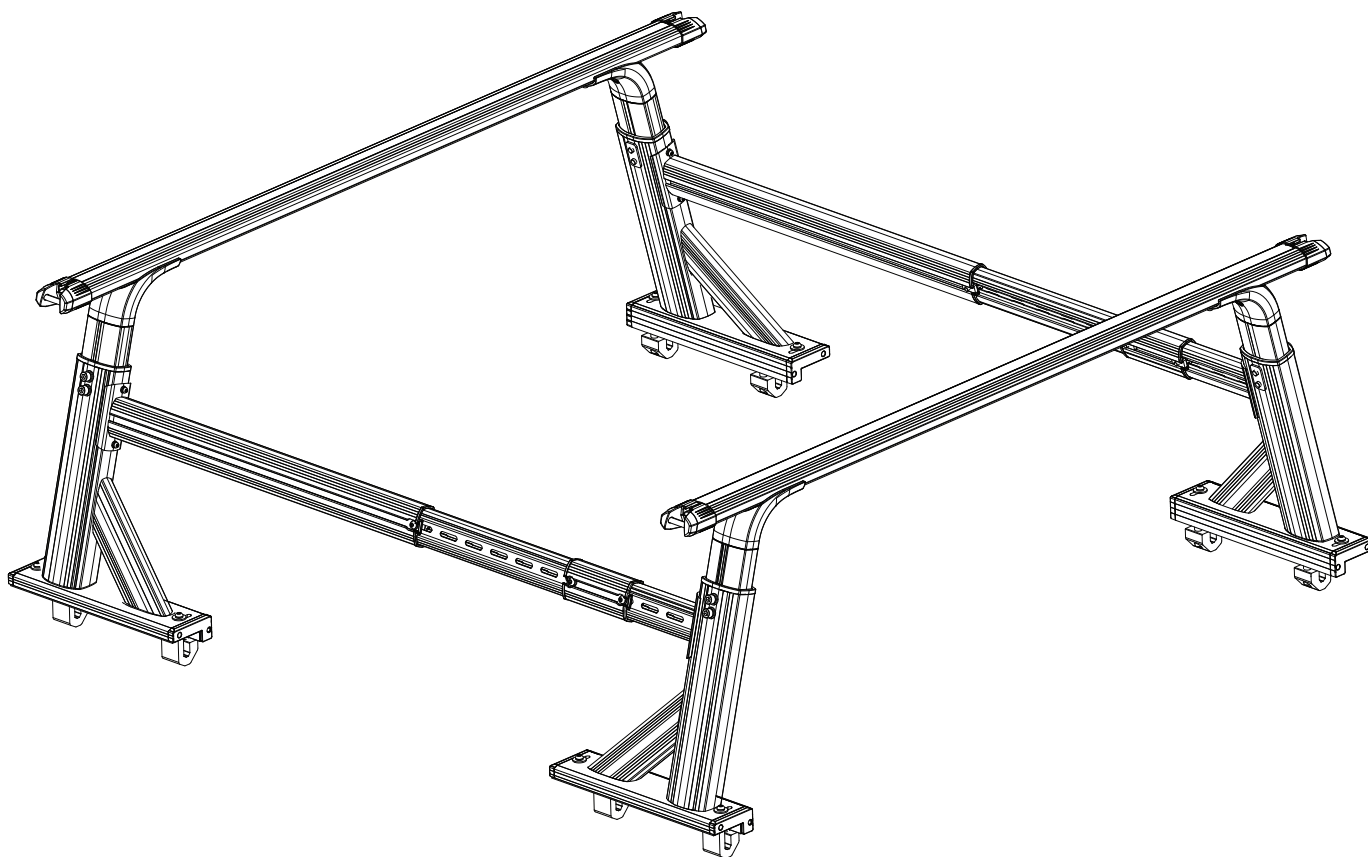

Installation Time: Approx. 60 mins

Place these instructions in vehicle's glove box after installation is complete

General Notes

- Read through the fitting instructions before installation of accessory.
- Always install the accessory following the fitting instructions. Failure to do so may cause damage to the vehicle or the accessory.
- Ensure all recyclable discarded vehicle accessory components and packaging are recycled following local recycling regulations.
- It is always recommended that this accessory is fitted by a qualified Technician.
- Safely store and protect any removed vehicle components.
- Ensure all bare metal surfaces are protected using Automotive Bare Metal Primer and touch-up paint.
- Please check content of kit using this list and subsequent sketches.
- Remove all metal swarf and dust from all vehicle surfaces if surface is used for accessory installation.

Safety Notes

- Check that all work practices comply with safety standards.
- Please wear appropriate clothing and use safety equipment.



Care Instructions:



Clean with mild detergent
and water solution.



Do not use abrasive
cleaners or solvents.

PARTS LIST

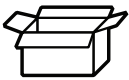

1

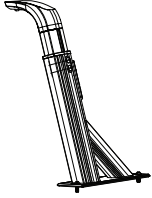

Leg Base A
Qty - 2

2

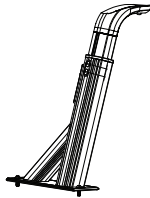

Leg Base B
Qty - 2

3

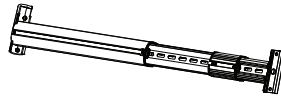

Side Bar
Qty - 2

4

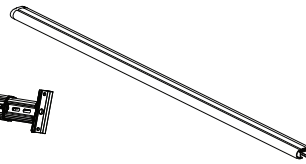

Cross Bar
Qty - 2

5



M4 x 12 Cross Round
Head Self Tapping Screw
Qty - 16

6

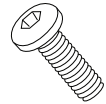

M6 x 12mm Hex
Socket Button Head
Qty - 4

7



M6 x 20mm Hex Socket
Button Head Screws
Qty - 8

8



M6 Flat
Washer
Qty - 8

9



M6 Spring
Washer
Qty - 8

10



M12 Spring
Washer
Qty - 8

11

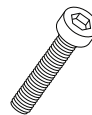

M12 x 50mm Hex
Socket Cap Screws
Qty - 8

12

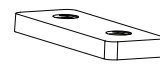

M8 Cross Bar Screw
Square Washer
Qty - 4

13



M8 x 20mm Hex
Socket Button Head
Screw
Qty - 16

14



M8 x 25mm Hex
Socket Button Head
Screw
Qty - 8

15



M8x24 Flat
Washer
Qty - 8

16



M8 Spring
Washer
Qty - 16

17



Nut Plate
M8 x 34 x 20 x 5
Qty - 8

18



Base Bracket
Qty - 8

19

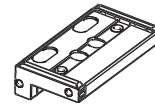

Fixed Base
Qty - 4

20



Base Washer Plate
Qty - 8

21



M8 x 16mm Hex
Socket Button Head
Screw
Qty - 8

22



M8x16 Flat
Washer
Qty - 8



TOOLS REQUIRED



6/8/10/12mm Allen Key



6/8/12 Allen Key
Socket



Socket Wrench

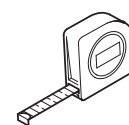

Tape Measure



Two
People
Required

ONLY FOR INSTALLATION ON VEHICLES WITH NO ROLLTRAC

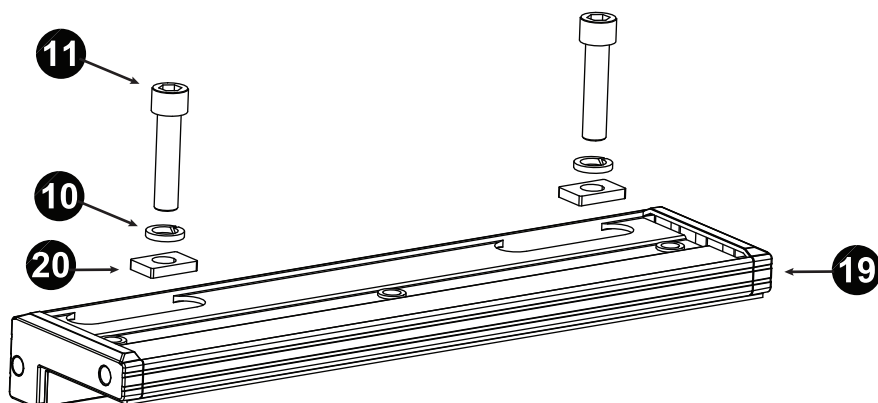

1. Pre-assemble fixed base if vehicle has no rolltrac installed, using 12x50 Hex Socket Cap Screw, Base Washer Plate and M12 Spring Washer.

ONLY FOR INSTALLATION ON VEHICLES WITH NO ROLLTRAC

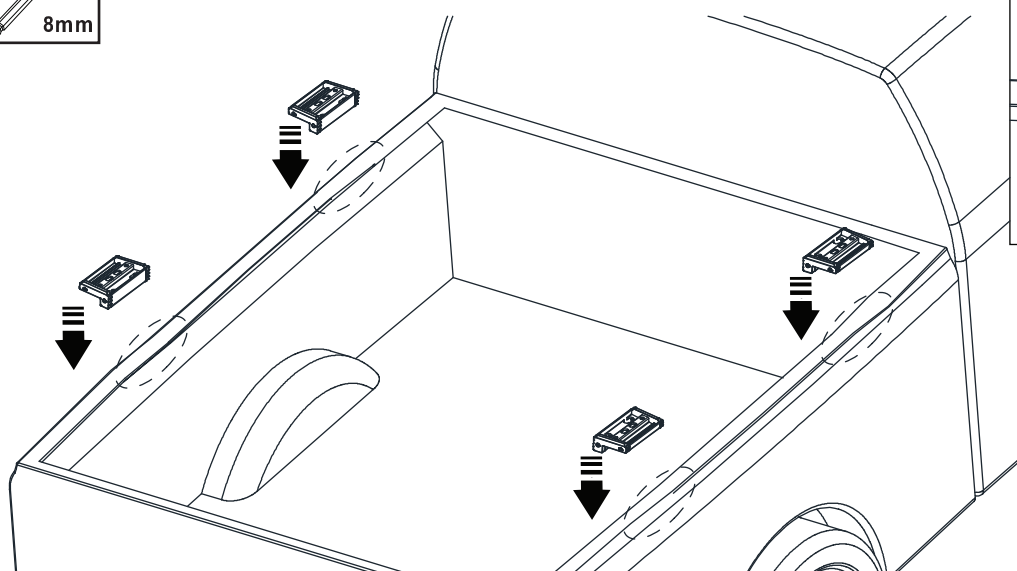
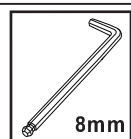

2. IF VEHICLE HAS ROLLTRAC INSTALLED SKIP TO STEP 6

Place the fixed base in the corresponding position of the tub. Fix the base bracket with the M12 x 50mm Base Screw, M12 Base Screw Spring Washer and M12 Base Screw Square Washer. DO NOT TIGHTEN THE SCREW.

Measure the size of the left and right 4 bases with a ruler respectively and place in the same position on the left and right. Adjust the consistent size and position on both sides and lock the screws.

FOR ROLLTRAC INSTALLATION:

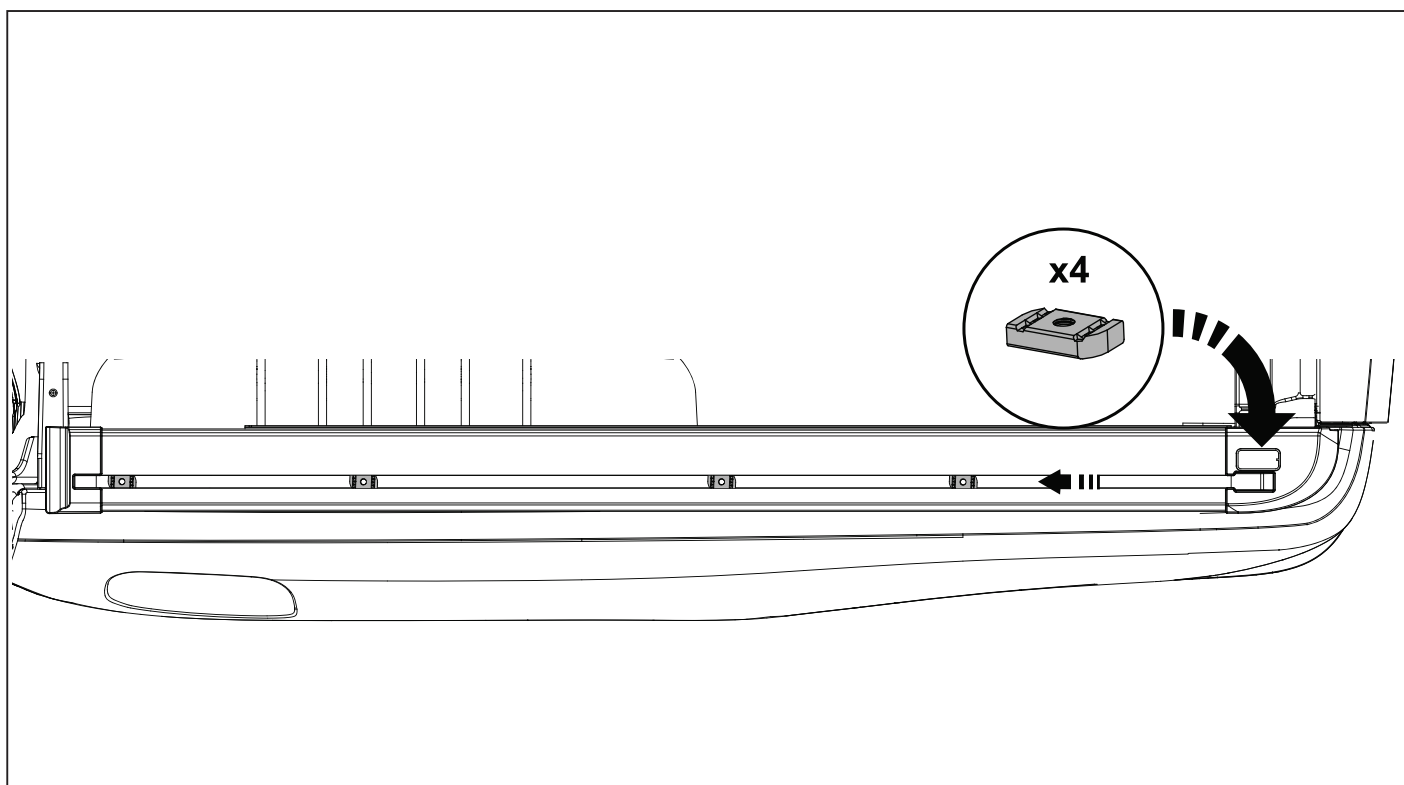
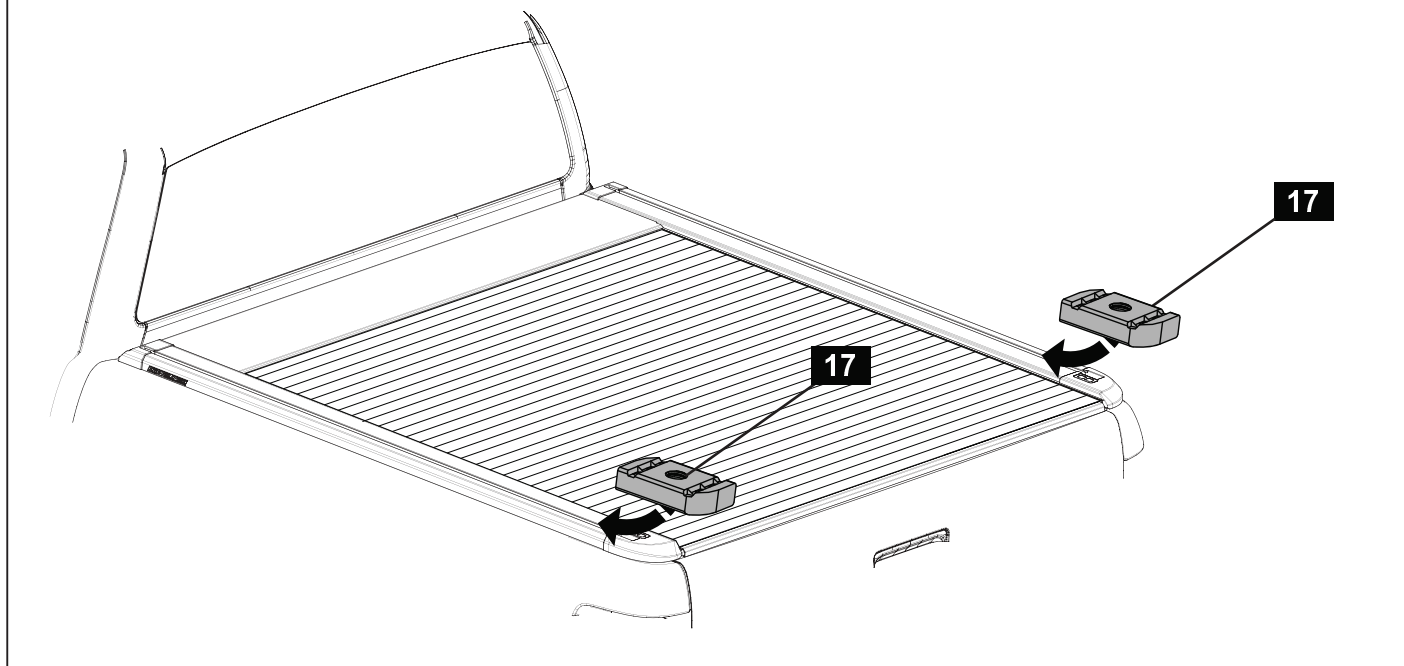

3. Insert 4x Nut Plates into each side rail T-Channel. Position Nut Plates in channel by lining up mounting slots in legs as shown.
Repeat for all four legs.

13/14

For Rolltrac: Use M8x20mm Screw
For Non-Rolltrac: Use M8x25mm Screw

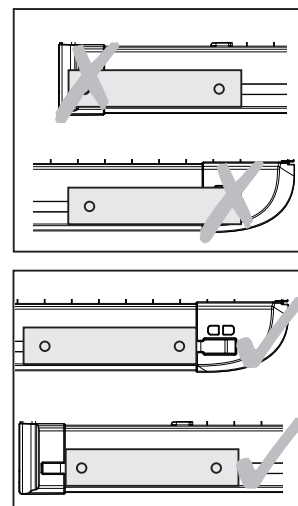
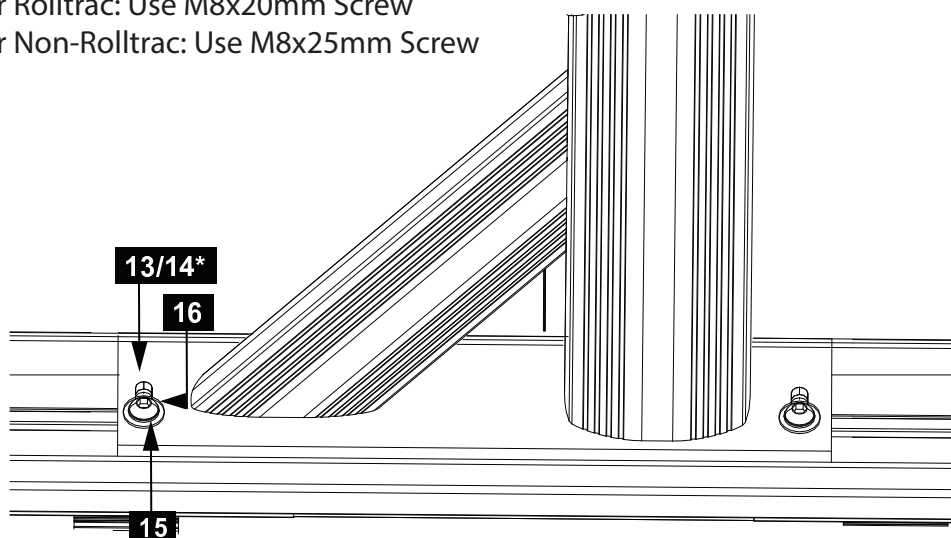

4. Loosely attach legs to the side rail using previously installed T-Nuts & M8x20mm or M8x25mm Screws, Spring Washer & Flat Washer.
Align the leg base so they only sit on the Aluminium Extrusion & not on the raised end caps of the side rail.

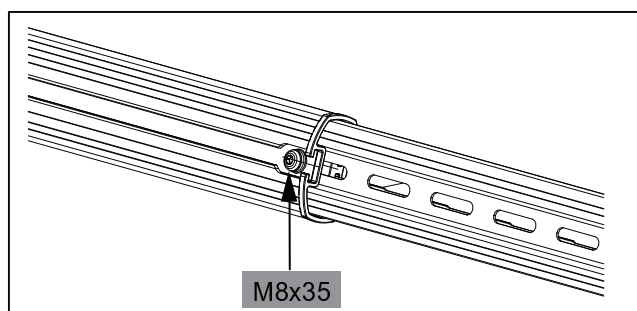
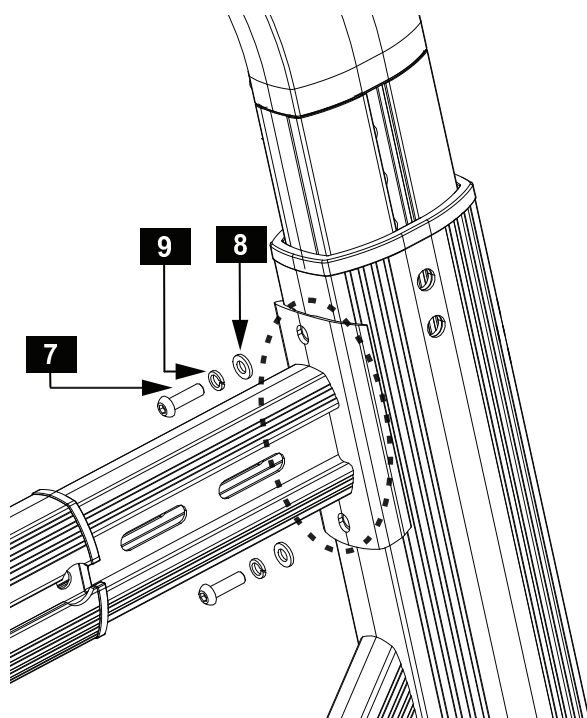

5. Remove & Retain M8x35 Hex Socket Button Head Screw from Side Bar. Extend side bar between front & rear leg uprights, then attach loosely with M6x20 Hex Socket Button Head Screws, M6 Flat Washers & M6 Spring Washers. Loosely reinstall M8 bolt removed from side bar, back into side bar. Repeat on other side.

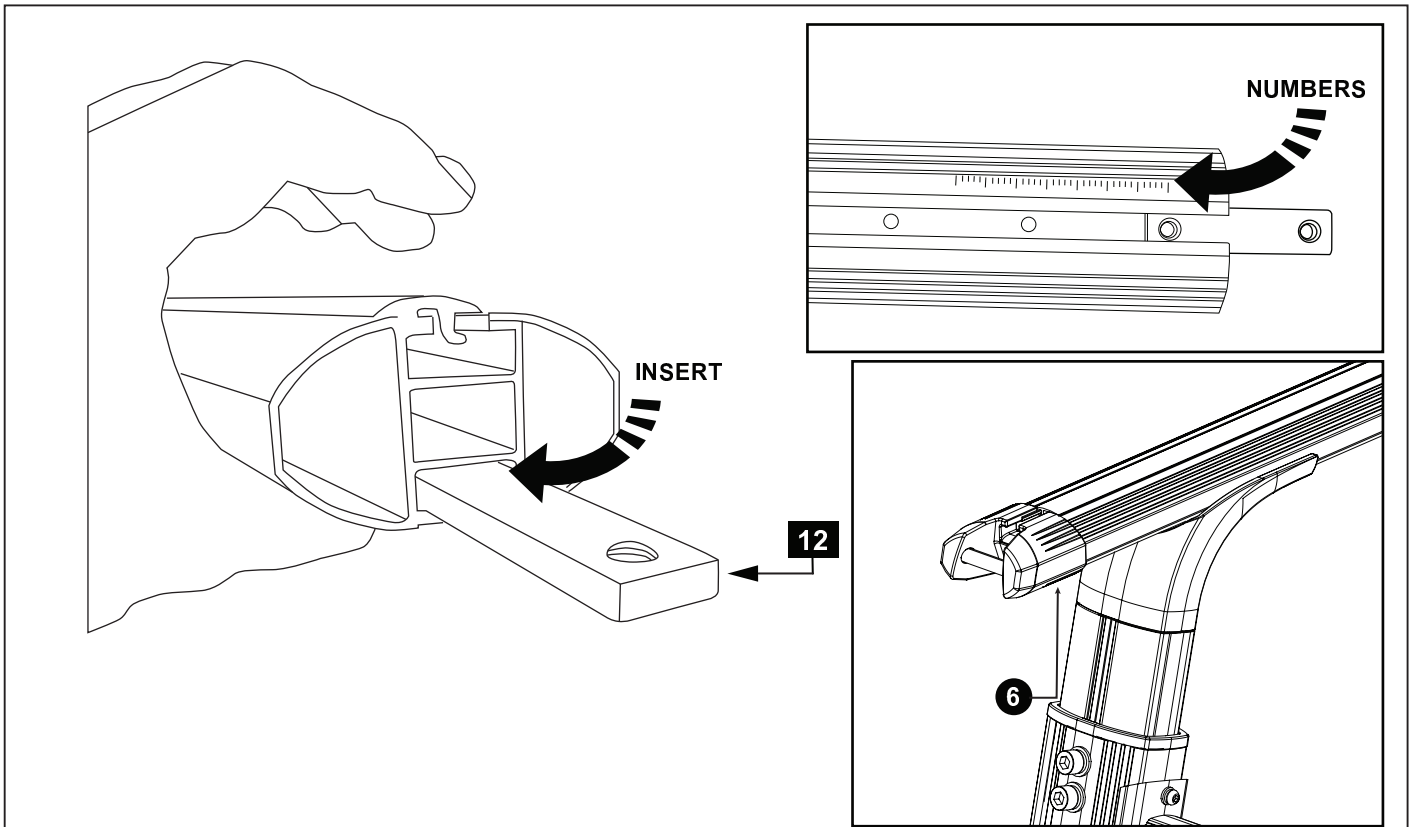

6. Remove the M6x12 Screw Beneath the End-Cap and Insert the M8 Nut Plate for the cross bar into the lowest slot.
Note: This is the side with the measurements printed on them.

Repeat for each end.

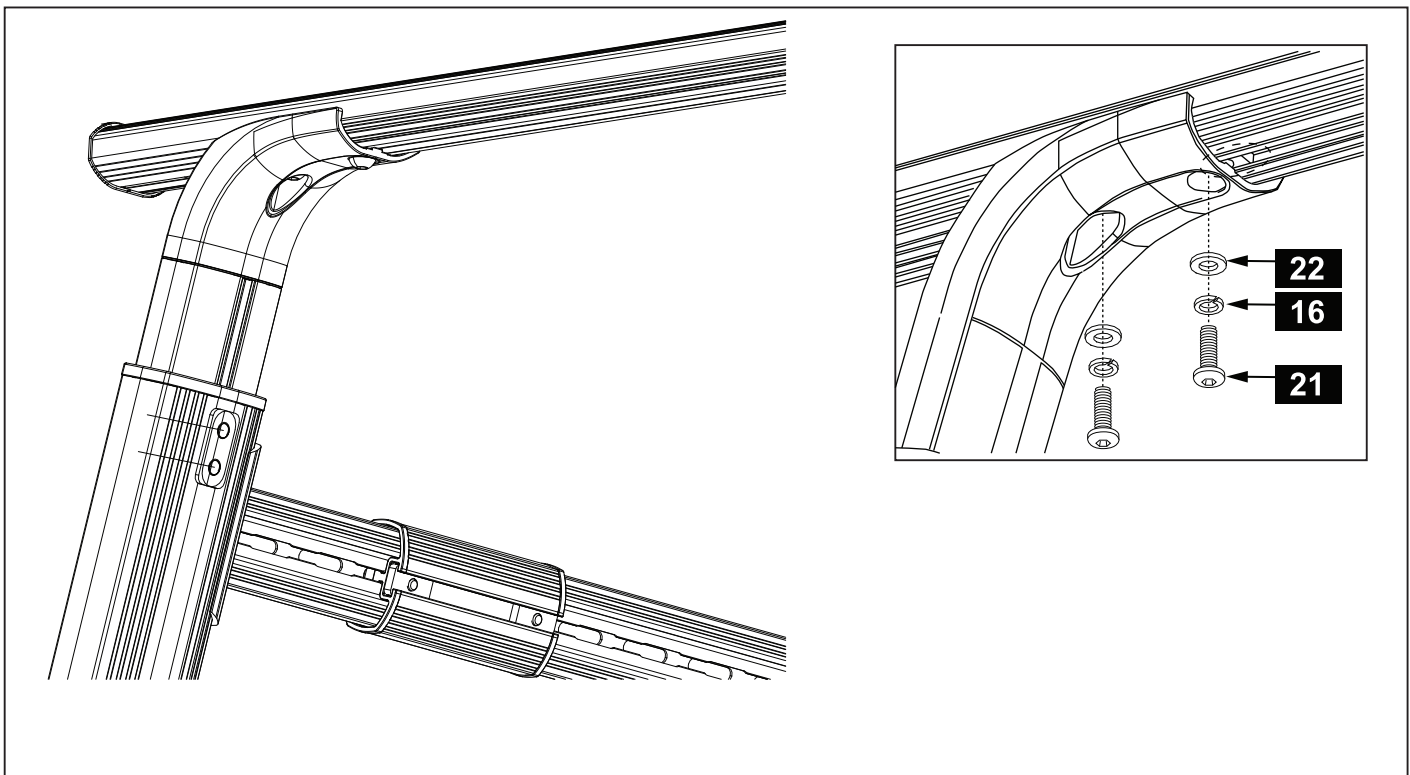

7. Place the cross bar onto top of front leg. Align Double Nut Plate with the holes on the underside of the upper leg. Loosely install and tighten M8x16 Hex Socket Button Head Screw with M8x16 Spring Washer & M8 Flat Washer. Repeat for Rear Legs.

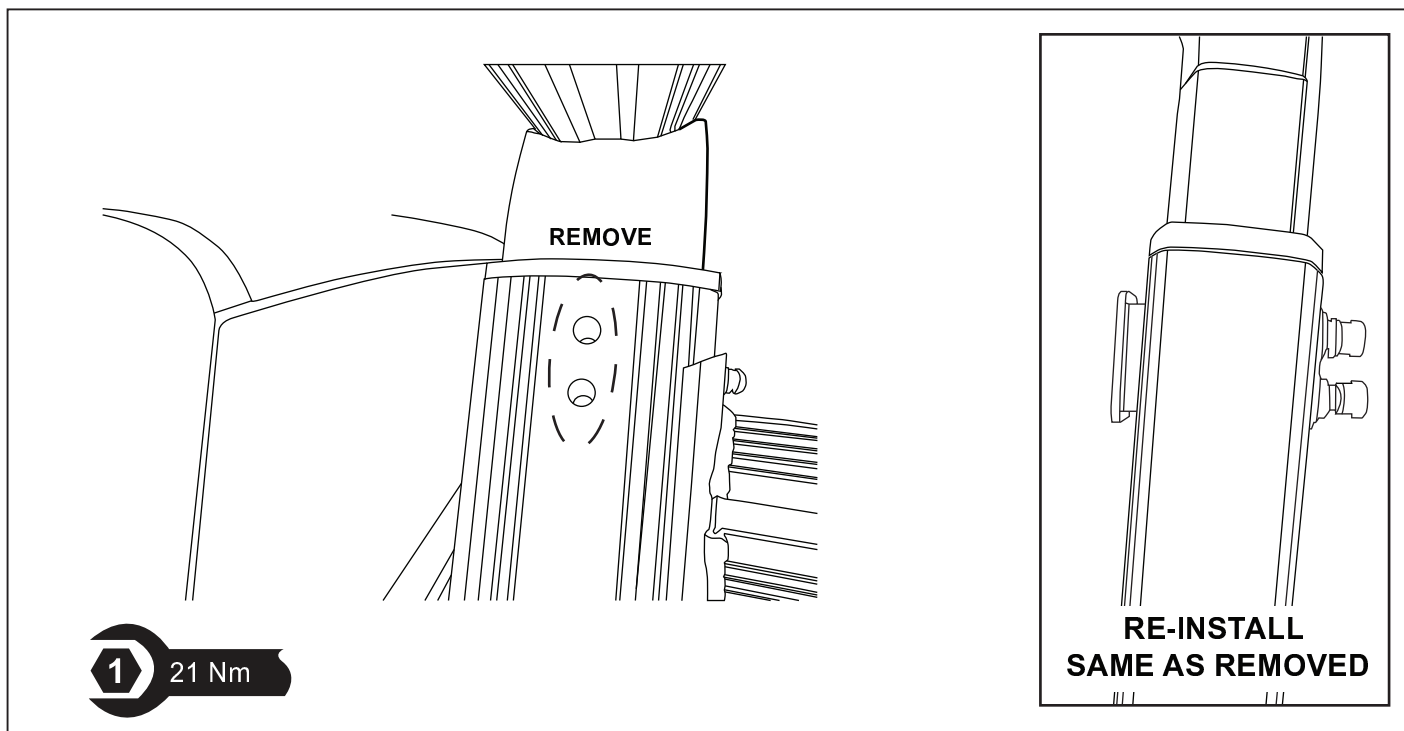

8. Remove & retain the M10x80 Hex Socket Button Head Screw, M10 Double Washer (Internal), M10 Double Nut Plate, M10 Flat Washer and M10 Spring Washer. Raise the leg to the desired height, then proceed to Re-install M10 Screw, Double Washer, Nut Plate, Flat Washer and Spring Washer on both sides once desired height has been reached. Tighten M10 Bolt at set height.

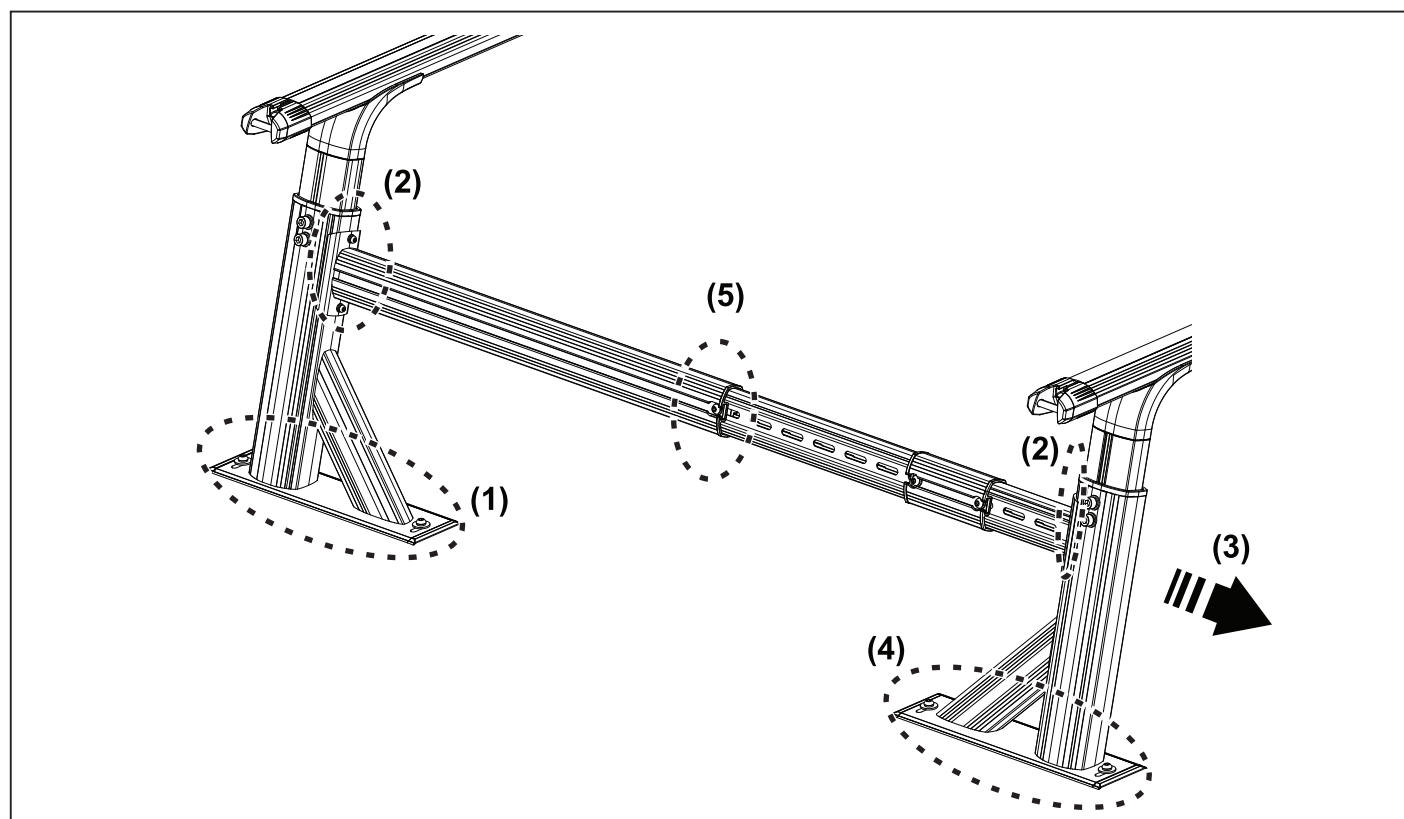

9. Once final positioning is achieved, follow tightening sequence to ensure correct alignment. (1) Tighten front LH & RH Leg base to rolltrac. (2) Tighten four M6 Bolts for side bars. (3) Pull tension back on both LH & RH rear Legs. (4) Tighten Rear Leg base to Rolltrac. (5) Tighten centre bolt on side bar.

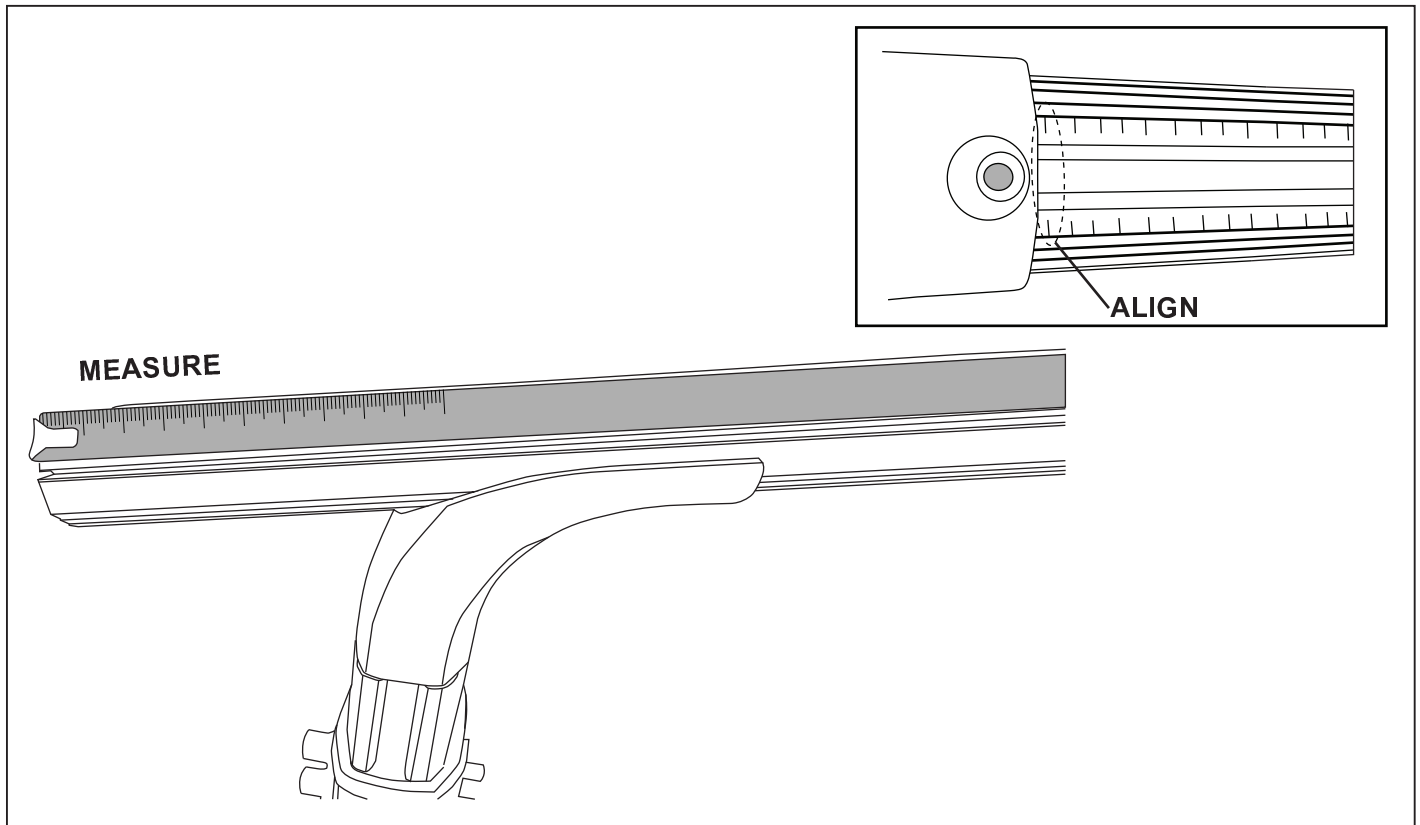

10. Centre the cross bar, use a tape measure to align the bar evenly from the end of the cross bar to the end of the leg riser. As a secondary alignment use the measure scale on the underside of cross bar. Align the two side with the same scale data position.

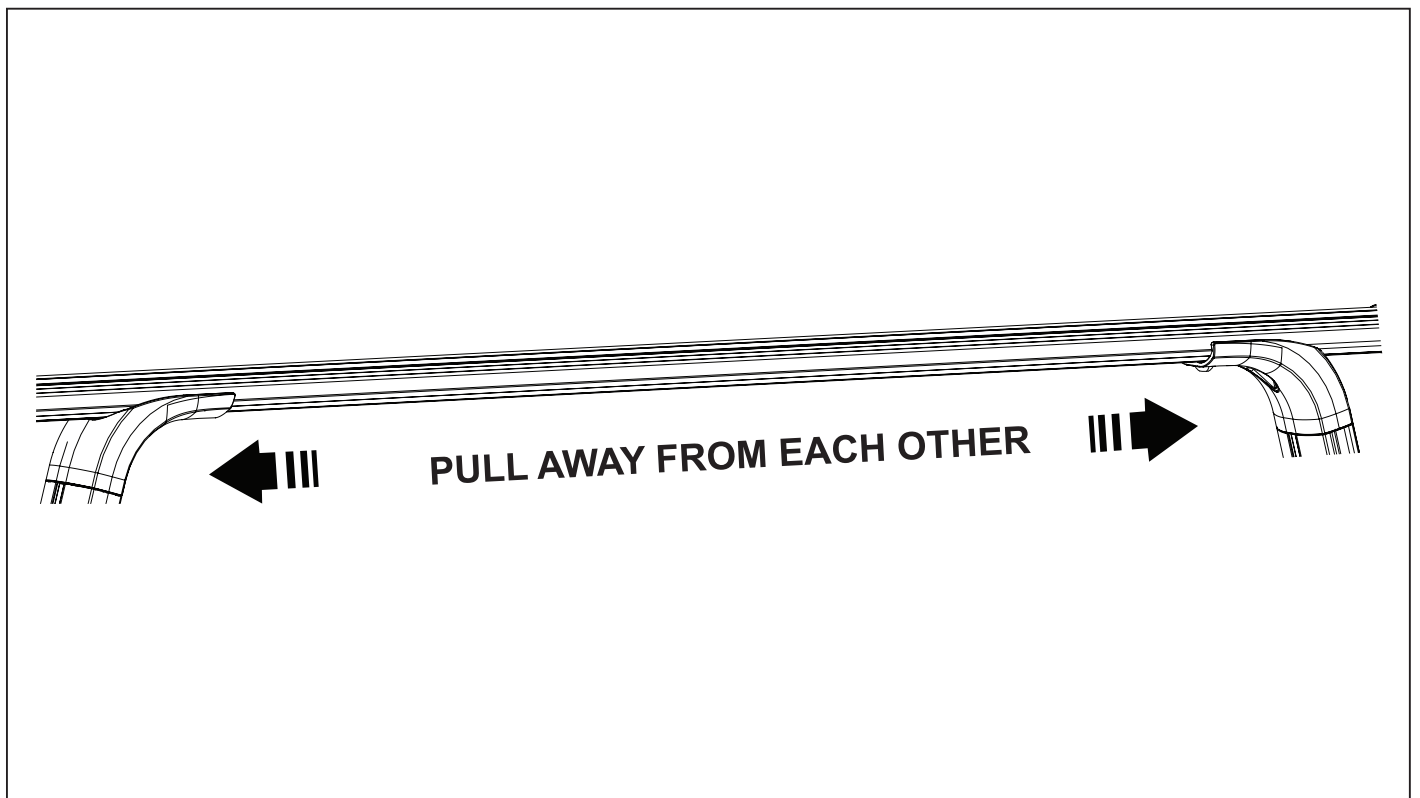

11. Pull outward applying tension on the upright while tightening the cross bar bolts.

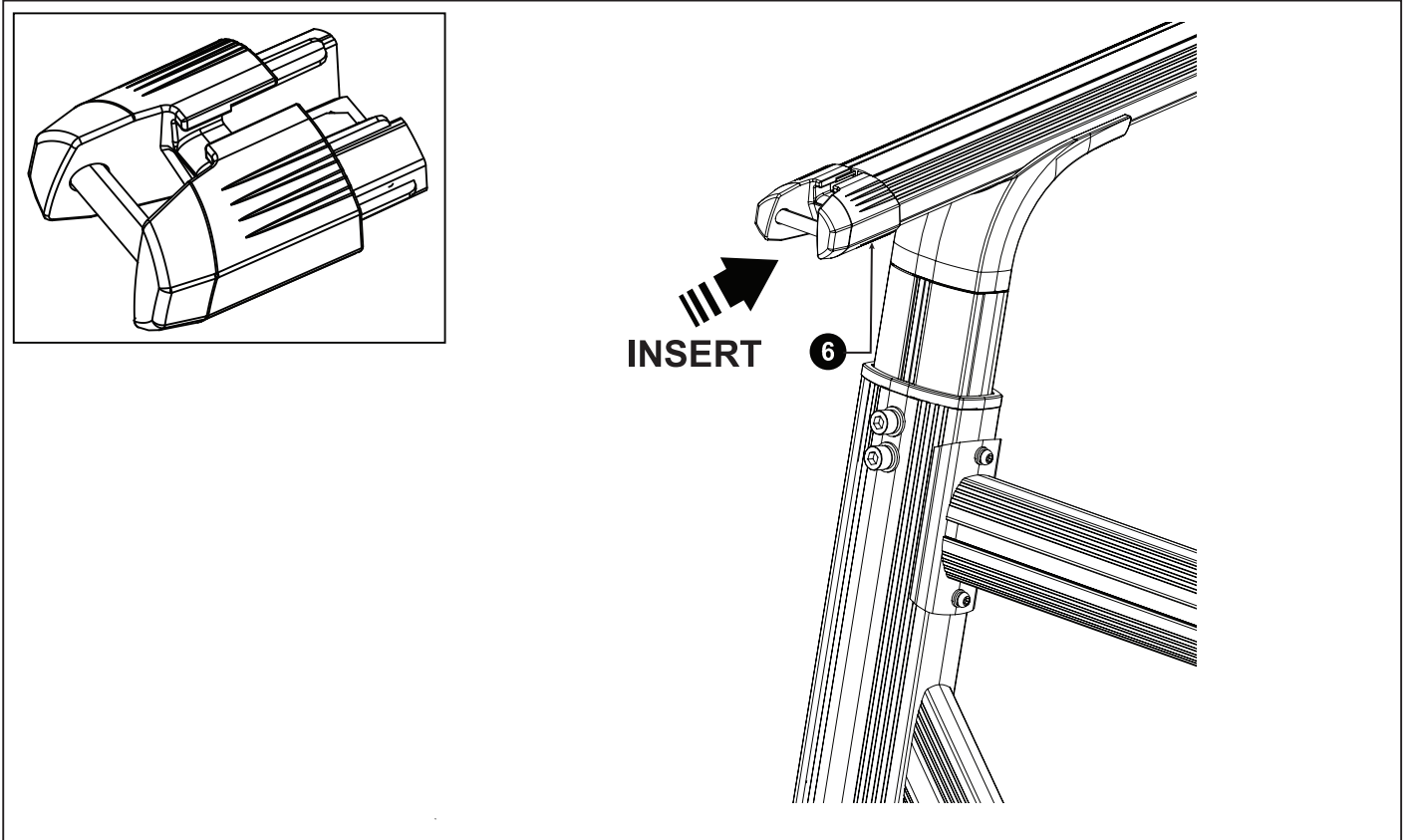

12. Install End Cap onto Cross Bar as removed in step 6. Repeat for all four End Caps.

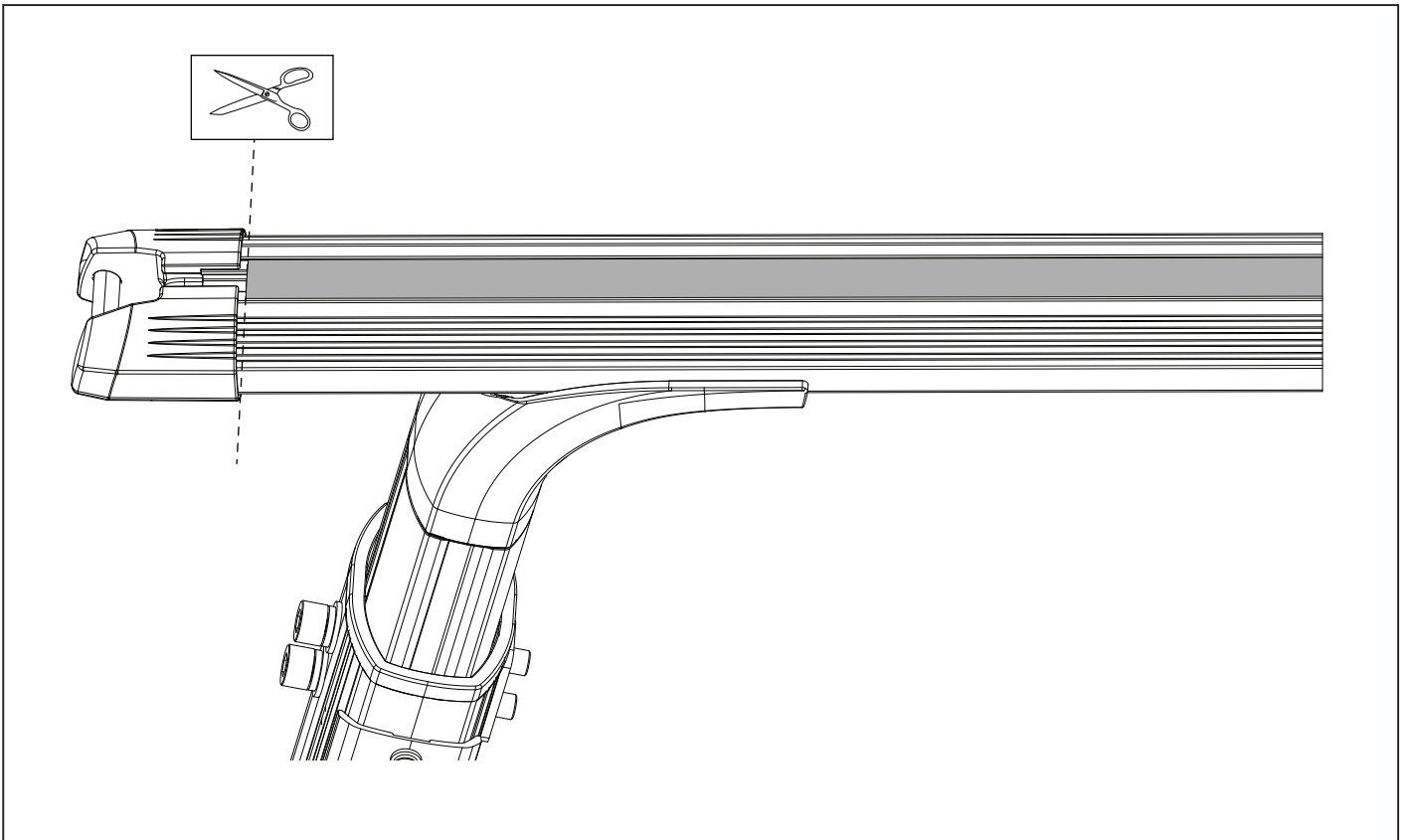

13. If supplied rubber seal is blocking insertion of End Caps, trim rubber seal to displayed length.