

**ROOF RACK for GEN3 CANOPY  
(RACK0057)**

**INSTALLATION INSTRUCTIONS**

**MIT S TRTN 2024 onwards**

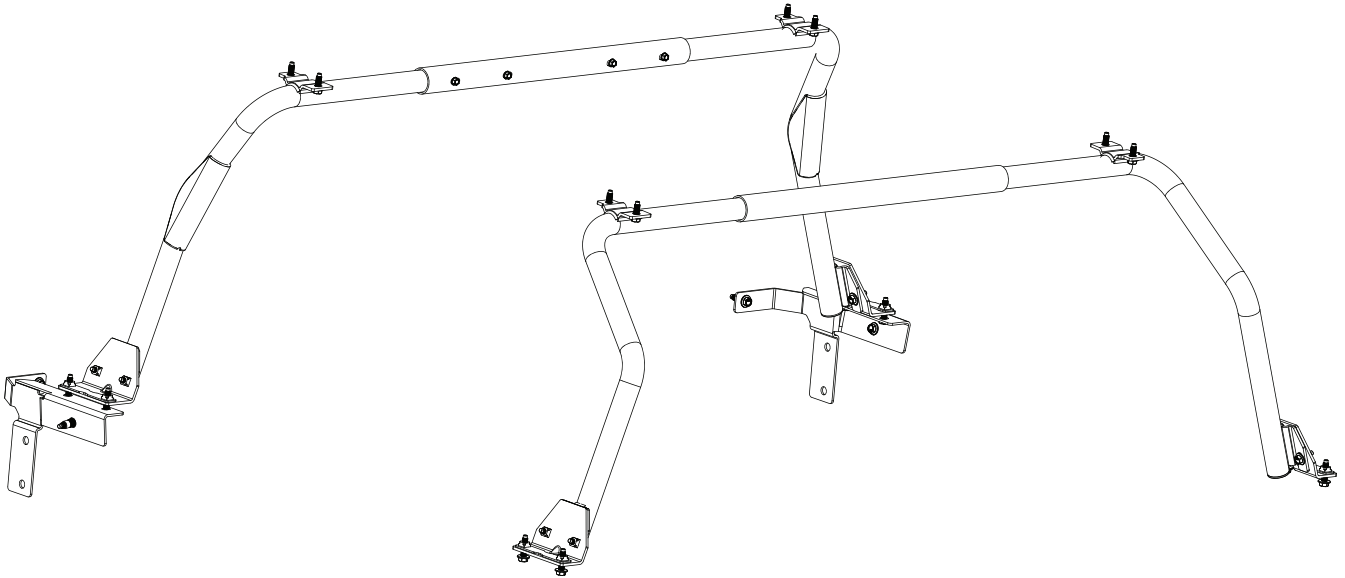

**IMPORTANT**

The EGR Gen3 Canopy is load rated to 80kg Dynamic. Adding the optional internal support frame to your EGR Gen3 Canopy will increase this dynamic rating to 120kg.

Extra weights in the load area of your tub and excessive loads on-top of your Canopy may adversely affect your vehicle tub.

EGR only provides a load rating for its product and recommends you discuss tub load ratings with your vehicle manufacturer.

Installation Time:

1 Hour (Approximately)

Care Instructions:

Clean Roof Racks with a mild detergent and water solution.

Do not use abrasive cleaners or solvents.

120Kg  
MAX.

Roof Racks Maximum Load to be carried  
**120Kg**

PERSONAL PROTECTIVE EQUIPMENT:

Mask

Rubber Gloves

Goggles

Hearing Protection

Place these instructions in vehicle's glove box after installation is complete

PLEASE REFER TO PAGE 2, OF THIS INSTRUCTION FOR A LIST OF PARTS AND QUANTITIES.

- IMPORTANT!**

- Read instructions carefully before installation.
  - It is strongly recommended that installation is conducted by an authorised dealer.
  - This product must be installed exactly as specified in these instructions.
  - Failure to do so may result in improper fit and/or retention.
  - Recommend installation by 2 people.

### PARTS CHECK SHEET

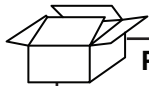

#### PARTS IN MAIN CARTON

**1**  
Front LHS bar  
x 1

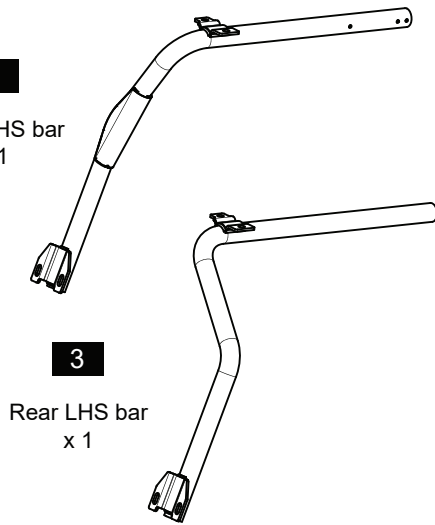

**3**  
Rear LHS bar  
x 1

**2**  
Front RHS bar  
x 1

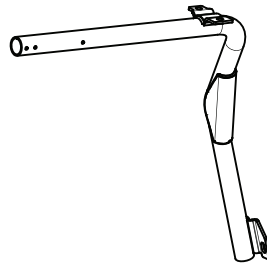

**4**  
Rear RHS bar  
x 1

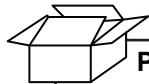
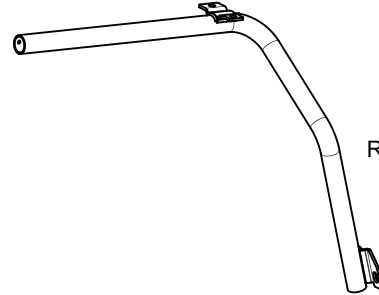

#### PARTS IN HARDWARE KIT

**5**  
Cross bar  
x 2

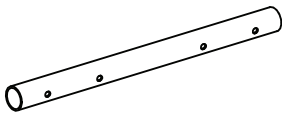

**6**  
Support bracket LH  
x 1

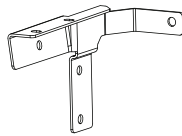

**7**  
Support bracket RH  
x 1

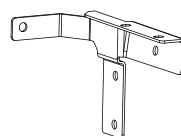

**8**  
Nut Plate  
x 4

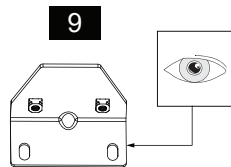
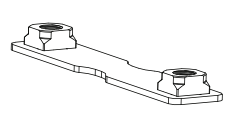

**9**  
Front Foot bracket  
x 2

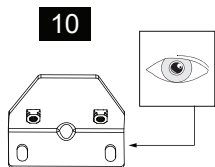

**10**  
Rear Foot bracket  
x 2



**11**  
Hex head bolt M8x20  
x 16

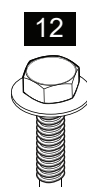

**12**  
Hex head bolt M8x30  
x 12



**13**  
M8 Nutsert  
Qty - 2



**14**  
Self Tapping Screw  
x 8

#### RECOMMENDED TOOLS (Not Supplied in Kit):

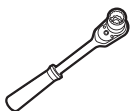

Ratchet &  
12mm Socket

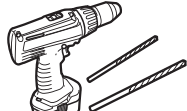

Drill & Ø5mm,  
Ø12mm Drill Bits



Automatic Centre  
Punch



Torque Wrench

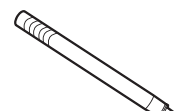

Nonpermanent  
Marker

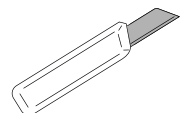

Sharp Knife

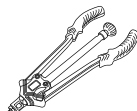

Nutsert Tool

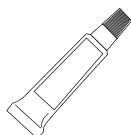

Rust Inhibitor

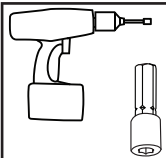

9mm Hex Head  
Driver

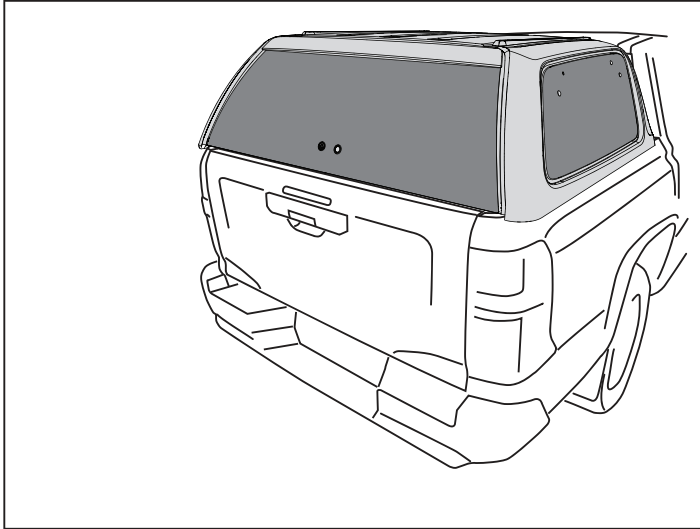

### Step 1

Required tools: Clean dry cloth.

1. Thoroughly clean and dry the interior of the canopy and tub where the installation will take place.

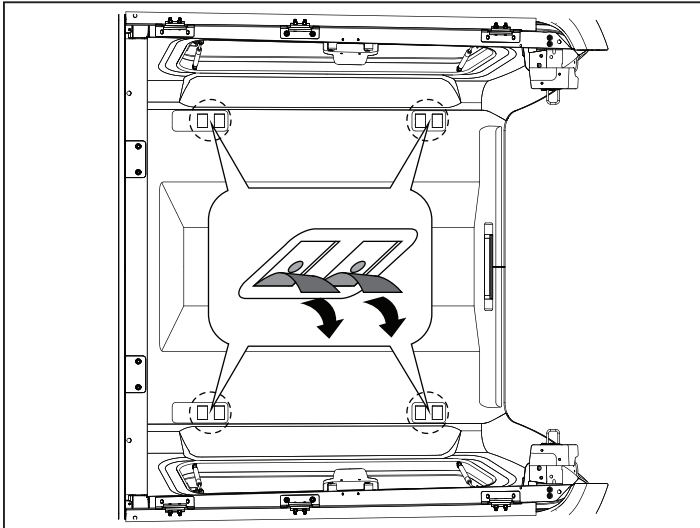

### Step 2

Required tools: Knife.

1. Locate the rectangular patches in the canopy roof lining as shown in 4 locations.
2. Cut the 8 patches out and discard.

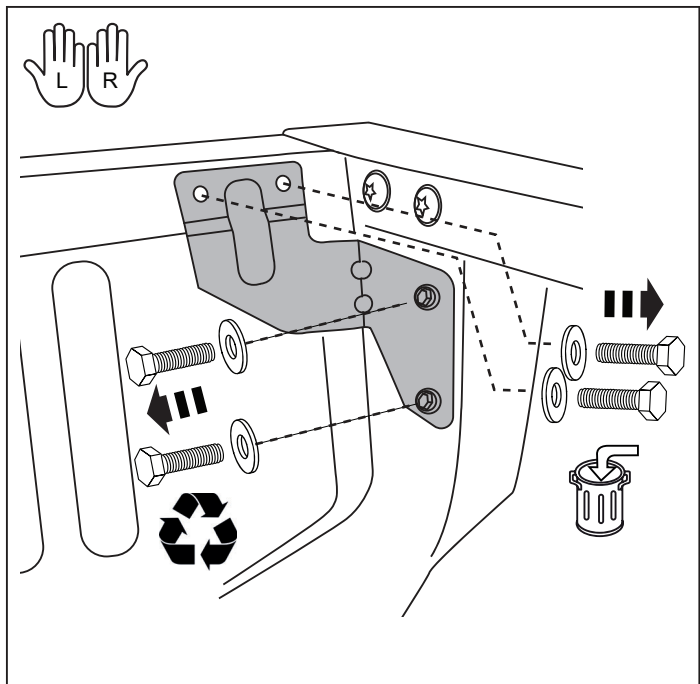

### Step 3

Required tools: 12mm Spanner.

1. Remove and discard the front reinforcement brackets and 2 bolts and 2 washers attached to the front wall of the tub. Retain the other 2 bolts and washers for later use.

### Step 4.

Required tools: 12mm Spanner.

1. Remove and discard the front RHS and LHS brackets as shown.

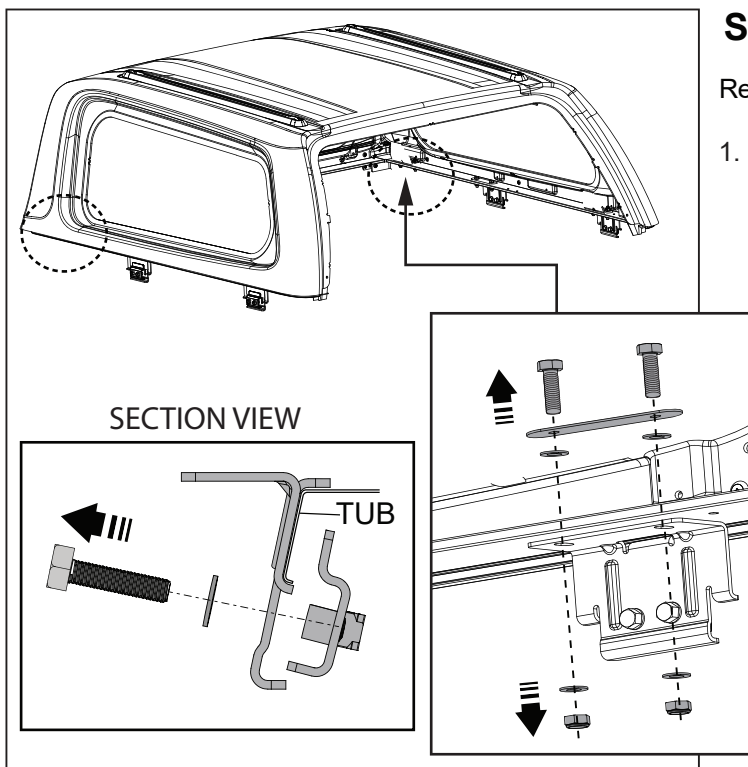

### Step 5.

Required tools: 12mm Spanner.

1. Remove and discard two screws, spacer, washers and nuts from the rear brackets as shown on RHS and repeat for the LHS.

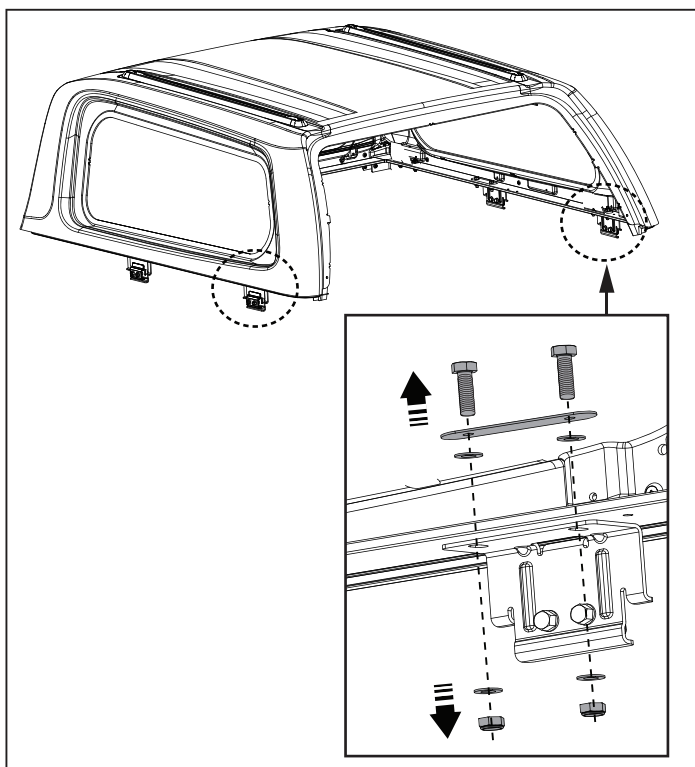



### Step 6.

Required tools: 12mm Spanner

1. Install the Rear Foot Brackets and loosely secure using the 30mm Hex Head Bolts and Nut Plates as shown on the RHS. Repeat for LHS.

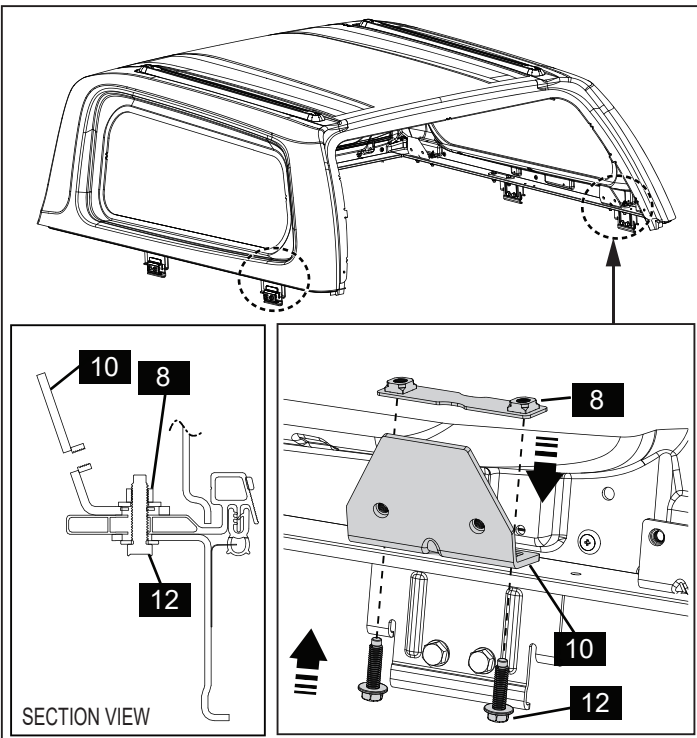

### Step 7.

Required tools: 12mm Spanner, Centre punch.

1. Install the front support bracket and foot bracket using the three 30mm hex head bolt provided with the hardware kit and reuse the two bolts and two washers, which were removed from step 3.

**IMPORTANT:** Do not fit the screws fully as they have thread locker. Only align the holes as shown.

Mark the hole position on the RHS of the tub and center punch the one hole shown.

Remove the bracket.

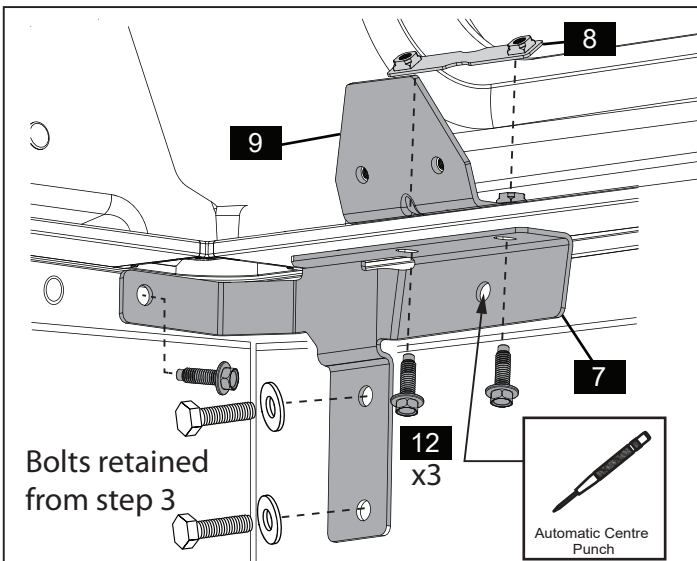

### Step 8.

Required tools: 5 & 12mm drill, Nutsert tool.

1. Drill 5mm pilot hole followed by 12mm drill.

Fit the M8 Nutsert using the Nutsert Tool.

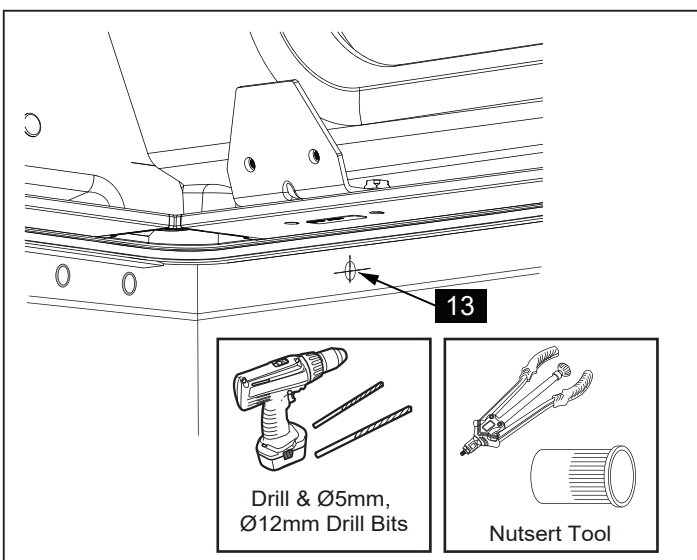

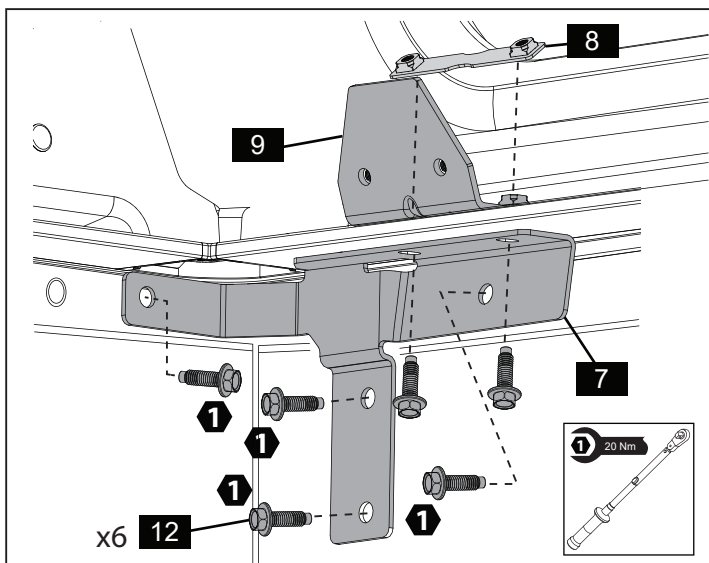

### Step 9.

Required tools: 12mm Spanner, Centre punch.

1. Install the front support bracket and foot bracket as shown.

**IMPORTANT:** Only tighten the 4 screws holding the support bracket to the tub. The 2 screws holding the foot bracket will be torqued once the tubes are installed.

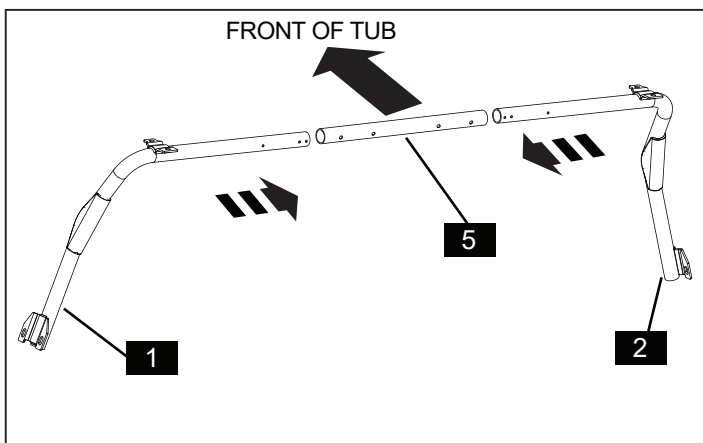

### Step 10.

1. Slide both the Front LHS and RHS Bars into the Cross Bar.

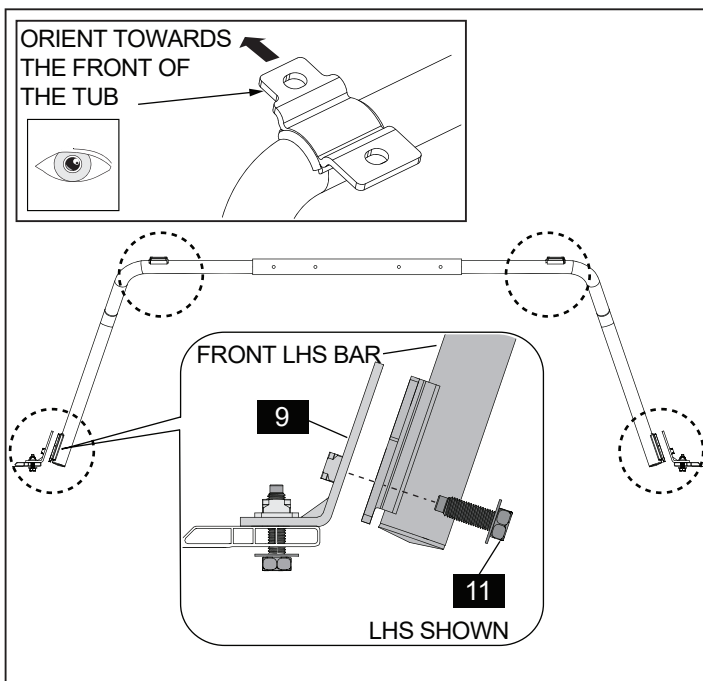

### Step 11.

Required tools: 12mm Ratchet.

1. Bring the front bar assembly towards the inside of the canopy and ensure that the narrow end of the top bracket is facing towards the front of the tub as shown.
2. Align the front bar assembly with the installed Foot Brackets at the front of the tub.
3. Loosely secure the Front LHS Bar to the Front LHS Foot Bracket using 20mm Hex Head Bolts.
4. Repeat for the RHS.

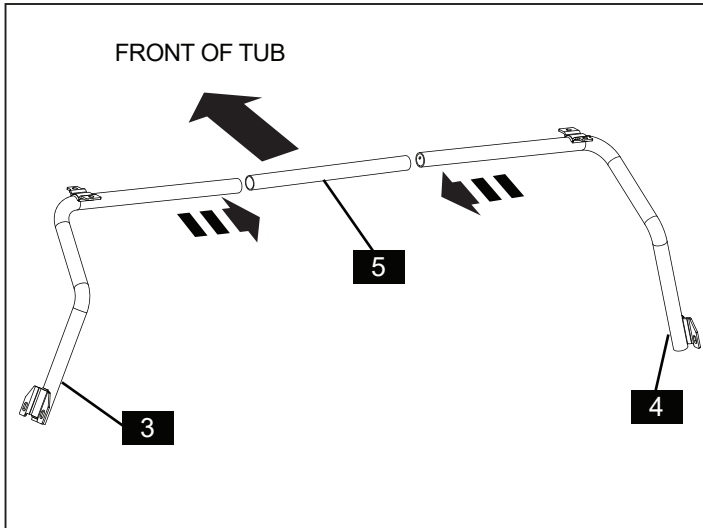

### Step 12.

1. Slide both the Rear LHS and RHS Bar into the Cross Bar.

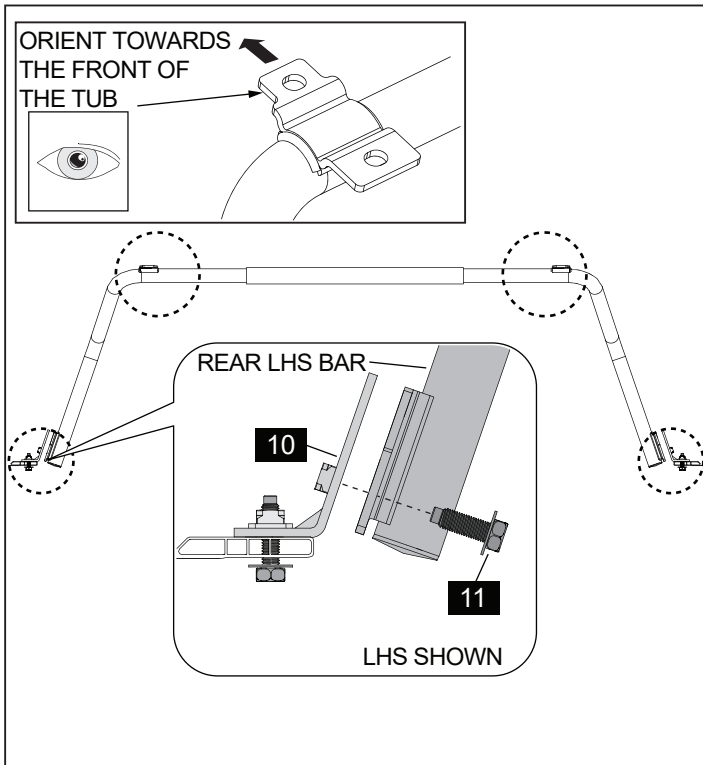

### Step 13.

Required tools: 12mm Ratchet.

1. Bring the rear bar assembly towards the inside of the canopy and ensure that the top bracket narrow end is facing towards the front of the tub as shown.
2. Align the rear bar assembly with the installed Foot Brackets at the rear of the tub.
3. Loosely secure the Rear LHS Bar to the Rear LHS Foot Bracket using 20mm Hex Head Bolts.
4. Repeat for the RHS.

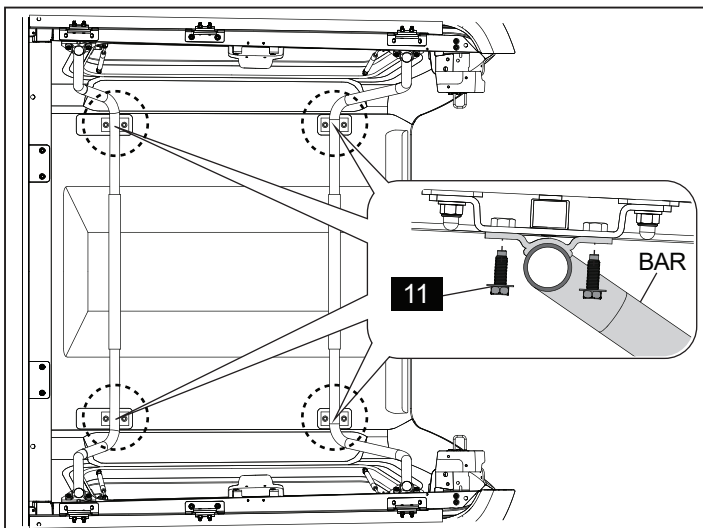

### Step 14.

Required tools: Ratchet.

1. Loosely secure the front and rear bar assembly to the canopy roof using 20mm Hex Head Bolts as shown.

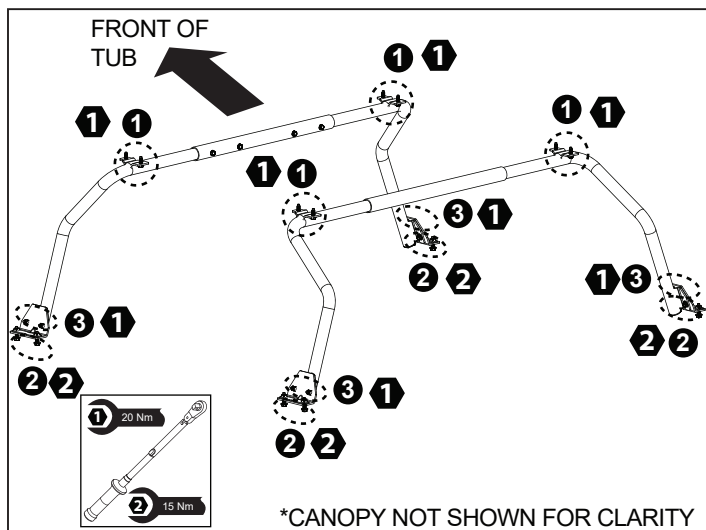

### Step 15.

Required tools: Torque Wrench & 12mm socket.

1. Tighten the top roof bolts (1) to 20Nm.
2. Tighten the foot brackets to base rail bolts (2) to 15Nm.
3. Tighten the foot bracket to side tube bolts (3) to 20Nm.

IMPORTANT: Follow the correct torque sequence.

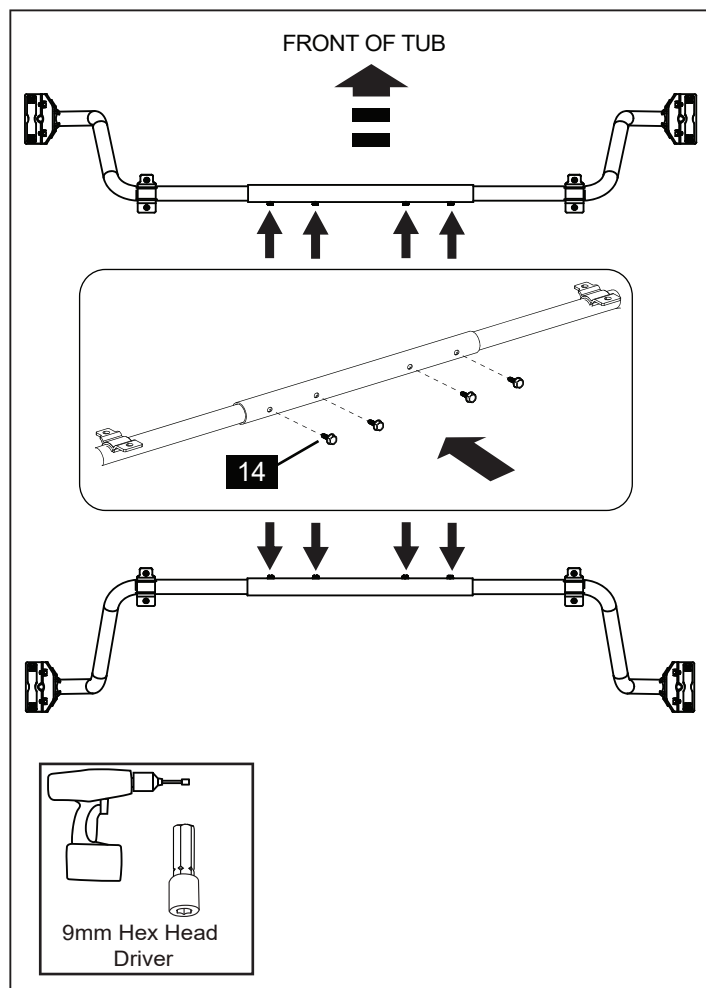

### Step 16.

Required tools: Hex head driver.

1. Screw four Self Tapping Screws through the holes in the Front Cross Bar and into the Front LHS and RHS Bars.
2. Repeat for the rear bars.



**OWNERS MANUAL SUPPLEMENT**  
**IMPORTANT: PLACE THIS PAGE IN THE CUSTOMER'S**  
**VEHICLE SERVICE BOOK.**



### **IMPORTANT**

**The EGR Gen3 Canopy is load rated to 80kg Dynamic. Adding the optional internal support frame to your EGR Gen3 Canopy will increase this dynamic rating to 120kg.**

**Extra weights in the load area of your tub and excessive loads on-top of your Canopy may adversely affect your vehicle tub.**

**EGR only provides a load rating for its product and recommends you discuss tub load ratings with your vehicle manufacturer.**

### **WARNING! - SAFETY!**

- Maximum Load to be carried on this Roof Rack system is 120Kg.
- Loads must be distributed as evenly as possible across this Roof Rack system, and the loads centre of gravity to be kept as low as possible. Narrow and Heavy loads (example: metal tubes) must be positioned over or near the Roof Rack Mounting Brackets attached to the vehicle roof.
- Loads that over-hang the ends of the Roof Racks must conform to any relevant laws and must be adequately secured.
- All loads must be firmly and independently secured, to both Front and Rear Roof Rack Extrusions.
- Loads must be secured using suitable straps or similar tightening devices.
- After loading, recheck the security of the load and Roof Racks regularly throughout the journey.
- Elastic straps with securing hooks must not be used.
- Where surfboards are carried (or similar items that may produce high lifting forces), they must not be carried side by side, but stacked one upon the other and secured independently to Front and Rear Roof Rack Extrusions using straps or other methods capable of with-standing the lifting forces.
- Where specialised accessories are available to carry or secure loads (example bicycle carriers), it is recommended that are used, and must be installed correctly.
- The handling characteristics of a vehicle will change when a carrier system (Roof Racks) is fitted, and especially when it is loaded (in particular cross wind sensitivity, handling on bends and braking). Driving techniques should be altered to allow for these changes, reducing speed especially on bends, and allow for longer braking distances.

### **Maintenance**

- Only use mild detergents or wax polish.
- Do Not use abrasive compounds on painted or plastic finished Roof Rack surfaces.
- Roof Racks and any accessories, straps or other tightening devices must be maintained and kept in good working order.
- Regularly check and tighten Roof Rack attachment hardware to specified values, (if required).
- If Roof racks are removed, all bolts must be re-tightened on refitting to specified values.

### **Warranty Terms**

Roof Racks will be free from defects in material and workmanship for a period of three (3) years from the retail date of purchase.

This warranty only applies to the original purchaser and is non-transferable. Warranty must be claimed with original sales receipt for proof of purchase.

### **Exclusions**

This warranty does not cover failure due to neglect, improper installation, including any modifications to installation hardware, alterations, addition of non genuine equipment, abuse, accident, normal wear and tear, lack of maintenance, misuse, and exposure to chemicals that are not safe for plastics or hardware components.

Incidental or consequential damage or loss of contents due to use, neglect, lack of maintenance, misuse of Roof Racks is sole responsibility of the vehicle owner and operator.

Our products are sold as Roof Rack Systems and not a Roll Bar. In the event of a collision or rollover, the vehicle and any persons or objects traveling in the rear of the vehicle will not be protected by this product. The manufacturer assumes no liability for injury, loss, incidental or consequential damages in the event of a collision or rollover.

### **Disclaimer**

In the event that your Roof Racks are found to be defective under the terms of this warranty, it is at the discretion of supplier to repair or replace the defective part. Transportation costs and labour are not associated with this warranty claim.

(Subject to vehicle manufacturer's recommendations)