

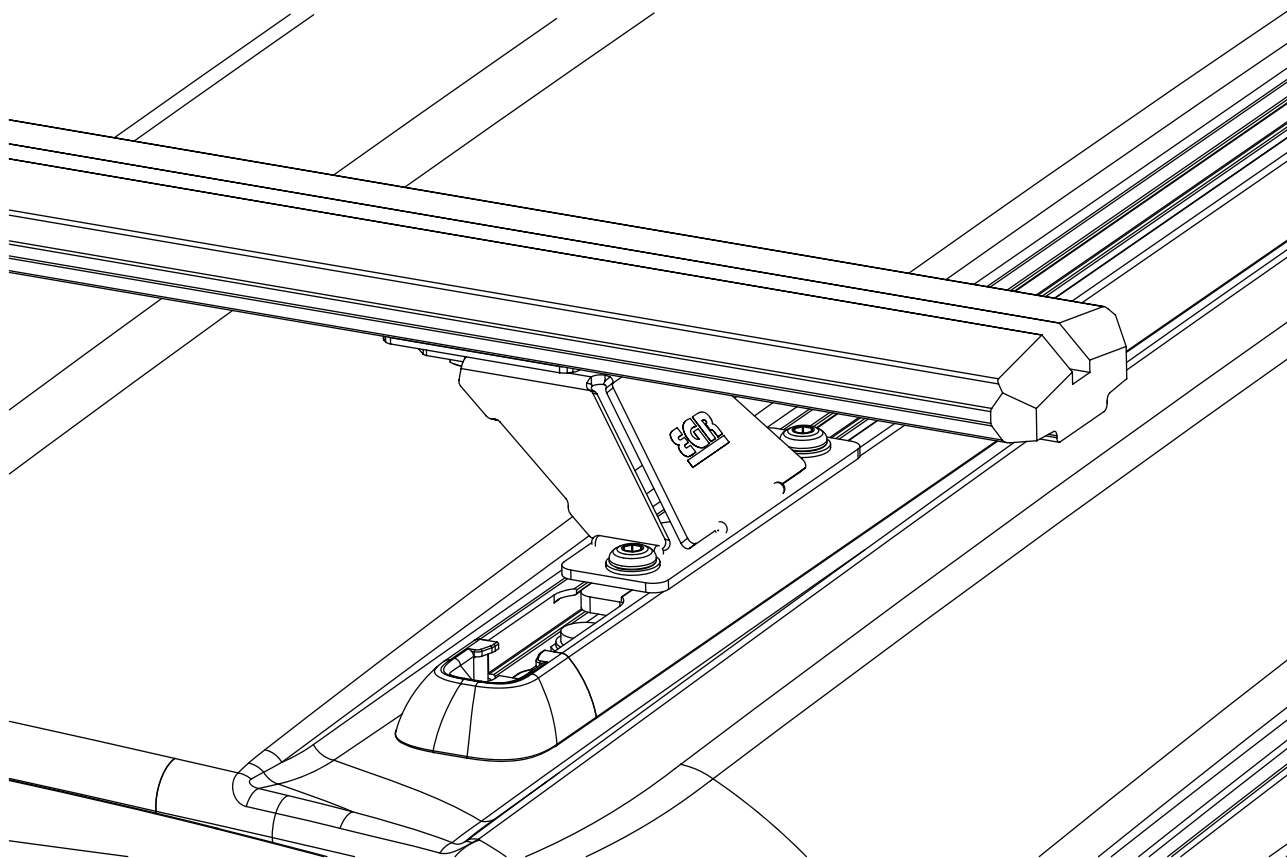

## Gen3 Canopy Crossbar Brackets

### EGR Crossbar Brackets Installation Instructions



Installation Time: Approx. 30 mins

Place these instructions in vehicle's glove box after installation is complete

#### General Notes

- Read through the fitting instructions before installation of accessory.
- Always install the accessory following the fitting instructions. Failure to do so may cause damage to the vehicle or the accessory.
- Ensure all recyclable discarded vehicle accessory components and packaging are recycled following local recycling regulations.
- It is always recommended that this accessory is fitted by a qualified Technician.
- Safely store and protect any removed vehicle components.
- Ensure all bare metal surfaces are protected using Automotive Bare Metal Primer and touch-up paint.
- Please check content of kit using this list and subsequent sketches.
- Remove all metal swarf and dust from all vehicle surfaces if surface is used for accessory installation.

#### Safety Notes

- Check that all work practices comply with safety standards.
- Please wear appropriate clothing and use safety equipment.



#### Care Instructions:



Clean with mild detergent  
and water solution.



Do not use abrasive  
cleaners or solvents.

### PARTS LIST

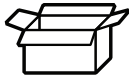

1



M8 Button Head  
Screw  
Qty - 8

2



M8 Washer  
Qty - 8

3

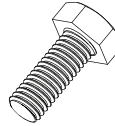

M8 Hex Head  
Bolt  
Qty - 8

4

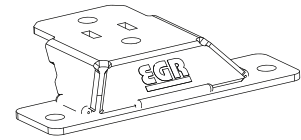

\*Crossbar  
Brackets  
Qty - 4

5

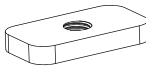

\*\*M8 T-Slot Nut  
Qty - 16

6

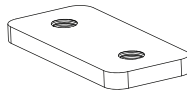

Crossbar Nut  
Plate  
Qty - 4

7

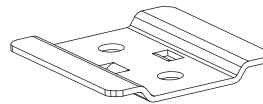

Bracket Stabiliser  
Qty - 4

\* Crossbar Brackets vary in height to ensure Crossbars sit level  
Front-To-Rear - Shorter Brackets should be fitted on the front Crossbar.

\*\* For EGR PLATFORM use all 16 T-slot nuts and for YAKIMA crossbars only 8.



### TOOLS REQUIRED



8mm Allen Key



Open Ended  
Spanner  
17mm



Threadlocker

### INSTALLATION INSTRUCTIONS

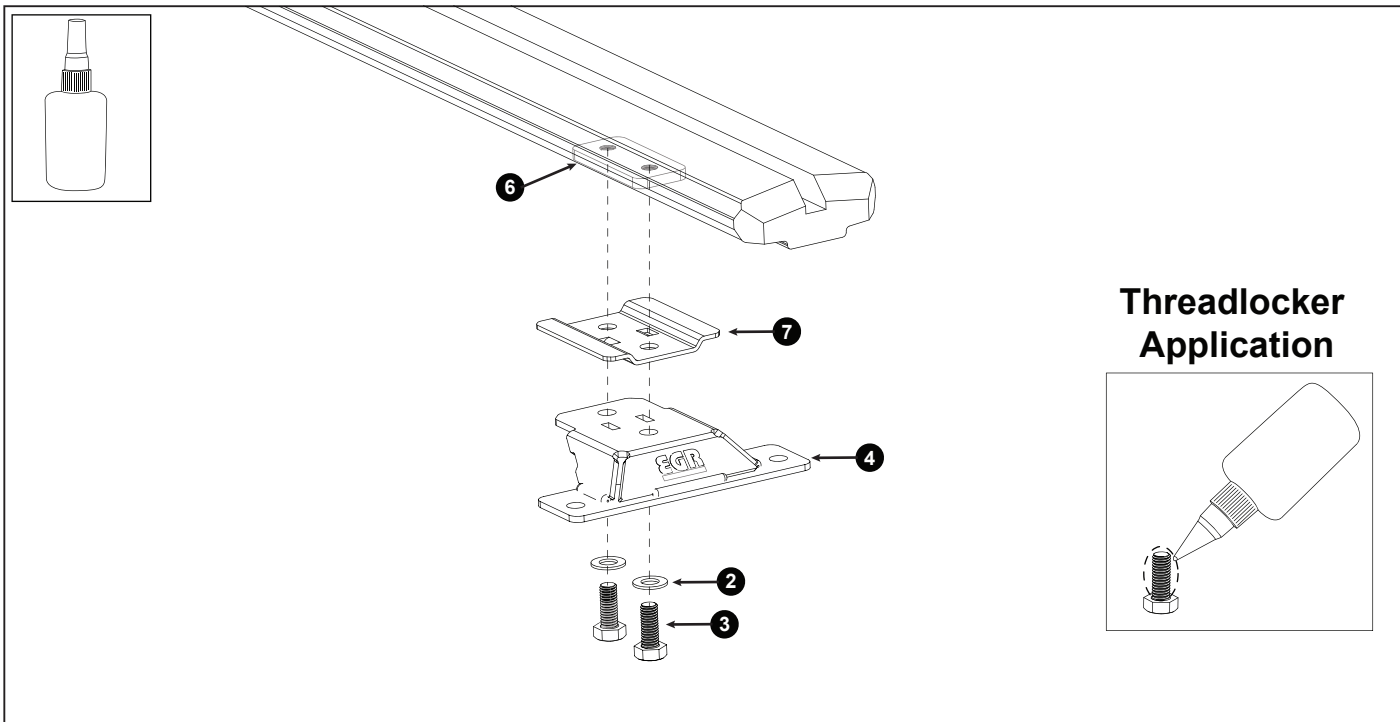

1. Apply Thread-Locker to the thread of 8x M8 Hex Bolts. Insert M8 T-Slot Nut into Crossbar track. Loosely fit Brackets to Crossbar using 2x M8 Hex Bolts, 2x M8 Washers, Crossbar Bracket, and Crossbar Nut Plate on each. Repeat for both ends of each Crossbar. Ensure same-height Bracket is used on each Crossbar.

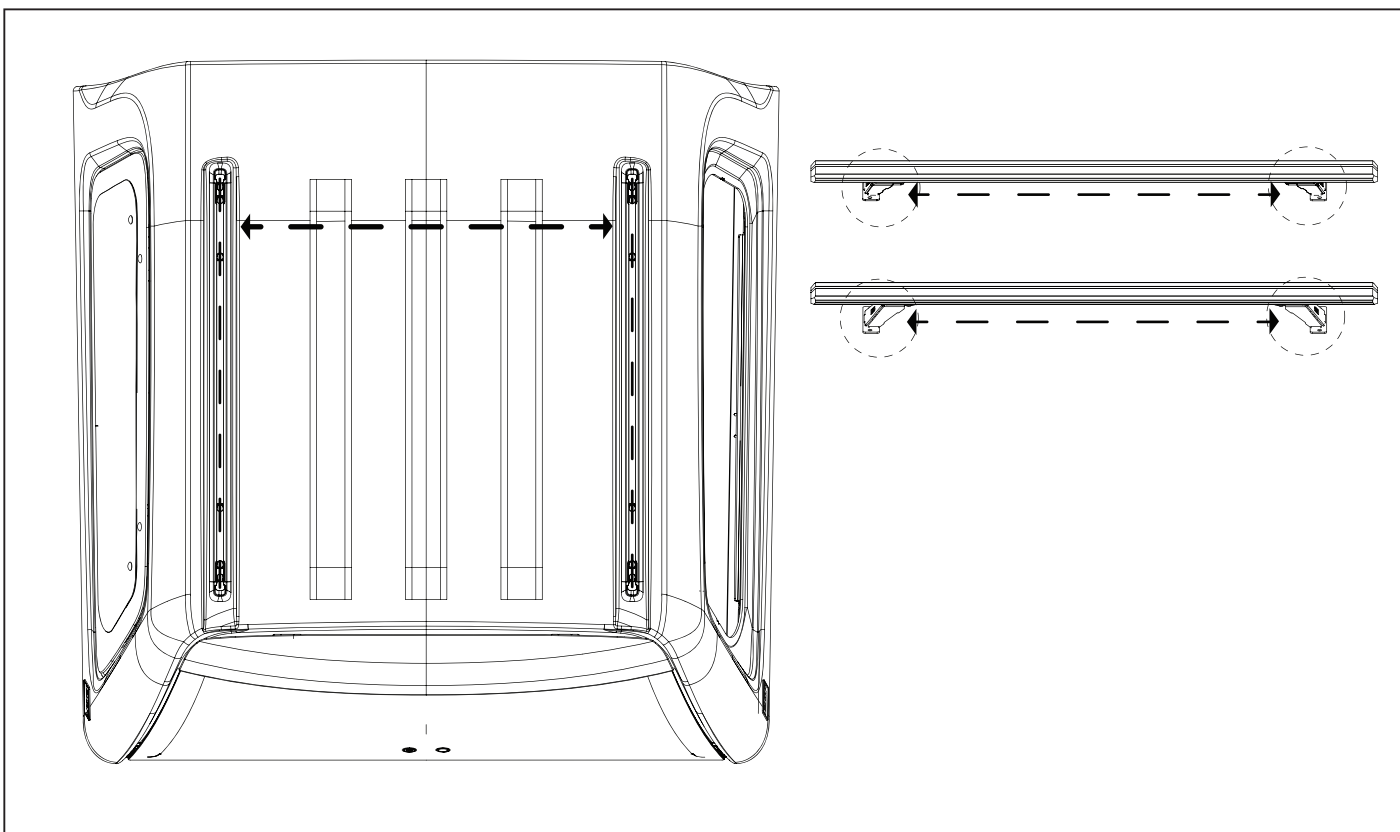

2. Measure the Canopy Track spacing & slide the Brackets along the Crossbar, so the Base Plate Bolt Holes match. Ensure both sides are positioned evenly.

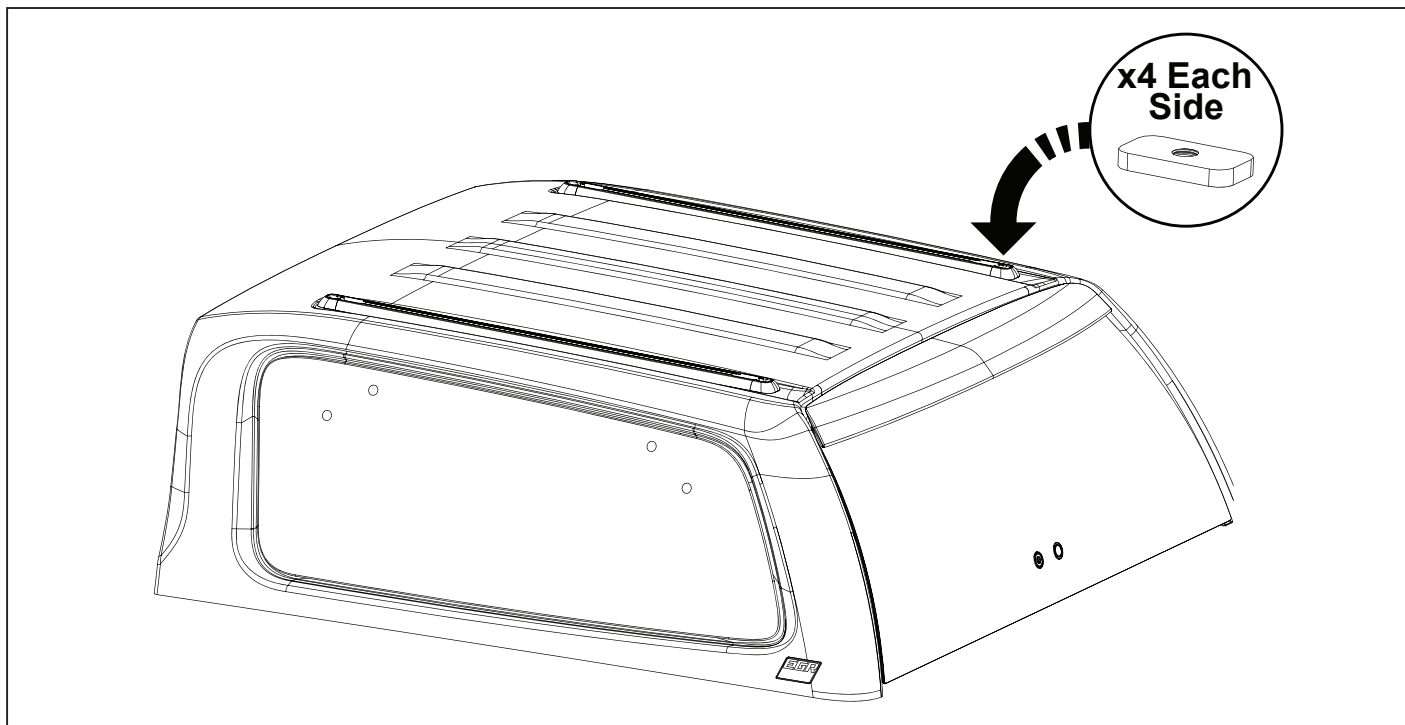

3. Insert 4x M8 T-Nuts into each side of the Canopy Tracks as shown.

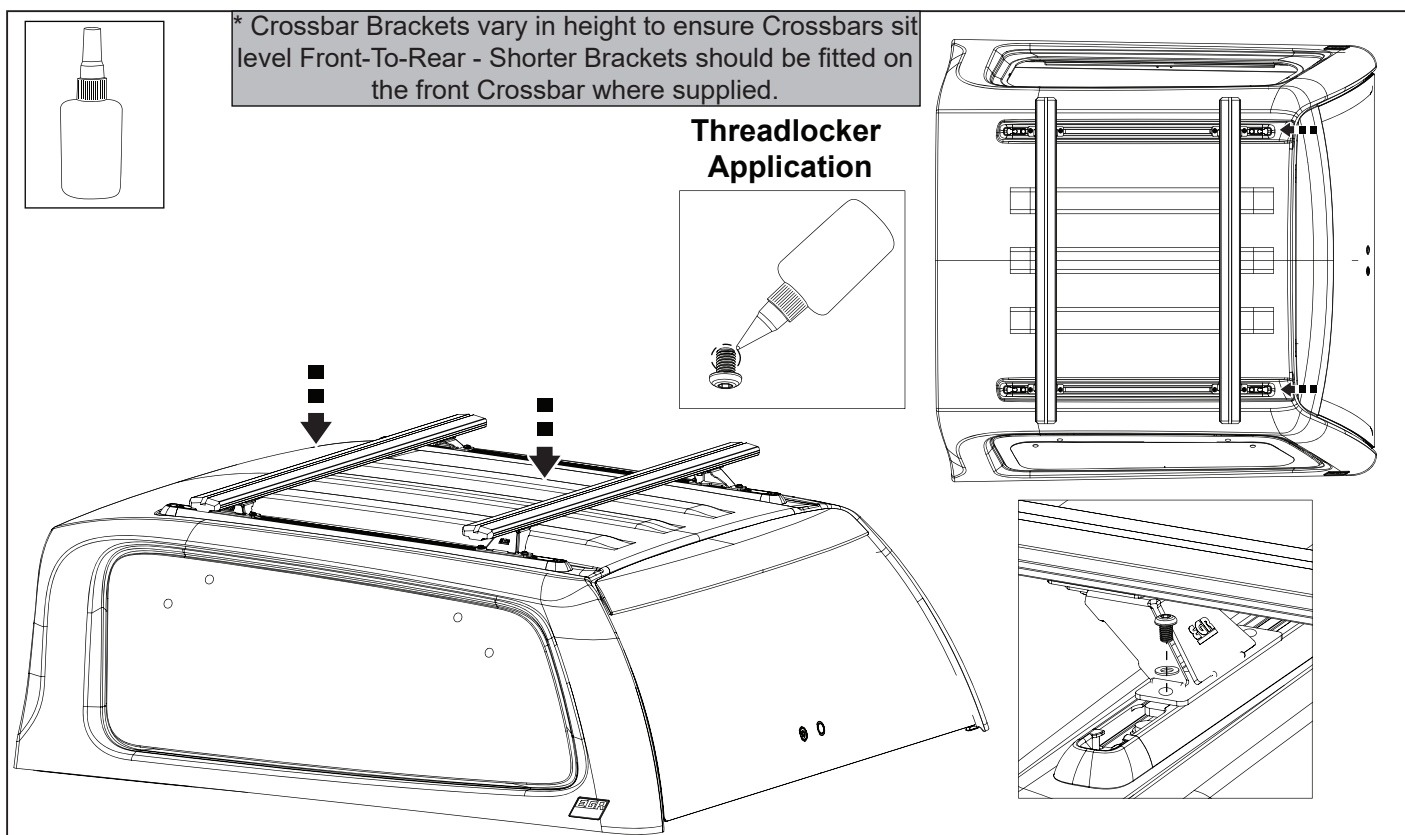

4. Position the Crossbar on the Canopy Tracks. Slide the T-Nuts along the Canopy Tracks to align with the Bracket Bolt-Holes as indicated. Apply Thread-Locker to the thread of 8x M8 Button Head Screws then Loosely Fasten to T-Nuts in Crossbar.

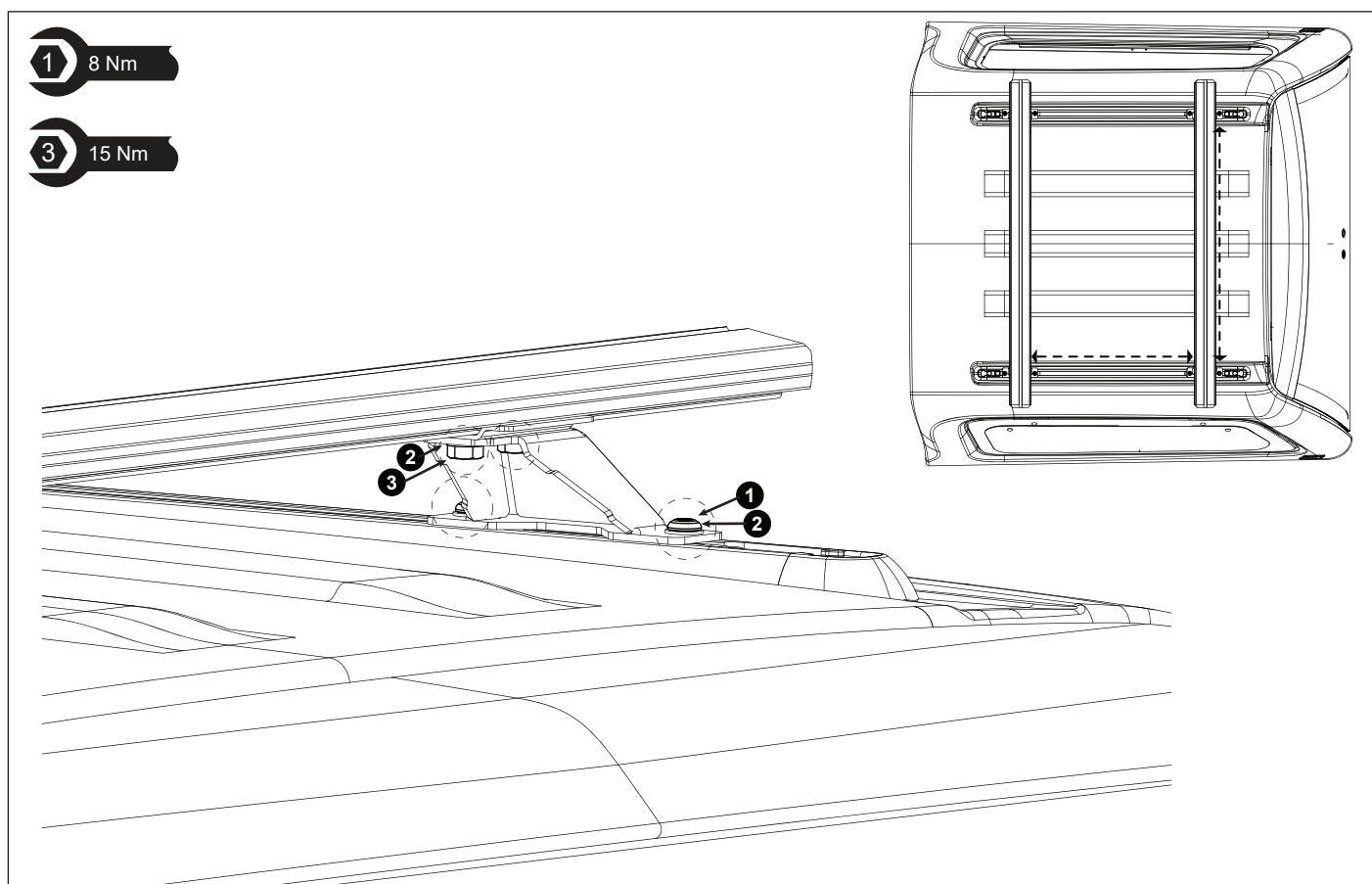

5. Check alignment of crossbars across and along the vehicle and adjust if needed by sliding or tapping gently into place. Torque M8 Screws to 8NM. Torque M8 Bolts to 15NM.