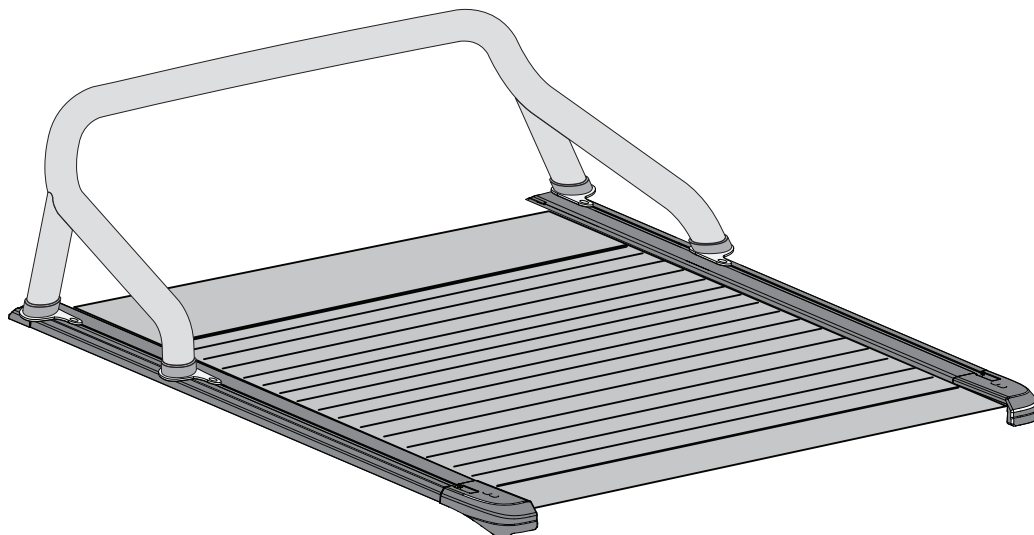

**LDV T60****Rolltrac Sportsbar Adaptor Kit  
Installation Instructions**

Installation Time: Approx. 15 mins

Place these instructions in vehicle's glove box after installation is complete

**General Notes**

- Read through the fitting instructions before installation of accessory.
- Always install the accessory following the fitting instructions. Failure to do so may cause damage to the vehicle or the accessory.
- Ensure all recyclable discarded vehicle accessory components and packaging are recycled following local recycling regulations.
- It is always recommended that this accessory is fitted by a qualified Technician.
- Safely store and protect any removed vehicle components.
- Ensure all bare metal surfaces are protected using Automotive Bare Metal Primer and touch-up paint.
- Please check content of kit using this list and subsequent sketches.
- Remove all metal swarf and dust from all vehicle surfaces if surface is used for accessory installation.

**Safety Notes**

- Check that all work practices comply with safety standards.
- Please wear appropriate clothing and use safety equipment.

**Care Instructions:**Clean with mild detergent  
and water solution.Do not use abrasive  
cleaners or solvents.



### PARTS LIST

1

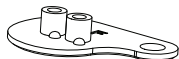

Front LHS Foot Plate  
Qty - 1

2

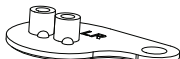

Rear LHS Foot Plate  
Qty - 1

3



Front RHS Foot Plate  
Qty - 1

4



Rear RHS Foot Plate  
Qty - 1

5



M8x25 Counter Sunk  
Socket Head Screw  
Qty - 8

6



M8x12 Counter Sunk  
Socket Head Screw  
Qty - 4

7

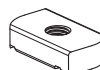

M8 T-Nut  
Qty - 4

8



Washer  
20mmx2mm  
Qty - 2

### TOOLS REQUIRED

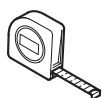

Tape Measure

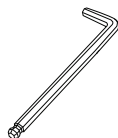

Allen Key

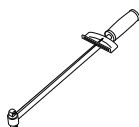

Torque  
Wrench



Ratchet  
Wrench



Allen Head  
Socket



Scissors

### INSTALLATION INSTRUCTIONS

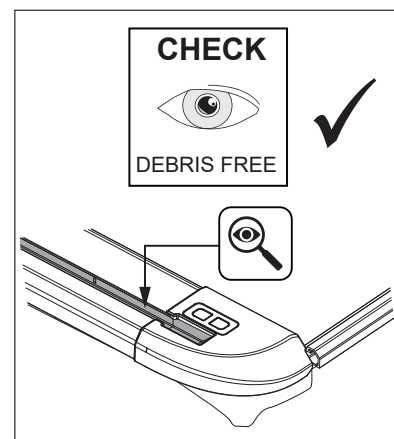
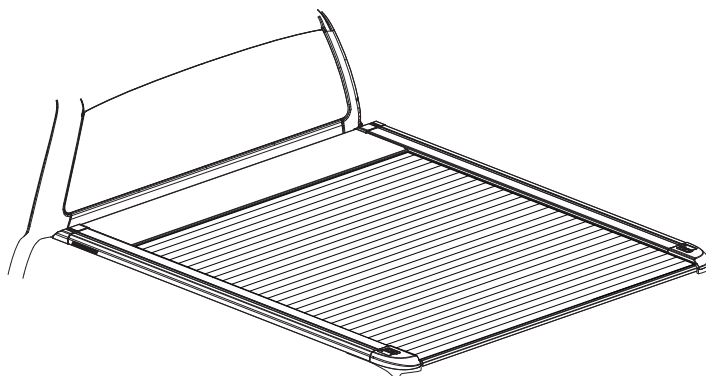
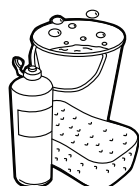

1. Prepare the surface of the side rails by cleaning them thoroughly ensuring that any debris in the side rail channels is completely removed.

**BEFORE**

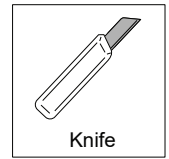
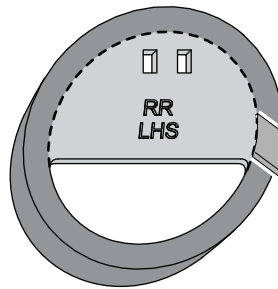
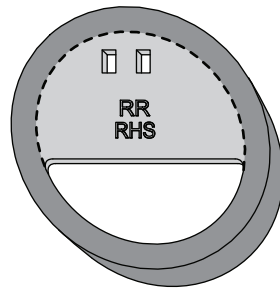

**AFTER**

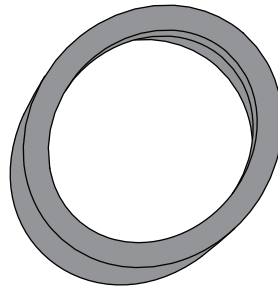
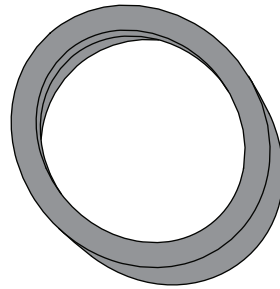

2. Locate the Foot Cups - FR LHS, RR LHS, FR RHS and RR RHS.  
Mark then cut the Foot Cups as shown and discard the cut out sections (shown above).

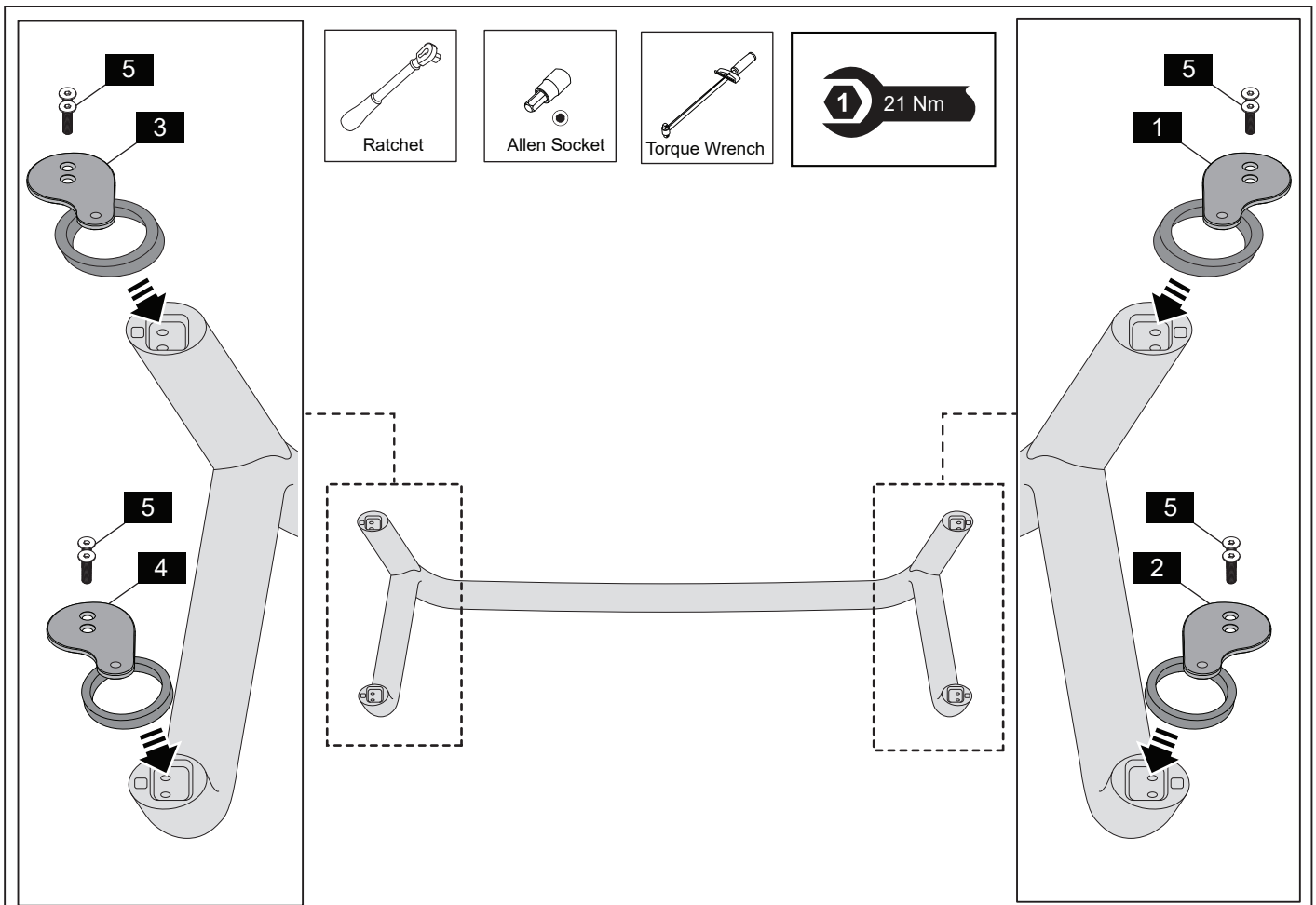

3. Attach the adaptor kit brackets (1),(2),(3),(4) and foot cups to the respective feet as shown with the M8x25 Counter Sunk Socked Head Screws (5). Torque all screws to 21Nm.

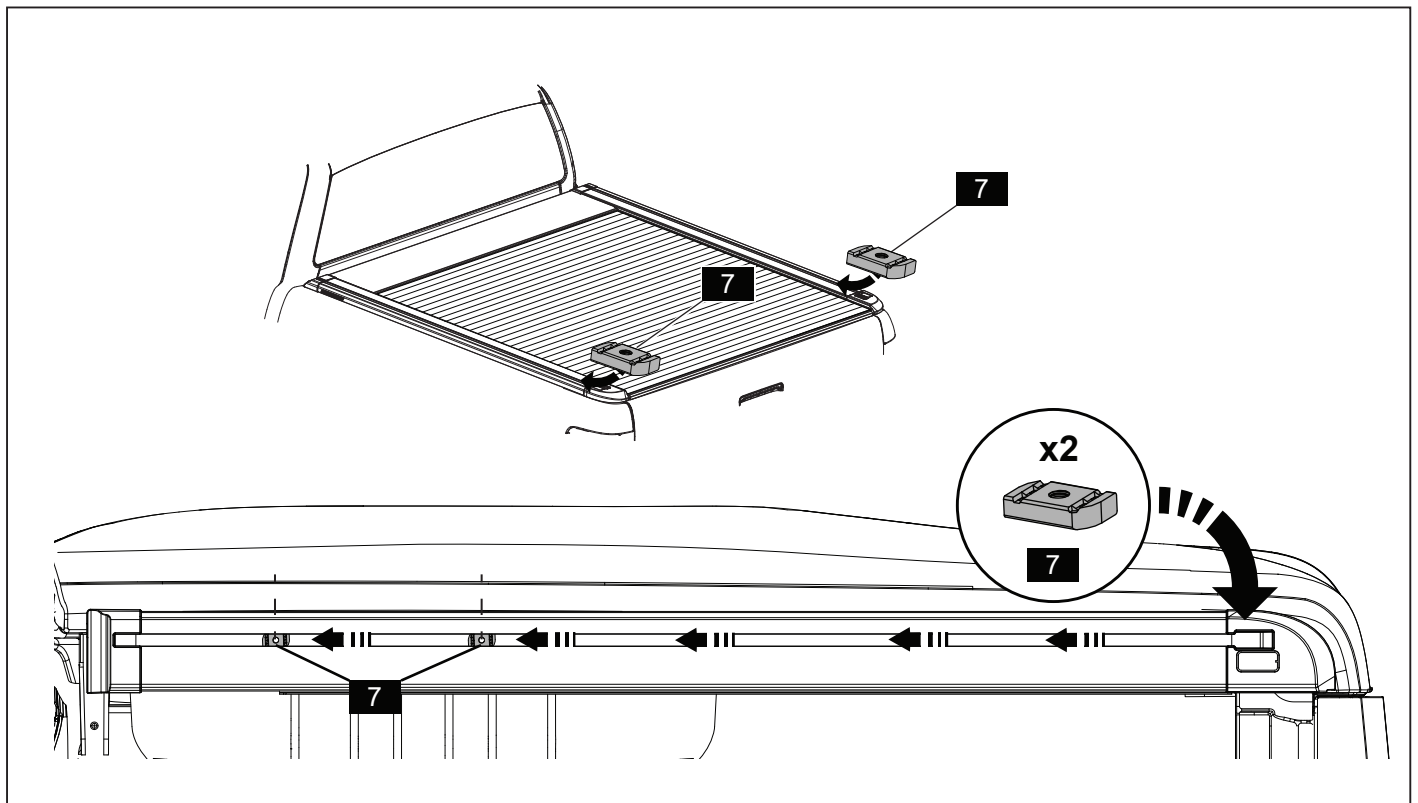

4. Slide two M8 T Nuts (7) into the RHS and two into the LHS T-channel of the side rails as shown. Ensure they align roughly with the holes in the Front and Rear Side Plate on the feet of the sports bar.

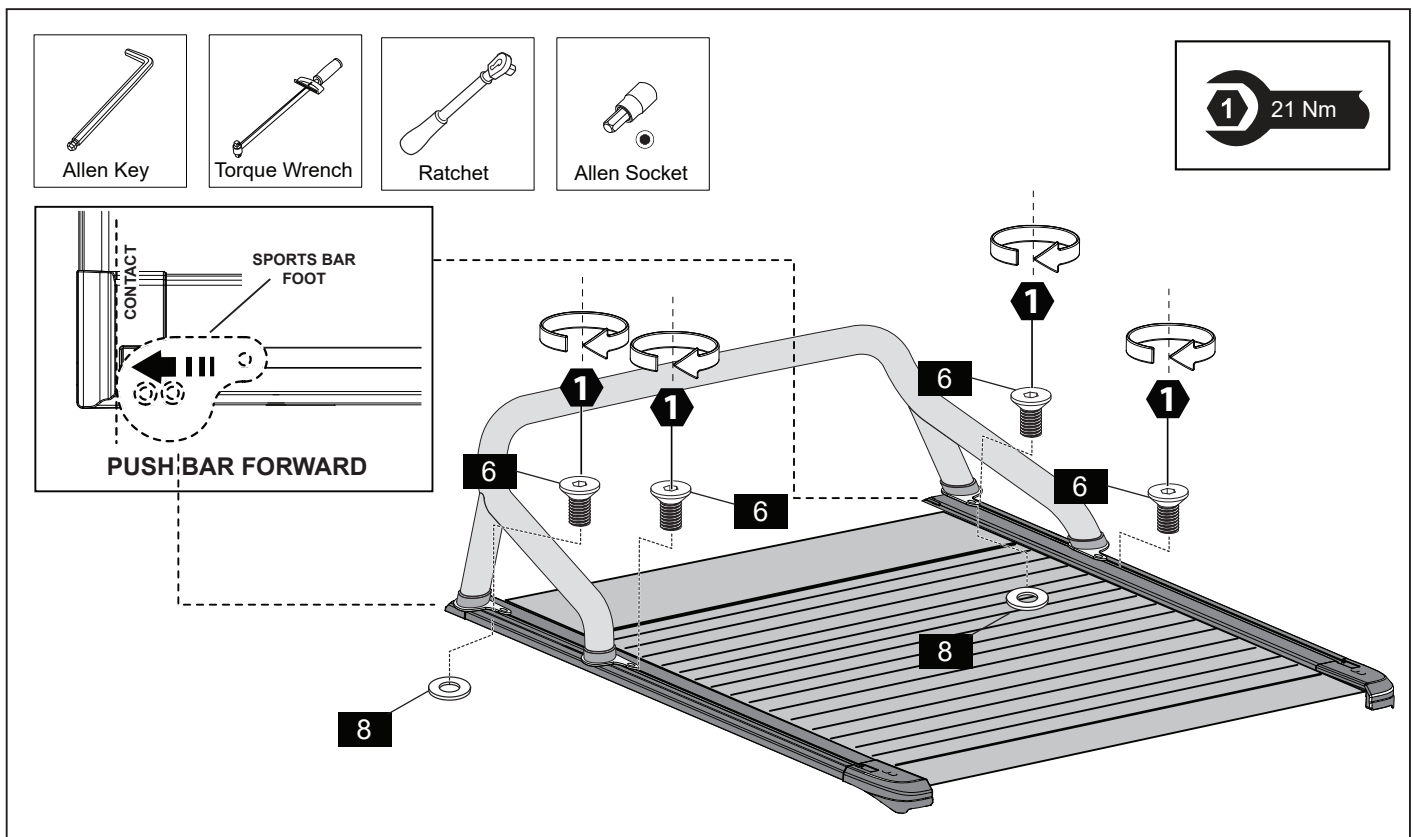

5. Push the sports bar forward so that the front feet are aligned with the front of the corner cap as shown. Reposition the M8 T Nuts (7) in the T-channel to align with the holes in the Foot Plates (1),(2),(3),(4). Place a washer (8) under front foot and then secure the sportsbar in place with four M8 Counter Sunk Socked Head Screws (6). Torque to 21Nm.