

TOY HLX

Rolltrac Sports Bar Installation Instructions

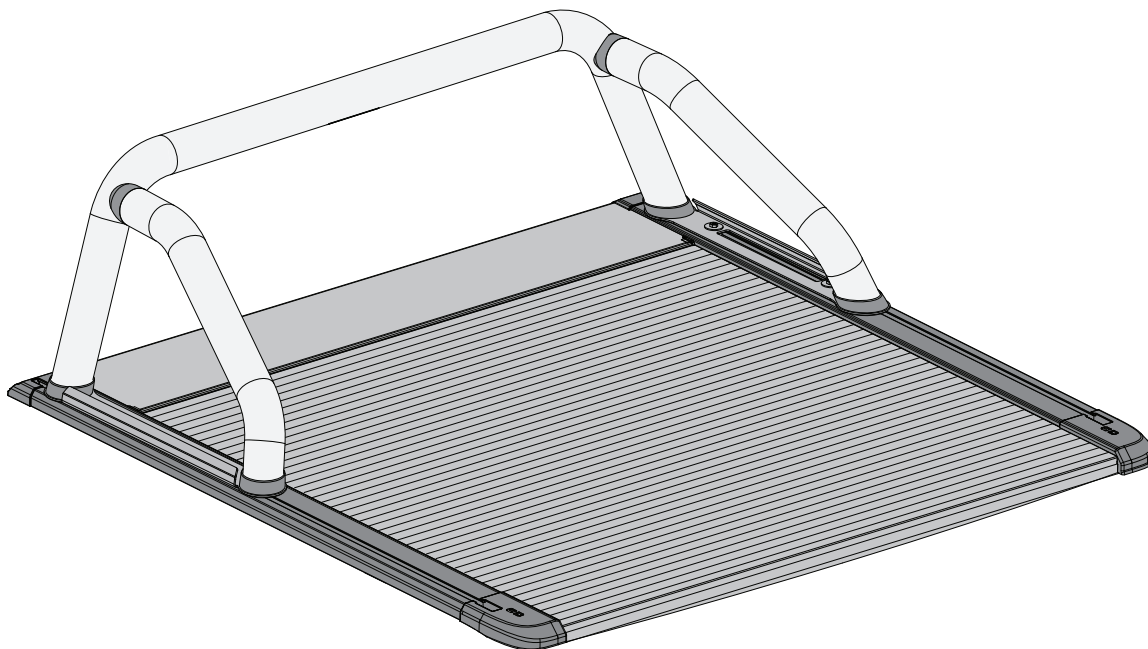

Installation Time: Approx. 30 mins

Place these instructions in vehicle's glove box after installation is complete

General Notes

- Read through the fitting instructions before installation of accessory.
- Always install the accessory following the fitting instructions. Failure to do so may cause damage to the vehicle or the accessory.
- Ensure all recyclable discarded vehicle accessory components and packaging are recycled following local recycling regulations.
- It is always recommended that this accessory is fitted by a qualified Technician.
- Safely store and protect any removed vehicle components.
- Ensure all bare metal surfaces are protected using Automotive Bare Metal Primer and touch-up paint.
- Please check content of kit using this list and subsequent sketches.
- Remove all metal swarf and dust from all vehicle surfaces if surface is used for accessory installation.

Safety Notes

- Check that all work practices comply with safety standards.
- Please wear appropriate clothing and use safety equipment.



Care Instructions:



Clean with mild detergent
and water solution.



Do not use abrasive
cleaners or solvents.



PARTS LIST

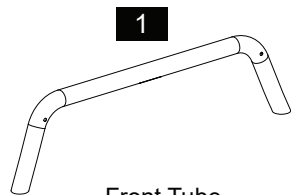

Front Tube
Qty - 1

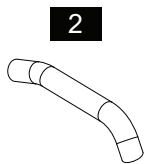

LH Side Tube
Qty - 1

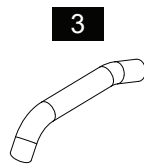

RH Side Tube
Qty - 1

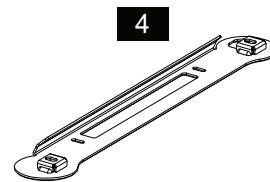

LH Mount Plate
Qty - 1

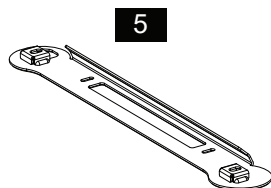

RH Mount Plate
Qty - 1

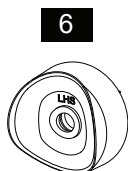

LH Joiner
Qty - 1

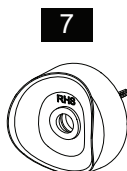

RH Joiner
Qty - 1



Joiner Gasket
Qty - 2

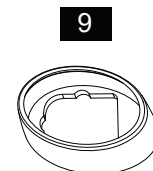

LH Front Foot Cup
Qty - 1

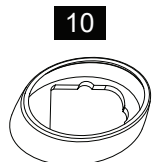

RH Front Foot Cup
Qty - 1

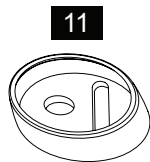

LH Rear Foot Cup
Qty - 1

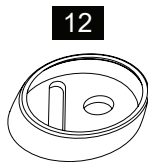

RH Rear Foot Cup
Qty - 1

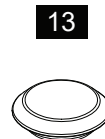

Rubber Grommet
Qty - 2

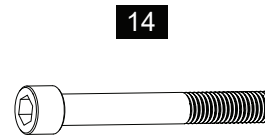

M12 Socket Head
Cap Screw
Qty - 2



Spacer
Qty - 2



M8 Hex Head Bolt
Qty - 4

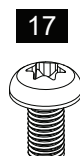

M8 Button Head
Torx Screw
Qty - 4



Slot Nut
Qty - 4



Small Washer (26mm)
Qty - 8

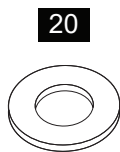

Large Washer (35mm)
Qty - 4

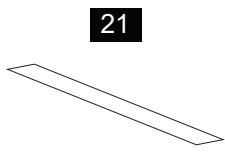

Installation Aid
Qty - 2



Fitting Instructions
Qty - 1

TOOLS REQUIRED

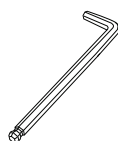

Allen Key



Torx
Screwdriver

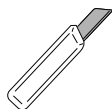

Knife

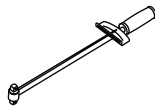

Torque Wrench



Allen Head
Socket



Torx Head
Socket

INSTALLATION INSTRUCTIONS

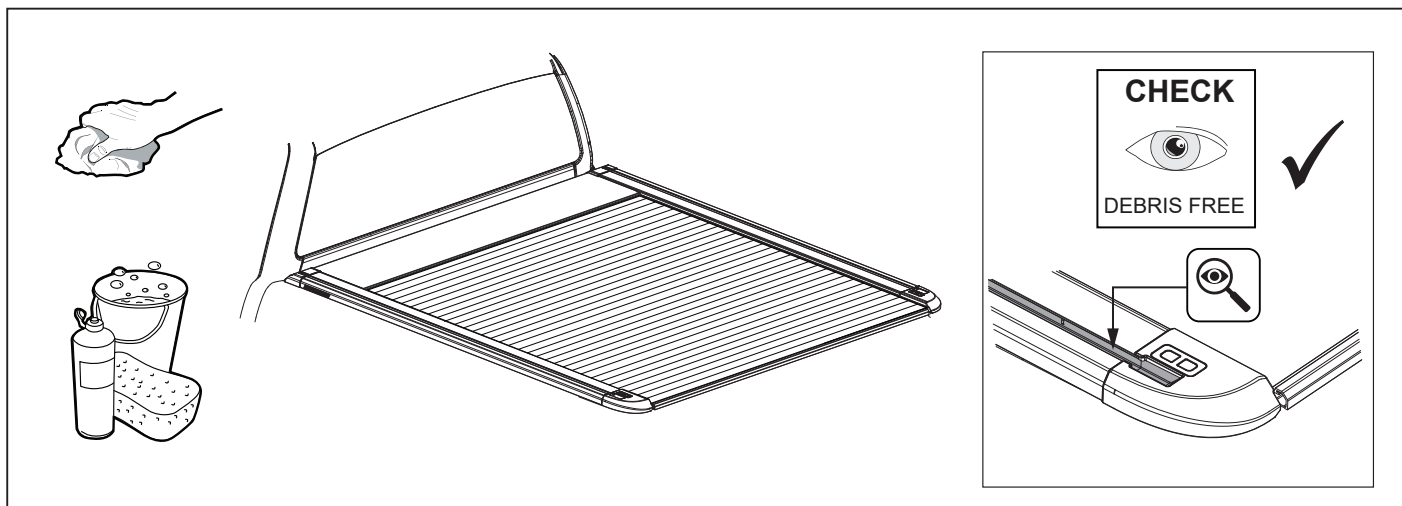

1. Prepare the surface of the side rails by cleaning them thoroughly ensuring that any debris in the side rail channels is completely removed.

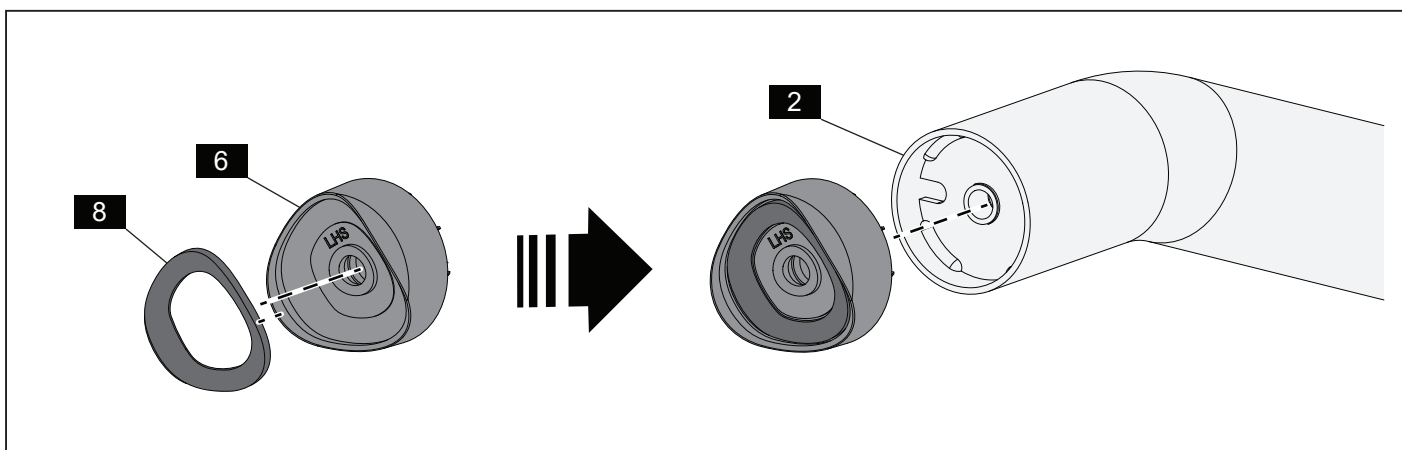

2. Install the Joiner LHS (6) to the top end of the Side Tube LHS (2). Ensure the locating pin on the joiner goes into the recess on the plate for alignment. Repeat for Joiner RHS (7) into the Side Tube RHS (3)

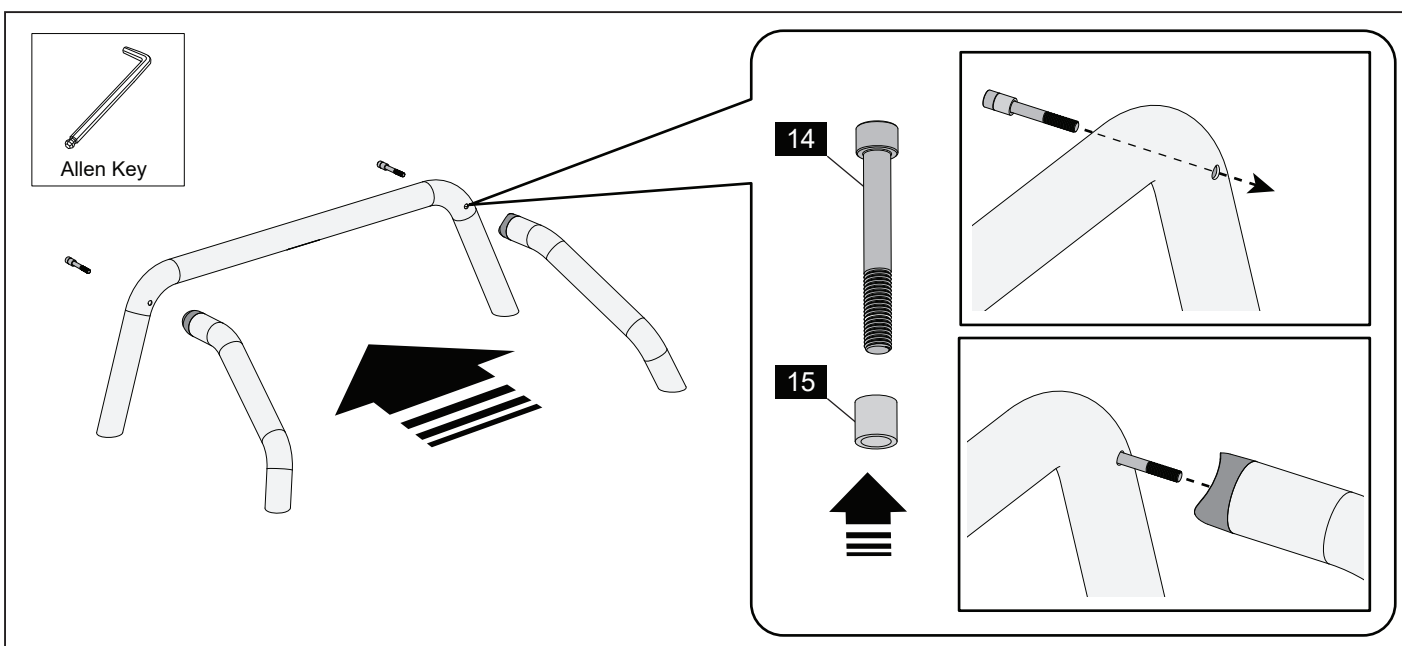

3. Add the Spacer (15) to each of the M12 Socket Head Cap Screws (14). Insert the Screw with Spacer through the front RHS hole of the Front Tube (1). Hold in place with a 10mm hex key. Install the Side Tube RHS to the Front Tube and finger tighten the screw. Repeat for LHS.

BEFORE

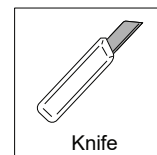
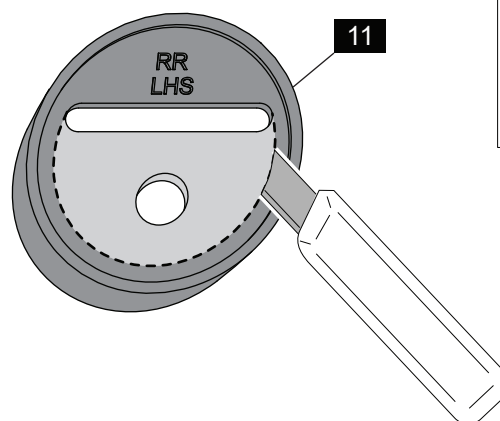
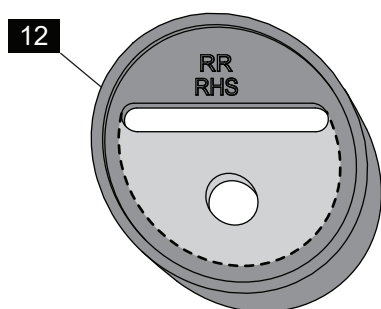

AFTER

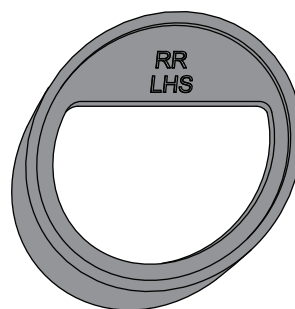
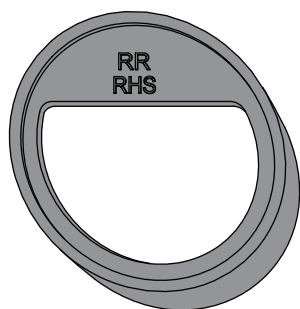

4. Locate the Foot Cups - RR LHS (11) and RR RHS (12).
Mark then cut the Foot Cups as shown and discard the cut out sections (shown above).

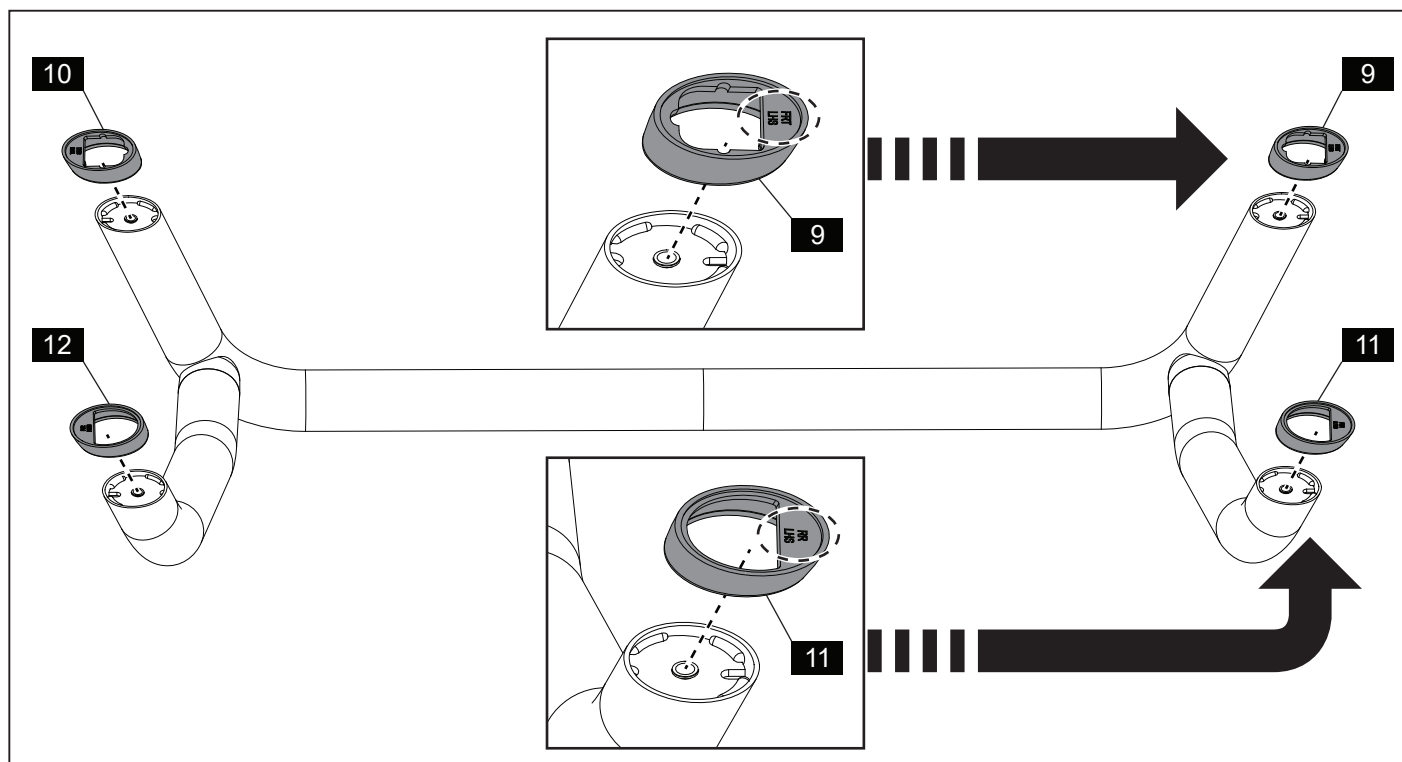

5. Carefully place the Sports Bar upside down.
Push all four Foot Cups (9,10,11,12) onto the corresponding foot of the Sports Bar. Ensure the Foot Cups are correctly oriented, with text to the outside of the Sports Bar.

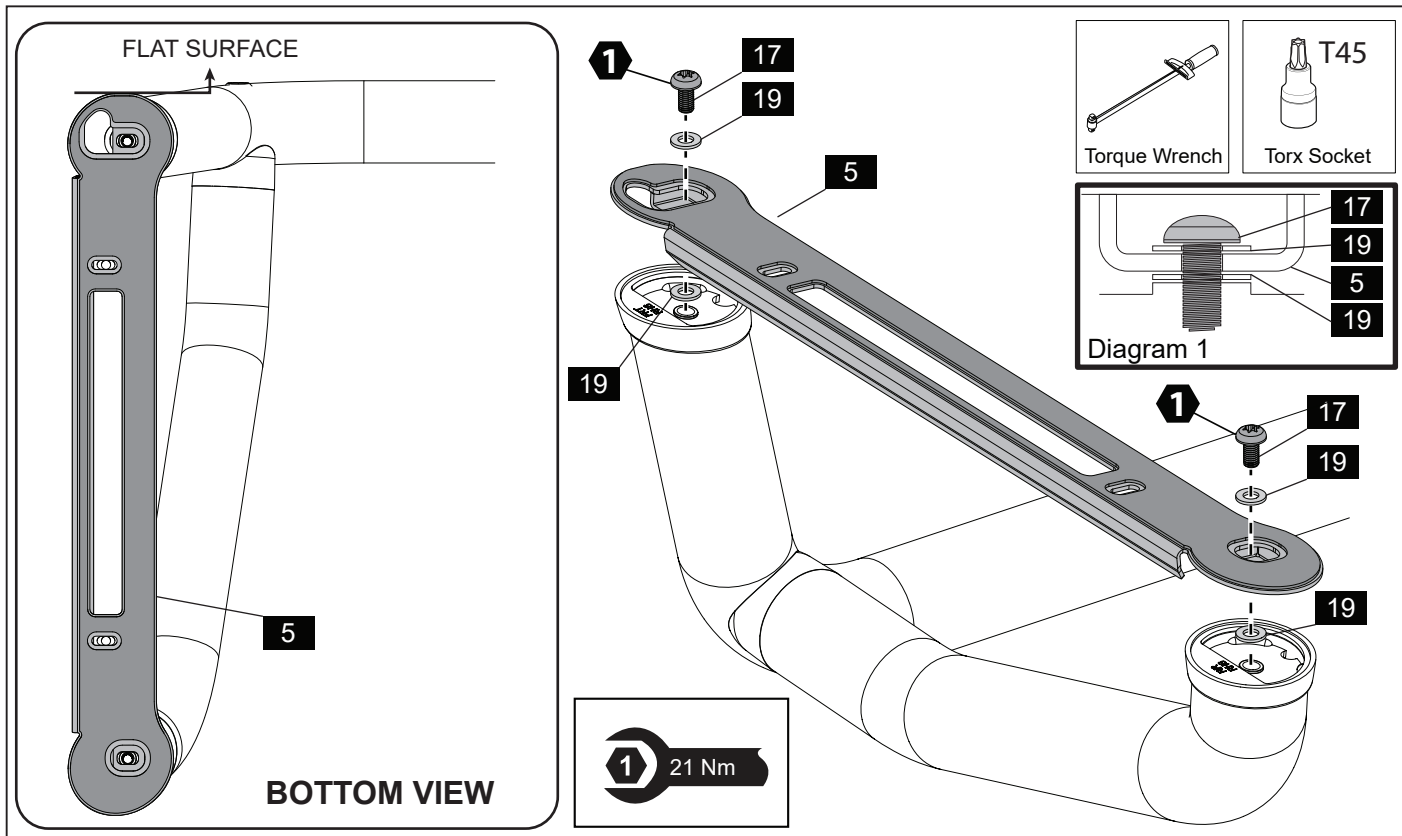

6. Place a Small Washer (19) between the Mount Plate and Sportsbar foot at each screw position. Then secure the Mount Plate RHS (5) with the M8 Torx Screw (17) and Small Washer (19). See Diagram 1 for detail. Tighten to 21Nm. Repeat for the LHS.

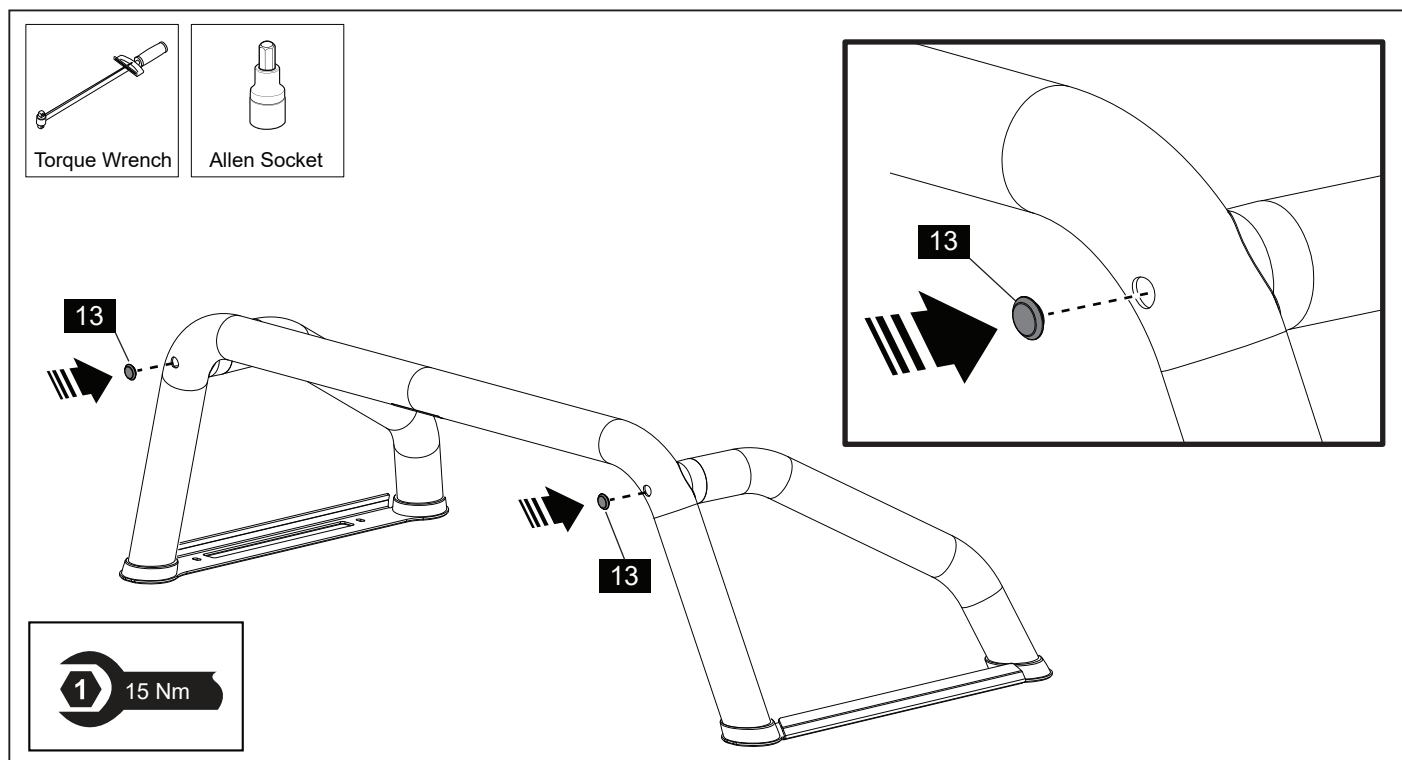

7. Carefully place the Sports Bar upright. Using a 10mm hex socket, tighten the M12 Socket Head Cap Screws (14) holding the Side tubes to the Front tube. Torque to 15Nm. After tightening, insert the Rubber Grommets (13) to cover each hole.

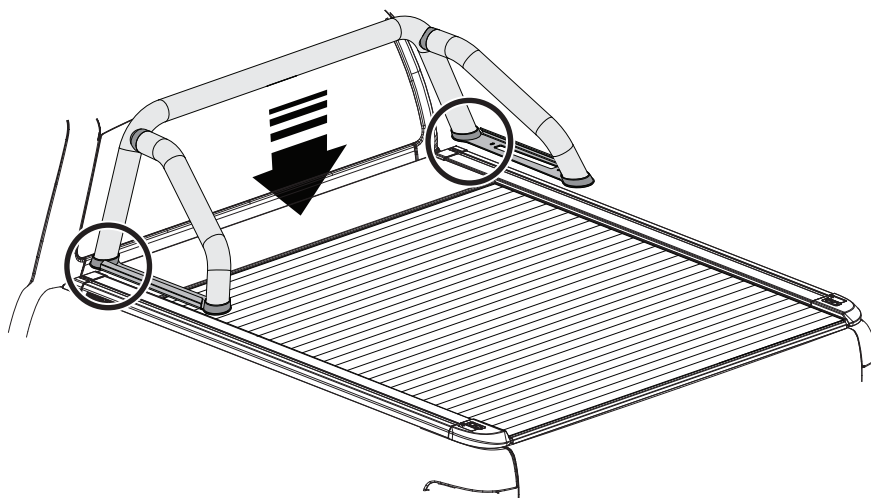
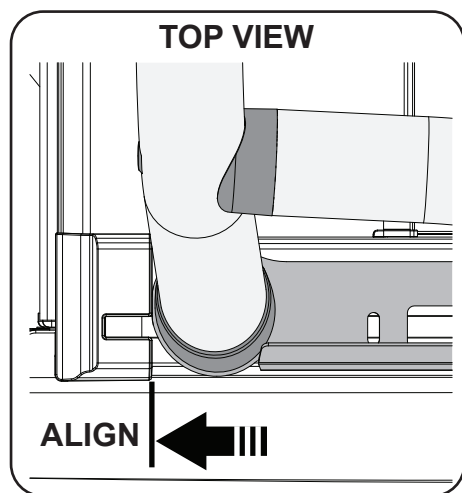

8. Carefully lower the Sports Bar onto the side rails.
Position the Sports Bar such that the Mount Plates align to the RollTrac End Caps.

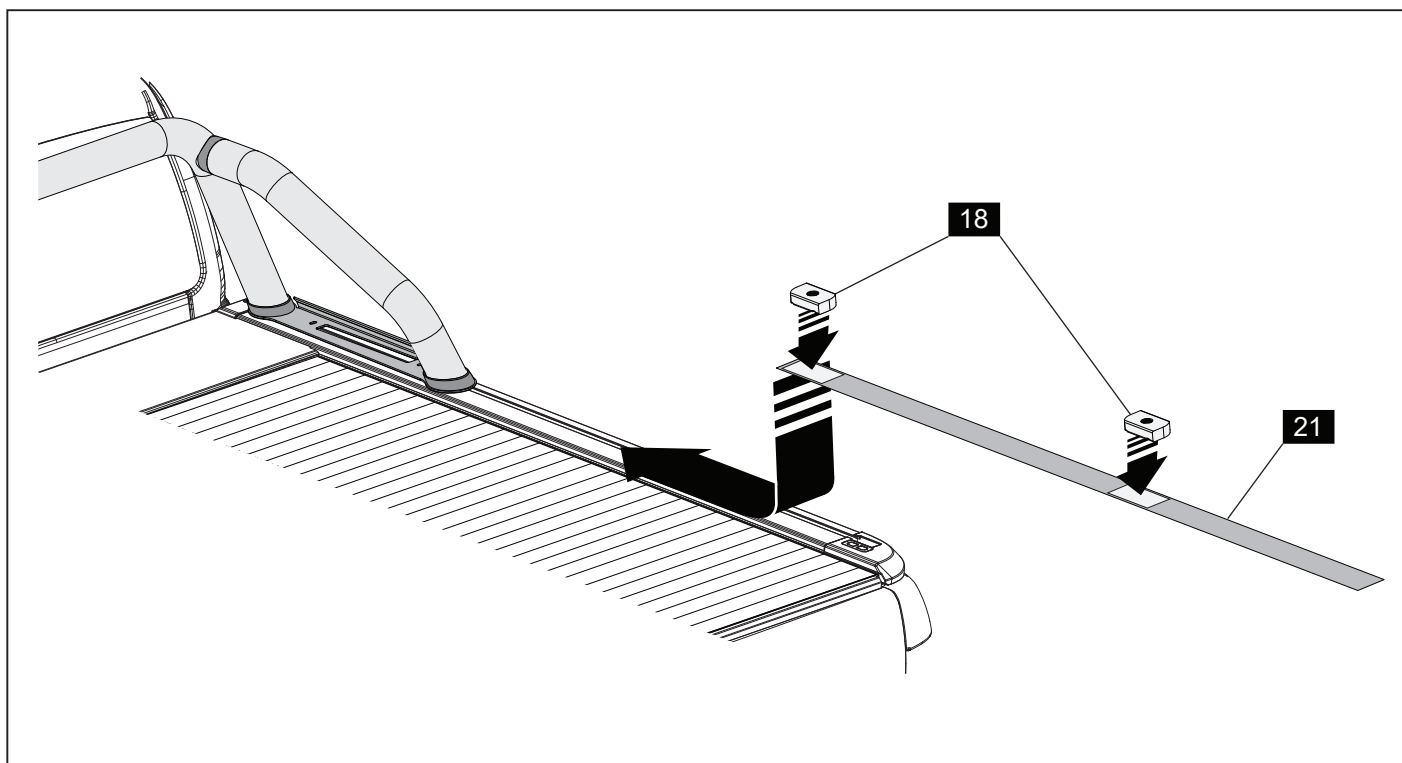

9. Insert the Installation Aid (21) into the T-Channel of the side rail. Slide two Slot Nuts (18) into the T-Channel and position them on top of the Installation Aid.

Note: The Installation Aid serves two purposes.

1. To assist in repositioning the Slot Nut under the Mount Plate.
2. Reduce the clearance between the Slot Nut and Mount Plate, ensuring the M8 Hex Head Bolt is able to contact the Slot Nut thread.

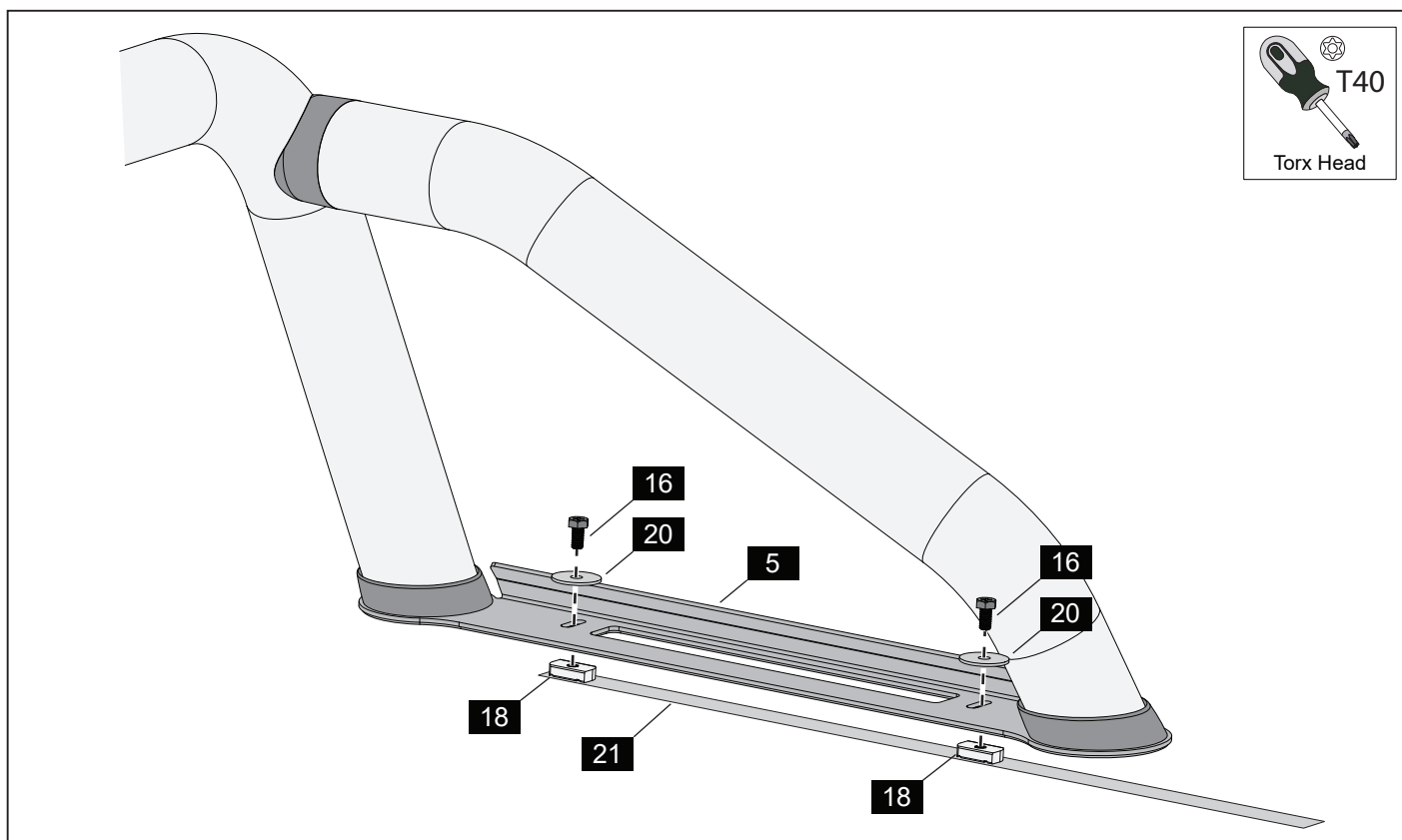

- 10.** Reposition the Slot Nuts (18) inside the T-Channel using the Installation Aid (21) and align with the holes in the Mount Plate RHS (5). Loosely install the M8 Hex Head Bolts (16) and the Large Washers (20) through the Mount Plate RHS. Once both Screws are finger tightened, remove the Installation Aid from the T-Channel and repeat for the LHS.

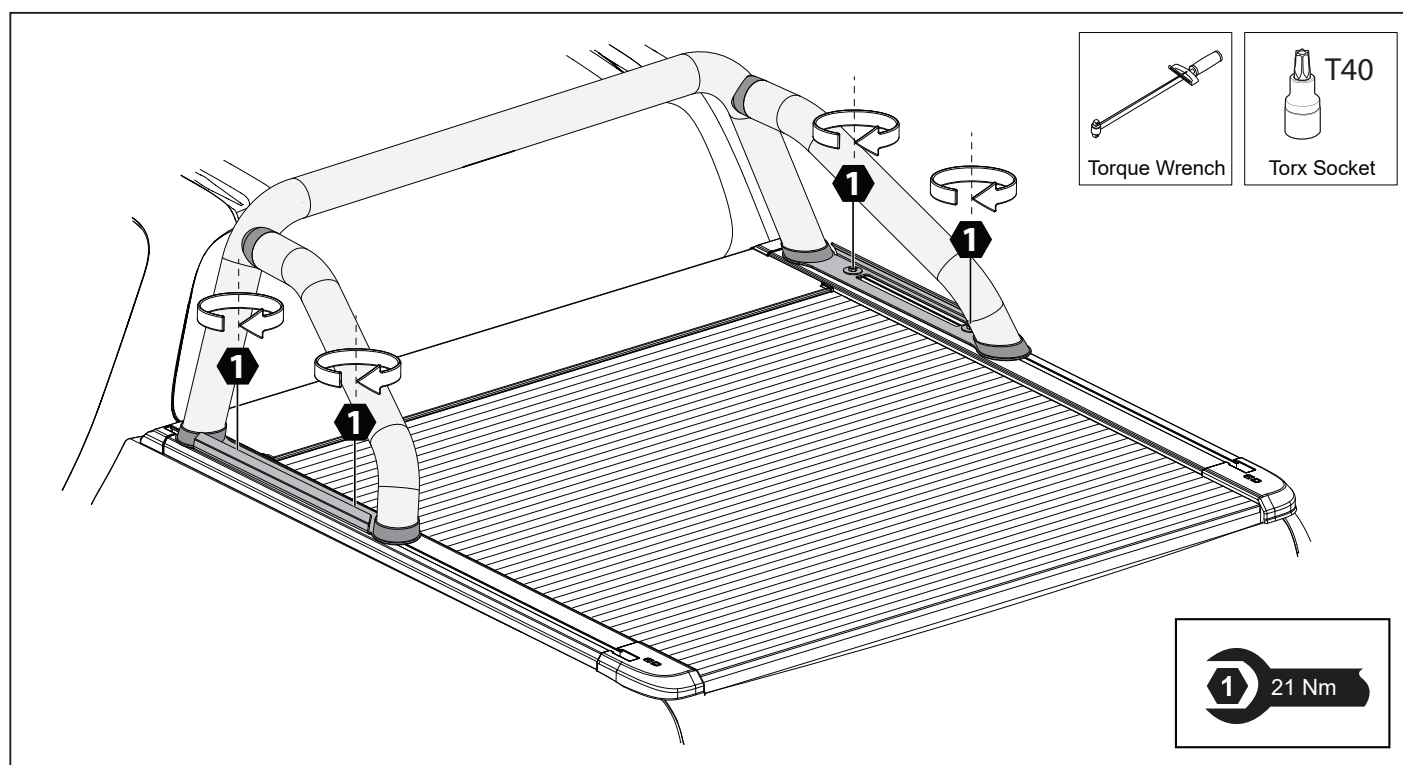

- 11.** Tighten all M8 Hex Head Bolts (16) to 21Nm.