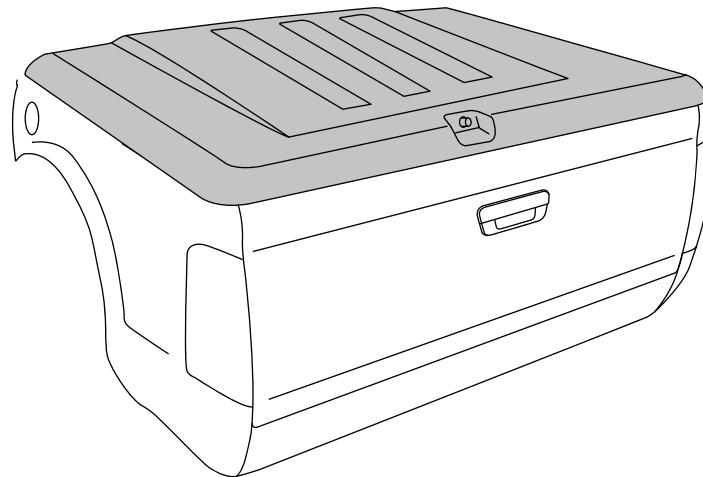


**GMH COLORADO RG**

**Installation Time:**  
2 Hour (Approximately)

**PLEASE KEEP INSTRUCTIONS IN GLOVE BOX FOR FURTHER USE**

**RECOMMENDED TOOL LIST - (Not Supplied in Kit)**

- Hammer & Centre Punch
- Non-permanent Marker
- Phillips Head Screwdriver
- Rivet Gun
- T40 size Torx Bit
- Ø5.5, Ø7.0 mm Drill Bit
- Drill
- Cleaning Cloth
- Socket Wrench 10,12,13mm
- Tape Measure
- Masking Tape
- Spanner 10,13mm
- Silicon Dispenser and Silicone

**IMPORTANT:** To obtain correct installation, we recommend that you follow these step by step instructions carefully. Failure to do so may result in improper fit and or retention.

- Please take care when assembling and installing this product to protect the finish and your investment.

**Finish Protection:**

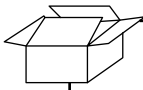
- Only use cleaners, waxes, or products that are labelled safe for use on plastics. Avoid the use of any chemicals to clean your Tonneau Cover unless labelled safe for plastics. Avoid use of abrasive type cleansers as they may dull the finish.
- If fuel is splashed onto the Tonneau Cover immediately wash it off with car washing detergent and water. If staining is apparent polish the stain out with a commercially available car polish.

**Maintenance:**

- The gas struts are self lubricating and should only be cleaned occasionally with a damp cloth. Premature seal failure will result if solvents or lubricants are used to clean struts.
- The locking mechanisms & Latches only require occasional lubrication with Graphite Powder. DO NOT use any other lubricants or oils. Using alternative products will VOID Warranty.
- All installation hardware and fasteners must be checked every so often for tightness.

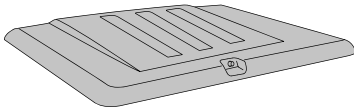
**Disclaimer:** The buyer assumes all risk and liability whatsoever from the installation and use of our products. Our products are sold as decorative accessories and should not be relied upon as protection for the vehicle or occupants in the event of a collision or rollover. The manufacturer assumes no liability for injury, loss, incidental or consequential damages in the event of a collision or rollover.

### PARTS CHECK SHEET



#### PARTS IN MAIN CARTON

**1**



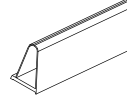
Tonneau Cover  
Qty - 1

**2**



Header Rail  
(HBAR0012)  
Qty - 1

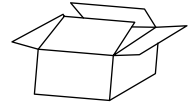
**3**



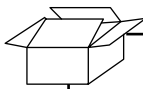
Header  
Rail Seal  
(MISC2229-9)  
Qty - 1



Lock Keys  
(Attached to  
Tonneau)  
Qty - 2

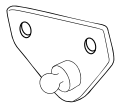


Fitting Kit  
KIT033411  
Qty - 1



#### PARTS IN FITTING KIT (KIT033411)

**4**



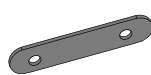
Ball Strut  
Bracket  
(CLIP2034-1)  
Qty - 2

**5**



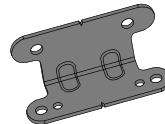
Hinge Pin  
(CLIP2808)  
Qty - 2

**6**



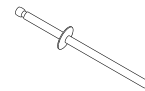
Striker  
Packer  
(CLIP2809PC)  
Qty - 2

**7**



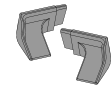
Striker  
Bracket  
(CLIP2874PC)  
Qty - 2

**8**



Pop Rivet  
(FAST0505)  
Qty - 4

**9**



Corner Piece  
Moulding  
(INJM0012-1)  
Qty - 1 Pair

**10**



Primer Stick  
(MISC1365)  
Qty - 2

**11**



Striker U-Bolt  
(LOCK0006)  
Qty - 2

**12**



Alcohol Wipe  
(MISC0052)  
Qty - 2

**13**



Rubber  
Thread Cap  
(MISC2532)  
Qty - 4

**14**



Rust Inhibitor  
(MISC2776)  
Qty - 1

**15**



Side Rail  
Drill Template  
(MISC3477)  
Qty - 1

**16**



M6 S/S  
Hex Nut  
(NUTS0161)  
Qty - 8

**17**



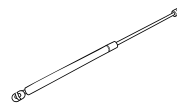
M8x25 Hex  
Head Bolt  
(SCRW0696)  
Qty - 4

**18**



M6x25 Csunk  
Screw  
(SCRW0862)  
Qty - 5

**19**



Gas Strut  
(STRT0021)  
Qty - 2

**20**



M6 S/S  
Spring Washer  
(WASH0103)  
Qty - 4

**21**



M8 S/S  
Spring Washer  
(WASH0152)  
Qty - 4

**23**



M6 Small S/S  
Flat Washer  
(WASH0153)  
Qty - 8

**24**



M8 S/S  
Flat Washer  
(WASH0171)  
Qty - 4

**25**



M8 Black  
Flat Washer  
(WASH0171-1)  
Qty - 6

**26**



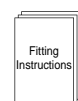
Blackout Decal  
RHS  
(LABL1508)  
Qty - 1

**27**

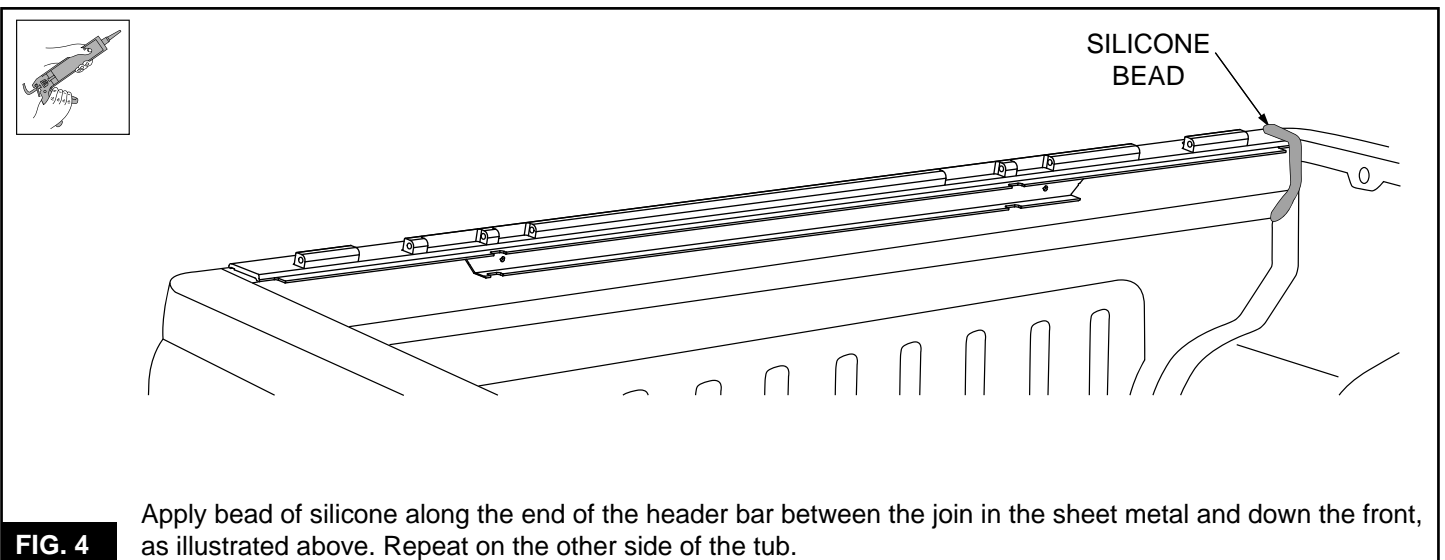
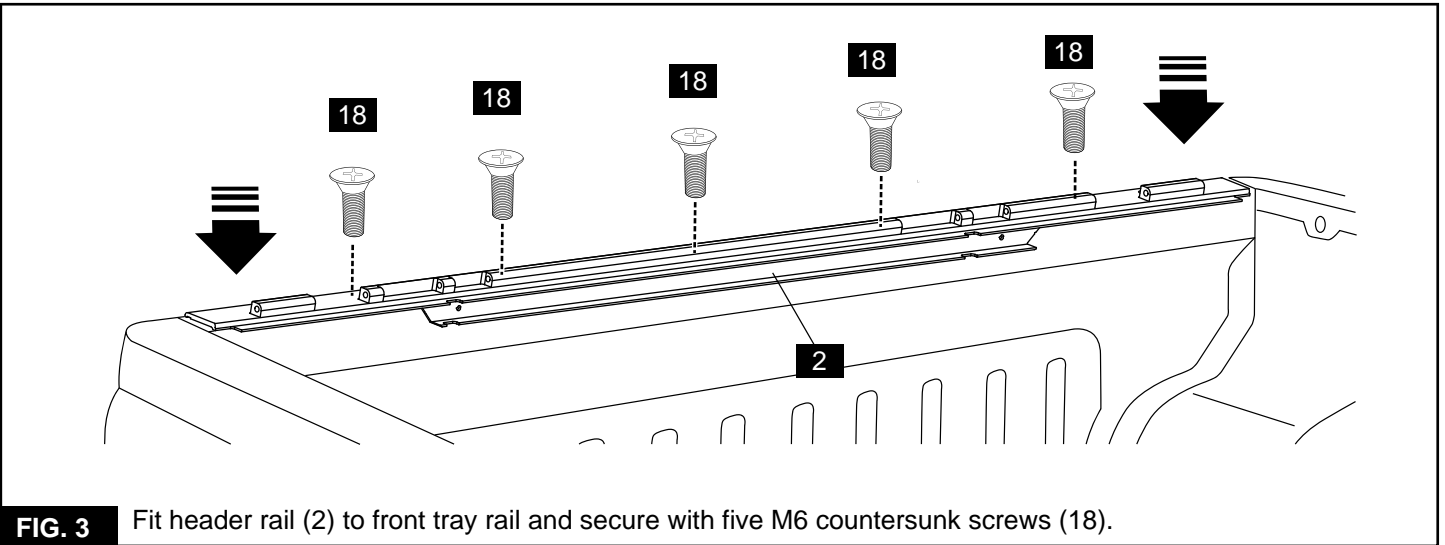
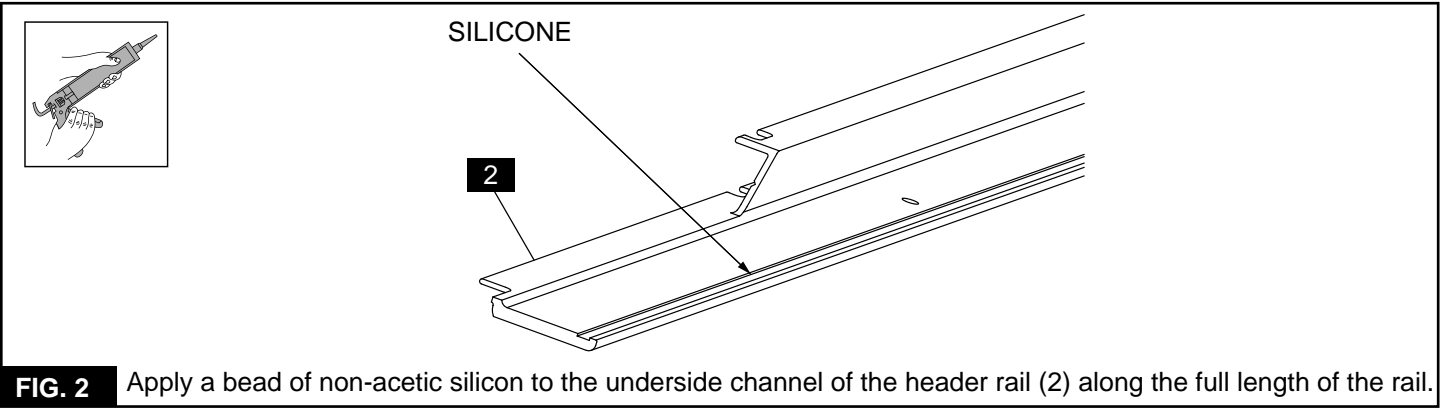
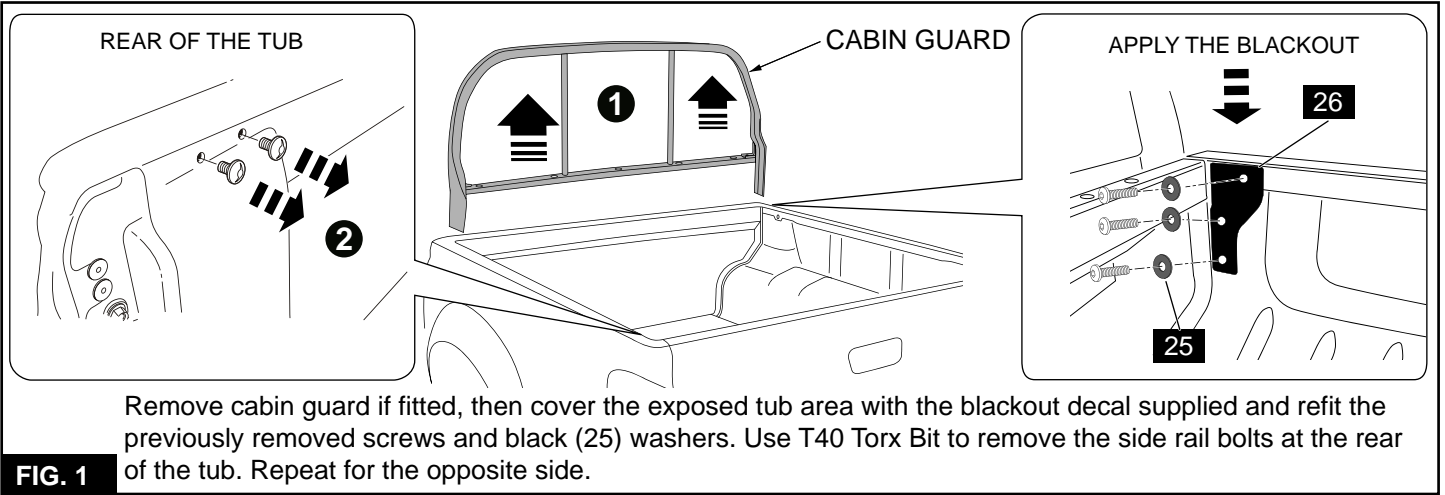


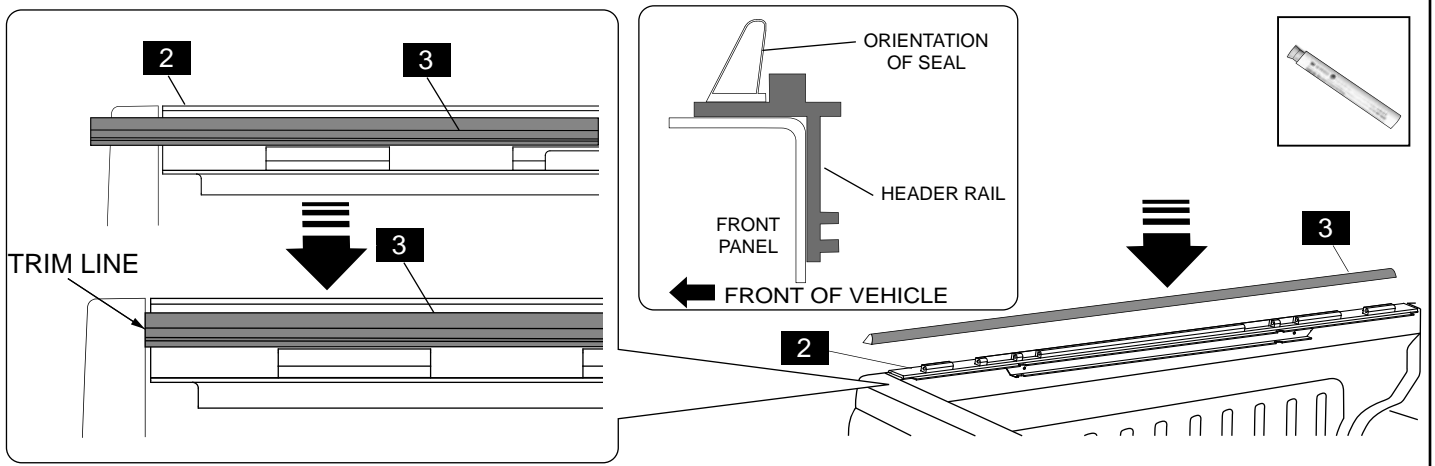
Blackout Decal  
LHS  
(LABL1507)  
Qty - 1

**28**

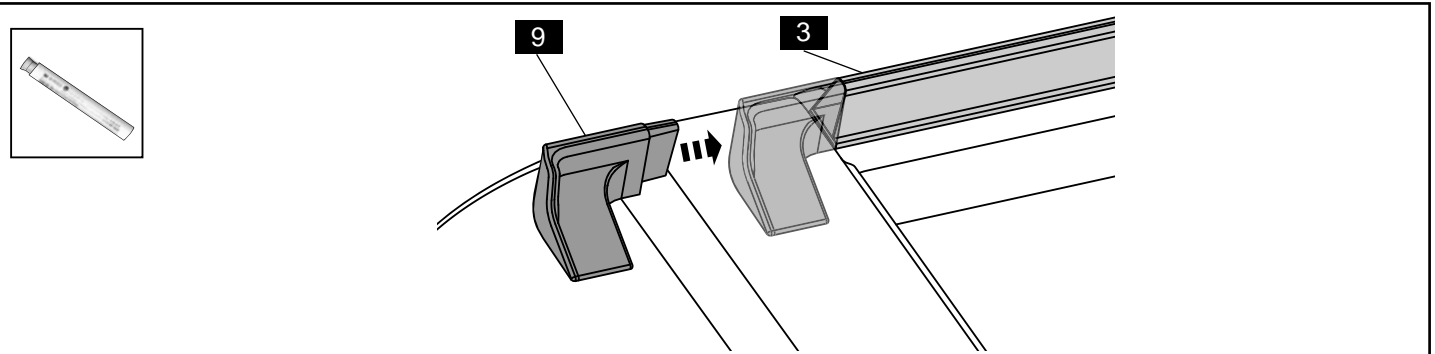


Fitting  
Instruction  
(FIT-TC0315)  
Qty - 1

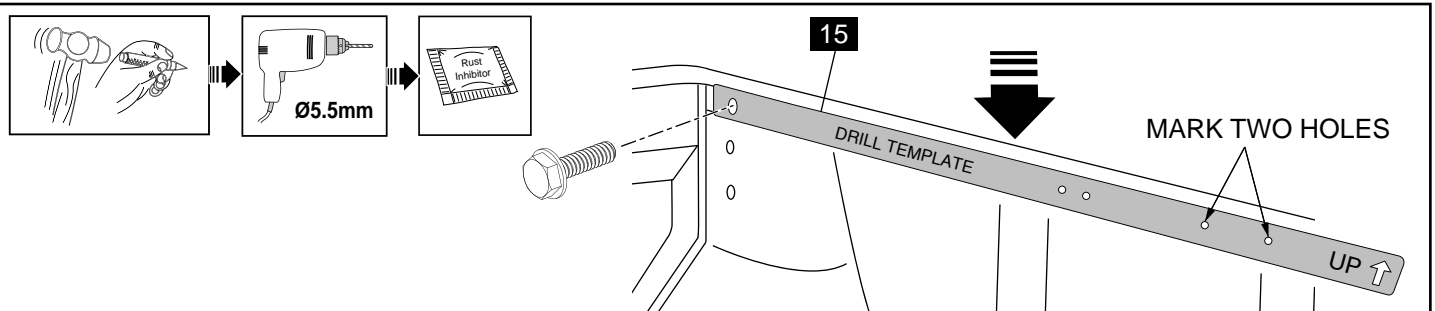




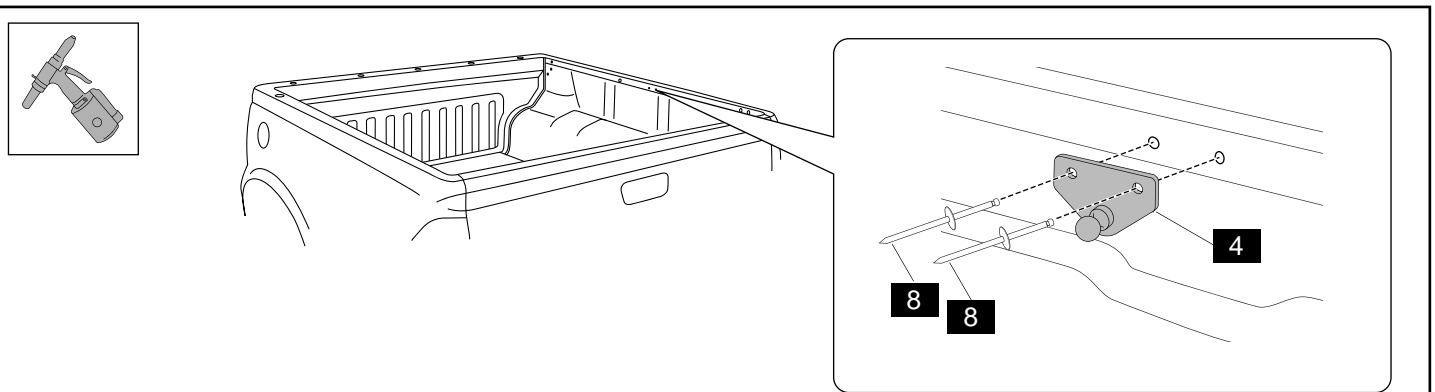
**FIG. 5** Use the primer supplied to prime the top of the header rail and then apply the bulb seal (3) along the top of the header rail (2), ensuring it is central on header rail. Trim the bulb seal on each end in line with the side bed rail.



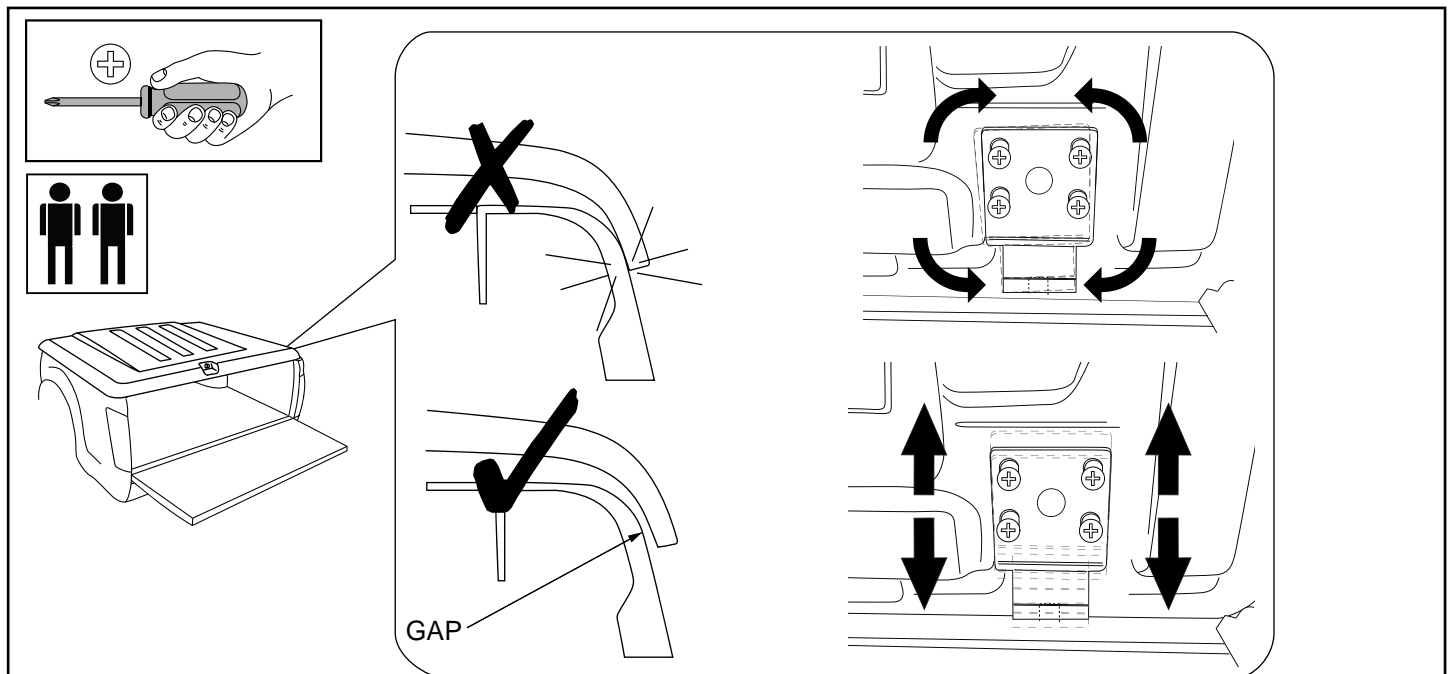
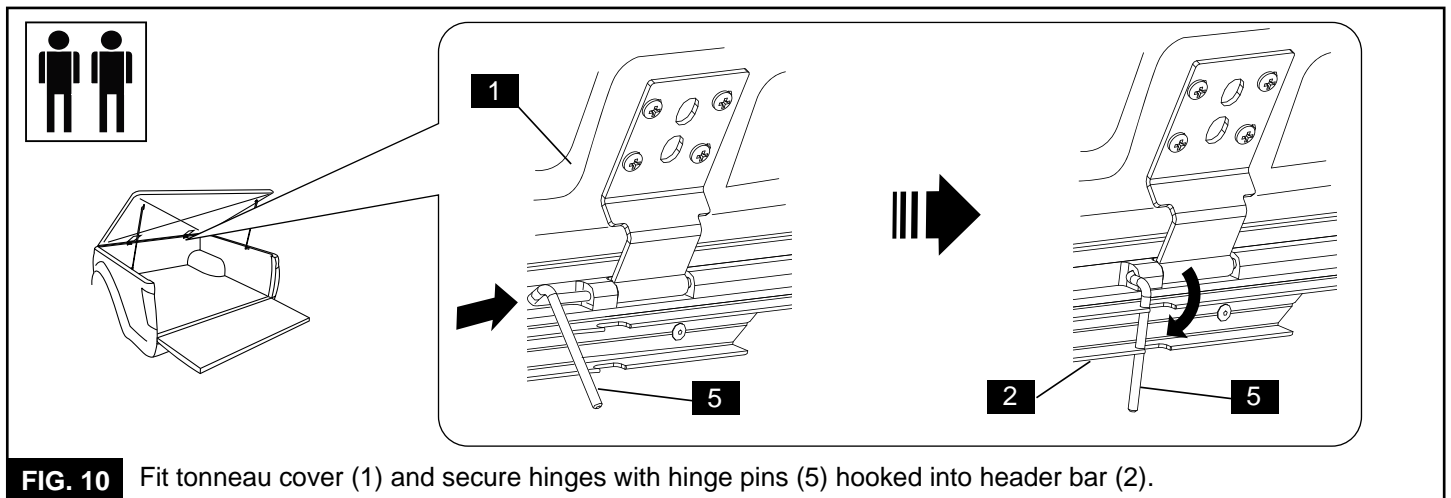
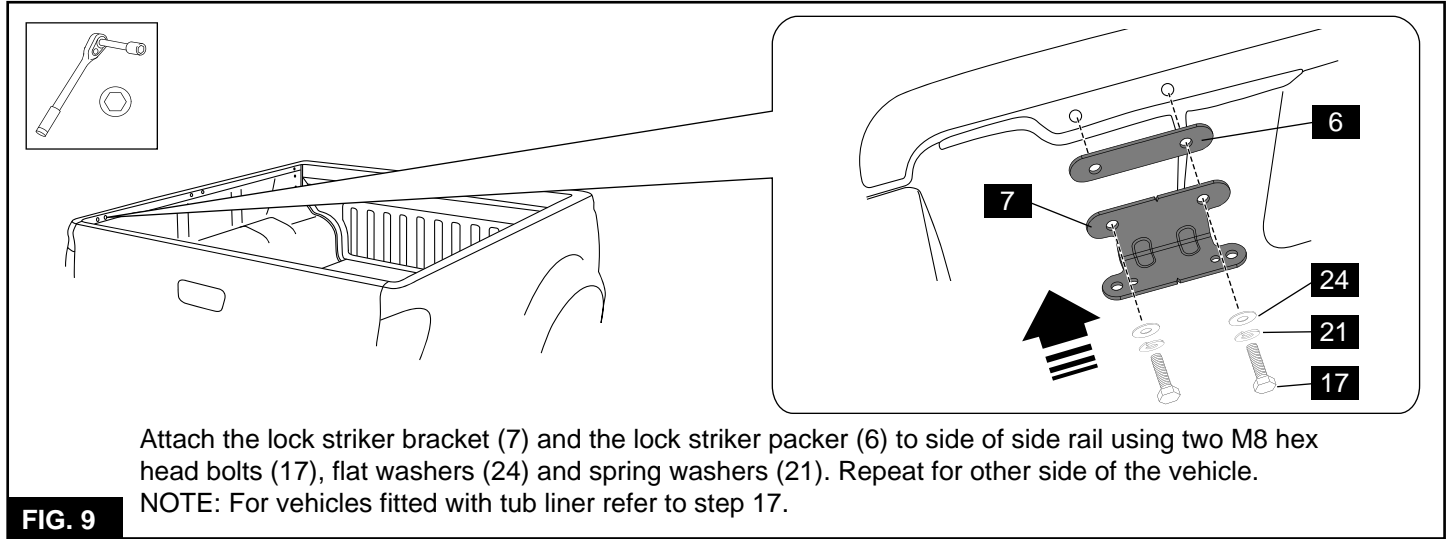
**FIG. 6** Trail fit the corner piece (9) to the bulb seal (3) and mark its position. Clean the marked area and apply primer to the area. Remove tape liner from corner piece moulding and fit into header rail seal and apply firm pressure down onto side rail as shown. Repeat process for the other side of the vehicle.



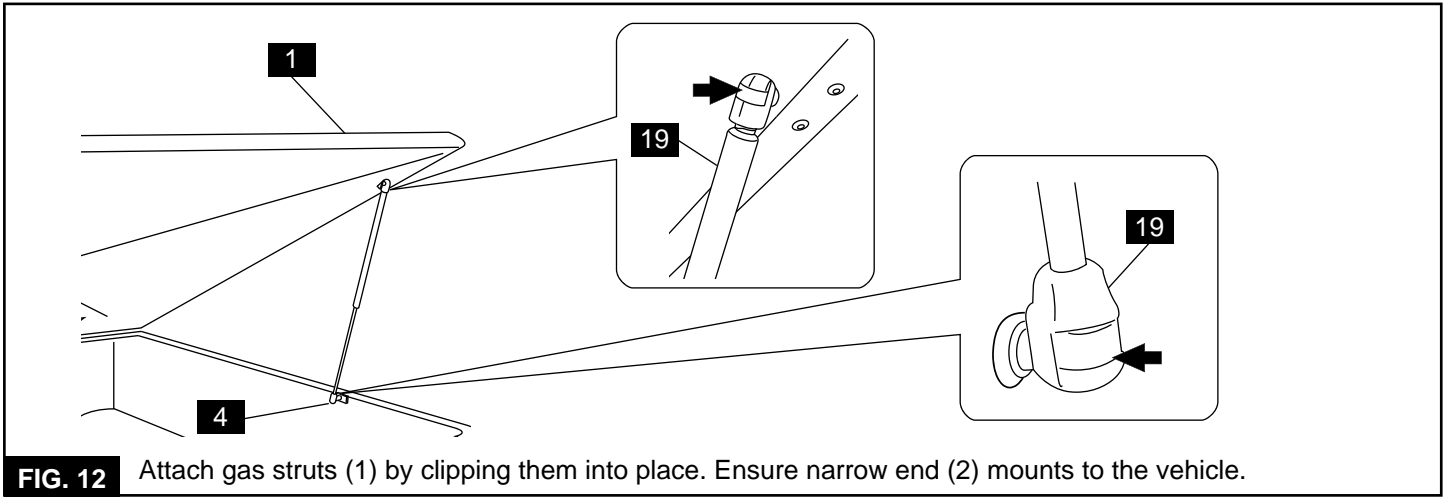
**FIG. 7** Use the T40 Torx Bit to remove front side rail bolts from the tub and then position the drill template (15) on the inside of the tub rail, ensure arrow faces upwards and secure with M8 bolt through hole in template. Ensure the template is aligned centrally on the inside of the side rail and mark the two rear holes. Reverse the template and repeat for other side of tub. Centre punch and drill the marked holes with a 5.5mm drill bit. Apply rust inhibitor to the drilled holes.



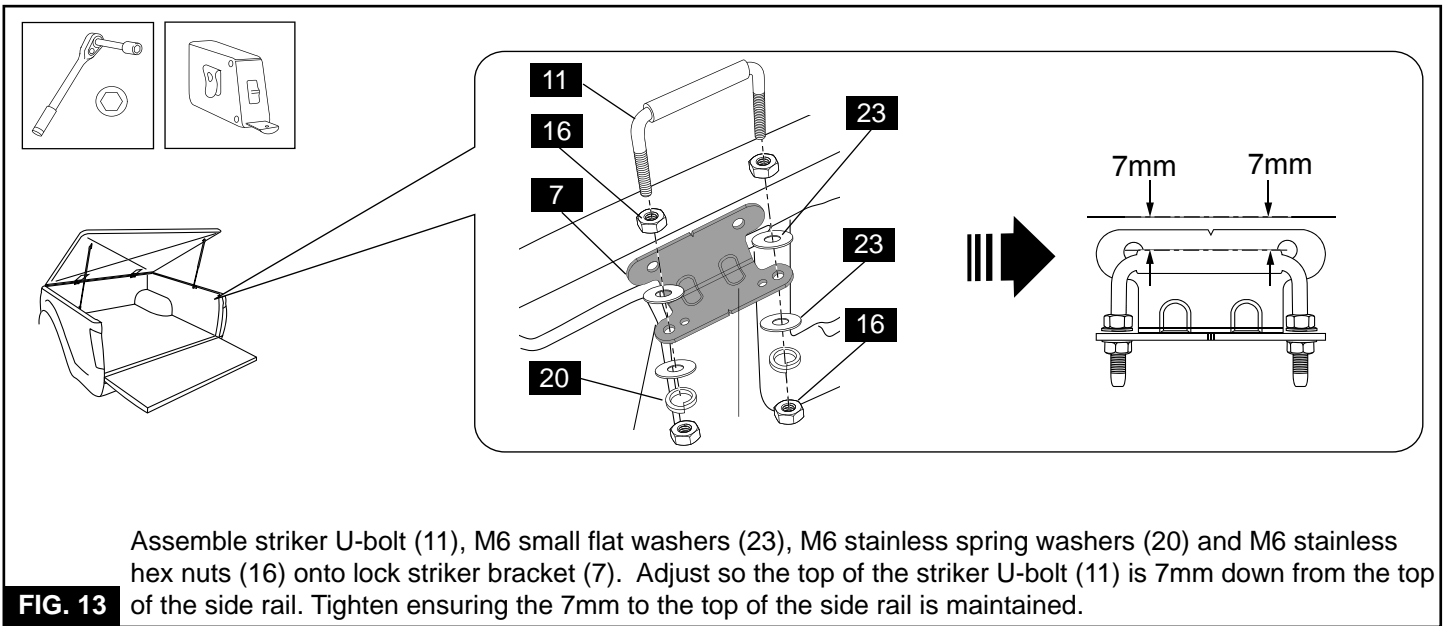
**FIG. 8** Position the gas strut bracket (4) to correspond with the two 5.5mm drilled holes in the side rail. Attach the gas strut bracket to the side rails using two rivets (8). Repeat for other side of the vehicle.



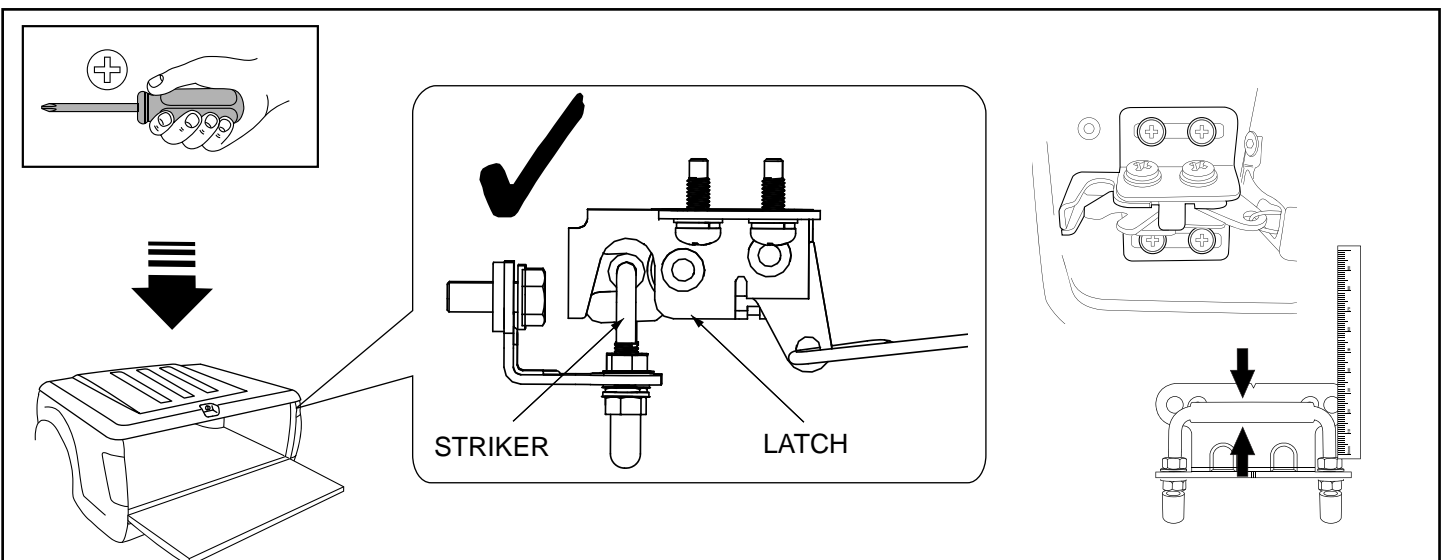
**FIG. 11** Check clearance of tonneau cover to vehicle rear corners. Ensure the tailgate is open and close tonneau cover. Check clearances at both rear corners between tonneau cover and sheet metal, gaps should be consistent and at least 2mm. If tonneau cover is touching sheet metal or gaps are not even, adjustment may be required.



**FIG. 12** Attach gas struts (1) by clipping them into place. Ensure narrow end (2) mounts to the vehicle.



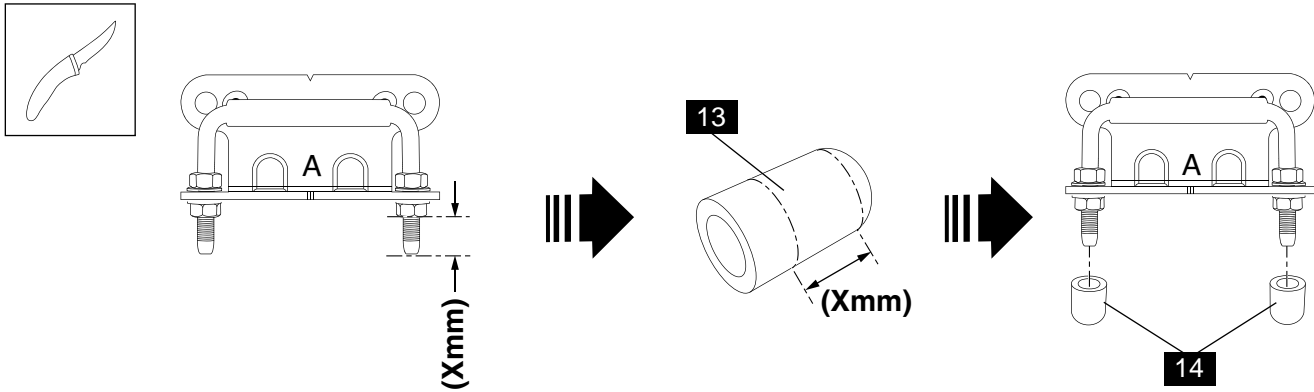
**FIG. 13** Assemble striker U-bolt (11), M6 small flat washers (23), M6 stainless spring washers (20) and M6 stainless hex nuts (16) onto lock striker bracket (7). Adjust so the top of the striker U-bolt (11) is 7mm down from the top of the side rail. Tighten ensuring the 7mm to the top of the side rail is maintained.



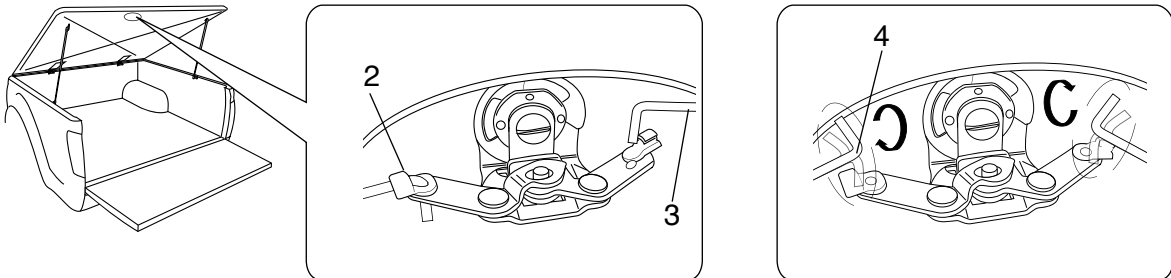
**Latch alignment.** Ensure the tailgate and tonneau are open. Slowly close the tonneau cover holding it in the middle and look where the latches will engage the hoop of the striker and make sure the latches are closing over the striker centrally. Note the latches have 2 stages and should close fully over the striker. Check both sides. If the latches do not fully engage the strikers have been positioned too low and will need to be lifted. If cross vehicle adjustment is required loosen the screws holding the latch and re-position them manually over strikers. Tighten latch screws with tonneau cover closed over the striker while the latch is in the right position. Ensure the latch is angled at 90° to the striker before re-tightening screws.

**IMPORTANT: Do not slam the tonneau cover closed until the latch position has been verified because it could damage the latches.**

**FIG. 14**



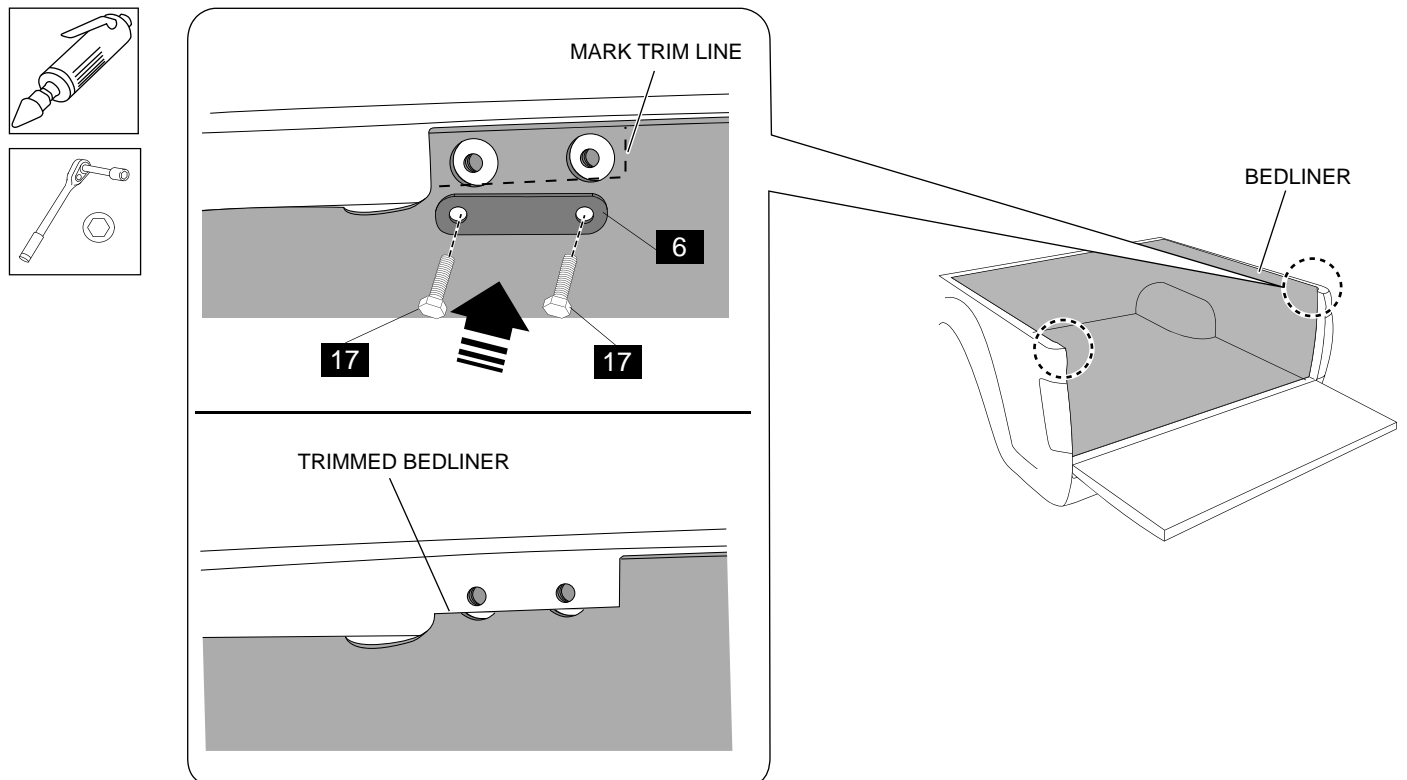
**FIG. 15** Measure the length of exposed thread (Xmm) from bottom of the nut to the end of the thread. Measure length (Xmm) on the rubber thread cap (13) and cut to length. Repeat for four thread caps and fit to threads.



Push button lock operation. Open tonneau cover, manually close latches and depress push button lock, both latches should open immediately. If latches do not open you may need to adjust the length of pull rods inside tonneau cover. To do this remove inspection cover by removing the two scrivenets and rotating it clockwise. Release plastic retainer clips (2) and unclip pull rods (3), do one at a time. If pull rods are too long they can be shortened by twisting clockwise. If too short they can be lengthened by twisting anti-clockwise. After a couple of turns put pull rods back into position and check operation of push button lock, adjust until lock operation is good.

**FIG. 16**

**STEP #17 ONLY FOR VEHICLES FITTED WITH BEDLINER**



Screw the striker packer (6) on top of the tub liner with M8 bolts (17). Mark the bed liner around the packer. Remove the packer (6). Cut the tub liner as shown using die grinder or Dremel. Repeat for the opposite side.

**FIG. 17**

**REMOVAL OF TONNEAU COVER**

**REPLACEMENT OF TONNEAU COVER**

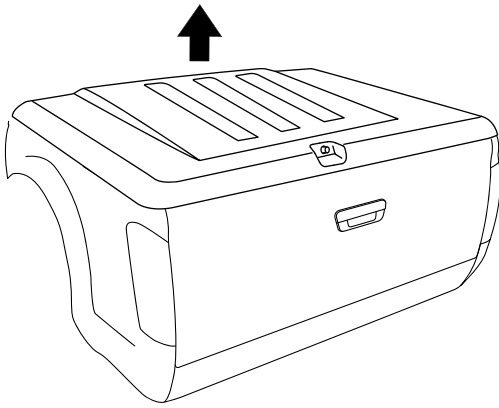


FIGURE 1

1. Open tonneau cover, Detach gas strut (1) by inserting a small screwdriver and adjusting the spring clip (2) on the gas strut (1). Refer to figure 2.  
**NOTE:** Do not remove the spring clip. only a small amount of levering is required to detach.

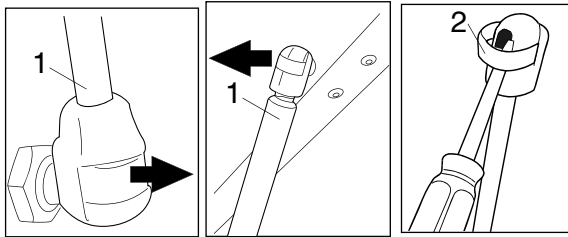
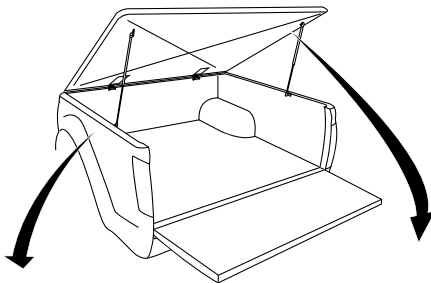


FIGURE 2

**NOTE:** 2 people are required to lift and remove the tonneau cover from the vehicle.

2. Remove hinge pins (1) and remove tonneau cover (2). Refer to figure 3.

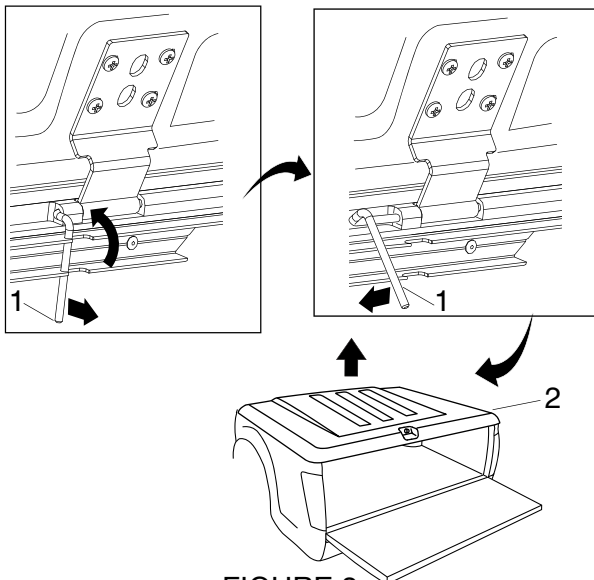


FIGURE 3

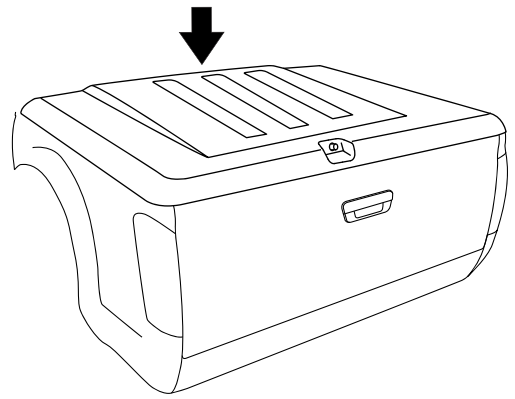


FIGURE 4

**NOTE:** 2 people are required to lift and fit the tonneau cover onto the vehicle.

1. Fit tonneau cover (2) and secure hinges with hinge pins (1). Refer to figure 5.

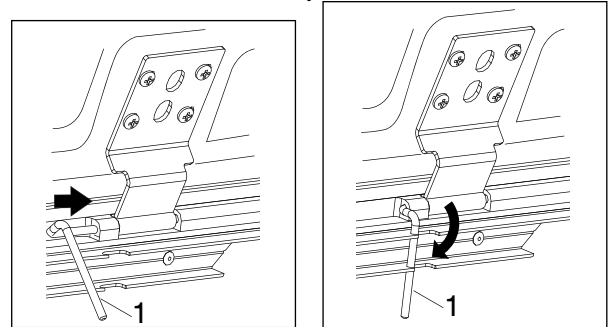
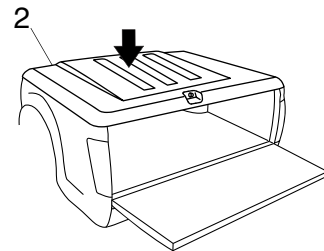


FIGURE 5

2. Attach gas struts (2) by clipping into place. Ensure narrow end (1) mounts to the vehicle. Refer to figure 6.

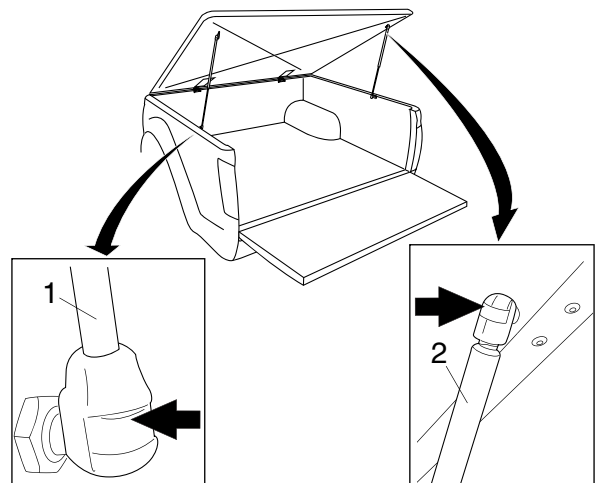


FIGURE 6